

STATE OF HAWAII
DEPARTMENT OF LAND AND NATURAL RESOURCES
Land Division
Honolulu, Hawaii 96813

May 22, 2015

Board of Land and Natural Resources
State of Hawaii
Honolulu, Hawaii

PSF No.: 15MD-075

Maui

Issuance of a Right-of-Entry Permit to the Association of Apartment Owners (AOAO) of Hale Kaanapali for the Removal of Vegetation (Naupaka) from within the Beach Transit Corridor / Shoreline at North Kaanapali Beach, Hanakaoo, Kaanapali, Lahaina, Maui; TMK: (2) 4-4-006: Seaward of 011.

APPLICANT:

Association of Apartment Owners (AOAO) of Hale Kaanapali.

LEGAL REFERENCE:

Sections 171-55, 115-5, 115-9, and 115-10, Hawaii Revised Statutes, as amended.

LOCATION:

Beach Transit Corridor / Shoreline at North Kaanapali Beach, Hanakaoo, Kaanapali, Lahaina, Maui; TMK: (2) 4-4-006: Seaward of 011, as shown on the attached map labeled Exhibit A.

AREA:

2,300 square feet, more or less.

ZONING:

State Land Use District: Urban

TRUST LAND STATUS:

Section 5(b) lands of the Hawaii Admission Act

DHHL 30% entitlement lands pursuant to the Hawaii State Constitution: NO

CURRENT USE STATUS:

Unencumbered

CHARACTER OF USE:

Removal of encroachments from shoreline (artificially induced vegetation).

EXHIBITS:

Exhibit A – Tax map of the subject area.

Exhibit B – Topographic photo of subject shoreline area.

TERM OF RIGHT-OF-ENTRY:

30 Days

CONSIDERATION:

Gratis.

CHAPTER 343 - ENVIRONMENTAL ASSESSMENT:

In conformance with Chapter 343, Hawaii Revised Statutes (HRS), as amended, and Hawaii Administrative Rules, Title 11, Department of Health, Chapter 200, Environmental Impact Statement Rules, Subchapter 8, 11-200-8(a)(1), the proposed use is exempt.

DCCA VERIFICATION:

Place of business registration confirmed:	YES <input checked="" type="checkbox"/>	NO <input type="checkbox"/>
Registered business name confirmed:	YES <input checked="" type="checkbox"/>	NO <input type="checkbox"/>
Applicant in good standing confirmed:	YES <input checked="" type="checkbox"/>	NO <input type="checkbox"/>

APPLICANT REQUIREMENTS:

Applicant shall be required to:

- 1) In the exercise of this right of entry AOA of Hale Kaanapali shall use appropriate

precautions and measures to minimize inconveniences to surrounding residents, landowners, and the public in general.

- 2) AOA of Hale Kaanapali shall maintain and employ debris, pollution and contamination control measures, safeguards and techniques to prevent debris, pollution or contamination to the ocean waters.
- 3) Cut and remove all vegetation located seaward of the subject private property within the beach transit corridor, pursuant to Hawaii Revised Statutes 115-5, 115-9, and 115-10.

REMARKS:

Per the request of the AOA of Hale Kaanapali, staff from the Office of Conservation and Coastal Lands conducted a site inspection of the shoreline at the subject location in attempt to have it certified as part of the permit process when applying for a County of Maui special management area (SMA) permit. During this inspection, staff observed a large section of artificially induced Naupaka hedge to be located seaward of the applicant's private property boundary, within the shoreline and beach transit corridor. Due to the discovery of the encroaching vegetation, the applicant is unable to have the shoreline certified and therefore unable to obtain a SMA permit. In an attempt to clear up and remove the overgrown vegetation which is taking up useable public space on the beach, the AOA of Hale Kaanapali is requesting a right-of-entry permit to access the shoreline for the removal of approximately 2,300 square feet of Naupaka hedge. The applicant has advised that they would like to conduct the hedge removal and clean up during the month of September 2015 when the property has the lowest occupancy.

The State property (shoreline) which the hedge is growing onto is currently unencumbered. This area is referred to as North Kaanapali Beach and is part of a heavily used Ocean Recreational Management Area (ORMA).

Staff is recommending gratis for this Right-of-Entry permit request, as it will clear the overgrown vegetation fronting the subject property off of shoreline and open up more useable space along the beach for public use. All cost affiliated with the encroachment removal will be covered by the applicant.

RECOMMENDATION: That the Board

1. Declare that, after considering the potential effects of the proposed disposition as provided by Chapter 343, HRS, and Chapter 11-200, HAR, this project will probably have minimal or no significant effect on the environment and is therefore exempt from the preparation of an environmental assessment.
2. Authorize the issuance of a right-of-entry permit to AOA of Hale Kaanapali

covering the subject area under the terms and conditions cited above, which are by this reference incorporated herein and further subject to the following:

- A. The standard terms and conditions of the most current right-of-entry permit form, as may be amended from time to time;
- B. Such other terms and conditions as may be prescribed by the Chairperson to best serve the interests of the State.

Respectfully Submitted,



Daniel Ornellas
District Land Agent

APPROVED FOR SUBMITTAL:



Suzanne D. Case, Chairperson



SUBJECT AREA

4 + 06

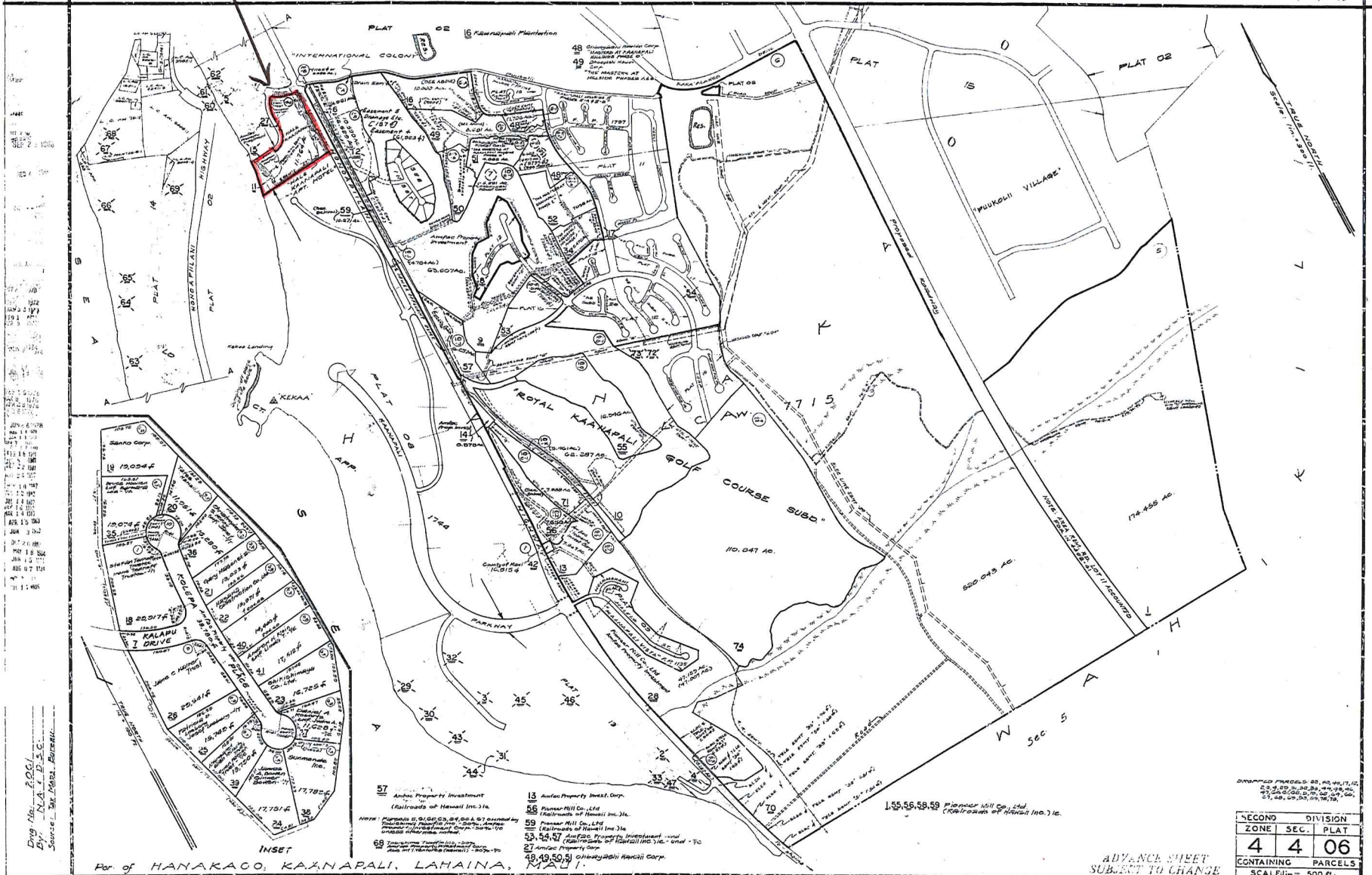

Drawn by: P.O.G.L.
 By: N.A. & D.S.C.
 Source: Title, Maps, Records.

- 57 Anafu Property Investment (Railroads of Hawaii Inc.)
 13 Anafu Property Invest. Corp.
 56 Pioneer Mill Co. Ltd (Railroads of Hawaii Inc.)
 59 Pioneer Mill Co. Ltd (Railroads of Hawaii Inc.)
 53, 48, 47 Anafu Property Investment and (Railroads of Hawaii Inc.) and - To
 27 Anafu Property Corp.
 48, 49, 50, 51 Chongwahai Hawaii Corp.

Overlaid parcels: 83, 84, 85, 86, 87, 88, 89, 90, 91, 92, 93, 94, 95, 96, 97, 98, 99, 100, 101, 102, 103, 104, 105, 106, 107, 108, 109, 110, 111, 112, 113, 114, 115, 116, 117, 118, 119, 120, 121, 122, 123, 124, 125, 126, 127, 128, 129, 130, 131, 132, 133, 134, 135, 136, 137, 138, 139, 140, 141, 142, 143, 144, 145, 146, 147, 148, 149, 150, 151, 152, 153, 154, 155, 156, 157, 158, 159, 160, 161, 162, 163, 164, 165, 166, 167, 168, 169, 170, 171, 172, 173, 174, 175, 176, 177, 178, 179, 180, 181, 182, 183, 184, 185, 186, 187, 188, 189, 190, 191, 192, 193, 194, 195, 196, 197, 198, 199, 200, 201, 202, 203, 204, 205, 206, 207, 208, 209, 210, 211, 212, 213, 214, 215, 216, 217, 218, 219, 220, 221, 222, 223, 224, 225, 226, 227, 228, 229, 230, 231, 232, 233, 234, 235, 236, 237, 238, 239, 240, 241, 242, 243, 244, 245, 246, 247, 248, 249, 250, 251, 252, 253, 254, 255, 256, 257, 258, 259, 260, 261, 262, 263, 264, 265, 266, 267, 268, 269, 270, 271, 272, 273, 274, 275, 276, 277, 278, 279, 280, 281, 282, 283, 284, 285, 286, 287, 288, 289, 290, 291, 292, 293, 294, 295, 296, 297, 298, 299, 300, 301, 302, 303, 304, 305, 306, 307, 308, 309, 310, 311, 312, 313, 314, 315, 316, 317, 318, 319, 320, 321, 322, 323, 324, 325, 326, 327, 328, 329, 330, 331, 332, 333, 334, 335, 336, 337, 338, 339, 340, 341, 342, 343, 344, 345, 346, 347, 348, 349, 350, 351, 352, 353, 354, 355, 356, 357, 358, 359, 360, 361, 362, 363, 364, 365, 366, 367, 368, 369, 370, 371, 372, 373, 374, 375, 376, 377, 378, 379, 380, 381, 382, 383, 384, 385, 386, 387, 388, 389, 390, 391, 392, 393, 394, 395, 396, 397, 398, 399, 400, 401, 402, 403, 404, 405, 406, 407, 408, 409, 410, 411, 412, 413, 414, 415, 416, 417, 418, 419, 420, 421, 422, 423, 424, 425, 426, 427, 428, 429, 430, 431, 432, 433, 434, 435, 436, 437, 438, 439, 440, 441, 442, 443, 444, 445, 446, 447, 448, 449, 450, 451, 452, 453, 454, 455, 456, 457, 458, 459, 460, 461, 462, 463, 464, 465, 466, 467, 468, 469, 470, 471, 472, 473, 474, 475, 476, 477, 478, 479, 480, 481, 482, 483, 484, 485, 486, 487, 488, 489, 490, 491, 492, 493, 494, 495, 496, 497, 498, 499, 500, 501, 502, 503, 504, 505, 506, 507, 508, 509, 510, 511, 512, 513, 514, 515, 516, 517, 518, 519, 520, 521, 522, 523, 524, 525, 526, 527, 528, 529, 530, 531, 532, 533, 534, 535, 536, 537, 538, 539, 540, 541, 542, 543, 544, 545, 546, 547, 548, 549, 550, 551, 552, 553, 554, 555, 556, 557, 558, 559, 560, 561, 562, 563, 564, 565, 566, 567, 568, 569, 570, 571, 572, 573, 574, 575, 576, 577, 578, 579, 580, 581, 582, 583, 584, 585, 586, 587, 588, 589, 590, 591, 592, 593, 594, 595, 596, 597, 598, 599, 600, 601, 602, 603, 604, 605, 606, 607, 608, 609, 610, 611, 612, 613, 614, 615, 616, 617, 618, 619, 620, 621, 622, 623, 624, 625, 626, 627, 628, 629, 630, 631, 632, 633, 634, 635, 636, 637, 638, 639, 640, 641, 642, 643, 644, 645, 646, 647, 648, 649, 650, 651, 652, 653, 654, 655, 656, 657, 658, 659, 660, 661, 662, 663, 664, 665, 666, 667, 668, 669, 670, 671, 672, 673, 674, 675, 676, 677, 678, 679, 680, 681, 682, 683, 684, 685, 686, 687, 688, 689, 690, 691, 692, 693, 694, 695, 696, 697, 698, 699, 700, 701, 702, 703, 704, 705, 706, 707, 708, 709, 710, 711, 712, 713, 714, 715, 716, 717, 718, 719, 720, 721, 722, 723, 724, 725, 726, 727, 728, 729, 730, 731, 732, 733, 734, 735, 736, 737, 738, 739, 740, 741, 742, 743, 744, 745, 746, 747, 748, 749, 750, 751, 752, 753, 754, 755, 756, 757, 758, 759, 760, 761, 762, 763, 764, 765, 766, 767, 768, 769, 770, 771, 772, 773, 774, 775, 776, 777, 778, 779, 780, 781, 782, 783, 784, 785, 786, 787, 788, 789, 790, 791, 792, 793, 794, 795, 796, 797, 798, 799, 800, 801, 802, 803, 804, 805, 806, 807, 808, 809, 810, 811, 812, 813, 814, 815, 816, 817, 818, 819, 820, 821, 822, 823, 824, 825, 826, 827, 828, 829, 830, 831, 832, 833, 834, 835, 836, 837, 838, 839, 840, 841, 842, 843, 844, 845, 846, 847, 848, 849, 850, 851, 852, 853, 854, 855, 856, 857, 858, 859, 860, 861, 862, 863, 864, 865, 866, 867, 868, 869, 870, 871, 872, 873, 874, 875, 876, 877, 878, 879, 880, 881, 882, 883, 884, 885, 886, 887, 888, 889, 890, 891, 892, 893, 894, 895, 896, 897, 898, 899, 900, 901, 902, 903, 904, 905, 906, 907, 908, 909, 910, 911, 912, 913, 914, 915, 916, 917, 918, 919, 920, 921, 922, 923, 924, 925, 926, 927, 928, 929, 930, 931, 932, 933, 934, 935, 936, 937, 938, 939, 940, 941, 942, 943, 944, 945, 946, 947, 948, 949, 950, 951, 952, 953, 954, 955, 956, 957, 958, 959, 960, 961, 962, 963, 964, 965, 966, 967, 968, 969, 970, 971, 972, 973, 974, 975, 976, 977, 978, 979, 980, 981, 982, 983, 984, 985, 986, 987, 988, 989, 990, 991, 992, 993, 994, 995, 996, 997, 998, 999, 1000.

Part of HANAKO, KAANAPALI, LAHAINA, MAUI.

ADVANCE SHEET
SUBJECT TO CHANGE

SECOND DIVISION		
ZONE	SEC.	PLAT
4	4	06
CONTAINING PARCELS		
SCALE 1" = 500 FT.		
PRINTED		

EXHIBIT A



244006027

4014016

4014015

244006011

PROJECT AREA

Exhibit B

DAVID Y. IGE
GOVERNOR OF HAWAII

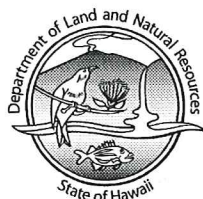

STATE OF HAWAII
DEPARTMENT OF LAND AND NATURAL RESOURCES

POST OFFICE BOX 621
HONOLULU, HAWAII 96809

SUZANNE D. CASE
CHAIRPERSON
BOARD OF LAND AND NATURAL RESOURCES
COMMISSION ON WATER RESOURCE MANAGEMENT

KEKOA KALUHIWA
FIRST DEPUTY

W. ROY HARDY
ACTING DEPUTY DIRECTOR - WATER

AQUATIC RESOURCES
BOATING AND OCEAN RECREATION
BUREAU OF CONVEYANCES
COMMISSION ON WATER RESOURCE MANAGEMENT
CONSERVATION AND COASTAL LANDS
CONSERVATION AND RESOURCES ENFORCEMENT
ENGINEERING
FORESTRY AND WILDLIFE
HISTORIC PRESERVATION
KAHOOLAWE ISLAND RESERVE COMMISSION
LAND
STATE PARKS

May 22, 2015

EXEMPTION NOTIFICATION

regarding the preparation of an environmental assessment pursuant to Chapter 343, HRS and Chapter 11-200, HAR

Project Title: Issuance of Right-of-Entry Permit to the Association of Apartment Owners (AOAO) of Hale Kaanapali for the Removal of Vegetation (Naupaka) from within the Beach Transit Corridor / Shoreline at North Kaanapali Beach.

Project / Reference No.: PSF# 15MD-075

Project Location: Lahaina, Maui, Tax Map Key: (2) 4-4-006: Seaward of 011.

Project Description: Removal of artificially induced vegetation from the shoreline fronting the subject private property.

Chap. 343 Trigger(s): Use of State Land

Exemption Class No. and Description: In accordance with the Department of Land and Natural Resources Department-wide Exemption List, approved by the Environmental Council and dated December 4, 1991, the subject project is considered to be exempt from the preparation of an environmental assessment pursuant to Exemption Class No.1, that states: Operations, repairs, or maintenance of existing structures, facilities, equipment, or topographical features, involving negligible or no expansion or change of use beyond that previously existing [HAR 11-200-8 (a)(1)].

Consulted Parties: The Office of Conservation and Coastal Lands was consulted as a source authority having jurisdiction or expertise in this matter, and concurs that the exemption identified above is applicable to and appropriate for the proposed project.

Recommendation:

It is anticipated this project will probably have minimal or no significant effect on the environment and is presumed to be exempt from the preparation of an environmental assessment.



Suzanne D. Case
Chairperson



Date

