

DAVID Y. IGE  
GOVERNOR



STATE OF HAWAII  
DEPARTMENT OF TRANSPORTATION  
869 PUNCHBOWL STREET  
HONOLULU, HAWAII 96813-5097

FORD N. FUCHIGAMI  
DIRECTOR

Deputy Directors  
JADE T. BUTAY  
ROSS M. HIGASHI  
EDWIN H. SNIFFEN  
DARRELL T. YOUNG

IN REPLY REFER TO:

Board of Land and  
Natural Resources  
State of Hawaii  
Honolulu, Hawaii

ISSUANCE OF A REVOCABLE PERMIT FOR AIRPORT LAND  
FOR AIRCRAFT WORK AREA ON RAMP  
PHILLIP D. BYRNES  
HILO INTERNATIONAL AIRPORT  
TAX MAP KEY: (3) 2-1-12: PORTION OF 90

HAWAII

REQUEST:

Issuance of a Revocable Permit for airport land at Hilo International Airport (ITO).

LEGAL REFERENCE:

Sections 171-11 and 171-55, Hawaii Revised Statutes

APPLICANT:

Phillip D. Byrnes (PDB) whose business address is 830-A Uilani Place,  
Hilo, Hawaii 96720

LOCATION AND TAX MAP KEY:

Portion of ITO, Hilo, Island of Hawaii, identified by  
Tax Map Key: 3rd division, 2-1-12: Portion of 90

AREA:

Area/Space No. 800-140, containing an area of approximately 600 square feet of  
improved paved land as shown on the attached Exhibit "A".

ZONING:

State Land Use District: Urban  
County of Hawaii: Industrial (ML-20)

**ITEM M-12**

LAND TITLE STATUS:

Section 5(a) lands of the Hawaii Admission Act: Ceded  
DHHL 30% entitlement lands pursuant to Hawaii Admission Act YES \_\_\_ NO X

CURRENT USE STATUS:

Airport and aeronautical purposes

CHARACTER OF USE:

Aircraft work area on ramp

COMMENCEMENT DATE:

Upon complete execution of the revocable permit

MONTHLY RENTAL:

\$ 80.00

SECURITY DEPOSIT:

\$240.00

HOLDOVER TENANCY:

\$ 2.67

CHAPTER 343, HRS - ENVIRONMENTAL ASSESSMENT:

Pursuant to Section 11-200-8(a), Environmental Impact Statement Rules of the Department of Health, State of Hawaii, this disposition is exempt from requirements regarding preparation of an environmental assessment, negative declaration, or environmental impact statement as required by Chapter 343, Hawaii Revised Statutes, as amended, relating to Environmental Impact Statements, because the proposed action falls within Exemption Class #1, Comprehensive Exemption List for the State of Hawaii, Department of Transportation, dated November 15, 2000, as approved by the Environmental Quality Council. Exemption Class #1 covers operations, repairs, or maintenance of existing structures, facilities, equipment, or topographical features involving negligible or no expansion or change of use beyond that previously existing.

REMARKS:

The DOT has no objections to PDB's request and therefore, in accordance with Sections 171-11 and 171-55, HRS, relating to Public Purposes and Permits, respectively and therefore, the DOT proposes to issue a month-to-month revocable permit to PDB for Area/Space No. 800-140.

RECOMMENDATION:

That the Board authorize the Department of Transportation to issue a month-to-month revocable permit to PDB, subject to: (1) terms and conditions herein outlined, which are by reference incorporated herein; and (2) such additional terms and conditions as may be prescribed by the Director of Transportation to best serve the interests of the State.

Respectfully submitted,



FORD N. FUCHIGAMI  
Director of Transportation

APPROVED FOR SUBMITTAL:



SUZANNE D. CASE  
Chairperson and Member

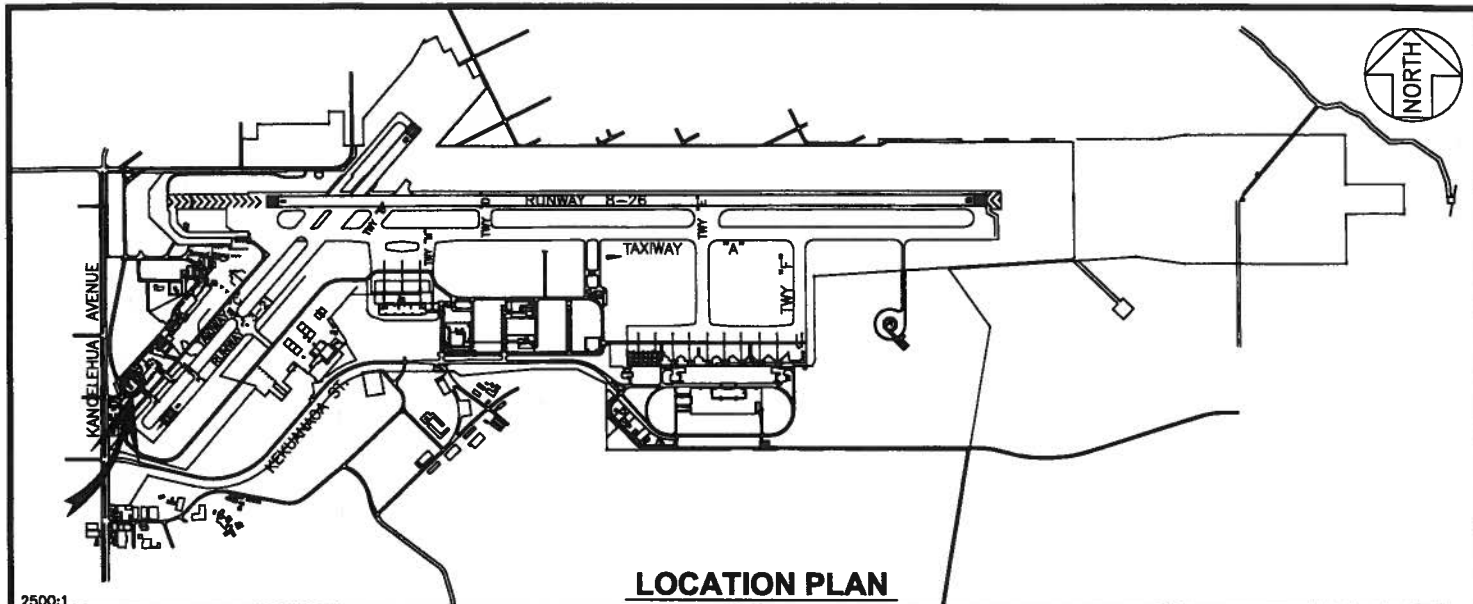

2500:1

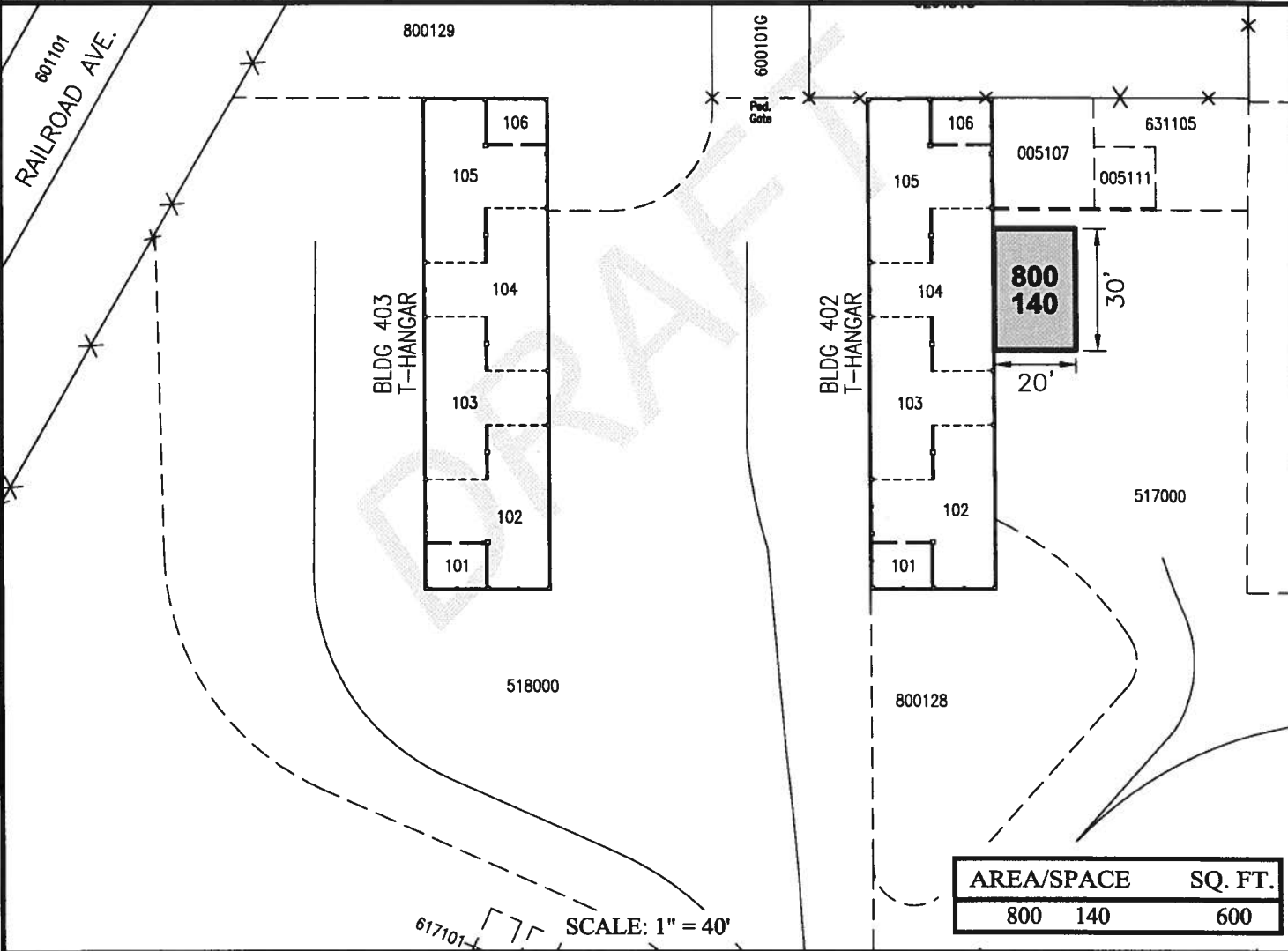

AREA/SPACE	SQ. FT.
800 140	600

DRAFT DATE : JULY 2015 EXHIBIT: **A**



IMPROVED LAND

800140  
PLATS, B1, 40

**HILO INTERNATIONAL AIRPORT**

N:\AIRPORTS\ITO\_Hilo\CAD\PM\ito\_800140-01\_draft.dwg