

BOARD OF WATER SUPPLY

CITY AND COUNTY OF HONOLULU

630 SOUTH BERETANIA STREET

HONOLULU, HAWAII 96843



August 2, 1990

FRANK F. FASI, Mayor

DONNA B. GOTH, Chairman

JOHN K. TSUI

SISTER M. DAVILYN AH CHICK, O.S.F. V-Chm

SAM CALLEJO

EDWARD Y. HIRATA

WALTER O. WATSON, JR.

MAURICE H. YAMASATO

KAZU HAYASHIDA

Manager and Chief Engineer

RECEIVED

'90 AGO -9 P2:39

OFC. OF ENVIRONMENTAL
QUALITY CONTROL

Dr. Bruce Anderson, Interim Director
Office of Environmental Quality Control
State of Hawaii
Kekuanaoa Building, #104
465 South King Street
Honolulu, Hawaii 96813

Dear Dr. Anderson:

Subject: Environmental Impact Assessment for Ala Wai Boulevard 16-Inch Main,
Waikiki, Oahu, Hawaii, TMK: 2-6-24, 25, 28 and 29

We request that our proposed project be published in the EQC Bulletin as a Negative Declaration.

Attached are four copies of the assessment for your use.

If you have any questions, please contact Bert Kuioka at 527-5235.

Very truly yours,

KAZU HAYASHIDA
Manager and Chief Engineer

Attachment

1990-08-23-0A-1-ED

FILE COPY

BOARD OF WATER SUPPLY
CITY AND COUNTY OF HONOLULU

NOTICE OF DETERMINATION
(NEGATIVE DECLARATION)

FOR

* ALA WAI BOULEVARD 16-INCH WATER MAIN

WAIKIKI, OAHU, HAWAII *

TAX MAP KEY: 2-6-24, 25, 28 AND 29

This Environmental Document is submitted pursuant to
Chapter 343, HRS

PREPARED BY

RICHARD M. SATO & ASSOCIATES, INC.
2046 South King Street
Honolulu, Hawaii 96826

July 1990

ENVIRONMENTAL ASSESSMENT
AND DETERMINATION

I. PROPOSING AGENCY

Board of Water Supply
City and County of Honolulu
630 South Beretania Street
Honolulu, Hawaii 96813

II. DESCRIPTION OF THE PROPOSED ACTION

A. Location

The proposed action is located in the community of Waikiki on the south shore of Oahu (Plate A). It begins from Kaiulani Avenue, along Ala Wai Boulevard, to Kapahulu Avenue (Plates B-1 through B-6).

B. Proposed Action

The scope of the proposed action is to replace the existing 12-inch water distribution main along Ala Wai Boulevard. Portions of the existing 12-inch main (to be abandoned) will be cut and plugged. All necessary connections to existing mains, and reconnection and installation of fire hydrants are included in this project.

The new 16-inch main will replace the existing 12-inch main, which was constructed approximately 55 years ago. Approximately 2,600 linear feet of 16-inch and 850 linear feet of 8-inch water mains will be installed.

Proposed pipe material will be concrete cylinder, PVC or poly wrapped Ductile Iron Pipe. PVC and Ductile Iron pipes will be the alternatives for the 8-inch mains.

Preliminary construction cost estimate for the project is \$850,000.00.

III. DESCRIPTION OF PROJECT'S TECHNICAL, ECONOMIC, SOCIAL AND ENVIRONMENTAL CHARACTERISTICS

A. Technical Characteristics

The new water mains shall be located within the Ala Wai Boulevard right-of-way. Existing mains to be abandoned shall be cut and plugged. All necessary connections to existing mains shall be made, including reconnection and installation of fire hydrants.

The existing pavement shall be restored to its original condition or better.

The existing drainage culverts shall remain, and the drainage patterns shall not be altered.

The existing utility poles shall remain.

The Contractor will be required to coordinate his work with all maintenance, repair work, or new construction by other utility agencies which will conflict with or affect this project.

B. Social, Economic and Environmental Characteristics

The proposed action will replace existing fire hydrants, and install additional fire hydrants, which will upgrade the existing fire protection system. The existing drainage patterns will not be altered. The installation of the new water mains will reduce the possibility of future water main breaks, which will also minimize water service interruptions to the people. Finally, the project will strengthen the existing water distribution grid in the Waikiki area.

IV. SUMMARY DESCRIPTION OF THE AFFECTED AREA

The project area is along Ala Wai Boulevard, from Kaiulani Avenue to Kapahulu Avenue (approximately 2,600 linear feet of roadway). The neighborhood is mostly high density residential in character. There are a few commercial establishments along the project area.

The project is outside the Shoreline Management Area of the City and County of Honolulu.

Along the project site, no endangered native flora and fauna were observed or known to inhabit the site. All of the flora are exotic species. Fauna consist of domesticated dogs and cats and other common "urban" species of animal and bird life.

There are no known historical or archaeological sites within the already well built-up project area. However, should any sites be encountered, the Historic Preservation Office of Department of Land and Natural Resources will be notified immediately and all work will be suspended.

V. DISCUSSION OF THE ASSESSMENT PROCESS

The proposed improvements will be constructed by the Board of Water Supply, City and County of Honolulu. The construction drawings will be submitted for approval to the appropriate State and City agencies, and all comments received will be incorporated into the final drawings.

VI. ANTICIPATED ENVIRONMENTAL IMPACTS

The proposed project will cause temporary adverse environmental impacts, but will not cause significant long term impacts. Excavation of the road will interfere with local traffic and excavated soil materials will have to be stockpiled. The excavation will require the use

of heavy machinery and equipment as well as pneumatic impact equipment. Noise and dust problems will result from the use of these equipment. Internal combustion engines will emit noise, heat and noxious gases, thus lowering the ambient air quality.

Excavation of the roadway area will create hazards to pedestrians and vehicular traffic.

During the disconnecting and connecting of the old and new waterlines as well as the laterals and fire hydrants, there will be temporary disruptions to water service. The Contractor will be required to minimize these interruptions and to keep them as short as possible. All users will be informed prior to the interruptions.

VII. MEASURES TO MITIGATE ANTICIPATED ENVIRONMENTAL IMPACTS

Dust generated by construction activities will be controlled by watering, or other dust control measures, in conformance with the Air Pollution Control Standards and Regulations of the State Department of Health. Hazardous road conditions created by trenching and installation of pipeline will be minimized by appropriate warning lights, signs, barricades, bridges and other traffic control devices. Construction noise can be mitigated by mufflers and by limiting construction to daylight hours from 7:00 a.m. to 3:30 p.m., Monday through Friday. The Contractor will comply with the Community Noise Control Regulations for Oahu (Chapter 44-B) Department of Health.

VIII. ALTERNATIVE TO THE PROPOSED ACTION

The no action alternative which provides for no changes to the existing water main was rejected. The existing water main is about 55 years old and it has experienced 9 breaks in the last 9 years (7 breaks within the last 5 years alone). During these breaks, the deteriorated main required emergency repairs and caused unnecessary wastage of water.

IX. DETERMINATION

The study of the project, the project site and the resulting environmental impacts indicate that the proposed project will not result in any significant long-term adverse environmental impacts. Based on these findings, it is determined that this action be a Negative Declaration to comply with regulations in Chapter 343, HRS, and that an Environmental Impact Statement is not required.

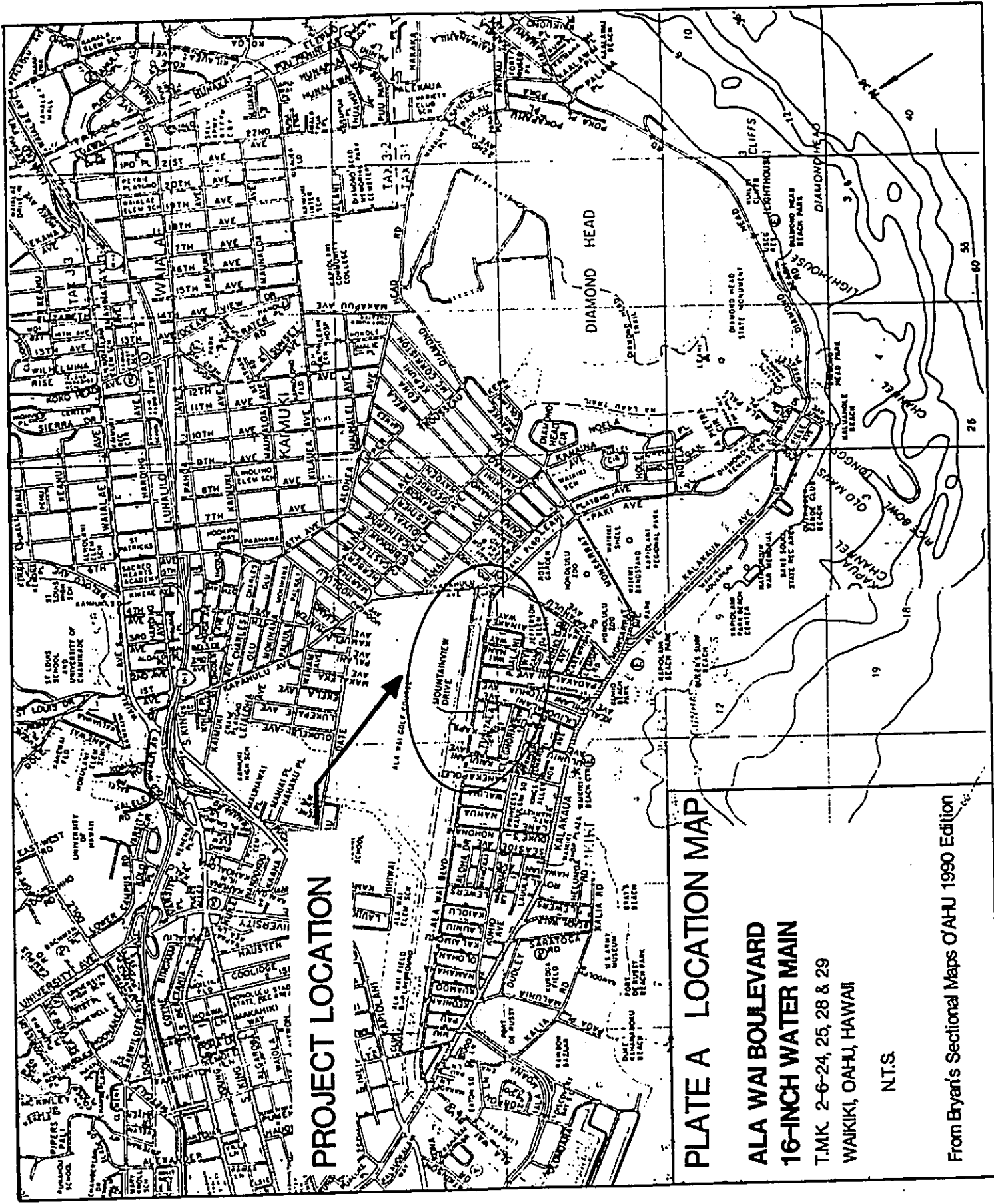

PROJECT LOCATION

PLATE A LOCATION MAP

**ALA WAI BOULEVARD
16-INCH WATER MAIN**

T.M.K. 2-6-24, 25, 28 & 29
WAIKIKI, OAHU, HAWAII

N.T.S.

From Beyer's Sectional Maps O'AHU 1990 Edition

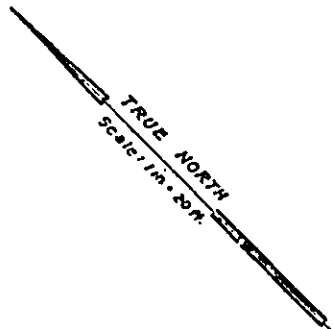

ALA WAI

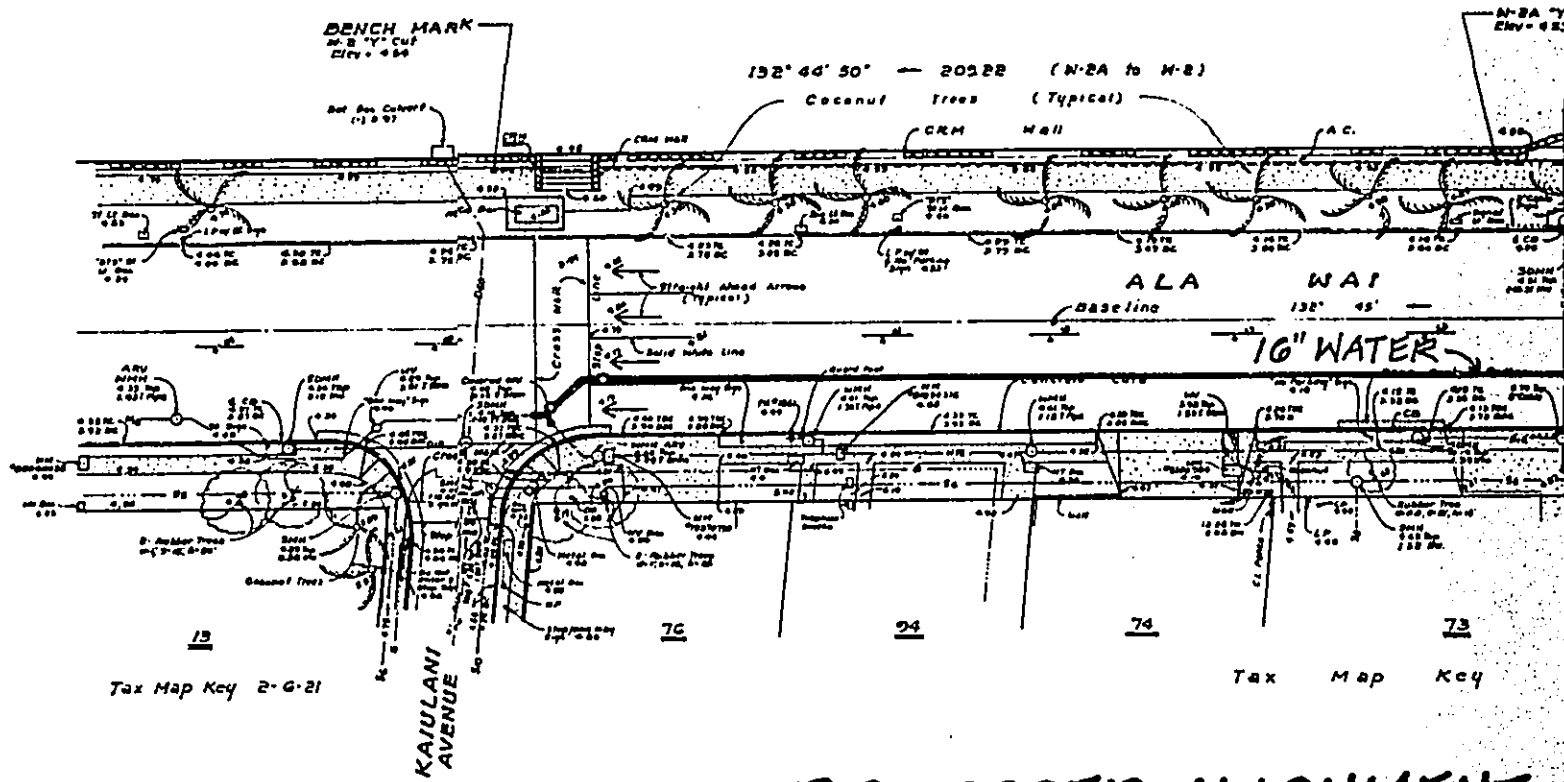

**PROPOSED ALIGNMENT
FOR ALA WAI BLVD
16" WATER MAIN**

PLATE B-1

UNDERGROUND PUBLIC UTILITIES SHOWN HEREON ARE FOR INFORMATION ONLY, HAVING BEEN OBTAINED FROM THE BEST AVAILABLE SOURCES BUT FROM OTHERS NOT CONNECTED WITH THE COMPANY. THEREFORE, NO GUARANTEE IS MADE ON THE ACCURACY OR COMPLETENESS OF SAID INFORMATION.

Drain Line taken from C & C drainage maps 0-11 and P-11
 Gas Line taken from GASCO, Inc maps 2-6-24, 2-6-25 and 2-6-28
 Water Line taken by Board of Water Supply personnel

CONTROL

W A I C A N A L

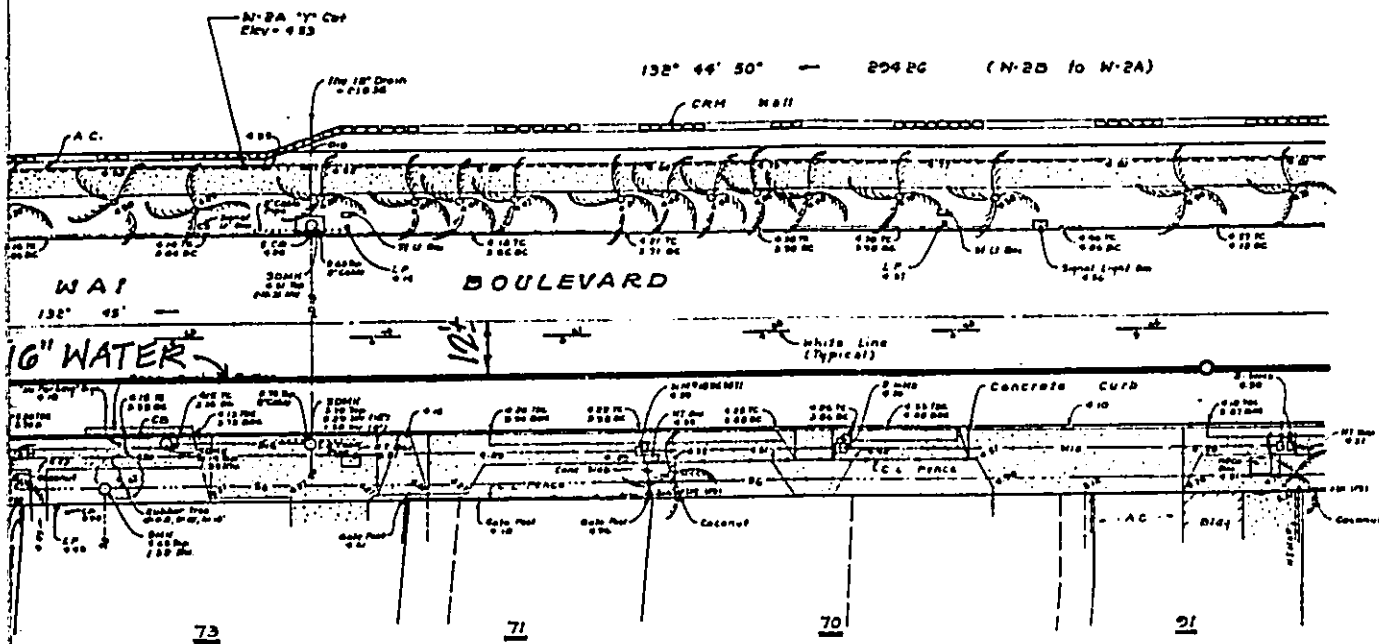

Map Key 2 - G - 24

IGNMENT
BLVD
IN

TOPOGRAPHIC SURVEY MAP
ALA WAI BOULEVARD - 16 INCH WATER MAIN
WAIKIKI, HONOLULU, OAHU, HAWAII

Tax Map Key: 2-G-21, 24, 25, 28 & 29
2-7-36

Scale: 1 in. = 20 ft. May 1, 1990
Job No. 90049 P.B. 552 & 563

CONTROL POINT SURVEYING AND ENGINEERING, INC.
1043 Hong Ho Lane
Honolulu, Hawaii 96814



Alden S. Kajioka
ALDEN S. KAJIOKA
Licensed Land Surveyor
Certificate Number 6605-L9

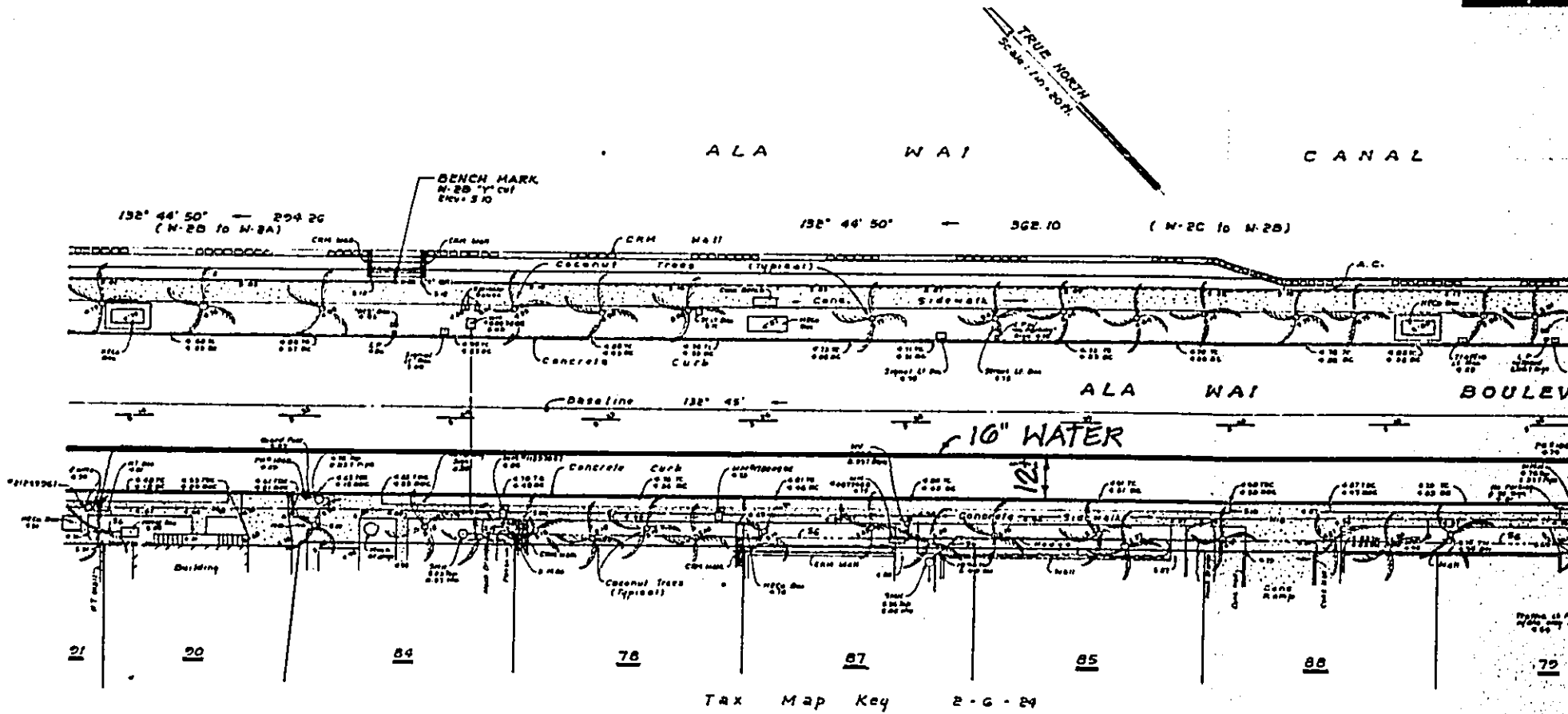

Tax Map Key 2-6-84

**PROPOSED ALIGNMENT
FOR ALA WAI BLVD
10" WATER MAIN
PLATE B-2**

UNDERGROUND PUBLIC UTILITIES SHOWN HEREON ARE FOR INFORMATION ONLY, HAVING BEEN OBTAINED FROM THE BEST AVAILABLE SOURCES BUT FROM OTHERS NOT CONNECTED WITH THE COMPANY. THEREFORE, NO GUARANTEE IS MADE ON THE ACCURACY OR COMPLETENESS OF SAID INFORMATION.

Drain Line taken from C & C drainage maps
D-11 and P-11
Gas Line taken from GASCO, Inc maps
2-6-24, 2-6-25 and 2-6-26.
Water Line toned by Board of Water Supply
personnel

CONTROL

ANAL

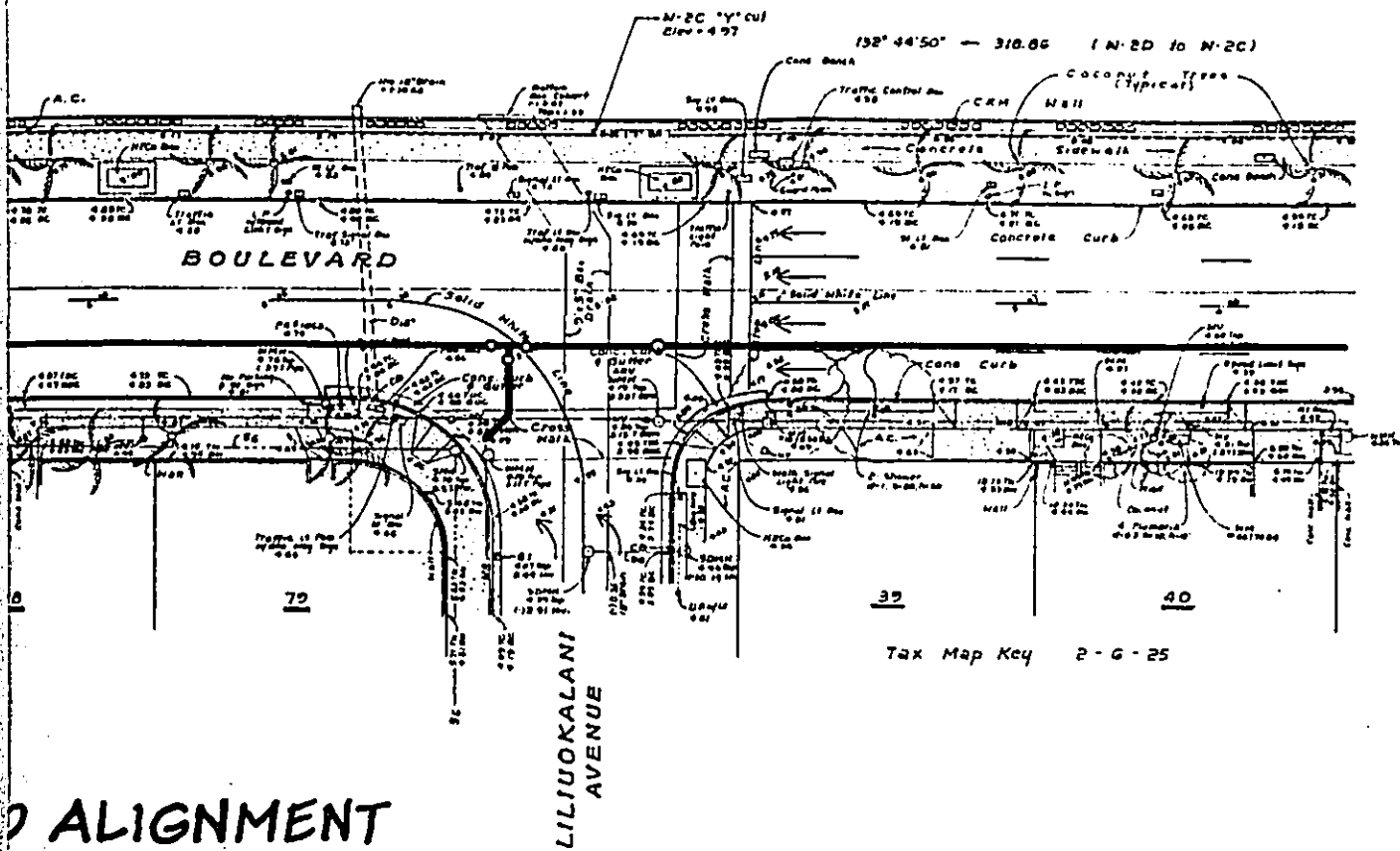

ALIGNMENT
ALA WAI BLVD
MAIN

TOPOGRAPHIC SURVEY MAP
ALA WAI BOULEVARD - 16 INCH WATER MAIN
WAIKIKI, HONOLULU, OAHU, HAWAII

Tax Map Key: 2-6-21, 24, 25, 28 & 29
2-7-36

Scale: 1 in = 20 ft.
Job No. 90049

May 1, 1970
P.B. 552 & 563

CONTROLPOINT SURVEYING AND ENGINEERING, INC.
1043 Nong Ho Lane
Honolulu, Hawaii 96814



Alden S. Kajioke
ALDEN S. KAJIOKE
Licensed Land Surveyor
Certificate Number 6503-L3

TRUE NORTH
Scale: 1 in. = 20 ft.

ALA WAI

132° 44' 50" — 318.86 (N-2D to N-2C)

132° 44' 50" — 316.61 (N-2E to N-2D)

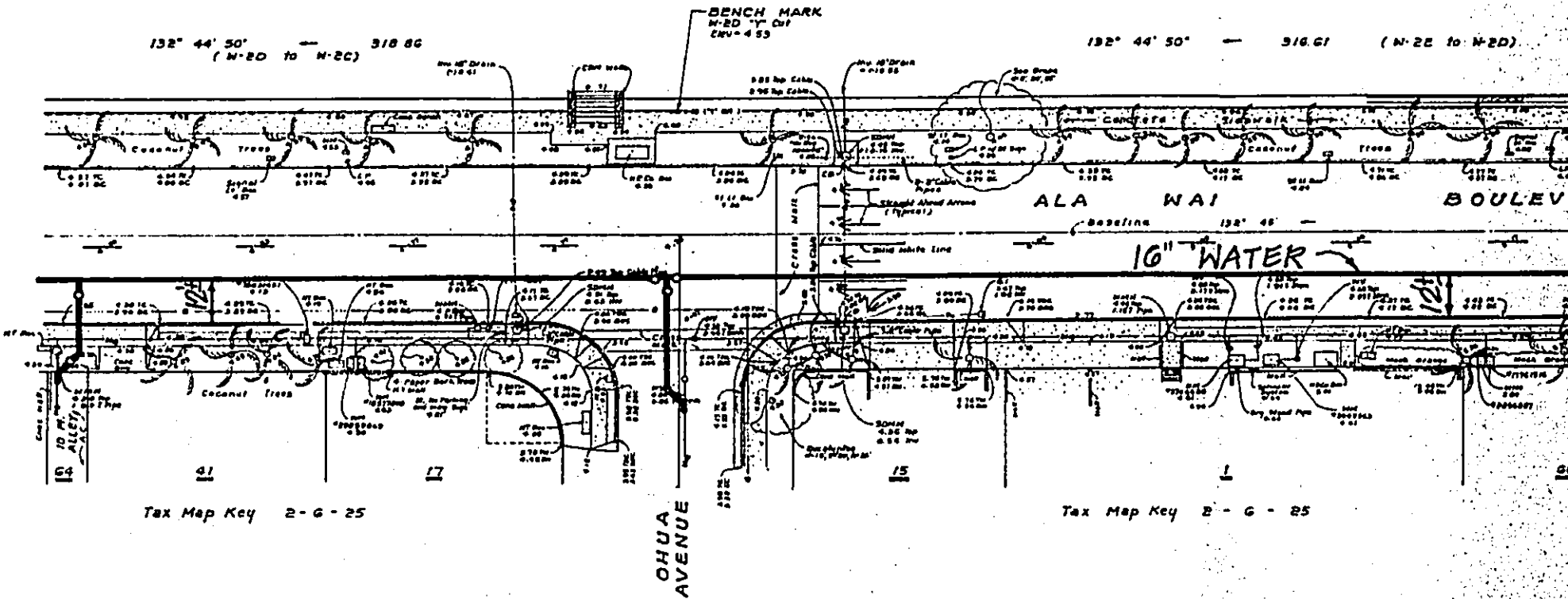

**PROPOSED ALIGNMENT
FOR ALA WAI BLVD
16" WATER MAIN
PLATE B-3**

UNDERGROUND PUBLIC UTILITIES SHOWN HEREON ARE FOR INFORMATION ONLY, HAVING BEEN OBTAINED FROM THE BEST AVAILABLE SOURCES BUT FROM OTHERS NOT CONNECTED WITH THIS COMPANY THEREFORE, NO GUARANTEE IS MADE ON THE ACCURACY OR COMPLETENESS OF SAID INFORMATION.

Drain Line taken from C & C drainage maps 0-11 and P-11
Gas Line taken from GASCO, Inc. maps 2-8-24, 2-6-25 and 2-6-26
Water Line toned by Board of Water Supply personnel

CONTROL

ALA WAI CANAL

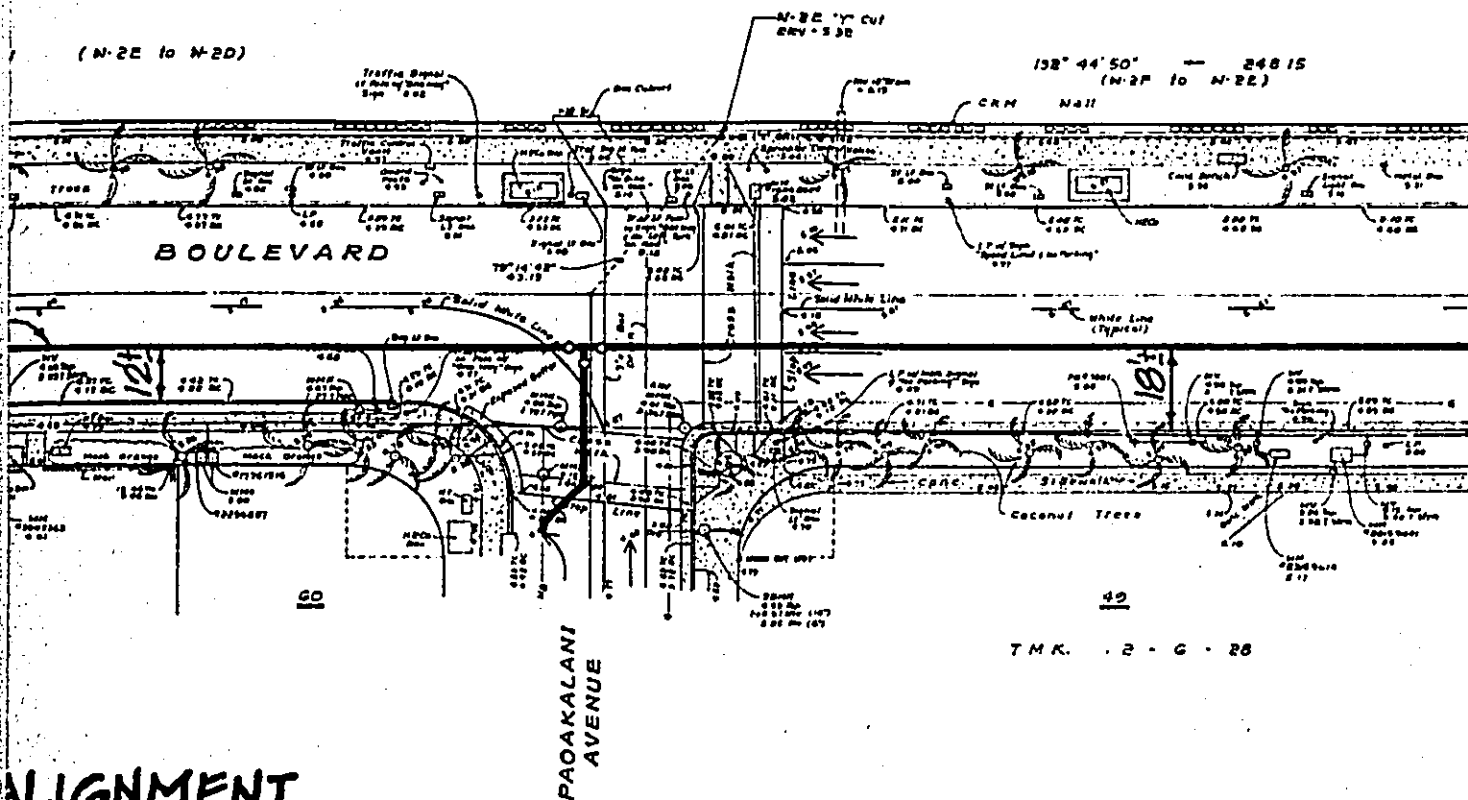

ALIGNMENT
16" BLVD
MAIN

TOPOGRAPHIC SURVEY MAP
ALA WAI BOULEVARD - 16 INCH WATER MAIN
WAIKIKI, HONOLULU, OAHU, HAWAII

Tax Map Key: 2-G-21, 24, 25, 28 & 29
2-7-36

Scale: 1 in = 20 ft.
Job No. 90049

May 1, 1990
R.D. 552 & 553

CONTROLPOINT SURVEYING AND ENGINEERING, INC.
1043 Wong Ho Lane
Honolulu, Hawaii 96814



Alden S. Kajioka
ALDEN S. KAJIOKA
Licensed Land Surveyor
Certificate Number 6005-LS

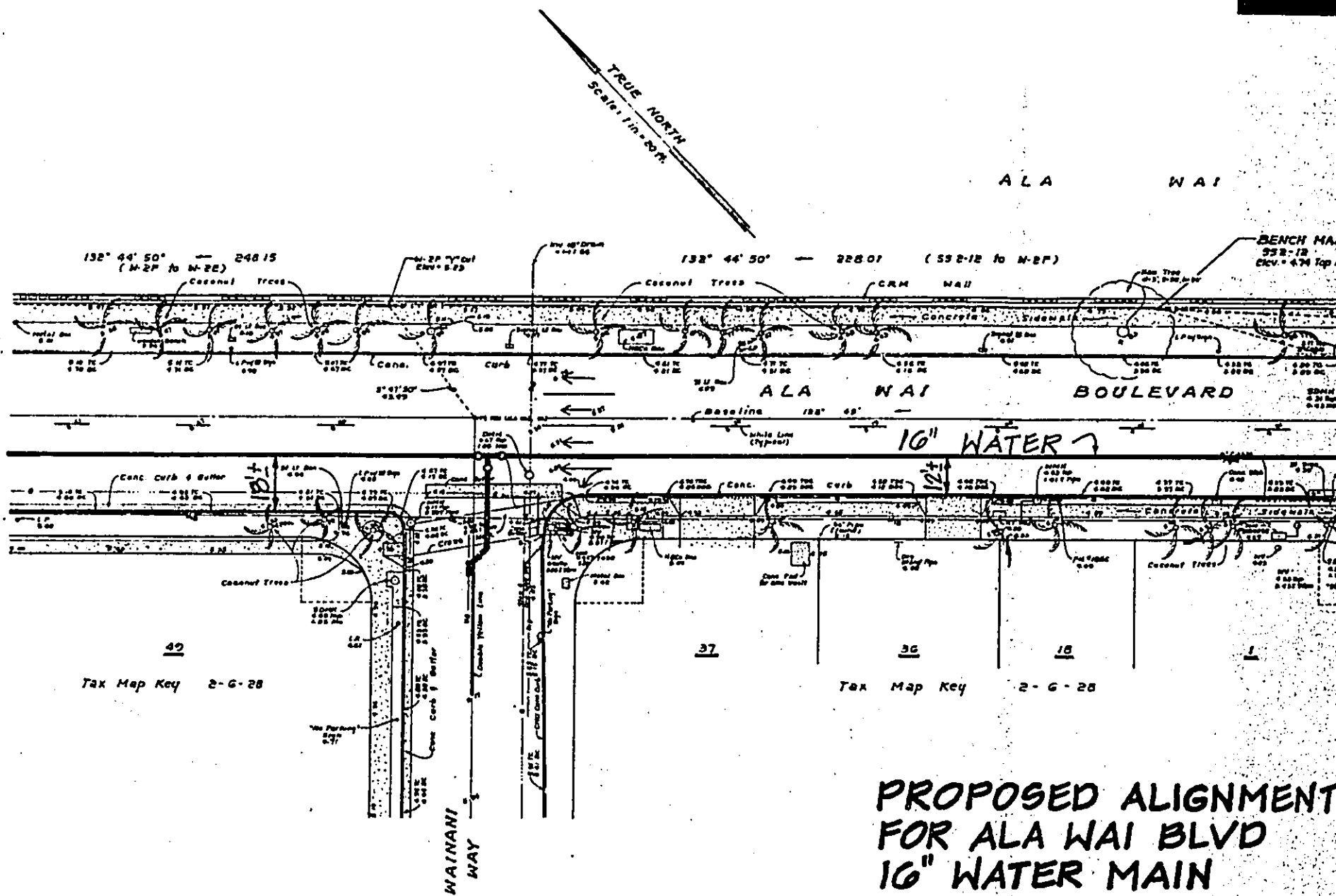

Tax Map Key 2-G-28

Tax Map Key 2-G-28

**PROPOSED ALIGNMENT
FOR ALA WAI BLVD
10" WATER MAIN
PLATE B-4**

UNDERGROUND PUBLIC UTILITIES
SHOWN HEREON ARE FOR
INFORMATION ONLY. HAVING
BEEN OBTAINED FROM THE BEST
AVAILABLE SOURCES BUT FROM
OTHERS NOT CONNECTED WITH
THIS COMPANY THEREFORE, NO
GUARANTEE IS MADE ON THE
ACCURACY OR COMPLETENESS OF
SAID INFORMATION.

Drain Line taken from C & C drainage maps
D-11 and P-11
Gas Line taken from GASCO, Inc maps
2-G-24, 2-G-25 and 2-G-28
Water Line toned by Board of Water Supply
personnel.

CONTROL

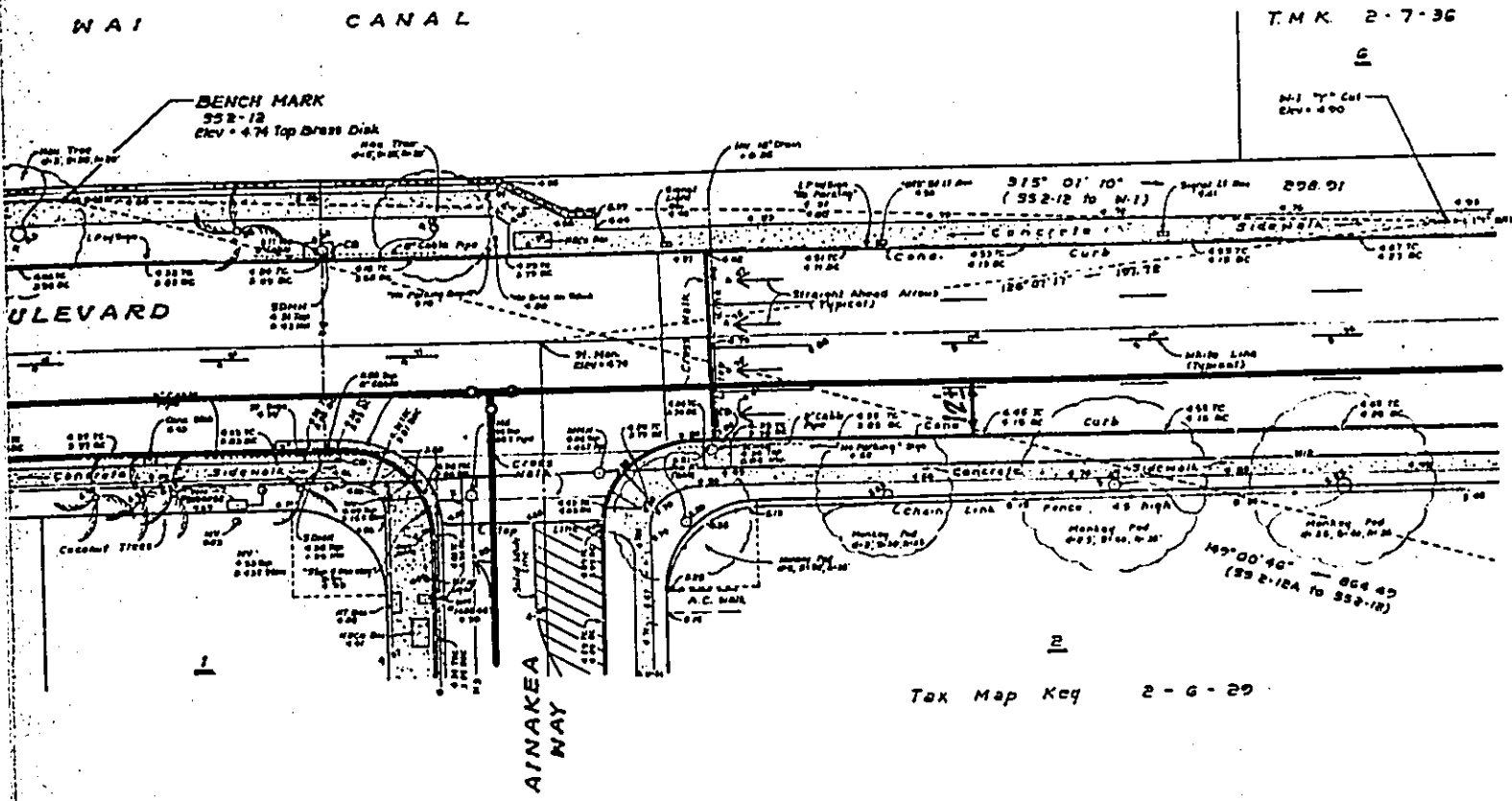

**ALIGNMENT
AL BLVD
MAIN**

**TOPOGRAPHIC SURVEY MAP
ALA WAI BOULEVARD - 16 INCH WATER MAIN
WAIKIKI, HONOLULU, OAHU, HAWAII**

Scale: 1 in. = 20 ft. May 1, 1970
Job No. 90049 P.D. 552 & 503

CONTROLPOINT SURVEYING AND ENGINEERING, INC.
1043 Moku Ho Lane
Honolulu, Hawaii 96814



Alden S. Kajiro
ALDEN S. KAJIRO
Licensed Land Surveyor
Certificate Number 6605-LS

TRUE NORTH
Scale: 1 in. = 20 ft

Tax Map Key 2-7-36
6

BENCH MARK
M 100 T Cut
Elevation 7.24

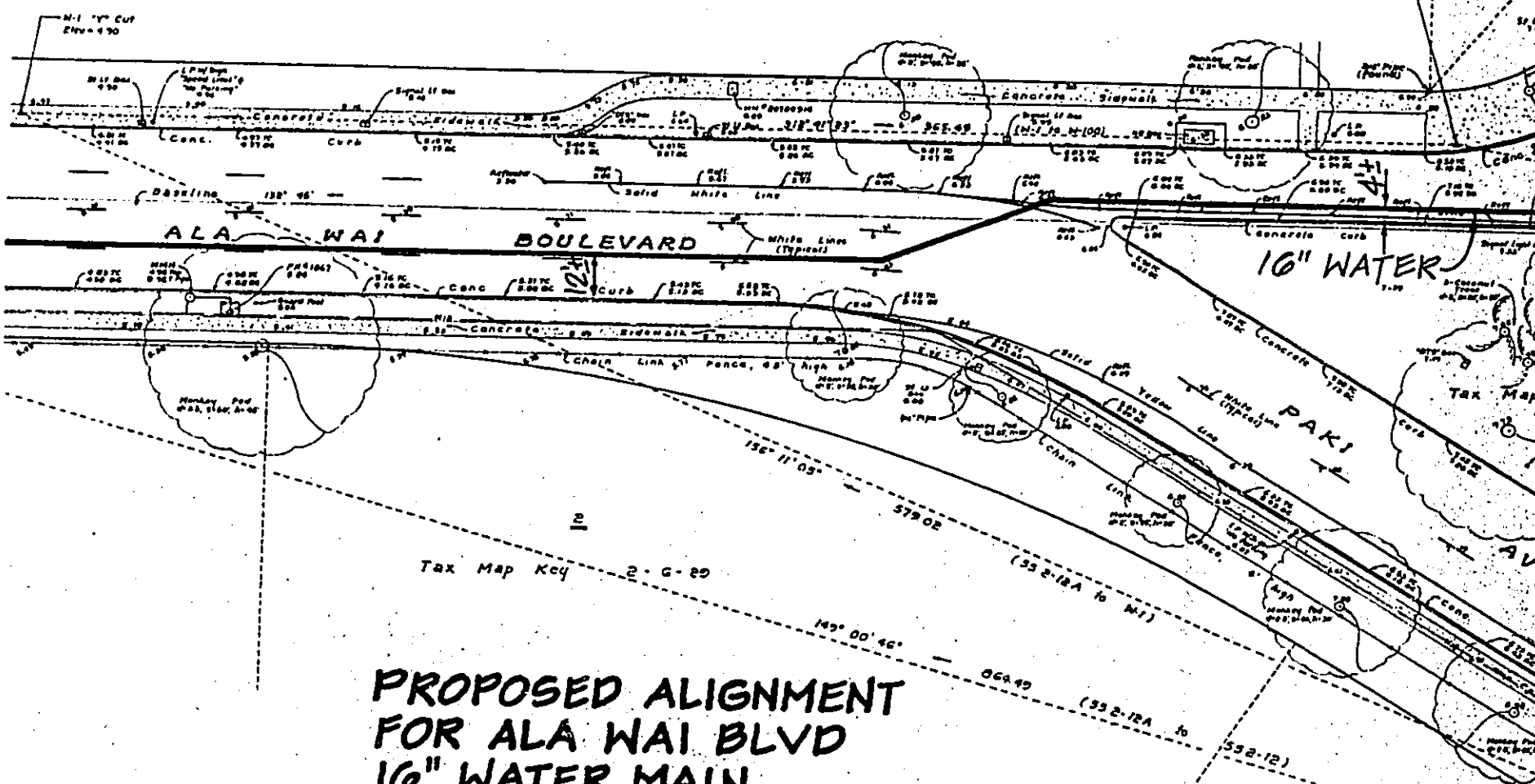

**PROPOSED ALIGNMENT
FOR ALAWAI BLVD
16" WATER MAIN**
PLATE B-5

**TOPOGRAPHIC SURVEY MAP
ALAWAI BOULEVARD - 16 INCH WATER MAIN
NAIKIKI, HONOLULU, OAHU, HAWAII**

Tax Map Key: 2-6-21, 24, 25, 28 & 29
2-7-36

Scale: 1 in. = 20 ft.
Job No. 90049

May 1, 1990
P.O. 552 & 563

UNDERGROUND PUBLIC UTILITIES SHOWN HEREON ARE FOR INFORMATION ONLY. HAVING BEEN OBTAINED FROM THE BEST AVAILABLE SOURCES BUT FROM OTHERS NOT CONNECTED WITH THIS COMPANY THEREFORE, NO GUARANTEE IS MADE ON THE ACCURACY OR COMPLETENESS OF SAID INFORMATION.

Drain Line taken from C & C drainage maps 0-11 and P-11
Gas Line taken from GASCO, Inc. maps 2-8-24, 2-8-25 and 2-6-28
Water Line furnished by Board of Water Supply personnel.

CONTROLPOINT SURVEYING AND ENGINEERING, INC.
1045 Wong Ho Lane
Honolulu, Hawaii 96814



Alden S. Kajioka
ALDEN S. KAJIOKA
Licensed Land Surveyor
Certificate Number 6605-L3

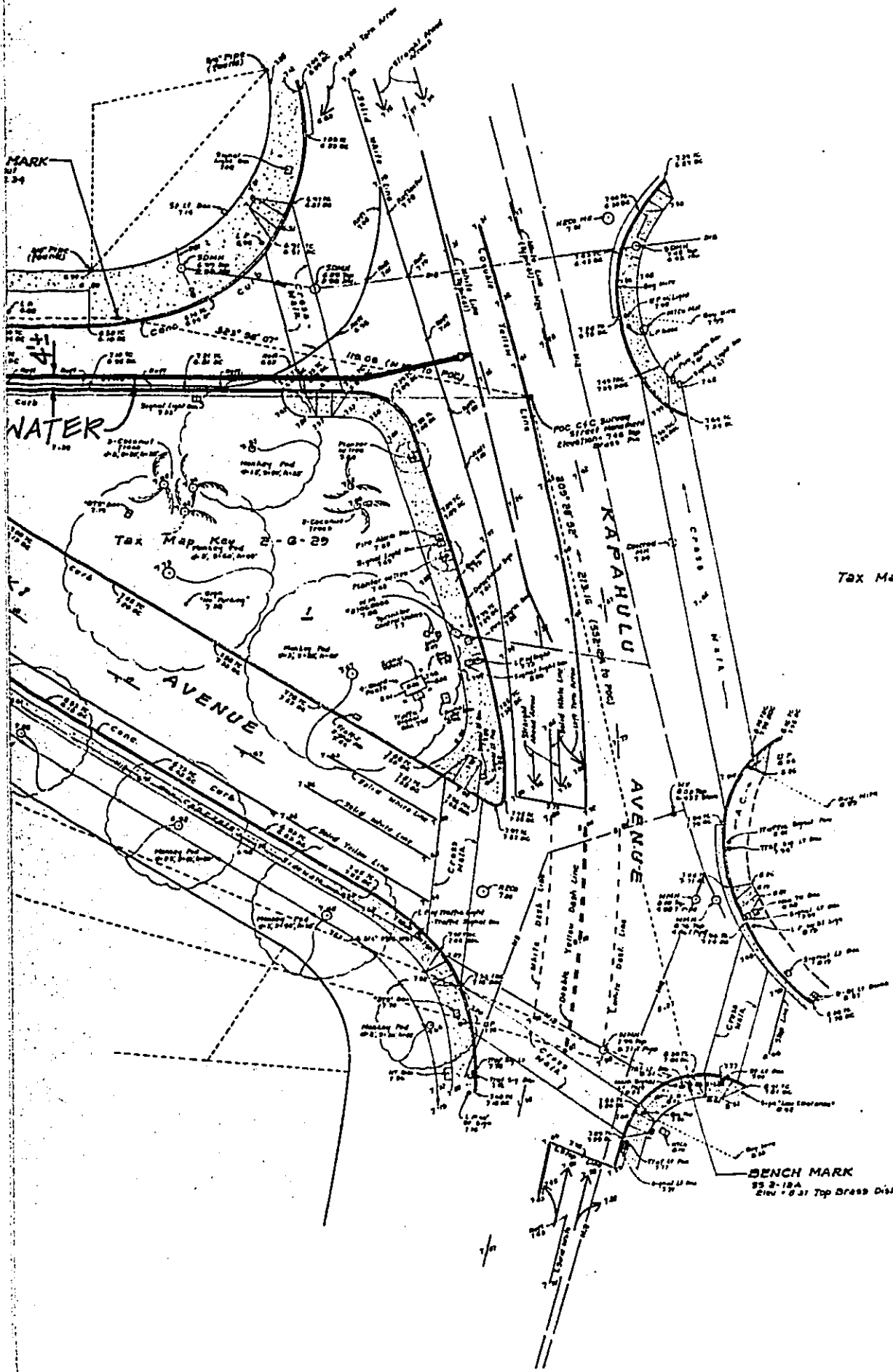

Tax Map Key 3-1

BENCH MARK
SS 2-10A
Elev. 6' 0" at Top Brass Disk

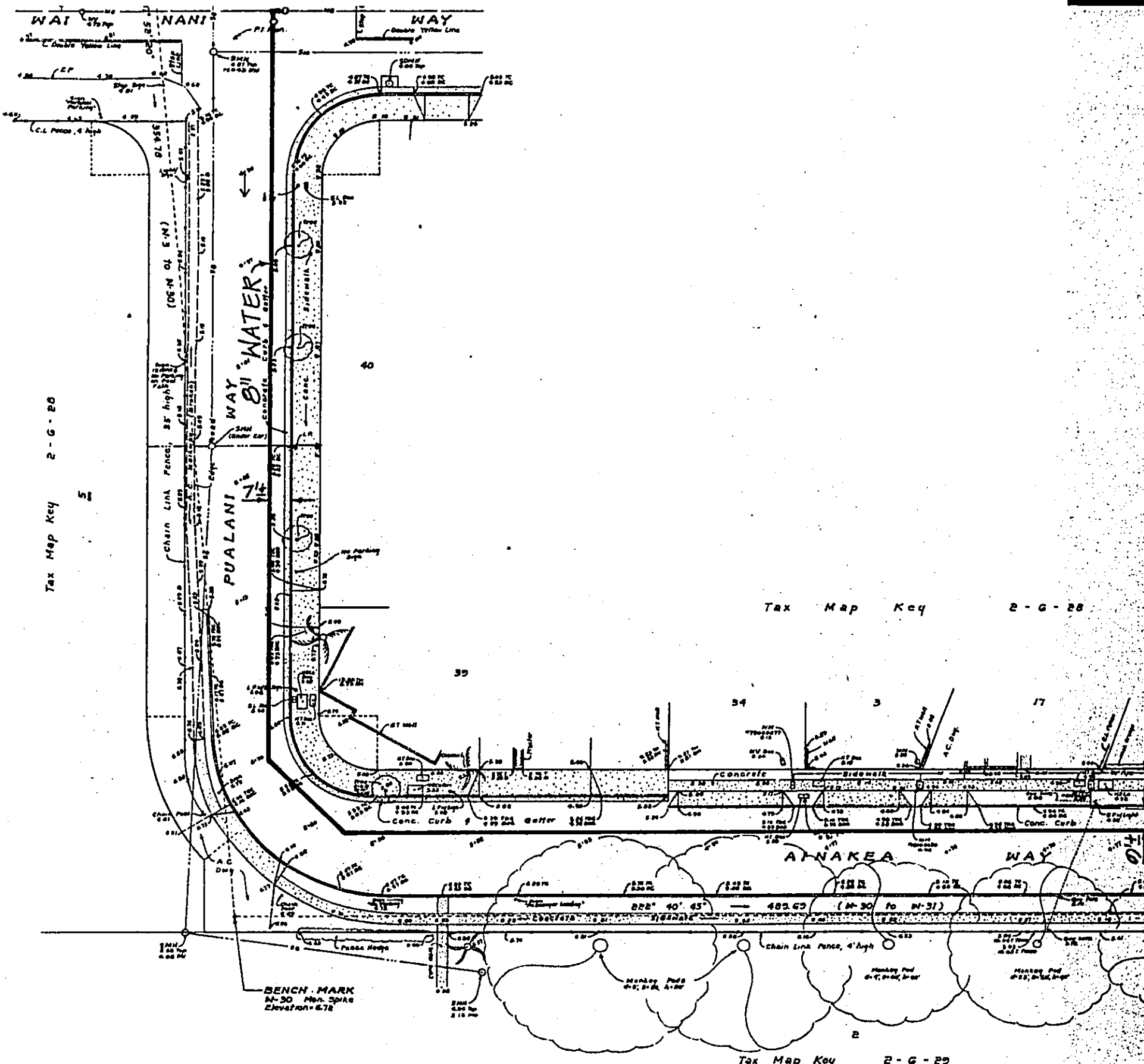

Tax Map Key 2-G-28

5

Tax Map Key 2-G-28

Tax Map Key 2-G-29

UNDERGROUND PUBLIC UTILITIES SHOWN IN THIS CASE FOR INFO ONLY, HAVING BEEN LOCATED FROM THE BEST AVAILABLE RECORDS BUT FROM OTHERS NOT CONNECTED WITH THIS OFFICE. THEREFORE, NO GUARANTEE IS MADE ON THE ACCURACY OR COMPLETENESS OF SAID INFORMATION.

Drain Line taken from C & C drainage maps 0-11 and P-11.
 Gas Line taken from GASCO, Inc. maps 8-6-26, 2-6-28 and 2-6-28.
 Water Line toned by Board of Water Supply personnel.

PROPOSED ALIGNMENT FOR ALA WAI BLVD 10" WATER MAIN PLATE B-G

TRUE NORTH
Scale: 1 in = 20 ft.

E - G - 28

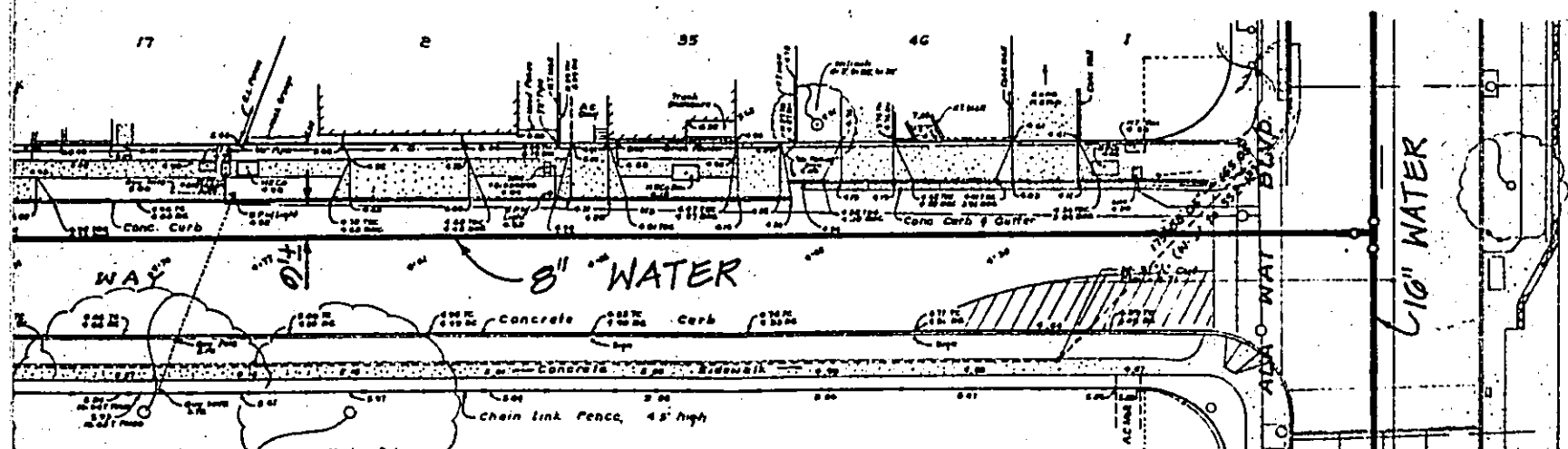

TOPOGRAPHIC SURVEY MAP
ALA WAI BOULEVARD - 16 INCH WATER MAIN
WAIKIKI, HONOLULU, OAHU, HAWAII
Tax Map Key: 2-G-21, 24, 25, 28 & 29
2-7-36

ALIGNMENT
AI BLVD
MAIN

Scale: 1 in = 20 ft. Job No. 90049 May 1, 1990 F.D. 552 & 563

CONTROLPOINT SURVEYING AND ENGINEERING, INC.
1043 Hong Mo Lane
Honolulu, Hawaii 96819



Alden S. Kajioka
ALDEN S. KAJIOKA
Licensed Land Surveyor
Certificate Number 6605-LB

SHEET G OF G SHEETS