

JOHN WAIHEE
GOVERNOR



RECEIVED
STATE OF HAWAII
DEPARTMENT OF ACCOUNTING AND GENERAL SERVICES
DIVISION OF PUBLIC WORKS

'90 AGO -7 P. 12:08
1990, HONOLULU, HAWAII 96810

OFFICE OF ENVIRONMENTAL
QUALITY CONTROL

AUG 06 1990

RUSSEL S. NAGATA
COMPTROLLER

JAMES H. YASUDA
DEPUTY COMPTROLLER

(P)1637.0

LETTER NO. _____

Dr. Marvin Miura
Director
Office of Environmental
Quality Control
465 South King Street, Rm. 104
Honolulu, Hawaii 96813

Dear Dr. Miura:

Subject: Lincoln Elementary School
Parking Lot and Exit Driveway

Attached for your appropriate action are the following:

1. QEQC Form for Publication of EIS Documents in the QEQC Bulletin.
2. Four copies of the Negative Declaration.

If there are any questions, please have your staff call Ms. Emily Chun of the Planning Branch at 548-7192.

Very truly yours,

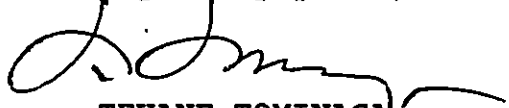
TEUANE TOMINAGA
State Public Works Engineer

EC:hc
Attachments

1990-08-23-0A-PRA

FILE COPY

NEGATIVE DECLARATION
* LINCOLN ELEMENTARY SCHOOL
PARKING LOT AND EXIT DRIVEWAY *
AUGUST 3, 1990

- A. PROPOSING AGENCY: Department of Accounting and General Services for the Department of Education.
- B. APPROVING AGENCY: Not applicable.
- C. AGENCY CONSULTED: Department of Education.
- D. GENERAL DESCRIPTION TECHNICAL, ECONOMIC, SOCIAL AND ENVIRONMENTAL CHARACTERISTICS:
1. Technical: This is to construct a parking lot to provide additional stalls. A paved driveway will also be constructed to provide an alternate exit driveway.
 2. Economic: The estimated cost of the project is \$117,000. Since the project will be constructed within the existing school campus, no land will be removed from the tax base.
 3. Social: The project will provide the school with a much-needed facility that will alleviate parking and traffic problems.
 4. Environmental: The project will not create any major environmental impact.
- E. SUMMARY DESCRIPTION OF THE AFFECTED ENVIRONMENT, INCLUDING SITE MAPS: The school and parking lot/driveway are located as shown in Figures 1 and 2, respectively. The proposed facility will be located in an area that had been previously graded during the construction of nearby structures.
- F. DISCUSSION OF THE ASSESSMENT PROCESS: The following assessments are made to determine whether or not the anticipated effects constitute a "significant effect":
1. The proposed action will not involve an irrevocable commitment to loss or destruction of any natural or cultural resources.
 2. The proposed action will not curtail the range of beneficial uses of the environment.

3. The proposed action will not conflict with the State's long-term environmental policies.
 4. The proposed action will not substantially affect the economic or social welfare of the community or State.
 5. The proposed action will not involve substantial secondary impacts, such as population changes or effects on public facilities.
 6. The proposed action will not involve a substantial degradation of environmental quality.
 7. The proposed action will not substantially affect any rare, threatened or endangered species of flora or fauna or habitat. No endangered species of flora or fauna are known to exist in the project site.
 8. The proposed action will not detrimentally affect air or water quality or ambient noise levels.
 9. The proposed action will not be located in any environmentally sensitive area, such as flood plain, tsunami zone, erosion-prone area, geologically hazardous land, estuary, fresh water, or coastal waters.
- G. SUMMARY OF MAJOR IMPACTS: From the above assessment, no major adverse environmental impact is anticipated. The project will result in the following minor adverse impacts:
1. Depletion of labor and material resources for construction.
 2. Some dust, noise and silting during construction.
- H. ALTERNATIVES CONSIDERED: The "no action" alternative was considered but deemed to be unacceptable.
- I. PROPOSED MITIGATION MEASURES: The temporary dust, noise and silting which would occur during construction will be controlled by application of appropriate pollution control measures.

J. DETERMINATION: It is determined that an Environmental Impact Statement should not be required for this project.

K. FINDINGS AND REASONS SUPPORTING DETERMINATION: The project site is generally free of flood, tsunami, erosion, and landslide hazards. No rare or endangered species of flora are known to exist at the site. No rare or endangered species of fauna are known to inhabit the site. There are no recorded archaeological or historical sites within the existing site.

For the reasons sited above, the proposed action will not have any significant effect in the context of Chapter 343, Hawaii Revised Statutes and Section 11-200-12 of the State Administrative Rules.

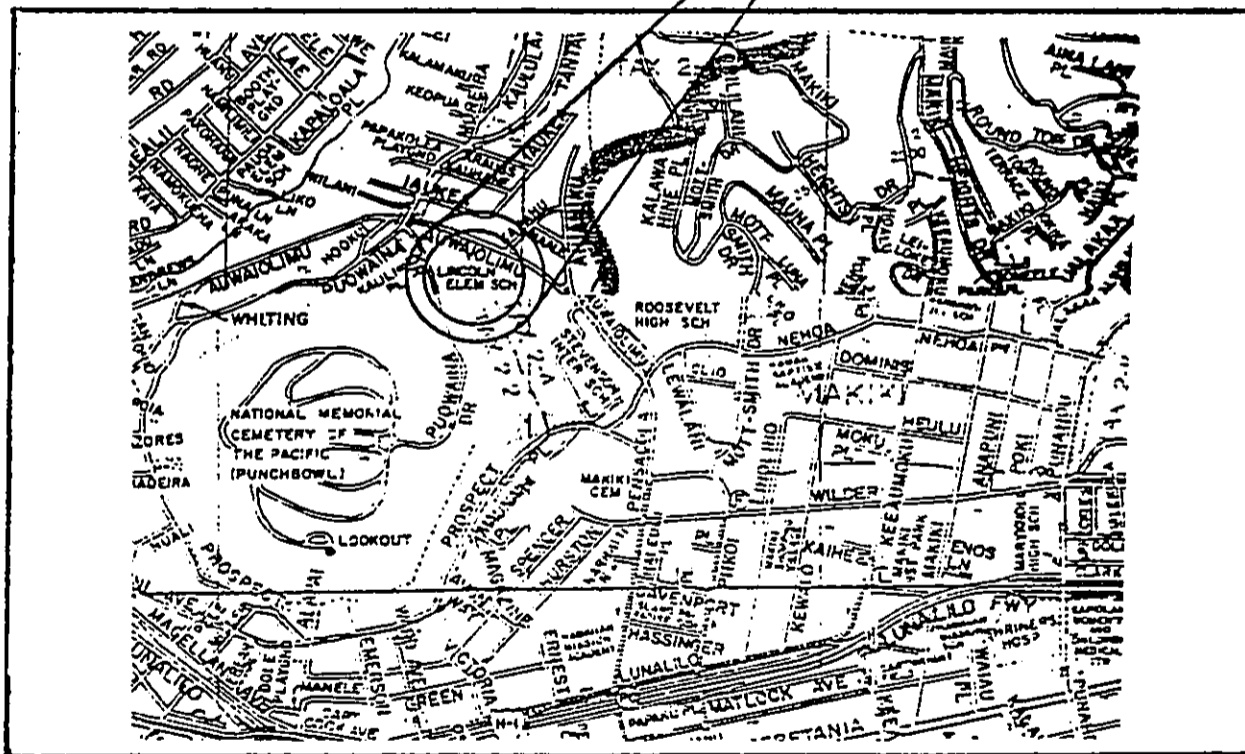
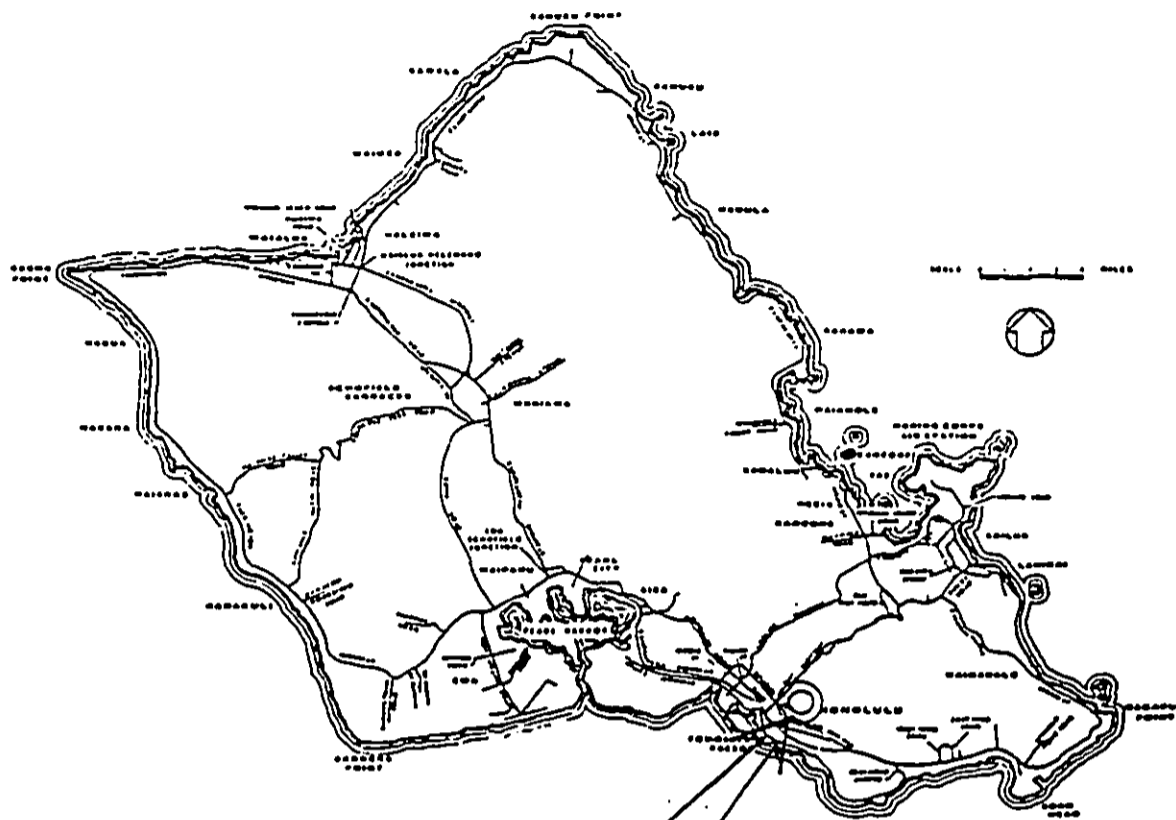

LOCATION MAP

FIGURE 1

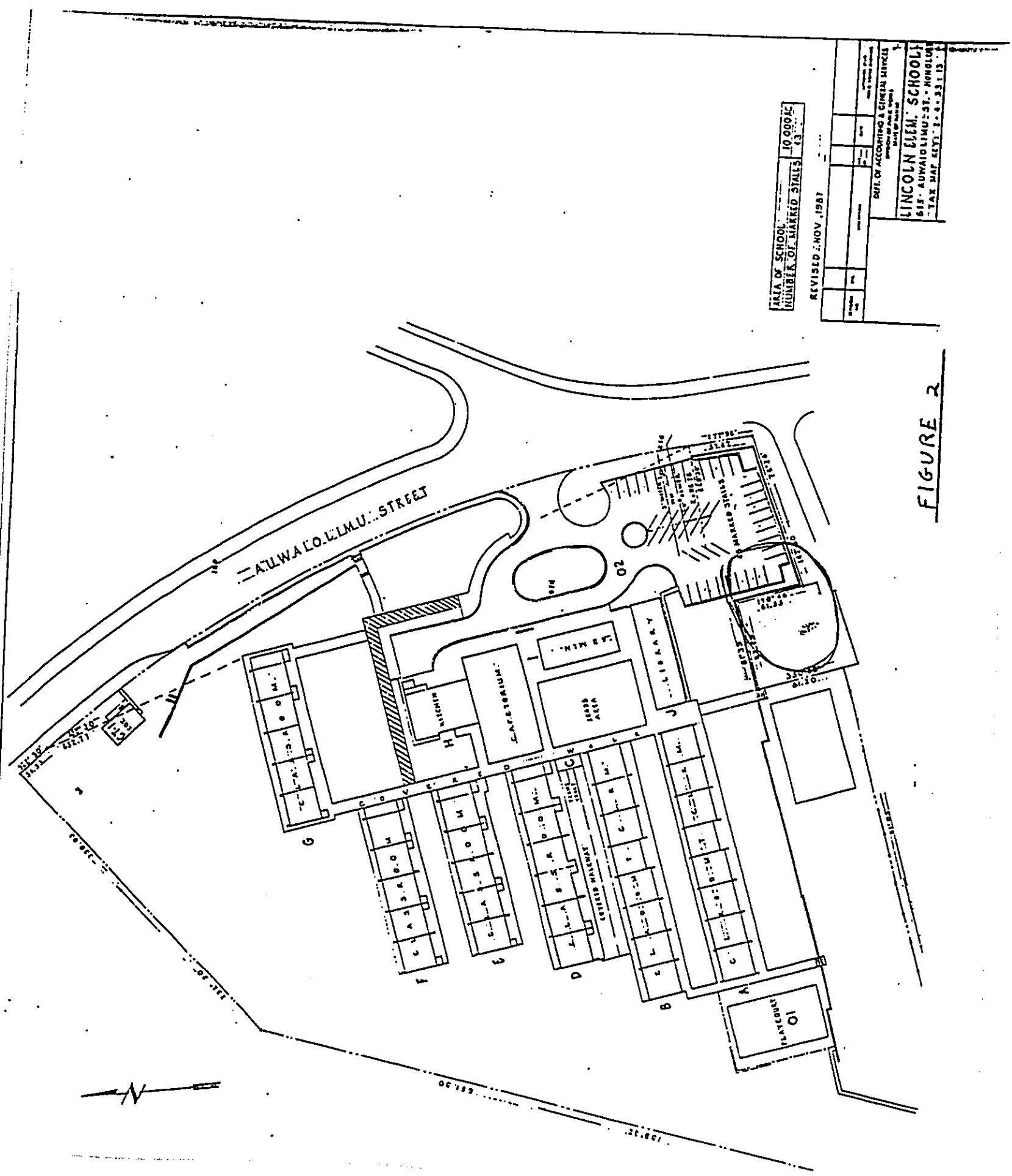

AREA OF SCHOOL 10,000 sq. ft.
 NUMBER OF MARKED STAIRS 13

REVISED 2 NOV 1987

NO.	DATE	BY	REVISION

DEPT. OF ACCOUNTING & GENERAL SERVICES
 LINCOLN ELEMENTARY SCHOOL
 615 ADWAIDILIMU ST. HONGKONG
 TAX MAP KEY: 1-2-331 13

FIGURE 2