

JOHN WAIHEE
GOVERNOR



STATE OF HAWAII
DEPARTMENT OF ACCOUNTING AND GENERAL SERVICES
DIVISION OF PUBLIC WORKS
P. O. BOX 119, HONOLULU, HAWAII 96810

RUSSEL S. NAGATA
COMPTROLLER

JAMES H. YASUDA
DEPUTY COMPTROLLER

RECEIVED (P)1696.0

LETTER NO. _____

'90 AUG 24 P 4 11

AUG 24 1990

Dr. Marvin Miura
Director
Office of Environmental
Quality Control
465 South King Street, Rm. 104
Honolulu, Hawaii 96813

Dear Dr. Miura:

Subject: Kaaawa Elementary School
Land Acquisition

Attached for your appropriate action are the following:

1. OEQC Form for Publication of EIS Documents in the OEQC Bulletin.
2. Four copies of the Negative Declaration.

If there are any questions, please have your staff call Ms. Emily Chun of the Planning Branch at 548-5742.

Very truly yours,

TEUANE TOMINAGA
State Public Works Engineer

EC:hc
Attachments

1990-09-08-0A-FBA

FILE COPY

NEGATIVE DECLARATION
* KAAAWA ELEMENTARY SCHOOL
LAND ACQUISITION *
AUGUST 20, 1990

- A. PROPOSING AGENCY: Department of Accounting and General Services for the Department of Education.
- B. APPROVING AGENCY: Not applicable.
- C. AGENCY CONSULTED: Department of Education.
- D. GENERAL DESCRIPTION TECHNICAL, ECONOMIC, SOCIAL AND ENVIRONMENTAL CHARACTERISTICS:
1. Technical: This is to acquire a 6-ft by 145-ft strip of land to provide access from Kekio Road to Kaaawa Elementary School.
 2. Economic: The estimated cost of the project is \$20,000.
 3. Social: The project will provide the school with an escape route to higher ground should there be a threat of tsunami or other flood hazard.
 4. Environmental: The project will not create any major environmental impact.
- E. SUMMARY DESCRIPTION OF THE AFFECTED ENVIRONMENT, INCLUDING SITE MAPS: The school and 6-ft by 145-ft strip of land is located as shown in Figures 1, 2 and 3.
- F. DISCUSSION OF THE ASSESSMENT PROCESS: The following assessments are made to determine whether or not the anticipated effects constitute a "significant effect":
1. The proposed action will not involve an irrevocable commitment to loss or destruction of any natural or cultural resources.
 2. The proposed action will not curtail the range of beneficial uses of the environment.
 3. The proposed action will not conflict with the State's long-term environmental policies.

4. The proposed action will not substantially affect the economic or social welfare of the community or State.
 5. The proposed action will not involve substantial secondary impacts, such as population changes or effects on public facilities.
 6. The proposed action will not involve a substantial degradation of environmental quality.
 7. The proposed action will not substantially affect any rare, threatened or endangered species of flora or fauna or habitat. No endangered species of flora or fauna are known to exist in the project site.
 8. The proposed action will not detrimentally affect air or water quality or ambient noise levels.
 9. The proposed action will not be located in any environmentally sensitive area, such as an erosion-prone area, geologically hazardous land, estuary, fresh water, or coastal waters. However, the strip of land is partially within a flood plain and tsunami zone for the purpose of providing an escape route to higher ground.
- G. SUMMARY OF MAJOR IMPACTS: From the above assessment, no major adverse environmental impact is anticipated. The project will result in the following minor adverse impacts:
1. Depletion of labor and material resources for construction.
 2. Loss of approximately 900 square feet from an adjacent landowner. However, the landowner has indicated a willingness to sell his land to the State for the public good of providing an escape route for the school.
- H. ALTERNATIVES CONSIDERED: The "no action" alternative was considered but deemed to be unacceptable.

- I. PROPOSED MITIGATION MEASURES: Since the action is to acquire land, the only mitigation will be just compensation for the land.
- J. DETERMINATION: It is determined that an Environmental Impact Statement should not be required for this project.
- K. FINDINGS AND REASONS SUPPORTING DETERMINATION: The project site is generally free of erosion and landslide hazards. No rare or endangered species of flora are known to exist at the site. No rare or endangered species of fauna are known to inhabit the site. There are no recorded archaeological or historical sites within the existing site.

For the reasons cited above, the proposed action will not have any significant effect in the context of Chapter 343, Hawaii Revised Statutes and Section 11-200-12 of the State Administrative Rules.

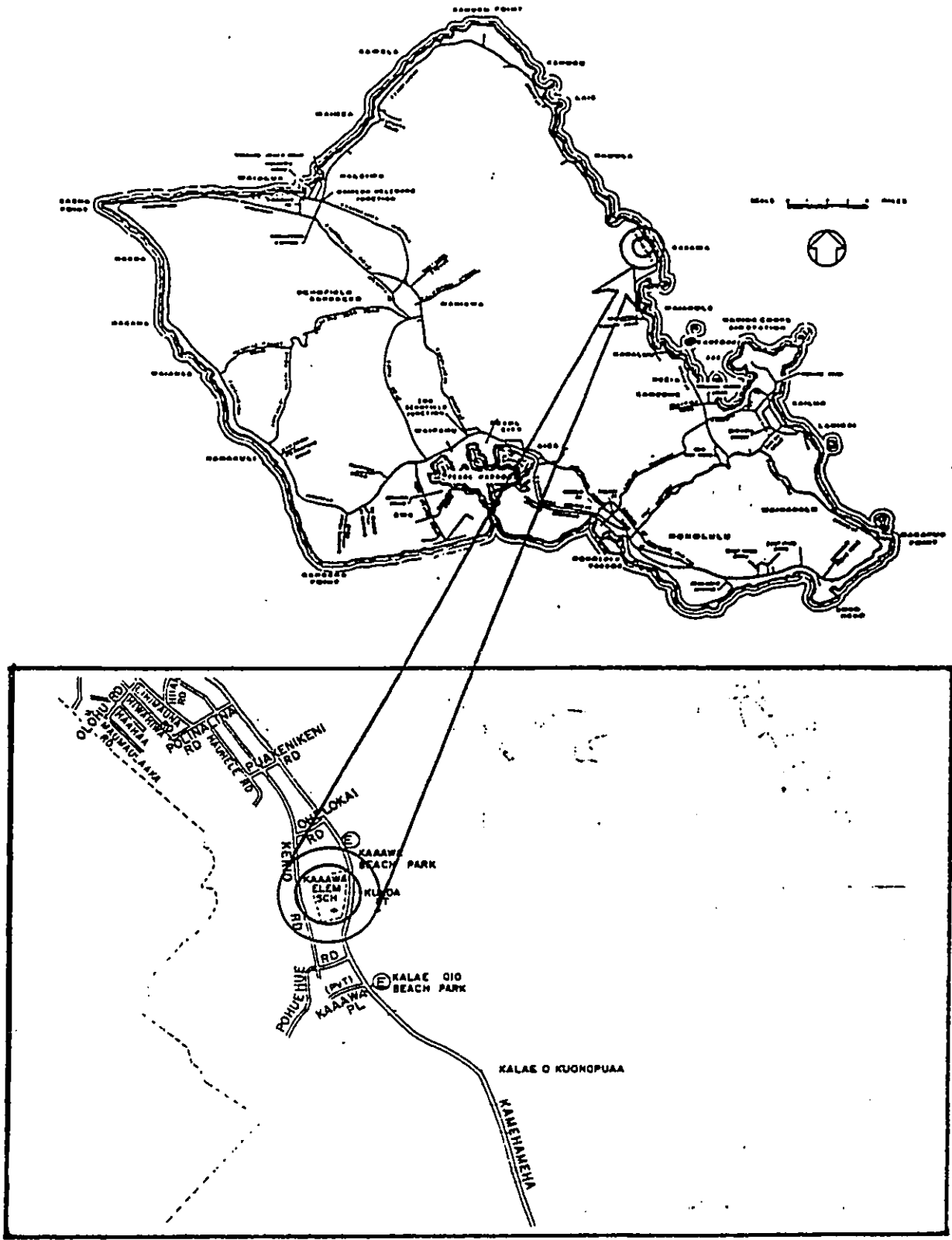

LOCATION MAP

FIGURE 1

KAAAWA ELEMENTARY SCHOOL

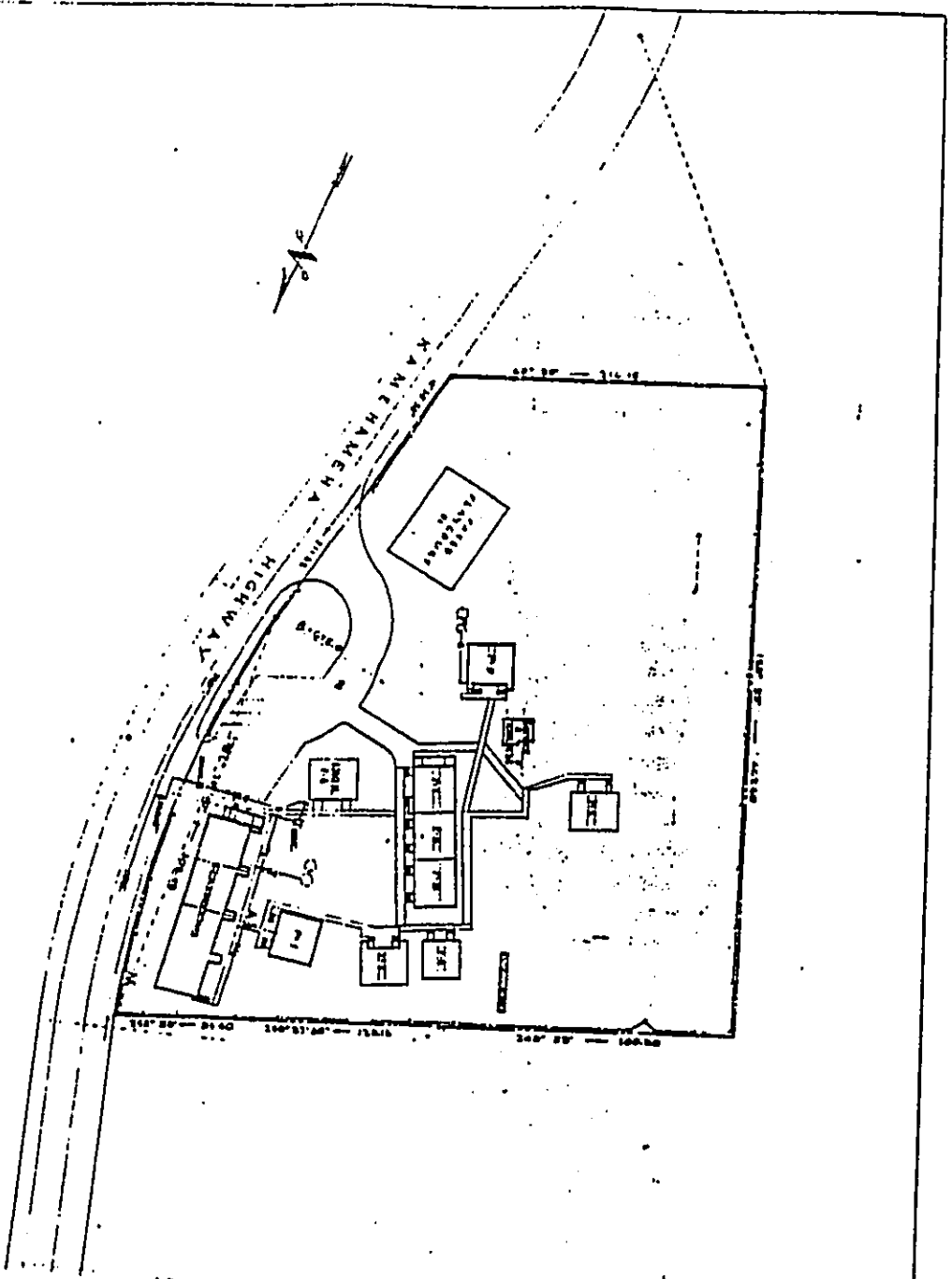

FIGURE 2

DATE: 1968
SCALE: 1/4" = 10'

BUILDING DEPARTMENT	
OFFICE OF SCHOOL	
SCHOOL: KAAAWA ELEMENTARY SCHOOL	
ADDRESS: KANEHANA HIGHWAY, KAAAWA	
DATE: JAN 1968	
BY: [Signature]	
6-02	

LIVABLE VOLUME	
AREA OF SCHOOL	112
NUMBER OF CLASS ROOMS	8

NO.	FACILITIES	NO.	NO.
1	CLASS ROOM	2	OFFICE
3	GYM	4	RESTROOM
5	PARKING LOT	6	OFFICE

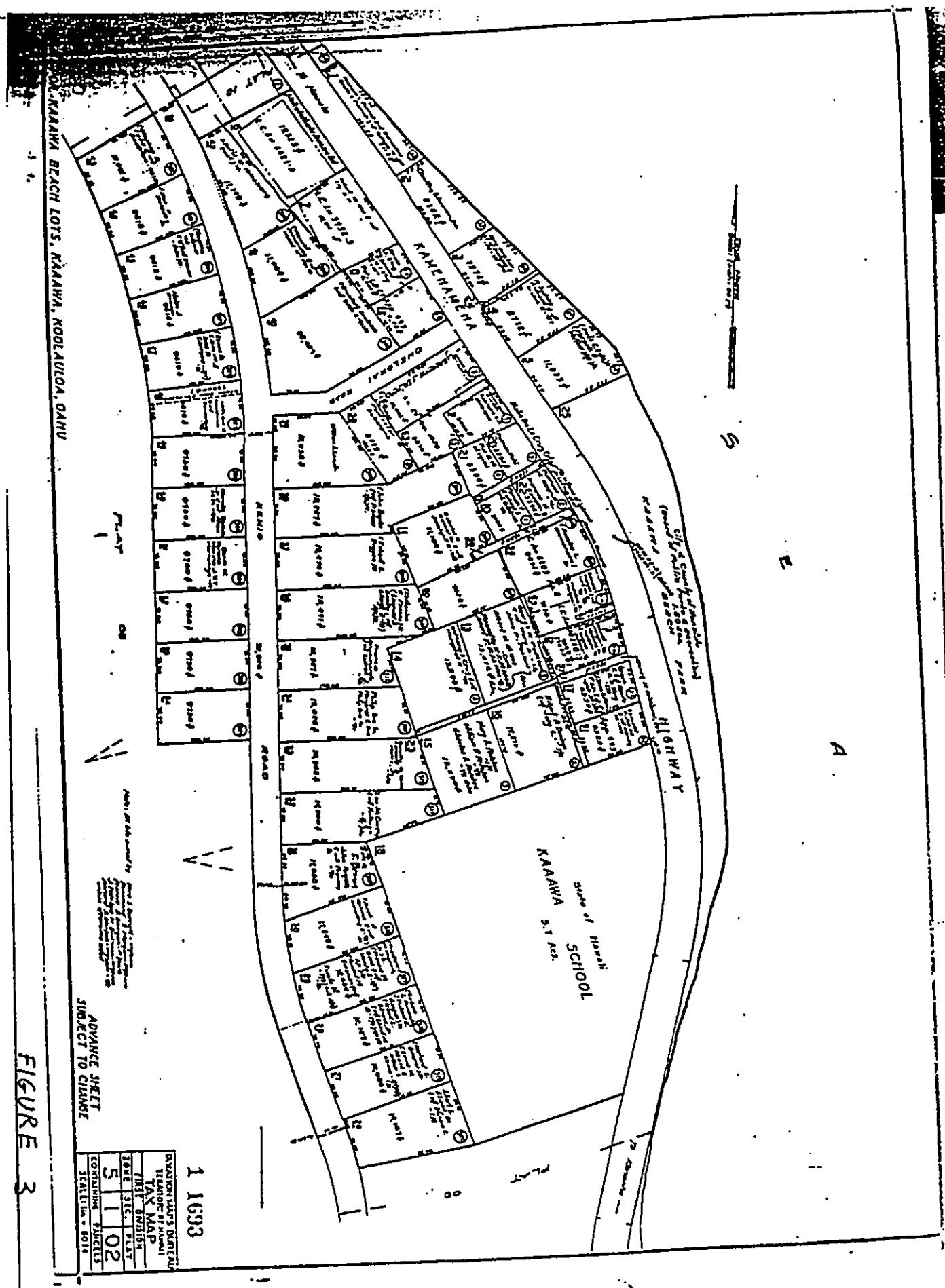

1 1693

REVISIONS	DATE	DESCRIPTION
1	11/02	ISSUE
2	11/02	ISSUE
3	11/02	ISSUE
4	11/02	ISSUE
5	11/02	ISSUE

FIGURE 3

ADVANCE SHEET
SUBJECT TO CHANGE

CORRECTION

THE PRECEDING DOCUMENT(S) HAS
BEEN REPHOTOGRAPHED TO ASSURE
LEGIBILITY
SEE FRAME(S)
IMMEDIATELY FOLLOWING

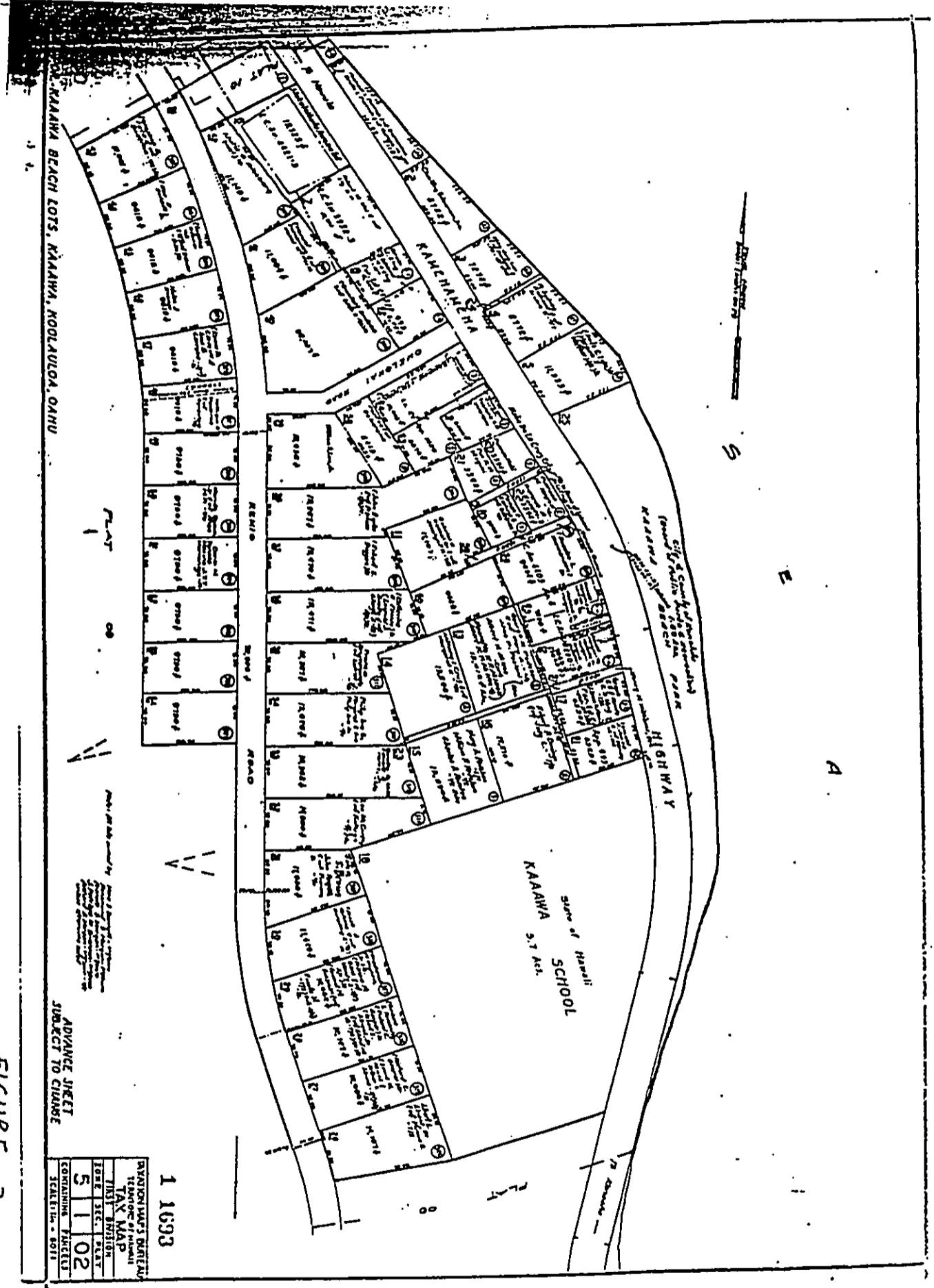

ADVANCE SHEET
SUBJECT TO CHANGE

1 1693	
DIVISION MAP & DETAIL	
TERRITORY OF HAWAII	
TAX MAP	
TAX DIVISION	
5	102
LORE	SEC. PLAT
CONTAINING PARCELS	
SCALE 1" = 80 FT	

FIGURE 3