

JOHN WAIHEE
GOVERNOR OF HAWAII



WILLIAM W. PATY, CHAIRPERSON
BOARD OF LAND AND NATURAL RESOURCES

STATE OF HAWAII
DEPARTMENT OF LAND AND NATURAL RESOURCES
DIVISION OF WATER RESOURCE MANAGEMENT

P. O. BOX 373
HONOLULU, HAWAII 96809

October 24, 1990

RECEIVED
'90 OCT 26 A9 00
OFC. OF ENVIRONMENTAL
QUALITY CONTROL

DEPUTIES
KEITH W. AHUE
MANABU TAGOMORI
RUSSELL N. FUKUMOTO

AQUACULTURE DEVELOPMENT
PROGRAM
BOTANIC RESOURCES
CONSERVATION AND
ENVIRONMENTAL AFFAIRS
CONSERVATION AND
RESOURCES ENFORCEMENT
CONVEYANCES
FORESTRY AND WILDLIFE
HISTORIC PRESERVATION
PROGRAM
LAND MANAGEMENT
STATE PARKS
WATER RESOURCE MANAGEMENT

Dr. Bruce Anderson, Acting Director
Office of Environmental
Quality Control
465 South King Street
Kekuanaoa Building, Room 104
Honolulu, Hawaii 96813

Dear Dr. Anderson:

Job No. 22-HW-M, Water System
Honokohau Boat Harbor
Kealakehe, North Kona, Hawaii

Pursuant to Section 11 of the Environmental Impact Statement Rules, transmitted for processing are four (4) copies of the Environmental Assessment and Notice of Determination (Negative Declaration) for the subject project. Also attached is a completed OEQC Bulletin Publication Form.

If there are any questions on this matter, please have your staff contact Mr. Ed Lau of the Planning Branch at extension 8-7496.

Sincerely,

Handwritten signature of Kazuo G. Akita in cursive script.
KAZUO G. AKITA
Manager-Chief Engineer

Attach.

1990-11-08-HA-FEM

FILE COPY

ENVIRONMENTAL ASSESSMENT
AND
NEGATIVE DECLARATION

Job No. 22-HW-M

Water System

Honokohau Boat Harbor

Kealahou, North Kona, Hawaii

State of Hawaii
Department of Land and Natural Resources
Division of Water Resource Management
July, 1990

NOTICE OF DETERMINATION: Negative Declaration

**FOR: Job No. 22-HW-M
Water System
Honokohau Boat Harbor
Kealakehe, North Kona, Hawaii**

**BY: Division of Water Resource Management
Department of Land and Natural Resources**

The proposed action will have no significant effect on the environment and therefore does not require the preparation of an Environmental Impact Statement. This Notice of Determination and Environmental Assessment are being filed as a Negative Declaration.

ENVIRONMENTAL ASSESSMENT

For

Job No. 22-HW-M
Water System
Honokohau Boat Harbor
Kealahou, North Kona, Hawaii

I. Applicant/Proposing Agency

Division of Water Resource Management
Department of Land and Natural Resources

II. Agencies Consulted

State of Hawaii
State Housing Finance and Development Corporation
Department of Transportation
Department of Land and Natural Resources
Division of Forestry
Historic Preservation Program

County of Hawaii
Planning Department
Department of Water Supply

III. Project Description

The State Department of Land and Natural Resources, Division of Water Resource Management is proposing the construction of a 1.0 million gallon (MG) concrete reservoir in the North Kona district on the island of Hawaii (see figures 1 and 2). The proposed reservoir is to be located near the Honokohau Small Boat Harbor, approximately 4000 feet mauka of Queen Kaahumanu Highway, at an elevation of about 305 feet above mean sea level. The reservoir will be built on a 800 acre parcel of land owned by the State of Hawaii, Tax Map Key 7-4-8:17 (see figure 3). At present, the land is designated as open agricultural land.

The population in the North Kona district is about 21,600 residents, which shows an increase of almost 60% from 1980. Due to this sharp increase, the current water storage system in Kona has become inadequate to handle both the

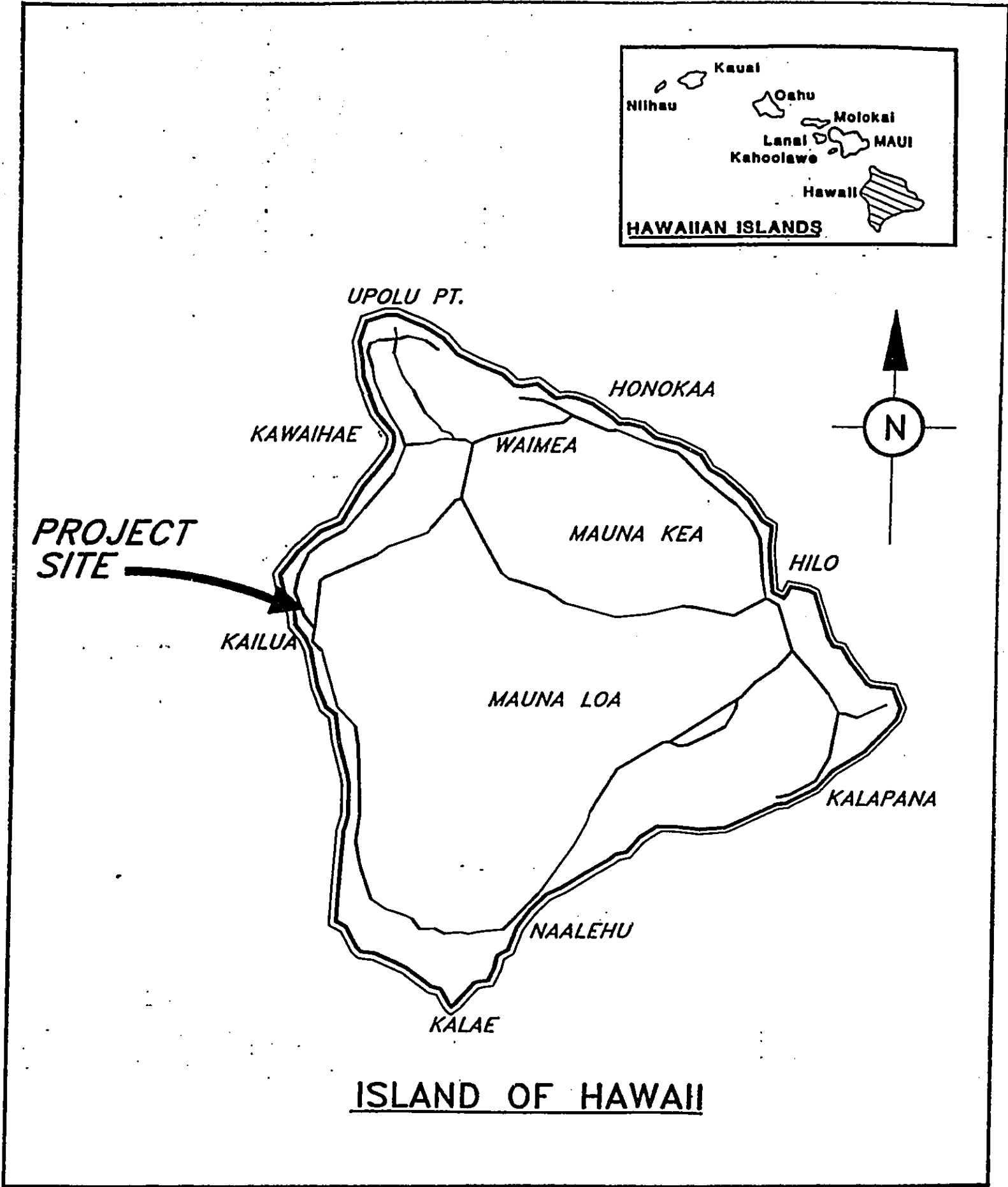

FIGURE 1

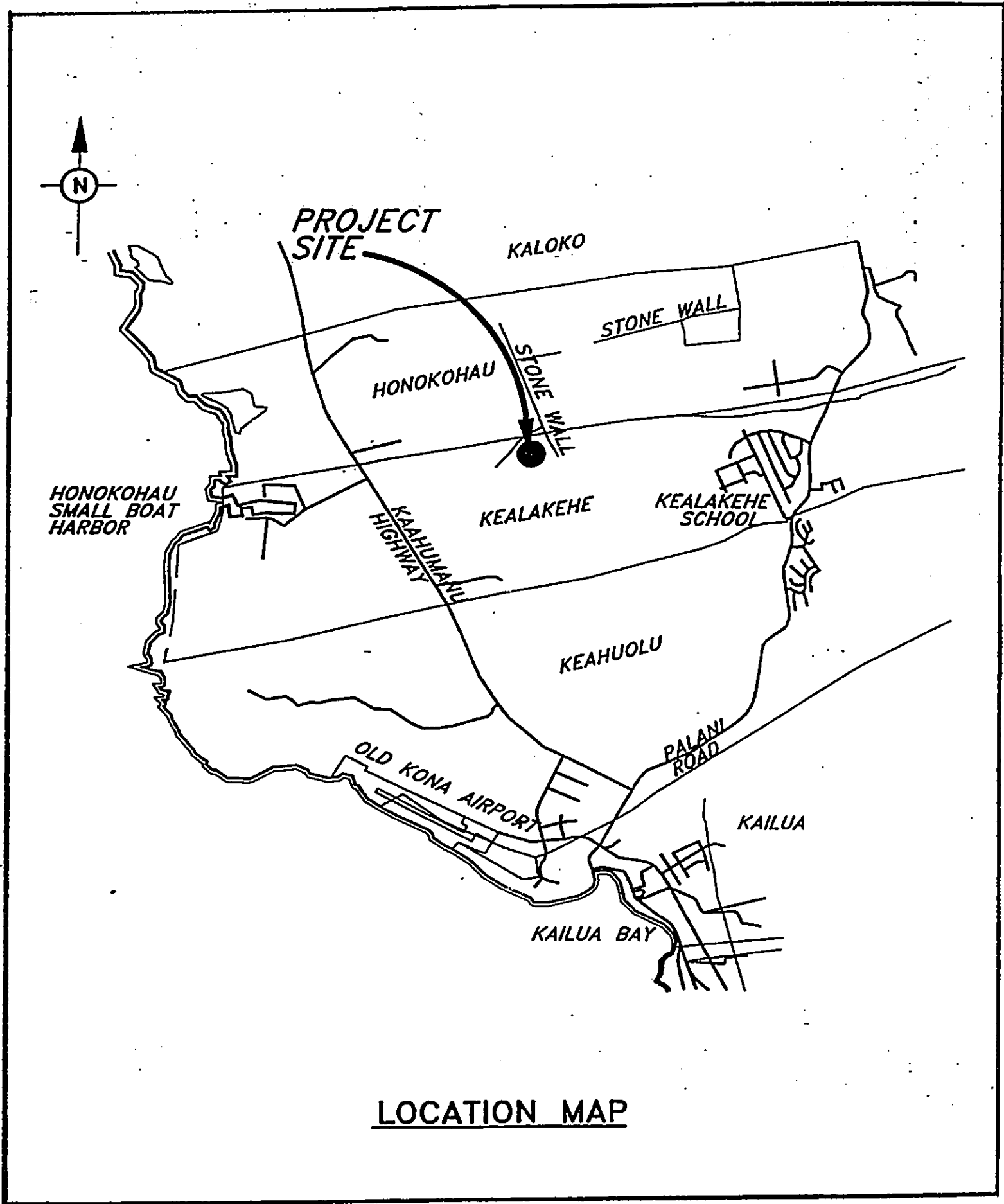

FIGURE 2

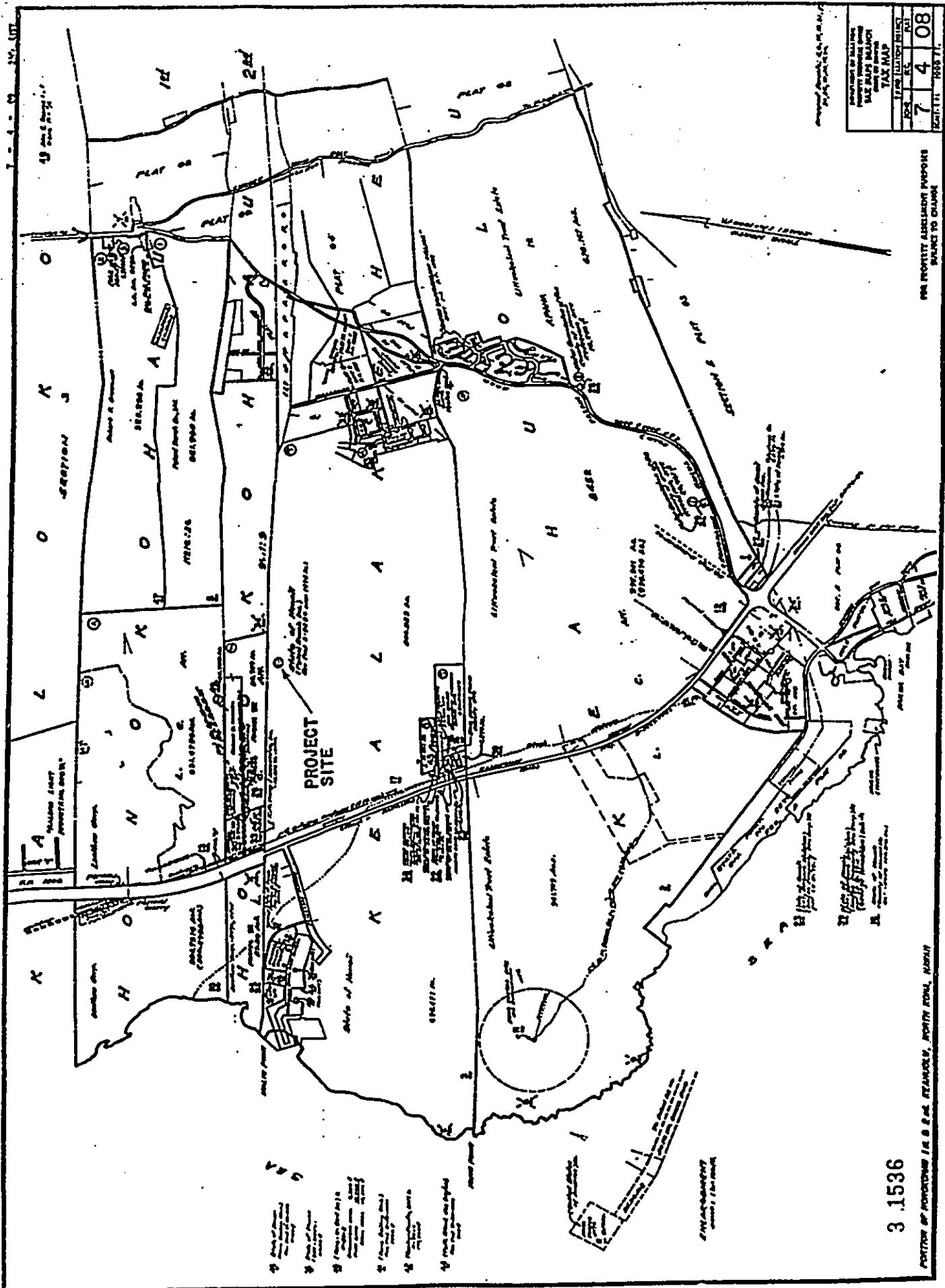

FIGURE 3

current demand and the new developments which are being planned and constructed to accommodate the burgeoning population. In order to help alleviate the problem, the proposed reservoir is being built to increase the water storage capabilities of North Kona's present water system. The main goal of this project is to provide a reservoir to support the future water needs for Honokohau Boat Harbor and for a portion of the housing development planned above the harbor by the Housing Finance Development Corporation (HFDC). This project is a joint effort by the Department of Transportation and the HFDC.

IV. Project Schedule and Cost Estimate

The construction portion of the project should be completed 270 days after receipt of notice to proceed. The preliminary construction cost estimate for the project is \$1,000,000.00.

V. Potential Impacts

Short Term Impacts

Short term impacts of the proposed project should be minimal. Noise from the construction equipment should not be a problem. Dust nuisance and vehicle emissions will be mitigated by strict conformance to environmental regulations. Equipment movement and storage will be governed by current public convenience and safety standards.

The Hawaii Housing Authority (HHA) has a housing project planned in the property immediately adjacent to the reservoir site. Part of this project involves the construction of a main roadway leading up from Queen Kaahumanu Highway. This job is scheduled to begin construction shortly. Minimal sitework will be done on a short, rough grade construction road leading from the new main road to the project site. All other short term impacts will be mitigated by normal construction practices.

Long Term Impacts

The proposed reservoir should enhance the current water system in North Kona by easing the demand from the existing reservoir. The project will accommodate all the water needs of the Honokohau Boat Harbor. Eventually, the lower increments of the housing development planned by the HFDC should also be served by the reservoir. Once construction of the reservoir is completed, operation and maintenance costs should be minimal. No adverse long term environmental impacts are anticipated.

VI. Alternatives to the Proposed Action

Alternative Site

Other sites on State of Hawaii land are less advantageous for the proposed reservoir. The present site is located in an area which can be accessed by a nearby main roadway which will be built shortly. Passage to the site itself from the main road will be achieved by the construction of a short access road over the existing lava rock. The project is situated in an area such that it will have minimal impact on existing archaeological sites. The reservoir is also within the hydraulic gradient of the existing system for maximum efficiency.

No Action

No action would mean continued dependence on the present water system. The proposed reservoir is necessary if adequate water storage is to be maintained.

VII. Discussion of Significant Criteria

In considering the significance of potential environmental impacts, both short term and long term, with respect to the criteria as defined in Chapter 343, Hawaii Revised Statutes Section 1:31, it has been determined that:

1. The proposed action does not involve an irrevocable commitment or loss of or destruction of any natural cultural resource:

There are no natural or cultural resources associated with the project site. The site is presently zoned as agricultural land and consists mostly of lava rock and scattered shrubs.

2. The proposed action does not curtail the range of beneficial uses of the environment:

The proposed project is consistent with the County's general plan and the Department of Water Supply policy and would not curtail beneficial uses of the environment in the area. The proposed project will be compatible with the uses of the surrounding area.

3. The proposed action is in concert with the state's long-term environmental policies, goals and guidelines as expressed in Chapter 343, HRS, and any revisions and amendments thereto, court decisions and executive orders:

The proposed project is consistent with the State Land Use Plan which is in concert with all applicable policies, goals, and guidelines. No long term environmental conflicts are foreseen.

4. The proposed action does not substantially affect the economic or social welfare of the community or state:

The proposed project will increase the water storage capabilities of the present system, which will be beneficial to the community. The economic impact will be affected by the short term construction related activities. Any long term effects of the proposed project should be positive.

5. The proposed action does not involve substantial secondary impacts such as population changes or effects on public facilities:

The proposed project in and of itself should not result in an increase in population, nor should it affect normal population growth in the area. HFDC has a planned community in Kealakehe which is expected to use a portion of the water from the proposed reservoir. The dependence of this community upon the reservoir may possibly be seen as a secondary impact. However, the reservoir water available for the proposed community is not unlimited and will only accommodate the lower portion of the planned development.

6. The proposed action does not substantially affect public health:

Construction activities will be regulated to minimize noise, dust and erosion. There are no residences in the vicinity of the construction site.

7. The proposed action does not involve a substantial degradation of environmental quality:

The existing physical aspects of the surrounding area will be preserved. Once completed, the reservoir will not generate any noise and will have no adverse impact on the air quality.

8. The proposed action is individually limited and cumulatively, does not have a considerable effect upon the environment or involve a commitment for larger actions:

The proposed project is a development of the State Department of Transportation and the Housing Finance and Development Corporation. Use will be regulated by the County of Hawaii Department of Water Supply. Approval of the project does not involve a commitment for any larger action.

9. The proposed action does not substantially affect rare, threatened or endangered species or habitats:

Botanical surveys have reported the presence of several uhiuhi (Caesalpinia kavaiensis) plants in the vicinity of the proposed project. None, however, were found at the project site itself. Neither the proposed reservoir nor the construction access road should have any impact on this species.

10. The proposed action does not affect areas of archaeological interest:

The proposed project site will only impact a wall. Since additional archaeological data can be taken from sections of the wall farther away from the project site, the project should not adversely affect the archaeological significance of the wall. All other sites are either of no significant value or will not be affected by the project (see reference attachment from Historic Sites). If any unanticipated sites or artifacts are discovered during construction, the work will be halted and the State Historic Preservation Office will be contacted.

11. The proposed action does not detrimentally affect air or water quality or ambient noise levels:

Short term impacts on air quality and noise will occur during the construction period but will be mitigated by normal construction practices. Once construction is completed, the reservoir will generate no noise and will have no effect on air or water quality.

VIII. Determination

In accordance with Chapter 343, Hawaii Revised Statutes, it is determined that the proposed project would not have any significant adverse effects on the environment. Any potentially negative effects have been identified along with suggested mitigative measures. Consequently, an Environmental Impact Statement is not required and this Environmental Assessment is hereby being filed as a Negative Declaration.

JOHN WAIHEE
GOVERNOR OF HAWAII



WILLIAM W. PATY, CHAIRPERSON
BOARD OF LAND AND NATURAL RESOURCES

DEPUTIES

KEITH W. AHUE
MANABU TAGOMORI
RUSSELL N. FUKUMOTO

STATE OF HAWAII
DEPARTMENT OF LAND AND NATURAL RESOURCES

P. O. BOX 621
HONOLULU, HAWAII 96809

May 14, 1990

AQUACULTURE DEVELOPMENT
PROGRAM
AQUATIC RESOURCES
CONSERVATION AND
ENVIRONMENTAL AFFAIRS
CONSERVATION AND
RESOURCES ENFORCEMENT
CONVEYANCES
FORESTRY AND WILDLIFE
LAND MANAGEMENT
STATE PARKS
WATER AND LAND DEVELOPMENT

MEMORANDUM

TO: Manabu Tagomori, DOWALD

ATTENTION: Karen Chung, DOWALD

FROM: Don Hibbard, Director, Historic Preservation Program

SUBJECT: Chapter 6E Compliance -- Water System for Honokohau
Boat Harbor (Job No. 22-HW-M)
Kealakehe, North Kona, Hawaii
TMK: 7-4-8: part 17

The reservoir location, as plotted by your staff on the PHRI archaeological map of Kealakehe (attached), indicates that the reservoir project area will only impact a wall (site 13,180). Parts of this wall need some further data collection (archaeological data recovery) according to the archaeological report and mitigation plan submitted by HFDC (Donham 1990. Archaeological Inventory Survey, Kealakehe Planned Community Project Area. PHRI.). But, this information can be recovered from other portions of the wall. Thus, we believe that your project will have "no adverse effect" on significant historic sites.

Site 13,191 (a cairn) is also nearby on the map, but this site has been determined to be "no longer significant", as the survey work adequately recorded the information in the site. The other sites inland of wall 13,179 (which runs north-south) are restricted to areas inland of the wall, and it appears clear that your project will not cross this wall and affect these sites. These sites include 13,178, 13,188, and 13,189.

DON HIBBARD

Attachment (map)

