

JOHN WAIHEE
GOVERNOR



STATE OF HAWAII
DEPARTMENT OF ACCOUNTING AND GENERAL SERVICES
DIVISION OF PUBLIC WORKS
P. O. BOX 119, HONOLULU, HAWAII 96810

RUSSEL S. NAGATA
COMPTROLLER

JAMES H. YASUDA
DEPUTY COMPTROLLER

RECEIVED

(P)1916.0

LETTER NO.

'90 NOV -8 P2:18

NOV 7 1990

OFC. OF ENVIRONMENTAL
QUALITY CONTROL

Dr. Bruce Anderson
Acting Interim Director
Office of Environmental
Quality Control
465 South King Street, Rm. 104
Honolulu, Hawaii 96813

Dear Dr. Anderson:

Subject: Waialua Elementary
8-Classroom Building

Attached for your appropriate action are the following:

1. OEQC Form for Publication of EIS Documents in the OEQC Bulletin.
2. Four copies of the Negative Declaration.

If there are any questions, please have your staff call Mr. Gordon Sam of the Planning Branch at 548-3921.

Very truly yours,

A handwritten signature in cursive script, appearing to read "Teuane Tominaga".

TEUANE TOMINAGA
State Public Works Engineer

GS:hc
Attachments

1990-11-23-0A-FBA

FILE COPY

NEGATIVE DECLARATION
★ WAIALUA ELEMENTARY SCHOOL
8-CLASSROOM BUILDING★
NOVEMBER 2, 1990

'90 NOV -8 P2:18

- A. PROPOSING AGENCY: Department of Accounting and General Services for the Department of Education. UFC. OF ENVIR. QUALITY CTR.
- B. APPROVING AGENCY: Not applicable.
- C. AGENCY CONSULTED: Department of Education.
- D. GENERAL DESCRIPTION TECHNICAL, ECONOMIC, SOCIAL AND ENVIRONMENTAL CHARACTERISTICS:
1. Technical: This is to construct a new concrete and masonry, 2-story building, approximately 8,700 square feet in size.
 2. Economic: The estimated cost of the project is \$1,391,000. Since the project will be constructed within the existing school campus, no land will be removed from the tax base.
 3. Social: The project will provide the school with a much-needed facility to implement its program in accordance with the Educational Specifications.
 4. Environmental: The project will not create any major environmental impact.
- E. SUMMARY DESCRIPTION OF THE AFFECTED ENVIRONMENT, INCLUDING SITE MAPS: The location of Waialua Elementary School is shown in Figures 1 and 2, respectively (TMK 1st Division 6-07-01:10). The school site is almost completely developed with other buildings and facilities.
- F. DISCUSSION OF THE ASSESSMENT PROCESS: The following assessments are made to determine whether or not the anticipated effects constitute a "significant effect":
1. The proposed action will not involve an irrevocable commitment to loss or destruction of any natural or cultural resources.
 2. The proposed action will not curtail the range of beneficial uses of the environment.

3. The proposed action will not conflict with the State's long-term environmental policies.
4. The proposed action will not substantially affect the economic or social welfare of the community or State.
5. The proposed action will not involve substantial secondary impacts, such as population changes or effects on public facilities.
6. The proposed action will not involve a substantial degradation of environmental quality.
7. The proposed action will not substantially affect any rare, threatened or endangered species of flora or fauna or habitat. No endangered species of flora or fauna are known to exist in the project site.
8. The proposed action will not detrimentally affect air or water quality or ambient noise levels.
9. The proposed action will not be located in any environmentally sensitive area, such as flood plain, tsunami zone, erosion-prone area, geologically hazardous land, estuary, fresh water, or coastal waters.

G. SUMMARY OF MAJOR IMPACTS: From the above assessment, no major adverse environmental impact is anticipated. The project will result in the following minor adverse impacts:

1. Depletion of labor and material resources for construction.
2. Some dust, noise and silting during construction.

H. ALTERNATIVES CONSIDERED: The "no action" alternative was considered but deemed to be unacceptable.

- I. PROPOSED MITIGATION MEASURES: The temporary dust, noise and silting which would occur during construction will be controlled by application of appropriate pollution control measures.
- J. DETERMINATION: It is determined that an Environmental Impact Statement should not be required for this project.
- K. FINDINGS AND REASONS SUPPORTING DETERMINATION: The project site is generally free of flood, tsunami, erosion, and landslide hazards. No rare or endangered species of flora are known to exist at the site. No rare or endangered species of fauna are known to inhabit the site. There are no recorded archaeological or historical sites within the existing site.

For the reasons sited above, the proposed action will not have any significant effect in the context of Chapter 343, Hawaii Revised Statutes and Section 11-200-12 of the State Administrative Rules.

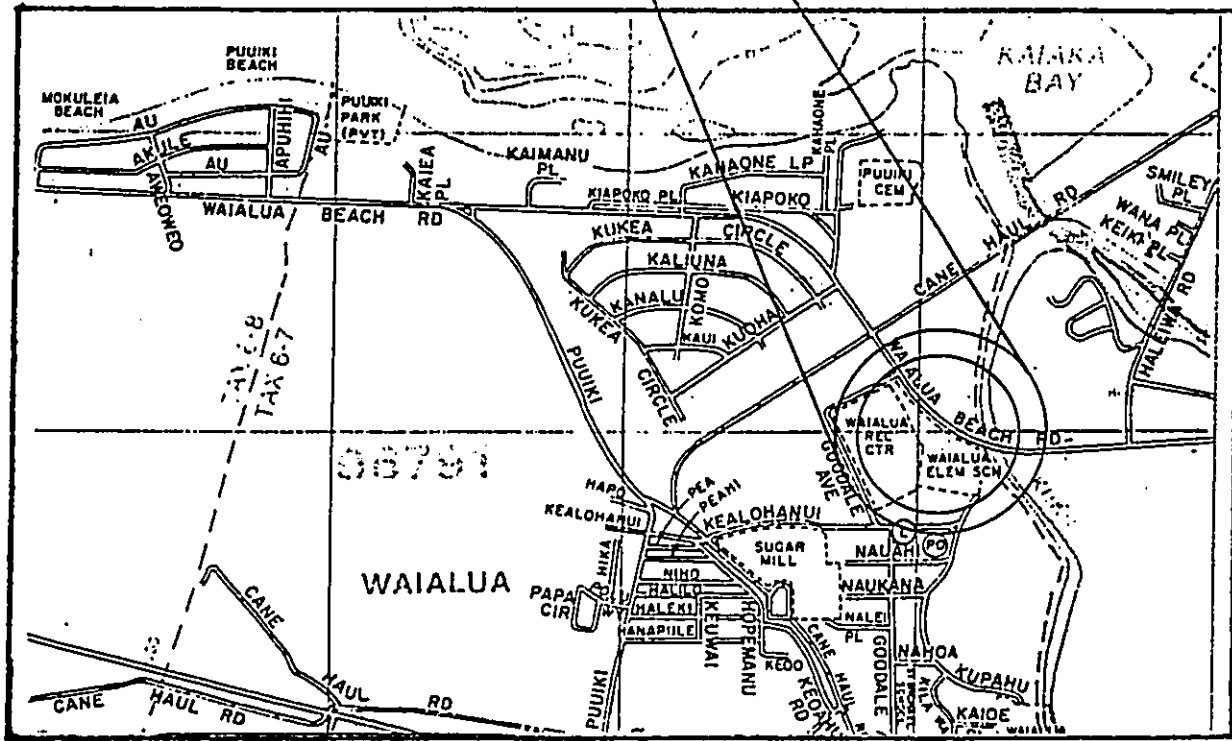
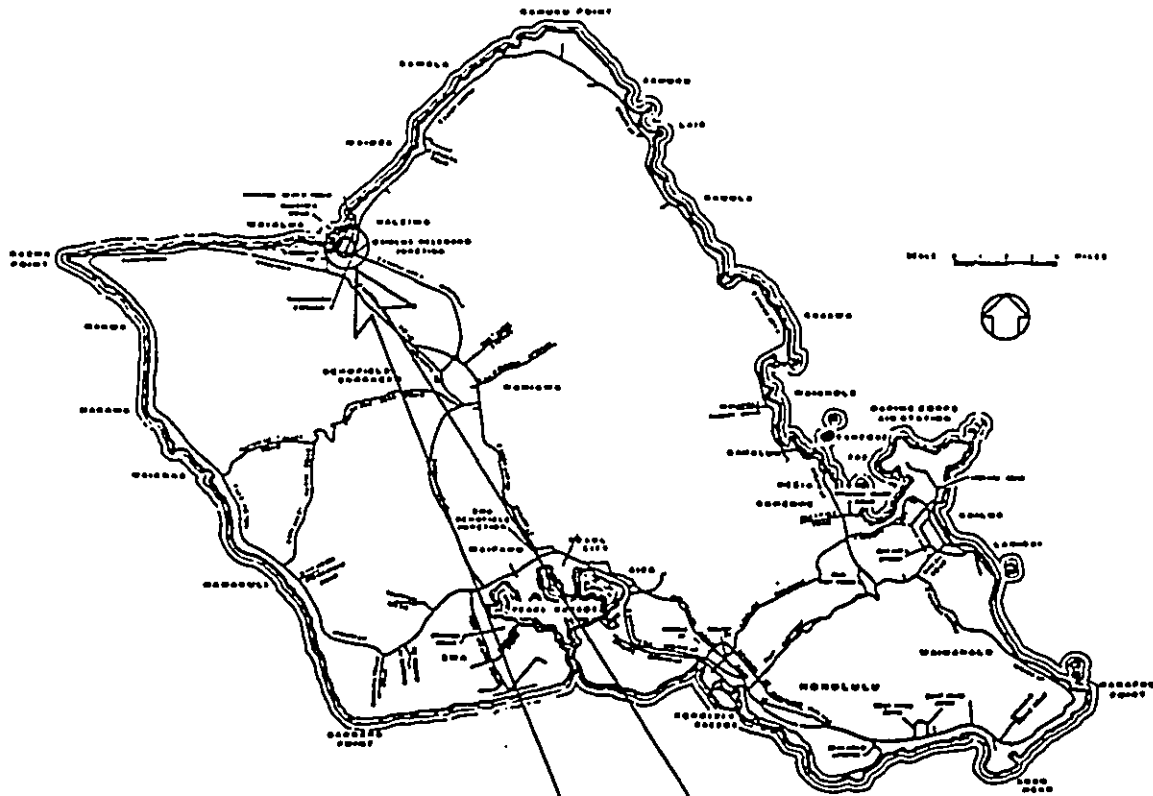

LOCATION MAP

FIGURE 1

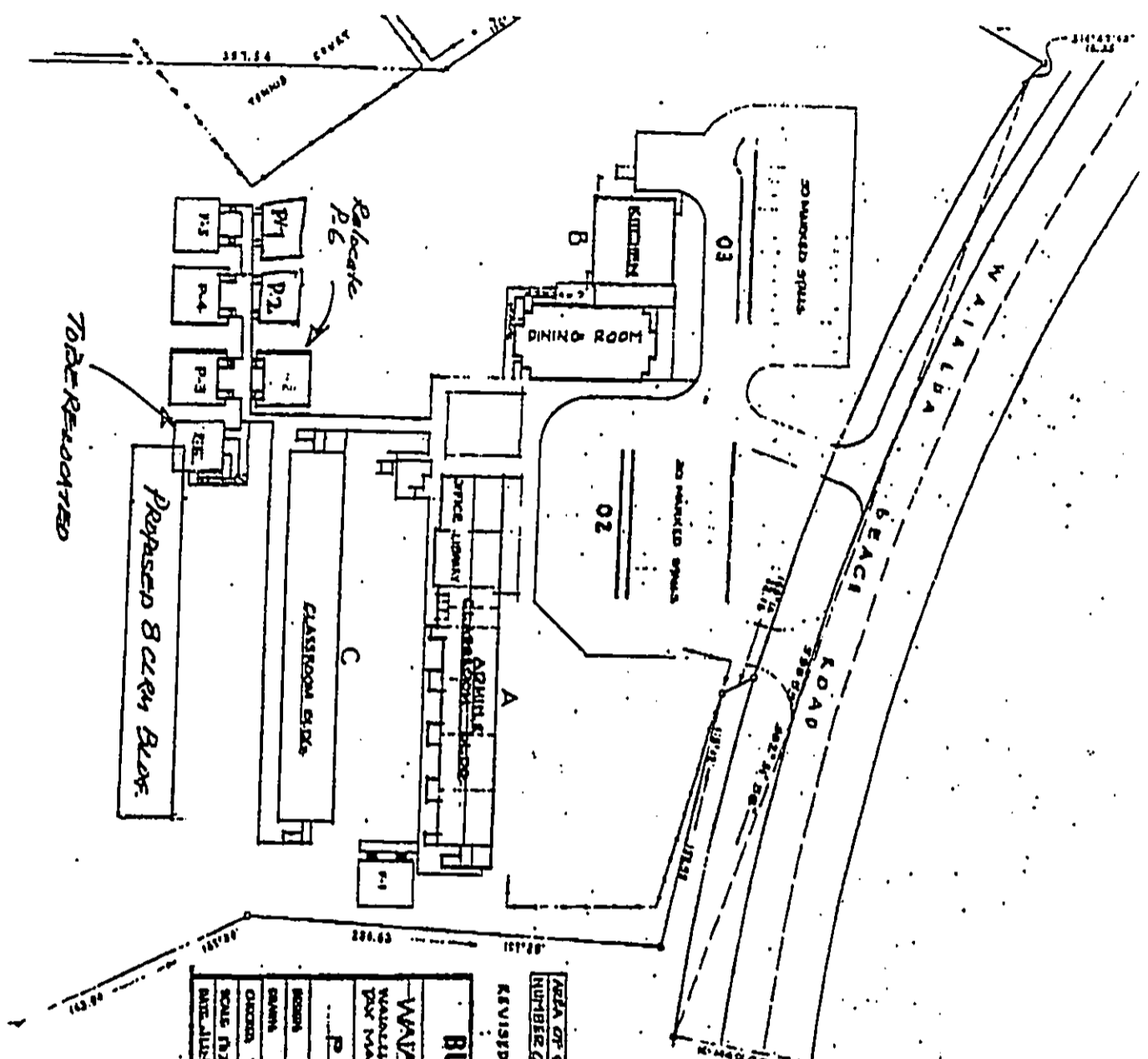

AREA OF SCHOOL: 5,311 sq. ft.
 NUMBER OF MARKED SPACES: 50

REVISED: MAR, 1965

BUILDING DEPARTMENT

WAVELIN ELEMENTARY SCHOOL
 CITY & COUNTY OF HOUSTON
 WASHINGTON ROAD
 DISTRICT NO. 7-01-10

PLANT PLAN

SECTION	NO.	DATE	BY	SCALE
00000	1	4-34		
00000	2			
00000	3			
00000	4			
00000	5			
00000	6			
00000	7			
00000	8			
00000	9			
00000	10			
00000	11			
00000	12			
00000	13			
00000	14			
00000	15			
00000	16			
00000	17			
00000	18			
00000	19			
00000	20			
00000	21			
00000	22			
00000	23			
00000	24			
00000	25			
00000	26			
00000	27			
00000	28			
00000	29			
00000	30			
00000	31			
00000	32			
00000	33			
00000	34			
00000	35			
00000	36			
00000	37			
00000	38			
00000	39			
00000	40			
00000	41			
00000	42			
00000	43			
00000	44			
00000	45			
00000	46			
00000	47			
00000	48			
00000	49			
00000	50			