

RECEIVED

'91 APR 23 A11:38

OFC. OF ENVIRONMENTAL  
QUALITY CONTROL

DEPARTMENT OF LAND UTILIZATION  
91/SV-003 (JSM)  
April 19, 1991

CHAPTER 343, HRS  
Environmental Assessment/Determination  
Negative Declaration

Recorded Owner : Sung Hi Lim and Sook Myeng Ahn Lim  
Applicant : Max Sung Hi Lim  
Location : 59779 Kam Highway, Haleiwa, Hawaii  
Tax Map Key : 5-9-04: 32  
Request : Construction of a 3' High Rock Wall  
to Protect Property Users from  
Vertical Drop-Off  
Determination : Environmental Impact Statement (EIS)  
Not Required

Attached and incorporated by reference is the environmental  
assessment prepared by the applicant for the project.

On the basis of the environmental assessment, we have determined  
that an Environmental Impact Statement is not required.

APPROVED

  
DONALD A. CLEGG

Director of Land Utilization

DAC:lg  
91/sv003/2

60

1991-05-08-0A - FEA - Max Sung Hi Lim Moss Rock Fence

'91 FEB 2 PM 3 US

FILE COPY

CITY AND COUNTY OF HONOLULU - DLU

SHORELINE SETBACK VARIANCE APPLICATION FOR MAX LIM

TO: Department of Land Utilization

RE: Environmental Assessment

I. General Information

A. Applicant: Max Sung Hi Lim

B. Address: 1525 Wilder Ave. 1008, Hon. Hi

Address of subject property: 59779 Kam Hwy, Sunset, Hi

C. Telephone: 949-1142

D. TMK: 5-9-04-32 Lot D

E Lot Area: 11,300 sq. ft.

F. Agencies Consulted: Building Department and Land Utilization Dept.

II. Description of Proposed Action: This application proposes the construction of a moss rock fence 3 feet high x 126 lineal feet on the north side of Lot D boundary line and entirely within the shoreline setback line (see rock fence plan and Tax Map submittal). This fence will provide protection from falling onto rocks 8 to 20 feet below property. (See picture 1)

III. Affected Environment:

The subject site has a one bedroom frame dwelling on it. This site is unique in that the entire flag portion projects out towards the ocean with no adjacent properties on either side, providing a wide vista. Also, the average ground elevation of the entire site is 20 feet or more over the mean sea level. (See pictures A & B)

This site is zoned R-5. Flood zone VE-X. Flood Hazard Elevation :

IV. Impact and Alternatives considered. NONE.

V. Mitigation Measures. NONE.

DOCUMENT CAPTURED AS RECEIVED



A

DOCUMENT CAPTURED AS RECEIVED



B

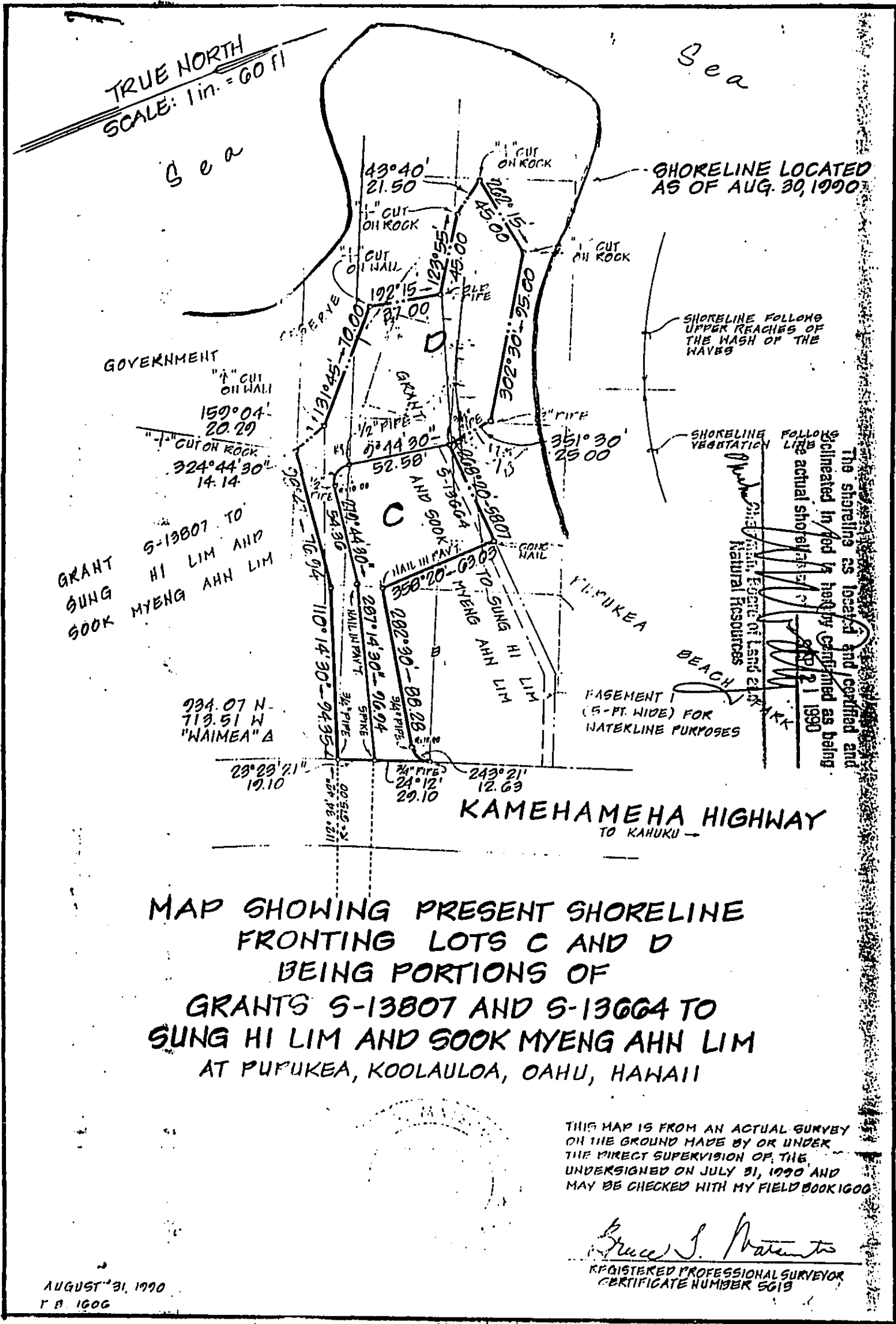

MAP SHOWING PRESENT SHORELINE FRONTING LOTS C AND D BEING PORTIONS OF GRANTS S-13807 AND S-13664 TO SUNG HI LIM AND SOOK MYENG AHN LIM AT PUPUKEA, KOOLAULOA, OAHU, HAWAII

THIS MAP IS FROM AN ACTUAL SURVEY ON THE GROUND MADE BY OR UNDER THE DIRECT SUPERVISION OF THE UNDERSIGNED ON JULY 31, 1990 AND MAY BE CHECKED WITH MY FIELD BOOK 1600

*Bruce S. Natus*  
 REGISTERED PROFESSIONAL SURVEYOR  
 CERTIFICATE NUMBER 5619

AUGUST 31, 1990  
 P.M. 1900

TAX MAP KEY: 5-9-04-32 R 13

PAREN, INC.  
 AND PARK ENGINEERING  
 KAWAIAO PLAZA SUITE 200  
 567 S KING ST HONOLULU HAWAII

0088 0

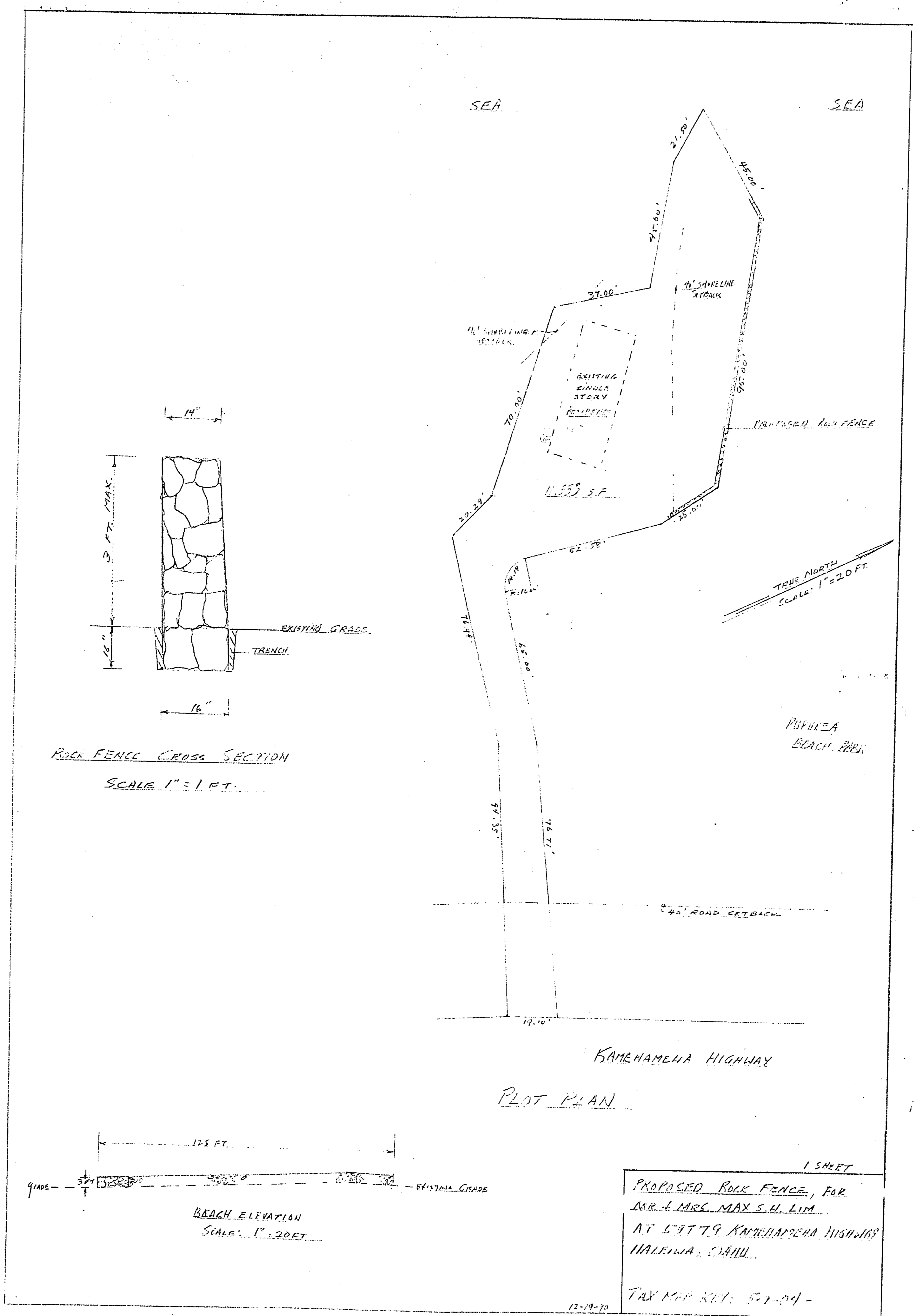

0088 0