

DEPARTMENT OF PUBLIC WORKS  
**CITY AND COUNTY OF HONOLULU**  
650 SOUTH KING STREET  
HONOLULU, HAWAII 96813

RECEIVED

'91 OCT -4 A11:55

SAM CALLEJO  
DIRECTOR AND CHIEF ENGINEER

OFC. OF ENVIRONMENTAL  
QUALITY CONTROL IN REPLY REFER TO:

91-11-0252

FRANK F. FASI  
MAYOR

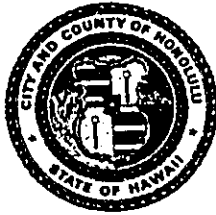

September 30, 1991

Mr. Brian J. J. Choy, Director  
Office of Environmental Quality Control  
220 South King Street, 4th Floor  
Honolulu, Hawaii 96813

Dear Mr. Choy:

Subject: Notice of Negative Declaration for the Kamooalii Stream  
Maintenance Ramps Near the End of Apuakea Street, Kaneohe,  
Oahu, Hawaii, Tax Map Key: 4-5-40

The Department of Public Works has reviewed the environmental assessment for the Kamooalii Stream Maintenance Ramp near the end of Apuakea Street, and has determined that the project will not have any significant impacts on the environment. Based on our determination, we are filing a Notice of Negative Declaration for this project.

Enclosed are four (4) copies of the Notice of Negative Declaration.

Please contact Jolie Nishikawa at 523-4041 with any questions you may have in regard to this matter. Thank you.

Very truly yours,

A handwritten signature in cursive script, appearing to read "Sam Callejo".

SAM CALLEJO  
Director and Chief Engineer

Encl.

177

1991-10-23-0A FEA

## FILE COPY

DEPARTMENT OF PUBLIC WORKS  
CITY AND COUNTY OF HONOLULU

NOTICE OF NEGATIVE DECLARATION

FOR THE

\* KAMOOALII STREAM MAINTENANCE RAMP

NEAR THE END OF APUAKEA STREET

KANEOHE, OAHU, HAWAII \*

TAX MAP KEY: 4-5-40

This document is prepared pursuant to Chapter 343, HRS.

PROPOSING AGENCY: DEPARTMENT OF PUBLIC WORKS  
CITY AND COUNTY OF HONOLULU  
650 SOUTH KING STREET  
HONOLULU, HAWAII 96813

RESPONSIBLE OFFICIAL:

C. Michael Street  
SAM CALLEJO  
Director and Chief Engineer

10/2/91  
DATE

PREPARED BY  
DIVISION OF ENGINEERING  
DEPARTMENT OF PUBLIC WORKS

**TABLE OF CONTENTS**

	<i>Page</i>
I. Description of Proposed Action and Statement of Objective	1
II. Description of Affected Environment	1
III. Agencies Consulted in Making this Assessment	2
IV. General Description of the Project's Technical, Economic, Social and Environmental Characteristics	2
V. Identification and Summary of Major Impacts	3
VI. Alternatives Considered	5
VII. Determination	5
VIII. Reasons for Supporting Determination	5
Appendix A - Location Map	
Appendix B - Site Map	
Appendix C - Plan	
Appendix D - Comments	

I. *DESCRIPTION OF PROPOSED ACTION AND STATEMENT OF OBJECTIVE*

The proposed project consists of construction of a maintenance access ramp into Kamooalii Stream from the embankment at the end of Apuakea Street (see Appendix B - Site Map). The project also includes construction of a 50 x 40 ft. concrete invert slab near the base of the ramp.

No vehicular access to the stream is presently available.

The proposed project will provide a permanent concrete access ramp to facilitate stream maintenance operations.

II. *DESCRIPTION OF THE AFFECTED ENVIRONMENT*

The proposed project is located in Kaneohe, Oahu, Hawaii (TMK: 4-5-40) along Kamooalii Stream near the end of Apuakea Street. The stream carries water from Hoomaluhia Dam down to Kaneohe Stream. The project area is approximately 12 miles from the State Capitol in Honolulu (see Appendix A - Location Map). The project area is zoned residential and there are subdivisions near the project site. The average annual rainfall in this area is 40 inches per year. The average temperature varies from 72.9 degrees to 79.1 degrees.

Kamooalii Stream is a perennial stream under State ownership with unimproved banks and invert in the project area. It provides a water habitat for aquatic species such as small freshwater fish, 'o'opu nakea, waterbirds, tadpoles, and insect and mosquito larvae. There is no vegetation in the stream near the project site.

Wildlife in the project area consists of the usual common birds found in built-up areas of Honolulu, and no rare or endangered species are known to frequent the lands adjacent to the proposed project.

There are no known archaeological or historical sites in the immediate project area. A search of the Hawaii Register of Historic Places indicates that the closest historical site is the Kukuipilau Heiau (Identification No. 80-11-372) located 5000+ feet east of the project site.

III. *AGENCIES CONSULTED IN MAKING THIS ASSESSMENT*

Copies of this assessment will be sent to the following agencies for review:

- A. City and County of Honolulu
1. Department of General Planning
  2. Department of Land Utilization

- B. State of Hawaii
  - 1. Department of Land and Natural Resources
  - 2. Department of Health
  - 3. Office of State Planning
- C. U.S. Government
  - 1. Department of Interior, Fish and Wildlife Service
  - 2. Department of the Army, Corps of Engineers
- D. Other
  - 1. Kaneohe Neighborhood Board No. 30
  - 2. RYM Kamooalii III Venture, Inc.

Appendix D contains comments on the environmental assessment. After two months of review time no comments were received from the Department of the Interior, Fish and Wildlife Service; Kaneohe Neighborhood Board No. 30; and RYM Kamooalii III Venture, Inc. The Department of Land and Natural Resources responded by telephone on September 24, 1991. The department had no comments on the environmental assessment and did not require an EIS.

**IV. GENERAL DESCRIPTION OF THE PROJECT'S TECHNICAL, ECONOMIC, SOCIAL AND ENVIRONMENTAL CHARACTERISTICS**

The construction of the maintenance ramp will entail the excavation of material from the stream embankment to provide a 11% ramp slope, construction of concrete retaining walls and ramp slab (see Appendix C - Plan). The ramp is to be approximately 200 feet in length.

No adverse hydraulic effects are expected to result from the construction of the new maintenance ramp because the cross-section of the stream will not be reduced.

The City will need to acquire an easement of approximately 200 square feet in order to construct the ramp.

The project has an estimated construction cost of \$200,000 exclusive of land rights. It is anticipated that construction will begin in the summer of 1992 and will take approximately 90 calendar days to complete. Capital Improvement Program funds will be utilized for the project.

The project will not require the displacement or relocation of any people.

A stream channel alteration permit for the construction of the maintenance ramp will be obtained from the State Department of Land and Natural Resources. An application will also be filed with the Department of Health (401 Water Quality Certification), Office of State Planning and U.S. Army Corps of Engineers.

V. **IDENTIFICATION AND SUMMARY OF MAJOR IMPACTS AND PROPOSED MITIGATION MEASURES**

The environmental impact of the proposed project will be limited to the construction phase and may include the following temporary, unavoidable, adverse environmental effects:

- A. **Dust and Noise Emission:** The discharge of dust into the atmosphere may occur during the construction period. This is, however, only a short-term effect on the environment. Dust will be reduced and controlled through the application of water and/or other appropriate methods. The specifications will contain provisions that will require the Contractor to prevent dust nuisance at all times and have sufficient equipment and manpower at the job site to accomplish this.

Noise will be generated by construction equipment such as backhoes and trucks. The increase in noise level by construction equipment cannot be avoided, but will be controlled and limited to normal working daylight hours. The Contractor will be required to obtain a Community Noise Permit pursuant to Chapter 43 of the State Public Health Regulations and shall comply with the provisions of Chapter 42, Vehicular Noise Control for Oahu. Individuals that may be adversely affected by the construction noises will be residents of the surrounding community. The sound level from equipment noise has been estimated for locations at various distances from the work area. The results may be summarized as follows:

	<u>Location</u>	<u>Distance from Project</u>	<u>Sound Level dBa</u>
1.	Nearest residence	50 feet	91 dB
2.	Nearest church	1,300 feet	63 dB
3.	Nearest school	2,200 feet	58 dB
4.	Nearest medical center	2,400 feet	57 dB
5.	Nearest playground	1,300 feet	63 dB
6.	Nearest library	5,000+ feet	51 dB

- B. **Water Pollution:** Construction will be scheduled during the dry season (summer months) and provisions will be made to divert or transfer water around the work area. This may be accomplished through the use of diversion ditches, pumps, sandbags, etc. This will minimize erosion and sedimentation during construction activities.

The Contractor will be required to properly dispose of wash and dust control water and to take other precautionary actions during the course of construction operations to preclude the discharge of petrochemical products from construction equipment into the stream.

Proper construction methods will be used to minimize disturbance to the stream bed, and prevent the entrance of debris and other deleterious materials into the water.

- C. **Archaeological Deposits:** Since the construction involves cutting back the stream bank in an unimproved stream, the possibility that archaeological deposits may be impacted has been recognized. The specifications will require the Contractor to contact the Historic Sites Section of the Department of Land and Natural Resources in the event that such deposits are encountered.
- D. **Disturbance to Marine Life:** Since construction will occur in the summer (low flow months) the fish and wildlife usage of the stream will be limited and the impact is not considered to be significantly adverse.

In view of the fact that Kamooalii Stream is perennial and unlined, the Contractor shall be required to construct the new concrete invert in sections, providing for some continuous flow of the stream around the worksite so that fish may traverse the site area.

## VI. *ALTERNATIVES CONSIDERED*

The following courses of action were considered: (1) no action, (2) a permanent maintenance ramp at another location, and (3) the proposed project.

**Alternative 1:** If no action is taken, it will be difficult to perform maintenance work in the stream due to lack of vehicular access.

**Alternative 2:** Construction of the ramp further downstream would require acquisition of private property and possible displacement of residents.

**Alternative 3:** Completion of the proposed project will enable maintenance personnel to more effectively maintain the channel using vehicles and motorized equipment. As a result, maintenance work may be done at a comparatively lower cost utilizing in-house forces. Construction of the ramp will also provide emergency access into the stream.

VII. *DETERMINATION*

After preparing an environmental assessment, we have determined that the proposed project will not have a significant impact on the environment, and an environmental impact statement will not be prepared.

VIII. *REASONS FOR SUPPORTING DETERMINATION*

Based on the criteria, the policies, guidelines, and provisions of Chapters 342, 343, and 344, HRS, the reason supporting the Negative Declaration determination is that the proposed project will not:

- affect rare or endangered species of flora or fauna.
- affect any natural or cultural resources.
- conflict with existing land use and development plans.
- affect undeveloped lands.
- have significant long term effect on air quality, water quality or ambient noise levels.
- displace any residences or businesses.
- be located in close proximity to any known natural, historic, or archaeological sites.



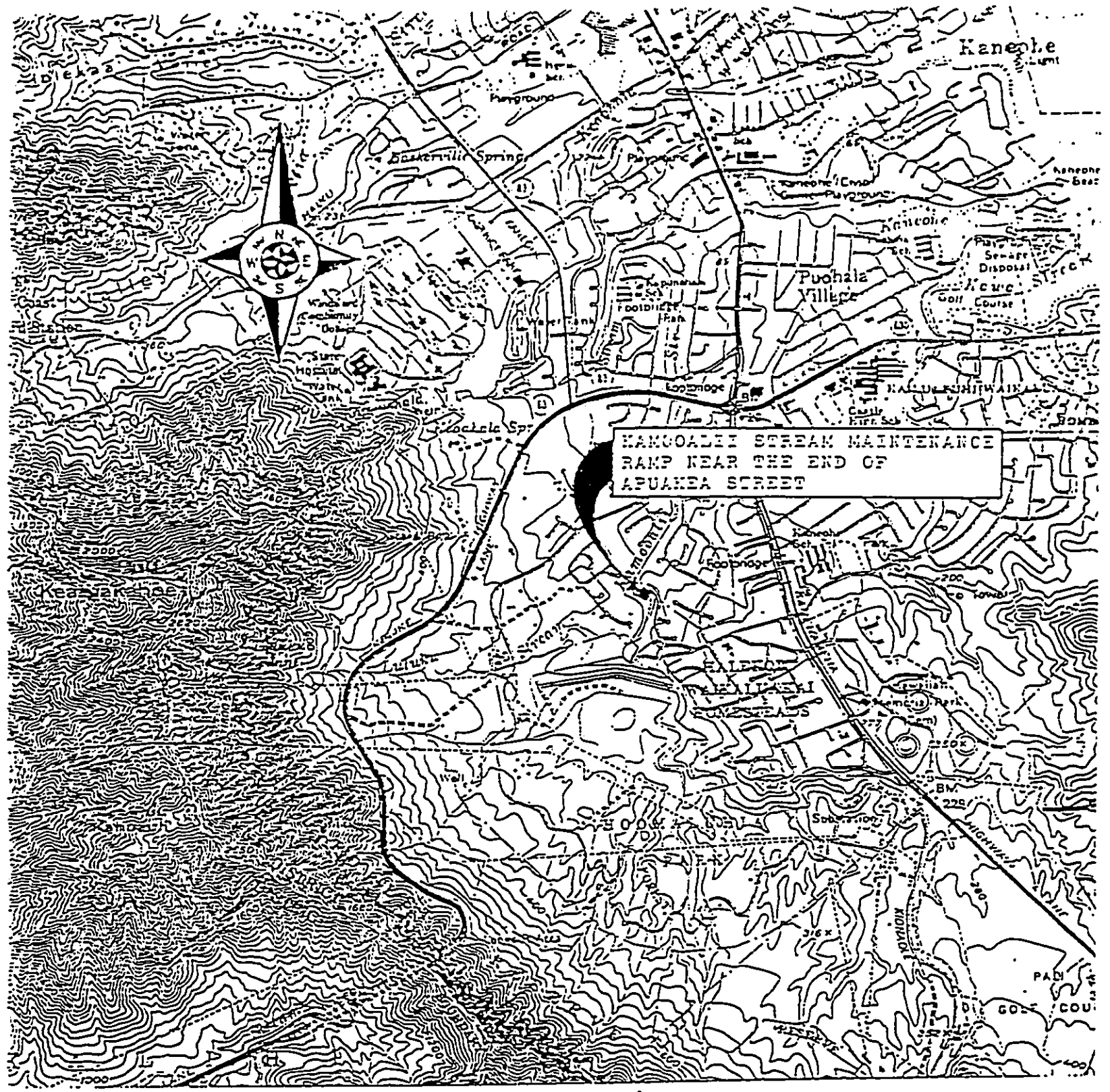

APPENDIX A  
LOCATION MAP

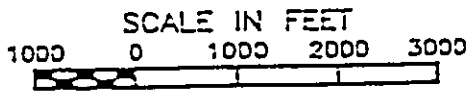



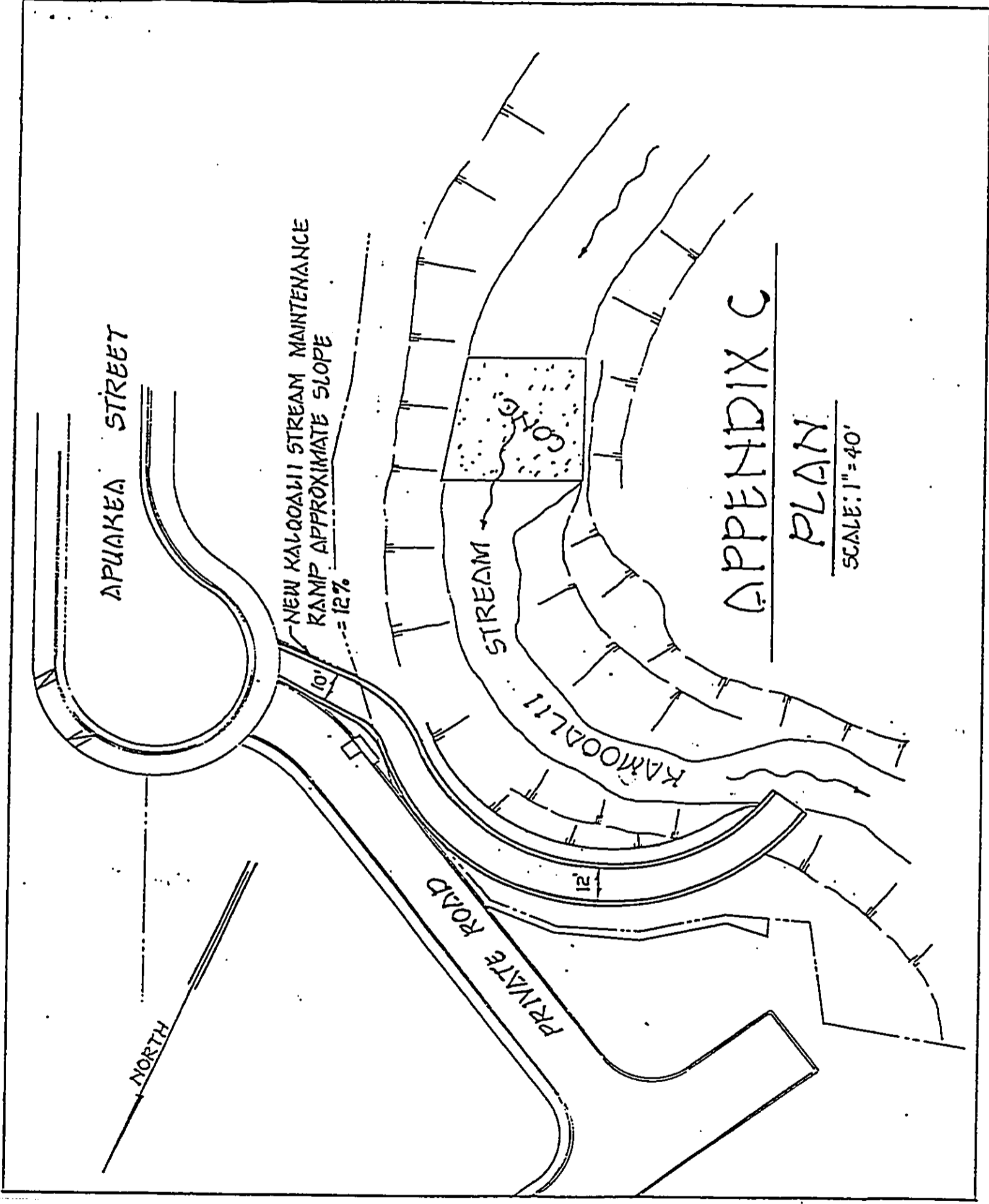

APPENDIX D  
COMMENTS

DEPARTMENT OF GENERAL PLANNING  
CITY AND COUNTY OF HONOLULU 91-3380  
RECEIVED  
DIV. OF ENGINEERING  
450 SOUTH KING STREET  
HONOLULU, HAWAII 96813  
AUG 27 3 18 PM '91

FRANK FASI  
MAYOR



*Eugen*  
BENJAMIN B. LEE  
CHIEF PLANNING OFFICER  
ROLAND D. LIBBY, JR.  
DEPUTY CHIEF PLANNING OFFICER

ET

August 22, 1991

MEMORANDUM

*Sam*  
TO: SAM CALLEJO, DIRECTOR AND CHIEF ENGINEER  
DEPARTMENT OF PUBLIC WORKS  
FROM: BENJAMIN B. LEE, CHIEF PLANNING OFFICER  
DEPARTMENT OF GENERAL PLANNING  
SUBJECT: ENVIRONMENTAL ASSESSMENTS FOR STREAM MAINTENANCE  
RAMPS FOR KAMOOALII, KANEOHE, KEAAHALA, MANOA-PALOLO  
AND NIU STREAMS, OAHU, HAWAII

This is in response to your letters of July 31, 1991 requesting comment on the Environmental Assessments for stream maintenance ramps along:

- Kamooalii Stream Maintenance Ramp near the end of Apuakea Street
- Kaneohe Stream Maintenance Ramp at Kamehameha Highway
- Keaahala Stream Maintenance Ramp at Kamehameha Highway
- Manoa-Palolo Stream Maintenance Ramp at Koali Road
- Niu Stream Maintenance Ramp Velocity Drops

The anticipated impacts of each of the proposed actions, based on their respective environmental assessments (EA) are not significant enough to warrant preparation of an Environmental Impact Statement (EIS) as determined by the criteria of Section 11-200-12 of the EIS Rules. We, therefore, concur with your determination of a negative declaration for these projects.

Sam Callejo  
August 22, 1991  
Page 2

We suggest, however, that these projects include landscaping, such as hedges or vines, to soften the appearance of chain link fencing surrounding the improvements where they occur within residential or high visibility areas. In addition, the use of black-painted chain link fabric is also recommended to increase transparency of the fencing.

Thank you for the opportunity to comment on these EA's. Should you have any questions, please contact Eugene Takahashi at 527-6022.



BENJAMIN B. LEE  
Chief Planning Officer

BBL:ft

DEPARTMENT OF LAND UTILIZATION  
CITY AND COUNTY OF HONOLULU

91-3122

650 SOUTH KING STREET  
HONOLULU 1, HAWAII 96813 • (808) 523-4432

RECEIVED  
DIV. OF ENGINEERING  
AUG 9 11 29 AM '91

*Eugene*  
DONALD A. CLEGG  
DIRECTOR

LORETTA K. C. CHEE  
DEPUTY DIRECTOR

LU 8/91-6424 (DJK)  
LU 8/91-6425  
LU 8/91-6426  
LU 8/91-6427

FRANK F. FASI  
MAYOR



August 8, 1991

TO: SAM CALLEJO, DIRECTOR AND CHIEF ENGINEER  
DEPARTMENT PUBLIC WORKS

FROM: DONALD A. CLEGG, DIRECTOR

SUBJECT: SPECIAL MANAGEMENT AREA REVIEW

Tax Map Keys : 3-7-7: 56, 4-5-15: 21, 4-5-18, 4-5-40  
Type of Projects : Niu Stream Maintenance Ramps,  
Keaahala Stream Maintenance Ramp,  
Kaneohe Stream Maintenance Ramp, and  
the Kamooalii Stream Maintenance Ramp

The proposed projects on the referenced tax map keys have been reviewed. We find that they:

- Are not within the Special Management Area.
- Are within the Special Management Area, but are not defined as "development" and are therefore, exempt (Exemption No. \_\_\_\_).

Should you have any questions, please contact the Environmental Affairs Branch at 523-4077.

*for* *Arthur Chalacome*  
DONALD A. CLEGG  
Director of Land Utilization

DAC:dk

JOHN WAIHEE  
GOVERNOR OF HAWAII

RECEIVED  
DIV. OF ENGINEERING  
SEP 20 2 22 PM '91



RECEIVED  
DEPT. OF PUBLIC WORKS  
SEP 19 2 24 PM '91

91-3717  
JOHN C. LEWIN, M.D.  
DIRECTOR OF HEALTH

STATE OF HAWAII  
DEPARTMENT OF HEALTH  
P. O. BOX 3378  
HONOLULU, HAWAII 96801

TO \_\_\_\_\_  
GPO DIV/DEPT 9/10/91  
Eng  
In reply, please refer to:  
File: EMD/CWB

September 9, 1991

Ref Nos. 91-3-276X  
91-3-278X  
91-3-279X  
91-3-280X  
91-3-281X

C0903WW

Mr. Sam Callejo  
Director and Chief Engineer  
Department of Public Works  
City and County of Honolulu  
650 South King Street  
Honolulu, Hawaii 96813

Dear Mr. Callejo:

Subject: City and County of Honolulu/Department of Public Works  
Environmental Assessments for Maintenance Ramps at:  
Kamooalii Stream (near end of Apuakea Street), Kaneohe, Oahu (TMK: 4-5-40)  
Kaneohe Stream (at Kamehameha Highway), Kaneohe, Oahu (TMK: 4-5-18)  
Kealahala Stream (at Kamehameha Highway), Kaneohe, Oahu (TMK: 4-5-15:021)  
Niu Stream (at Velocity Drops), Honolulu, Oahu (TMK: 3-7-7:056)  
Manoa-Palolo Stream (at Koali Road), Honolulu, Oahu (TMK: 2-8-27)

The Department of Health has reviewed the Environmental Assessments transmitted with your letter of July 31, 1991, for the stream maintenance ramps listed above and has the following comments:

1. The City and County of Honolulu should contact the U.S. Army Corps of Engineers (COE) to determine whether Section 404 permits are required for the construction of maintenance ramps in the Kamooalii, Kaneohe, and Manoa-Palolo Streams. In the event that a Section 404 permit is required for any of these projects, please contact the Clean Water Branch of the State Department of Health to apply for a Section 401 Water Quality Certification (WQC).
2. Due to existing stream improvements in the Kealahala and Niu Streams, construction of these maintenance ramps would be authorized under the General Permit by the U.S. Army COE and would not require a Section 401 WQC from the State Department of Health.



DOCUMENT CAPTURED AS RECEIVED

Mr. Sam Callejo  
C0903WW  
September 9, 1991  
Page 2

If you have any questions on this matter, please contact Mr. Walter West of the Engineering Section, Clean Water Branch, at 543-8309.

Very truly yours,



JOHN C. LEWIN, M.D.  
Director of Health

DOCUMENT CAPTURED AS RECEIVED



**OFFICE OF STATE PLANNING**

Office of the Governor

STATE CAPITOL, HONOLULU, HAWAII 96813 TELEPHONE (808) 548-5803

Ref. No. P-2269

RECEIVED  
AUG 22 11 32 AM '91

91-3312

*Luigi*

August 19, 1991

The Honorable Sam Callejo  
Director and Chief Engineer  
Department of Public Works  
City and County of Honolulu  
650 South King Street  
Honolulu, Hawaii 96813

Dear Mr. Callejo:

Subject: Environmental Assessments for Stream Maintenance Ramps at  
Kamooalii, Keahala and Kaneohe Streams, Kaneohe, Oahu

We have reviewed the Environmental Assessments for the above-referenced projects and have the following comments. A Coastal Zone Management Program objective is to protect coastal ecosystems from disruption and minimize adverse impacts on all coastal ecosystems. In 1990, the Legislature recognized Kaneohe Bay as a unique ecosystem and established a task force to make recommendations to the Governor and Legislature to regulate its use. We are concerned that the construction of the maintenance ramps within the streams, two of which are perennial, may have adverse impacts on the water quality of the bay. The assessment does not adequately describe the methods the contractor will be using to prevent pollution of the nearshore waters. Strong efforts should be made to prevent silt, construction debris, etc., from flowing downstream and entering Kaneohe Bay. The assessment should be expanded to thoroughly discuss additional stream diversion methods and erosion control measures.

The Hawaii Stream Assessment, draft 1990, by the Department of Land and Natural Resources and the National Park Service, indicates that Kaneohe Stream contains 'o'opu nakea. The study also indicates that Kaneohe Stream has wetlands and is frequented by waterbirds. The Environmental Assessment does not indicate this information. The assessment should discuss the impacts this proposal may have on the aquatic and other resources in a comprehensive manner.

Thank you for allowing us the opportunity to comment on these assessments. If you have any questions, please contact the Coastal Zone Management Program at 548-3961.

Sincerely,

*Harold S. Masumoto*  
Harold S. Masumoto  
Director

cc: Office of Environmental Quality Control

91-11-0216

August 29, 1991

Mr. Harold S. Masumoto, Director  
Office of State Planning  
Office of the Governor  
State Capitol  
415 South Beretania Street  
Honolulu, Hawaii 96813

Dear Mr. Masumoto:

Subject: Your Letter of August 19, 1991 Regarding the Environmental Assessments for Stream Maintenance Ramps at Kamooalii, Keaahala and Kaneohe Streams. Ref. No. P-2269

We appreciate your comments and concerns regarding the proposed project. Your comments have been taken into consideration and we will take all reasonable precautions to preclude adverse impacts on water quality.

The presence of 'O'opu Nakea and waterbirds will be mentioned in the environmental assessments for these streams. In addition, the project specifications will provide for continuous flow of water around the project site during construction to facilitate movement of aquatic species.

Please contact Jolie Nishikawa at 523-4041 with any further questions or comments you may have.

Very truly yours,

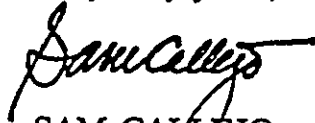

SAM CALLEJO  
Director and Chief Engineer

JN:RN:HK:tt



DEPARTMENT OF THE ARMY  
U. S. ARMY ENGINEER DISTRICT, HONOLULU  
FT. SHAFTER, HAWAII 96858-5440

91-3289

06 AUG 1991

RECEIVED  
DEPT OF THE ARMY  
AUG 7 2 23 PM '91  
EWJ/ah  
ENG

REPLY TO  
ATTENTION OF  
Operations Division

Mr. Sam Callejo  
Director and Chief Engineer  
Department of Public Works  
City and County of Honolulu  
650 S. King Street  
Honolulu, Hawaii 96813

RECEIVED  
DIV. OF ENGINEERING  
AUG 8 8 19 AM '91

Dear Mr. Callejo:

In response to your July 31, 1991 letters, we have reviewed the environmental assessments prepared for construction of maintenance ramps at Manoa-Palolo Streams, Kamooalii Stream, and Kaneohe Stream. The streams at the locations of the ramps are perennial and unimproved.

Department of the Army (DA) permits are required for all three projects, subject to processing as individual permits. DA permit applications must be submitted for the three projects. Your application should include complete project descriptions, drawings of the location, plan, and typical sections and environmental assessments for each project. The assessment should address the permanent conversion of portions of the unimproved, natural stream invert into concrete-lined sections. Finally, the quantities of material to be excavated and to be placed for the concrete sections should be included.

Since the actions are similar, but in different locations, you may want to submit a joint application for all three projects to be processed at the same time. File No. PO91-198 has been assigned to these projects. Please refer to this number in future correspondence. If you have any questions on the information required, please contact Ruby Mizue at 438-9258.

Sincerely,

*Stanley T. Arakaki*  
Stanley T. Arakaki  
Chief, Operations Division