

JOHN WAIHEE  
GOVERNOR



STATE OF HAWAII  
DEPARTMENT OF EDUCATION  
OFFICE OF THE DISTRICT SUPERINTENDENT  
HAWAII SCHOOLS  
P.O. BOX 4160  
HILO, HAWAII 96720-0160

CHARLES T. TOGUCHI  
SUPERINTENDENT

DR. ALAN L. GARSON  
DISTRICT SUPERINTENDENT

October 25, 1991

RECEIVED  
'91 OCT 29 A9:13  
OFC. OF ENVIRONMENTAL  
QUALITY CONTROL

Mr. Brian J. J. Choy, Director  
Office of Environmental Quality Control  
Central Pacific Plaza  
220 South King Street, 4th Floor  
Honolulu, Hawaii 96813

Dear Mr. Choy:

Re: Request for Negative Declaration  
Environmental Assessment  
Kamehameha Schools Preschool  
Keaukaha Elementary School

Attached are four (4) copies of the Request for Negative Declaration, Environmental Impact for two portable buildings to be constructed at Keaukaha School.

The portable buildings are being constructed by Kamehameha Schools to be used as a classroom for the Pre-Kindergarten Education Program (PREP) and an office to house the Kamehameha Elementary Education Program (KEEP). The site is on the campus of the Keaukaha Elementary School in Hilo.

As noted in the Negative Declaration, the proposed facilities will provide space for 20 four year old preschoolers as well as office space for six KEEP staff members. The program was instituted in 1981 and was created to improve reading and language arts skills for Hawaiian children enrolled in Hawaii's public schools.

Attached also are supporting documents from the Hawaii District Office of the Department of Education and from the principal of Keaukaha School.

The Department of Education has reviewed the environmental assessment for the proposed facilities and has determined that the project will not have any significant impact on the environment. Accordingly, it is requested that the Negative

Mr. Brian J. J. Choy  
October 25, 1991  
Page 2

Declaration be processed by your agency to enable the construction of the proposed facilities to commence.

Your cooperation and assistance in this matter is most sincerely appreciated. Please call me at 933-4201 should you have any questions.

Sincerely,

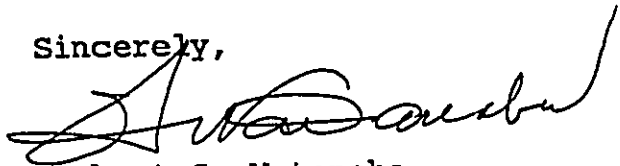

Herbert S. Watanabe  
District Business Specialist

HSW/ekc

Attachments

c: Edward Harada  
Denise Johnson  
Oda/McCarty Architects

1991-11-08-111-FEA

REQUEST for NEGATIVE DECLARATION  
ENVIRONMENTAL IMPACT  
\* KAMEHAMEHA SCHOOLS PRESCHOOL/KEEP PORTABLE BUILDINGS  
KEAUKAHA ELEMENTARY SCHOOL \*

Proposing Agency: Kamehameha Schools/Bishop Estate

Agencies Consulted:

State: Department of Education  
Department of Social Services & Housing  
County: Hawaii County Planning Department

Project Characteristics

General: The Kamehameha Schools/ Bishop Estate is proposing building two portable buildings to be used as a classroom for the Pre-Kindergarten Education Program (PREP) and an office to house the Kamehameha Elementary Education Program (KEEP). The proposed site is on the campus of the Keaukaha Elementary School in Hilo. The construction of these two portables will provide office space for six KEEP staff members and a classroom for twenty four-year old preschoolers, one teacher and one aide. This facility will serve the teachers, children and families in the adjacent community.

The Kamehameha Elementary Education Program was created to assist teachers in improving reading and language arts achievement of Hawaiian children enrolled in Hawaii's public schools. KEEP has been at Keaukaha Elementary School since 1981, training and supporting teachers in language arts instruction. The program also provides many additional resources to students such as classroom libraries and curriculum materials. KEEP is in partnership with the

Department of Education to increase educational opportunities for Hawaiian children. The program has been provided housing by the DOE as long as facilities were available. Due to the recent increase in enrollment at Keaukaha School the DOE is no longer able to provide the KEEP and PREP programs with facilities. Because KEEP staff work directly in the Keaukaha classrooms, being located on campus is vital to the success of the program.

The Pre-Kindergarten Education Program (PREP) consists of three components designed to meet the needs of Hawaiian preschool children and their families. The program has a home visiting component, a traveling preschool component and a center-based preschool for four-year olds. The proposed facility will include a classroom for the center-based preschool program. There has been overwhelming support from the Keaukaha community to have this preschool on campus. (See attached petitions and list of applicants). It would also be in partnership with the Department of Education in working toward the State's goal of providing universal education for four-year olds.

**Project Location:** See attached drawings

**Technical:** The proposed buildings consist of two portable classroom buildings that provide 896sf each for the preschool and the KEEP offices. They will be located parallel to Baker Avenue as shown on the enclosed drawings.

Two restrooms will be provided for the preschool

students. A single restroom is provided for the KEEP office. Waste for these restrooms will be collected in a septic tank for eventual disposal in a leaching field. Seven paved parking stalls will be constructed on the schools grounds to serve staff needs.

The areas around the new buildings and waste disposal field will be regrassed after construction is completed.

**Economic:** Costs for constructing the facility will be paid entirely by Kamehameha Schools/Bishop Estate. There will be no tuition charged to the preschool students by Kamehameha. This will provide educational opportunities for many children in the community who's parents could otherwise not afford to send their children to preschool.

**Social:** The KEEP and PREP programs are targeting Hawaiian/part-Hawaiian students in Doe schools that have the lowest rates of academic achievement. Both programs are designed to increase educational opportunities for these students. The PREP program will provide preschool education for many children in Keaukaha who would otherwise enter kindergarten without any preschool experience. There is one other preschool located in Keaukaha but because of tuition costs, very few children from the Keaukaha community are able to attend this school. The KEEP program has support at the State, District, school and community levels. It provides not only training and classroom support for teachers but it also provides extra resources for the school. (See attached letter).

The Keaukaha Community has expressed a strong desire to have the Kamehameha Pre-Kindergarten Education Program based at Keaukaha Elementary School. PREP's initial admissions process had thirty-six applicants for twenty openings at the preschool. (See attached list of applicants).

The portable buildings will house both programs that will serve the needs of the children in the appropriate setting of the elementary school campus. By linking the preschool activities with the elementary programs at the school a continuity will be developed with an emphasis on educational opportunities from the earliest ages.

**Environmental:** The facility will provide off street parking for all staff. There would be a possible increase in traffic on Baker Ave. due to student drop off. Many students are siblings of children already attending Keaukaha Elementary School, so this problem will be minimal.

There would be no additional load on existing sewers as the design includes a separate treatment facility.

The architectural design is similar to the existing school buildings. The proposed structure would be less aesthetically pleasing than the present green grass that covers the lot. However, the aesthetic impact would be minimized by the small size of the buildings and the replacing of grass wherever possible.

**Summary of the affected environment:**

The proposed facility is located on a vacant plot of land covered by grass, that is not presently used by Keaukaha

Elementary School. There are no endangered fauna, critical habitats, historical/archaeological sites at the location of the proposed facility. The new buildings match the design of the existing school environment.

**Summary of major impacts**

**Short-term:**

During construction there will be some noise and dust.

**Long-term:**

There are no significant long-term impacts to the environment expected from this proposed facility.

**Water Quality:** No significant impact to the water quality is expected.

**Noise:** The noise from traffic would be very minimal. No significant noise impact is expected.

**Traffic:** A small increase in traffic is expected near the drop-off area of the facility. The increase however is expected to be minimal. No significant traffic impact is expected.

**Archaeological:** No significant archaeological impact is expected.

**Flora:** No significant impact on the flora is expected.

**Visual:** The proposed structure will be in keeping with the surrounding school buildings and environment.

**Alternatives considered:**

The "no-action" alternative was considered but deemed to be unacceptable because the benefits to the children and families of Keaukaha far outweigh any adverse impacts of the project.

**Proposed mitigation measure**

1. The temporary dust and noise which will occur during construction will be mitigated by application of appropriate pollution control measures.
2. Grass will be replaced after construction is completed.
3. Parents and students will be encouraged to walk to the facility whenever possible to minimize the impact caused by motor vehicles.



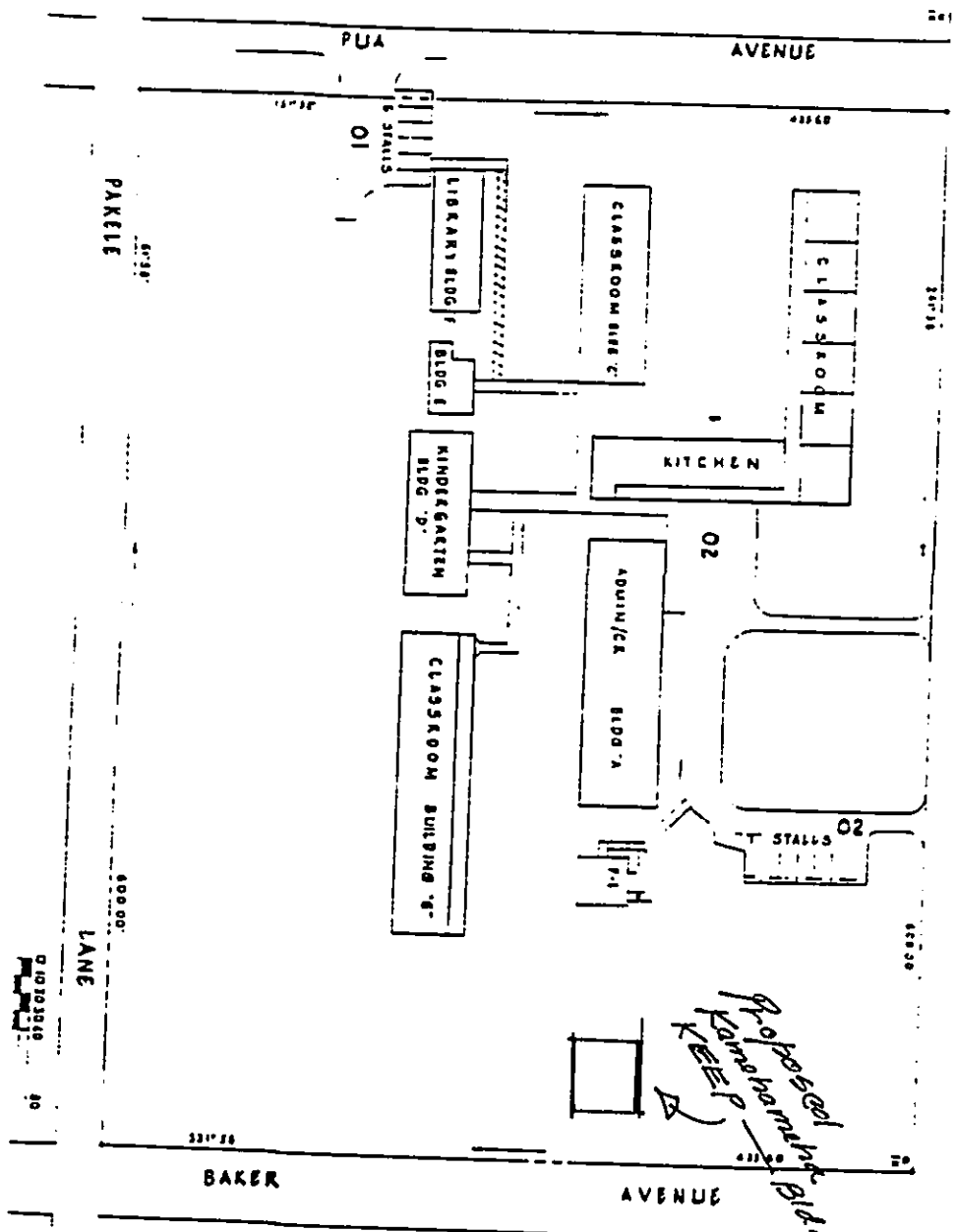

AREA OF SCHOOL		NUMBER OF STUDENTS		NUMBER OF TEACHERS	
DEPT. OF ACCOUNTING & GENERAL SERVICES					
KEAUKAHA ELEMENTARY SCHOOL					
HILLO, HAWAII					
700 WARD BLVD. 2-1-10-01					
2107 PLAN					
1-25					

REVISED DATE: 10/30  
 AREA OF SCHOOL  
 NUMBER OF STUDENTS  
 NUMBER OF TEACHERS