

1992-01-23-MA-FA - Kihei Elem. School - Classroom Bldg "F"  
Lokelani Inter. School - Classroom Bldg "G"

FILE COPY

NEGATIVE DECLARATION  
KIHEI ELEMENTARY AND LOKELANI INTERMEDIATE SCHOOL  
1/6/92

- A. PROPOSING AGENCY: Department of Accounting and General Services for the Department of Education.
- B. APPROVING AGENCY: Not applicable.
- C. AGENCY CONSULTED: Department of Education.
- D. GENERAL DESCRIPTION TECHNICAL, ECONOMIC, SOCIAL AND ENVIRONMENTAL CHARACTERISTICS:
1. Technical:
    - a. Lokelani Intermediate School. This is to construct a new 8-classroom building "G" which will be an approximately 14,000 square feet, two-story reinforced concrete and masonry building on the Lokelani Intermediate campus site.
    - b. Kihei Elementary School. This is to construct a new 8-classroom building "F" which will be an approximately 14,000 square feet, two-story reinforced concrete and masonry building on the Kihei Elementary campus site.
  2. Economic:
    - a. Lokelani Intermediate School. The estimated cost of the project is \$3,000,000. Since the project will be constructed within the existing school campus, no land will be removed from the tax base.
    - b. Kihei Elementary School. The estimated cost of the project is \$3,000,000. Since the existing project will be constructed within the existing school campus, no land will be removed from the tax base.
  3. Social: The project will provide the school with a much-needed facility to implement its program in accordance with the Educational Specifications.
  4. Environmental: The project will not create any major environmental impact.
- E. SUMMARY DESCRIPTION OF THE AFFECTED ENVIRONMENT, INCLUDING SITE MAPS: The classroom buildings are located as shown in figures 1 and 2. The proposed buildings will

be located in an area that had been previously graded during the construction of nearby structures.

F. DISCUSSION OF THE ASSESSMENT PROCESS: The following assessments are made to determine whether or not the following anticipated effects constitutes a "significant effect."

1. The proposed action will not involve an irrevocable commitment to loss or destruction of any natural or cultural resources.
2. The proposed action will not curtail the range of beneficial uses of the environment.
3. The proposed action will not conflict with the State's long-term environmental policies.
4. The proposed action will not substantially affect the economic or social welfare of the community or state.
5. The proposed action will not involve substantial secondary impacts such as population changes or effects on public facilities.
6. The proposed action will not involve a substantial degradation of environmental quality.
7. The proposed action will not substantially affect any rare, threatened, or endangered species of flora or fauna or habitat. No endangered species of flora or fauna are known to exist in the project site.
8. The proposed action will not detrimentally affect air or water quality or ambient noise levels.
9. The proposed action will not be located in any environmentally sensitive areas, such as flood plains, tsunami zones, erosion prone areas, geologically hazardous lands, estuaries, fresh waters or coastal waters.

G. SUMMARY OF MAJOR IMPACTS: From the above assessment, no major adverse environmental impact is anticipated. The project will result in the following minor adverse impacts:

1. Depletion of labor and material resources for construction.
2. Some dust, noise and silting during construction.

- H. ALTERNATIVE CONSIDERED: The "no action" alternative was considered but deemed to be unacceptable.
- I. PROPOSED MITIGATION MEASURES: The temporary dust, noise and silting which would occur during construction will be controlled by application of appropriate pollution control measures.
- J. DETERMINATION: It is determined that an Environmental Impact Statement should not be required for this project.
- K. FINDINGS AND REASONS SUPPORTING DETERMINATION: The project site is generally free of flood, tsunami, erosion, and landslide hazards. No rare or endangered species of flora are known to exist at the site. No rare or endangered species of fauna are known to inhabit the site. There are no recorded archaeological or historical sites within the existing site.

For the reasons sited above, the proposed action will not have any significant effect in the context of Chapter 343, Hawaii Revised Statutes and Section 11-200-12 of the State Administrative Rules.

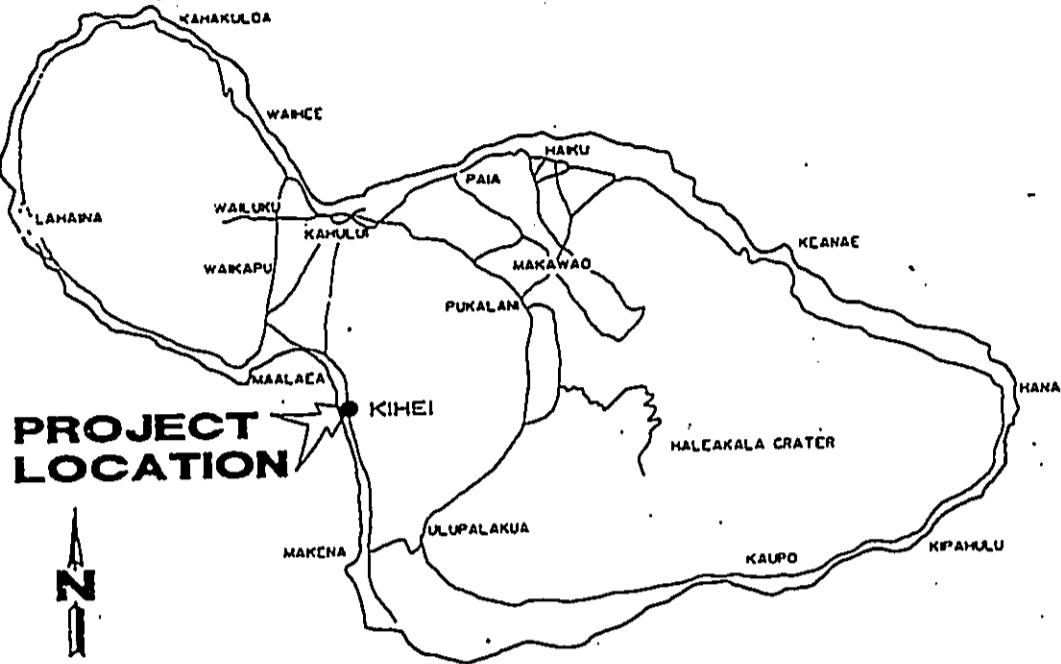

**ISLAND OF MAUI**



**PROJECT SITE**

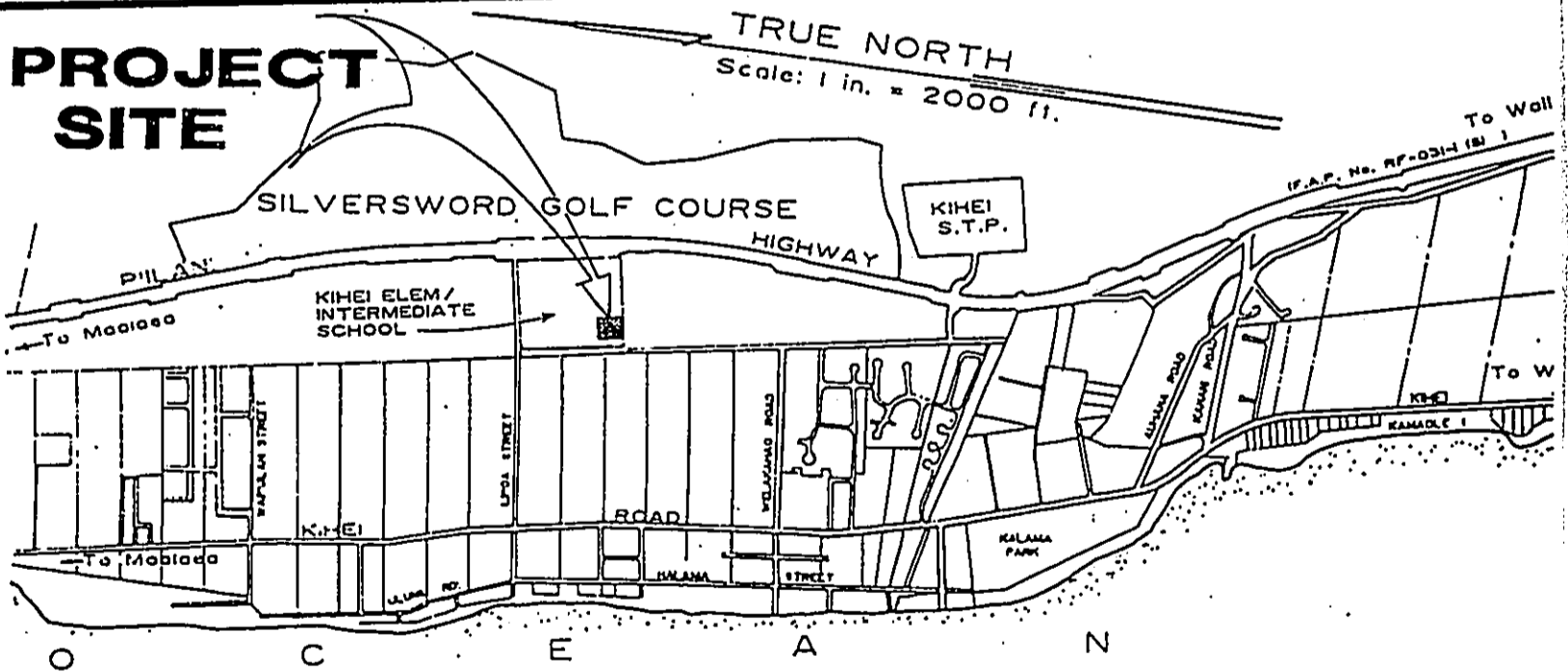

**PROJECT VICINITY MAP**

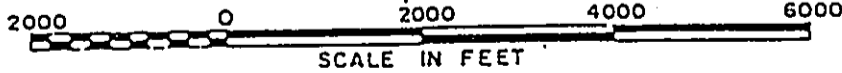
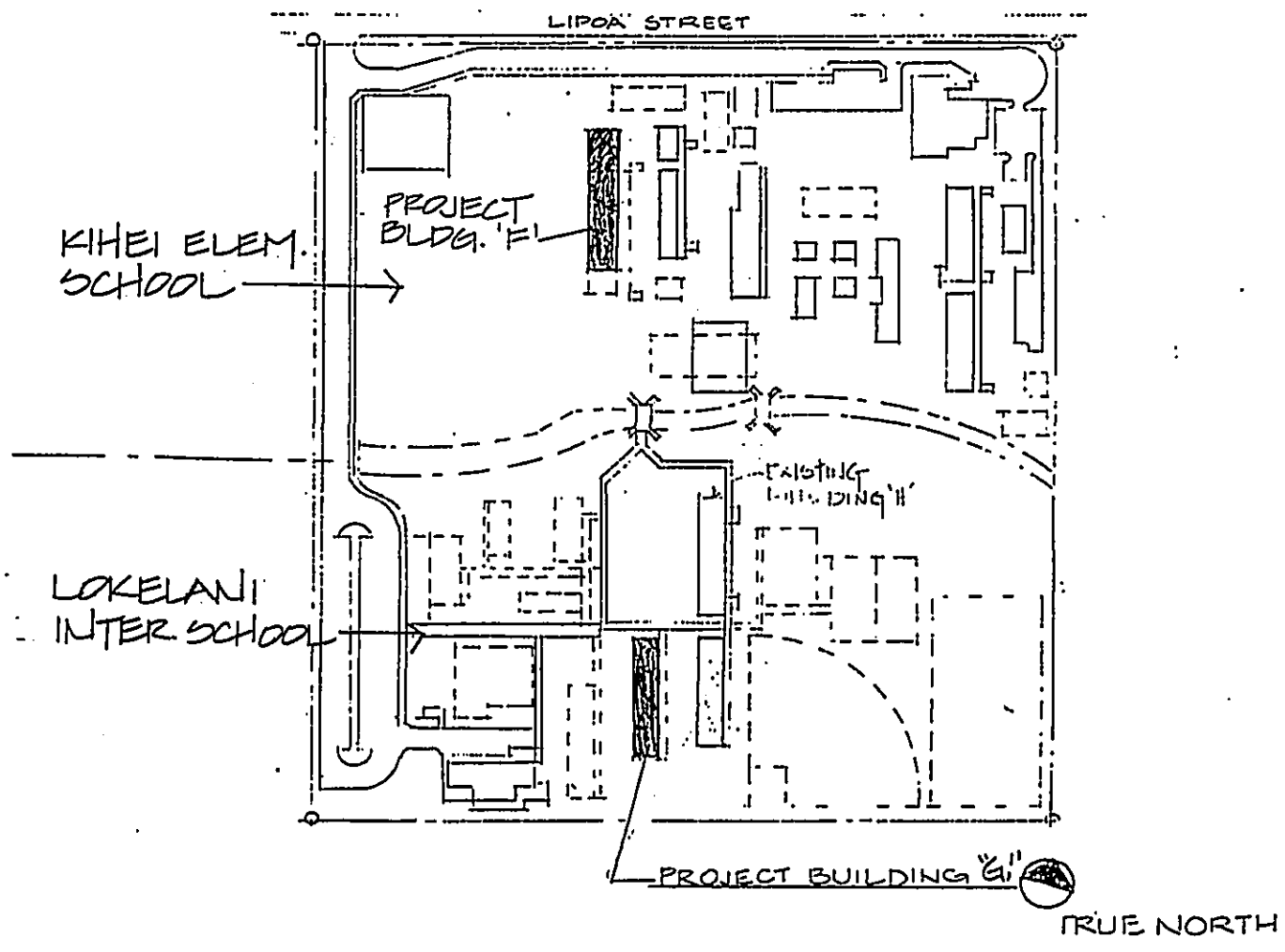

FIGURE 1



CAMPUS PLAN  
NOT TO SCALE

FIGURE 2