

JOHN WAIHEE
GOVERNOR



STATE OF HAWAII
DEPARTMENT OF DEFENSE
OFFICE OF THE ADJUTANT GENERAL
3949 DIAMOND HEAD ROAD, HONOLULU, HAWAII 96816-4495

Margaret R

EDWARD V. RICHARDSON
MAJOR GENERAL
ADJUTANT GENERAL

MYLES M. NAKATSU
COLONEL
DEPUTY ADJUTANT GENERAL

RECEIVED

March 16, 1992

'92 MAR 18 P1:54

Engineering Office

OFFICE OF ENVIRONMENTAL
QUALITY CONTROL

Mr. Brian J.J. Choy, Director
Office of Environmental Quality Control
220 South King Street
Fourth Floor
Honolulu, Hawaii 96813

Dear Mr. Choy:

Subject: Negative Declaration - Kauai Veterans Center

We have assessed the potential environmental impacts anticipated through the construction and operation of the proposed Kauai Veterans Center and have determined that significant adverse effects in the context of Chapter 343, Hawaii Revised Statutes and Section 11-200-12 of the State Administrative Rules will not result from this action. Therefore it has been determined that a negative declaration for this project will be filed.

Our EA/Negative Declaration document has been transmitted to you under separate cover. Thank you for your attention to this matter.

Sincerely,

A handwritten signature in cursive script that reads "Jerry M. Matsuda".

Jerry M. Matsuda
Lieutenant Colonel
Hawaii Air National Guard
Contracting and Engineering Officer

C:
S. Kato
Wil Chee Planning



1992-03-23-KA-PEA-Kauai Veterans Center

MAR 23 1992
MAR

NEGATIVE DECLARATION
KAUAI VETERANS' CENTER
FEBRUARY 27, 1992

Proposing Entity: Kauai Veterans' Council

Agencies Consulted: Department of Defense, State of Hawaii
Department of Land and Natural Resources
County of Kauai, Planning Department

Individuals Consulted: Mr. Susumu Kato, Project Architect
Mr. Caesar Portugal, Project Engineer
Lt. Colonel Jerry Matsuda, Hawaii National Guard,
Contracting and Engineering Officer
Kauai Veterans' Council
Mr. Edward Kawamura, President
Mr. William Fernandes
Mr. Brian K. Nishimura, Amfac/JMB,
Vice President and General Manager

Project Characteristics

General

The Kauai Veterans' Council proposes to construct the Kauai Veterans' Center in Kalapaki, Puna, Kauai. The veteran's center is intended to serve as the central headquartering facility for the Kauai Veteran's Council and its member organizations. The 2.0 acre site is located on a portion of TMK 3-6-02:1 approximately one mile northeast of the Lihue Airport. Situated on the northern side of Kapule Highway, the site is also located next to the proposed expansion site for the A. Vidinha Memorial Stadium.

The site is a portion of a larger 197 acre parcel and was donated to the Kauai Veterans Council by Amfac/JMB for the construction of the Veterans' Center. The remaining portion of the larger parcel is planned for a mixture of single family and multi-family residential development, park, public and other agricultural uses. The County General Plan indicates this area to be in the "Urban Mixed Use" designation. On October 24, 1991 the County of Kauai Planning Commission awarded a Use Permit (U-92-13), a Special Permit (SP-92-2), a Variance Permit (V-92-5) and a Class VI Zoning Permit (Z-IV-92-11) to allow the construction of the proposed project.

Technical

The Veteran's Center will total approximately 11,300 square feet and is designed to consist of the following primary spaces:

Assembly Hall	6718 sf.
Offices	368 sf.
Meeting Rooms	1957 sf.
Museum	1520 sf.
Library	247 sf.
Food Preparation	507 sf.

The building will measure 100 ft. X 138 ft. and will be 38 ft at its highest point on the roof. Exterior construction will consist of split and scored hollow tile blocks, clear and jalousie glazing, and metal roofing. A parking lot with 160 marked stalls will be provided. Access to the building and parking lot will be off Kapule Highway where a 48-foot landscaped buffer will front the property.

All utility hookups will be directed toward Kapule Highway where main lines are located.

Economic

Construction costs for the facility are estimated at approximately \$1.25 million. Funds for the project will be obtained from the State of Hawaii, Department of Defense in the form of grant-in-aid. The use of these funds will be for construction purposes only. Upon completion of construction, the Veterans' Center will be dedicated to the Kauai Veterans Council for its management and use. All subsequent operational and management costs will be borne by the Council.

No projections for operation and management fundings are currently available. However it is the stated intent of the Veterans' Council to operate the facility through its own budget, and only charge appropriate nominal fees for use by its member organizations and the general public.

Social

The principal intent of the Kauai Veterans' Center is to provide a facility for use by member organizations of the Kauai Veteran's Council. They include:

- Disabled American Veterans
- American Legion
- Veterans of Foreign Wars
- Club 100
- 442 Battalion
- Military Intelligence Service (MIS)
- Military Order of Purple Heart
- Kauai Veterans' Club
- Kauai Vietnam Era Veterans' Association
- Kauai Merchant Marines
- Kauai Military Women's Auxiliary

The Center will provide meeting and workshop space for the variety of veterans services. It will provide a permanent home for the Council's community service programs, youth and educational activities its membership conducts. A repository for memorabilia collected and donated by veterans, and a showplace (museum) for display of these items is also a vital part of the plan for the facility.

On a secondary basis, the Veteran's Center will serve an unmet need for a large publicly available assembly space for large gatherings such as birthday parties, weddings and other large social events in Lihue.

Environmental

The project is proposed on former cane field land. Immediately off Kapule Highway, the site was until recently planted in sugar cane. A former intersection point for a cane haul road and Kapule Highway will now serve as the Center's driveway to the highway.

Flora on-site consists entirely of sugar cane with a few species of scrub and grasses along Kapule Highway. No fauna were observed during visits to the site and it is highly unlikely that endangered species of animals reside there.

An Archaeological Inventory Survey of the site was conducted in December of 1991 in conjunction with the preparation of documents for this project. The survey noted as follows:

"The subject property is the site of a former sugarcane field which has been subjected to radical disturbances. No archaeological sites are present on the surface of the property and it is our opinion that chances for subsurface recovery are poor. No additional (archaeological) work has been recommended." (Archaeological Consultants of Hawaii, 12/1992)

The Veteran's Center structure will be a positive esthetic addition to the current site and surrounding environment. Although it will be replacing an open canefield, the design quality proposed is expected to enhance visual quality in this area. Also, landscaping within the 48-foot wide buffer and parking area will further augment the visual quality of the site.

The site is presently bordered by vacant lands to the west and north. The Vidinha Stadium expansion site and Kapule Highway border the site to the south and east respectively.

Summary of the Impacts

Short-term Impacts

In the short-term construction related period, adverse impacts due to noise, fugitive dust and periodic traffic slow-downs are anticipated to result from this project. Project contractors will be instructed to adhere to applicable noise and air quality standards of the Department of Health, and to limit movement of large equipment to non-peak traffic hours.

Long-term Impacts

Air Quality: In the long-term, automobile exhaust emissions in the immediate area and on-site are expected to be increased due to the presence of a greater number of visitors to the Veterans' Center. Although increased, the levels are not expected to be significantly adverse.

The Center will have a small kitchen which will periodically vent cooking odors when in use. This is expected to have a negligible effect on the surrounding environment.

Water Quality: No adverse impacts to water quality (ground) are expected.

Drainage: Drainage on-site will be by sheet flow and will not be concentrated in any area sufficient to cause adverse effects to surrounding properties.

Noise: New activities at the Center will generate additional levels of noise on-site. Noise generated from the interior of the building should be sufficiently reduced to render insignificant those noises which do radiate beyond the borders of the site.

Traffic arriving, circulating and departing the site will also generate additional noise. This is not expected to be significantly greater than the levels now generally experienced along Kapule Highway.

Traffic: The Veterans' Center will increase traffic to the portion of Kapule Highway which fronts the site. Such increases to traffic are anticipated to be greatest during times when large gatherings are held at the Center. In those instances, and when conditions warrant, special or off-duty police officers may be necessary to provide effective mitigation of traffic impacts generated.

Archaeology: As previously noted, no significant archaeological value has been attributed to the project site.

Flora/Fauna: No significant impacts to the flora or fauna of the site are expected.

Visual: The construction of the project is expected to enhance the visual environment of the area.

Public Facilities: No long-term adverse impacts due to additional usage of public services (sewer, water, trash disposal), utilities (telephone, electricity) or emergency services are anticipated.

Alternatives Considered

The "no action" alternative was an option identified early in the formulation of this project, but was also the course of action to be taken only if the efforts of the Kauai Veteran's Council were unsuccessful. The diligence of the veterans and widespread social benefit to the general community however, have ensured the success of the project effort.

Proposed Mitigation Measures

1. The construction contractor will be expected to minimize construction noise, dust and traffic related impacts.

Noise can be expected to be mitigated to the extent possible by adherence to applicable Department of Health noise regulations.

Fugitive dust and emission impacts can be expected to be minimized through periodic dust control measures utilizing water or dust barriers, and through maintaining properly functioning equipment.

Construction traffic impacts can be expected to be minimized through careful transport and scheduling of slow moving vehicles to avoid rush or high traffic hours.

2. Long-term traffic impacts due to large events at the Center can also be minimized through use of special or off-duty police officers to provide effective traffic control especially at peak times.

Determination

The Kauai Veterans' Center is not expected to generate significantly adverse impacts to the environment. Therefore, it has been determined that a negative declaration for its construction will be filed.

Findings and Reasons Supporting Determination

1. The Center will not involve an irrevocable commitment to loss or destruction of any natural or cultural resources.
2. The Center will not curtail the range of beneficial uses of the environment.
3. The Center does not conflict with the State's long-term environmental policies.
4. The Center will not adversely affect the economic and social welfare of the County of Kauai or the State.
5. The project will not generate secondary impacts on population or public facilities.
6. The Center will not cause a substantial degradation of environmental quality.
7. The Center will not affect any rare, threatened or endangered specie of flora or fauna. No endangered species of flora or fauna are known to exist on the proposed site.
8. The Center will not adversely affect air or water quality, or the ambient noise environment of the area.
9. The Center is not located in a flood plain, tsunami zone, erosion-prone, or geologically hazardous area.

For the reasons cited above, the proposed construction and operation of the Kauai Veterans' Center will not have any significant effect in the context of Chapter 343, Hawaii Revised Statutes and section 11-200-12 of the State Administrative Rules

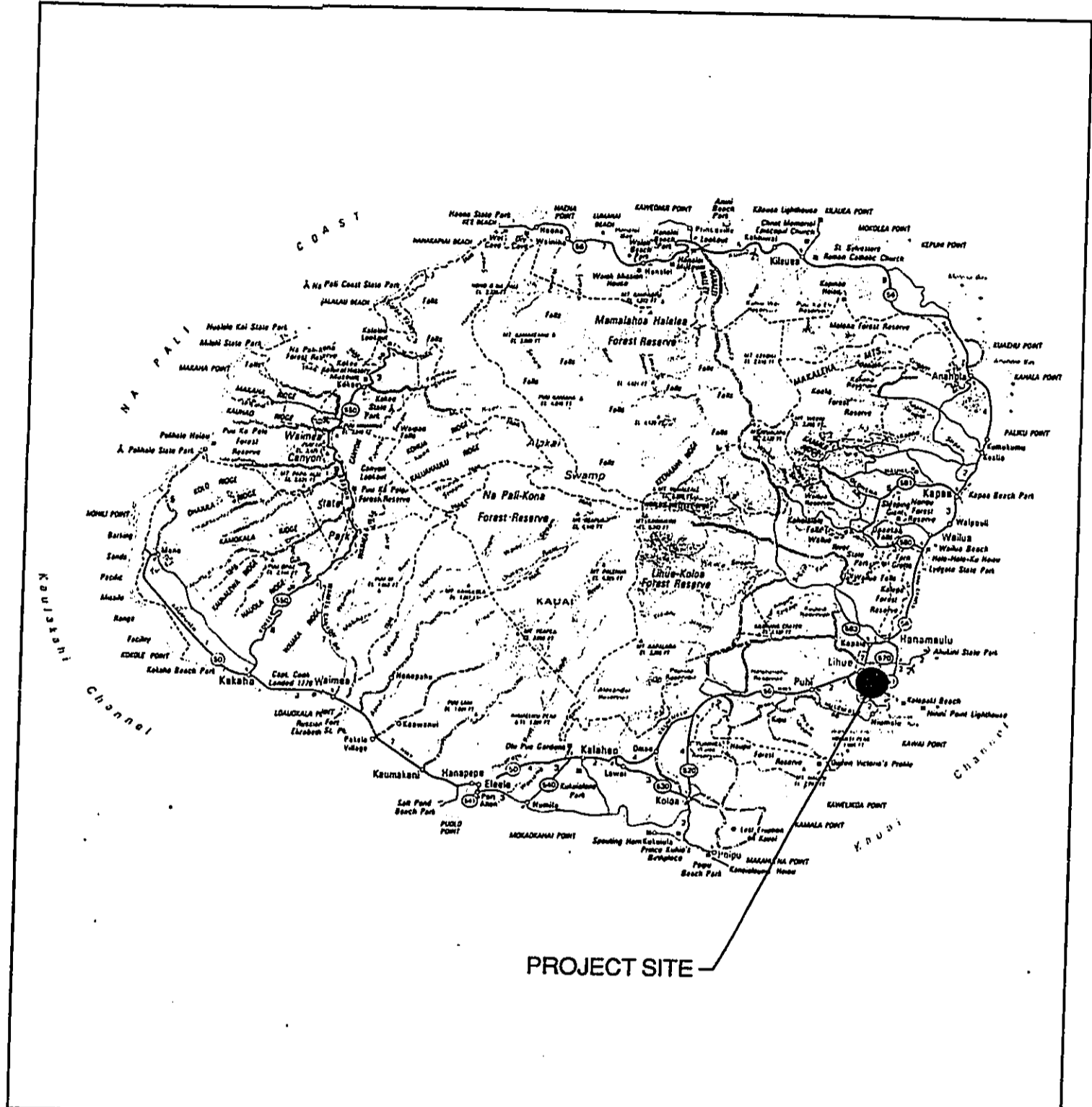

SITE LOCATION MAP

KAUI VETERANS CENTER
Lihue, Puna, Kauai, Hawaii

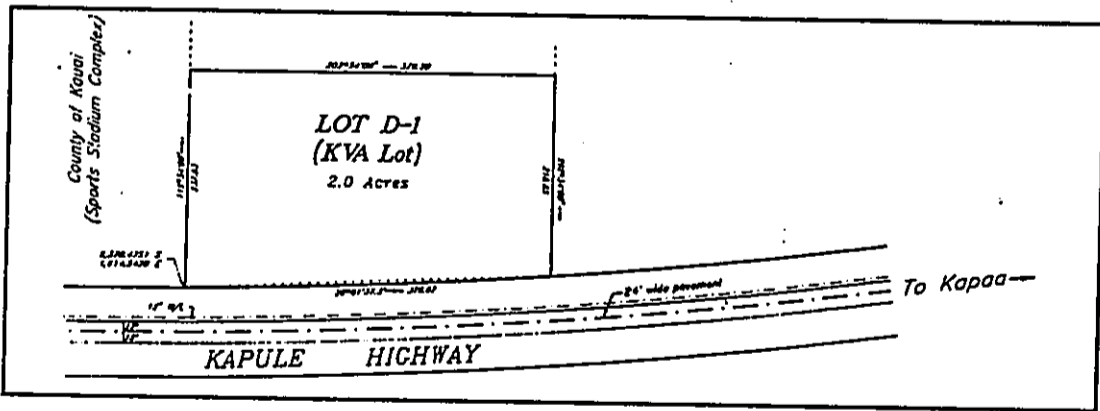
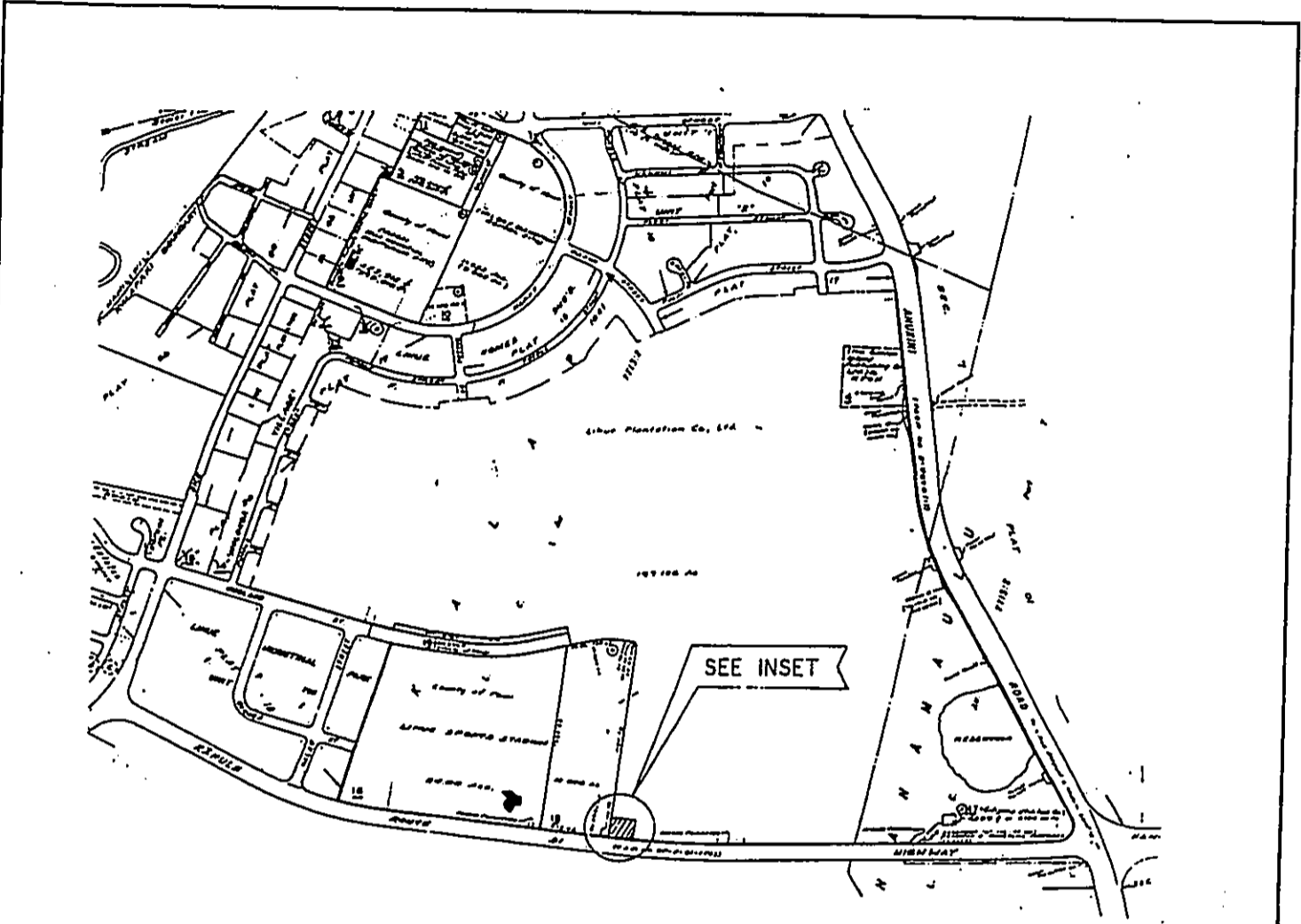

SITE LOCATION MAP

KAUAI VETERANS CENTER
Lihue, Puna, Kauai, Hawaii



Photo 1. View of the site. Looking North from across Kapule Highway.



Photo 2. View of the site and Kapule Highway. Looking southwest.

PHOTOGRAPHS

KAUAI VETERANS CENTER
Lihue, Puna, Kauai, Hawaii



Photo 3. View of the site. Looking north.

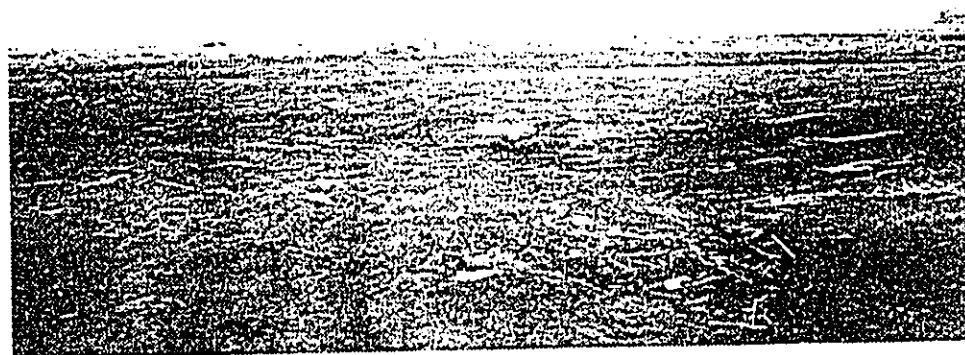

Photo 4. View of the site. Looking west.

PHOTOGRAPHS

KAUAI VETERANS CENTER
Lihue, Puna, Kauai, Hawaii