

2280

JOHN WAIHEE
GOVERNOR OF HAWAII



WILLIAM W. PATY, CHAIRPERSON
BOARD OF LAND AND NATURAL RESOURCES

DEPUTIES

JOHN P. KEPPELER, II
DONA L. HANAIKE

DOFAW

STATE OF HAWAII
DEPARTMENT OF LAND AND NATURAL RESOURCES
P.O. BOX 621
HONOLULU, HAWAII 96809

AQUACULTURE DEVELOPMENT PROGRAM
AQUATIC RESOURCES CONSERVATION AND ENVIRONMENTAL AFFAIRS
CONSERVATION AND RESOURCES ENFORCEMENT
CONVEYANCES
FORESTRY AND WILDLIFE LAND MANAGEMENT
STATE HISTORIC PRESERVATION
STATE PARKS
WATER AND DEVELOPMENT

REF

'92 MAY 7 11:45

April 28, 1992

In reply, please refer to:

REF: DOFAW
(FC. OF ENVIRONMENTAL QUALITY CONTROL)

only 1 copy of neg dec submitted

Mr. Brian Choy, Director
Office of Environmental Quality Control
465 South King Street, Room 104
Honolulu, Hawaii 96813

Dear Mr. Choy:

Enclosed is the Division of Forestry and Wildlife's Determination of Negative Declaration for the construction of a nursery operation building at the Central Tree Nursery in Kamuela, Hawaii.

We are submitting this Declaration for action as required in Environmental Quality Commission - Environmental Impact Statement Regulations.

Sincerely,

WILLIAM W. PATY

Enclosure

cc: Hawaii District Office

1992-05-18-HI-PEA-State Tree Nursery Operations Bldg

MAY 18 1992

DETERMINATION NOTICE OF NEGATIVE DECLARATION

FOR

STATE TREE NURSERY OPERATIONS BUILDING

AT

KAMUELA, HAWAII

TMK: 6-6-05:01

- I. PROPOSING AGENCY: DEPARTMENT OF LAND AND NATURAL RESOURCES, DIVISION OF FORESTRY AND WILDLIFE.
- II. APPROVING AGENCY: DEPARTMENT OF LAND AND NATURAL RESOURCES, DIVISION OF FORESTRY AND WILDLIFE.
- III. AGENCIES CONSULTED: DLNR, DIVISION OF WATER AND LAND DEVELOPMENT, HAWAII COUNTY PLANNING DEPARTMENT
- IV. SUMMARY OF PROPOSED ACTION:

The Division of Forestry and Wildlife (DOFAW) has plans to construct a replacement Nursery Operations Building containing 4,200 square feet at the State Tree Nursery, Kamuela, Island of Hawaii, TMK 6-6-05:01. The existing building is old and obsolete. The Nursery Operations Building is where the majority of tree seedling production activities such as grading and packing seedlings for shipment, washing of trays and containers, mixing of plant media, filling containers with media, bagging seedlings, sowing seed, and storing of nursery equipment and supplies.

ENVIRONMENTAL ASSESSMENT
FOR
STATE TREE NURSERY OPERATIONS BUILDING
AT
STATE TREE NURSERY, KAMUELA, HAWAII

PROPOSED BUILDING FOR STATE TREE NURSERY

I. SCOPE:

This environmental assessment addresses the construction of a replacement Nursery Operations Building at the State Tree Nursery, Kamuela, Hawaii.

A. PROJECT DESCRIPTION:

1. History of the State Tree Nursery

The State Tree Nursery which began operation in 1960, produces several hundred thousands of seedlings a year for statewide distribution for commercial timber, windbreak, erosion and pollution control, landscaping, and other forestation purposes. DOFAW, other government agencies, private landowners and the general public receive a economical source of tree seedlings to meet the various tree planting purposes.

The Nursery Operations Building is the center of the nursery as it is used for seedling production activities such as packing seedlings, mixing planting media, filling containers with media,

sowing seed, washing and sterilizing containers and trays etc.

The existing Nursery Operation Building is a military quonset building which was reconstructed at the State Tree Nursery in 1962. The building is approximately 50 years old, obsolete, and unsafe.

2. Project's Environment:

The State Tree Nursery consists of approximately 15 acres of state-owned land. It is located at the 2,500 feet elevation, one mile from Kamuela town center, and is part of the Lalamilo Farm Lots which is zoned "Agriculture". Its eastern boundary is Mamalahoa State Highway, its northern boundary is Lalamilo Farm Lots Road, and the remaining two boundaries are adjacent Farm Lots.

The nursery complex includes a nursery operations building, greenhouse and propagation areas, office, garage, District Support Facility, and pesticide storage building. The proposed Nursery Operations Building site is approximately 150 feet from existing Nursery Operations Building. The proposed site was selected for its closer proximity to greenhouse and propagation areas. The proposed building is the same dimension as the existing building (100 feet X 40 feet).

B. ENVIRONMENTAL IMPACT FROM PROPOSED PROJECT:

1. Biota

The site is currently vegetated primarily with Kikuyu grass. Kikuyu is a non-native grass that is found extensively throughout the Waimea area as a pasture grass.

2. Unavoidable Adverse Effects

mitigation
Short term unavoidable adverse effects would be soil loss through wind during excavation of site. The dust level can be reduced by watering the exposed soil during excavation for the new building.

3. Long Range Effects

Long range effects are all positive as the project will provide a safer working environment for employees and seedling pick-up area for the general public.

The State of Hawaii will benefit from the new building as more trees are planted. Planting of trees can protect watersheds and ocean reefs, reduce soil erosion, increase wildlife habitat, and enhance the scenery for residents as well as for visitors.

4. Relationship of Project to Management's Goals

The continuation of producing tree seedlings to DOFAW, the public and other government agencies is the function of the State Tree Nursery. DOFAW is

currently promoting the forest stewardship and land grant programs which the cooperators are depending on the State Tree Nursery for seedlings. Another cost sharing program through Agricultural Conservation Program, USDA, depend on purchase of seedlings through the nursery.

III. ALTERNATIVES TO THE PROPOSED PROJECTS:

A. Alternative Sites

An alternative site would not be practical as this is a replacement building and is part of a total nursery complex.

B. No Action

A "no action" plan cannot be accepted. Existing building is deteriorating rapidly and is dangerous. The Nursery Operation Building and site selection is essential to continued tree seedling production.

IV. IRREVERSIBLE AND IRRETRIEVABLE COMMITMENTS OF RESOURCES:

The funding allocated to this Capital Improvements Project will lapse and be irretrievable.

V. SIGNIFICANCE OF PROJECT'S IMPACT:

This project is significant and essential to the continued production of tree seedlings available for statewide distribution.

VI. REASON FOR FILING A NON-IMPACT STATEMENT:

The construction of the State Tree Nursery Operations Building is not expected to have a significant negative impact on the environment. The production, distribution, and planting of nursery seedlings will have a positive impact by benefiting the environment on a statewide and global scale.

Revised
Copy

DOCUMENT CAPTURED AS RECEIVED

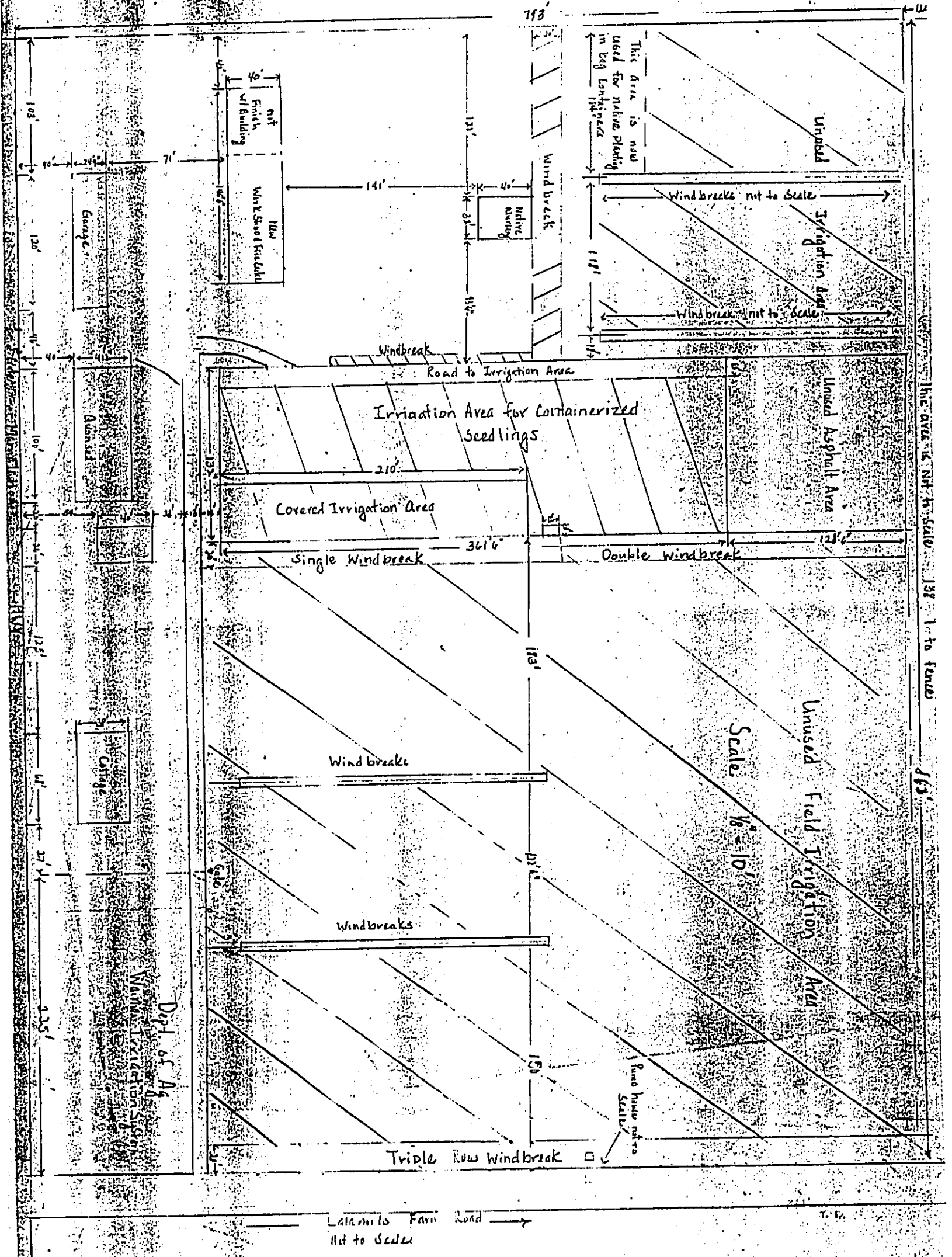

The area is not to scale 1/8" = 10' to 100'

Scale 1/8" = 10'

Road house not to Scale

Laramie Farm Road not to Scale

Revised

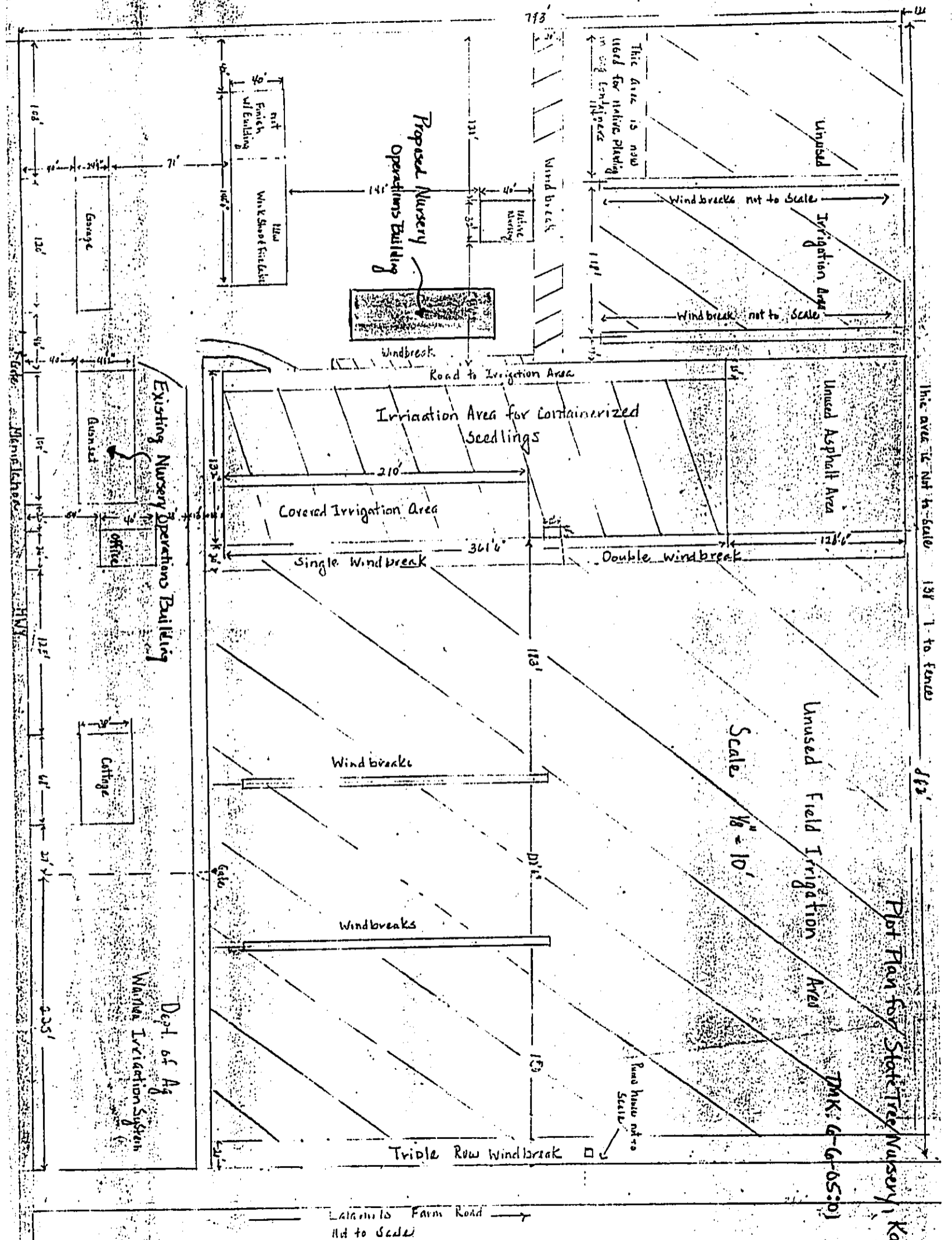

Kamuela, Hawaii

Lalamis Farm Road
1/4" = 100'

DMK: G-6-05:01