

JOHN WAIHEE
GOVERNOR



RUSSEL S. NAGATA
COMPTROLLER
ROBERT P. TAKUSHI
DEPUTY COMPTROLLER

STATE OF HAWAII
DEPARTMENT OF ACCOUNTING AND GENERAL SERVICES
DIVISION OF PUBLIC WORKS
P. O. BOX 119, HONOLULU, HAWAII 96810

LETTER NO. (P)1564.2

RECEIVED

JUN 16 1992

'92 JUN 16 A8:46

OFFICE OF ENVIRONMENTAL
QUALITY CONTROL

Mr. Brian J. J. Choy
Director
Office of Environmental
Quality Control
Central Pacific Plaza
220 South King Street, 4th Floor
Honolulu, Hawaii 96813

Dear Mr. Choy:

Subject: Moanalua Intermediate School
Basic Practical Arts Classroom

Attached for your appropriate action are the following:

1. Document for publication in the OEQC Bulletin.
2. Four copies of the Negative Declaration.

If there are any questions, please have your staff call
Mr. Brian Major of the Planning Branch at 586-0485.

Very truly yours,

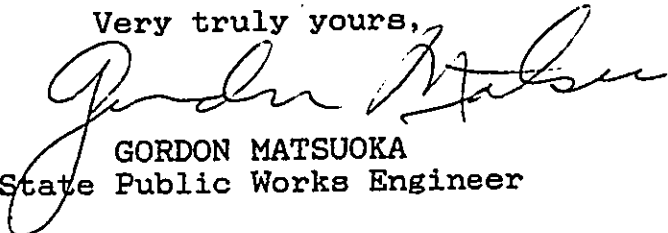
GORDON MATSUOKA
State Public Works Engineer

BM:jnt
Attachments

1992-06-23-DA-PEA - Moanalua Intermediate
School Arts Classroom

JUN 23 1992

NEGATIVE DECLARATION
MOANALUA INTERMEDIATE SCHOOL
BASIC PRACTICAL ARTS CLASSROOM
JUNE 9, 1992

- A. PROPOSING AGENCY: Department of Accounting and General Services for the Department of Education.
- B. APPROVING AGENCY: Not applicable.
- C. AGENCY CONSULTED: Department of Education.
- D. GENERAL DESCRIPTION TECHNICAL, ECONOMIC, SOCIAL AND ENVIRONMENTAL CHARACTERISTICS:
1. Technical: This is to construct a one-story reinforced concrete/masonry basic practical arts classroom building comprising approximately 1900 net square feet.
 2. Economic: The estimated cost of the project is \$868,000. Since the project will be constructed within the existing school campus, no land will be removed from the tax base.
 3. Social: The project will provide the school with a much-needed facility to implement its program in accordance with the Educational Specifications.
 4. Environmental: The project will not create any major environmental impact.
- E. SUMMARY DESCRIPTION OF THE AFFECTED ENVIRONMENT, INCLUDING SITE MAPS: The school and basic practical arts classroom are located as shown in Figures 1 and 2, respectively. The proposed building will be located in an area that had previously been graded during the construction of nearby structures.
- F. DISCUSSION OF THE ASSESSMENT PROCESS: The following assessments are made to determine whether or not the anticipated effects constitute a "significant effect":
1. The proposed action will not involve an irrevocable commitment to loss or destruction of any natural or cultural resources.
 2. The proposed action will not curtail the range of beneficial uses of the environment.
 3. The proposed action will not conflict with the State's long-term environmental policies.
 4. The proposed action will not substantially affect the economic or social welfare of the community or State.

5. The proposed action will not involve substantial secondary impacts, such as population changes or effects on public facilities.
 6. The proposed action will not involve a substantial degradation of environmental quality.
 7. The proposed action will not substantially affect any rare, threatened or endangered species of flora or fauna or habitat. No endangered species of flora or fauna are known to exist in the project site.
 8. The proposed action will not detrimentally affect air or water quality or ambient noise levels.
 9. The proposed action will not be located in any environmentally sensitive area, such as flood plain, tsunami zone, erosion-prone area, geologically hazardous land, estuary, fresh water, or coastal waters.
- G. SUMMARY OF MAJOR IMPACTS: From the above assessment, no major adverse environmental impact is anticipated. The project will result in the following minor adverse impacts:
1. Depletion of labor and material resources for construction.
 2. Some dust, noise and silting during construction.
- H. ALTERNATIVES CONSIDERED: The "no action" alternative was considered but deemed to be unacceptable.
- I. PROPOSED MITIGATION MEASURES: The temporary dust, noise and silting which would occur during construction will be controlled by application of appropriate pollution control measures.
- J. DETERMINATION: It is determined that an Environmental Impact Statement should not be required for this project.
- K. FINDINGS AND REASONS SUPPORTING DETERMINATION: The project site is generally free of flood, tsunami, erosion, and landslide hazards. No rare or endangered species of flora are known to exist at the site. No rare or endangered species of fauna are known to inhabit the site. There are no recorded archaeological or historical sites within the existing site.

Negative Declaration
Moanalua Intermediate
Basic Practical Arts Classroom

Page 3

For the reasons cited above, the proposed action will not have any significant effect in the context of Chapter 343, Hawaii Revised Statutes and Section 11-200-12 of the State Administrative Rules.

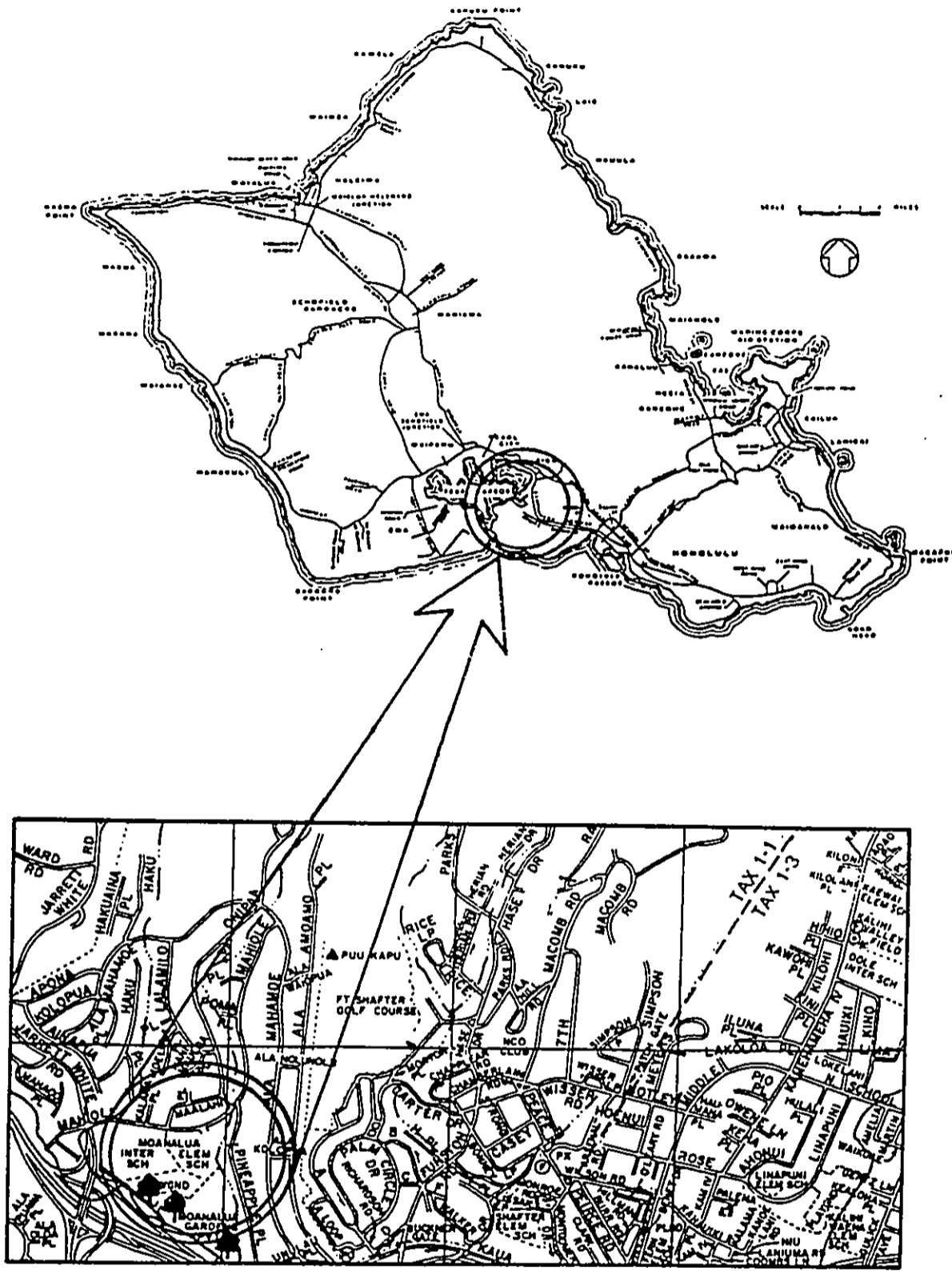

LOCATION MAP

FIGURE 1

PROJECT
BASIC PRACTICAL
CLASSROOM

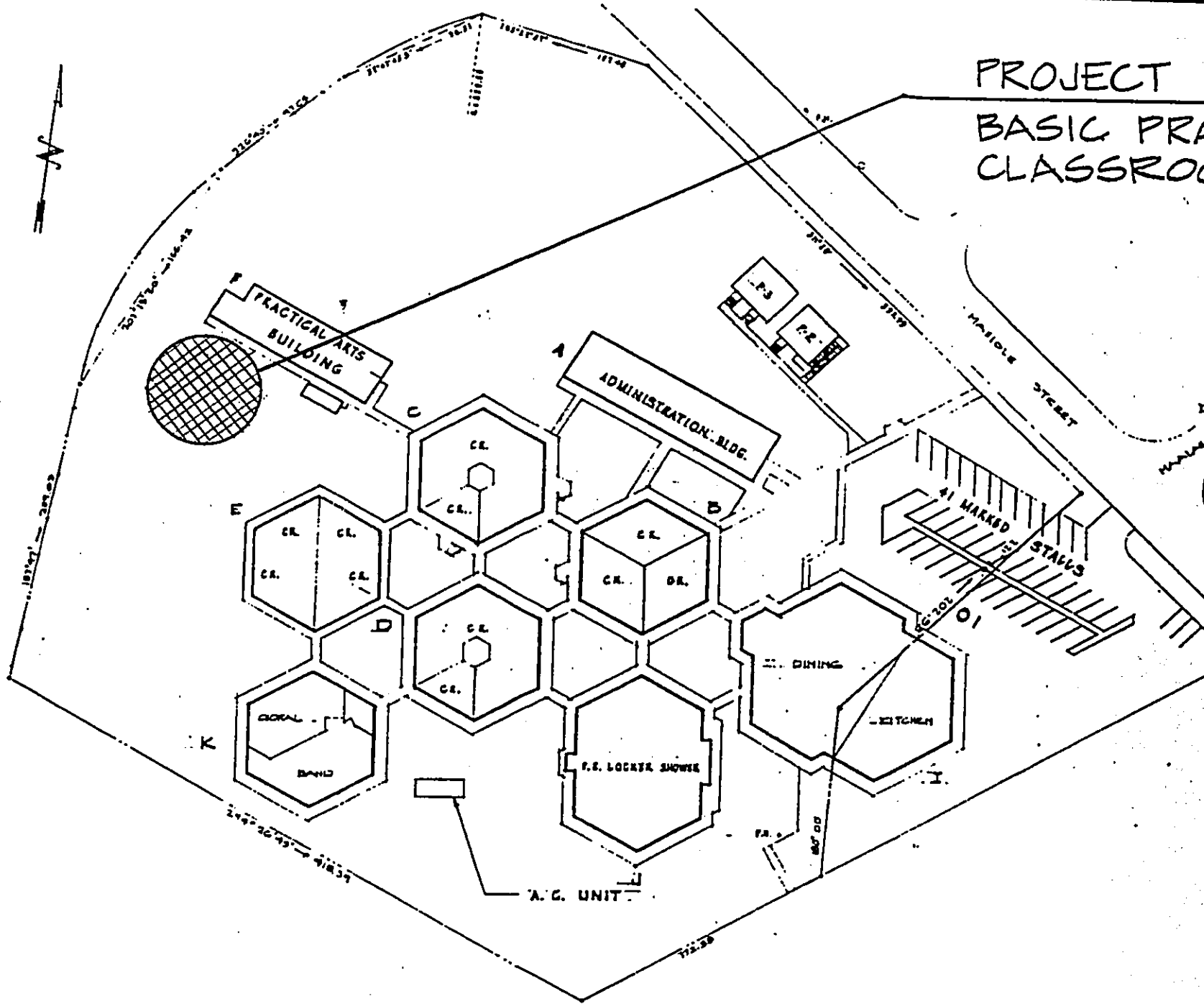

FIG

BLDG.	FACILITIES	YEAR COMPL'D	NO OF STORIES	CLASS OR CONSTR.
-------	------------	--------------	---------------	------------------

PROJECT LOCATION
BASIC PRACTICAL ARTS
CLASSROOM

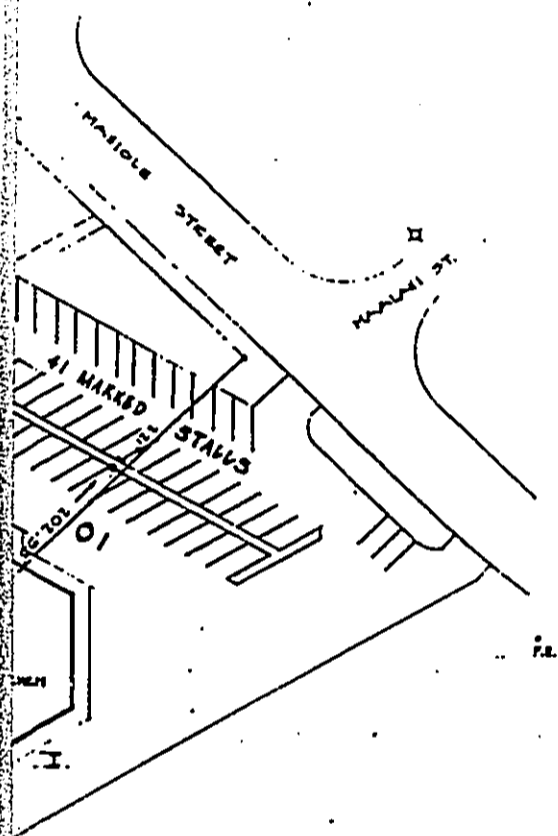
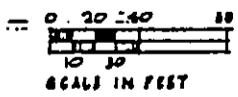

FIGURE 2



AREA OF SCHOOL	7.598 AC.
NO. OF MARKED STALLS	41

REVISED: FEB., 1992

BUILDING DEPARTMENT	
<small>CITY & COUNTY OF HONOLULU</small>	
MOHIALIA INTERMEDIATE SCHOOL	
<small>HONOLULU, HAWAII</small>	
<small>TAX MAP KEY: 1-1-051 PORTION OF 3</small>	
E.L.R.T. PLAN	
DESIGN	4-22
DRAWN	
CHECKED	
SCALE	
DATE	<small>SHEET OF SHEETS</small>