

JOHN WAIHEE
GOVERNOR



STATE OF HAWAII
DEPARTMENT OF ACCOUNTING AND GENERAL SERVICES
P. O. BOX 119, HONOLULU, HAWAII 96810

ROBERT P. TAKUSHI
COMPTROLLER
LLOYD T. UNEBASAMI
DEPUTY COMPTROLLER

LETTER NO. (P)1995.2

DEC 23 1992

RECEIVED

'92 DEC 23 10:53

Mr. Brian J. J. Choy
Director
Office of Environmental
Quality Control
Central Pacific Plaza
220 South King Street, 4th Floor
Honolulu, Hawaii 96813

Dear Mr. Choy:

Subject: Negative Declaration for
Kahakai Elementary School
Six-Classroom Building
TMK 7-5-20:77 Kailua-Kona, Hawaii

The Department of Accounting and General Services (DAGS) did not receive any comments on the draft Environmental Assessment (EA) during the 30-day public comment period which began on November 23, 1992. Therefore, DAGS has determined that this project will not have a significant environmental effect and has issued a negative declaration. Please publish this notice in the January 8, 1993 OEQC Bulletin.

We have enclosed a completed OEQC Bulletin Publication Form and four copies of the final EA. If there are any questions on this matter, please have your staff call Mr. Ralph Morita of the Planning Branch at 586-0486.

Very truly yours,

A handwritten signature in cursive script, appearing to read "Gordon Matsuoka".
GORDON MATSUOKA
State Public Works Engineer

RM:jk
Attachments

223

1993-01-08- H1- FEA- Kahakai Elementary School 6- classroom Bldg

FINAL ENVIRONMENTAL ASSESSMENT
KAHAKAI ELEMENTARY SCHOOL
SIX-CLASSROOM BUILDING
NOVEMBER 23, 1992

- A. PROPOSING AGENCY: Department of Accounting and General Services for the Department of Education.
- B. APPROVING AGENCY: Not applicable.
- C. AGENCY CONSULTED: Department of Education.
- D. GENERAL DESCRIPTION OF THE TECHNICAL, SOCIO-ECONOMIC AND ENVIRONMENTAL CHARACTERISTICS:
1. Technical: This project proposes to construct a two-story reinforced concrete and masonry building of approximately 14,356 square feet which will consist of six (6) regular classrooms, one (1) teachers' workroom and toilet facilities. The facility will provide classrooms needed to implement growing educational programs at the elementary school. Construction of the building will be completed in a single phase.
 2. Socio-Economic:
 - a. The proposed project will not create sufficient work to substantially impact the economy and welfare of the community and State.
 - b. The estimated cost of the project is \$2,643,000.
 - c. Since the project will be constructed within the existing school campus, no land will be removed from the tax base.
 - d. The project will provide the school with a much-needed facility to implement its program in accordance with the Educational Specifications.
 - e. Easements for utility lines and roads may be required at a later date.
 3. Environmental:
 - a. The project will not create any major long-term environmental impacts.
 - b. However, during construction, the air quality may be affected by dust and exhaust emissions and it

is anticipated there will be a temporary increase in noise levels.

- c. These impacts are expected to be minimal since State and Federal regulations need to be met.

E. SUMMARY DESCRIPTION OF THE AFFECTED ENVIRONMENT, INCLUDING SITE MAPS:

1. The site of the proposed project is located on the school campus (TMK 7-5-20:77). It is on level ground covered with grass and weeds.
2. No habitat of endangered species, flora or fauna are known to exist at the site.
3. No historical, archaeological or cultural sites are known to exist at the site.
4. The site is not in a Special Management Area.
5. The location of the proposed project is shown in Figures 1 and 2.

F. IDENTIFICATION AND SUMMARY OF MAJOR IMPACTS AND ALTERNATIVES CONSIDERED:

1. Major Impacts: The proposed project will not:
 - a. Involve an irrevocable commitment to loss or destruction of any natural or cultural resources.
 - b. Curtail the range of beneficial uses of the environment.
 - c. Conflict with the State's long term environmental policies.
 - d. Substantially affect the economic or social welfare of the community or State.
 - e. Involve substantial secondary impacts, such as population changes or effects on public facilities.
 - f. Involve a substantial degradation of environmental quality.

- g. Detrimentially affect air or water quality or ambient noise levels.
- h. Be located in any environmentally sensitive area, such as a flood plain, tsunami zone, erosion-prone area, geologically hazardous land, estuary, fresh water, or coastal waters.

2. Alternatives to the Proposed Project: "No action" is not considered to be a viable or desirable alternative.

G. PROPOSED MITIGATION MEASURES: Short term impacts on air and noise quality during construction will be controlled by application of appropriate pollution and noise control measures.

H. DETERMINATION: On the basis of the above assessment, it is concluded that the proposed project will not have a significant adverse impact on the environment.

 I. FINDINGS AND REASONS SUPPORTING DETERMINATION: No evidence has been found to require any further environmental studies.

Kahakai Elementary School
 TMK: 7-5-20:72
 FIGURE NO. 1 (Vicinity Map)
 11/2 KMORITA
 PLAT

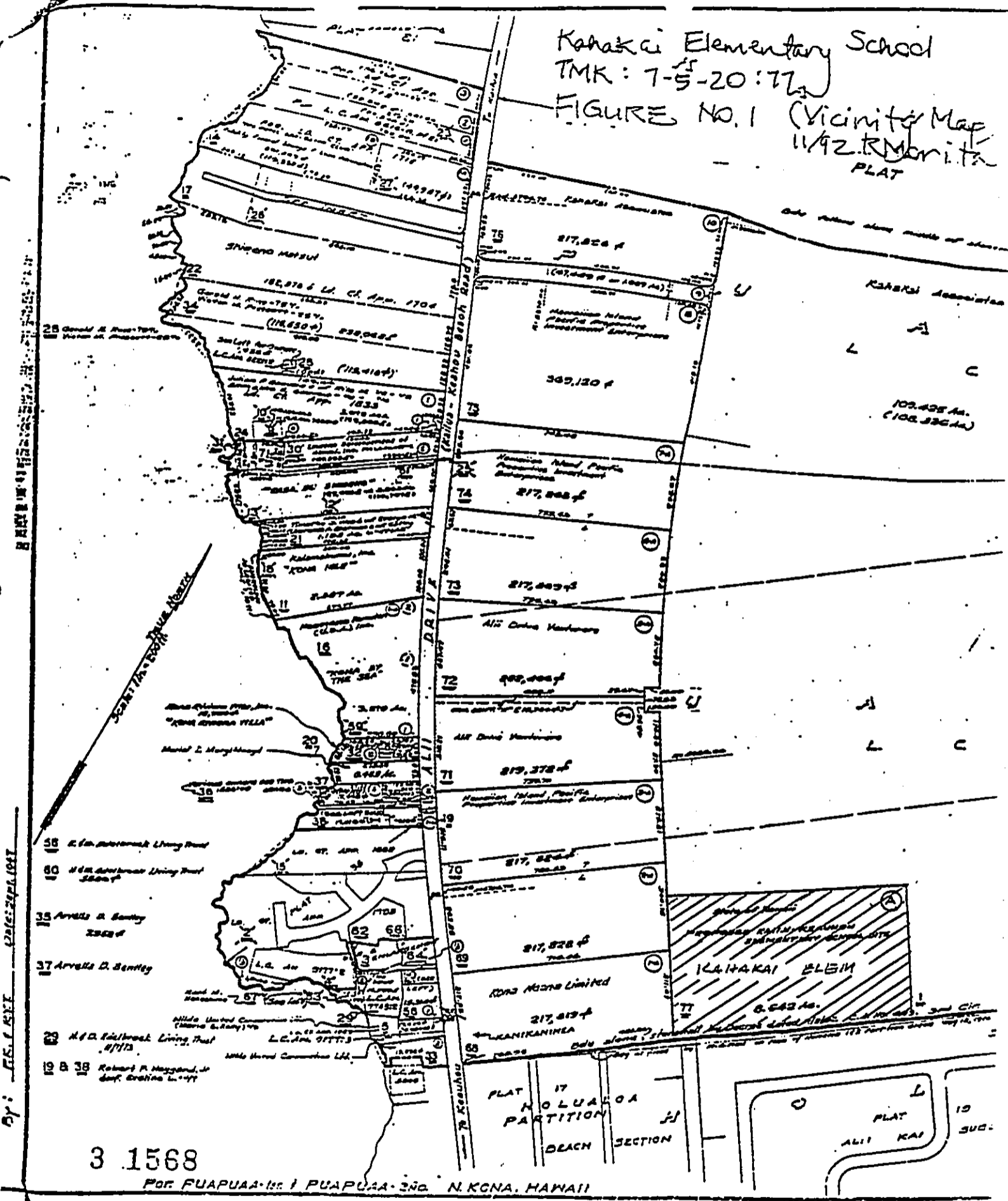

3 1568

FOR PUAPUAA-111; PUAPUAA-210. N. KONA, HAWAII

PRINT BY:

-10-91 : 3:04PM : DOE HI Dist C

808 737 5231: # 4

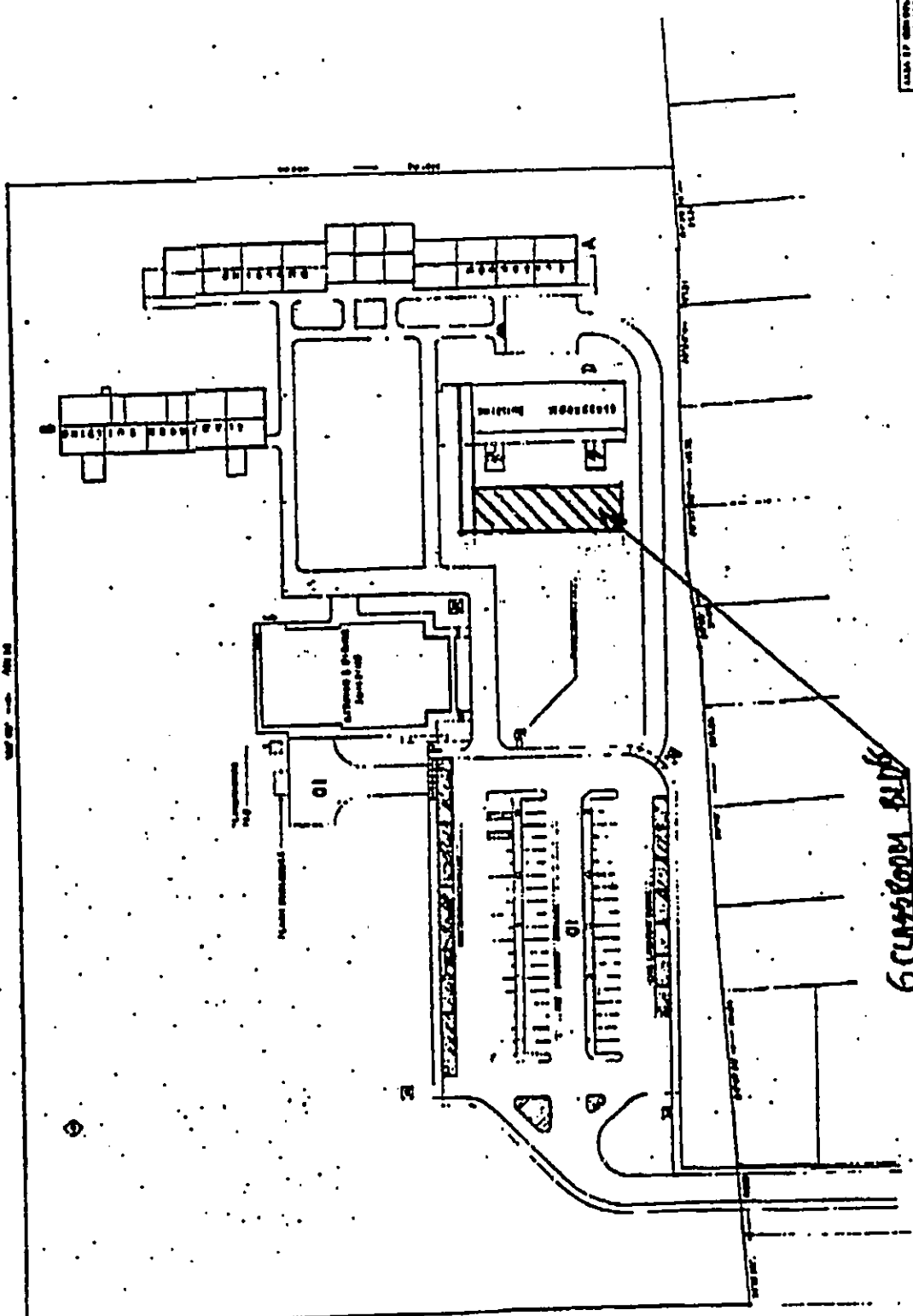
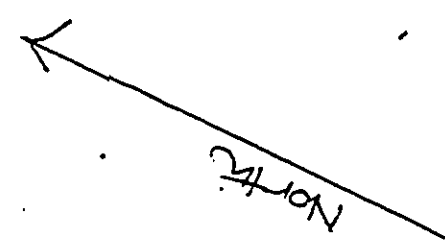

CLASSROOM BLDG



Kahakai Elementary School
6- Classroom Building
TMK: 7-5-20:77
FIGURE NO. 2 (Plot Plan) 11/2 RMorita

DATE OF REVISION	CLASS NO.
NO. OF REVISIONS	01
REVISIONS	

DATE OF APPROVAL		DATE OF REVISION	
APPROVED BY	DATE	APPROVED BY	DATE
DEPT. OF ACCOUNTING & GENERAL SERVICES			
HAWAII			
KAREN M. TELEPHONIC SERVICES			
MAY 1991			
MAY 1991			