

BUILDING DEPARTMENT  
**CITY AND COUNTY OF HONOLULU**

HONOLULU MUNICIPAL BUILDING  
680 SOUTH KING STREET  
HONOLULU, HAWAII 96813

RECEIVED

'93 JUL 26 AM 11:55

FRANK F. FASI  
MAYOR

OFF. OF ENVIRONMENTAL  
QUALITY CONTROL

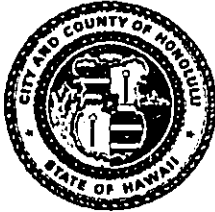

HERBERT K. MURAOKA  
DIRECTOR AND BUILDING SUPERINTENDENT

WILLIAM F. REMULAR  
DEPUTY

PB 93-742

July 26, 1993

Mr. Brian Choy, Director  
Office of Environmental Quality Control  
220 South King Street, 4th Floor  
Honolulu, Hawaii 96813

Dear Mr. Choy:

Subject: Negative Declaration for the Proposed  
Campbell Industrial Park Fire Station  
Oahu, Hawaii (TMK: 9-1-15:12)

This letter constitutes a notice to determination by this department after the potential impacts of the proposed project had been assessed according to Title II, Chapter 200, Environmental Impact Statement Rules, and Chapter 343 of the Hawaii Revised Statutes relating to the environmental impact statements. The determination has been made that an environmental assessment (EA) that was prepared by our consultant, Joseph Lancor Architects, Inc.

Based on our determination, we are filing a negative declaration for this project. Attached are four copies of the EA and an OEQC publication form.

We are requesting publication in your OEQC Bulletin of August 8, 1993.

Should there be any questions, please have your staff call Craig Nishimura at 527-6370.

Very truly yours,

A handwritten signature in black ink, appearing to read "Herbert K. Muraoka".

HERBERT K. MURAOKA  
Director and Building Superintendent

Attach.

cc: Joseph H. Lancor Architects, Inc.  
Parametrix, Inc.  
Fire Dept.

1993-08-08-DA-~~FEA~~-Campbell Industrial Park Battalion Headquarters AUG 8 1993

FINAL  
ENVIRONMENTAL ASSESSMENT  
FOR  
CAMPBELL INDUSTRIAL PARK  
BATTALION HEADQUARTERS  
FIRE STATION

This Environmental document prepared pursuant to Chapter 343, HRS

Prepared For:

Building Department  
City & County of Honolulu

Responsible Official: Herbert Muraoka 7-28-93  
Herbert Muraoka, Director & Date  
Building Superintendent

Prepared By:

Joseph H. Lancor Architects, Inc.

## TABLE OF CONTENTS

<u>SECTION</u>		<u>PAGE NUMBER</u>
I.	SUMMARY	1
II.	PROJECT DESCRIPTION	3
III.	AFFECTED ENVIRONMENT	5
IV.	MAJOR IMPACTS AND MITIGATION MEASURES	8
V.	ALTERNATIVES CONSIDERED	9
VI.	DETERMINATION	10
VII.	FUNDING AND PHASING	11
VIII.	AGENCIES CONSULTED IN PREPARATION OF E.A.	12
IX.	LIST OF PREPARERS	14
	<b>LIST OF FIGURES</b>	
Figure 1.	Location Map (USGS Quad Map)	2
Figure 2.	Site Plan	3
Figure 3.	Flood Hazard Map	8
	<b>EXHIBIT</b>	
	Correspondence - Agencies Consulted	

I. SUMMARY

CHAPTER 343, HRS  
ENVIRONMENTAL ASSESSMENT (EA)

Proposing Agency: Building Department  
City & County of Honolulu

Action: Agency

Project Name: Campbell Industrial Park Fire/Ambulance Station

Project Description: The proposed improvements will include the following: Construction of a new three Bay Station Battalion Headquarters on one acre of the Site. The Fire Station is to consist of a 3 Bay Apparatus room to house a ladder truck, engine, the Battalion Commander's vehicle. Living quarters will be for the Ladder and engine companies, a Captain's dorm, Battalion Commander's dorm, and Battalion Commander's driver's dorm. Other design improvements will be provided to insure that the facility is capable to meet the fire safety concerns of the Campbell Industrial Park.

Project Location: Campbell Industrial Park, Ewa, Oahu (See Figure 1)

Tax Map Key: 9-1-15: 1414 A-5

Area: 1.503 acres

State Land Use Designation: Urban

County Zoning Designation: I-2

Landowner: Estate of James Campbell

Contact: F. J. Rodriguez  
Parametrix Inc.  
1164 Bishop Street, Suite 1600  
Honolulu, Hawaii 96813  
Tel. (808) 524-0594

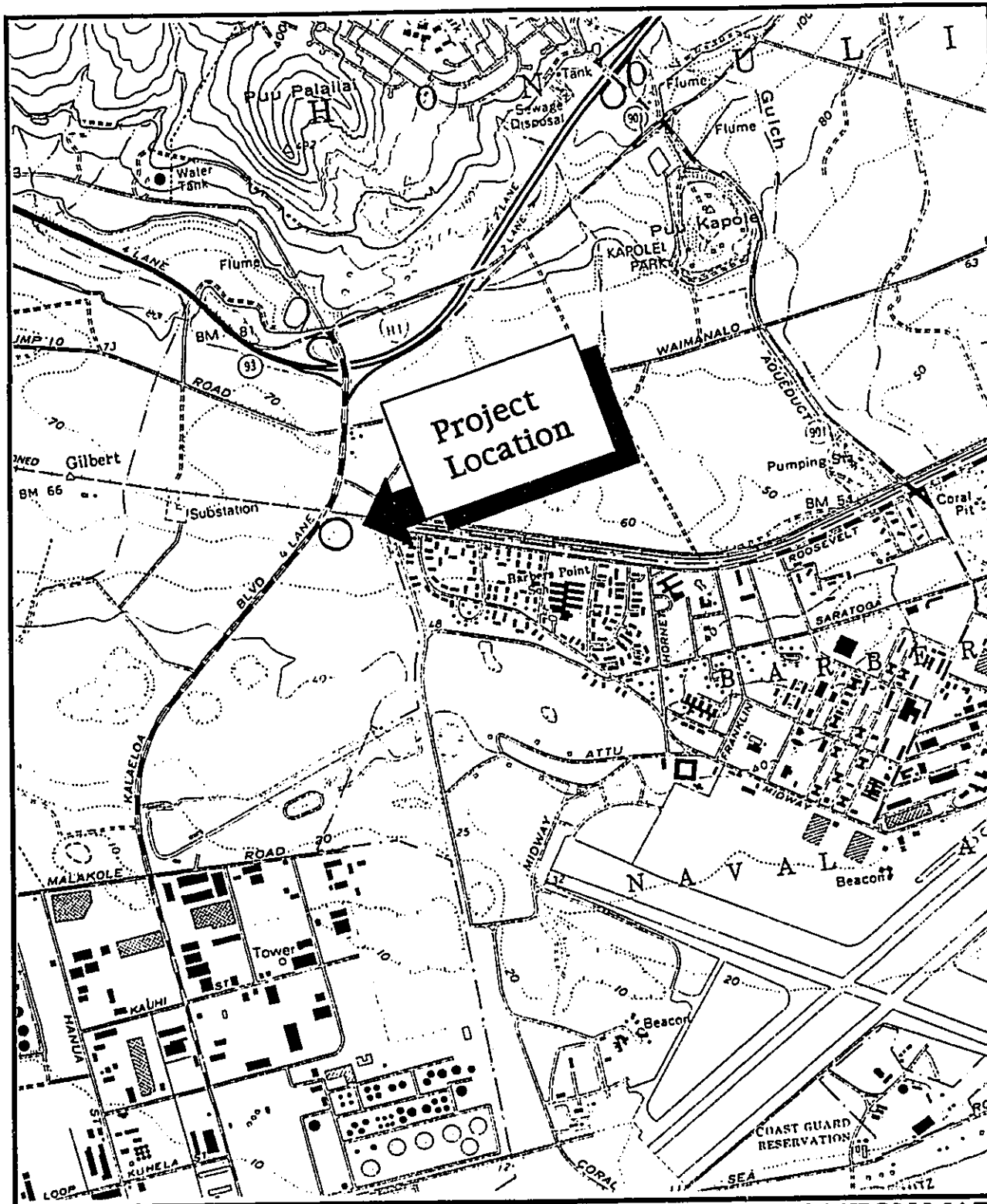

USGS QUAD MAP  
 Oahu, Hawaii  
 Campbell Industrial Park Fire/  
 Ambulance Station

PROJECT LOCATION MAP  
 FIGURE 1

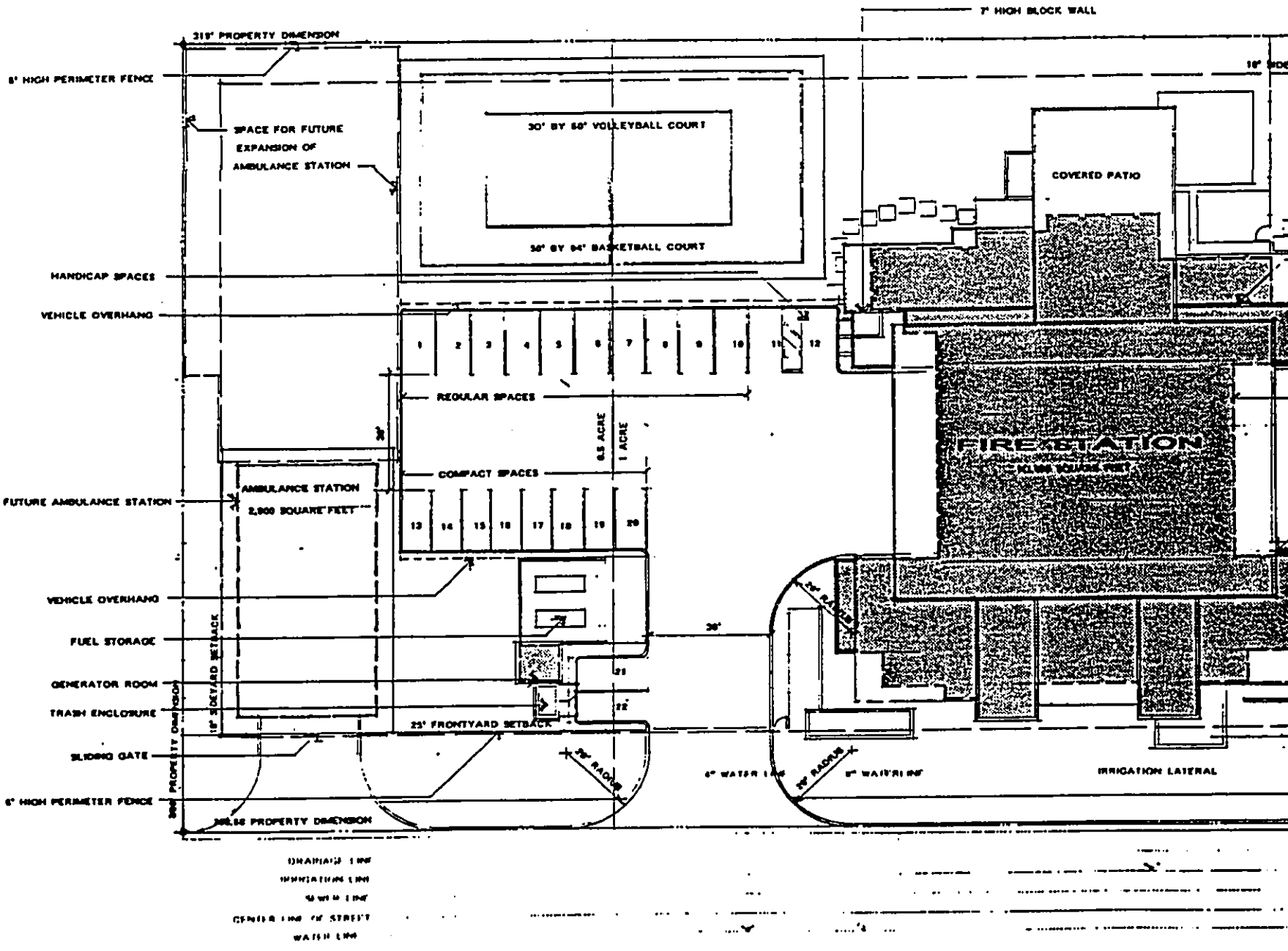

# SITE PLAN



SCREEN WALL

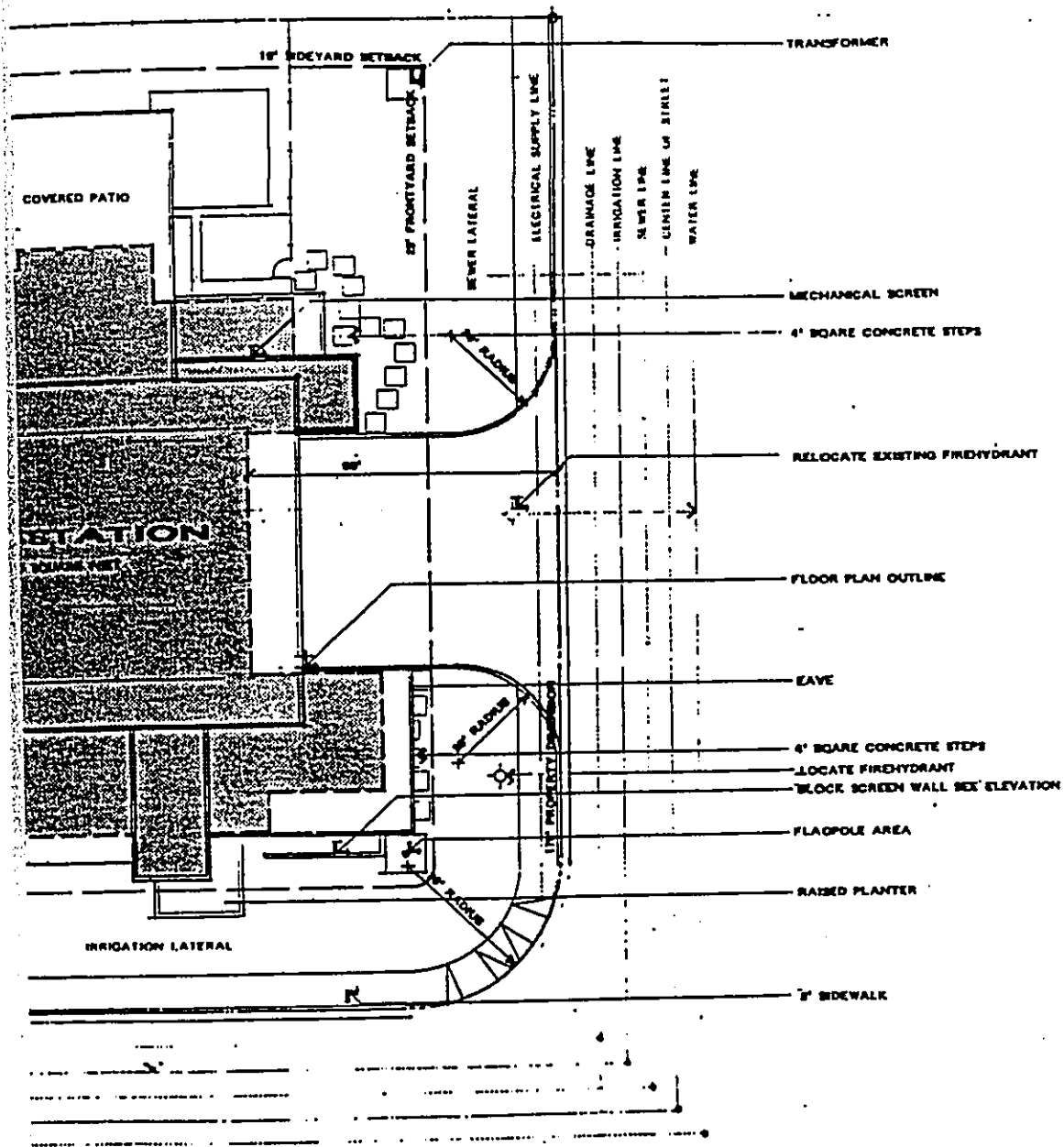

SCALE 1/16"=1'-0"

<b>BUILDING DEPARTMENT</b>		
CITY & COUNTY OF HONOLULU		
CAMPBELL INDUSTRIAL PARK FIRE STATION		
DESIGN	JOSEPH H LANCOR ARCHITECTS INC	
DRAWN		
CHECKED	120 KAA LUANA PLACE KAA LUANA HAWAII 96734 808 291-8810 FAX 808 292-0302	SHEET 1
DATE APRIL 23, 93		OF 8 SHEETS
PROJECT NO.	FILE	DRAW FOLDER

## II. PROJECT DESCRIPTION

### A. Technical Characteristics

The proposed Campbell Industrial Park Fire/Ambulance Station is designed to meet the current and future fire protection demands for the Campbell Industrial Park, and the newly emerging Kapolei Business & Industrial Park.

The Station will consist of approximately 8600 square feet on a parcel of approximately 1.5 acres. The Fire Station will comprise approximately one acre, and the Ambulance Station approximately 0.5 acres. When completed, the Station will be the new Battalion Headquarters for a portion of the leeward area.

The building will consist of a three (3) Bay apparatus room for the engine and ladder truck; offices for the Battalion Commander and Fire Captains; living quarters for both fire companies. There will also be a study/conference room, exercise room, tool room, storage for supplies, and an emergency generator room. In addition to these basic Station requirements, a few specialized requirements will be provided due to location and functions within the Campbell Industrial Park. These will include a decontamination room for dealing with exposure to hazardous materials, laundry room and medical storage.

Due to the location within the Campbell Industrial Park, and in quick response range to the oil refineries, it is possible and very likely that Station personnel will come in contact with chemicals and hazardous materials which are not normally experienced in non-industrial fires. The Decontamination Room will be specified location where the Fire fighters can wash the hazardous materials from their gear and themselves. It will be equipped with shower facilities connected to the Municipal sewer system. Lockers/storage areas for the separation or disposal of gear used in hazardous materials fire fighting is also part of this Decon area.

Design and construction of the future ambulance station will take place on the remaining 0.5 acre portion of the Station parcel. The ambulance station will have an apparatus (Ambulance) room; storage for emergency equipment; a treatment room and storage for medical supplies, an office, and bathroom with shower stall. Onsite parking will also be provided for ambulance staff personnel.

The balance of the Station site will be designed and built to provide recreational amenities, i.e. volleyball and basketball courts, exercise rooms, and onsite parking for the fire fighters.



**B. Social and Economic Characteristics**

The Station design will need to consider and implement the conditions of the new Americans with Disabilities Act (ADA). Final decision as to the extent of compliance with the ADA will be with the City & County Building Department. Due to the location within the Industrial Park, and the nature of the non-typical urban/residential character, compliance may be subject to special review considerations. Also, the Station is often made available to the general public for events such as charity fund raisers, free blood pressure tests, and other community-related activities. ADA compliance may be on the basis that the Station will have to provide adequate access/ingress facilities for the general public, as well as designing the station for all or in part to meet standards set forth by the ADA.

### III. AFFECTED ENVIRONMENT

#### A. Geographical Characteristics

##### 1. Topography

The proposed Campbell Industrial Park Fire Station will be built on a basically flat parcel with very little slope difference from the corner of the lot to the front of the parcel.

##### 2. Soils

Campbell Industrial Park at the Kalaeloa Boulevard intersection location, consists of Coral Outcrop (CR) soils. "This land type is used for military installations, quarries, and urban development. Vegetation is sparse and consists of kiawe, koa haole, and fingergrass. Annual rainfall amounts to 18-40 inches" USDA/SCS 8/72 Soil Survey of Islands of Kauai, Oahu, Molokai, and Lanai, State of Hawaii.

##### 3. Vegetation

At the proposed location for the Fire/Ambulance Station, the subject parcel has experienced a transition from vacant and fallow land, to an improved industrial subdivision. All previous onsite vegetation consisted of exotic or introduced species of kiawe, and haole koa. No endangered species were observed.

#### B. Hydrological Characteristics

##### 1. Drainage

Onsite drainage will be provided with the existing system of Industrial Park drainage master plan systems. The proposed Station improvements will not increase drainage loading on the existing drainage system. In the event of accidental spills of hazardous materials from industrial fire fighting, there are operational procedures that will mitigate the spillage and minimize the impacts into the adjacent coastal zone. Compliance with the Flood Insurance Rate map criteria for construction improvements will be a responsibility of the site design engineering firm and also the structural design engineer. The FIRM maps are primarily for residential impacts, and the Campbell Industrial Park parcel for the proposed Station is in Zone "D".

2. Coastal Zone Management Program

Compliance with the Coastal Zone Management Act is not required since there are no Federal funds involved in this proposed improvement project. However, the State Department of Business, Economic Development & Tourism will review this document as a routine evaluation. The proposed project is located outside the Special Management Area Boundary (See Figure 3).

**C. Biological Characteristics**

The location of the proposed Fire/Ambulance Station at the Campbell Industrial Park is on fully improved and previously disturbed lands. There will be little if any impacts to the existing biota due to this proposed project. Plant and animal species prevalent at the site are exotic or introduced species and will not be affected by this project.

**D. Historic and Archaeological Characteristics**

The previously disturbed nature of the proposed Station site and the fact that the Campbell Industrial Park has been the subject of previous archeological surveys precludes the possibility of uncovering sites with historic or archaeological significance. In the event that sites are uncovered, construction work will be halted and the State Historic Preservation Division, Department of Land and Natural Resources will be advised.

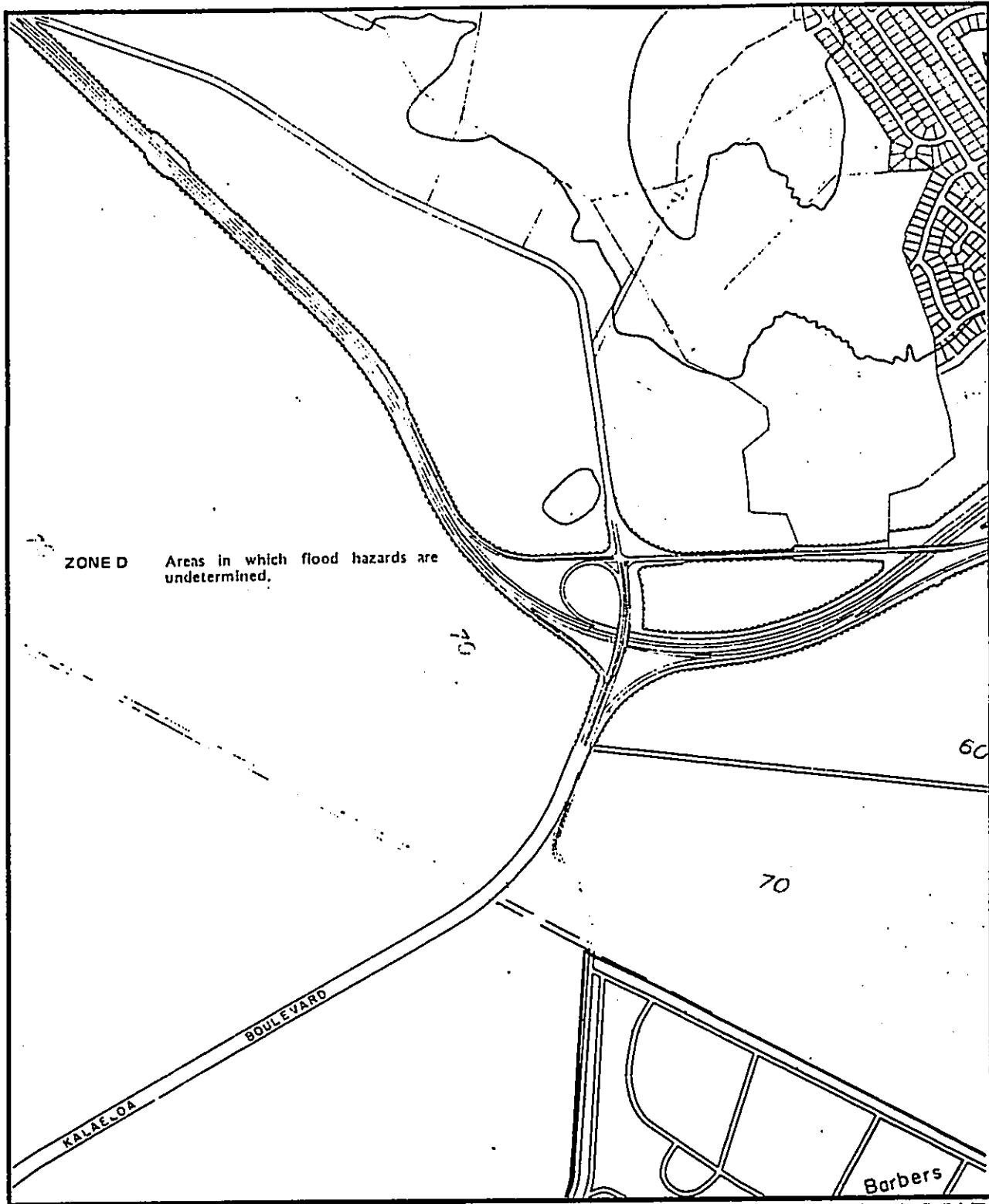

SMA FLOOD ZONE  
 Oahu, Hawaii  
 Campbell Industrial Park Fire/  
 Ambulance Station

FLOOD HAZARD MAP  
 FIGURE 3

#### IV. SUMMARY OF MAJOR IMPACTS AND MITIGATIVE MEASURES

##### A. Impacts

Impacts due to the implementation of the proposed project improvements can be viewed in two areas: short and long term. Short term impacts, beneficial and adverse, generally result from construction related activities. These are consequently of short duration and are related and limited to the construction phase of site improvements, i.e. on site and structural. Topographic alterations will result from the onsite grading necessary to provide an even and stable building platform for the structural improvements. Other onsite improvements will be to:

- provide ready access for the emergency fire and ambulance vehicles to meet their mission of instant response;
- the connection of the onsite utilities;
- the onsite drainage improvements to tie in with the drainage master plan system;
- and the visual aesthetics of the future Kapolei Industrial Park design plan that is based on a low-rise campus-like configuration and treatment.

Long term impacts result from the implementation and operation of the proposed project.

These include the following:

Increased emergency activities due to the urbanization Kapolei Second City, as well as the Kapolei Industrial Park.

##### B. Mitigative Measures

Short term or construction related impacts will be contractor responsibility to adhere to the State Department of Health Regulations on Community Noise for Oahu. This will be done by avoiding the "gunning" of equipment; working only during the normal operating hours of 7:00 a.m. to 3:30 p.m.; and installing appropriate muffler noise abatement devices on all construction equipment. Fugitive Dust will be abated by adhering to the State Department of Health Regulations on Air Quality. Frequent street watering; lay on of dust control materials; and exposing only a minimum of earth at a time. Fortunately, the prevailing zoning is I-2 and there are no residential districts adjacent to the Station site.

## V. ALTERNATIVES

The selected site location took into consideration the existing and future industrial/commercial development within the Kapolei Industrial Park, as well as the existing Campbell Industrial park. The decision to place the Station Facilities at the designated north-east corner was based on ready ingress and egress for emergency vehicles to H-1, and Farrington Highway. Other areas were evaluated and discarded due to the existing Fire Stations located there for the emergency protection of Makakilo, and the Waianae Coast.

The continued planned development at Ko Olina and other urban approved sectors will require station sites of their own. This site will be essentially an industrial station, and also act as the Battalion Chief's Headquarters.

The "No Action" alternative would have resulted in the selected site remaining unused and the ability to respond to emergency calls within the Industrial Park would not be available.

## VI. DETERMINATION, FINDINGS, AND REASONS SUPPORTING DETERMINATION

After completing an assessment of the potential environmental effects of the proposed action, and consulting with other government agencies, it has been determined that a Notice of Negative Declaration can be anticipated. This will be completed after the pre-agency consultation period and Draft Environmental Assessment has been posted in the OEQC Bulletin. The policies, guidelines, and provisions of Chapters 342, 343, and 344 Hawaii Revised Statutes were consulted in the evaluation process.

1. The proposed project will not adversely affect the physical and social environment. There may be minor discomfort and annoyances to the Kalaeloa Road traffic during construction, but these will be mitigated by adherence to applicable City traffic control ordinances. Increased operational traffic once the Station Facility is completed will also result.
2. There will be no permanent degradation of the existing ambient air quality and community noise levels. During the construction phase, the air and noise standards will be temporarily affected, but these effects will be temporary and short term in nature.
3. No residences or businesses will be disrupted by the project. The site is part of the Campbell Industrial Park, and will be a vital addition to their Master Planned industrial Park community.
4. There are no endangered plant species on the project site, and the prevailing flora and fauna are exotic or introduced species.
5. There are no known natural, historic, or archaeological sites within the project's metes and bounds.
6. The project will be consistent with the prevailing Land Use District Urban designation; the Development Plan Facilities Map; and the Zoning designation of I-2.
7. There are no significant adverse secondary effects on population, future development, and public facilities due to this project.

## VII. FUNDING AND PHASING

This Project will be funded entirely by the City & County of Honolulu. All improvements will be designed and built to County Building code standards. Construction will commence after all required permits have been processed and completed. Construction costs are estimated to be \$2,900,000.00 for the fire station and the work will be completed in the first phase. The ambulance station is estimated at \$300,000.00 and is designated as a future project. Funding will be solely from the City & County of Honolulu.



VIII. LIST OF AGENCIES CONSULTED DURING THE PREPARATION OF THE ENVIRONMENTAL ASSESSMENT

ORGANIZATIONS AND AGENCIES:

<u>Agency</u>	<u>Date of Consultation</u> <u>MARCH 23, 1993</u>	<u>Date</u> <u>Comment</u> <u>Received</u>
<u>State of Hawaii</u>		
Mr. Harold Masumoto, Director Office of State Planning		4-19-93
Mr. Keith W. Ahue, Chair State Dept. of Land & Natural Resources		4-26-93
Dr. Bruce Anderson, Dep. Director State Dept. of Health		
Mr. T. Harano, Chief Highways Division State Dept. of Transportation		4-9-93
Mr. Mufi Hanneman, Director Department of Business and Economic Development		
<u>City &amp; County of Honolulu</u>		
Mr. Robin Foster Planning Dept.		4-27-93
Mr. Donald A. Clegg, Director Dept. of Land Utilization		4-30-93
Mr. C. Michael Street, Ch. Engr. Dept. of Public Works		4-5-93
Mr. Joseph N. Magaldi, Director Dept. of Trans. Services		4-27-93
Mr. Michael S. Nakamura, Chief Honolulu Police Department		4-15-93
Mr. Donald Chang, Chief Honolulu Fire Department		4-19-93
<i>Campbell Industrial Park Fire/ Ambulance Station</i>	13	<i>May 19, 1993</i>

ORGANIZATIONS AND AGENCIES:

Agency

Date of Consultation  
MARCH 23, 1993

Date  
Comment  
Received

Mr. Kazu Hayashida, Manager  
Board of Water Supply

4-27-93

Mr. John DeSoto  
City Council

Ewa Neighborhood Board # 23

Mr. David W. Rae  
Manager, Community Development  
Estate of James Campbell

4-6-93

*Campbell Industrial Park Fire/  
Ambulance Station*

14

*May 19, 1993*

**IX. LIST OF PREPARERS**

Joseph H. Lancor Architects, Inc. - Site Design

Parametrix, Inc. - Environmental Assessment

DEPARTMENT OF LAND UTILIZATION  
CITY AND COUNTY OF HONOLULU  
630 SOUTH KING STREET  
HONOLULU, HAWAII 96813 & 96814-2123

**REVIEWED**  
APR 30 1993



FRANK P. FARR  
DIRECTOR



HERBERT K. MURAOKA  
DIRECTOR AND BUILDING SUPERINTENDENT

April 29, 1993

PB 93-497

Mr. Fred Rodriguez  
Parametrix, Inc.  
1164 Bishop Street, Suite 1600  
Honolulu, Hawaii 96813

MEMO TO: DONALD A. CLEGG, DIRECTOR  
DEPARTMENT OF LAND UTILIZATION

FROM: HERBERT K. MURAOKA  
DIRECTOR AND BUILDING SUPERINTENDENT

SUBJECT: PRE-AGENCY COMMENTS ON THE PROPOSED  
CAMPBELL INDUSTRIAL PARK FIRE STATION  
DRAFT ENVIRONMENTAL ASSESSMENT (EA)

Dear Mr. Rodriguez:

Draft Environmental Assessment (EA) for Campbell Industrial  
Park Battalion Headquarters Fire Station. TK: 9-1-15: 14

Thank you for allowing the Department of Land Utilization (DLU) the opportunity to review and comment on the above-mentioned Environmental Assessment. We note that page 9 of the EA estimates the cost of construction for the fire station at 0 dollars. This is likely a typographical error, which we assume will be corrected in the final EA.

Should you have any questions, please contact Mr. Art Challacombe of our staff at 523-4107.

Very truly yours,  
*Donald Clegg*  
DONALD A. CLEGG  
Director of Land Utilization

DAC:ak  
eastira.doc

We have received your letter dated April 29, 1993 to Parametrix, Inc. regarding the subject EA and provide the following response:

The estimated construction cost figure will be provided in the Draft EA. There was no preliminary estimate available at the time of the pre-agency EA.

Thank you for your timely review and cooperation.

*Herbert K. Muraoka*  
HERBERT K. MURAOKA  
Director and Building Superintendent

cc: Joseph Lancor Architects, Inc.

**RECEIVED**  
APR 26 1993

PARAMETRIX, INC.  
HONOLULU



STATE OF HAWAII  
DEPARTMENT OF LAND AND NATURAL RESOURCES  
P. O. BOX 621  
HONOLULU, HAWAII 96809

GENERAL AND SPECIAL  
LAND AND NATURAL RESOURCES  
SERVICES  
ADVISORY STAFF  
DONALD MALLER

AGRICULTURE DEVELOPMENT  
PROGRAM  
SOIL CONSERVATION  
PLANTATION AND RECREATION  
CONSERVATION AND  
ENVIRONMENTAL AFFAIRS  
CONSERVATION AND  
RECREATION  
AGRICULTURE DEVELOPMENT  
PROGRAM  
SOIL CONSERVATION  
PLANTATION AND RECREATION  
CONSERVATION AND  
ENVIRONMENTAL AFFAIRS  
CONSERVATION AND  
RECREATION

File No.: 93-524  
DOC. NO.: 2633

APR 22 1993

Mr. Fred Rodriguez  
Parametrix, Inc.  
1164 Bishop Street, Suite 1600  
Honolulu, Hawaii 96813

Dear Mr. Rodriguez:

Subject: Draft Environmental Assessment (DEA): Campbell Industrial Park  
Battalion Headquarters Fire Station, Pua, Oahu, TMK: 9-1-15:  
Por. 12

We have reviewed the DEA information for the subject project transmitted  
by your letter received on March 29, 1993, and have the following comments:

- The tax map key number (TMK) listed in the Summary (page 1) is  
incorrectly indicated as 9-1-15: 1414 A-5. As shown on the  
Project Location Map (Figure 1), the correct TMK would be  
9-1-15: portion 12. Parcel 12 is an approximately 192.07 acre  
parcel owned by James Campbell Trust Estate.
- The construction cost in Section VII. FINDING AND CONSTRUCTION  
(page 9) appears to be mistakenly represented as \$,0,000,000.00.

We will forward our Historic Preservation Division comments as they become  
available.

We have no other comments to offer at this time. Thank you for the  
opportunity to comment on this matter.

Please feel free to call Steve Tagawa at our Office of Conservation and  
Environmental Affairs, at 587-0377, should you have any questions.

Very truly yours,

*Keith W. Ahue*  
KEITH W. AHUE

BUILDING DEPARTMENT  
CITY AND COUNTY OF HONOLULU  
HONOLULU MUNICIPAL BUILDING  
430 SOUTH KING STREET  
HONOLULU, HAWAII 96813



HERBERT K. MURAOKA  
DIRECTOR OF BUILDING SUPERINTENDENT  
DEPUTY

PB 93-498

May 12, 1993

Mr. Keith W. Ahue, Chairman  
Board of Land and Natural Resources  
State of Hawaii  
P.O. Box 621  
Honolulu, Hawaii 96809

Dear Mr. Ahue:

Subject: Pre-Agency Comments on the Proposed  
Campbell Industrial Park Fire Station  
Draft Environmental Assessment (EA)

We have received your letter dated April 22, 1993 to  
Parametrix, Inc. regarding the subject EA and provide the  
following response:

1. The TMK is presently an unresolved issue. It is  
anticipated that the actual TMK will be established  
shortly. However, it is correct that the TMK at this  
time is 9-1-15:12.
2. The estimated construction cost will be provided in the  
Draft EA that will be published in the OEQC Bulletin.  
Thank you for calling this omission to our attention.

Thank you for your timely review and cooperation.

Very truly yours,

*Herbert K. Muraoka*  
HERBERT K. MURAOKA

Director and Building Superintendent

cc: Joseph Lancor Architects, Inc.

BOARD OF WATER SUPPLY  
CITY AND COUNTY OF HONOLULU  
630 SOUTH BERETANIA STREET  
HONOLULU HAWAII 96813



APR 27 1993

PARAMETRIX, INC.  
HONOLULU April 21, 1993

Mr. F.J. Rodriguez  
Parametrix, Inc.  
1164 Bishop Street, Suite 1600  
Honolulu, Hawaii 96813

Dear Mr. Rodriguez:

Subject: Your Letter Regarding Draft Environmental Assessment (EA) for the  
Proposed Campbell Industrial Park Battalion Headquarters Fire Station,  
TMK: 2-1-15: 1414 A-5, Kalahele Boulevard

Thank you for allowing us to comment on the Draft EA for the Proposed Campbell  
Industrial Park Battalion Headquarters Fire Station. We have the following comments:

1. The Estate of James Campbell has allocated water for the proposed project  
from Hawaiian Electric Company's Waiiau source.
2. The availability of water will be confirmed when the building permit  
application is submitted for our review and approval.
3. If a three-inch or larger meter is required to accommodate the project,  
construction drawings showing the installation of the meter should be  
submitted for our review and approval.
4. A Board of Water Supply approved reduced pressure principle backflow  
prevention assembly should be installed on the domestic water service  
immediately after the property valve and prior to any branch piping.

If you have any questions, please contact Roy Doi at 527-5121.

Very truly yours,

KAZU HAYASHIDA  
Manager and Chief Engineer

BUILDING DEPARTMENT  
CITY AND COUNTY OF HONOLULU

HONOLULU MUNICIPAL BUILDING  
200 SOUTH BERETANIA STREET  
HONOLULU, HAWAII 96813



May 12, 1993

PB 93-488

MEMO TO: KAZU HAYASHIDA, MANAGER AND CHIEF ENGINEER  
BOARD OF WATER SUPPLY

FROM: HERBERT K. MURAOKA  
DIRECTOR AND BUILDING SUPERINTENDENT

SUBJECT: PRE-AGENCY COMMENTS ON THE PROPOSED  
CAMPBELL INDUSTRIAL PARK FIRE STATION  
DRAFT ENVIRONMENTAL ASSESSMENT (EA)

We have received your letter dated April 21, 1993 to  
Parametrix, Inc. regarding the subject EA and provide the  
following response:

1. Allocation of available water via the Estate of James  
Campbell is acknowledged.
2. Confirmation of available water will be finalized with  
the submittal of final construction drawings. The  
meter size will be determined during design and  
necessary details will be provided in the drawings.
3. The inclusion of a backflow preventer is acknowledged  
and will be incorporated into the construction  
drawings.

Thank you for your timely review and cooperation.

Very truly yours,

HERBERT K. MURAOKA  
Director and Building Superintendent

cc: Joseph Lancor Architects, Inc.

**RECEIVED**

APR 27 1993

FRANK P. FAS...

PARAMETRIX, INC.  
HONOLULU

DEPARTMENT OF TRANSPORTATION SERVICES  
**CITY AND COUNTY OF HONOLULU**

HONOLULU MUNICIPAL BUILDING  
400 SOUTH KING STREET  
HONOLULU, HAWAII 96813



JOSEPH M. MAGALDI, JR.  
DIRECTOR

AMERISAPAL  
DRAFT ENVIRONMENTAL ASSESSMENT

TE-1215  
PL93.1.118

April 23, 1993

Mr. F. J. Rodriguez  
Parametrix, Inc.  
1164 Bishop Street, Suite 1600  
Honolulu, Hawaii 96813

Dear Mr. Rodriguez:

Subject: Campbell Industrial Park Battalion Headquarters  
Fire Station, Draft Environmental Assessment  
TKK: 9-1-15: Portion of 12

This is in response to your request to review the Draft  
Environmental Assessment received on March 29, 1993.

Based on our review, we have the following comments:

1. A site plan showing the proposed access points to the fire station should be included in subsequent submittals.
2. Construction plans for all work within the City right-of-way should be submitted to our department for review. A traffic control plan should be included in these plans.

Should you have any questions, please contact Lance Watanabe of my staff at 523-4199.

Sincerely,

*[Signature]*  
JOSEPH M. MAGALDI, JR.  
Director

BUILDING DEPARTMENT  
**CITY AND COUNTY OF HONOLULU**

HONOLULU MUNICIPAL BUILDING  
400 SOUTH KING STREET  
HONOLULU, HAWAII 96813



FRANK P. FAS...

HERBERT K. HURAOKA  
DIRECTOR AND BUILDING SUPERINTENDENT

May 12, 1993

May 12, 1993

MEMO TO: JOSEPH M. MAGALDI, JR., DIRECTOR  
DEPARTMENT OF TRANSPORTATION SERVICES

FROM: HERBERT K. HURAOKA  
DIRECTOR AND BUILDING SUPERINTENDENT

SUBJECT: PRE-AGENCY COMMENTS ON THE PROPOSED  
CAMPBELL INDUSTRIAL PARK FIRE STATION  
DRAFT ENVIRONMENTAL ASSESSMENT (EA)

We have received your letter dated April 23, 1993 to Parametrix, Inc. regarding the subject EA and provide the following response:

1. A Site Plan showing proposed access points to the fire station will be provided in future submittals.
2. Final construction drawings will be provided for agency review to all applicable agencies. A traffic control plan will be included if it is determined if there is any work within the City Right-of-Way.

Thank you for your timely review and cooperation.

*[Signature]*  
HERBERT K. HURAOKA  
Director and Building Superintendent

cc: Joseph Lancor Architects, Inc.

PLANNING DEPARTMENT  
CITY AND COUNTY OF HONOLULU  
430 SOUTH KING STREET  
HONOLULU, HAWAII 96813

**RECEIVED**  
APR 27 1993



ROBIN FOSTER  
CHIEF PLANNING OFFICER  
HONOLULU  
HH 3/93-841

BUILDING DEPARTMENT  
CITY AND COUNTY OF HONOLULU  
HONOLULU PUBLIC WORKS BUILDING  
215 SOUTH KING STREET  
HONOLULU, HAWAII 96813



PB 93-490

April 21, 1993

May 12, 1993

Mr. F. J. Rodriguez  
Parametrix, Inc.  
1164 Bishop Street, Suite 1600  
Honolulu, Hawaii 96813

MEMO TO: ROBIN FOSTER, CHIEF PLANNING OFFICER  
PLANNING DEPARTMENT

FROM: HERBERT K. MURAOKA  
DIRECTOR AND BUILDING SUPERINTENDENT

Draft Environmental Assessment (DEA) for  
Campbell Industrial Park Battalion Headquarters  
Fire Station, Eva, Oahu

SUBJECT: PRE-AGENCY COMMENTS ON THE PROPOSED  
CAMPBELL INDUSTRIAL PARK FIRE STATION  
DRAFT ENVIRONMENTAL ASSESSMENT (DEA)

In response to your request, we have reviewed the subject  
DEA and offer the following comments:

We have received your letter dated April 21, 1993 to  
Parametrix, Inc. regarding the subject EA and provide the  
following response:

1. The proposed project site is consistent with the current Industrial use designation on the Eva Development Plan Land Use Map.
2. A portion of the Eva Development Plan Public Facilities Map was amended on March 10, 1992, by adding a symbol for a publicly funded fire station, site determined within six years. (see attached Ordinance No. 92-10).

1. Eva Development Plan Industrial designation is acknowledged.
2. Eva Development Plan Public Facilities Map amendment is acknowledged.

Thank you for your timely review and cooperation.

Should you have any questions, please contact Matthew Higashida of our staff at 527-6056.

Sincerely,

ROBIN FOSTER  
Chief Planning Officer

  
HERBERT K. MURAOKA  
Director and Building Superintendent

cc: Joseph Lancor Architects, Inc.

RF:lh

Attachment

cc: Office of Environmental Quality Control  
Building Department  
Honolulu Fire Department



FIRE DEPARTMENT  
CITY AND COUNTY OF HONOLULU  
3375 EQUIVALENT STREET SUITE 403  
HONOLULU, HAWAII 96818



FRANK P. FASI  
-41000

DONALD S. M. CHANG  
FIRE CHIEF  
RICHARD S. SETO-MOOKA  
DEPUTY FIRE CHIEF

April 16, 1993

RECEIVED  
APR 19 1993  
PARAMETRIX, INC.  
HONOLULU

Mr. F. J. Rodriguez  
Parametrix, Inc.  
1164 Bishop Street, Suite 1600  
Honolulu, Hawaii 96813

SUBJECT: ENVIRONMENTAL ASSESSMENT  
CAMPBELL INDUSTRIAL PARK  
BATTALION HEADQUARTERS FIRE STATION

We have reviewed the subject material provided and our  
recommendations are noted in red.

Should you have any questions, please call Assistant Chief Attilio  
Leonardi of our Administrative Services Bureau at 831-7775.

Sincerely,

DONALD S. M. CHANG  
Fire Chief

AKL:ny  
Attachment

BUILDING DEPARTMENT  
CITY AND COUNTY OF HONOLULU  
3375 EQUIVALENT STREET SUITE 403  
HONOLULU, HAWAII 96818



FRANK P. FASI  
-41000

HERBERT K. MURAOKA  
DIRECTOR AND BUILDING SUPERINTENDENT

PB 93-491

May 12, 1993

MEMO TO: DONALD S. M. CHANG, FIRE CHIEF  
HONOLULU FIRE DEPARTMENT

FROM: HERBERT K. MURAOKA  
DIRECTOR AND BUILDING SUPERINTENDENT

SUBJECT: PRE-AGENCY COMMENTS ON THE PROPOSED  
CAMPBELL INDUSTRIAL PARK FIRE STATION  
DRAFT ENVIRONMENTAL ASSESSMENT (EA)

We have received your letter dated April 16, 1993 to  
Parametrix, Inc. regarding the subject EA and provide the  
following response:

The corrections and revisions indicated in red have been  
made. The subsequent Draft EA will be circulated to all  
concerned parties and will be published in the OEQC Bulletin  
for thirty days.

Thank you for your timely review and cooperation.

HERBERT K. MURAOKA  
Director and Building Superintendent

cc: Joseph Lancer Architects, Inc.

RECEIVED  
APR 13 1993

**OFFICE OF STATE PLANNING**



Office of the Governor  
MAILING ADDRESS: P.O. BOX 3548 HONOLULU, HAWAII 96811-3548  
STREET ADDRESS: 206 SOUTH HOTEL STREET, 4TH FLOOR  
TELEPHONE: (808) 587-3344 347-2389

Ref. No. P-4201

April 14 1993

Mr. F.J. Rodriguez  
c/o Parametrix, Inc.  
1164 Bishop Street, Suite 1600  
Honolulu, Hawaii 96813

Dear Mr. Rodriguez:

Subject: Draft Environmental Assessment for Campbell Industrial  
Park Battalion Headquarters Fire Station

We have reviewed the Draft Environmental Assessment for the Campbell  
Industrial Park Battalion Headquarters Fire Station and do not have any  
comments to offer.

We appreciate very much the opportunity to review the proposal.

*Harold S. Masumoto*  
Harold S. Masumoto  
Director

**BUILDING DEPARTMENT  
CITY AND COUNTY OF HONOLULU**

HONOLULU MUNICIPAL BUILDING  
180 SOUTH KING STREET  
HONOLULU, HAWAII 96813



PERMITS SECTION  
MAY 10 1993

HERBERT X. MURAOKA  
DIRECTOR AND BUILDING SUPERINTENDENT  
MAY 10 1993

PB 93-492

May 12, 1993

Mr. Harold S. Masumoto, Director  
Office of State Planning  
Office of the Governor  
250 South Hotel Street, 4th Floor  
Honolulu, Hawaii 96813

Dear Mr. Masumoto:

Subject: Pre-Agency Comments on the Proposed  
Campbell Industrial Park Fire Station  
Draft Environmental Assessment (EA)

We have received your letter dated April 14, 1993 to  
Parametrix, Inc. regarding the subject EA and the acknowledgement  
of "no comments to offer" is duly noted.

Thank you for your timely review and cooperation.

Very truly yours,

*Herbert X. Muraoka*  
HERBERT X. MURAOKA  
Director and Building Superintendent

cc: Joseph Lancor Architects, Inc.

POLICE DEPARTMENT  
CITY AND COUNTY OF HONOLULU  
891 SOUTH BERTANHA STREET  
HONOLULU, HAWAII 96813 - AREA CODE (808) 535-3111



FRANK F. FASI  
MAYOR

RECEIVED  
APR 15 1993

MICHAEL S. NAKAMURA  
CHIEF  
HEROLD M. KAWASAKI  
DEPUTY CHIEF

FRANK F. FASI  
MAYOR



HERBERT K. MURAOKA  
DIRECTOR AND BUILDING SUPERINTENDENT

OUR REFERENCE BS-LX

April 13, 1993 HONOLULU  
PARAMETRIX, INC.

May 12, 1993

PB 93-493

Mr. F. J. Rodriguez  
Parametrix, Inc.  
1164 Bishop Street, Suite 1600  
Honolulu, Hawaii 96813

Dear Mr. Rodriguez:

This is in response to your request for comments on the environmental assessment for the Campbell Industrial Park Battalion Headquarters Fire Station.

The Honolulu Police Department notes that the environmental assessment adequately discusses the mitigation of short term adverse impacts arising from construction-related activities. We have no further comments to make at this time.

Thank you for the opportunity to review this document.

Sincerely,

MICHAEL S. NAKAMURA  
Chief of Police

*Michael S. Nakamura*  
By  
CHESTER E. HUGHES  
Assistant Chief of Police

MEMO TO: MICHAEL NAKAMURA, POLICE CHIEF  
HONOLULU POLICE DEPARTMENT

FROM: HERBERT K. MURAOKA  
DIRECTOR AND BUILDING SUPERINTENDENT

SUBJECT: PRE-AGENCY COMMENTS ON THE PROPOSED  
CAMPBELL INDUSTRIAL PARK FIRE STATION  
DRAFT ENVIRONMENTAL ASSESSMENT (EA)

We have received your letter dated April 13, 1993 to Parametrix, Inc. regarding the subject EA and your acknowledgement of no significant impact is duly noted.

Thank you for your timely review and cooperation.

*Herbert K. Muraoka*

HERBERT K. MURAOKA  
Director and Building Superintendent

cc: Joseph Lancor Architects, Inc.

JOHN WARD  
CHIEF

**RECEIVED**  
APR 9 1993



PARAMETRIX, INC. DEPARTMENT OF TRANSPORTATION  
HONOLULU  
180 PUNCHBOWL STREET  
HONOLULU, HAWAII 96813  
April 8, 1993

READ JOHNSON  
DIRECTOR  
DEPUTY DIRECTORS  
JOYCE T. OARNE  
AL FANG  
JEANNE K. SCHELTZ  
CALVIN L. TSOUL

BY REPLY REFER TO:

HUY-PS  
2-6298

FRANK F. FARM  
MAY 1993

BUILDING DEPARTMENT  
CITY AND COUNTY OF HONOLULU  
HONOLULU MUNICIPAL BUILDING  
830 SOUTH KING STREET  
HONOLULU, HAWAII 96813



HERBERT K. MURAKA  
DIRECTOR OF BUILDING DEPARTMENT  
TELEPHONE REGULAR  
EXT. 2111

DB 93-494

May 12, 1993

Mr. Fred J. Rodriguez  
Parametrix, Inc.  
1164 Bishop Street, Suite 1600  
Honolulu, Hawaii 96813

Dear Mr. Rodriguez:

Draft Environmental Assessment of Campbell Industrial  
Park Battalion Headquarters Fire Station  
Campbell Industrial Park, Ewa, Oahu, TMK: 9-1-15: 1414 A-5

Please coordinate your access plans with our Highways Division.  
Plans for any construction work within our State highway  
right-of-way must be submitted for our review and approval.

Sincerely,

*[Signature]*  
Rex D. Johnson  
Director of Transportation

Mr. Rex D. Johnson, Director  
Department of Transportation  
State of Hawaii  
869 Punchbowl Street  
Honolulu, Hawaii 96813-5097

Dear Mr. Johnson:

Subject: Pre-Agency Comments on the Proposed  
Campbell Industrial Park Fire Station  
Draft Environmental Assessment (EA)

We have received your letter dated April 8, 1993 to  
Parametrix, Inc. regarding the subject EA and provide the  
following response:

Access plans will be provided to the Highways Division for  
review and approval.

Thank you for your timely review and cooperation.

Very truly yours,

*[Signature]*  
HERBERT K. MURAKA  
Director and Building Superintendent

cc: Joseph Lancor Architects, Inc.

RECEIVED

THE ESTATE OF JAMES CAMPBELL

APR 6 1993

PARAMETRIX, INC.  
HONOLULU

April 5, 1993

Mr. F. J. Rodriguez  
Parametrix Inc.  
1164 Bishop Street, Suite 1600  
Honolulu, HI 96813

Dear Mr. Rodriguez:

Draft Environmental Assessment (DES) for the Proposed  
Campbell Industrial Park Battalion Headquarters Fire Station

Thank you for the opportunity to comment on the Draft Environmental Assessment. The Estate of James Campbell is in complete accord with the construction of the proposed fire station and the ambulance facility. We have been working with the fire department and remain available for any future assistance that they or you may require.

We would like to recommend that the project designator name be changed to reflect its location in the Kapolei Business Park rather than the existing Campbell Industrial Park.

Thank you for your attention to this matter. Should you have any questions, please call me at 544-3117.

Very truly yours,

*D. W. Rae*

David W. Rae  
Manager, Community Development

kg-010031001K10009

BUILDING DEPARTMENT  
CITY AND COUNTY OF HONOLULU  
HONOLULU MUNICIPAL BUILDING  
530 SOUTH KING STREET  
HONOLULU, HAWAII 96813



HERBERT K. MURAKA  
DIRECTOR AND BUILDING SUPERINTENDENT  
HONOLULU, HAWAII 96813

PB 93-495

May 12, 1993

Mr. David Ray  
Community Development  
The Estate of James Campbell  
828 Fort Street, Suite 500  
Honolulu, Hawaii 96813

Dear Mr. Ray:

Subject: Pre-Agency Comments on the Proposed  
Campbell Industrial Park Fire Station  
Draft Environmental Assessment (EA)

We have received your letter dated April 8, 1993 to Parametrix, Inc. regarding the subject EA and provide the following response:

Your advice that the Campbell Estate is in accord with the proposed fire station and ambulance facility is duly noted and appreciated. Also, we will consider naming the station to reflect the newly emerging Kapolei Business Park.

Thank you for your timely review and cooperation.

Very truly yours,

*Herbert K. Muraka*

HERBERT K. MURAKA  
Director and Building Superintendent

cc: Joseph Lancor Architects, Inc.

DEPARTMENT OF PUBLIC WORKS  
CITY AND COUNTY OF HONOLULU  
400 SOUTH KING STREET  
HONOLULU HAWAII 96813



FRANK F. FARI  
DIRECTOR

March 31, 1993

Mr. F. J. Rodriguez  
Parametrix, Inc.  
1164 Bishop Street, Suite 1600  
Honolulu, Hawaii 96813

Dear Mr. Rodriguez:

Subject: Draft Environmental Assessment (DEA)  
Campbell Industrial Park Battalion Headquarters  
Kila Station. TMK:2-1-15:1414 A-5

We have reviewed the subject DEA and have the following comments:

1. The DEA should address the impact of storm water discharges associated with construction activities on water quality of the receiving waters.
2. The DEA should also state what structural or non-structural best management practice (BMP) will be provided to control and reduce the discharge or pollutants resulting from construction and/or dewatering operations.
3. If dewatering activity is anticipated, dewatering permits from the State Department of Health as well as the Department of Public Works, City and County of Honolulu, will be required.
4. An "Application for Sewer Connection" form should be submitted to our Division of Wastewater Management for review and approval.

Should you have any questions, please contact Mr. Alex Ho, Environmental Engineer, at 523-4150.

Very truly yours,

*C. Michael Street*  
C. MICHAEL STREET  
Director and Chief Engineer

BUILDING DEPARTMENT  
CITY AND COUNTY OF HONOLULU  
HONOLULU MUNICIPAL BUILDING  
430 SOUTH KING STREET  
HONOLULU HAWAII 96813



FRANK F. FARI  
DIRECTOR

C. MICHAEL STREET  
DIRECTOR AND CHIEF ENGINEER  
FELIX B. LUTERICO  
SENIOR ENGINEER

ENV 93-79

May 12, 1993

PB 93-496

MEMO TO: C. MICHAEL STREET, DIRECTOR AND CHIEF ENGINEER  
DEPARTMENT OF PUBLIC WORKS

FROM: HERBERT K. MURAOKA  
DIRECTOR AND BUILDING SUPERINTENDENT

SUBJECT: PRE-AGENCY COMMENTS ON THE PROPOSED  
CAMPBELL INDUSTRIAL PARK FIRE STATION  
DRAFT ENVIRONMENTAL ASSESSMENT (EA)

We have received your letter dated March 31, 1993 to Parametrix, Inc. regarding the subject EA and provide the following response:

1. At the present time, the potential impacts to the receiving water quality due to construction activities related to the construction of the Fire Station are an unknown quantity. This is due to the ambient physical conditions at the site and the extent of site preparation anticipated for the project. No significant runoff from the grading and site preparation for the project is anticipated. The contractor may be required to include runoff controls in his scope of work for bidding purposes.

2. There are no structural or Best Management Practices anticipated at this early stage to mitigate discharge of pollutants resulting from construction. The project architect may recommend certain BMP, but at this time, these are not under consideration.

3. No dewatering activities are anticipated at this time.

C. Michael Street  
Page 2  
May 12, 1993

4. The "Application for Sewer Connection" will be submitted for review and approval.

Thank you for your timely review and cooperation.

  
HERBERT K. MURAOKA  
Director and Building Superintendent

cc: Joseph Lancor Architects, Inc.