

JOHN WAIHEE
GOVERNOR



REX D. JOHNSON
DIRECTOR
DEPUTY DIRECTORS
JOYCE T. OMINE
AL PANG
JEANNE K. SCHULTZ
CALVIN M. TSUDA

RECEIVED

'93 JUL 27 AM 11:25

OFFICE OF ENVIRONMENTAL
QUALITY CONTROL

STATE OF HAWAII
DEPARTMENT OF TRANSPORTATION

869 PUNCHBOWL STREET
HONOLULU, HAWAII 96813-5097

July 15, 1993

IN REPLY REFER TO:

HWY-DD
2.7658

Mr. Brian J. J. Choy, Director
Office of Environmental Quality Control
220 South King Street, 4th Floor
Honolulu, Hawaii 96813

Dear Mr. Choy:

Subject: Negative Declaration for Interstate Route H-1
Eastbound Off-Ramp Improvements at Pali Highway
Project No. IM-IR-H1-1(216), TMK: 2-1-05:por.4
Honolulu, Oahu, Hawaii

The Department of Transportation has reviewed the comments received during the 30-day public comment period which began on April 8, 1993. The Department has determined that this project will not have significant environmental effect and has issued a negative declaration. The Federal Highway Administration has designated this project as a categorical exclusion under 23 CFR 771.117(d) which waives Federal EIS requirements. Please publish this notice in the August 8, 1993 OEQC Bulletin.

We have enclosed a completed OEQC Bulletin Publication Form and four (4) copies of the final EA. Please contact Mr. Albert Yamaguchi at 587-2235 if you have any questions.

Very truly yours,

A handwritten signature in black ink, appearing to read "T. Harano".

T. HARANO
Chief
Highways Division

Enc.

1993-08-08-0A-FEA - Interstate Route H-1 Eastbound

AUG 8 1993

Off Ramp Improvements at Pali Hwy

FINAL ENVIRONMENTAL ASSESSMENT
INTERSTATE ROUTE H-1
EASTBOUND OFF-RAMP IMPROVEMENTS AT PALI HIGHWAY
PROJECT NO. IM-IR-H1-1(216)
HONOLULU, OAHU
JULY 8, 1993

Proposing agency: Department of Transportation, Highways
Division

Agencies consulted:

State: Department of Land and Natural Resources
-Conservation and Environmental
Affairs
-State Historic Preservation Division

Department of Health
-Environmental Health Services
Division

Department of Business, Economic
Development and Tourism
-Land Use Commission

Office of State Planning

County: Department of Land Utilization

Citizen Group: Queen Emma Gardens Apartments-Tenant's
Association

Individual: Hawaiian Trust Company, Ltd., Trustee
Robert E. Black Memorial Trust

Project Characteristics:

General: The State of Hawaii, Department of
Transportation is proposing to implement a
roadway widening project to relieve traffic
congestion on the H-1 eastbound off-ramp at
Pali Highway (eastbound Ramp 21A). Ramp 21A
is located between the Nuuanu Avenue and Pali
Highway overpasses. Figure 1 shows the
project location.

Technical:

The proposed project consists of widening approximately 570 feet of Ramp 21A. The ramp will be widened from the existing two 12-foot lanes to three 12-foot lanes (Figure 2). Constructing an additional lane will require demolishing an existing retaining wall, building a new retaining wall, modifying the existing traffic signal, extending an overhead sign support, and relocating existing highway lighting. Figure 3 shows the proposed work.

The right-of-way boundary between H-1 and Queen Emma Gardens Apartments will be relocated southwest 0 to 20 feet. Approximately 4,800 square feet of additional right-of-way will be needed for the proposed project (Figure 4). Vegetation affected by construction will be reestablished by landscaping.

Economic:

The construction costs for the proposed project will be \$250,000 for the State of Hawaii, and \$1,750,000 for the Federal Government. The State of Hawaii and the Federal Government will also compensate Hawaiian Trust Co., Ltd. for the additional land needed for the project.

Social:

The proposed project will benefit motorists by increasing the vehicle capacity of the ramp. The widening will provide a smoother transition from the H-1 to Pali Highway and decrease commuting time to downtown Honolulu.

Residents of Queen Emma Gardens Apartments will be affected by landscaping modifications around their picnic facility. Modifications will include tree removal or relocation, minor grading and replanting shrubbery along the new right-of-way.

Environmental:

The proposed project will not affect any substantial plant or animal habitats, native or otherwise. The increase in noise level caused by vehicular traffic being closer to the Queen Emma Gardens Apartments' picnic facility will be minimal. The increase in traffic flow will have no significant adverse effect on air quality, and aesthetics will be maintained to reflect existing conditions.

Summary of the Affected Environment

The roadway widening will enhance vehicular traffic flow within the area concerned, while having practically no long-term adverse impacts. There are no endangered flora, fauna, critical habitats, historical/archaeological or cultural sites at the location of the proposed project.

Summary of Major Impacts

Short Term:

During construction, the following minor adverse impacts are anticipated:

1. Some dust and noise
2. Traffic congestion along H-1 (eastbound) and on Ramp 21A during non-peak hours.
3. Limited access to Queen Emma Gardens Apartments' picnic facility.

Long Term:

Air Quality: No significant impact to the air quality is expected.

Noise: No significant noise impact is expected.

Traffic: No significant traffic impact is expected.

Archaeological: No significant archaeological impact is expected.

Flora: No significant impact on the flora is expected.

Fauna: No significant impact on the fauna is expected.

Visual: No significant visual impact is expected.

Alternatives Considered:

The "no-action" alternative was considered but deemed to be unacceptable because the benefits of providing the motoring public with a higher volume travelway outweigh the adverse impacts of this project.

Proposed Mitigation Measures:

1. The temporary dust and noise occurring during construction will be controlled by application of appropriate pollution control measures.
2. Temporary obstruction to traffic on Interstate Route H-1 and Ramp 21A will be controlled by application of appropriate traffic control measures.

Determination

The proposed roadway widening is not expected to cause significant environmental impacts.

Findings and Reasons Supporting Determination

1. The proposed project will not involve an irrevocable commitment to loss or destruction of any natural or cultural resources.
2. The proposed project will not curtail the range of beneficial uses of the environment.
3. The proposed project will not conflict with the State's long-term environmental policies.
4. The proposed project will not substantially affect the economic or social welfare of the community or State.
5. The proposed project will not involve substantial secondary impacts, such as population changes or effects on public facilities.
6. The proposed project will not involve a substantial degradation of environmental quality.
7. The proposed project will not substantially affect any rare, threatened, or endangered species of flora and fauna or habitat. No endangered species of flora or fauna are known to exist in the project site.
8. The proposed project will not detrimentally affect air quality, water quality, or ambient noise levels.

For the reasons above, the proposed project will not have any significant effect in the context of Chapter 343, Hawaii Revised Statutes and Section 11-200-12 of the State Administrative Rules.

RECEIVED AND ACCEPTANCE RECOMMENDED:

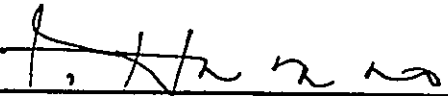

T. HARANO
Chief
Highways Division

7/20/93
Date

CONCURRENCE:

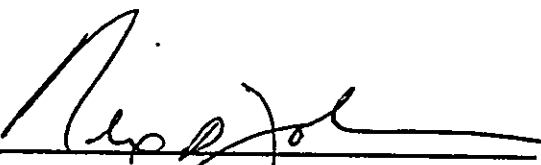

REX D. JOHNSON
Director of Transportation

7/21/93
Date

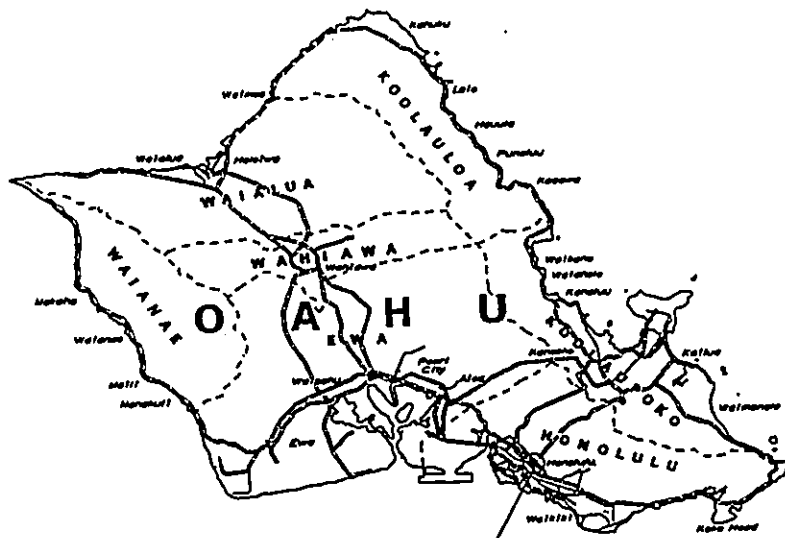

PROJECT LOCATION
F.A.P. NO. IM-IR-H1-1(216)

LOCATION MAP

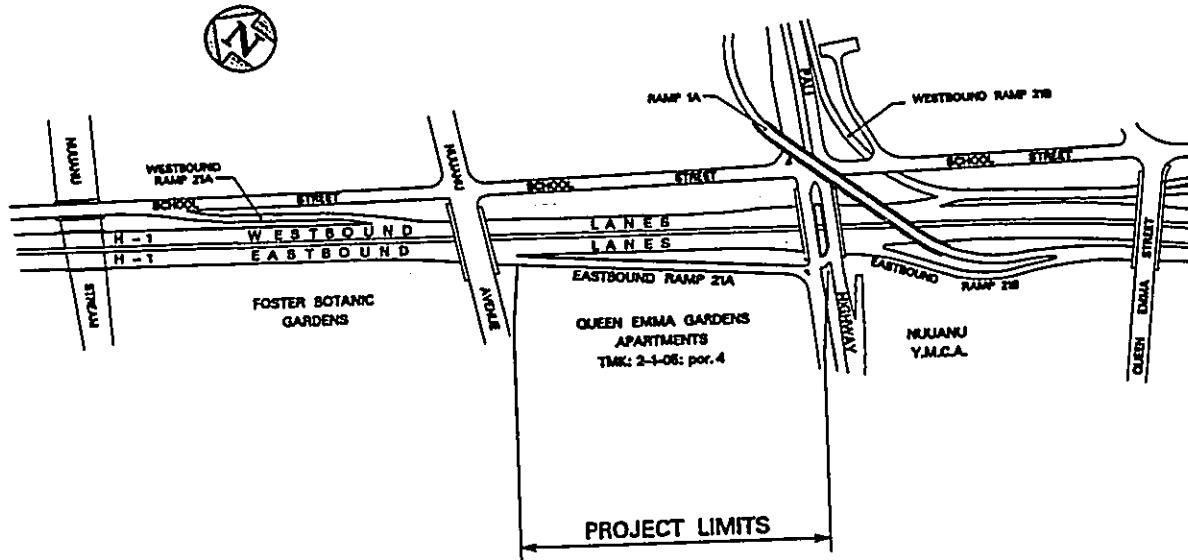

LAYOUT OF PROJECT

INTERSTATE ROUTE H-1
EASTBOUND OFF-RAMP IMPROVEMENTS AT PALI HIGHWAY
FEDERAL AID PROJECT NO. IM-IR-H1-1(216)

FIGURE 1

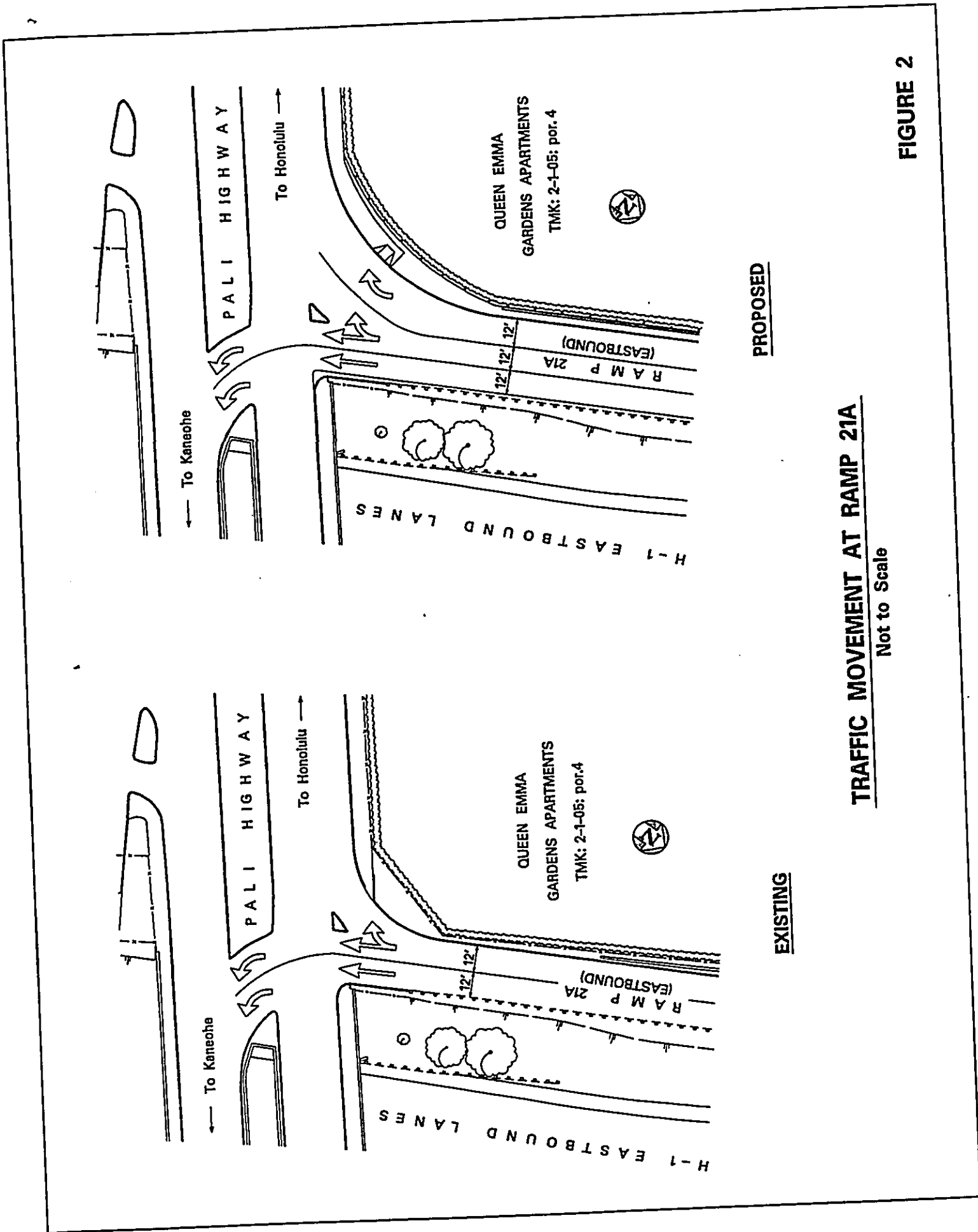

TRAFFIC MOVEMENT AT RAMP 21A
 Not to Scale

FIGURE 2

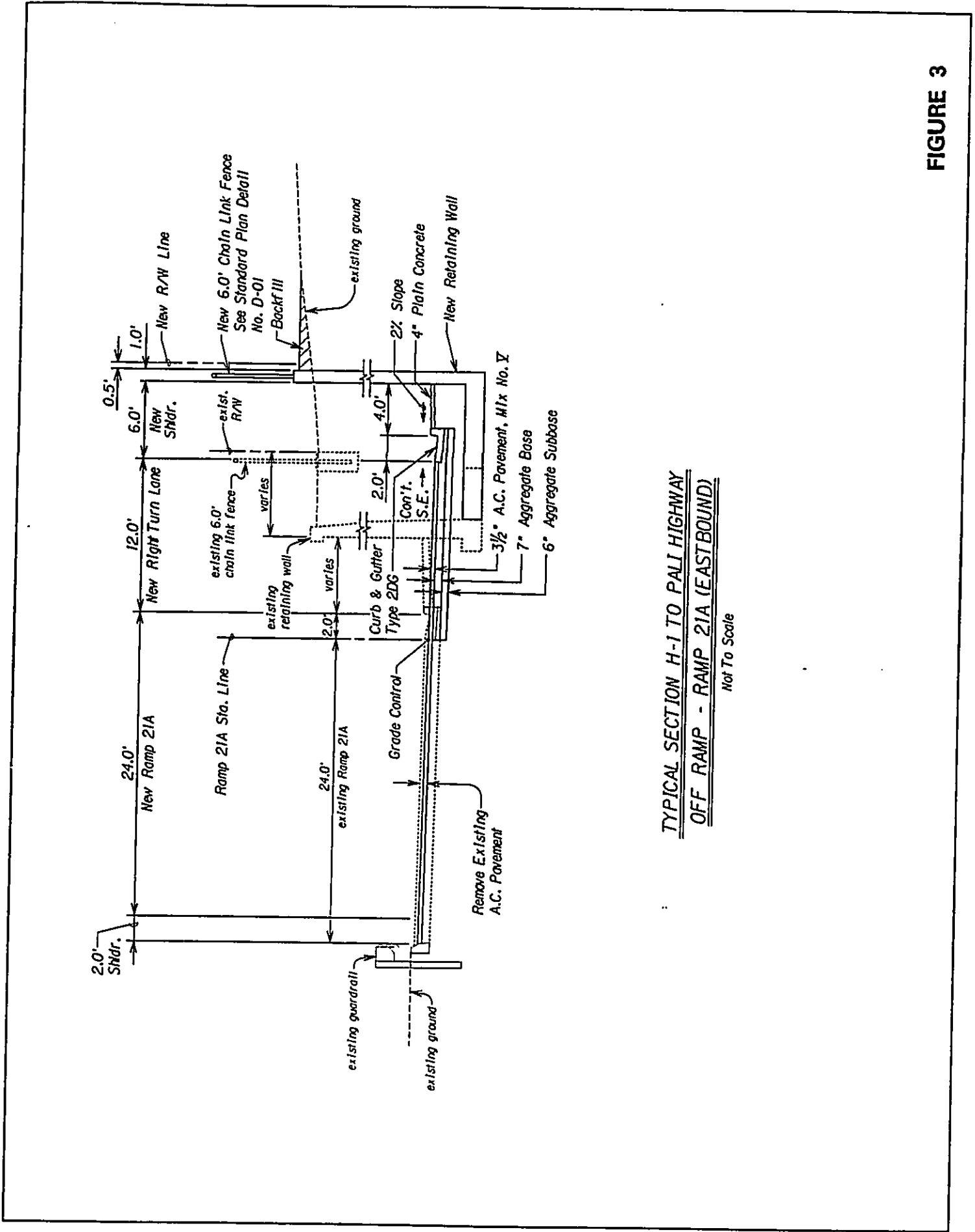

TYPICAL SECTION H-1 TO PALI HIGHWAY
OFF RAMP - RAMP 21A (EASTBOUND)

Not To Scale

FIGURE 3

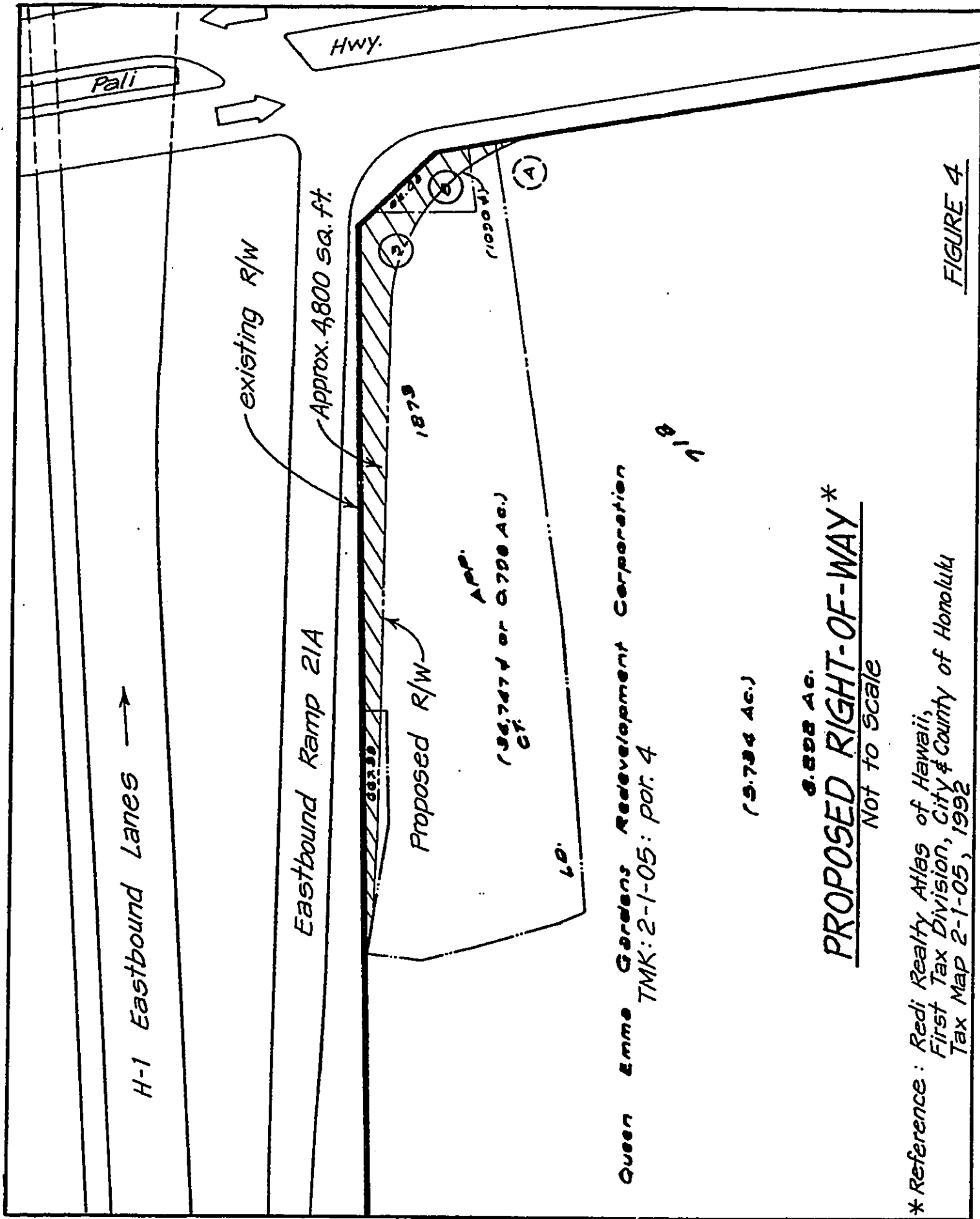

Queen Emma Gardens Redevelopment Corporation
 TMK: 2-1-05: par. 4

(2.734 Ac.)

0.698 Ac.

PROPOSED RIGHT-OF-WAY*
 Not to Scale

* Reference: Redi Realty Atlas of Hawaii,
 First Tax Division, City & County of Honolulu
 Tax Map 2-1-05, 1992

FIGURE 4