

JOHN WAIHEE
GOVERNOR



STATE OF HAWAII
DEPARTMENT OF ACCOUNTING AND GENERAL SERVICES
P. O. BOX 119, HONOLULU, HAWAII 96810

ROBERT P. TAKUSHI
COMPTROLLER

LLOYD I. UNEBASAMI
DEPUTY COMPTROLLER

LETTER NO. (P)1588.3

AUG 6 1993

OFFICE OF ENVIRONMENTAL
QUALITY CONTROL

'93 AUG -9 A7:45

RECEIVED

Mr. Brian J. J. Choy
Director
Office of Environmental
Quality Control
Central Pacific Plaza
220 South King Street, 4th Floor
Honolulu, Hawaii 96813

Dear Mr. Choy:

Subject: Negative Declaration for Maluhia Hospital
Upper Area Parking Improvement
TMK 1-6-9:04

The Department of Accounting and General Services has not received any comments during the 30-day public comment period which began on June 8, 1993. The agency has determined that this project will not have significant environmental effect and has issued a negative declaration. Please publish this notice in the August 23, 1993 OEQC Bulletin.

Enclosed are a completed OEQC Bulletin Publication Form and four copies of the final EA. If there are any questions, please have your staff call Mr. Ralph Yukumoto of the Planning Branch at 586-0488.

Very truly yours,

A handwritten signature in cursive script, appearing to read "Gordon Matsuoka".
GORDON MATSUOKA
State Public Works Engineer

RY:jk
Attachments

AUG 23 1993

1993-08-23-0A-FEA-Maluhia Hospital Upper Area Parking Improvement

FINAL ENVIRONMENTAL ASSESSMENT
MALUHIA HOSPITAL
UPPER AREA PARKING IMPROVEMENT
AUGUST 3, 1993

- A. PROPOSING AGENCY: Department of Accounting and General Services for the Department of Health.
- B. APPROVING AGENCY: Not applicable.
- C. AGENCY CONSULTED: Department of Health.
- D. GENERAL DESCRIPTION TECHNICAL, ECONOMIC, SOCIAL AND ENVIRONMENTAL CHARACTERISTICS:
1. Technical: This project is to improve the upper parking area by constructing the following:
 - a. Increase the number of parking stalls from 54 to at least 70, but not more than 75.
 - b. Repave the existing parking area.
 - c. Remove a chain link fence and relocate light poles in the parking area.
 - d. Realign and restripe the parking stalls.
 - e. Improve entrance and exit of parking area.
 2. Socio-Economic:
 - a. The proposed project will not create sufficient work to substantially impact the economy and welfare of the community and State.
 - b. The estimated cost of the project is \$112,000.
 - c. Since the project will be constructed within the existing hospital site, no land will be removed from the tax base.
 - d. The project will provide the hospital with a much improved parking facility to more effectively provide patient and staff services.
 4. Environmental:
 - a. The project will not create any major long-term environmental impacts.

- b. However, during construction, the air quality may be affected by dust and exhaust emissions and it is anticipated there will be a temporary increase in noise levels.
- c. These impacts are expected to be minimal since State and Federal regulations need to be met.

E. SUMMARY DESCRIPTION OF THE AFFECTED ENVIRONMENT, INCLUDING SITE MAPS:

- 1. The site of the proposed project is located on the hospital site (TMK 1-6-9:04), as shown in Figures 1 and 2.
- 2. No habitat of endangered species, flora or fauna are known to exist at the site.
- 3. No historical, archaeological or cultural sites are known to exist at the site.
- 4. The site is not in a Special Management Area.

F. IDENTIFICATION AND SUMMARY OF MAJOR IMPACTS AND ALTERNATIVES CONSIDERED:

- 1. Major Impacts: The proposed project will not:
 - a. Involve an irrevocable commitment to loss or destruction of any natural or cultural resources.
 - b. Curtail the range of beneficial uses of the environment.
 - c. Conflict with the State's long-term environmental policies.
 - d. Substantially affect the economic or social welfare of the community or State.
 - e. Involve substantial secondary impacts, such as population changes or effects on public facilities.
 - f. Involve a substantial degradation of environmental quality.

- g. Detrimentially affect air or water quality or ambient noise levels.
 - h. Be located in any environmentally sensitive area, such as a flood plain, tsunami zone, erosion-prone area, geologically hazardous land, estuary, fresh water, or coastal waters.
2. Alternatives to the Proposed Project: "No action" is not considered to be a viable or desirable alternative.
- G. PROPOSED MITIGATION MEASURES: Short-term impacts on air and noise quality during construction will be controlled by application of appropriate pollution and noise control.
- H. DETERMINATION: On the basis of the above assessment, it is concluded that the proposed project will not have a significant adverse impact on the environment.

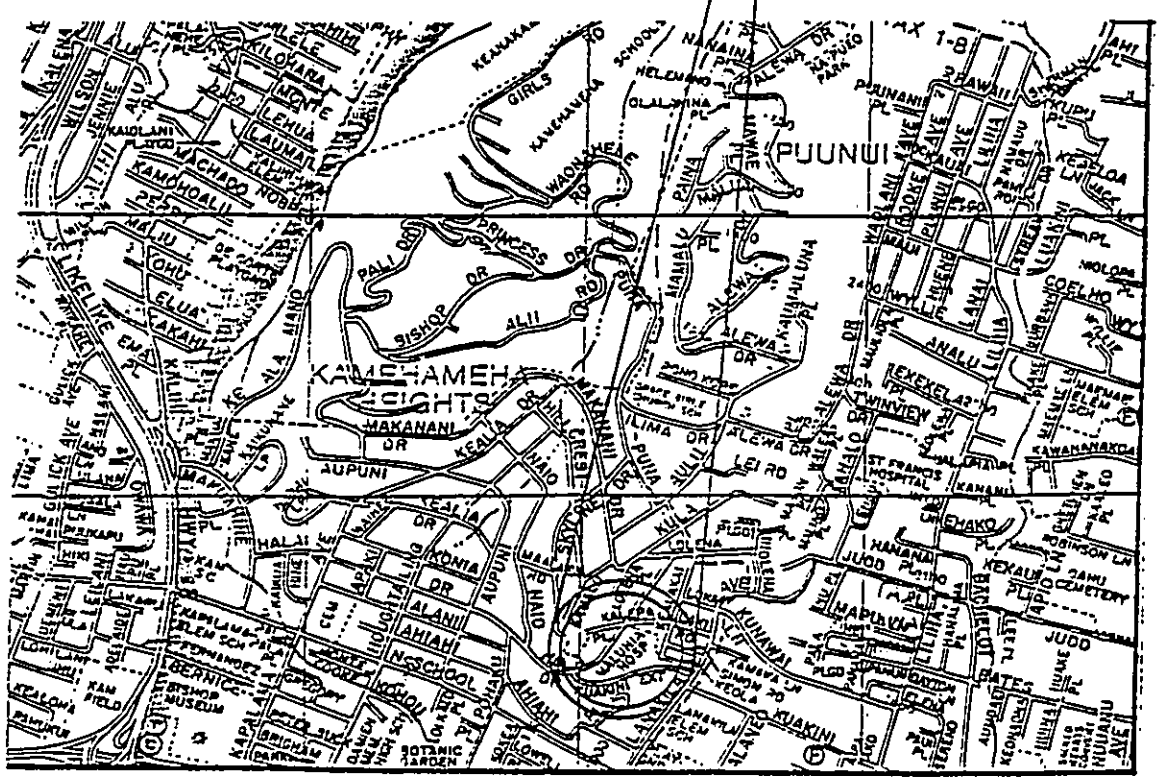
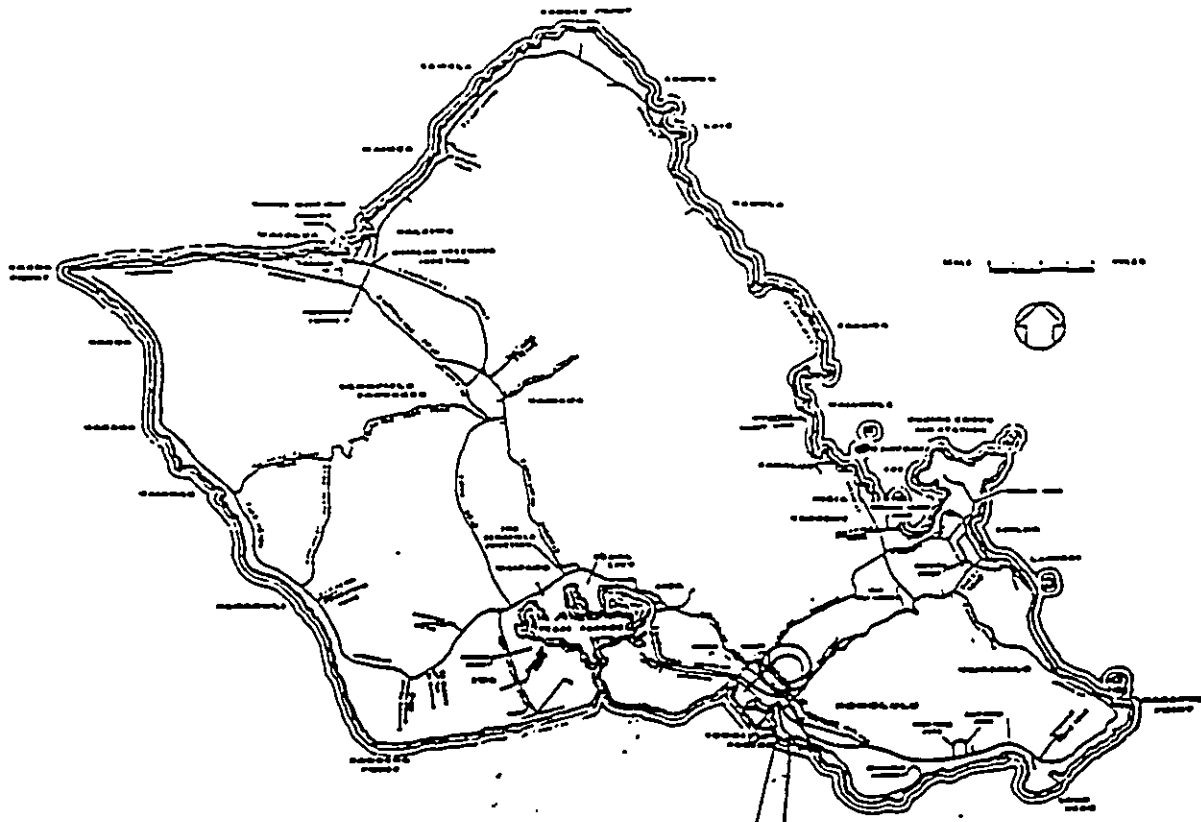

LOCATION MAP

FIGURE 1

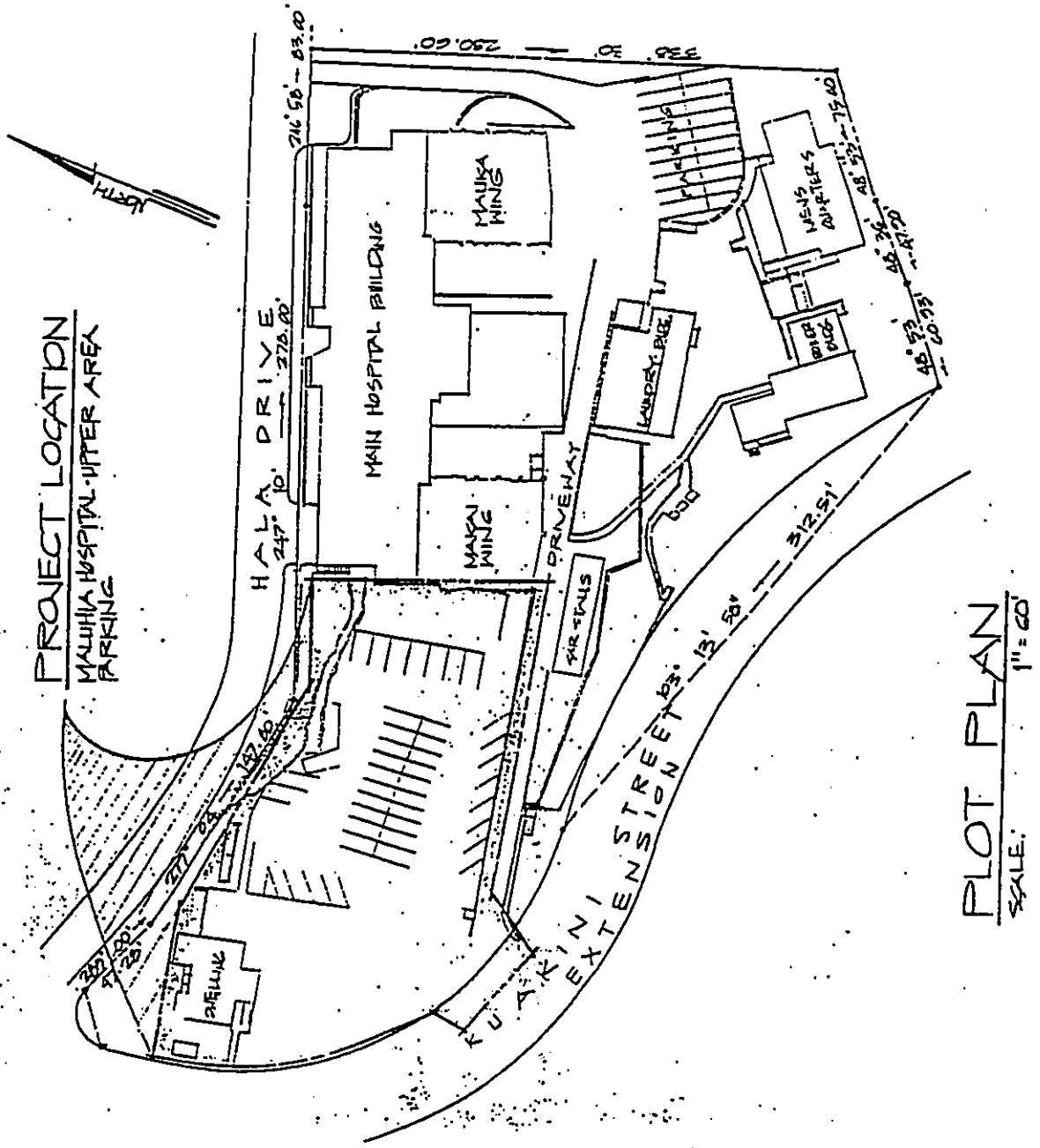

PLOT PLAN
SCALE: 1" = 60'

FIGURE 2