

DEPARTMENT OF WASTEWATER MANAGEMENT  
**CITY AND COUNTY OF HONOLULU**

650 SOUTH KING STREET  
HONOLULU, HAWAII 96813

RECEIVED

'93 OCT 27 A8:46

FRANK F. FASI  
MAYOR

OFFICE OF ENVIRONMENTAL  
QUALITY CONTROL

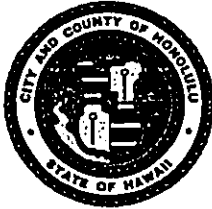

KENNETH M. RAPPOLT  
DIRECTOR

FELIX B. LIMTIACO  
DEPUTY DIRECTOR

WPP 93-544

October 25, 1993

Mr. Brian J.J. Choy, Director  
Office of Environmental Quality Control  
220 South King Street, 4th Floor  
Honolulu, Hawaii 96813

Dear Mr. Choy:

Subject: Negative Declaration for the Kaalaea Wastewater Pump  
Station and Force Main, Kaalaea, Kaneohe, Hawaii

The Department of Wastewater Management (DWWM) of the City and County of Honolulu has reviewed the comments received during the 30-day public comment period which began on April 23, 1993. DWWM has determined that this project will have no significant environmental effects and has issued a negative declaration. Please publish this notice in the next OEQC Bulletin.

We have enclosed a completed OEQC Bulletin Publication Form and four copies of the Final EA. Please contact Mr. Richard Leong at 527-5863, if you have any questions.

Very truly yours,

  
KENNETH M. RAPPOLT  
Director

Attachments

1993-11-08-0A-~~FEA~~-Kat Kaalaea Wastewater Pump Station and Force Main  
NOV 8 1993

*FINAL*

---

Environmental Assessment for the  
**KAALAEA WASTEWATER PUMP STATION  
AND FORCE MAIN**  
Kaalaea, Kaneohe, Hawaii

OCTOBER 1993

Prepared For:

Department of Wastewater Management  
City & County of Honolulu

Prepared By:

R. M. Towill Corporation  
420 Waiakamilo Road, Suite 411  
Honolulu, Hawaii 96817

---

DEPARTMENT OF WASTEWATER MANAGEMENT  
**CITY AND COUNTY OF HONOLULU**

650 SOUTH KING STREET  
HONOLULU, HAWAII 96813



FRANK F. FABI  
MAYOR

KENNETH M. RAPPOLT  
DIRECTOR

FELIX B. LIMTIACO  
DEPUTY DIRECTOR

WPP 93-545

October 25, 1993

Mr. Brian J.J. Choy, Director  
Office of Environmental Quality Control  
220 South King Street, 4th Floor  
Honolulu, Hawaii 96813

Dear Mr. Choy:

Subject: Notice of Negative Declaration for Kaalaea Wastewater Pump Station and Force Main, Kaalaea, Hawaii, TMK 4-7-14

This letter is a Notice of Negative Declaration for the Kaalaea Wastewater Pump Station (WWPS) and Force Main (FM), Kaalaea, Hawaii pursuant to Chapter 343, Hawaii Revised Statutes (HRS). The determination is based on an Environmental Assessment prepared for the Department of Wastewater Management (DWWM) of the City and County of Honolulu after consultation with other agencies and individuals. The construction of the proposed project will involve the use of public funds and City lands.

Attached are four (4) copies of the Notice of Negative Declaration/Environmental Assessment for your use and file.

The pertinent data for this Notice are as follows:

1. Proposing Agency: City and County of Honolulu, Department of Wastewater Management.
2. Proposed Action: The proposed action consists of construction of the Kaalaea WWPS and FM to collect and convey wastewater from Kahaluu Sewers Improvement District, Section 3 to the Kahaluu WWPS. From the Kahaluu WWPS, wastewater will be pumped to the Ahuimanu Wastewater Preliminary Treatment Facility (WWPTF), then to the Kaneohe WWPTF and ultimately to the Kailua Wastewater Treatment Plant where it will be treated and discharged through the Mokapu Ocean Outfall.

October 25, 1993

3. Determination: After preparation of an Environmental Assessment and consultation with other agencies and individuals, it was determined that the proposed project will not have a significant impact on the environment, and an Environmental Impact Statement is not required.
4. Reasons Supporting the Determination: An action is defined as having a significant impact on the environment if it contains any of the criteria listed in Chapter 200 of Title 11, Administrative Rules, "Environmental Impact Statement Rules." The criteria are:
  - a. Involves a loss or destruction of any natural or cultural resource
  - b. Curtails the range of beneficial uses of the environment
  - c. Conflicts with the State's long-term goals or guidelines as expressed in Chapter 344, HRS
  - d. Substantially affects the economic or social welfare of the community or state
  - e. Substantially affects public health
  - f. Involves substantial secondary effects, such as population changes or infrastructure demands
  - g. Involves a substantial degradation of environmental quality
  - h. Is individually limited but cumulatively has considerable effect on the environment, or involves a commitment to larger actions
  - i. Substantially affects a rare, threatened or endangered species or habitat
  - j. Detrimently affects air or water quality or ambient noise levels
  - k. Affects an environmentally sensitive area, such as a flood plain, tsunami zone, erosion-prone area, geologically hazardous land, estuary, freshwater area, or coastal waters

Because the proposed project does not contain any of the significance criteria listed above, the proposed project will not have negative impacts on the environment and Environmental Impact Statement is not required. In

Mr. Brian J.J. Choy

- 3 -

October 25, 1993

accordance with the provisions of Chapter 343, HRS, a Negative Declaration is determined to be in order.

5. Contact Person:

Mr. Richard Leong  
City and County of Honolulu  
Department of Wastewater Management  
650 South King Street, 14th Floor  
Honolulu, Hawaii 96813

Very truly yours,

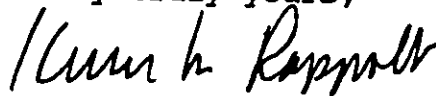

KENNETH M. RAPPOLT  
Director

Attachments

ENVIRONMENTAL ASSESSMENT FOR THE  
KAALAEA WASTEWATER PUMP STATION  
AND FORCE MAIN

Kaalaea, Kaneohe, Hawaii

Tax Map Key: 4-7-14

This Document is prepared pursuant to Chapter 343, HRS

Proposing Agency:

Department of Wastewater Management  
City and County of Honolulu  
650 South King Street  
Honolulu, Hawaii 96813

Responsible Official:

  
Kenneth M. Rappolt  
Director, DWWM

10-25-93  
Date

Prepared By:

R. M. Towill Corporation  
420 Waiakamilo Road, Suite 411  
Honolulu, Hawaii 96817

## TABLE OF CONTENTS

	<u>Page</u>
SECTION 1 - INTRODUCTION	1
1.1 Background	1
1.2 Purpose	1
1.3 Service Area and Design Flows	2
SECTION 2 - DESCRIPTION OF THE PROPOSED PROJECT	3
2.1 Pump Station	3
2.1.1 Site	3
2.1.2 Existing Utilities	3
2.1.3 Security	4
2.1.4 Type of Pump Station	4
2.1.5 Substructure	4
2.1.6 Number and Type of Sewage Pumps	5
2.2 Force Main	5
SECTION 3 - PREASSESSMENT CONSULTATION	7
3.1 General	7
3.2 Federal	7
3.2.1 Department of the Army, Corps of Engineers	7
3.2.2 Department of Interior	7
3.3 State	7
3.3.1 Commission on Persons with Disabilities	7
3.3.2 Department of Business, Economic Development and Tourism, Land Use Commission	8
3.3.3 Department of Health	8
3.3.3 Department of Land and Natural Resources	9
3.3.4 Department of Transportation	10
3.3.5 Office of State Planning	10
3.4 City and County of Honolulu	10
3.4.1 Fire Department	10
3.4.2 Department of Parks and Recreation	11
3.4.3 Planning Department	11
3.4.4 Police Department	11

	<u>Page</u>
3.4.5 Department of Transportation Services	11
3.4.6 Board of Water Supply	11
3.5 Government Officials	12
3.5.1 The Honorable Terrance Tom	12
3.6 Utilities Companies	12
3.6.1 Hawaiian Telephone Company	12
3.6.2 Hawaiian Electric Company, Inc.	12
3.7 Organizations	12
3.7.1 Kahaluu Neighborhood Board No. 29	12
3.7.2 Life of the Land	13
<b>SECTION 4 - DESCRIPTION OF THE ENVIRONMENTAL, POTENTIAL IMPACTS AND MITIGATION MEASURES</b>	<b>14</b>
4.1 Physical Environment	14
4.1.1 Climate	14
4.1.2 Geography and Topography	14
4.1.3 Soils	14
4.1.4 Flora and Fauna	14
4.1.5 Wetlands	15
4.1.6 Air Quality	15
4.1.7 Noise	15
4.1.8 Flooding Conditions	16
4.1.9 Solid Waste	17
4.1.10 Liquid Waste	17
4.2 Socio-Economic Environment	19
4.2.1 Ownership and Land Uses	19
4.2.2 Archaeology	20
4.2.3 Coastal Views/Visual Resources	20
4.2.4 Recreational Facilities	21
4.2.5 Access for Persons with Disabilities	21
4.2.6 Population	21
4.2.7 Economy	21
4.2.8 Construction	21



	<u>Page</u>
4.3 Infrastructure Systems and Services	21
4.3.1 Traffic and Transportation System	21
4.3.2 Existing Utilities	22
4.4 Summary of Impacts and Mitigative Measures	23
<b>SECTION 5 - ENVIRONMENTAL IMPACTS OF ALTERNATIVE ACTIONS</b>	<b>24</b>
5.1 No Action	24
5.2 Optimize Operation of Existing Facilities	24
5.3 Package Wastewater Treatment Plants (WWTP)	24
5.4 Alternate Site	24
<b>SECTION 6 - DETERMINATION</b>	<b>25</b>
6.1 Definition	25
6.2 Determination	25
<b>SECTION 7 - PERMITS AND APPROVALS</b>	<b>26</b>
7.1 Federal	26
7.2 State of Hawaii	26
7.3 City and County of Honolulu	27
7.4 Utility Companies	28
<b>SECTION 8 - AGENCIES CONSULTED</b>	<b>29</b>
8.1 Federal	29
8.2 State of Hawaii	30
8.3 City and County of Honolulu	31
8.4 Government Officials	32
8.5 Utility Companies	32
8.6 Organizations	33
<b>APPENDIX A - REVIEW PERIOD COMMENTS AND RESPONSES</b>	

### LIST OF FIGURES

<u>Figure No.</u>	<u>Title</u>
1-1	Kahaluu Sewers, Section 1, I.D.
1-2	Kahaluu Sewers, Section 2, I.D.
1-3	Kahaluu Sewers, Section 3, I.D.
1-4	Kahaluu Sewers, Section 4, I.D.
1-5	Kahaluu Sewers, Section 5, I.D.
1-6	Kaalaea WWPS and FM
2-1	Pump Station Site
2-2	Preliminary Pump Station Site Plan
2-3	Force Main Route
4-1	Flood Insurance Rate Map
4-1a	State Land Use Districts
4-2	Registered Historic Sites in Kahaluu Area

### LIST OF TABLES

<u>Table No.</u>	<u>Title</u>
4-1	Summary of Impacts and Mitigation Measures

## SECTION 1 INTRODUCTION

### 1.1 BACKGROUND

The Kahaluu area has been planned to be sewered under the Kahaluu Sewers Improvement District, Sections 1 through 5 (Figures 1-1 to 1-5). The large population densities in these subareas currently utilize cesspools for wastewater disposal and may be a potential source of pollution to the nearby shorelines.

The Kaalaea Wastewater Pump Station (WWPS) and Force Main (FM) Project is to collect wastewater from Section 3 of the Kahaluu Sewers Improvement District (Figure 1-3). The location of the Kaalaea WWPS and FM project is shown in Figure 1-6.

The Kaalaea WWPS and FM will collect and convey wastewater from Kahaluu Sewers ID, Section 3 to the Kahaluu WWPS. From the Kahaluu WWPS wastewater will be pumped to the Ahuimanu Wastewater Preliminary Treatment Facility (WWPTF), then to the Kaneohe WWPTF and ultimately to the Kailua Wastewater Treatment Plant where it will be treated and then discharged through the Mokapu Ocean Outfall. The Ahuimanu and Kaneohe facilities are presently wastewater treatment facilities and will be converted to preliminary treatment and pumping facilities in the near future.

### 1.2 PURPOSE

The purpose of this Environmental Assessment is to assess the environmental impact of the proposed Kaalaea WWPS and Force Main project, and to determine if the preparation of an Environmental Impact Statement will be required.

This Environmental Assessment has been prepared pursuant to Chapter 343 of the Hawaii Revised Statutes and is a supplement to the following Environmental Impact Statement:

- \* Environmental Impact Statement for the Kahaluu Wastewater Treatment and Disposal System, Department of Public Works, City and County of Honolulu, January 1980.

### 1.3 SERVICE AREA AND DESIGN FLOWS

The Kaalaea WWPS is to service the Kahaluu Sewers Section 3 Improvement District as defined by the City and County of Honolulu's Department of Wastewater Management (see Figure 1-3).

The existing land use/zoning for the 130-acre service area was used to project the ultimate population of 3,256. This information was used by the Department of Wastewater Management to calculate the projected ultimate sewage flows according to their design standards. The design data are as follows:

Design Period	Ultimate
Service Area	130 acres
Design Population	3,256
Design Average Flow	0.326 mgd
Design Peak Flow	1.353 mgd

The area is rural and consists primarily of residential and small agricultural farm lots. Sewage is expected to be of normal domestic strength.

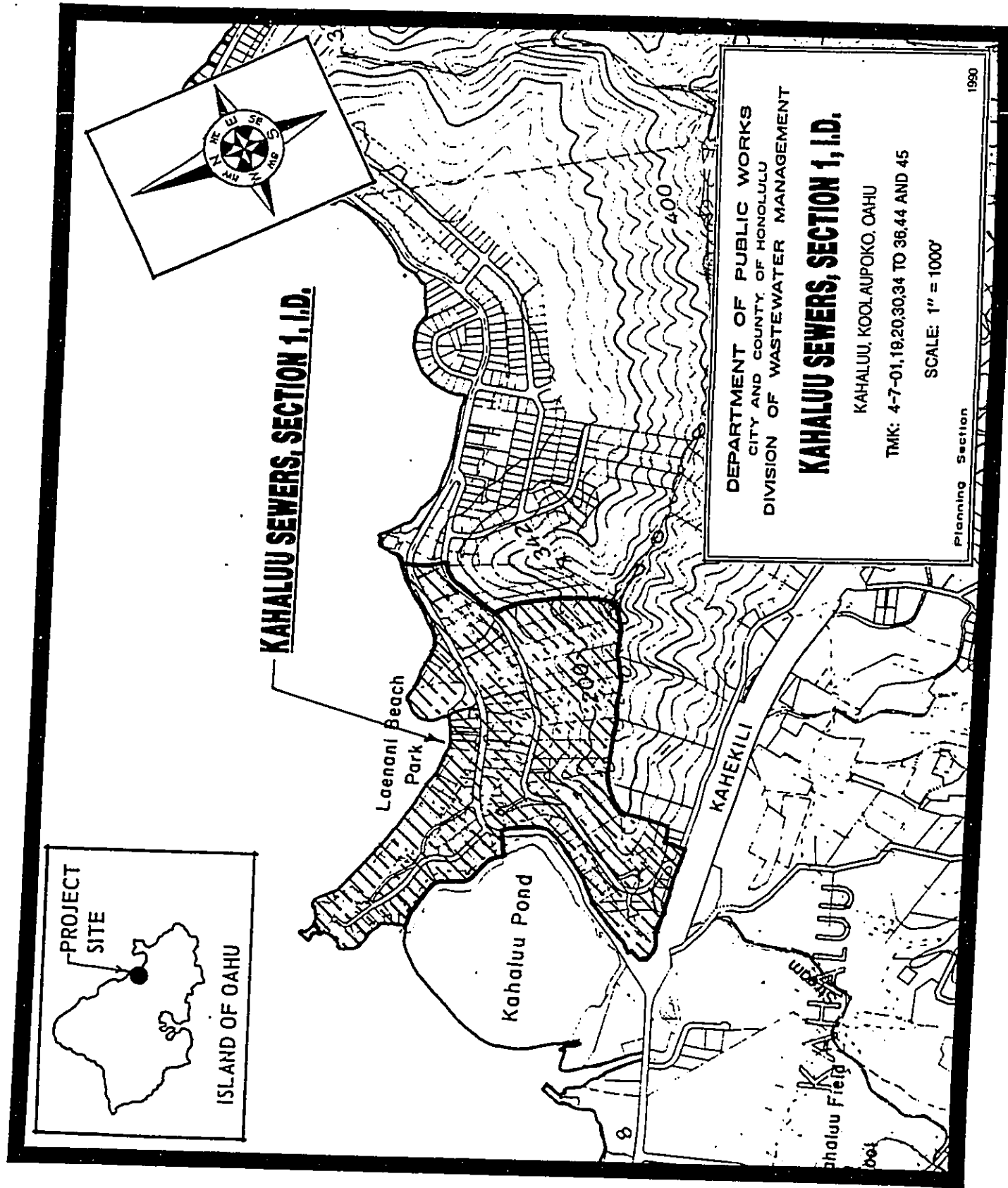

Figure 1-1

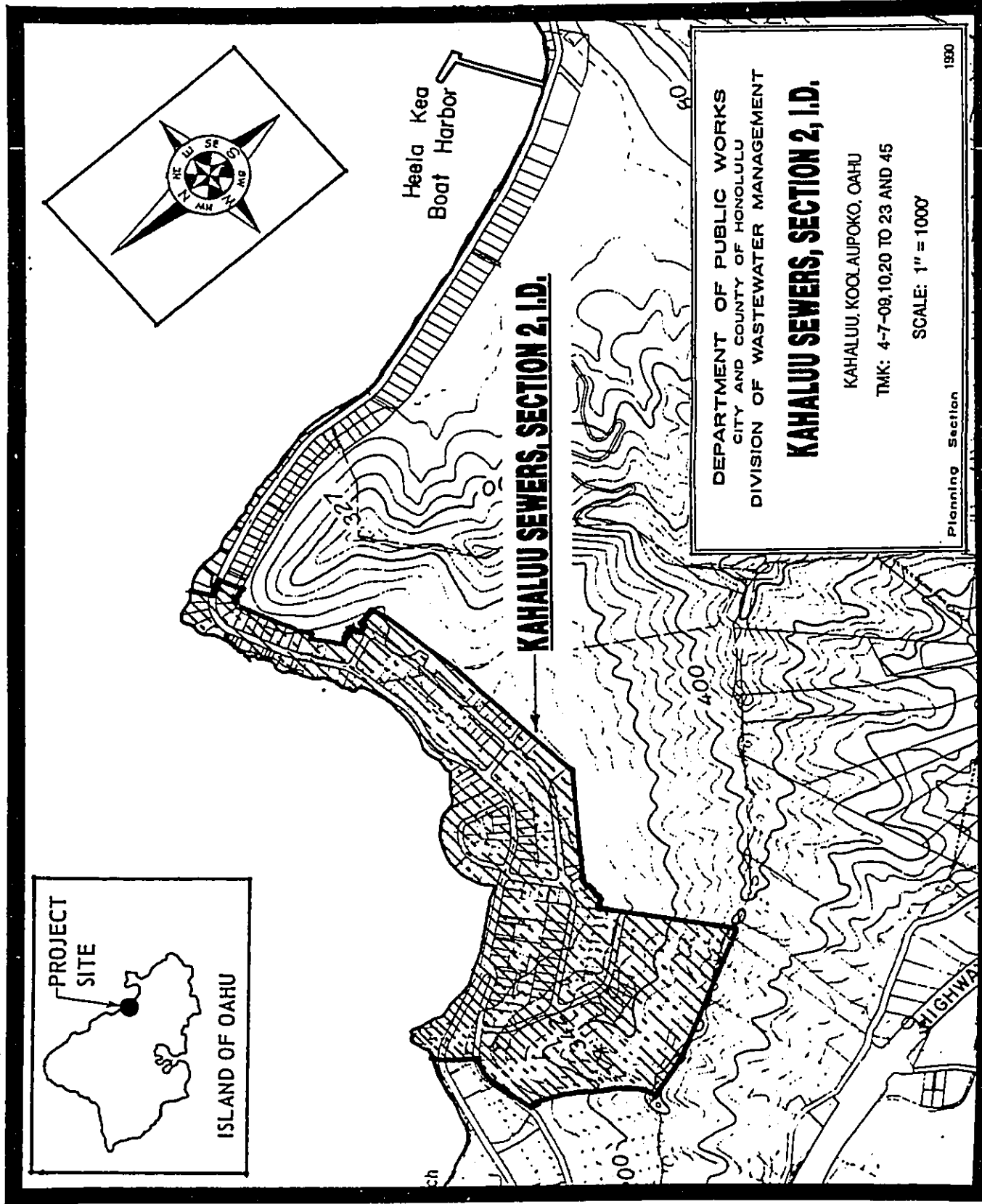
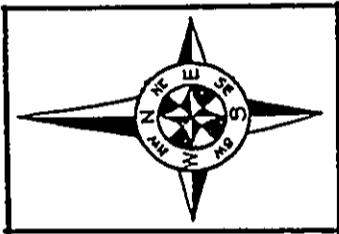
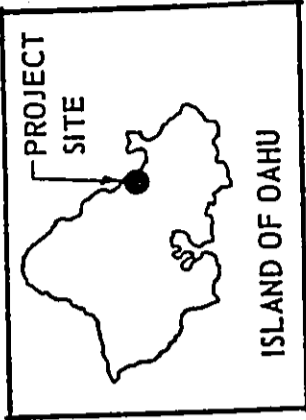
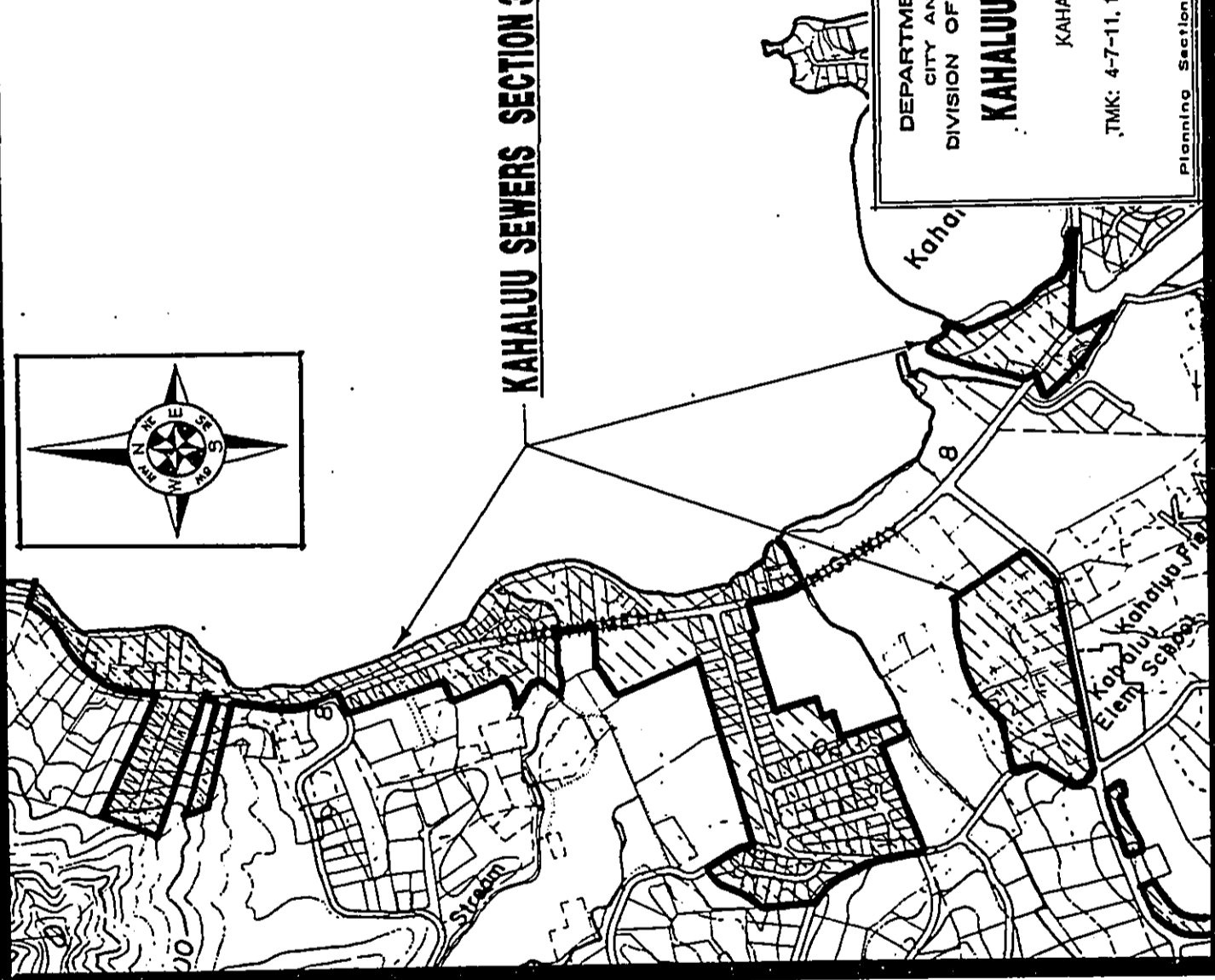

Figure 1-2



**KAHALUU SEWERS SECTION 3, I.D.**



DEPARTMENT OF PUBLIC WORKS  
CITY AND COUNTY OF HONOLULU  
DIVISION OF WASTEWATER MANAGEMENT

**KAHALUU SEWERS SECTION 3, I.D.**

KAHALUU, KOOLAUPOKO, OAHU

TMK: 4-7-11, 13, 14, 16, 17, 18, 24, 26, 41, 43 AND 58

SCALE: 1" = 1000'

1988  
Planning Section

Figure 1-3

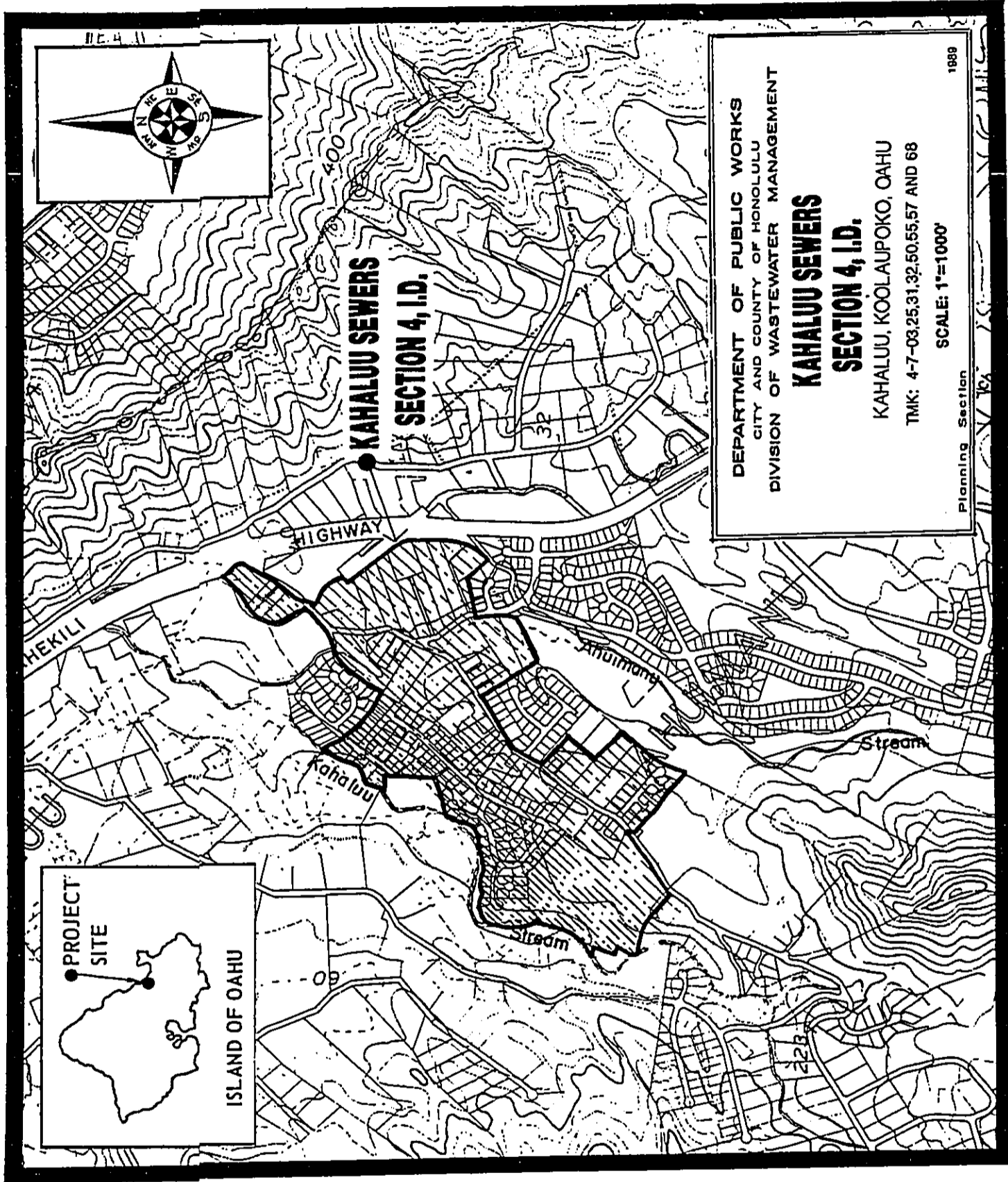

Figure 1-4



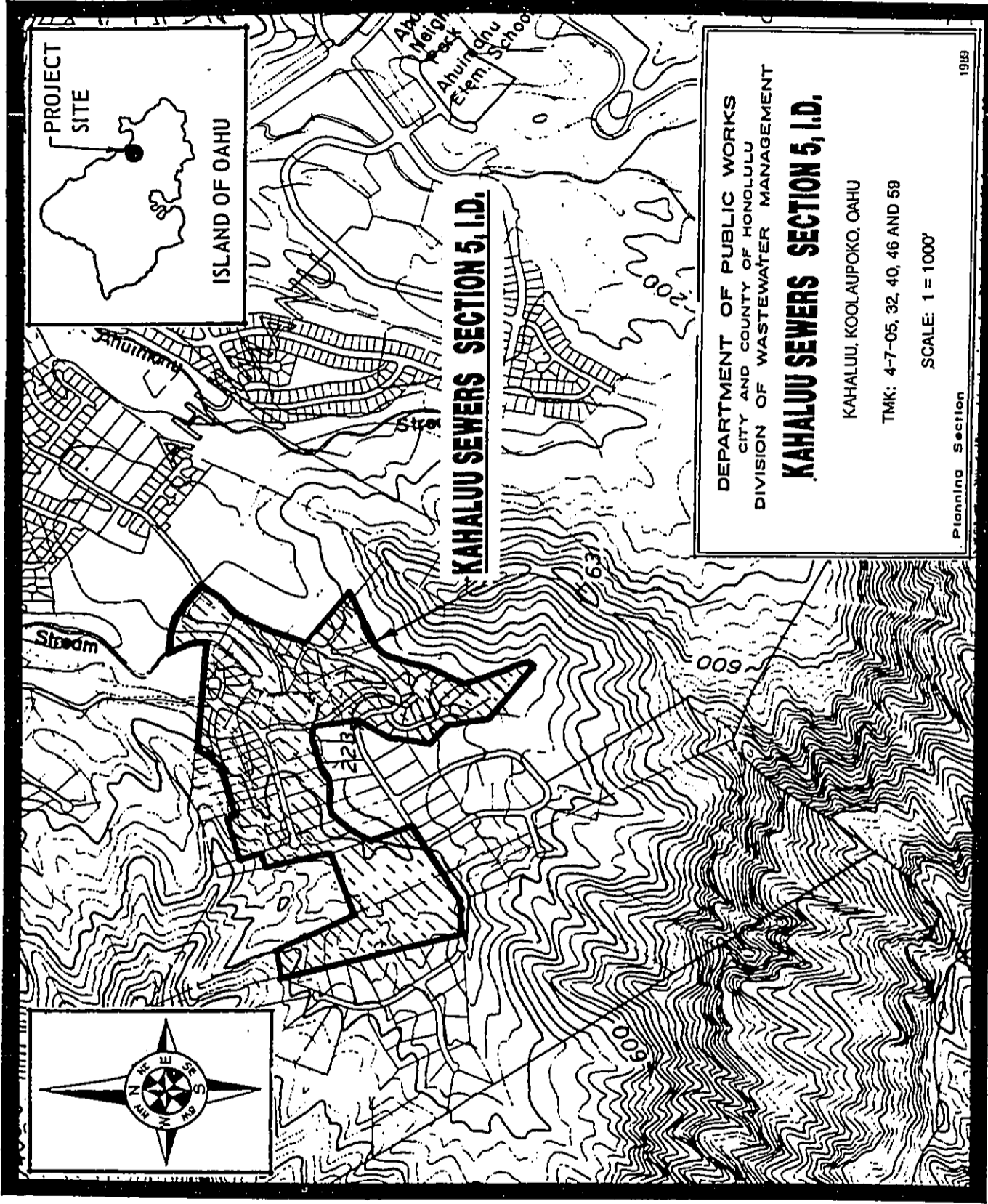

Figure 1-5

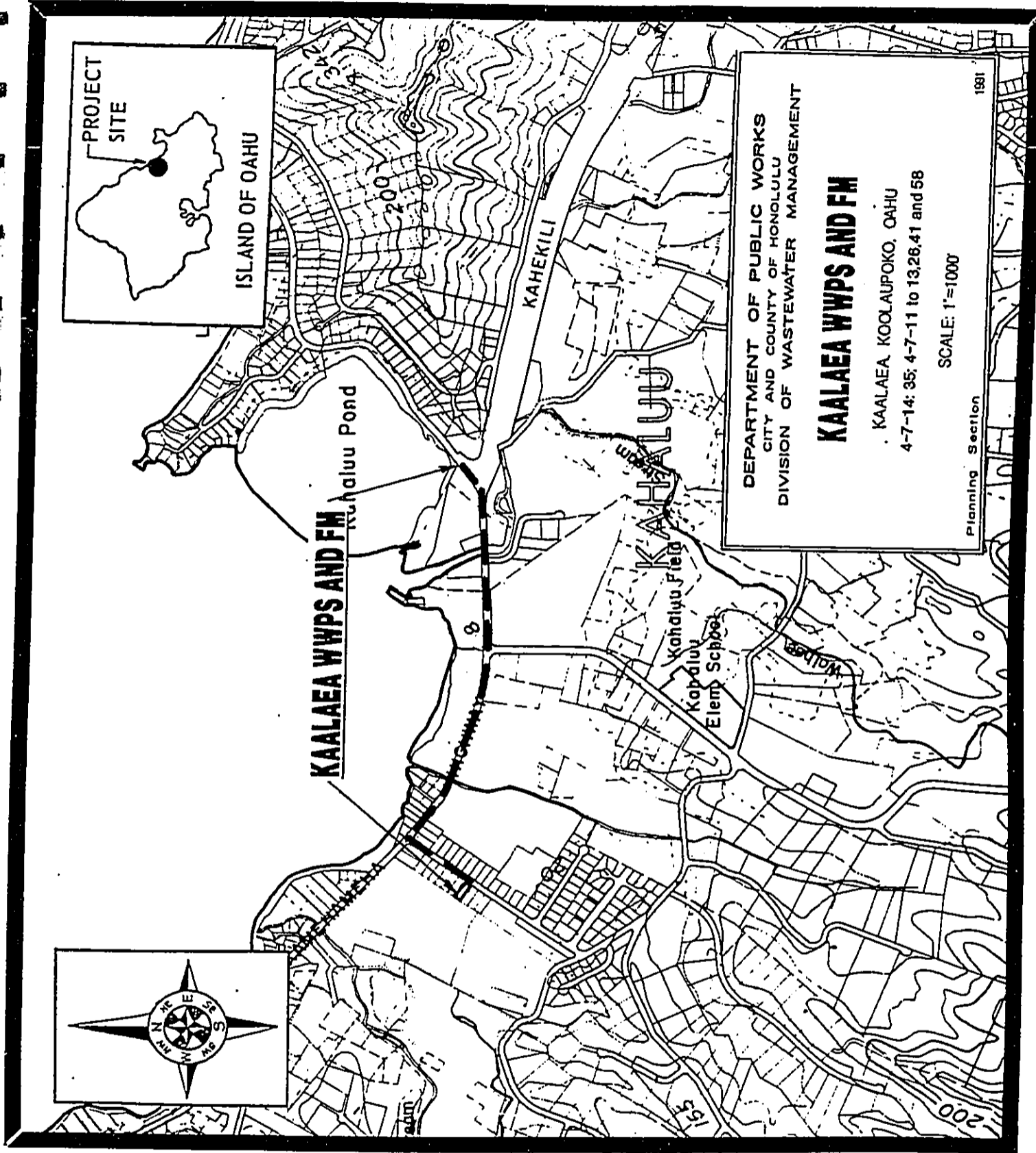

Figure 1-6

SECTION 2  
DESCRIPTION OF THE PROPOSED PROJECT

2.1 PUMP STATION

2.1.1 Site

The pump station site consists of two City owned land parcels on Wailehua Road. Wailehua Road is currently paved and no new access road to the pump station will be required. A partial Tax Map Key plan, presented as Figure 2-1, shows the proposed site for the pump station, Parcels 35 and 36 of Tax Map Key 4-7-14. Parcels 35 and 36 have areas of 9,200 and 9,540 square feet, respectively. A preliminary site plan is presented in Figure 2-2.

The pump station will be accessed from Wailehua Road by a paved driveway. The driveway will be sized to allow a 30-foot long single unit truck to park outside of the gate while the driver locks or unlocks the gate. The truck will bring diesel fuel to the storage tank as necessary. The gate will be recessed as such that when Wailehua Road is widened by 8 feet, the truck will be clear of the sidewalk area. The site and facilities will not require handicapped access as the facility will not be designed for public access and will not be operable by handicapped personnel.

The perimeter of the site will consist of a 6-foot high solid CMU wall with landscaping in front of the wall to provide an aesthetic appearance. There will be a 15-foot setback from the property line fronting Wailehua Road. The landscaping of the site will consist of no grass except in the setback from the property line. The remainder of the unpaved portions of the site will be gravel with some trees and bushes.

2.1.2 Existing Utilities

The existing utilities are adequate for the needs of the proposed pump station. Water, electric and telephone lines are currently available for connection. Bordering the North property line at the rear of the lots is an existing drainage ditch. Drainage will be directed towards Wailehua Road.

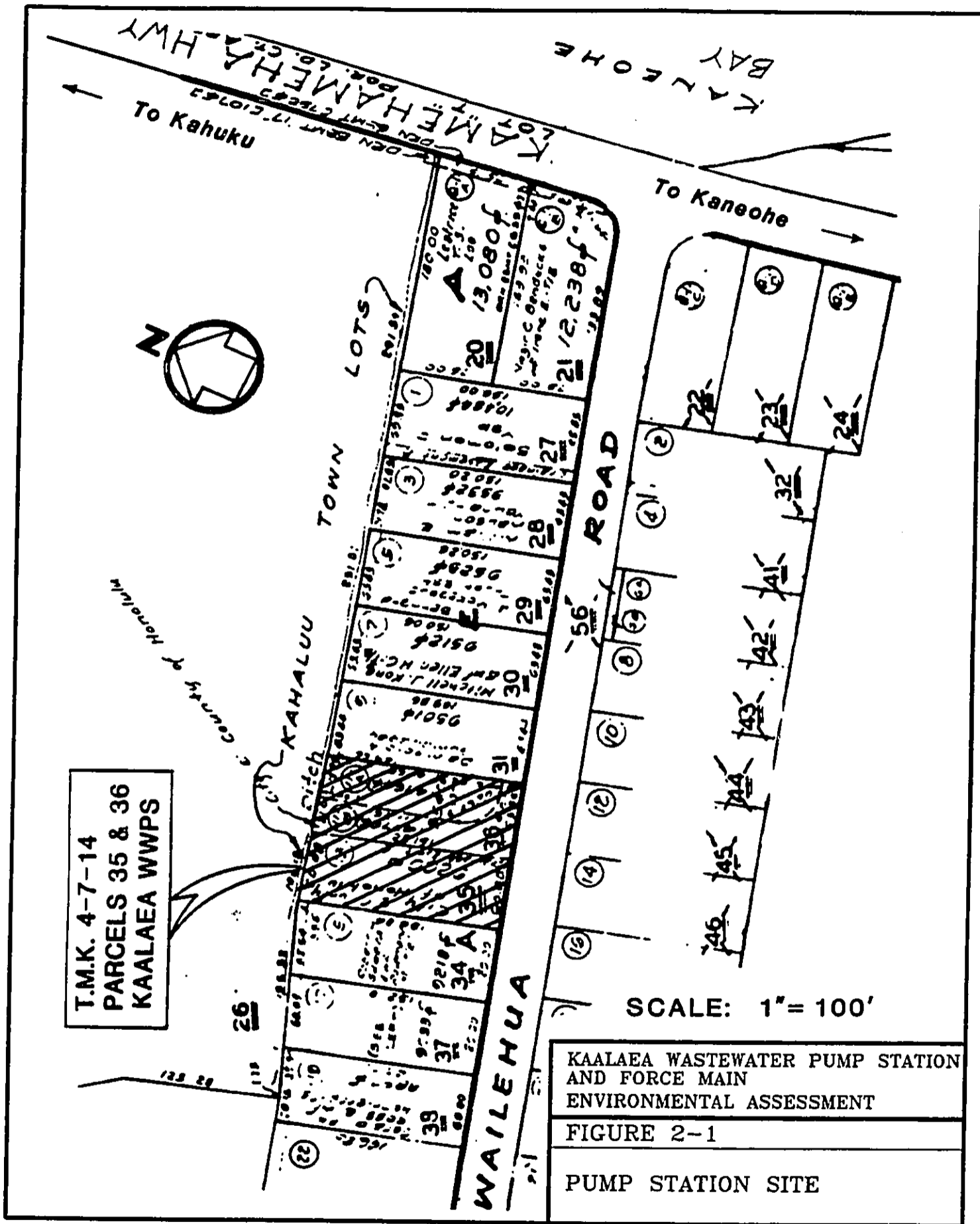

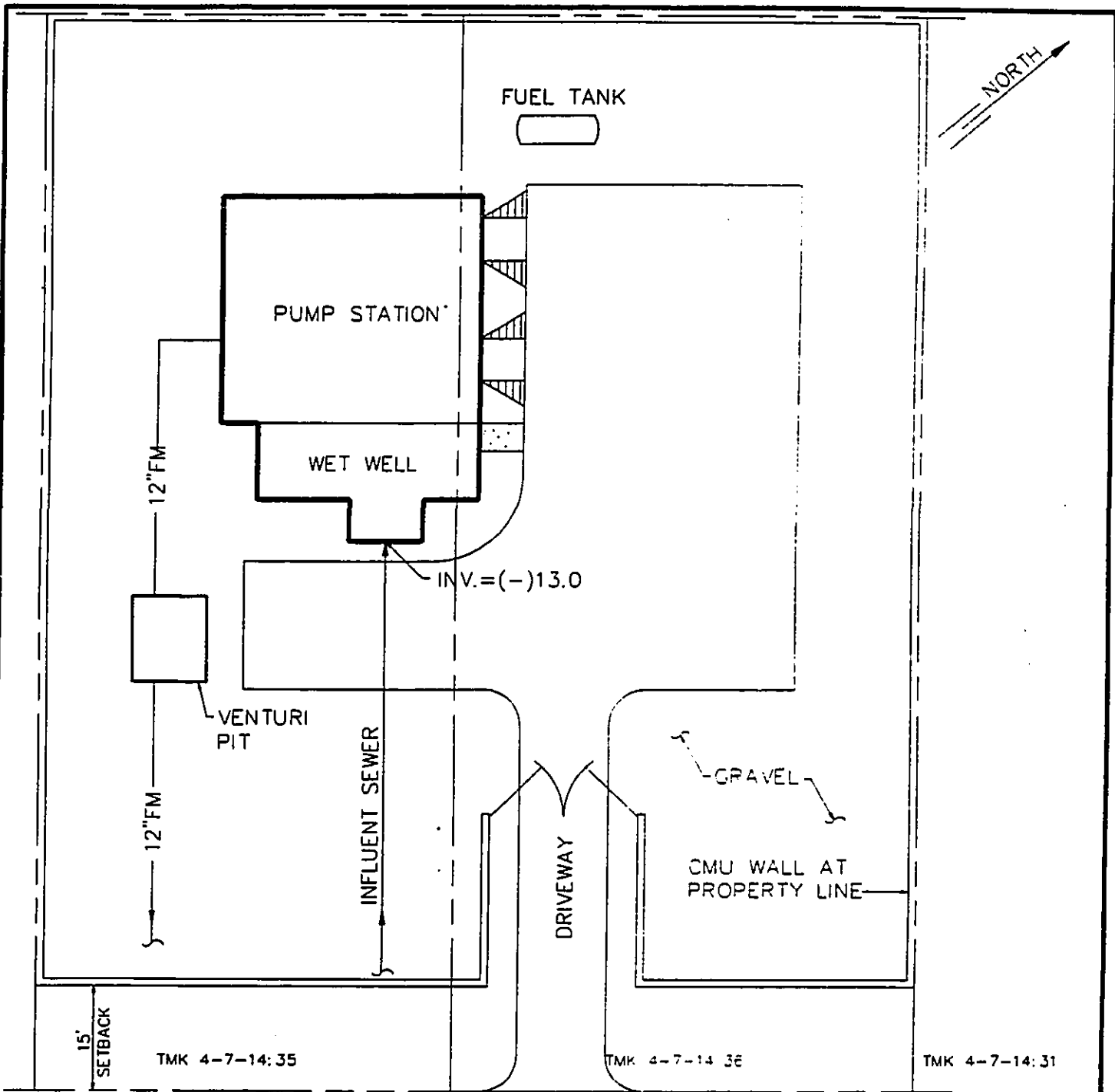

15' SETBACK

TMK 4-7-14:35

TMK 4-7-14:3E

TMK 4-7-14:31

WAILEHUA ROAD

TO KAM HWY

SCALE: 1"=20'

KAALAEA WASTEWATER PUMP STATION AND FORCE MAIN ENVIRONMENTAL ASSESSMENT
FIGURE 2-2
PRELIMINARY PUMP STATION SITE PLAN

The sewer collection line will enter the pump station at elevation (-)13.0 feet. The bottom of the wetwell will be approximately 7 feet below this invert, or at elevation (-)20.0 feet.

#### 2.1.3 Security

To secure the pump station against vandalism, a wall will be provided along the property lines of the pump station. The wall will be of CMU material, approximately 6 feet in height. The entrance for the station will front Wailehua Road and will be provided with a double swing gate.

#### 2.1.4 Type of Pump Station

The pump station will be of the wet-well/dry-well type.

The top floor will contain the standby generator room, the motor control center (MCC) units for the equipment, hand wheels to control the gate valves isolating the pumps, and a restroom. Maintenance, maneuvering, and replacement of the pumps below will be performed via a monorail and access hatches. Storage space for the spare pump unit and flammable storage of paint, etc., will also be provided for on this floor.

The Architectural features will be in harmony with the surrounding residential subdivision. The roof will be of reinforced concrete. A monorail and hoist will be provided. The roof height will be kept at a minimum since the surrounding homes are of single story type.

#### 2.1.5 Substructure

The substructure will be of reinforced concrete construction and will be waterproofed against exterior ground water intrusion. The substructure will also be designed to resist flotation as two thirds of the substructure is expected to be submerged below the water table.

There will be three lower levels to the dry well. The two intermediate levels will provide landings for the stairs as well as additional storage. The top intermediate floor will also contain the ventilation fan. The bottom level will house the pumps.

The wetwell will have two compartments to provide for redundancy and maintenance.

#### 2.1.6 Number and Type of Sewage Pumps

Based on City & County of Honolulu wastewater pump station design requirements, three (3) identical sewage pumps are recommended for pump stations of over 1.0 MGD capacity. The lead pump will handle normal flow; two pumps will handle the peak flow. A third pump will serve as a standby unit. In addition to the three installed pumps, a complete spare pump will be provided, ready for installation.

The pumps will be of the dry-pit submersible type. The selection was based on cost and noise generation criteria.

#### 2.2 FORCE MAIN

The Force Main (FM) will begin at the Kaalaea WWPS and will be routed along Wailehua Road towards Kamehameha Highway. Once at Kamehameha Highway, the force main will run in a South-Southeasterly direction along the highway, across Haiamoa Stream and Kahaluu Stream, and will continue on towards the existing Kahaluu WWPS. Two alternatives are shown in Figure 2-3. Alternative A has the force main running the entire route to the Kahaluu WWPS. Alternative B has the force main ending at a discharge manhole immediately after Kahaluu Stream; the flow is by gravity to the Kahaluu WWPS. The two alternatives and the exact force main route will be evaluated in the design phase of the project.

Along Kamehameha Highway, the force main will be located within the State Highway right-of-way and on the same side as Kaneohe Bay.

The force main will be 12-inch high density polyethylene (HDPE). This was chosen over PVC and ductile iron due to its corrosion resistant characteristics and reliability. Cleanouts will be provided as mandated by the City's design standards.

High points in the force main will be avoided but if necessary, air release and vacuum valves will be provided at those particular high points. The construction plans will reflect the force main profile and will determine the need for air release and vacuum valves. The manholes for the air release and vacuum valves will be designed to permit recovery of sewage discharged from the valves into the manholes.

The force main will cross the streams by one of the following methods: horizontal drilling under the stream, pipe bridge or bridge attachment. The bridge attachment method is preferred but is subject to State Department of Transportation approval at the time of design.



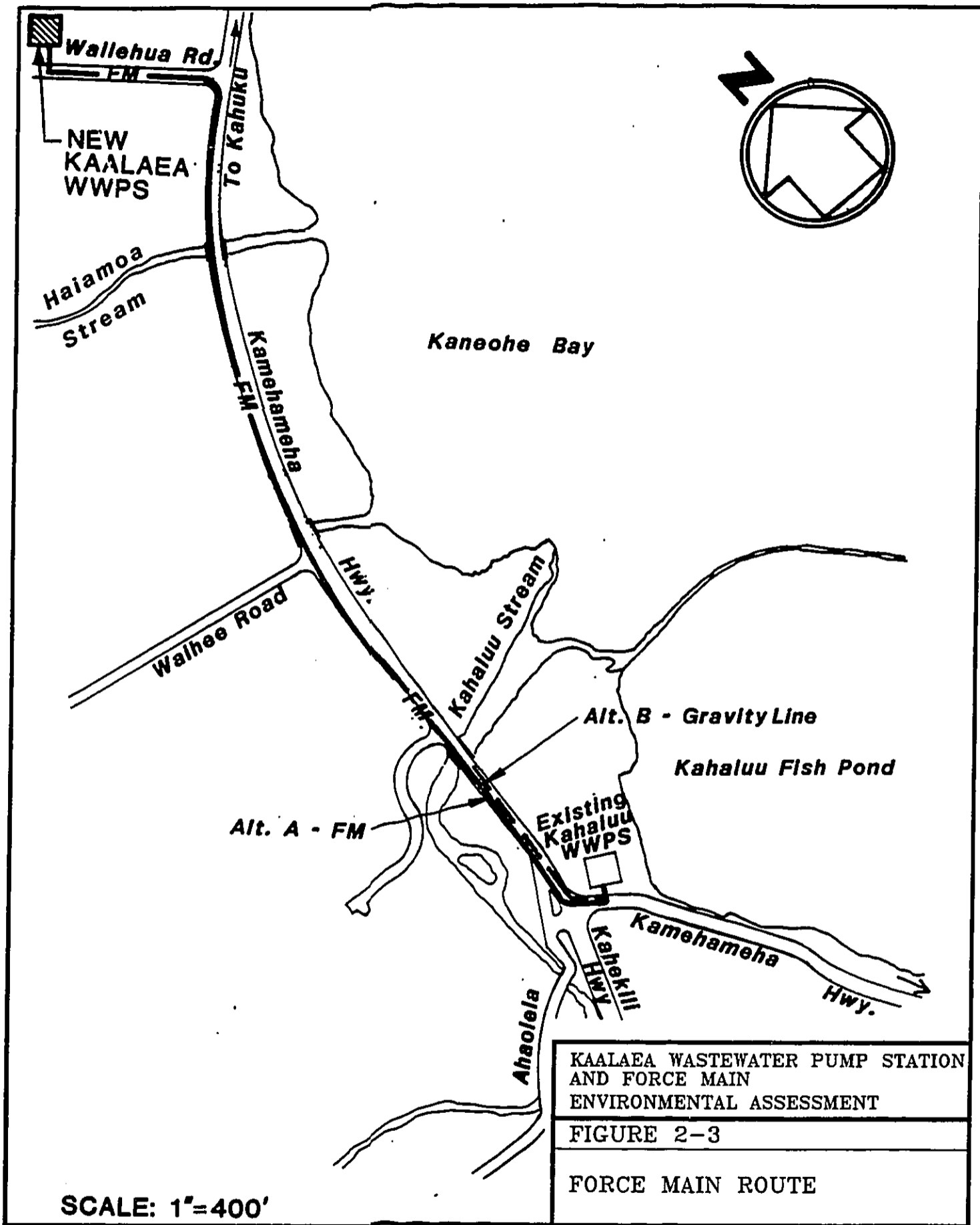

SCALE: 1"=400'

KAALAEA WASTEWATER PUMP STATION  
AND FORCE MAIN  
ENVIRONMENTAL ASSESSMENT

FIGURE 2-3

FORCE MAIN ROUTE

SECTION 3  
PREASSESSMENT CONSULTATION

3.1 GENERAL

A preassessment review of the project was solicited. A complete list of agencies contacted is presented in Section 8. The responses received are included in this section.

3.2 FEDERAL

3.2.1 Department of the Army, Corps of Engineers

- A. The project involves force main crossings over streams for which a DA permit will be required.
  
- B. According to the Federal Emergency Management Agency's Flood Insurance Rate Map, panel 150001-055-B, dated September 4, 1987, the proposed wastewater pump station appears to be located in Zone X - unshaded (areas determined to be outside of the 500-year flood plain). The force main appears to be located in Zone X - shaded (areas inundated by the 500-year flood); Zone X - unshaded (areas inundated by the 500-year flood); Zone AE (areas inundated by the 100-year flood with a base flood elevation of 5 to 6 feet above mean sea level); and, the floodway area designated as Zone AE (areas inundated by the 100-year flood with a base flood elevation of 5 to 6 feet). Confirmation of the flood hazard designations will be performed upon review of the final EA. (See Section 4.1.8)

3.2.2 Department of the Interior

No input.

3.3 STATE

3.3.1 Commission on Persons with Disabilities

- A. A policy statement with respect to access for persons with disabilities should be included in the Socio-Economic Environment section.

- B. A reference to HRS 103-50, requiring a review for accessibility by the Commission on Persons with Disabilities, should be included in the Permits and Approvals section.
- C. The overall use category "mechanical" does not exempt certain buildings of this facility, and the appropriate site approaches, from being accessible to persons with disabilities. This would apply both to providing access for visitors and providing employment opportunities without discrimination.

3.3.2 Department of Business, Economic Development & Tourism  
Land Use Commission

- A. The Kahaluu Sewers Section 3 Improvement District as shown on Figure 1-3 appears to be in both the Urban and Conservation Districts.
- B. The Kaalaea WWPS site (TMK 4-7-14:35 & 36) and the two force main alternate routes as shown in Figure 2-3 appear to be located within the Urban District.
- C. The Final EA should include a map showing the Improvement District, proposed WWPS, and force main routes in relation to the State Land Use Districts. (See Figure 4-1a)

3.3.3 Department of Health

- A. Concur with the project.
- B. Sound levels emanating from stationary equipment at the proposed pump station must be attenuated to comply with the provisions of Administrative Rules, Title 11, Chapter 43, Community Noise Control for Oahu."
- C. Activities associated with the construction phase of the project must also comply with Chapter 43.

- D. Traffic noise from heavy vehicles travelling to and from the project site must be minimized near existing residential areas and must comply with the provisions of Administrative Rules, Title 11, Chapter 42, "Vehicular Noise Control for Oahu."

3.3.4 Department of Land and Natural Resources

- A. Division of Aquatic Resources - Precautions should be taken during all aspects of the proposed project to prevent wastewater, excessive sediments, construction debris, petroleum products, and other contaminants from entering Kaneohe Bay.
- B. Commission on Water Resource Management - Should be consulted during further planning for this project for possible Stream Channel Alteration Permits that may be required.
- C. Division of Forestry and Wildlife - No objections.
- D. Natural Area Reserves System Commission - No objections.
- E. Historic Preservation Division - There are no known historic sites at the location of the proposed pump station or proposed force main route. However, these areas have not been inventoried for surface or subsurface historic sites, so the potential for the presence of archaeological sites does exist in these areas. Of particular concern is the proposed force main route, since it runs through an area of prime land for traditional Hawaiian agriculture. It is expected that trenching for the force main in areas outside of developed facilities corridors will expose subsurface deposits relating to traditional Hawaiian agriculture that contain information important to the history and prehistory of Hawaii.

It is recommended that a qualified archaeologist monitor any excavation outside of developed facilities corridors to identify and record any subsurface historic deposits and collect appropriate samples for laboratory analysis. A report of the laboratory analyses should then be submitted to the Historic Preservation Division. This would result in a "no adverse effect" determination if sites are present, or a "no effect" determination if no sites are found.

3.3.5 Department of Transportation

- A. No objections to the project.
- B. All plans for work within the Kamehameha Highway right-of-way must be submitted for review and approval.
- C. The impact of construction activities on the existing traffic must be identified and mitigative measures taken to avoid congestion and to insure the safety of motorists and pedestrians during construction.

3.3.6 Office of State Planning

- A. The two force main alternatives should be assessed to determine which will best address the issue of infiltration into and seepage from the collection system.
- B. The current and proposed status of all of the area's various wastewater treatment facilities and their capacities to handle the expected volume of effluent from the proposed Kaalaea WWPS should be discussed.

3.4 CITY AND COUNTY OF HONOLULU

3.4.1 Fire Department

No comments.

3.4.2 Department of Parks and Recreation

No comments.

3.4.3 Planning Department

The Koolaupoko Development Plan Public Facilities Map was amended on July 29, 1991 to include the subject proposal.

3.4.4 Police Department

Major concern is the mitigation of dust, noise, liquid waste, and traffic problems.

3.4.5 Department of Transportation Services

- A. There is an 8-foot road widening setback fronting the subject parcels on Wailehua Road.
- B. The EA should include a site plan showing the proposed driveway access points to the pump station.
- C. Construction plans for all work within the City's right-of-way should be submitted to DTS for review. A traffic control plan showing temporary detours for pedestrians and vehicles should be included in these plans.

3.4.6 Board of Water Supply

- A. There is no existing water service to the site.
- B. The availability of water will be determined when the building permit is submitted. If water is made available, the applicant will be required to pay the prevailing Water System Facilities Charge and any applicable meter installation charges.
- C. If a three-inch or larger water meter is required, the construction drawings showing the installation of the meter should be submitted for review and approval.

- D. A Board of Water Supply approved reduced pressure principle backflow prevention assembly should be installed on the domestic water service immediately after the property valve and prior to any branch piping.

3.5 GOVERNMENT OFFICIALS

3.5.1 The Honorable Terrance Tom

No comments.

3.6 UTILITY COMPANIES

3.6.1 Hawaiian Telephone Company

- A. *There are no large underground telephone structures in the area described.*
- B. The attachments provided were not detailed sufficiently to provide a complete analysis of any conflicts or area impacts.

3.6.2 Hawaiian Electric Company, Inc.

- A. No comments on the proposed project.
- B. HECO shall reserve comment pertaining to the protection of existing facilities bordering the project area until construction plans are finalized.

3.7 ORGANIZATIONS

3.7.1 Kahaluu Neighborhood Board No. 29

- A. The proposed service area should be re-examined to be sure all needed areas are included. The sewer lines should be sized to accommodate only the service area.
- B. The proposed WWPS site appears to be suitable and available for the proposed project.

- C. Traffic disruptions and soil stockpiling on public lands and on the Kahaluu Fishpond property should be avoided.

3.7.2 Life of the Land

No comments.



SECTION 4  
DESCRIPTION OF THE ENVIRONMENT, POTENTIAL  
IMPACTS AND MITIGATION MEASURES

4.1 PHYSICAL ENVIRONMENT

4.1.1 Climate

Mild and uniform temperatures prevail with a dominance of cool northeast tradewinds. The mean annual temperature is about 75°F. The average annual rainfall is about 50 inches, with about 70 percent of the rainfall occurring from November to April.

4.1.2 Geography and Topography

Impacts on physical terrain at the pump station site and along the force main route are expected to be minimal. Little grading will be required since the existing site is relatively flat.

4.1.3 Soils

The area was formed with deposits of alluvial material and is generally of poor seepage characteristics.

4.1.4 Flora and Fauna

No endangered flora or fauna exist on the pump station site. The area is mostly clear except for a banana patch and two rows of small coconut trees; both the banana and coconut trees are located on the mauka (western) edge of the site. A monkey pod tree is located at the south east corner of the site. All of the trees will be relocated to other City facilities since they will interfere with excavation on the site.

The proposed force main will be located within the roadway right-of-way. As a result, there are no endangered flora or fauna along the force main route as the area has already been fully developed.

#### 4.1.5 Wetlands

The EIS prepared for the Kahaluu area identified Waihee Marsh as the only wetland in the Kahaluu area. Waihee Marsh lies adjacent to Kamehameha Highway between Waihee Road and Wailehua Road and extends about 1,000 feet inland from the highway. The proposed pump station and force main will not disturb the marsh.

#### 4.1.6 Air Quality

The principal source of short term air quality impacts will be from construction activities. The necessary air pollution permits will be obtained from the State Department of Health prior to the start of construction. Dust control practices will be required to be implemented as necessary, and will comply with State Department of Health Regulations, Chapter 60, Air Pollution Control.

Odor control should not be necessary for the pump station since the detention time within the tributary collection system is relatively short and the detention time in the wetwell will be below 30 minutes. The short detention time should prevent septic conditions from developing. As a precautionary measure, a 6-inch stubout at the wetwell top slab for future odor control connections and space for future odor control facilities will be provided.

The location of the emergency generator engine exhaust outlet will be selected to minimize the possibility of exhaust fume odors reaching homeowners of nearby properties.

#### 4.1.7 Noise

Sound levels from the proposed pump station are to comply with the State Department of Health Regulations, Chapter 43, "Community Noise Control for Oahu." Chapter 43 limits noise levels along the property boundary lines to 55 dBA during the day and 45 dBA at night.

Short term noise impacts are primarily related to construction. Construction related noise is generated from the use of heavy equipment. Generally, the heavy construction equipment will exceed allowable noise levels. To mitigate short term impacts associated with

construction, the equipment and vehicles will utilize mufflers and other accepted noise reduction technology. In addition, specific start and curfew times will be established for construction activities. A permit issued by the State DOH will contain necessary construction noise conditions.

Traffic noise from heavy vehicles traveling to and from the pump station must be minimized near existing residential areas and must comply with the provisions of Chapter 42, "Vehicular Noise Control for Oahu."

Long term noise impact on the area surrounding the KWWPS generally would be caused by the standby generator and wastewater pumps. Mitigative measures for the standby generator include the use of intake and exhaust silencers into the generator room consisting of duct work and sound attenuators, exhaust muffler and discharge silencer in series, and acoustical wall and ceiling panels for the generator room. Mitigative measures for the wastewater pumps include locating the pumps below ground level and using acoustical wall and ceiling panels.

#### 4.1.8 Flooding Conditions

The proposed pump station site may be subject to flooding during periods of extended rainfall. The Federal Emergency Management Agency's Flood Insurance Rate Map, panel 150001-055-B dated September 4, 1987, is shown on Figure 4-1. According to the map, the pump station overlaps three different flood zones:

- \* Zone AE within the 100-year flood plain with base flood elevations of 6 to 7 feet above mean sea level
- \* Zone X within the 500-year flood plain
- \* Zone X outside the 500-year flood plain

Zone AE will be used as the basis of the design of the pump station because Zone AE is subject to the greatest danger of flooding. An elevation of 6.0 feet above mean sea level will be used as the design flood level. The finished floor elevation of the pump station will be designed at a minimum of 8.0 feet above mean sea level. The pump station will be designed to resist flotation, collapse or lateral movement due to the forces caused by flooding.

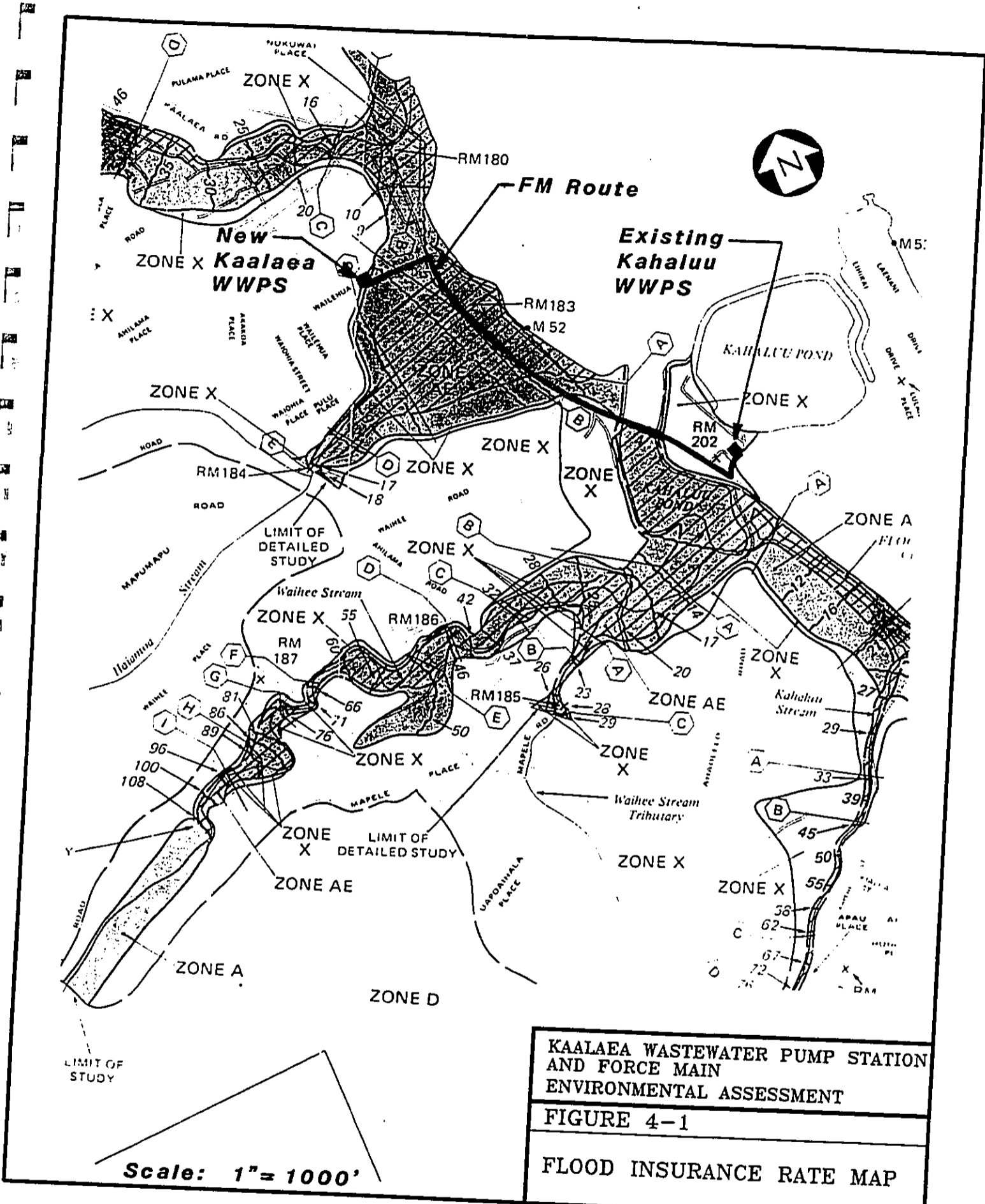

KAALAEA WASTEWATER PUMP STATION  
AND FORCE MAIN  
ENVIRONMENTAL ASSESSMENT  
FIGURE 4-1  
FLOOD INSURANCE RATE MAP

Scale: 1" = 1000'

According to Figure 4-1, the force main route passes through the following flood zones:

- \* Zone X within the 500-year flood plain
- \* Zone X outside the 500-year flood plain
- \* Zone AE within the 100-year flood plain with base flood elevations of 5 to 6 feet above mean sea level
- \* Zone AE within the floodway area and within the 100-year flood plain with base flood elevations of 5 to 6 feet above mean sea level

Developments within the General Flood Plain District are subject to review and approval by the Department of Land Utilization, City and County of Honolulu. The project location and site plan showing dimensions, topographic data, and relationship of the project to the flood zones will be provided.

#### 4.1.9 Solid Waste

Solid waste generated during construction is to be disposed of. No solid waste will be generated during normal operations.

#### 4.1.10 Liquid Waste

Liquid wastes may arise from construction activities and post construction pump station operations. Construction activities wastes include disposal of construction dewatering water and hydrotesting water. Liquid wastes during normal operations include potentially raw wastewater and would be classified as a spill condition.

##### 4.1.10.1 Construction Activities

Construction dewatering water and hydrotesting is likely to ultimately be disposed of to State waters. As a result, construction dewatering and hydrotesting water disposal will both require the State Department of Health, National Pollutant Discharge Elimination System (NPDES) General Permit or Individual Permit prior to the commencement of construction. For discharges directly to Kaneohe Bay, including discharges through storm drainage structures, an Individual Permit will be required.

Data required includes source and discharge water quality and a Best Management Practice plan to control the construction generated discharges.

The General Permit or Individual Permit will provide the Best Management Practice plan for the disposal of construction dewatering water and hydrotesting water. The permit will address the disposal options prior to the time of construction.

#### 4.1.10.2 Pump Station Operations-Wastewater Spills

During normal operations, raw wastewater entering the proposed Kaalaea pump station is to be pumped to the Kahaluu WWPS.

Any discharge to the surrounding area will be a violation of the Clean Water Act, classified as a wastewater spill and subject to enforcement action. A number of provisions will be provided to reduce the probability of wastewater spills. These include:

- \* Two wetwells will be provided. In the event of a problem in one wetwell, the second wetwell and pumps will be operational.
- \* To reduce the probability of wastewater spills, the wetwell capacity will be enlarged slightly beyond the required minimum size to provide for additional storage capacity. Size will be limited to a level that will minimize odor control.
- \* To protect against spills from force main failure, a branch connection for the force main will be provided at the pump station. This will be accessible to wastewater haul (cesspool) trucks for temporary storage or delivery to Kahaluu WWPS.
- \* A standby generator will be provided in the event of Hawaiian Electric Company power failure.

- \* In the event of total station failure for an extended time, a portable self-priming pump will take suction feed from the wetwell and discharge into the force main through a valved connection.

## 4.2 SOCIO-ECONOMIC ENVIRONMENT

### 4.2.1 Ownership and Land Uses

The proposed pump station is to be situated on two adjacent City owned parcels on Wailehua Road (T.M.K. 4-7-14, Parcels 35 & 36). The two lots are currently vacant and are zoned R-10 for residential use. According to the Development Plan Land Use Map for the Kahaluu area, the site of the proposed pump station is bordered by land zoned for residential usage. The Development Plan Public Facilities Map was amended on July 29, 1991 to include the proposed pump station. According to the State Land Use District Map, the site is located within the Urban District.

The proposed route of the force main starts at the site of the Kaalaea WWPS on Wailehua Road (City jurisdiction) and continues along Kamehameha Highway (State jurisdiction) to the existing Kahaluu WWPS. Along the route of the proposed force main, the land is zoned by the Development Plan for a variety of different uses, including residential, commercial, light industrial, preservation, agricultural, public, and park land usage. The proposed force main route lies within the State Land Use Urban District. There is a 25-foot setback on both sides of Kamehameha Highway to accommodate future widening.

Figure 4-1a shows Improvement District 3, the proposed pump station, and proposed force main route in relation to the State Land Use Districts.

The proposed pump station and force main lie entirely within the City Shoreline Management Area (SMA). On January 31, 1990 the City Council approved Resolution 89-570. The Kahaluu Sewers Improvement District 3 and the proposed Kaalaea pump station and force main were among the improvements granted an SMA permit by Resolution 89-570.

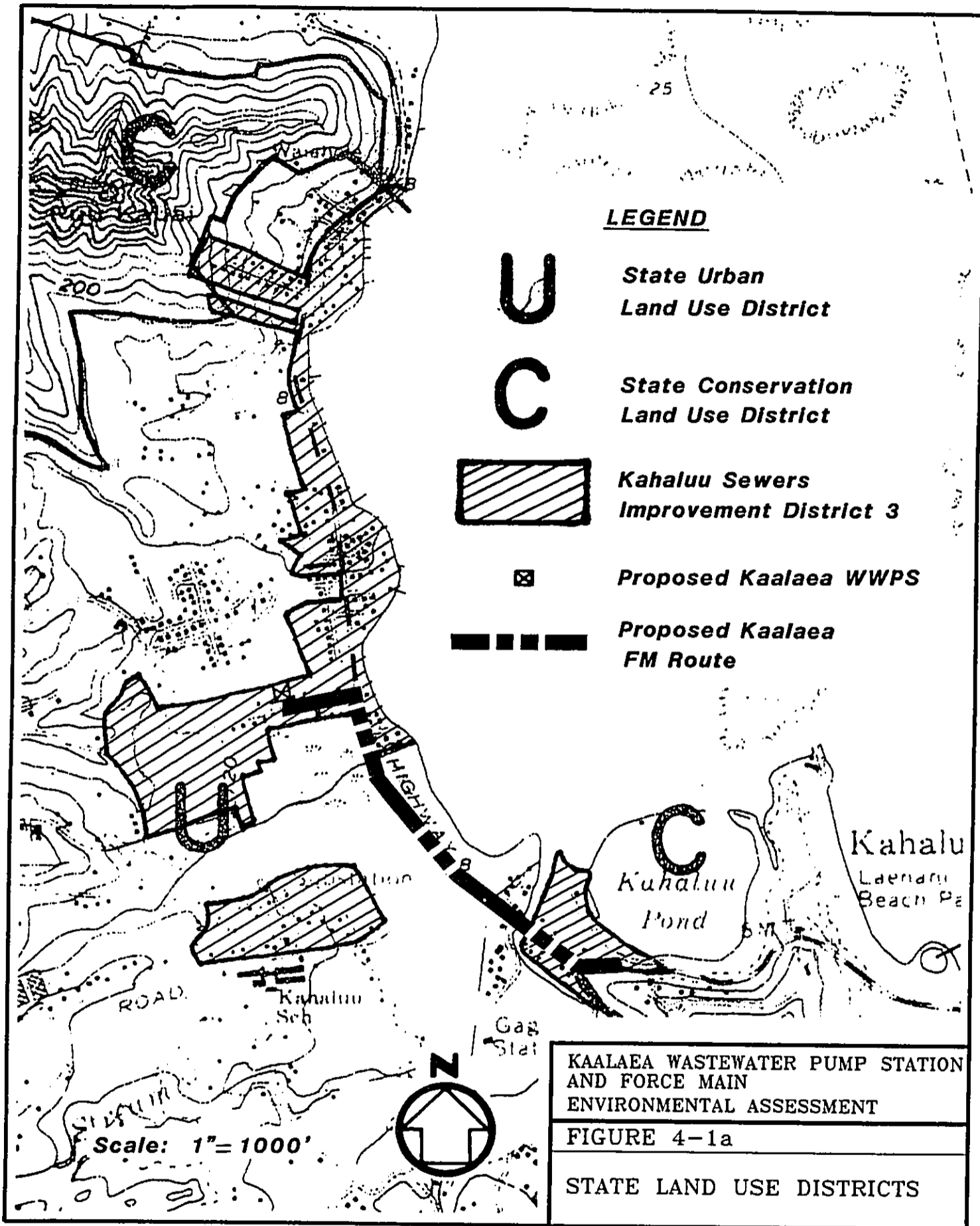



The City Department of Land Utilization has decided that since the proposed pump station and force main are substantially consistent with the plans contained in Resolution 89-570, an additional SMA permit will not be required.

#### 4.2.2 Archaeology

Eleven registered historic sites have been identified in the Kahaluu area, as shown on Figure 4-2. There are no known historic sites at the location of the proposed pump station or proposed force main route. However, these areas have not been inventoried for surface or subsurface historic sites, so the potential for the presence of archaeological sites does exist in these areas. Of particular concern is the proposed force main route, since it runs through an area of *prime land for traditional Hawaiian agriculture*. Trenching for the force main in areas outside of developed facilities corridors may expose subsurface deposits relating to traditional Hawaiian agriculture that contain information important to the history and prehistory of Hawaii.

A qualified archaeologist will monitor any excavation for the project which takes place outside of developed facilities corridors to identify and record any subsurface historic deposits and collect appropriate samples for laboratory analysis. A report of the laboratory analyses will be submitted to the Historic Preservation Division of the Department of Land and Natural Resources. A determination of "no adverse effect" will be made if sites are present or "no effect" if no sites are found.

#### 4.2.3 Coastal Views/Visual Resources

The proposed pump station will not have a significant impact on coastal views as it will be a single story structure in a residential neighborhood. Also, the proposed pump station is inland from Kamehameha Highway so the pump station will not block any coastal views from the highway. The architectural and landscaping features of the proposed pump station will be chosen to minimize visual impacts within the residential community.

There will be no visual impacts caused by the proposed underground force main.

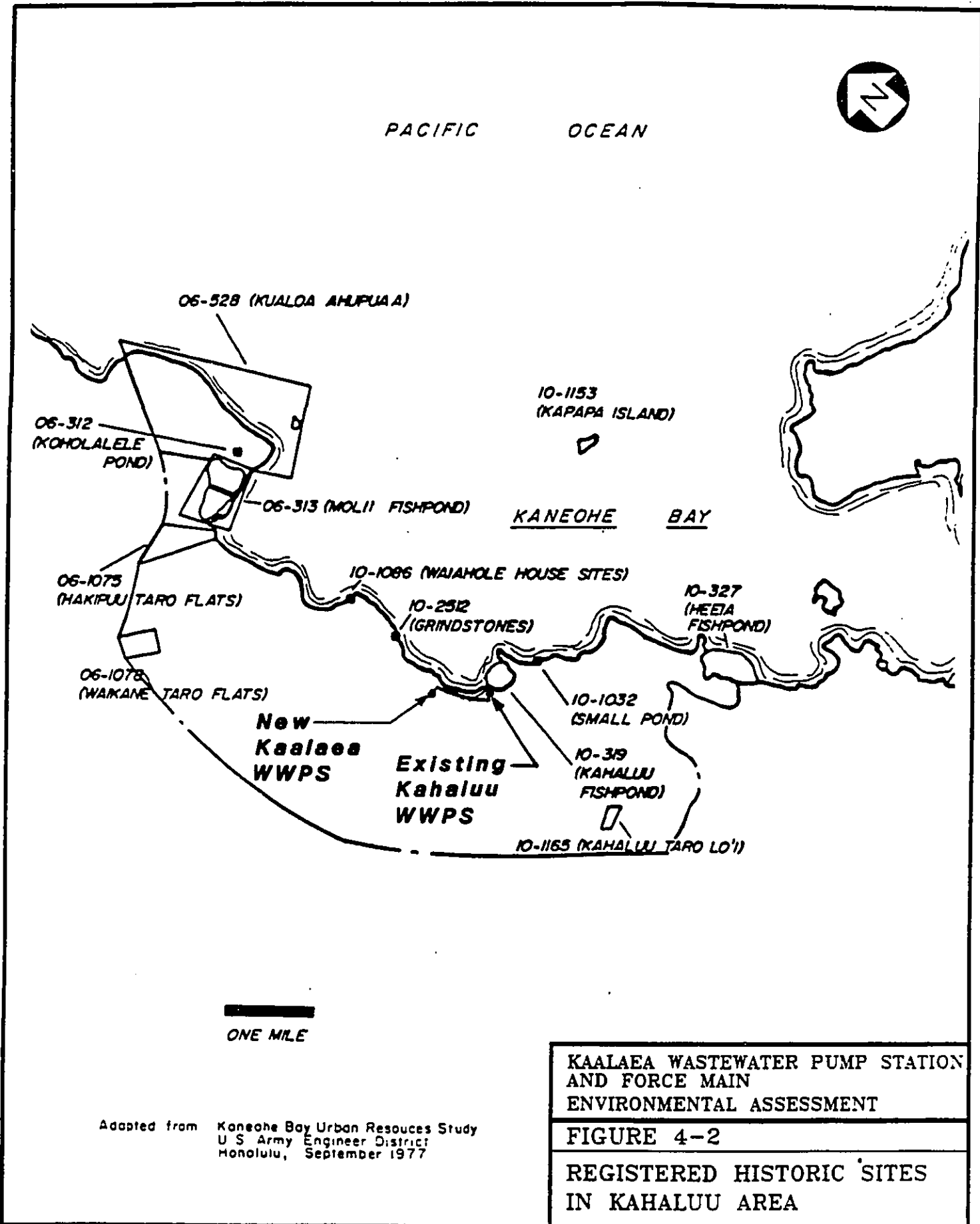

#### 4.2.4 Recreational Facilities

There are no recreational facilities in the vicinity of the proposed pump station site.

#### 4.2.5 Access For Persons With Disabilities

The proposed pump station design will comply with the accessibility requirements set forth in HRS 103-50. The construction plans will be submitted to the State Commission on persons with disabilities for review.

#### 4.2.6 Population

The proposed pump station will service the Kahala Sewers Section 3 Improvement District. This district is comprised of 130 acres with a projected ultimate population of 3,256. The land is mostly residential with some commercial areas.

#### 4.2.7 Economy

The new Kaalaea WWPS construction cost is estimated at \$2.6 million in 1993 dollars. The construction cost for the force main is estimated at \$0.7 to \$1.0 million in 1993 dollars. Operation and maintenance costs for the Kaalaea WWPS are expected to be approximately \$30,000 annually in 1993 dollars.

The City and County of Honolulu is expected to provide funds for construction. They will also provide funds for operation and maintenance costs. This will have the impact of higher sewer fees.

#### 4.2.8 Construction

Construction on the project will begin in late 1994. The work is expected to take approximately two years to complete.

### 4.3 INFRASTRUCTURE SYSTEMS AND SERVICES

#### 4.3.1 Traffic and Transportation System

Construction of the proposed pump station and force main will have a significant impact on traffic, particularly along Kamehameha Highway because of the volume of daily traffic.

Residential traffic on Wailehua Road will also be affected. Mitigation of these impacts will be provided to the greatest degree possible through coordination with the State Department of Transportation, Highways Division, and the City Department of Transportation Services with the design of the force main route and traffic control schemes.

Upon completion of the project, there should not be any impact on traffic on a regular basis, as the pump station will be designed to operate on an automated basis with periodic maintenance. Access to the pump station will be from Kamehameha Highway on Wailehua Road. In addition to periodic maintenance, a single unit truck will be required to bring diesel fuel for the standby generator fuel tank as necessary. All vehicles servicing the pump station will be able to maneuver on-site.

#### 4.3.2 Existing Utilities

The existing utilities available in the area are expected to be adequate for the needs of the proposed pump station. Water, electric, and telephone lines are currently available for connection. Electrical service is available but primarily in single phase. Overhead 3-phase lines will need to be brought in from Kamehameha Highway.

Water needs will be minimal on a daily basis, as water will normally only be required for the restroom, sink, and washdown of equipment. Periodic wetwell flushing and cleaning will use additional water on an intermittent basis. The availability of water will be determined when the building permit is submitted. If water is made available, the applicant will be required to pay the prevailing Water System Facilities Charge and any applicable meter installation charges.

A Board of Water Supply approved reduced pressure principle backflow prevention assembly should be installed on the domestic water service immediately after the property valve and prior to any branch piping.

A telephone connection will be required for telemetry of operating conditions to the Kailua WWTP and Sand Island WWTP SCADA (Supervisory Control and Data Acquisition) system.

The annual electrical usage for the pump station will be approximately 43,000 KWH.

#### 4.4 SUMMARY OF IMPACTS AND MITIGATIVE MEASURES

A summary of the impacts and the mitigative measures which may be implemented is presented in Table 4-1.

The primary temporary impacts are the dust, noise, liquid waste, and traffic due to construction. These factors will be mitigated by following State and County regulations and by establishing start and curfew times for construction.

The primary long term impacts are the possibility of odors, noise, and wastewater spills from the pump station. These factors will be accounted for in the design of the pump station. Higher sewer fees are also likely to result from the construction cost and annual operating and maintenance cost.

The beneficial impact of this project is the elimination of cesspools from the area and disposal of sewage into the ground. This will reduce the chance of deteriorating the water quality and the environment by sewage contamination.

TABLE 4-1  
SUMMARY OF IMPACTS AND  
MITIGATION MEASURES

<u>Probable Impact</u>	<u>Possible Mitigation Measures</u>
<u>Temporary Impacts</u>	
1. Dust due to construction	1. Follow State and County regulations
2. Noise due to construction	2. Establish start & curfew times for construction; comply with DOH noise regulations
3. Liquid waste from construction	3. Follow NPDES permit
4. Traffic during construction	4. Use traffic control plans; work during non-peak hours
<u>Permanent Impacts</u>	
1. Wastewater odors	1. Odor control facilities to be provided if necessary
2. Generator exhaust odors	2. Dilution system to be provided if necessary
3. Noise from generator	3. Acoustical design of generator room
4. Noise from pumps	4. Acoustical design of pump room; pumps located below grade
5. Wastewater spills	5. Spill prevention design features
6. Higher sewer fees	6. None
7. Elimination of cesspools in area	7. None - beneficial environmental impact
October 1993	\kaa\ea\IMFACTS.wk3

SECTION 5  
ENVIRONMENTAL IMPACTS OF ALTERNATIVE ACTIONS

5.1 NO ACTION

If no action is taken, then sewage disposal through the use of cesspools in the Kahaluu Sewers Section 3 Improvement District will continue. The cesspools will continue to be a potential source of groundwater and surface water contamination. The risk is increased due to the low seepage characteristics of the soil. Malfunctioning cesspools require frequent pumping and have a high probability of resulting spills. The elimination of the cost of pumping malfunctioning cesspools partially offsets the cost of the proposed project.

5.2 OPTIMIZE OPERATION OF EXISTING FACILITIES

This option seeks to optimize the performance of the existing on-site cesspools. Experience has shown that little can be done to significantly improve older cesspools which have declined in capacity and require frequent pumping. In addition, the low seepage characteristics of soil in the area inhibit optimization. Therefore, this option is not feasible.

5.3 PACKAGE WASTEWATER TREATMENT PLANTS (WWTP)

Small collection systems in combination with a packaged or prefabricated WWTP is another alternative. The development of a new wastewater treatment and disposal facility would incur much more cost and environmental impact than the proposed sewage pump station. There will be more operation and maintenance requirements and potential for problems. Effluent disposal will also be a concern, as will other problems typical of a wastewater treatment plant including odors, noise, aesthetics, and land acquisition.

5.4 ALTERNATE SITE

If another site can be found which is farther away from residences, this would be preferable. Problems with noise, odors and aesthetics would be lessened. As the current site is owned by the City, any other site may incur the cost of purchasing an additional plot of land. In addition, the collection system would have to be redesigned and/or reconstructed.

SECTION 6  
DETERMINATION

6.1 DEFINITION

An action is defined as having a significant impact on the environment if it contains any of the criteria listed in Chapter 200 of Title 11, Administrative Rules, "Environmental Impact Statement Rules." The criteria are as follows:

- \* Involves a loss or destruction of any natural or cultural resource.
- \* Curtails the range of beneficial uses of the environment.
- \* Conflicts with the State's long-term goals or guidelines as expressed in Chapter 344, HRS.
- \* Substantially affects the economic or social welfare of the community or state.
- \* Substantially affects public health.
- \* Involves substantial secondary effects, such as population changes or infrastructure demands.
- \* Involves a substantial degradation of environmental quality.
- \* Is individually limited but cumulatively has considerable effect on the environment, or involves a commitment to larger actions.
- \* Substantially affects a rare, threatened or endangered species or habitat.
- \* Detrimentally affects air or water quality or ambient noise levels.
- \* Affects an environmentally sensitive area, such as a flood plain, tsunami zone, erosion-prone area, geologically hazardous land, estuary, freshwater area, or coastal waters.

6.2 DETERMINATION

The proposed project does not contain any of the impact criteria listed above. The proposed project will not have any negative impacts on the environment and an Environmental Impact Statement is not required. In accordance with the provisions of Chapter 343, Hawaii Revised Statutes, a Negative Declaration is determined to be in order.



SECTION 7  
PERMITS AND APPROVALS

7.1 FEDERAL

The following Federal permit would only be required if the pipe bridge or stream dredging option for stream crossing of the force main is used:

- \* Department of the Army Permit for Activities in Waterways - Corps of Engineers (COE), Honolulu District, Fort Shafter

7.2 STATE OF HAWAII

The following permits are required by the State:

- \* State Highways Permit - State Department of Transportation, Highways Division
- \* NPDES Permit for Construction Related Discharges - State Department of Health (Chapter 55)

The following approvals are required by the State:

- \* Community Noise Control - State Department of Health (Chapter 43)
- \* Air Pollution Control - State Department of Health (Chapter 60)
- \* Wastewater Systems - State Department of Health (Chapter 62)
- \* Archaeological Review - State Department of Land and Natural Resources, Historic Preservation Division
- \* Commission on Persons With Disabilities

The following State permits would only be required if the pipe bridge or stream dredging option for stream crossing of the force main is used:

- \* Water Quality Certification Permit - State Department of Health (Chapter 54, Section 401)
- \* Stream Channel Alteration Permit - Department of Land and Natural Resources, Division of Water and Land Development
- \* Permit for Work in Shores and Shorewaters - Department of Transportation, Harbors Division

The following approval would be required from the State only if the pipe bridge or stream dredging option for stream crossing of the force main is used:

- \* Coastal Zone Management Federal Consistency Review - Office of State Planning

### 7.3 CITY AND COUNTY OF HONOLULU

The following City and County permits are required:

- \* Street Usage Permit - City Department of Transportation Services
- \* Grading, Grubbing, Excavating, and Stockpiling Permits - City Department of Public Works, Division of Engineering
- \* Building Permit - City Building Department
- \* Construction Dewatering Permit - Department of Public Works, Division of Engineering
- \* Combustible and Flammable Liquids Tank Installation Permit - Honolulu Fire Department

The following approvals are required by the City and County of Honolulu:

- \* Flood Determination in General Flood Plain District - Department of Land Utilization
- \* Landscaping Plan - Department of Land Utilization
- \* Department of Public Works, Division of Engineering
- \* Board of Water Supply

#### 7.4 UTILITY COMPANIES

Construction plans will be reviewed by the following utility companies:

- \* Hawaiian Electric Company
- \* Hawaiian Telephone Company
- \* Gasco
- \* Oceanic Cablevision

SECTION 8  
AGENCIES CONSULTED

The following is the list of agencies consulted for this Environmental Assessment:

8.1 FEDERAL

Ms. Karen Evans  
Pacific Islands Office  
Department of the Interior  
Fish and Wildlife Services  
P.O. Box 50167  
Honolulu, Hawaii 96850

Mr. William Meyer, District Chief  
Department of the Interior  
Geological Survey  
677 Ala Moana Boulevard, Room 415  
Honolulu, Hawaii 96813-5412

Mr. Warren M. Lee, State Conservationist  
Soil Conservation Service  
U.S. Department of Agriculture  
P.O. Box 50004  
Honolulu, Hawaii 96850

Mr. Kisuk Cheung, Director of Engineering  
Department of the Army  
Pacific Ocean Division, Building 230  
Fort Shafter, Hawaii 96858-5440

Mr. Alvin Char, Chief  
U.S. Army Support Command Hawaii  
Directorate of Public Works  
Attn: Environmental Management Office  
Fort Shafter, Hawaii 96858-5000

8.2 STATE OF HAWAII

Ms. Francine Wai, Director  
Commission on Persons with Disabilities  
Department of Health  
5 Waterfront Plaza  
500 Ala Moana Boulevard, #5-210  
Honolulu, Hawaii 96813

Mr. Mufi Hannemann, Director  
Department of Business, Economic Development and Tourism  
P.O. Box 2359  
Honolulu, Hawaii 96804

Dr. John C. Lewin, Director  
Department of Health  
P.O. Box 3378  
Honolulu, Hawaii 96801

Mr. Keith Ahue  
Department of Land and Natural Resources  
P.O. Box 621  
Honolulu, Hawaii 96809

Mr. Brian J. J. Choy, Director  
Office of Environmental Quality Control  
220 South King Street, Fourth Floor  
Honolulu, Hawaii 96813

Mr. Harold S. Matsumoto, Director  
Office of State Planning  
P.O. Box 3540  
Honolulu, Hawaii 96811-3540

Mr. Rex Johnson, Director  
Department of Transportation  
869 Punchbowl Street  
Honolulu, Hawaii 96813

Dr. John Harrison, Director  
University of Hawaii  
Environmental Center  
2550 Campus Road, Crawford 317  
Honolulu, Hawaii 96822

Dr. Sherwood Maynard, Director  
University of Hawaii  
Marine Option Program  
1000 Pope Road, Room 229  
Honolulu, Hawaii 96822

Dr. Roger Fujioka, Director  
University of Hawaii  
Water Resources Research Center  
2540 Dole Street, Holmes Hall 283  
Honolulu, Hawaii 96822

8.3 CITY & COUNTY OF HONOLULU

Mr. Kazu Hayashida, Manager and Chief Engineer  
Board of Water Supply  
630 South Beretania Street  
Honolulu, Hawaii 96813

Mr. Robin Foster, Chief Planning Officer  
Department of Planning  
650 South King Street, Eighth Floor  
Honolulu, Hawaii 96813

Mr. Donald A. Clegg, Director  
Department of Land Utilization  
650 South King Street, Seventh Floor  
Honolulu, Hawaii 96813

Mr. Walter M. Ozawa, Director  
Department of Parks and Recreation  
650 South King Street, Tenth Floor  
Honolulu, Hawaii 96813

Mr. Joseph Magaldi, Director  
Department of Transportation Services  
650 South King Street, Third Floor  
Honolulu, Hawaii 96813

Mr. Donald S.M. Chang, Fire Chief  
Fire Department  
3375 Koapaka Street, Suite H425  
Honolulu, Hawaii 96819

Mr. Michael Nakamura, Police Chief  
Police Department  
801 South Beretania Street  
Honolulu, Hawaii 96813

8.4 GOVERNMENT OFFICIALS

The Honorable Mike McCartney  
State Office Tower  
530 South King Street  
Honolulu, Hawaii 96813

The Honorable Terrance Tom  
State Office Tower  
530 South King Street  
Honolulu, Hawaii 96813

The Honorable Steve Holmes  
City Council  
530 South King Street  
Honolulu, Hawaii 96813

8.5 UTILITY COMPANIES

Mr. Roy Yoshimoto, Manager  
GASCO, Inc.  
P. O. Box 3379  
Honolulu, Hawaii 96842

Mr. William Bonnet, Manager  
Environmental Department  
Hawaiian Electric Company, Inc.  
P. O. Box 2750  
Honolulu, Hawaii 96840

Mr. Winslow Tanabe, Operations Manager  
OSP Engineering  
Hawaiian Telephone Company  
P. O. Box 2200  
Honolulu, Hawaii 96841

Mr. Don Camacho, Engineering Manager  
Oceanic Cablevision  
200 Akamainui Street  
Mililani, Hawaii 96789

8.6 ORGANIZATIONS

Life of the Land  
2500 Pali Highway  
Honolulu, Hawaii 96817

Sierra Club, Hawaii Chapter  
212 Merchant Street, Room 201  
Honolulu, Hawaii 96813

Kahaluu Neighborhood Board No. 29  
c/o Key Project  
47-200 Waihee Road  
Kaneohe, Hawaii 96744



APPENDIX A

APPENDIX A  
REVIEW PERIOD COMMENTS AND RESPONSES

The following agencies provided comments on the Draft Environmental Assessment during the consultation period. Copies of the comment and response letters are contained in this appendix.

FEDERAL

- Department of the Army, U.S. Army Engineer District, Honolulu

STATE OF HAWAII

- Commission On Person with Disabilities
- Department of Business, Economic Development & Tourism
- Department of Health
- Department of Land and Natural Resources
- Department of Transportation

CITY AND COUNTY OF HONOLULU

- Department of Land Utilization
- Planning Department
- Police Department
- Department of Transportation Services
- Board of Water Supply

UTILITIES COMPANIES

- GTE Hawaiian Telephone Company



DEPARTMENT OF THE ARMY  
U.S. ARMY ENGINEER DISTRICT, HONOLULU  
FORT SHAFTER, HAWAII 96858-5440

MAILED  
ATTENTION OF

July 12, 1993



Planning Division

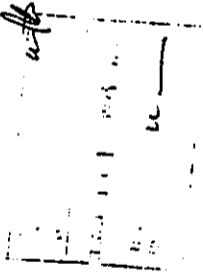

Mr. Leighton W. K. Lum,  
Chief Environmental Engineer  
R. M. Towill Corporation  
420 Waikamilo Road, Ho. 411  
Honolulu, Hawaii 96817-4941

Dear Mr. Lum:

Thank you for the opportunity to review and comment on the Draft Environmental Assessment for the Kaalaea Wastewater Pump Station and Force Main, TMK 4-7-14: 35 and 36). We do not have any additional comments to offer beyond those provided in our previous letter dated March 5, 1993.

Sincerely,

*Kisuk Cheung*  
Kisuk Cheung, P.E.  
Director of Engineering

R. M. TOWILL CORPORATION

480 WAIKAMILLO RD #411 HONOLULU, HI 96817-4941 (808) 848-1133 FAX (808) 848-1037

October 1, 1993

Mr. Kisuk Cheung, Director of Engineering  
Department of the Army  
Pacific Ocean Division, Building 230  
Fort Shafter, Hawaii 96858-5440

Dear Mr. Cheung:

Subject: Draft Environmental Assessment for the Kaalaea Wastewater Pump Station and Force Main, TMK 4-7-14:35 & 36, Kaalaea, Kaneohe, Hawaii

On behalf of the Department of Wastewater Management of the City and County of Honolulu, thank you for your July 12, 1993 comments on the subject project. We appreciate your review of the subject document.

A copy of your letter will be appended to the Environmental Assessment. If there are any questions, please contact Walter Chong at 842-1133.

Very truly yours,

*Leighton W.K. Lum*

Leighton W.K. Lum, PhD, PE  
Chief Environmental Engineer



**COMMISSION ON PERSONS WITH DISABILITIES**

Five Waterfront Plaza, Suite 210, 500 Ala Moana Blvd., Honolulu, HI 96813, Ph. 586-8121 (V/TDD) 586-8129 (FAX)

11/18/93

**R. M. TOWILL CORPORATION**  
480 WAIKAKULU RD #411 HONOLULU HI 96817-4041 808-548-1133 FAX 808-548-1037

2 August 1993

Mr. Walter Chong  
R. M. Towill, Inc.  
420 Waiakamilo Road, Suite 411  
Honolulu, Hawaii 96817

**Technical Assistance Review**

October 1, 1993

Ms. Francine Wai, Director  
Commission on Persons with Disabilities  
Department of Health  
5 Waterfront Plaza  
500 Ala Moana Boulevard, #5-210  
Honolulu, Hawaii 96813

Dear Ms. Wai:

Subject: Draft Environmental Assessment for the Kaalaea Wastewater Pump Station and Force Main, TMK 4-7-14:35 & 36, Kaalaea, Kaneohe, Hawaii

CPD Job #: 93-215  
Project Name: Kaalaea Wastewater Pump Station and Force Main  
Project Number: (na)

Documents Reviewed: Draft Environmental Assessment

The following comments identify those areas of this project which do not meet the minimum design requirements set forth in HRS 103-50. These comments represent technical assistance only and do not constitute a Final Document Review required by HRS 103-50. A written reply or submittal of plans addressing the noted deficiencies is requested. The Final Document Review will be provided upon submittal of the final construction documents.

Item	Sheet	Deficiency and/or Finding
1	p. 7	Statements in sections 3.3.1 and 4.2.5 conflict. Only the statement in section 3.3.1 represents the CPD viewpoint; the statement in 4.2.5 is untenable.
2	p. 27	Ben Gorospe is now the FA Coordinator (no longer Bruce Clark); although the address should reflect Francine Wai, Director Commission.....

Reviewed By:

Richard R. Bosch, Architect  
Senior Access Technician

On behalf of the Department of Wastewater Management of the City and County of Honolulu, thank you for your August 2, 1993 comments on the subject assessment. The statement in section 4.2.5 of the final version of the Environmental Assessment has been revised to comply with HRS 103-50. Construction drawings will be submitted for your review and approval.

A copy of your letter will be appended to the Environmental Assessment. If there are any questions, please contact Walter Chong at 842-1133.

Very truly yours,

Leighton W.K. Lum, PhD, PE  
Chief Environmental Engineer



**DEPARTMENT OF BUSINESS,  
ECONOMIC DEVELOPMENT & TOURISM**

Central Pacific Plaza 270 South King Street, 15th Floor, Honolulu, Hawaii  
 Phone: (808) 534-2400 Fax: (808) 534-2377

JOHN WAIKIE  
 MUI HANAUSSALA  
 BARBARA ERM STANTON  
 BOB EGGER  
 TALESI YOSHIMASA

JOHN WAIKIE  
 CONFERENCE



**STATE OF HAWAII  
 DEPARTMENT OF BUSINESS, ECONOMIC DEVELOPMENT & TOURISM  
 LAND USE COMMISSION**  
 Room 104, Old Federal Building  
 333 Merrihue Street  
 Honolulu, Hawaii 96813  
 Telephone: 597-3822

ENTER USA  
 DEPARTURE OFFICE

MAILED  
 JUL 11 1993  
 HONOLULU, HI

July 9, 1993

Mr. Leighton W.K. Lum  
 Chief Environmental Engineer  
 R.M. Towill Corporation  
 420 Waiakamilo Road, #411  
 Honolulu, Hawaii 96817-4941

Dear Mr. Lum:

The Department of Business, Economic Development & Tourism is pleased to submit the enclosed comments on the Draft Environmental Assessment for the Kaalaea Wastewater Pump Station and Force Main.

The comments were provided by the Land Use Commission. Questions regarding these comments may be directed to Esther Ueda, LUC Executive Officer at 587-3826.

Thank you for the opportunity to comment.

Sincerely,

*Mufi Hamann*  
 Mufi Hamann

Enclosure

July 7, 1993

Subject: Draft Environmental Assessment (DEA) for the Kaalaea Wastewater Pump Station and Force Main, TMK No.: 4-7-14: 35 & 36, Kaalaea, Kaneohe, Hawaii

We have reviewed the DEA for the subject project and would like to reiterate our comments of March 4, 1993 that the Final EA include a map showing the Improvement District, proposed pump station, and force main routes in relation to the State Land Use Districts.

We have no other comments to offer at this time.

EU:BKS:th

**R. M. TOWILL CORPORATION**

480 WAIKAWAHI RD #411 HONOLULU HI 96817-4941 (808) 848-1133 FAX (808) 848-1037

October 1, 1993

Mr. Mufi Hannemann, Director  
Department of Business, Economic Development and Tourism  
P.O. Box 2359  
Honolulu, Hawaii 96804

Dear Mr. Hannemann:

Subject: Draft Environmental Assessment for the Kaalaea Wastewater Pump Station  
and Force Main, TMK 4-7-14:35 & 36, Kaalaea, Kaneohe, Hawaii

On behalf of the Department of Wastewater Management of the City and County of Honolulu, thank you for your July 7, 1993 comments on the subject assessment. A map showing the Improvement District, proposed pump station and force main route in relation to the State Land Use Districts will be provided in the final version of the Environmental Assessment.

A copy of your letter will be appended to the Environmental Assessment. If there are any questions, please contact Walter Chong at 842-1133.

Very truly yours,



Leighton W.K. Lum, PhD, PE  
Chief Environmental Engineer

Engineers Planners Photogrammetrists Surveyors Construction Managers

1 2 3 4 5 6 7 8 9 10 11 12 13 14 15 16 17 18 19 20 21 22 23 24 25 26 27 28 29 30 31 32 33 34 35 36 37 38 39 40 41 42 43 44 45 46 47 48 49 50 51 52 53 54 55 56 57 58 59 60 61 62 63 64 65 66 67 68 69 70 71 72 73 74 75 76 77 78 79 80 81 82 83 84 85 86 87 88 89 90 91 92 93 94 95 96 97 98 99 100

Mr. Leighton M.K. Lum  
April 2, 1993  
Page 2

If you should have any questions on this matter, please call Jerry Haruno,  
Environmental Health Program Manager, Noise and Radiation Branch at 586-4701.  
Very truly yours,

*John C. Lewin*  
JOHN C. LEWIN, M.D.  
Director of Health

cc: Wastewater Branch  
Noise and Radiation Branch

JOHN C. LEWIN, M.D.  
DIRECTOR OF HEALTH

REC'D	APR 6 1993	11:11
HDR:		
USY:		
DISK:		

in year, and no other fee.



STATE OF HAWAII  
DEPARTMENT OF HEALTH  
P. O. BOX 3119  
HONOLULU, HAWAII 96811

April 2, 1993  
93-066/epo

Not rec'd in waft  
EA rec'd too  
(4-2)

Mr. Leighton M.K. Lum  
Chief Environmental Engineer  
R.M. Towill Corporation  
420 Waiakamilo Road #411  
Honolulu, Hawaii 96817-4941

Dear Mr. Lum:

Subject: Draft Environmental Assessment for the Kaalaea Wastewater  
Pump Station and Force Main, THK 4-7-14:35 & 36, Kaalaea  
Kaneohe, Hawaii

Thank you for allowing us to review and comment on the subject project.  
We have the following comments to offer:

Wastewater

We concur with the proposed project to collect wastewater from Section 3 of  
the Kahaluu Sewers Improvement District (I.D.) at the Kaalaea Wastewater Pump  
Station (WPS) and Force Main (FM) to improve the reliability and increase  
capacity for transporting wastewater flows to the County sewer system.

If you should have any questions on this matter, please contact  
Ms. Lori Kajiura of the Wastewater Branch at telephone 586-4290.

Noise and Radiation

1. Sound levels emanating from stationary equipment at the proposed Kaalaea  
Wastewater Pump Station must be attenuated to comply with the provisions  
of Administrative Rules, Title 11, Chapter 43, "Community Noise Control  
for Oahu."
2. Activities associated with the construction phase of the project must  
also comply with the provisions of Administrative Rules, Title 11,  
Chapter 43, "Community Noise Control for Oahu."
3. Traffic noise from heavy vehicles travelling to and from the project  
site must be minimized near existing residential areas and must comply  
with the provisions of Administrative Rules, Title 11, Chapter 42,  
"Vehicular Noise Control for Oahu."

JOHN WALKER  
GOVERNOR OF HAWAII



STATE OF HAWAII  
DEPARTMENT OF HEALTH  
P. O. BOX 3173  
HONOLULU, HAWAII 96801

SEARCHED	INDEXED
SERIALIZED	FILED
JUL 26 1993	
FBI - HONOLULU	

JOHN C. LEWIN, M.D.  
DIRECTOR OF HEALTH

in reply, please refer to:  
93-066/epo  
July 21, 1993

Mr. Leighton W.K. Lum  
Chief Environmental Engineer  
R.M. Towill Corporation  
420 Waiakamilo Road #411  
Honolulu, Hawaii 96817-4941

Dear Mr. Lum:

Subject: Draft Environmental Assessment for the  
Kaalaea Wastewater Pump Station and Force Main  
Kaalaea, Kaneohe, Hawaii  
TMK: 4-7-14: 35 & 36

Thank you for allowing us to review and comment on the subject document.  
We do not have any comments to offer besides those contained in our letter of  
April 2, 1993.

Very truly yours,

*John C. Lewin*

JOHN C. LEWIN, M.D.  
Director of Health

R. M. TOWILL CORPORATION  
420 Waiakamilo Rd #411 Honolulu HI 96817-4941 (808) 848-1133 FAX (808) 848-1037

October 1, 1993

Dr. John C. Lewin, Director  
Department of Health  
P.O. Box 3378  
Honolulu, Hawaii 96801

Dear Dr. Lewin:

Subject: Draft Environmental Assessment for the Kaalaea Wastewater Pump Station  
and Force Main, TMK 4-7-14:35 & 36, Kaalaea, Kaneohe, Hawaii

On behalf of the Department of Wastewater Management of the City and County of  
Honolulu, thank you for your July 21, 1993 comments on the subject assessment. The  
comments contained in your April 2, 1993 letter have been incorporated in the final version  
of the Environmental Assessment.

A copy of your letter will be appended to the Environmental Assessment. If there are any  
questions, please contact Walter Chong at 842-1133.

Very truly yours,

*Leighton W.K. Lum*

Leighton W.K. Lum, PhD, PE  
Chief Environmental Engineer

Engineers Planners Photogrammetrists Surveyors Construction Managers



John Smith  
Director of Water



STATE OF HAWAII  
DEPARTMENT OF LAND AND NATURAL RESOURCES  
P. O. BOX 51  
HONOLULU, HAWAII 96817

REF:OCEA:SKX

Keith W. Ahue, Chairperson  
BOARD OF LAND AND NATURAL RESOURCES

John P. Keppeler, II  
Donna L. Hanaika

ADVISORY COUNCIL  
ON AQUATIC RESOURCES  
CONSISTING OF  
MEMBERS APPOINTED BY  
THE BOARD OF LAND AND NATURAL RESOURCES  
AND THE DEPARTMENT OF LAND AND NATURAL RESOURCES

FILE NO.: 93-458  
DOC. NO.: 2453

MAR 31 1993

Mr. Leighton W. K. Lum  
Chief Environmental Engineer  
R. M. Towill Corporation  
420 Waiakamilo Road, #411  
Honolulu, Hawaii 96817-4941

Not included  
in VA/EA  
(rec'd too late)

Dear Mr. Lum:

SUBJECT: Draft Environmental Assessment (DEA) for the  
Kaalea Wastewater Pump Station and Force Main,  
Kaneohe, Oahu, TPK: 4-7-14: 35, 36

We have reviewed the information for the subject DEA transmitted by your  
letter dated February 24, 1993, and have the following comment:

**Brief Description:**

The County Department of Public Works is proposing to construct a new  
wastewater pump station on Waiilehua Road and a force main from this new  
station along Kaneohe Highway to an existing station near the Kahakahi  
Highway junction.

A new collection system is needed because of the large population in the  
subject area that currently utilize cesspools for wastewater disposal and  
because this area has been designated within the "Critical Wastewater  
Disposal Area."

Division of Aquatic Resources

The Division of Aquatic Resources comments that the proposed project  
provides an opportunity for residents to convert from cesspools to sewage  
line for their wastewater disposal. Accordingly, the potential for  
minimizing adverse impacts to nearshore aquatic resources can be  
realized. Precautions should be taken during all aspects of the proposed  
project to prevent wastewater, excessive sediments, construction debris,  
petroleum projects, and other contaminants from entering Kaneohe Bay.

Mr. L. Lum

File No.: 93-458

-2-

We note that the force main would cross several streams in the area, and  
suggest that the Commission on Water Resource Management (OWRM) be  
consulted during further planning for this project for possible Stream  
Channel Alteration Permit(s) (SCAP) that may be required.

Both our Division of Forestry and Wildlife and our Natural Area Reserves  
System Commission comment that they have no objections to the proposed  
project.

We will forward our Historic Preservation Division comments as they become  
available.

We have no other comments to offer at this time. Thank you for the  
opportunity to comment on this matter.

Please feel free to contact Steve Tegawa at our Office of Conservation and  
Environmental Affairs, at 587-0377, should you have any questions.

Very truly yours,

*Keith W. Ahue*  
KEITH W. AHUE

HMAT	W. L.	✓
DK	KTS	✓
RYK	WPC	✓
REC'D	APR 2 1993	1993
TRD	USY	✓
UHM		✓

RENEWABLE RESOURCES  
BOARD OF LAND AND NATURAL RESOURCES



STATE OF HAWAII  
DEPARTMENT OF LAND AND NATURAL RESOURCES

TIME	10:00-11:00
DATE	JUN 1 1993
BY	RECEIVED
FILE NO.	93-458A
DEC. NO.	2898

Not included  
in VA/EA  
(rec'd too late)

Mr. Leighton W. K. Lum  
Chief Environmental Engineer  
R. M. Towill Corporation  
420 Waiakamilo Road, #411  
Honolulu, Hawaii 96817-4941

Dear Mr. Lum:

SUBJECT: Draft Environmental Assessment (DEA) for the  
Kaalaea Wastewater Pump Station and Force Main,  
Kaunoe, Oahu, TTK: 4-7-14: 35, 36

The following are our Historic Preservation Division's comments on the  
subject project which supplement those forwarded in our previous letter  
dated March 31, 1993.

Historic Preservation Division

A review of our records shows that there are no known historic sites at  
the proposed location of the pump station, or along the route of the  
proposed force main. These areas have not been inventoried for surface or  
subsurface historic sites, so it is possible that historic sites,  
including human burials, are present. We are especially concerned with  
the force main, since it runs through an area of prime land for  
traditional Hawaiian agriculture. Hardly described this area in 1940 as  
"all sectioned with terraces" and "one of the largest single areas of wet  
taro land on the Koolau coast." Thus, we expect that trenching for the  
force main in areas outside of developed facilities corridors will expose  
subsurface deposits relating to traditional Hawaiian agriculture that  
contain information important to the history and prehistory of Hawaii.

Thus, we recommend that a qualified archaeologist monitor any excavation  
outside of developed facilities corridors to identify and record any  
subsurface historic deposits and collect appropriate samples for  
laboratory analysis. This would be followed by completion of laboratory  
analyses and submission of an acceptable report to the Historic  
Preservation Division. This would result in a "no adverse effect"  
determination if sites are present, or a "no effect" determination if no  
sites are found.

Mr. L. Lum

-2-

93-458A

We have no other comments to offer at this time. Thank you for the  
opportunity to comment on this matter.

Please feel free to call Tom Dye at Historic Preservation Division, at  
587-0014, should you have any questions.

Very truly yours,

*Keith W. Aube*  
KEITH W. AUBE

Keith W. Ahue, Chairperson  
Department of Land and Natural Resources

John P. Keppeler, II  
Donna L. Hanaika



STATE OF HAWAII  
DEPARTMENT OF LAND AND NATURAL RESOURCES

7, 8, 908 411  
HONOLULU, HAWAII 96817

REF:OCEA:KCK

File No.: 93-695  
DOC. ID.: 3172

JUL 21 1993

THAT	FILE	SEARCHED
DK	FILE	INDEXED
DK	FILE	INDEXED
REC'D JUL 29 1993 HAWAII		
FILE	SEARCHED	INDEXED
FILE	SEARCHED	INDEXED

Mr. Leighton W.K. Lum  
Chief Environmental Engineer  
R.M. Towill Corporation  
420 Waiakamilo Road, #411  
Honolulu, Hawaii 96817-4941

Dear Mr. Lum:

SUBJECT: Draft Environmental Assessment (DEA) for the Kaalaea Wastewater Pump Station and Force Main, TMK: 4-7-14: 35 & 36  
We have reviewed the DEA information for the proposed project transmitted by your letter dated June 25, 1993, and find that Sections 3.3.3, Department of Land and Natural Resources and Section 4.2.2 Archaeology, should be revised in the Final EA to accurately reflect our Historic Preservation Division's (HPD) comment that the potential for the presence of archaeological sites does exist in this area.

As discussed in our letter dated June 15, 1993, the subject project will run through an area of prime land for traditional Hawaiian agriculture. It is expected that trenching for the force main in areas outside of developed facilities' corridors will expose subsurface deposits relating to traditional Hawaiian agriculture which contain information important to the history and pre-history of Hawaii.

We also reiterated HPD's recommendation that a qualified archaeologist be utilized to monitor any excavations outside of developed facilities' corridors.

We have no other comments to offer at this time. Thank you for the opportunity to comment on this matter.

Please feel free to contact Steve Tagawa at our Office of Conservation and Environmental Affairs, at 587-0377, should you have any questions.

Very truly yours,

*Keith W. Ahue*  
KEITH W. AHUE

R. M. TOWILL CORPORATION  
180 WAIKIKI RD. #411 HONOLULU HI 96817-4141 HONOLULU, HAWAII 96817-4141

October 1, 1993

Mr. Keith W. Ahue, Chairperson  
Department of Land and Natural Resources  
P.O. Box 621  
Honolulu, Hawaii 96809

Dear Mr. Ahue:

Subject: Draft Environmental Assessment for the Kaalaea Wastewater Pump Station and Force Main, TMK 4-7-14:35 & 36, Kaalaea, Kaneohe, Hawaii

On behalf of the Department of Wastewater Management of the City and County of Honolulu, thank you for your July 27, 1993 comments on the subject assessment. Sections 3.3.3 and 4.2.2 will be revised to reflect the potential for the presence of archaeological sites at the project site. A qualified archaeologist will monitor any excavation for the subject project which takes place outside of developed facilities corridors.

A copy of your letter will be appended to the Environmental Assessment. If there are any questions, please contact Walter Chong at 842-1133.

Very truly yours,

*Leighton W.K. Lum*  
Leighton W.K. Lum, PhD, PE  
Chief Environmental Engineer

Engineers Planners Photographers Surveyors Construction Managers

JOHN HARRIS  
OWNER

RETO JORDAN  
OWNER  
RETO JORDAN  
JUICE LANE  
KAWAIA, HAWAII  
CALVIN TUSA  
OWNER



STATE OF HAWAII  
DEPARTMENT OF TRANSPORTATION  
869 PUNCHBOWL STREET  
HONOLULU, HAWAII 96813-5087

July 15, 1993

SEARCHED	INDEXED
SERIALIZED	FILED
JUL 20 1993	
FBI - HONOLULU	

Mr. Leighton W. K. Lum  
Chief Environmental Engineer  
R. M. Towill Corporation  
420 Waakamilo Road, Room 411  
Honolulu, Hawaii 96817-4941

Dear Mr. Lum:

Subject: Draft Environmental Assessment  
Kaalea Wastewater Pump Station and Force Main  
Kaalea, Kaneohe, Hawaii

To accommodate the future widening of Kamehameha Highway, we have been informing landowners to observe a 25-foot setback on both sides of the highway. Plans for any construction work within the State highway right-of-way must be submitted for our review and approval.

Thank you for the opportunity to provide comments.

Sincerely,

*Rex D. Johnson*  
Rex D. Johnson  
Director of Transportation

R. M. TOWILL CORPORATION

180 WAIKIKI DRIVE #411 HONOLULU, HAWAII 96817-4041 (808) 548-1123 FAX (808) 548-1037

October 1, 1993

Mr. Rex Johnson, Director  
Department of Transportation  
869 Punchbowl Street  
Honolulu, Hawaii 96813

Dear Mr. Johnson:

Subject: Draft Environmental Assessment for the Kaalea Wastewater Pump Station  
and Force Main, TMK 4-7-14:35 & 36, Kaalea, Kaneohe, Hawaii

On behalf of the Department of Wastewater Management of the City and County of Honolulu, thank you for your July 15, 1993 comments on the subject assessment. We appreciate the information you provided regarding the 25-foot setback on both sides of Kamehameha Highway. Construction drawings will be submitted for your review and approval.

A copy of your letter will be appended to the Environmental Assessment. If there are any questions, please contact Walter Chong at 842-1133.

Very truly yours,

*Leighton W.K. Lum*  
Leighton W.K. Lum, PhD, PE  
Chief Environmental Engineer

DEPARTMENT OF LAND UTILIZATION  
CITY AND COUNTY OF HONOLULU

150 SOUTH KING STREET  
HONOLULU, HAWAII 96813-2742

FILE NO.	DATE	BY
100-100000-100000	JUL 30 1993	LL

93-04629 (ASK)

FRANKIE FAN  
RECORD

CONRAD A. CLEGG  
DIRECTOR

DEPARTMENT OF LAND UTILIZATION

Mr. Leighton W. K. Lum  
Page 2  
July 29, 1993

If you have any questions, please contact Ardis Shaw-Kim of our staff at 527-5349.

July 29, 1993

Mr. Leighton W. K. Lum  
Chief Environmental Engineer  
R. M. Towill Corporation  
420 Waiakamilo Road, #411  
Honolulu, Hawaii 96817-4941

Dear Mr. Lum:

Draft Environmental Assessment for the  
Kaalaea Wastewater Pump Station and Force Main  
TAX Map Key: 4-7-14: 35, 36

This responds to your June 25, 1993 request for comments on the Draft Environmental Assessment (DEA) for the proposed Kaalaea wastewater pump station (WSPS) and force main.

As noted on page 17 of the DEA, the project is within the Special Management Area. On January 31, 1990, the City Council approved Resolution 89-570 (copy enclosed) for construction of a wastewater collection system consisting of sewer lines, pump stations and force mains within four improvement districts of the Kahaluu Sewerage Subdistrict, subject to conditions. The Kahaluu Sewers ID-3 and the Kaalaea WSPS were among the improvements approved by Resolution 89-570.

The proposed Kaalaea WPS and Force Main plans are substantially consistent with plans on file with the Department of Land Utilization, approved by Resolution 89-570. As such, an additional Special Management Area Use Permit is not required.

Be advised that the conditions of Resolution 89-570 remain in effect and must be met.

Very truly yours,

*Donald A. Clegg*

DONALD A. CLEGG  
Director of Land Utilization

DAC:lg  
Encl.

cc: Richard Leong, Department of Public Works

8/1/93:ds  
8/1/93:ds

CITY COUNCIL  
CITY AND COUNTY OF HONOLULU  
HONOLULU HAWAII

No. 89-570  
CD-1, FD-1

RESOLUTION

GRANTING A SPECIAL-MANAGEMENT AREA USE PERMIT FOR A WASTEWATER COLLECTION SYSTEM WITHIN THE KAHALUU SEWERAGE SUBDISTRICT

WHEREAS, the Department of Land Utilization (DLU) on October 5, 1989, accepted the application of the City and County of Honolulu, Department of Public Works, herein referred to as the APPLICANT, for a Special Management Area Use Permit (SMP) to construct a wastewater collection system consisting of sewer lines, pump stations and force mains within improvement districts within the Kahaluu Sewerage Subdistrict and identified as Tax Map Key 4-7-various plats; Reference Number 89/SMA-74; and

WHEREAS, on November 30, 1989, the DLU held a public hearing which was attended by 50 people; and

WHEREAS, on December 14, 1989, within ten (10) working days after the close of the public hearing, the DLU, having duly considered all evidence and reports of said public hearing and the review guidelines as established in Sections 33-3.1 and 33-3.2. Revised Ordinances of Honolulu, completed its report and transmitted its findings and recommendation of approval to the Council; and

WHEREAS, the City Council having received the findings and recommendation of DLU on December 14, 1989, and at its meeting of January 31, 1990, having duly considered all of the findings and reports on the matter, approved the subject application for an SMP with the conditions enumerated below; now, therefore,

BE IT RESOLVED by the Council of the City and County of Honolulu that an SMP be issued to the APPLICANT for Kahaluu Sewers Improvement Districts 1, 2, 3, and 4 as depicted in Exhibits A, B, and C attached hereto, under the following conditions:

- A. Prior to implementation of the project, the APPLICANT must meet the requirements and obtain approval of all government agencies normally required for such projects.
- B. Construction of the proposed project shall not disturb the eleven registered historic sites identified in the Final Environmental Impact Statement.

CITY COUNCIL  
CITY AND COUNTY OF HONOLULU  
HONOLULU HAWAII

No. 89-570  
CD-1, FD-1

RESOLUTION

- C. Prior to issuance of grading and building permits for each project increment, the APPLICANT shall contract with a professional archaeologist to monitor construction on a periodic basis and to perform data recovery work, as may be necessary. Prior to execution, a copy of the contract shall be submitted to the Department of Land and Natural Resources for review and approval.
- D. If, during construction, any previously unidentified sites or remains (such as artifacts, shell, bone, or charcoal deposits, human burials, rock or coral alignments, pavings, or walls) are encountered, the APPLICANT shall stop work and contact the State DLNR Historic Sites Office at 548-7460 and the contracted archaeologist immediately. Work in the immediate area shall be stopped until the Office is able to assess the impact and make further recommendations for mitigative activity.
- E. Additional landscaping, such as canopy trees and hedges, shall be provided as necessary to screen each wastewater pump station from public viewing areas. The existing Monkeypod tree located on the Laenani Wastewater Pump Station (WSPS) site shall be retained. A continuous hedge shall be provided along the perimeter of the Laenani WSPS facing the Laenani Beach Park. Prior to obtaining a building permit, the APPLICANT shall submit a landscape plan for each WSPS to DLU for approval.
- F. Construction permits shall be issued for plans which are substantially consistent with plans on file with the Department of Land Utilization. Any change in the size or nature of the project which has a significant effect on coastal resources addressed in Chapter 33, ROH, shall require a new application. Any change which does not have a significant effect on coastal resources shall be considered a minor modification and therefore permitted under this resolution, upon review and approval of the Director of Land Utilization.
- G. In order to assess the impacts of the proposed Wastewater Pump Station for Improvement District 3, plans shall be submitted to DLU for review and approval prior to issuance of a building permit. The WSPS for 1D-3 shall comply with Flood Hazard District Regulations.

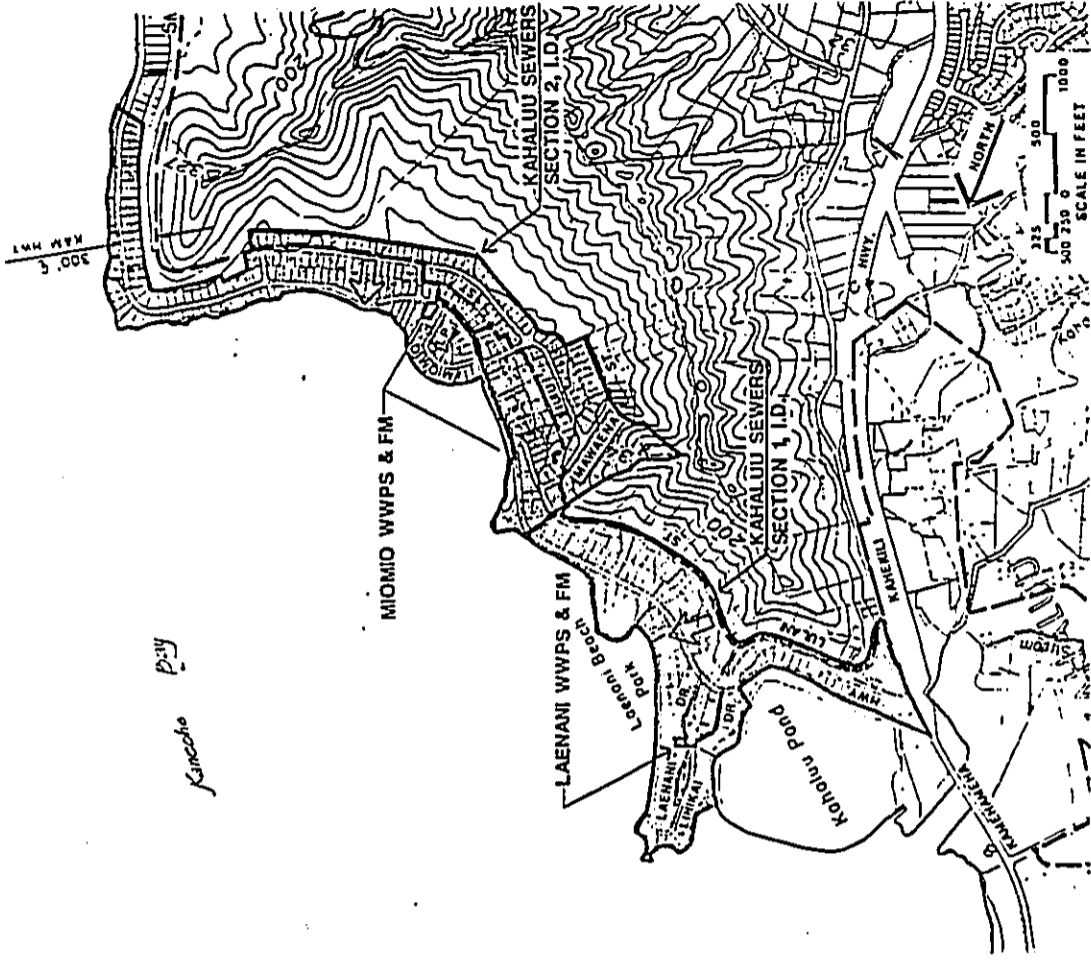

LOCATION MAP

Exhibit A

**RESOLUTION**

BE IT FINALLY RESOLVED by the Council of the City and County of Honolulu that the Clerk be, and he is, hereby directed to transmit copies of this resolution to Mr. Donald A. Clegg, Director of Land Utilization; Mr. Herbert Muraoka, Director and Building Superintendent, Building Department; Mr. William W. Paly, State Department of Land and Natural Resources, Historic Preservation Office, P. O. Box 621, Honolulu, Hawaii 96809 and Mr. Sam Callejo, Director and Chief Engineer, Department of Public Works.

INTRODUCED BY:

*[Signature]*

Councilmembers

DATE OF INTRODUCTION:

December 19, 1989

Honolulu, Hawaii

(8012690/na)

**CITY COUNCIL**  
CITY AND COUNTY OF HONOLULU  
HONOLULU, HAWAII

I hereby certify that the foregoing RESOLUTION was adopted by the COUNCIL OF THE CITY AND COUNTY OF HONOLULU on the date and by the vote indicated to the right.

ATTEST:  
*[Signature]*  
RICHARD K. TUA  
CITY CLERK

*[Signature]*  
ARNOLD MORCAJO, JR.  
CHAIR AND PRESIDING OFFICER

Dated JAN 31 1990

ADOPTED MEETING HELD		DATE	
JAN	31	1990	
AM			
PM			
ADPTD			X
DOO			
FRS			
CLL			
SHAWM			X
TRN			
MAVNO			
MORCAJO			
			7
			0
			2

Reference: D-1060  
Report No. ZCR-11

Resolution No.  
89-570  
CD-1, FD-1

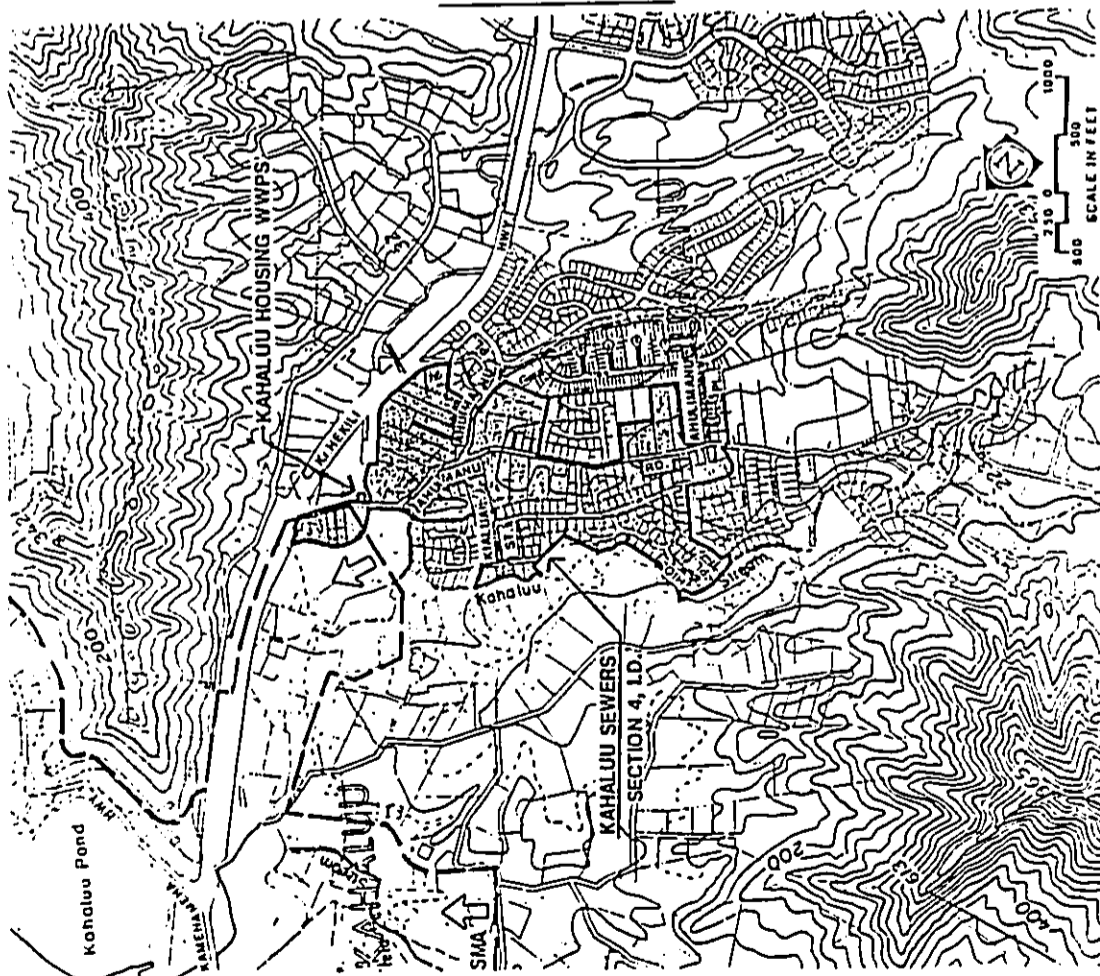

LOCATION MAP

Exhibit B

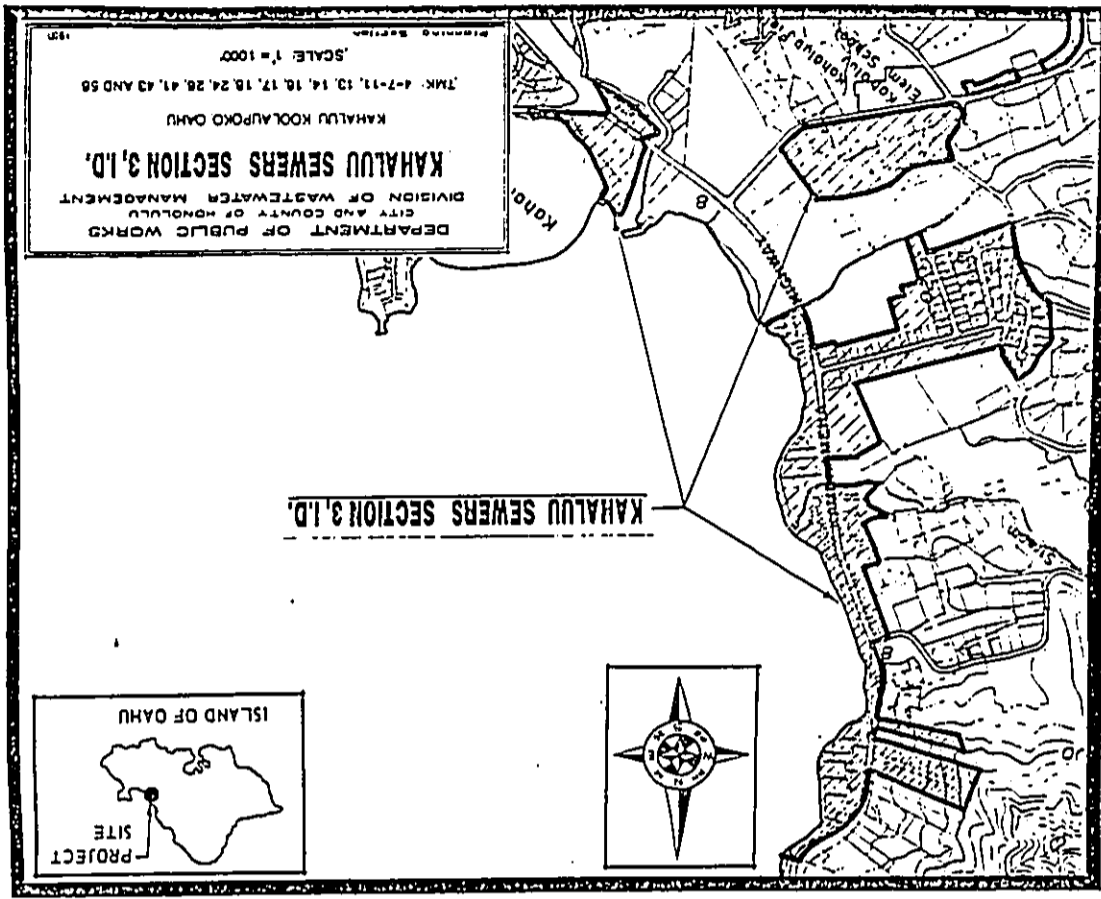

Exhibit C - Page 1



**EXHIBIT D**  
 SITE PLAN  
 Approx. Scale 1" = 20'

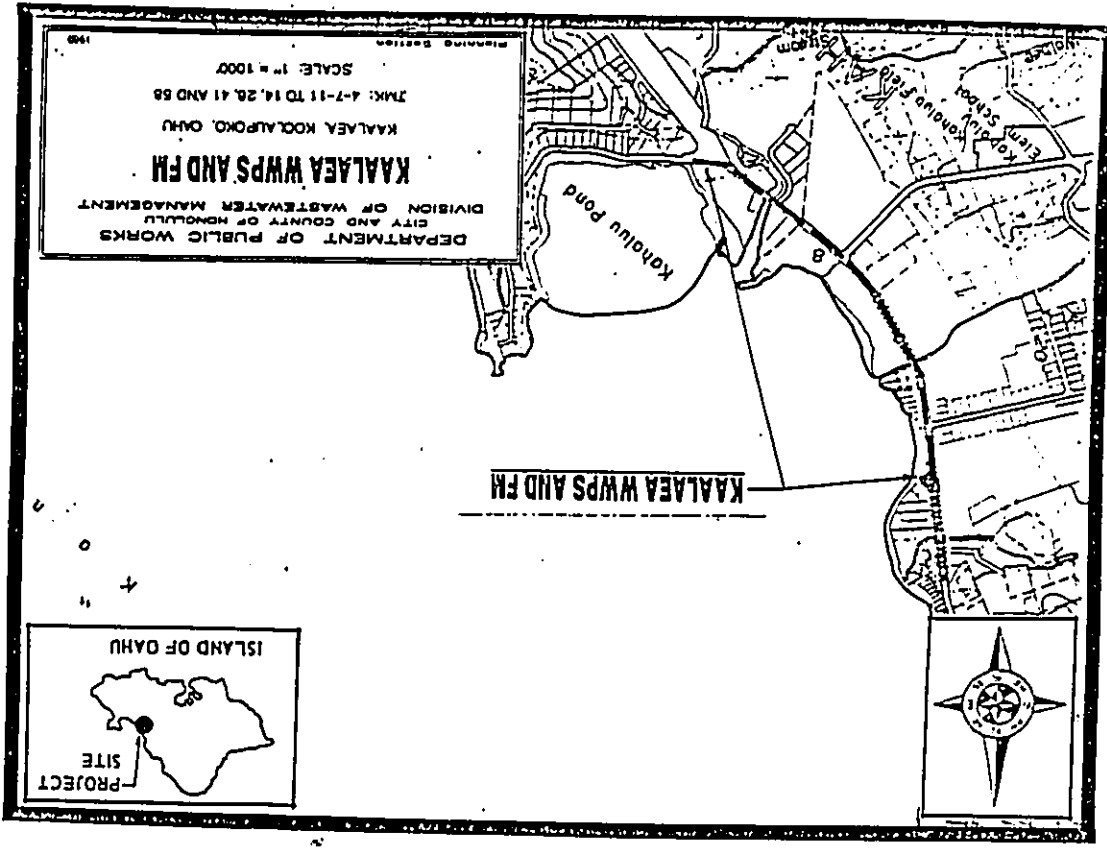
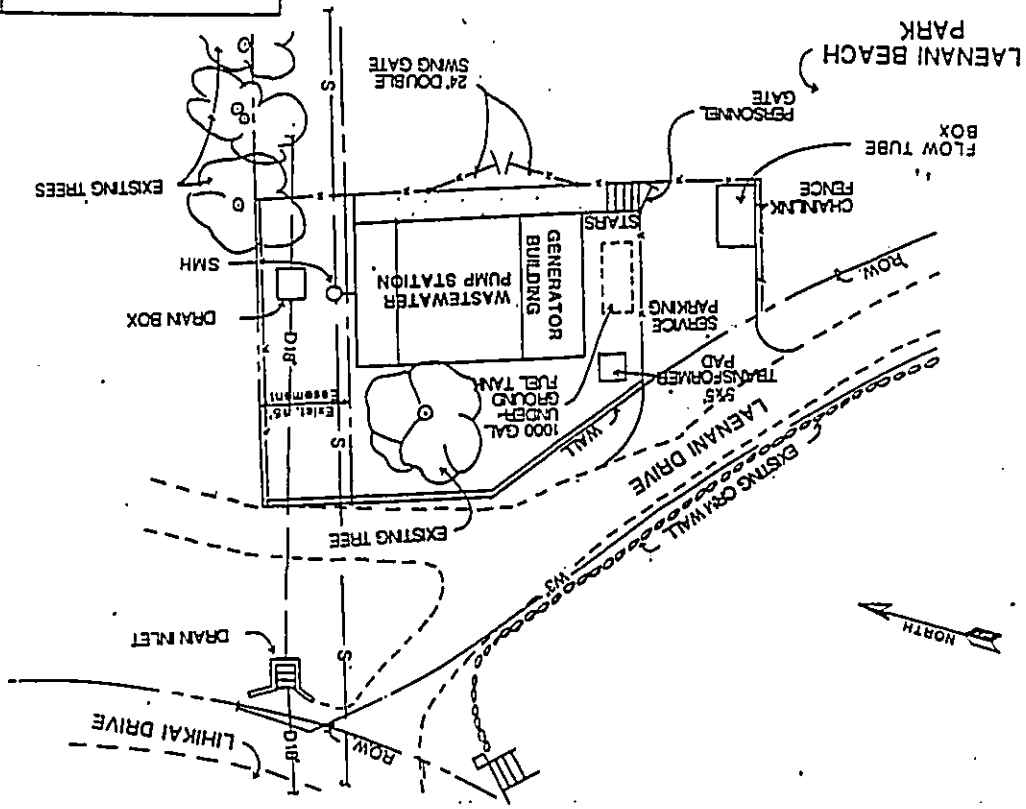

Exhibit C - Page 2

**R. M. TOWILL CORPORATION**

420 WAIKAMAHIA RD #111 HONOLULU HI 96817-4041 (808) 648-1123 FAX (808) 648-1037

October 1, 1993

Mr. Donald A. Clegg, Director  
Department of Land Utilization  
650 South King Street, Seventh Floor  
Honolulu, Hawaii 96813

Dear Mr. Clegg:

Subject: Draft Environmental Assessment for the Kaalaea Wastewater Pump Station and Force Main, TMK 4-7-14:35 & 36, Kaalaea, Kaneohe, Hawaii

On behalf of the Department of Wastewater Management of the City and County of Honolulu, thank you for your July 29, 1993 comments on the subject assessment. We appreciate the information you provided that a Special Management Area Use Permit is not required. The design of the project will meet the conditions of Resolution 89-570.

A copy of your letter will be appended to the Environmental Assessment. If there are any questions, please contact Walter Chong at 842-1133.

Very truly yours,

*Walter Chong*

Leighton W.K. Lum, PhD, PE  
Chief Environmental Engineer

Engineers Planners Photographers Surveyors Construction Managers

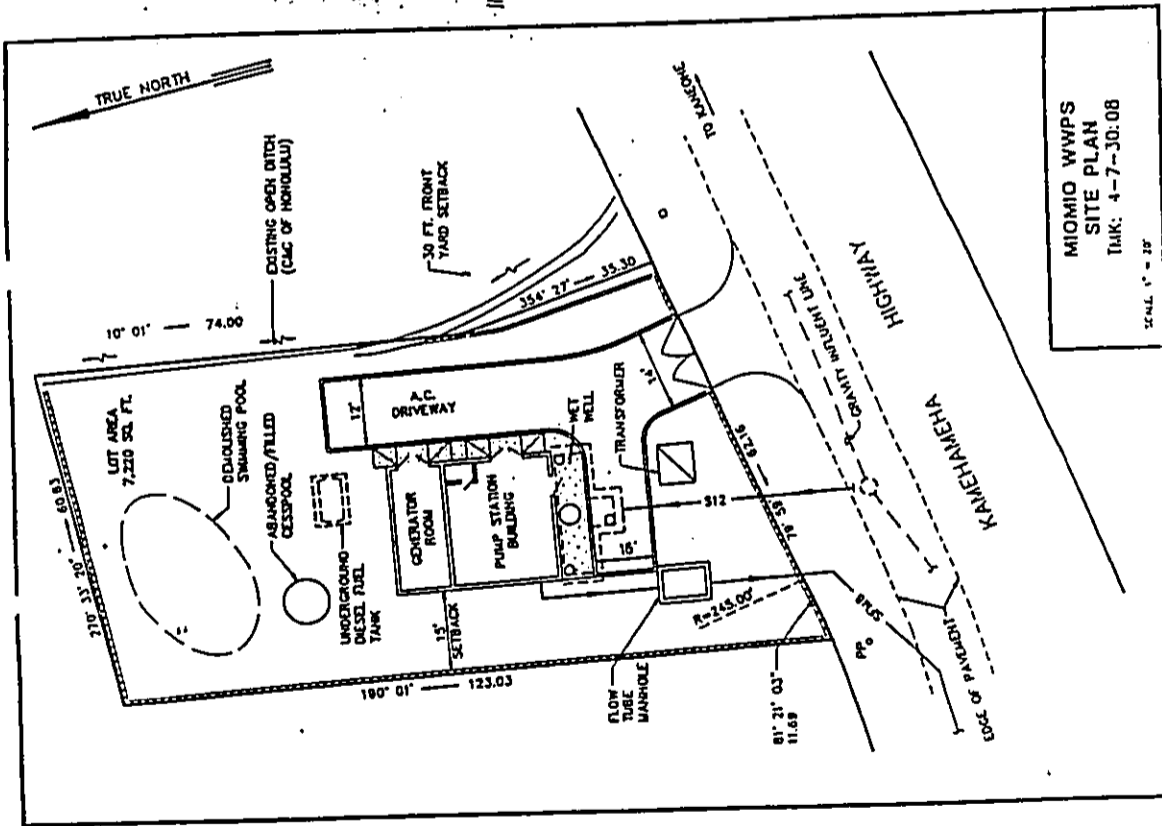

MCOM WWPS  
SITE PLAN  
TMK: 4-7-30-08

SCALE: 1" = 20'

**EXHIBIT E**

FILE M029  
SCALE 1" = 20'  
DATE 4/24/89

PLANNING DEPARTMENT  
CITY AND COUNTY OF HONOLULU  
650 SOUTH KING STREET  
HONOLULU, HAWAII 96813

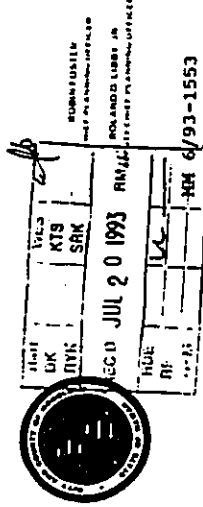

July 13, 1993

Mr. Leighton W.K. Lum  
Chief Environmental Engineer  
R. M. Towill Corporation  
420 Waikamilo Road, #411  
Honolulu, Hawaii 96817-4941

Dear Mr. Lum:

Draft Environmental Assessment for the  
Kaalaee Wastewater Pump Station and Force Main  
Tax Map Key 4-7-14: 35 & 36, Kaalaee, Kaneohe, Hawaii

This is in response to your request for comments on the  
Draft Environmental Assessment identified above. The Koolau-poko  
Development Plan Public Facilities Map was amended on July 29,  
1991 to include the subject proposal. We have no other comments  
to offer at this time.

Should you have any questions, please contact Melvin  
Murakami of our staff at 577-6020.

Sincerely,

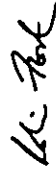
  
ROBIN FOSTER  
Chief Planning Officer

RF:ft

R. M. TOWILL CORPORATION  
420 WAIKAMILLO ROAD #411 HONOLULU HAWAII 96817-4941 (HONOLULU) 842-1133 FAX (HONOLULU) 842-1637

October 1, 1993

Mr. Robin Foster, Chief Planning Officer  
Department of Planning  
650 South King Street, Eighth Floor  
Honolulu, Hawaii 96813

Dear Mr. Foster:

Subject: Draft Environmental Assessment for the Kaalaee Wastewater Pump Station  
and Force Main, TMK 4-7-14:35 & 36, Kaalaee, Kaneohe, Hawaii

On behalf of the Department of Wastewater Management of the City and County of  
Honolulu, thank you for your July 13, 1993 comments on the subject assessment. We  
appreciate the information you provided regarding the Koolau-poko Development Plan  
Public Facilities Map.

We would also like for you to be aware that the Department of Land Utilization has  
informed us that:

"The proposed Kaalaee WWPS and Force Main plans are substantially  
consistent with plans on file with the Department of Land Utilization,  
approved by Resolution 89-570. As such, an additional Special Management  
Area Use Permit is not required."

A copy of your letter will be appended to the Environmental Assessment. If there are any  
questions, please contact Walter Chong at 842-1133.

Very truly yours,

  
Leighton W.K. Lum, PhD, PE  
Chief Environmental Engineer

POLICE DEPARTMENT  
**CITY AND COUNTY OF HONOLULU**  
 861 SOUTH BERETANIA STREET  
 HONOLULU, HAWAII 96813 - AREA CODE (808) 538-3111



FRANK P. JASI  
 MAYOR

FILE	FILE	FILE	FILE
INX	INX	INX	INX
WLS	WLS	WLS	WLS
KTS	KTS	KTS	KTS
SRK	SRK	SRK	SRK
JUL 20 1993			
MAYOR		DEPUTY MAYOR	
CHIEF		DEPUTY CHIEF	
MAYOR		DEPUTY MAYOR	
CHIEF		DEPUTY CHIEF	

OUR REFERENCE BS-LX

July 16, 1993

Mr. Leighton W. K. Lum  
 Chief Environmental Engineer  
 R. M. Towill Corporation  
 420 Waiakamilo Road, #411  
 Honolulu, Hawaii 96817-4941

Dear Mr. Lum:

This is in response to your request for comments on the draft environmental assessment for the Kaalaea Wastewater Pump Station, Kaneohe.

We note (on page 20) that dust, noise, liquid waste, and traffic impacts will be mitigated during construction, and that long term impacts such as odors, noise, and wastewater spills will be accounted for in the design of the station. We have no further comments on the draft.

Thank you for the opportunity to review this document.

Sincerely,

MICHAEL S. NAKAMURA  
 Chief of Police

By Eugene Uemura  
 EUGENE UEMURA  
 Assistant Chief of Police  
 Administrative Bureau

**R. M. TOWILL CORPORATION**  
 420 WAIKAMILLO RD #411 HONOLULU, HI 96817-4941 (808) 848-1123 FAX (808) 848-1027

October 1, 1993

Mr. Michael Nakamura, Police Chief  
 Police Department  
 801 South Beretania Street  
 Honolulu, Hawaii 96813

Dear Mr. Nakamura:

Subject: Draft Environmental Assessment for the Kaalaea Wastewater Pump Station and Force Main, TMK 4-7-14:35 & 36, Kaalaea, Kaneohe, Hawaii

On behalf of the Department of Wastewater Management of the City and County of Honolulu, thank you for your July 16, 1993 comments on the subject assessment. We appreciate your review of the subject document.

A copy of your letter will be appended to the Environmental Assessment. If there are any questions, please contact Walter Chong at 842-1133.

Very truly yours,

*Leighton W.K. Lum*  
 Leighton W.K. Lum, PhD, PE  
 Chief Environmental Engineer

0 1 2 3 4 5 6 7 8 9 10 11 12 13 14 15 16 17 18 19 20 21 22 23 24 25 26 27 28 29 30 31

DEPARTMENT OF TRANSPORTATION SERVICES  
CITY AND COUNTY OF HONOLULU

OFFICE OF THE DIRECTOR OF TRANSPORTATION SERVICES  
DEPARTMENT OF TRANSPORTATION SERVICES  
HONOLULU, HAWAII



SEARCHED	SERIALIZED	FILED
INDEXED		
REC'D JUL 26 1993		
FILE	RF	...

July 22, 1993

Mr. Leighton W. K. Lum  
Chief Environmental Engineer  
R. M. Towill Corporation  
420 Waiakamilo Road, #411  
Honolulu, Hawaii 96817-4941

Dear Mr. Lum:

Subject: Kaalaea Wastewater Pump Station and Force Main  
Draft Environmental Assessment (EA)  
TMK: 4-7-14: 35 AND 36

This is in response to your letter of June 25, 1993 requesting our comments on the draft EA.

Based on our review, we have the following comments:

- The access gate should be recessed as such that when Waiehuna Road is widened by 8 feet, the vehicles servicing the pump station will be clear of the sidewalk area.
- All vehicles servicing the pump station should be able to maneuver on-site.
- Construction plans for all work within the City's right-of-way should be submitted to our department for review. A traffic control plan showing temporary detours for pedestrians and vehicles should be included in these plans.

Should you have any questions, please contact Lance Hatanabe of my staff at 523-4199.

Sincerely,

JOSEPH H. MAGALDI, JR.  
Director

R. M. TOWILL CORPORATION

480 WAIKAMULO RD #411 HONOLULU HI 96817-4941 (808) 648-1133 Fax: (808) 648-1037

October 1, 1993

Mr. Joseph Magaldi, Director  
Department of Transportation Services  
650 South King Street, Third Floor  
Honolulu, Hawaii 96813

Dear Mr. Magaldi:

Subject: Draft Environmental Assessment for the Kaalaea Wastewater Pump Station and Force Main, TMK 4-7-14:35 & 36, Kaalaea, Kaneohe, Hawaii

On behalf of the Department of Wastewater Management of the City and County of Honolulu, thank you for your July 22, 1993 comments on the subject assessment. The access gate will be recessed to accommodate service vehicles when Waiehuna Road is widened by 8 feet. The site will be designed such that all vehicles servicing the pump station will be able to maneuver on-site. Construction drawings will be submitted for your review and approval. A traffic control plan will be included in the construction drawings.

A copy of your letter will be appended to the Environmental Assessment. If there are any questions, please contact Walter Chong at 842-1133.

Very truly yours,

Leighton W.K. Lum, PhD, PE

Chief Environmental Engineer

Engineers Planners Photographers Surveyors Construction Managers

BOARD OF WATER SUPPLY

CITY AND COUNTY OF HONOLULU  
630 SOUTH BERETANIA STREET  
HONOLULU HAWAII 96813



July 14, 1993

THOMAS I. PAULI, Mayor  
WALTER W. WALKER, Jr., Chairman  
MARGARET H. TAMAKAHO, Vice-Chairman  
SOLIH M. DAVUTYAN, Chairman, OSI  
JAMES W. AKERMAN, Jr.  
KEVIN JOHNSON  
MELISSA T. IMAI  
C. MICHAEL STREET

KAZU HAYASHIDA  
Manager and Chief Engineer

SEARCHED	INDEXED
SERIALIZED	FILED
JUL 1 1993	
FBI - HONOLULU	

Mr. Leighton W. K. Lum  
Chief Environmental Engineer  
R. M. Towill Corporation  
420 Waikamilo Road, #411  
Honolulu, Hawaii 96817-4941

Dear Mr. Lum:

Subject: Your Letter Of June 25, 1993 Regarding the Draft Environmental Assessment (EA) for the Proposed Kaalaea Wastewater Pump Station and Force Main, TMK: 4-7-14: 35 and 36, Waialehua Road

Thank you for the opportunity to comment on the Draft EA for the proposed Kaalaea Wastewater Pump Station and Force Main project.

Our pre-assessment comments of March 19, 1993, included in Section 3, are still applicable. As noted on page 25, construction plans for the project should be submitted for our review and approval.

If you have any questions, please contact Roy Doi at 527-5235.

Very truly yours,

KAZU HAYASHIDA  
Manager and Chief Engineer

R. M. TOWILL CORPORATION

420 WAIAKAMILO ROAD #411 HONOLULU HI 96817-4941 (808) 841-1153 FAX (808) 841-1037

October 1, 1993

Mr. Kazu Hayashida, Manager and Chief Engineer  
Board of Water Supply  
630 South Beretania Street  
Honolulu, Hawaii 96813

Dear Mr. Hayashida:

Subject: Draft Environmental Assessment for the Kaalaea Wastewater Pump Station and Force Main, TMK 4-7-14:35 & 36, Kaalaea, Kaneohe, Hawaii

On behalf of the Department of Wastewater Management of the City and County of Honolulu, thank you for your July 14, 1993 comments on the subject assessment. Construction drawings will be submitted for your review and approval. Any applicable Water System Facilities Charges and meter installation charges will be paid.

A copy of your letter will be appended to the Environmental Assessment. If there are any questions, please contact Walter Chong at 842-1133.

Very truly yours,

Leighton W.K. Lum, PhD, PE  
Chief Environmental Engineer



Beyond the call

All times are based on the company's standard  
For the Star Island Island (Hawaii) 1000-30-111

August 6, 1993

Mr. Leighton W.K. Lum  
R.M. Towill Corporation  
420 Waiakamilo Road, #411  
Honolulu, Hawaii 96817-4941

Subject: Draft Environmental Assessment for the Kaalaea  
Wastewater Pump Station and Force Main.

Dear Mr. Lum,

Thank you for allowing GTE Hawaiian Telephone to review the draft of the  
Environmental Assessment for the Kaalaea Wastewater Pump Station and Force Main.  
We have reviewed the Assessment document and found that GTE Hawaiian Telephone's  
facilities are largely aerial in the project area and should not be impacted.  
However, we would like to review the construction plans when they are finalized.  
Should you have any questions, please call Joy Fujita at 834-6314 or Stacy  
Shishido at 834-6285.

Sincerely,

Winslow Tanabe  
Operation Manager  
OSP Engineering

MT:am

Reply to  
ABY-3

Honolulu, HI

1000-30-111  
AUG 11 1993  
MAIL ROOM

R. M. TOWILL CORPORATION

480 Waiakamilo Rd #411 Honolulu HI 96817-4941 (808) 848-1133 FAX (808) 848-1037

October 1, 1993

Mr. Winslow Tanabe, Operations Manager  
OSP Engineering  
Hawaiian Telephone Company  
P. O. Box 2200  
Honolulu, Hawaii 96841

Dear Mr. Tanabe:

Subject: Draft Environmental Assessment for the Kaalaea Wastewater Pump Station  
and Force Main, TMK 4-7-14:35 & 36, Kaalaea, Kaneohe, Hawaii

On behalf of the Department of Wastewater Management of the City and County of  
Honolulu, thank you for your August 6, 1993 comments on the subject project. We  
appreciate the information you provided regarding GTE Hawaiian Telephone's facilities in  
the project area. Construction drawings will be submitted for your review and approval.

A copy of your letter will be appended to the Environmental Assessment. If there are any  
questions, please contact Walter Chong at 842-1133.

Very truly yours,

Leighton W.K. Lum, PhD, PE  
Chief Environmental Engineer