

Rec'd 12-2-93

DEC 23 1993

JOHN WAIHEE
GOVERNOR

DEC 6 8:13



ROBERT P. TAKUSHI
COMPTROLLER

LLOYD I. UNEBASAMI
DEPUTY COMPTROLLER

STATE OF HAWAII
DEPARTMENT OF ACCOUNTING AND GENERAL SERVICES
P. O. BOX 119, HONOLULU, HAWAII 96810

LETTER NO. (P) 1827.3

NOV 30 1993

Mr. Brian J. J. Choy
Director
Office of Environmental
Quality Control
Central Pacific Plaza
220 South King Street, 4th Floor
Honolulu, Hawaii 96813

Dear Mr. Choy:

Subject: Negative Declaration for
Waianae Intermediate School
New Six-Classroom Building
TMK 8-5-28:42

The Department of Accounting and General Services has reviewed the comments received during the 30-day public comment period which began on September 8, 1993. The agency has determined that this project will not have significant environmental effect and has issued a negative declaration. Please publish this notice in the December 23, 1993 OEQC Bulletin.

We have enclosed a completed OEQC Bulletin Publication Form and four copies of the final EA. If there are any questions, please have your staff call Mr. Ralph Morita of the Planning Branch at 586-0486.

Very truly yours,

Gordon Matsuoka
GORDON MATSUOKA
State Public Works Engineer

RM:jk
Attachments

WD

1993-12-23-0A-FEA-Waianae Intermediate School
New 6 Classroom Bldg

DEC 23 1993

FINAL ENVIRONMENTAL ASSESSMENT
(NEGATIVE DECLARATION)
WAIANAЕ INTERMEDIATE SCHOOL
NEW SIX-CLASSROOM BUILDING
NOVEMBER 29, 1993

- A. PROPOSING AGENCY: Department of Accounting and General Services for the Department of Education.
- B. APPROVING AGENCY: Not applicable.
- C. AGENCY CONSULTED: Department of Education.
- D. GENERAL DESCRIPTION OF THE TECHNICAL, SOCIO-ECONOMIC AND ENVIRONMENTAL CHARACTERISTICS:
1. Technical: This project is to design and construct a new reinforced concrete/masonry six-classroom building of approximately 7,800 square feet. Also included are any site improvements, connection to public utilities and easements which may be required as a result of this project.
 2. Socio-Economic:
 - a. The proposed project will not create sufficient work to substantially impact the economy and welfare of the community and State.
 - b. The estimated cost of the project is \$3,005,000.
 - c. Since the project will be constructed within the existing school campus, no land will be removed from the tax base.
 - d. The project will provide the school with a much-needed facility to implement its program in accordance with the Educational Specifications.
 3. Environmental:
 - a. The project will not create any major long-term environmental impacts.
 - b. However, during construction, the air quality may be affected by dust and exhaust emissions and it is anticipated there will be a temporary increase in noise levels.
 - c. These impacts are expected to be minimal since State and Federal regulations need to be met.

E. SUMMARY DESCRIPTION OF THE AFFECTED ENVIRONMENT, INCLUDING SITE MAPS:

1. The site of the proposed project is located on the school campus (TMK 8-5-28:42).
2. No habitat of endangered species, flora or fauna are known to exist at the site.
3. No historical, archaeological or cultural sites are known to exist at the site.
4. The site is not in a Special Management Area.
5. The school and the proposed project are located as shown in Figures 1 and 2, respectively.

F. IDENTIFICATION AND SUMMARY OF MAJOR IMPACTS AND ALTERNATIVES CONSIDERED:

1. Major Impacts: The proposed project will not:
 - a. Involve an irrevocable commitment to loss or destruction of any natural or cultural resources.
 - b. Curtail the range of beneficial uses of the environment.
 - c. Conflict with the State's long term environmental policies.
 - d. Substantially affect the economic or social welfare of the community or State.
 - e. Involve substantial secondary impacts, such as population changes or effects on public facilities.
 - f. Involve a substantial degradation of environmental quality.
 - g. Detrimentially affect air or water quality or ambient noise levels.

- h. Be located in any environmentally sensitive area, such as a flood plain, tsunami zone, erosion-prone area, geologically hazardous land, estuary, fresh water, or coastal waters.
- 2. Alternatives to the Proposed Project: "No action" is not considered to be a viable or desirable alternative.
- G. PROPOSED MITIGATION MEASURES: Short term impacts on air and noise quality during construction will be controlled by application of appropriate pollution and noise control measures.
- H. DETERMINATION: On the basis of the above assessment, it is concluded that the proposed project will not have a significant adverse impact on the environment.

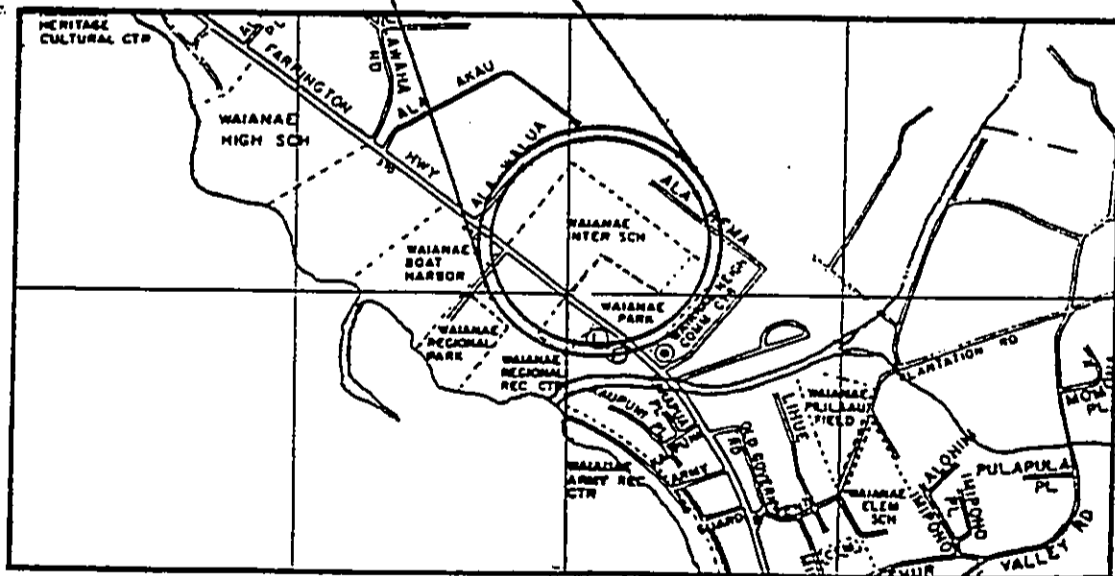
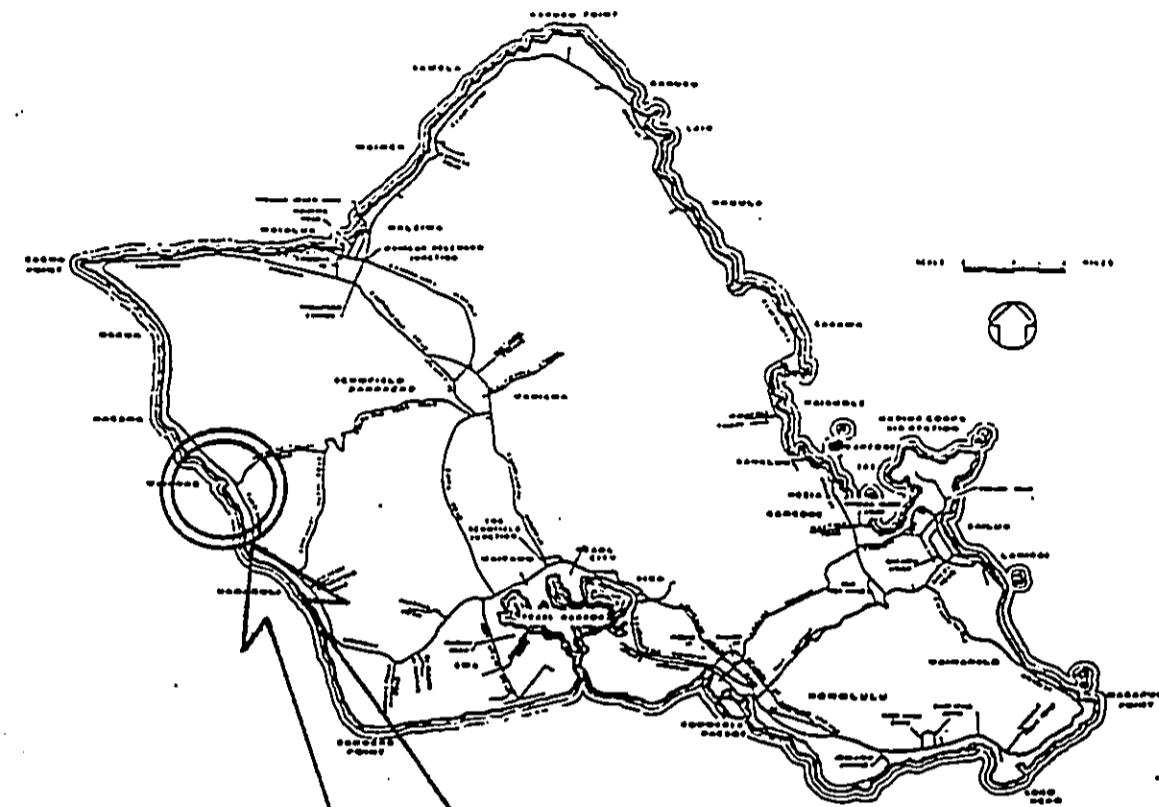

LOCATION MAP

FIGURE 1

SECOND OPTION FOR BUILDING LOCATION

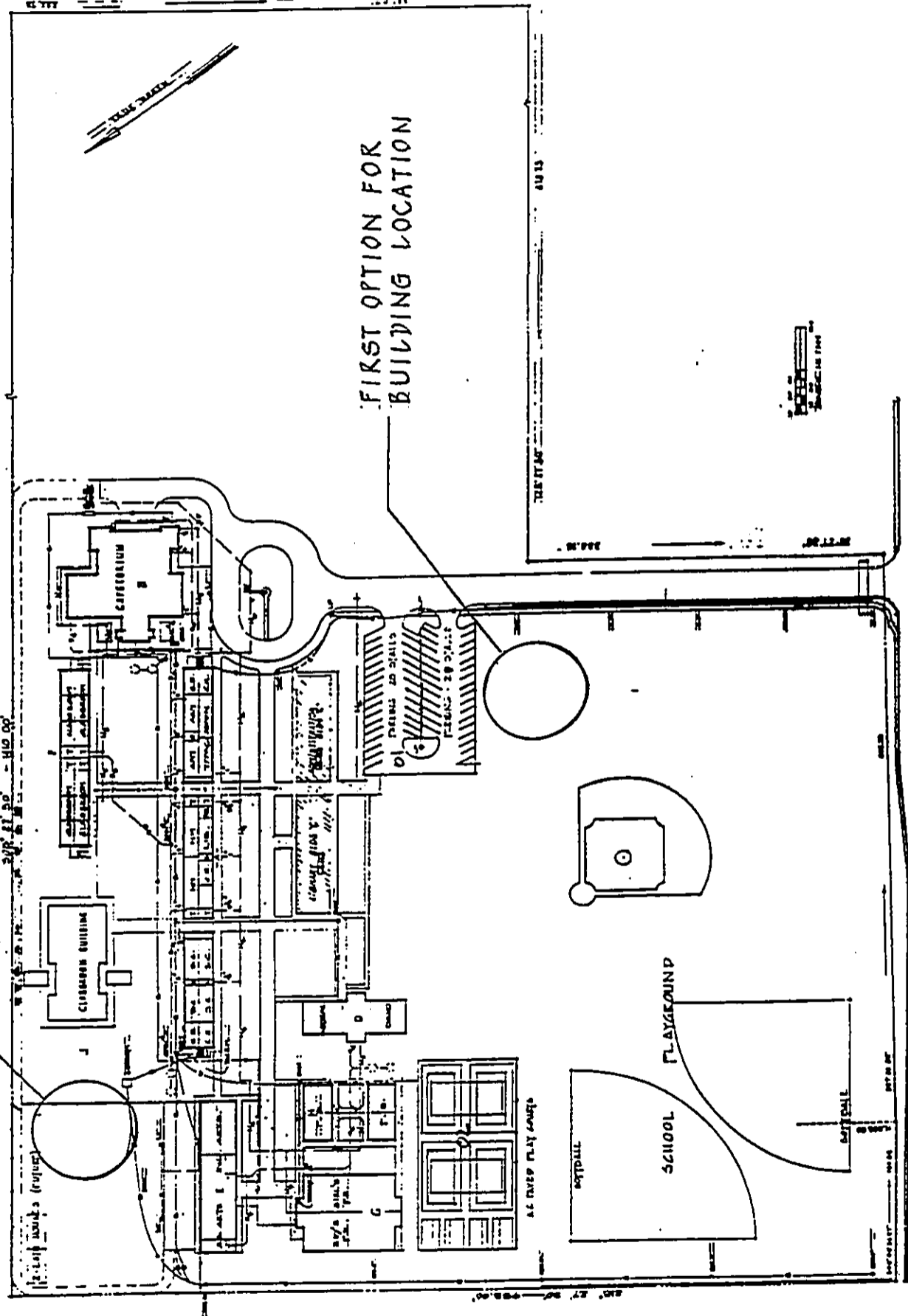

WAIANAЕ INTERMEDIATE SCHOOL

FIGURE 2