

98

DEPARTMENT OF PUBLIC WORKS
CITY AND COUNTY OF HONOLULU

650 SOUTH KING STREET
HONOLULU, HAWAII 96813

FRANK F. FASI
MAYOR

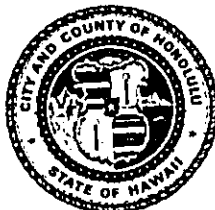

April 15, 1994

RECEIVED
KENNETH E. SPRAGUE 22
DIRECTOR AND CHIEF ENGINEER

IN REPLY REFER TO:
QUAL 94-11-0089

Mr. Bruce Anderson, Interim Director
Office of Environmental Quality Control
220 South King Street, 4th Floor
Honolulu, Hawaii 96813

Dear Mr. Anderson:

Subject: Negative Declaration for Kapunahala Stream Lining Repairs
at Hulinuu Place, TMK: 4-5-26: 002, 075, Kaneohe, Oahu, Hawaii

The City and County of Honolulu has not received any comments during the 30-day public comment period which began on March 8, 1994. The City and County of Honolulu has determined that this project will not have significant environmental effect and has issued a negative declaration. Please publish this notice in the April 23, 1994 OEQC Bulletin.

We have enclosed a completed OEQC Bulletin Publication Form and four copies of the final EA.

Please contact Ms. Jolie Yee at 523-4041 if you have any questions.

Very truly yours,

KENNETH E. SPRAGUE
Director and Chief Engineer

Encl.

1994-05-08-0A-*FEA-Kapunahala Stream* MAY - 8 1994
Repairs

DEPARTMENT OF PUBLIC WORKS
CITY AND COUNTY OF HONOLULU

ENVIRONMENTAL ASSESSMENT
FOR THE
KAPUNAHALA STREAM LINING REPAIRS
AT HULINUU PLACE
KANEHOE, OAHU, HAWAII
TAX MAP KEY: 4-5-26: 002, 075

This document is prepared pursuant to Chapter 343, HRS.

PROPOSING AGENCY: DEPARTMENT OF PUBLIC WORKS
CITY AND COUNTY OF HONOLULU
650 SOUTH KING STREET
HONOLULU, HAWAII 96813

RESPONSIBLE OFFICIAL: _____

[Signature]
KENNETH E. SPRAGUE
Acting Director and Chief Engineer

2/22/94
Date

PREPARED BY
DIVISION OF ENGINEERING
DEPARTMENT OF PUBLIC WORKS

TABLE OF CONTENTS

	<u>Page</u>
I. Description of Proposed Action and Statement of Objective	1
II. Description of Affected Environment	1
III. Agencies Consulted in Making this Assessment	1
IV. General Description of the Project's Technical, Economic, Social and Environmental Characteristics	2
V. Identification and Summary of Major Impacts	3
VI. Alternatives Considered	4
VII. Determination	4
VIII. Reasons for Supporting Determination	5
Appendix A - Location Map	
Appendix B - Site Map	
Appendix C - Plan	
Appendix D - Comments	

I. Description of Proposed Action and Statement of Objective

The proposed project involves the construction of a section of reinforced concrete channel lining in Kapunahala Stream near Kahekili Highway.

The project will repair the washed out section of stream at the rear of 45-603 Hulinuu Place.

II. Description of the Affected Environment

The proposed project is located in Kaneohe, Oahu, Hawaii (TMK: 4-5-26: 002, 075) along Kapunahala Stream near Kahekili Highway. The project is approximately 11 miles from the State Capitol in Honolulu (see Appendix A - Location Map). The project area is zoned residential.

The average annual rainfall in this area is 40 inches per year. The average temperature varies from 72.9 degrees to 79.1 degrees.

Kapunahala Stream is an unimproved channel in the project area. Kapunahala Stream is lined both up and downstream of the site. The stream is an intermittent stream that provides a water habitat for aquatic species such as tadpoles and insect and mosquito larvae. There is no vegetation in the stream near the project site.

The work will be done within a drainage easement in favor of the City and County of Honolulu.

Wildlife in the project area consists of the usual common birds found in built-up areas of Honolulu, and no rare or endangered species are known to frequent the lands adjacent to the proposed project.

There are no known archaeological or historical sites in the immediate project area. A search of the Hawaii Register of Historic Places indicates that the closest historical site is the Luluku Discontiguous Archaeological District located approximately 1000+ feet east of the project site.

III. Agencies to be Consulted in Making this Assessment

Copies of this environmental assessment will be sent to the following agencies for review:

- A. City and County of Honolulu
 - 1. Planning Department
 - 2. Department of Land Utilization

B. State of Hawaii

1. Department of Land and Natural Resources
2. Department of Health
3. Office of State Planning

C. U.S. Government

1. Department of Interior, Fish and Wildlife Service
2. Department of the Army, Corps of Engineers

D. Other

1. Kaneohe Neighborhood Board No. 30
2. Koolau Baptist Church
3. Mr. and Mrs. George Oshiro

Appendix D contains comments on the environmental assessment. After four months of review time no comments were received from the Office of State Planning and the Kaneohe Neighborhood Board No. 30. Mr. and Mrs. Oshiro responded by telephone (no amendments to the assessment).

IV. ***General Description of the Project's Technical, Economic, Social, and Environmental Characteristics***

The construction will entail filling the stream embankment and invert to provide a constant slope between existing channelized sections, the construction of concrete channel lining and replacement of chain link fencing at the back of 45-603 Hulinuu Place. The new section of concrete lining will be approximately 65 feet in length.

No adverse hydraulic effects are expected to result from the new channel lining because the cross-section will match existing dimensions both up and downstream of the site.

The project has an estimated construction cost of \$125,000.00. It is anticipated that construction will begin in the summer of 1994 and will take approximately 60 calendar days to complete. Operating funds from the Department of Public Works will be utilized for the project.

The project will not require the displacement or relocation of any people.

The construction site is within a drainage easement in favor of the City and County of Honolulu.

A stream alteration permit for the construction of the channel lining will be obtained from the State Department of Land and Natural Resources. Permit applications have also been filed with the Department of Health (401 Water Quality Certification), State Planning Office and the U.S. Army Corps of Engineers. The project will be covered under a nationwide permit from the U.S. Army Corps of Engineers.

V. **Identification and Summary of Major Impacts and Proposed Mitigation Measures**

The environmental impact of the proposed project will be limited to the construction phase and may include the following temporary, unavoidable, adverse environmental effects:

- A. **Dust and Noise Emission:** The discharge of dust into the atmosphere may occur during the construction period. This is, however, only a short-term effect on the environment. Dust will be reduced and controlled through application of water and/or appropriate methods. The specifications will contain provisions that will require the Contractor to prevent dust nuisance at all times and have sufficient equipment and manpower at the job site to accomplish this.

Noise will be generated by construction equipment such as backhoes and trucks. The increase in noise level by construction equipment cannot be avoided, but will be controlled and limited to normal working daylight hours. The Contractor will be required to obtain a Community Noise Permit pursuant to Chapter 43 of the State Public Health Regulations and shall comply with the provisions of Chapter 42, Vehicular Noise Control for Oahu. Individuals that may be adversely affected by the construction noises will be residents of the surrounding community. The sound level from equipment noise has been estimated for locations at various distances from the work area. The results may be summarized as follows:

	<u>Location</u>	<u>Distance from Project</u>	<u>Sound Level</u>
(1)	Nearest residence	50 feet	91 dB
(2)	Nearest church	50+ feet	91 dB
(3)	Nearest school	1200+ feet	63 dB
(4)	Nearest medical center	2600 feet	57 dB
(5)	Nearest playground	1300 feet	63 dB
(6)	Nearest library	3800 feet	53 dB

- B. *Water Pollution:* Construction will be scheduled during the dry season (summer months) and provisions will be made to divert or transfer the water around the work area. This may be accomplished with sandbags, etc. This will minimize erosion and sedimentation during construction activities.

The Contractor will be required to properly dispose of wash and dust control water and to take other precautionary actions during the course of construction operations to preclude the discharge of petrochemical products from construction equipment into the stream.

Proper construction methods will be used to minimize disturbance to the stream bed and prevent the entrance of debris and other deleterious materials into the water.

- C. *Archaeological Deposits:* Since the construction involves filling the stream bank in an unimproved segment of a lined stream, no impact on archaeological deposits is anticipated. The specifications will require the Contractor to contact the Historic Sites Section of the Department of Land and Natural Resources in the event that such deposits are encountered.
- D. *Disturbance to Marine Life:* Since construction will occur in the summer (low flow months) in an intermittent stream, the fish and wildlife usage of the stream will be limited and the impact is not considered to be significantly adverse.

VI. *Alternatives Considered*

The following courses of action were considered: (1) no action, (2) the proposed project.

Alternative 1: If no action is taken, erosion of the stream in the unlined segment may continue. Eventually, the lined segment downstream may be undermined.

Alternative 2: Completion of the proposed project would line the unlined segment of an otherwise lined portion of Kapunahala Stream and preclude erosion at the site.

VII. *Determination*

After preparing an environmental assessment, we have determined that the proposed project will not have a significant impact on the environment, and an environmental impact statement will not be prepared.

VIII. *Reasons for Supporting Determination*

Based on the criteria, the policies, guidelines and provisions of Chapter 342, 343 and 344, HRS, for the reason supporting the Negative Declaration determination is that the proposed project will not:

- affect rare or endangered species of flora or fauna.
- affect any natural or cultural resources.
- affect undeveloped lands
- conflict with existing land use and development plans.
- have significant long term effect on air quality, water quality or ambient noise levels.
- displace any residences or businesses.
- be located in close proximity to any known natural, historic or archaeological sites.

DOCUMENT CAPTURED AS RECEIVED

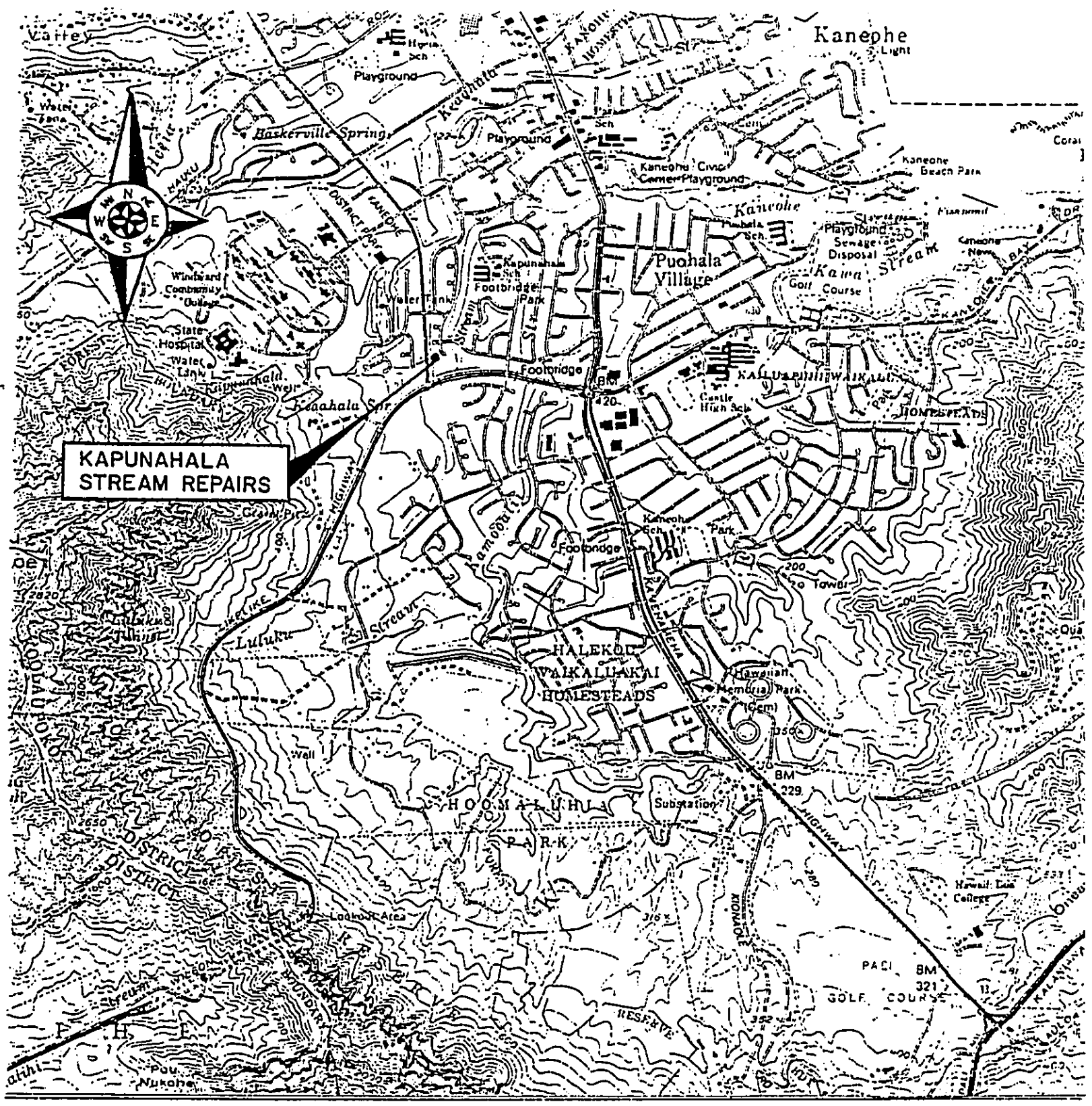

APPENDIX A
LOCATION MAP

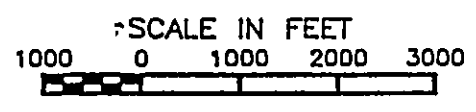

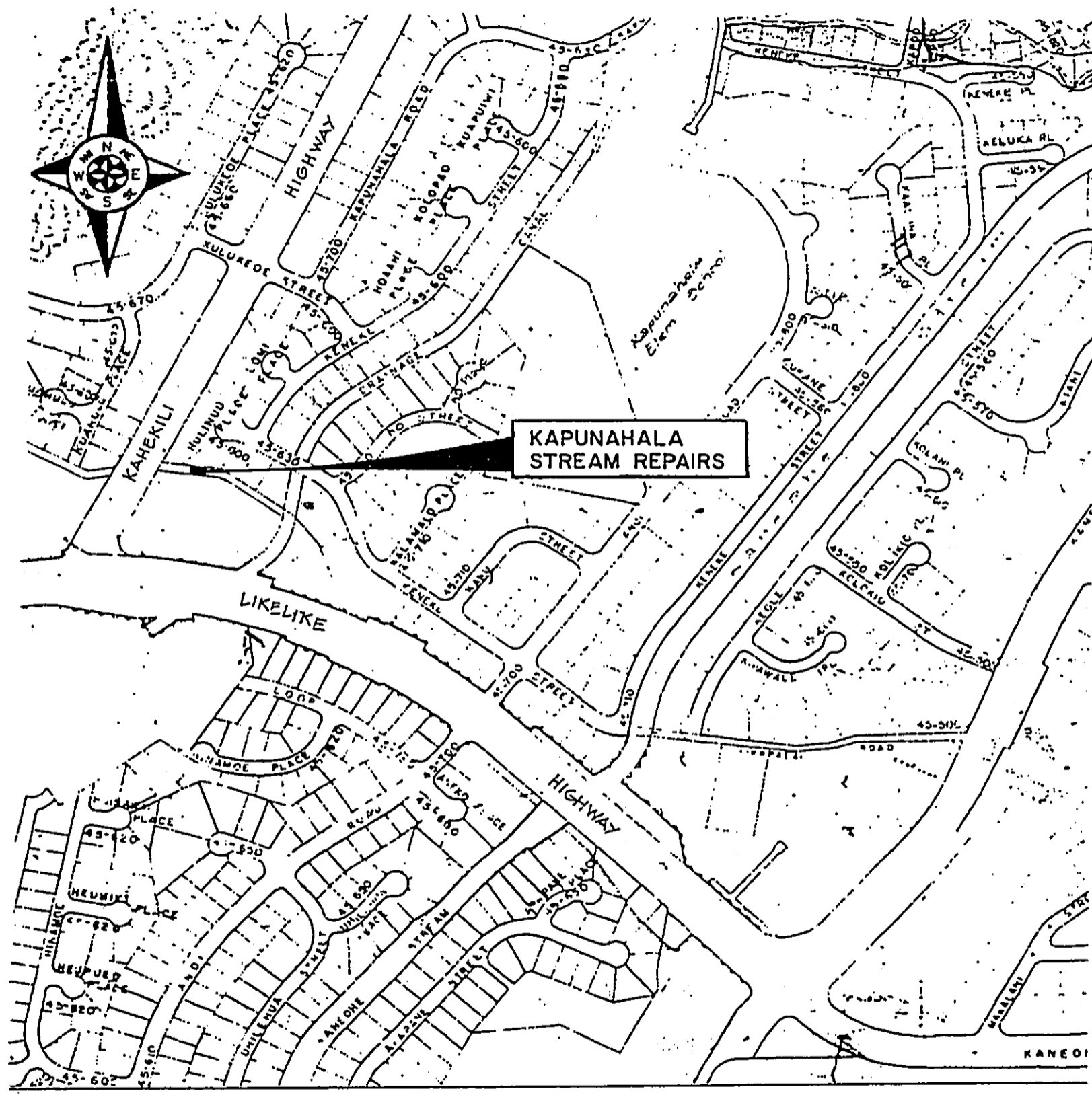

APPENDIX B
SITE MAP
NOT TO SCALE

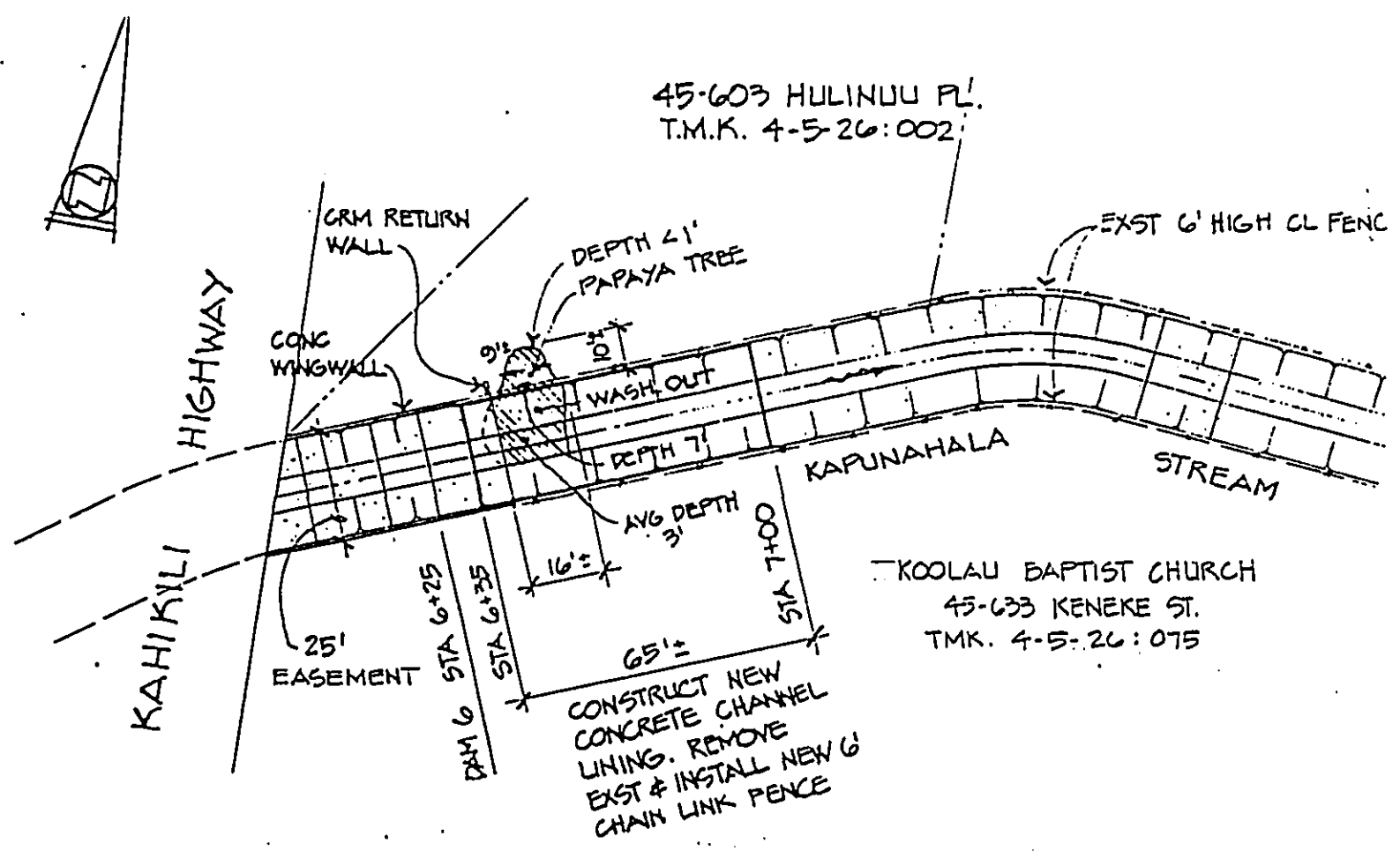

PLAN SC: 1"=40'

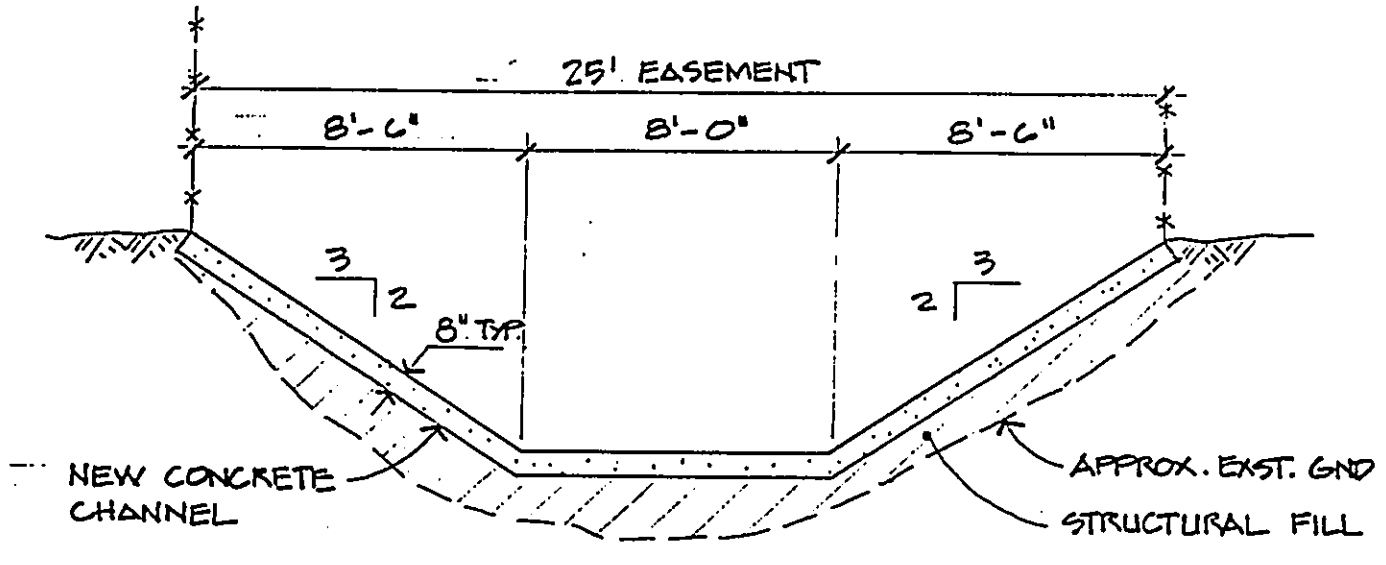

TYPICAL SECTION SC: 1"=5'

APPENDIX C.

APPENDIX D
COMMENTS

PLANNING DEPARTMENT
CITY AND COUNTY OF HONOLULU
DEPT. OF PUBLIC WORKS
650 SOUTH KING STREET
HONOLULU, HAWAII 96813

FRANK F. FASI
MAYOR

OCT 21 2 40 PM '93
KRA
mg



93-3557

ROBIN FOSTER
CHIEF PLANNING OFFICER
ROLAND D. LIBBY, JR.
DEPUTY CHIEF PLANNING OFFICER

MM 10/93-2368

October 19, 1993

RECEIVED
DIV. OF ENGINEERING
OCT 22 9 32 AM '93

MEMORANDUM

TO: C. MICHAEL STREET, DIRECTOR AND CHIEF ENGINEER
DEPARTMENT OF PUBLIC WORKS

FROM: ROBIN FOSTER, CHIEF PLANNING OFFICER
PLANNING DEPARTMENT

SUBJECT: ENVIRONMENTAL ASSESSMENT FOR KAPUNAHALA STREAM
REPAIRS AT HULINUU PLACE
TAX MAP KEY: 4-5-26: 02

This is in response to your October 4, 1993 memorandum requesting our comments on the subject application.

The Koolaupoko Development Plan Public Facilities Map does not show improvements on the subject site. However, this is not a requirement since the repair work is considered to be minor in nature.

Thank you for the opportunity to comment. Should you have any questions, please contact Mel Murakami of our staff at 527-6020.

ROBIN FOSTER
Chief Planning Officer

RF:ft

DOCUMENT CAPTURED AS RECEIVED

RECEIVED
CITY AND COUNTY OF HONOLULU
DEPARTMENT OF LAND UTILIZATION
DEPT. OF PUBLIC WORKS

650 SOUTH KING STREET
HONOLULU, HAWAII 96813 • (808) 523-4432

Oct 29 3 55 AM '93

93-3641
ENGL

FRANK F. FASI
MAYOR



DONALD A. CLEGG
DIRECTOR

LORETTA K.C. CHEE
DEPUTY DIRECTOR
93-08125 (DT)

October 28, 1993

MEMORANDUM

TO: C. MICHAEL STREET, DIRECTOR AND CHIEF ENGINEER
DEPARTMENT OF PUBLIC WORKS

FROM: DONALD A. CLEGG, DIRECTOR
DEPARTMENT OF LAND UTILIZATION

SUBJECT: ENVIRONMENTAL ASSESSMENT (EA) FOR KAPUNAHALA STREET
REPAIRS AT HULINUU PLACE, KANEOHE, OAHU
TAX MAP KEY: 4-5-26: 2

RECEIVED
DIV. OF ENGINEERING
Nov 1 9 44 AM '93

We have reviewed the above-described EA, reference number 93-11-0143. We have no objections or comments at this time. Thank you for the opportunity to comment.

Donald A. Clegg
DONALD A. CLEGG
Director of Land Utilization

DAC:ak
kstream.djt

JOHN WAMPLI
GOVERNOR OF HAWAII



ALTHEA ANN JAMESON
BOARD OF LAND AND NATURAL RESOURCES

RECEIVED
DEPT. OF PUBLIC WORKS

DEPT. OF
LAND AND NATURAL RESOURCES
JOHN F. APPELLE
GENERAL MANAGER

FEB 17

9 30 AM '94

STATE OF HAWAII
DEPARTMENT OF LAND AND NATURAL RESOURCES

REF: OCEA:KCK

P O BOX 621
HONOLULU, HAWAII 96805

AGRICULTURE DEVELOPMENT PROGRAM
AQUATIC RESOURCES
BOATING AND OCEAN RECREATION
CONSERVATION AND ENVIRONMENTAL AFFAIRS
CONSERVATION AND RESOURCES ENFORCEMENT
CONVICTIONS
FORESTRY AND WILDLIFE
HISTORIC PRESERVATION
LAND MANAGEMENT
STATE PARKS
WATER AND LAND DEVELOPMENT

FEB 15 1994

File No.: 94-449
DOC. NO.: 4149

eng

The Honorable Kenneth E. Sprague
Acting Director and Chief Engineer
Department of Public Works
City and County of Honolulu
650 South King Street
Honolulu, Hawaii 96813

RECEIVED
DIV. OF PUBLIC WORKS
FEB 17 1 58 PM '94

Dear Mr. Sprague:

Subject: Environmental Assessment (EA) for Kapunahala Stream Repairs at Hulinuu Place, Kaneohe, Oahu, TMK: 4-5-26: 2

Thank you for the additional time to review the information on the subject project received by our office on January 18, 1994. The following are our comments on the proposed stream repairs:

Division of Aquatic Resources

The Division of Aquatic Resources (DAR) comments that it seems peculiar that this section of stream would have been left unlined given the existing upstream and downstream concrete channelization. However, the lack of such action may have been fortuitous for the migratory native gobies and shrimp. The upper reach of the Kapunahala tributary of Kaneohe Stream is the only area in the extensively channelized stream system where native gobies have been reported in recent years.

Concrete channels are a serious impediment to the successful immigration of the post larvae of these species from the sea for reasons ranging from micro-habitat flow changes to elevated temperatures. It is conceivable that this unaltered section could have been providing a temporary refugium that allowed at least one species each of a native goby and a native shrimp to successfully immigrate to the unaltered upper reach. The Oahu populations of both of these species have declined markedly during this century, based on oral reports, and are much smaller than that of the neighbor islands.

The upper reach of Kapunahala Stream is probably not capable of sustaining a reproductively viable population of native gobies at the present time given the extensive downstream channelization. Nevertheless, DAR recommends that consideration be given to restricting the proposed alterations to the stabilization of stream banks, with the retention of the natural stream bed (if this can be accomplished without compromising the structural integrity of the downstream channel). This would be compatible with any future Kaneohe Stream restoration proposals (DAR is aware of one that has been discussed by another agency), which would have to focus on redesign of the bottom of the lined reaches.

Historic Preservation Division

The Historic Preservation Division (HPD) comments that a review of their records shows that there are no known historic sites at this parcel although part of the Luluku Discontinuous Archaeological District (State Site 50-80-10-2914) is located over 1000 feet east of this area. The project proposes to fill and concrete line approximately 65 feet of an unimproved segment of the Kapunahala Stream bank in an area that is developed for residential use and is unlikely to have historic sites remaining on the surface. Because the area is developed and the project will entail filling the stream bank, HPD believes that this project will have "no effect" on historic sites.

It is possible that historic sites, including human burials, will be uncovered during routine construction activities. Should this be the case, all work in the vicinity must stop and the HPD must be contacted at 587-0047.

Commission on Water Resource Management

The Commission on Water Resource Management's (CWRM) staff comments that an application for a Stream Channel Alteration Permit (SCAP) OA-143 is currently being processed for the subject project.

We have no other comments to offer at this time. Thank you for the opportunity to comment on this matter.

Please feel free to call Steve Tagawa at our Office of Conservation and Environmental Affairs, at 587-0377, should you have any questions.

Very truly yours,

KEITH W. AHUE

DEPARTMENT OF PUBLIC WORKS
CITY AND COUNTY OF HONOLULU

850 SOUTH KING STREET
HONOLULU HAWAII 96813



FRANK F. FASI
MAYOR

Kenneth E. Sprague
Acting

In Reply Refer to:

94-11-0027

February 22, 1994

Mr. Keith W. Ahue, Director
Department of Land and Natural Resources
State of Hawaii
P. O. Box 621
Honolulu, Hawaii 96809

Dear Mr. Ahue:

Subject: Your Comments on the Environmental Assessment for Kapunahala Stream
Repairs at Hulinuu Place, Kaneohe, Oahu, TMK: 4-5-26: 002, 075

We appreciate your comments on the proposed project. Our responses to the issues raised are as follows:

Division of Aquatic Resources

The section of stream in question was originally left unlined as a result of the design method in use at the time of construction. If today's design standards were used, the section would be lined.

We understand the concerns you have for keeping this section of stream invert unlined.

The invert at the proposed project site has already experienced considerable erosion. Past experience indicates that this situation leaves the concrete lining downstream vulnerable to undermining and considerable damage.

Since keeping the invert unlined would endanger the structural integrity of the channel lining downstream of the site, we propose to line both the invert and banks of the stream.

Historic Preservation Division

We concur that there is a possibility that historic sites, including human burials, will be uncovered during routine construction activities.

The project specifications will require the contractor to stop work and contact the State of Hawaii Historic Sites Preservation Officer at 587-0047 in the event that such items are uncovered.

Please contact Jolie Yee of our Division of Engineering at 523-4041 with any further questions or comments you may have.

Very truly yours,

A handwritten signature in black ink, appearing to read "K. E. Sprague", is written over the typed name.

KENNETH E. SPRAGUE
Acting Director and Chief Engineer

DOCUMENT CAPTURED AS RECEIVED

JOHN WAINEE
GOVERNOR OF HAWAII

RECEIVED
DIV. OF ENGINEERING
Nov 4 8 27 AM '93



STATE OF HAWAII
DEPARTMENT OF HEALTH
P. O. BOX 3378
HONOLULU, HAWAII 96801

RECEIVED
DEPT. OF PUBLIC WORKS
JOHN C. LEWIN, M.D.
DIRECTOR OF HEALTH

Nov 3 2 24 AM '93

93-3687
env. ah
Eng

In reply, please refer to:

November 1, 1993

93-291/epo

Mr. C. Michael Street
Director & Chief Engineer
Department of Public Works
City & County of Honolulu
650 South King Street
Honolulu, Hawaii 96813

Dear Mr. Street:

Subject: Environmental Assessment for
the Kapunahala Stream Repairs at Hulinuu Place
Kaneohe, Oahu
TMK: 4-5-26: 002

Thank you for allowing us to review and comment on the subject project.
We do not have any comments to offer at this time.

Very truly yours,

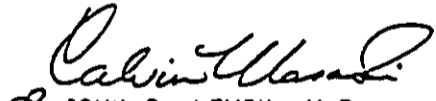
JOHN C. LEWIN, M.D.
Director of Health



United States Department of the Interior

FISH AND WILDLIFE SERVICE
Pacific Islands Office
P.O. Box 50167
Honolulu, Hawaii 96850



In Reply Refer To: AAP

C. Michael Street
Department of Public Works
City and County of Honolulu
650 South King Street
Honolulu, Hawaii 96813

RECEIVED
DEPT. OF PUBLIC WORKS
DEC 14 1 42 PM '93

*Engn
93-4066*

DEC 02 1993

Re: Environmental Assessment for Kapunahala Stream Repairs at Hulinuu Place, Kaneohe, Oahu, Hawaii Tax Map Key (TMK): 4-5-26:002

Dear Mr. Street:

The U.S. Fish and Wildlife Service (Service) has reviewed the Environmental Assessment (EA) for the Kapunahala Stream Repairs at Hulinuu Place, Kaneohe, Oahu, Hawaii. The project proposes to repair a washed-out portion of the Kapunahala Stream with a concrete channel lining. In addition, the stream embankment and invert will be filled and the chain link fence at the rear of parcel TMK 45-603 Hulinuu Place will be replaced. All work will occur within a drainage easement favorable to the City and County of Honolulu, the project applicant. The Service offers the following comments for your consideration.

No rare, threatened or endangered species occur in the project area, and the affected site lacks wetlands and other sensitive habitats. Construction activity in the stream will be restricted to the summer months when low water levels limit usage of the stream by fish and wildlife resources. Erosion control measures will be implemented to prevent sediment, debris, and other pollutants from entering stream waters.

Based on the above information, the Service has no significant concerns relating to the proposed action. Thank you for the opportunity to comment. Should you have any questions or need additional assistance, please contact staff biologist, Arlene Pangelinan (808/541-3441).

Sincerely,

Karen A. Evans
Acting Field Supervisor

RECEIVED
DIV. OF ENGINEERING
DEC 15 10 35 AM '93



DEPARTMENT OF THE ARMY
U. S. ARMY ENGINEER DISTRICT, HONOLULU
BUILDING 230
FT. SHAFTER, HAWAII 96858-5440

RECEIVED
DEPT. OF PUBLIC WORKS

October 27, 1993

Oct 29 3 55 AM '93

REPLY TO
ATTENTION OF:

Planning Division

93-3640
DIR/DEPS
ENV
ENGINEER

RECEIVED
DIV. OF ENGINEERING
NOV 1 2 16 PM '93

Mr. C. Michael Street
Director and Chief Engineer
Department of Public Works
City and County of Honolulu
650 South King Street
Honolulu, Hawaii 96813

Dear Mr. Street:

Thank you for the opportunity to review and comment on the Environmental Assessment for the Kapunahala Stream Repairs, Oahu (TMK 4-5-26: 2). The following comments are provided pursuant to Corps of Engineers authorities to disseminate flood hazard information under the Flood Control Act of 1960 and to issue Department of the Army (DA) permits under the Clean Water Act; the Rivers and Harbors Act of 1899; and the Marine Protection, Research and Sanctuaries Act.

a. The proposed work will require a DA permit as stated on page 2 of the Environmental Assessment. Please contact our Operations Division at 438-8554 for further information.

b. According to the enclosed Federal Emergency Management Agency's Flood Insurance Rate Map, panel number 150001-0090C dated September 28, 1990, the project site is located in Zone X (unshaded; areas determined to be outside of the 500-year flood plain).

Sincerely,

Thomas Ushijima, P.E.
Acting Director of Engineering

Enclosure

PO54-007

CORRECTION

THE PRECEDING DOCUMENT(S) HAS
BEEN REPHOTOGRAPHED TO ASSURE
LEGIBILITY
SEE FRAME(S)
IMMEDIATELY FOLLOWING

DOCUMENT CAPTURED AS RECEIVED



DEPARTMENT OF THE ARMY
U. S. ARMY ENGINEER DISTRICT, HONOLULU
BUILDING 230
FT. SHAFTER, HAWAII 96858-5440

RECEIVED
DEPT. OF PUBLIC WORKS

October 27, 1993

OCT 29 3 55 AM '93

REPLY TO
ATTENTION OF:

Planning Division

93-3640
DIR/DEPS
ENV/ENR
ENGR

RECEIVED
DIV. OF ENGINEERING
NOV 1 2 16 PM '93

Mr. C. Michael Street
Director and Chief Engineer
Department of Public Works
City and County of Honolulu
650 South King Street
Honolulu, Hawaii 96813

Dear Mr. Street:

Thank you for the opportunity to review and comment on the Environmental Assessment for the Kapunahala Stream Repairs, Oahu (TMK 4-5-26: 2). The following comments are provided pursuant to Corps of Engineers authorities to disseminate flood hazard information under the Flood Control Act of 1960 and to issue Department of the Army (DA) permits under the Clean Water Act; the Rivers and Harbors Act of 1899; and the Marine Protection, Research and Sanctuaries Act.

a. The proposed work will require a DA permit as stated on page 2 of the Environmental Assessment. Please contact our Operations Division at 438-8554 for further information.

b. According to the enclosed Federal Emergency Management Agency's Flood Insurance Rate Map, panel number 150001-0090C dated September 28, 1990, the project site is located in Zone X (unshaded; areas determined to be outside of the 500-year flood plain).

Sincerely,

Thomas Ushijima, P.E.
Acting Director of Engineering

Enclosure

PO54-007

DOCUMENT CAPTURED AS RECEIVED

RECEIVED
DIV. OF ENGINEERING

OCT 26 11 11 AM '93

The end of your search for a Gospel preaching church.

Koolau Baptist Church

REV. THOMAS BOWLIN, PASTOR • 45-633 KENEKE STREET • KANEHOE, HAWAII 96744 • (808) 247-5442

93-3571
Rev. Div. Dept. of
10/25/93 Eng

RECEIVED
DIV. OF PUBLIC WORKS
OCT 22 2 43 PM '93

October 21, 1993

Department of Public Works
City and County of Honolulu
650 South King St.
Honolulu, HI 96813
Attn: Mr. C. Michael Street
Director and Chief Engineer

Dear Mr. Street,

Thank you for your letter of October 4, 1993, Subject: Environmental Assessment for Kapunahala Stream Repairs at Hulinui Place.

After studying the attached assessment information, the following are our inputs concerning the project.

1. Ref. Paragraph II of your assessment. The stream is indeed lined both upstream and downstream of the project site. However, erosion has occurred downstream at the bridge access to the Koolau Baptist Church property. This should also be corrected.
2. Ref. Paragraph III of your assessment. You correctly noted that the chain link fencing at the back of 45-603 Hulinui Place should be replaced. That is also true of the chain link fencing on the Koolau Baptist Church side of the stream (due to soil erosion/mass wasting).
3. Reference Paragraph III of your assessment. Approximately 75 (plus or minus) cars park on our property on Sundays. Also, we have a school (K-4 thru High School) that meets Monday thru Friday. I have three questions.
 - A. Will this affect access to our property?
 - B. Will this affect parking on our property (a large parking lot is located adjacent to the project side)?
 - C. Will there be sufficient safety around the stream to prevent entry by children?
4. Ref. Paragraph IV of your assessment. Will sufficient dust discharge controls be in place to protect the church building. The building has many louvered windows that do not seal tightly. Also our school is within 50 feet of the site as is the church.

DOCUMENT CAPTURED AS RECEIVED

5. Ref. Paragraph VI D of your assessment. This is for your information only. There may be an intermittent spring on Mr. Oshiro's property that empties into the stream at the project site. Encasing the stream bank in concrete could possibly cause flooding on the Oshiro's property. Again, this is for your information only.

Thank you for your correspondence. We will be awaiting your reply to our concerns as given in paragraphs 2-4 above.

Sincerely,

Thomas G. Bowlin
Thomas G. Bowlin
Pastor

TGB:js

93-11-0161

November 8, 1993

Reverend Thomas Bowlin, Pastor
Koolau Baptist Church
45-663 Keneke Street
Kaneohe, Hawaii 96744

Dear Reverend Bowlin:

Subject: Your Letter of October 21, 1993 Regarding the Environmental Assessment
for Kapunahala Stream Repairs at Hulinuu Place

We appreciate your comments and concerns regarding the proposed project.

1. *Soil Erosion at Bridge:* The erosion that has occurred downstream of the project site at the bridge access to the Koolau Baptist Church property appears to have resulted from the flow of surface water from the church property and is, therefore, a private matter.
2. *Replacement of Chain Link Fencing:* The chain link fencing on the Koolau Baptist Church side of the stream is not within our drainage easement. It is entirely within private property and its replacement is the responsibility of the church.
3. *Impact on Parking and Access:*
 - A, B. The work may have impact on the ease of access and parking on the property of the church since the project is best accessed through your property. Our Land Division will be contacting you in the future regarding the granting of a construction easement on the property. One lane of the bridge would be kept open.

Reverend Thomas Bowlin
November 8, 1993
Page 2

- C. The specifications for the project require the contractor to take measures to ensure safety of pedestrians. He will be informed of the presence of the school on the property and the need to protect children from falling into the stream.
- 4. *Dust Control:* As noted in the environmental assessment, the specifications for the project will contain provisions and have sufficient equipment and manpower at the job site to accomplish this.

Please contact Jolie Yee of the Division of Engineering at 523-4041 with any further questions or comments you may have.

Very truly yours,

C. MICHAEL STREET
Director and Chief Engineer

JY:HK:tt