

JOHN WAHEE  
GOVERNOR OF HAWAII



STATE OF HAWAII  
DEPARTMENT OF LAND AND NATURAL RESOURCES  
DIVISION OF LAND MANAGEMENT

P.O. BOX 621  
HONOLULU, HAWAII 96809

AUG 3 1994

RECEIVED  
94 AUG -4 16:17  
LIFE QUALITY

AQUACULTURE DEVELOPMENT  
PROGRAM  
AQUATIC RESOURCES  
CONSERVATION AND  
ENVIRONMENTAL AFFAIRS  
CONSERVATION AND  
RESOURCES ENFORCEMENT  
CONVEYANCES  
FORESTRY AND WILDLIFE  
HISTORIC PRESERVATION  
PROGRAM  
LAND MANAGEMENT  
STATE PARKS  
WATER AND LAND DEVELOPMENT

KA-92:0228

Ref.: LM-GM

Mr. Bruce Anderson, Acting Director  
Office of Environmental  
Quality Control  
220 South King Street, 4th Floor  
Honolulu, HI. 96813

Dear Mr. Anderson *Brill*

Subject: Negative Declaration for Proposed Lease of  
Non-Exclusive Easement to Install Magnesium  
Anodes, Kekaha, Kauai, Tax Map Key: 1-2-02: Por. 1

The Department of Land and Natural Resources has reviewed the comments received during the 30-day public comment period. We have determined that this project will not have a significant environmental effect, and therefore, we are issuing a negative declaration. Please publish this notice in the next available OEQC Bulletin.

We have enclosed a completed OEQC Bulletin Publication Form, four(4) copies of the final environmental assessment and the applicant's list of consulted agencies.

Please contact Gary Martin at 587-0414 if you have any questions.

Thank you for your attention to this matter.

Very truly yours,

*W. Mason Young*  
W. MASON YOUNG  
Land Management Administrator

Enclosures

cc: Kauai Land Board Member  
Kauai District Land Office

103

1994-08-23 - KA-PEA - Gasco Lease of Easement to  
Install Magnesium Anodes  
AUG 23 1994

ENVIRONMENTAL ASSESSMENT  
FOR  
EASEMENT ON GOVERNMENT LANDS  
AT KEKAHA KAUAI, HAWAII

I. Applicant

Gasco, Inc.  
515 Kamakee Street  
Honolulu, Hawaii 96814

Approving Agency

Division of Land Management  
Department of Land and  
Natural Resources

II. Project Description

Location: Kekaha Gardens Subdivision, Kekaha, Kauai, Hawaii.  
Tax Map Key 1-2-10: Lot 117

Proposed Action: We are applying for an easement for State Lands. We have no intention to make any changes or improvements on the State Lands only to preserve it in its natural state.

Remarks: Subject land is adjacent to our tank farm at Iwipolena Road. It is within a 30 foot easement in favor of Citizens Utilities Co., and adjacent to Kekaha Sugar Company's cane haul road. The exposure is 3 foot underground, within the easement, and adjacent to the cane haul road which will be restored to its original contour after installation. The Anodes are for protection of the buried gas lines servicing the Kekaha Gardens Subdivision.

III. Description of Affected Environment

Existing Use: No present use, except it is within an easement for Citizens Utilities overhead electrical transmission lines. General Lease No. S-4547.

Surrounding Land Use: The bordering property has been used for a cane haul road, The Gas Company tank farm and the Kekaha Gardens Subdivision.

Historical: Bordering property has been in long-term-sugar, and Gas Company's use. It does not appear to contain any archaeological sites.

Utilities and Service: The Citizens Utilities Company maintains overhead transmission lines within the 30 foot easement. A positive has been received from them.

**ENVIRONMENTAL ASSESSMENT  
FOR  
EASEMENT ON GOVERNMENT LANDS  
AT KEKAHA KAUAI, HAWAII  
Page 2**

**IV. Probable Impacts**

Short Term: There is no short term impact.  
Long Term: There is no long term impact.

**V. Alternatives to Proposed Action**

No alternatives has been identified.

**VI. Irreversible and Irretrievable Commitment of Resources**

There would be no irreversible or irretrievable commitment of resources as a result of granting the proposed easement.

**VII. Mitigating Circumstances**

We are not engaging in any changes to the property, therefore, there will be no mitigating circumstances.

**VIII. Findings and Determination**

Based on the foregoing statements approving our request for an easement will not have a significant affect on the environment.

**IX. Contact:**

Mr. W. Mason Young, Land Management Administrator  
Division of Land Management  
Department of Land and Natural Resources  
P.O. Box 621  
Honolulu, Hawaii 96809

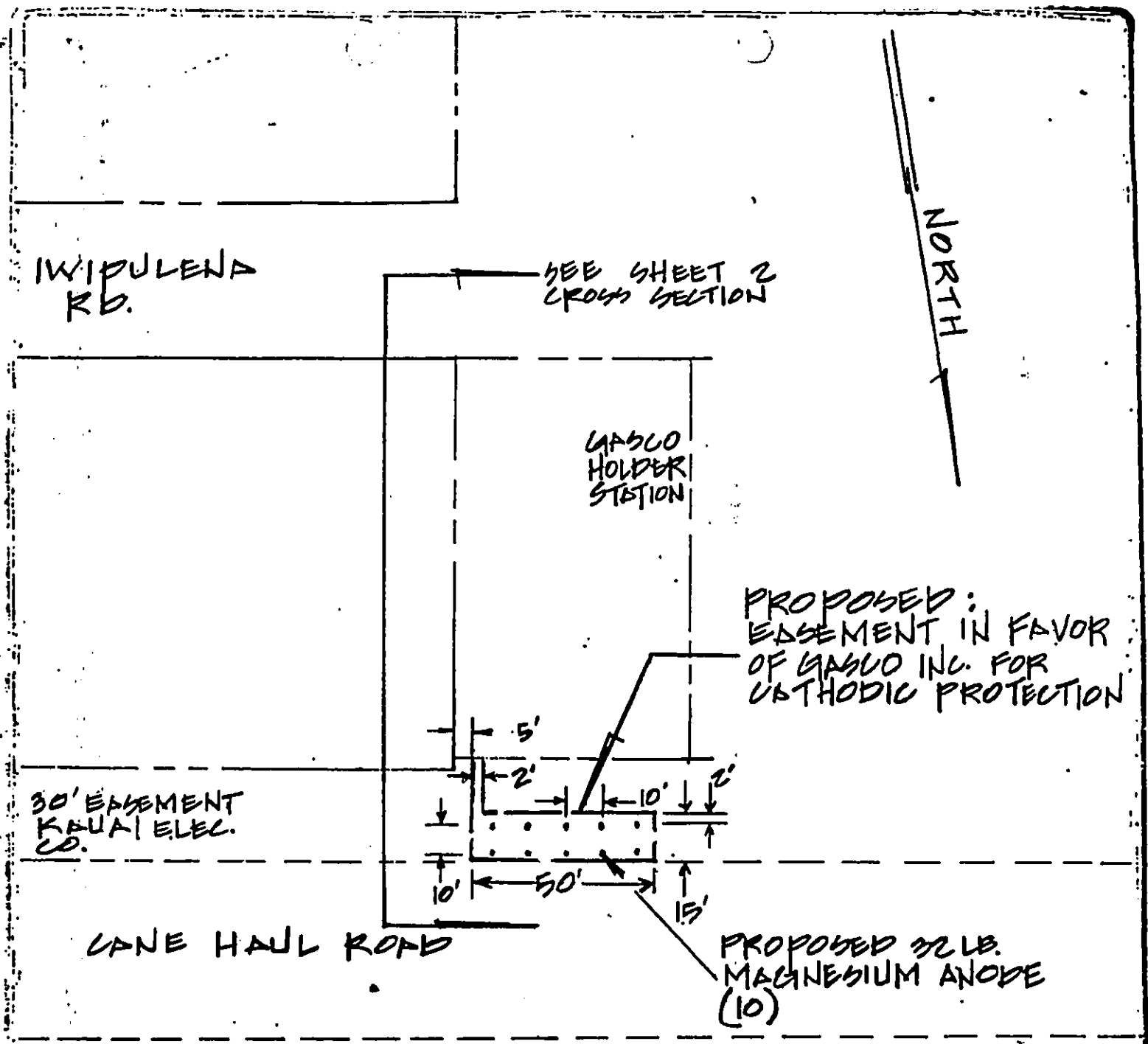

"PLAN"

**CASCO, Inc.**  
A PERI Company

**Engineering Department**

Project number

**GASCO BASEMENT FOR KEKAHA GARDENS  
SUBV. (CATHODIC PROTECTION) TMK**

prepared by  
G1

checked by

date  
12-3-91

scale  
1"=40'

sheet 1 OF 2

