

BENJAMIN J. CAYETANO
GOVERNOR



DEC 29 1994

ROBERT P. TAKUSHI
COMPTROLLER

'94 DEC 29 AM 11:33

STATE OF HAWAII
DEPARTMENT OF ACCOUNTING AND GENERAL SERVICES
P. O. BOX 119, HONOLULU, HAWAII 96810

LETTER NO. (P) 2092.4

QUALITY

DEC 28 1994

Mr. James Ikeda
Interim Director
Office of Environmental
Quality Control
Central Pacific Plaza
220 South King Street, 4th Floor
Honolulu, Hawaii 96813

Dear Mr. Ikeda:

Subject: Negative Declaration for Helemano Elementary
School - Six-Classroom Building
TMK 7-1-02:17

The Department of Accounting and General Services has reviewed the comments received during the 30-day public comment period which began on November 23, 1994. The agency has determined that this project will not have significant environmental effect and has issued a negative declaration. Please publish this notice in the January 8, 1995 OEQC Bulletin.

We have enclosed a completed OEQC Bulletin Publication Form and four copies of the final EA. If there are any questions, please have your staff call Mr. Ralph Morita of the Planning Branch at 586-0486.

Very truly yours,

A handwritten signature in cursive script, appearing to read "Gordon Matsuoka".
GORDON MATSUOKA
State Public Works Engineer

BM:jk
Attachments

174

1995-01-23-0A-FEA - Helemano Elementary School - 6 Classroom
JAN 23 1995

FINAL ENVIRONMENTAL ASSESSMENT
(NEGATIVE DECLARATION)
HELEMANO ELEMENTARY SCHOOL
SIX-CLASSROOM BUILDING
DECEMBER 27, 1994

- A. PROPOSING AGENCY: Department of Accounting and General Services for the Department of Education.
- B. APPROVING AGENCY: Not applicable.
- C. AGENCY CONSULTED: Department of Education.
- D. GENERAL DESCRIPTION OF THE TECHNICAL, SOCIO-ECONOMIC AND ENVIRONMENTAL CHARACTERISTICS:
1. Technical: This is to construct a reinforced concrete/masonry six-classroom building. The approximate size is 11,000 square feet. Also included are a connecting bridge to Building F, ground and site improvements, and any easements required by the new building.
 2. Socio-Economic:
 - a. The proposed project will not create sufficient work to substantially impact the economy and welfare of the community and State.
 - b. The estimated cost of the project is \$2,831,000.
 - c. Since the project will be constructed within the existing school campus, no land will be removed from the tax base.
 - d. The project will provide the school with a much-needed facility to implement its program in accordance with the Educational Specifications.
 3. Environmental:
 - a. The project will not create any major long-term environmental impacts.
 - b. However, during construction, the air quality may be affected by dust and exhaust emissions and it is anticipated there will be a temporary increase in noise levels.
 - c. These impacts are expected to be minimal since State and Federal regulations need to be met.

E. SUMMARY DESCRIPTION OF THE AFFECTED ENVIRONMENT, INCLUDING SITE MAPS:

1. The site of the proposed project is located on the school campus (TMK 7-1-02:17).
2. No habitat of endangered species, flora or fauna are known to exist at the site.
3. No historical, archaeological or cultural sites are known to exist at the site.
4. The site is not in a Special Management Area.
5. The school location and project site are as shown in Figures 1 and 2, respectively..

F. IDENTIFICATION AND SUMMARY OF MAJOR IMPACTS AND ALTERNATIVES CONSIDERED:

1. Major Impacts: The proposed project will not:
 - a. Involve an irrevocable commitment to loss or destruction of any natural or cultural resources.
 - b. Curtail the range of beneficial uses of the environment.
 - c. Conflict with the State's long term environmental policies.
 - d. Substantially affect the economic or social welfare of the community or State.
 - e. Involve substantial secondary impacts, such as population changes or effects on public facilities.
 - f. Involve a substantial degradation of environmental quality.
 - g. Detrimentially affect air or water quality or ambient noise levels.

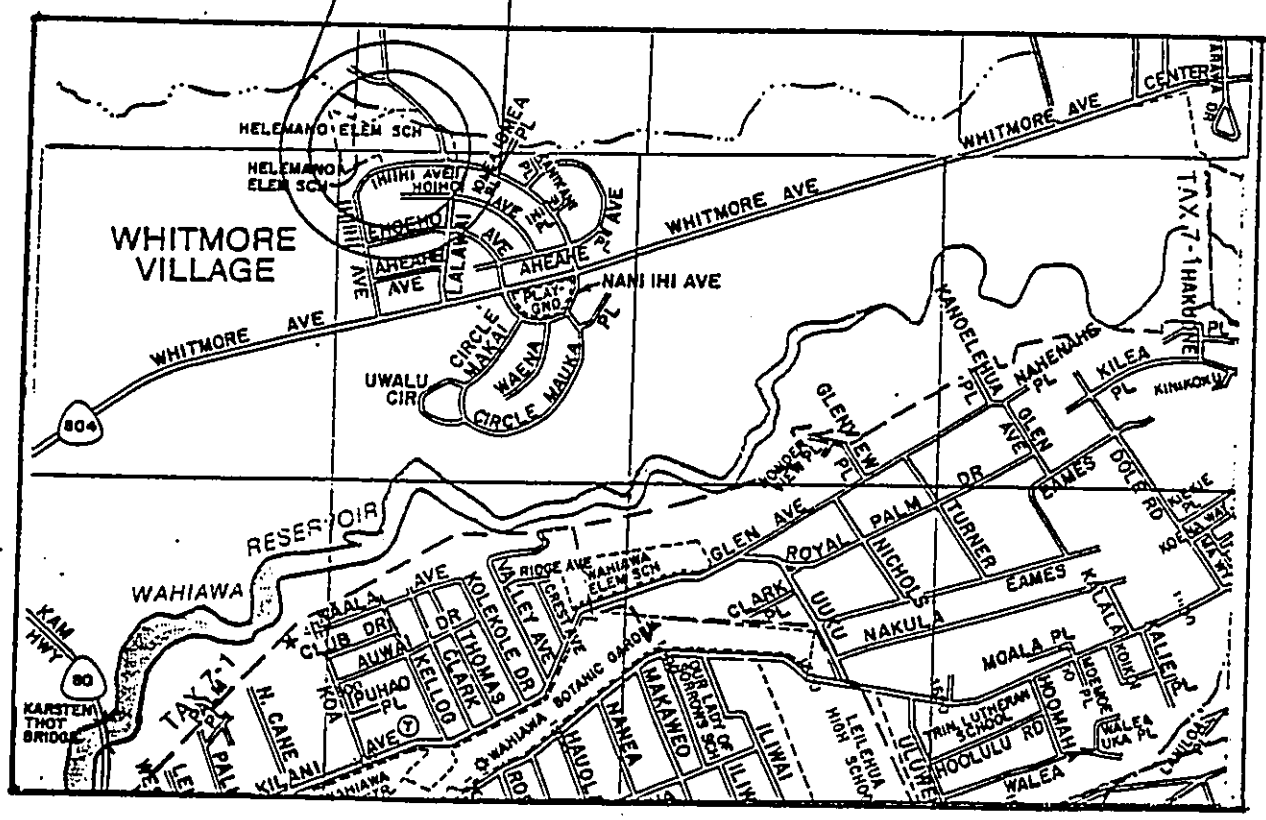
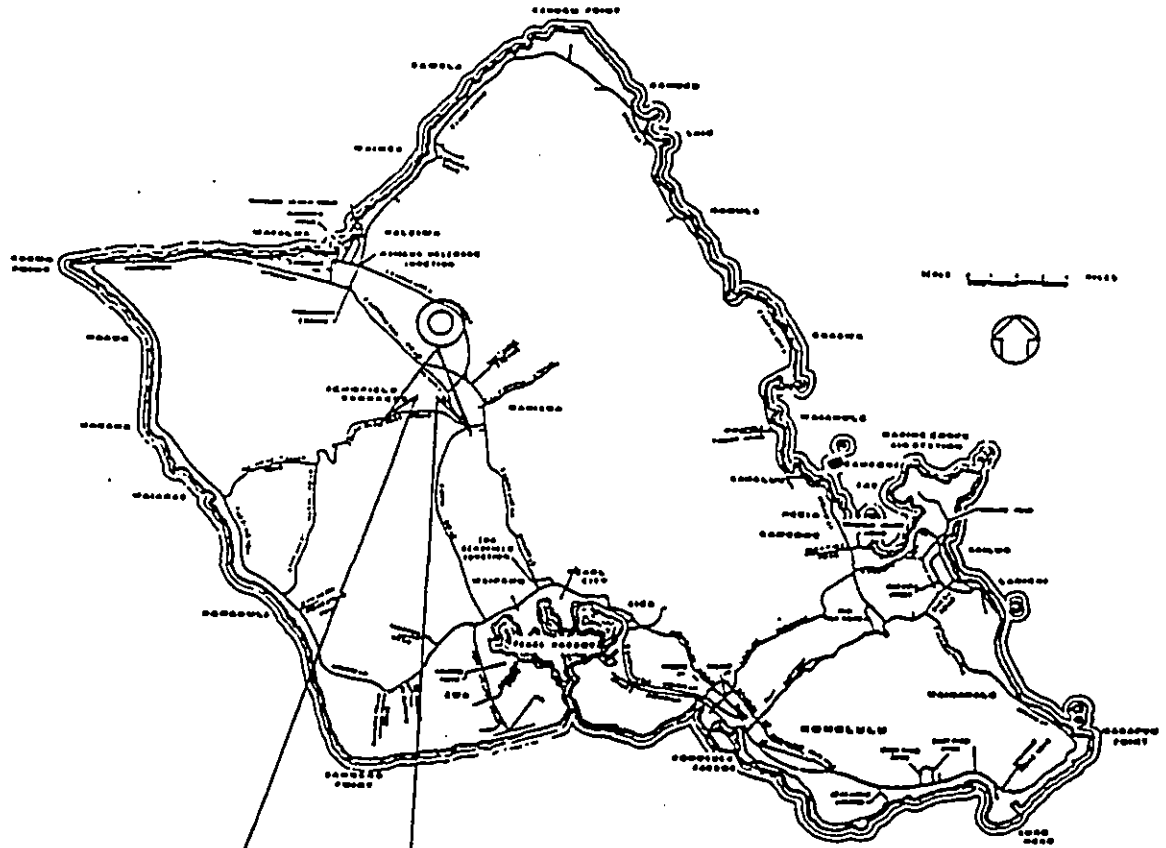

LOCATION MAP

FIGURE 1

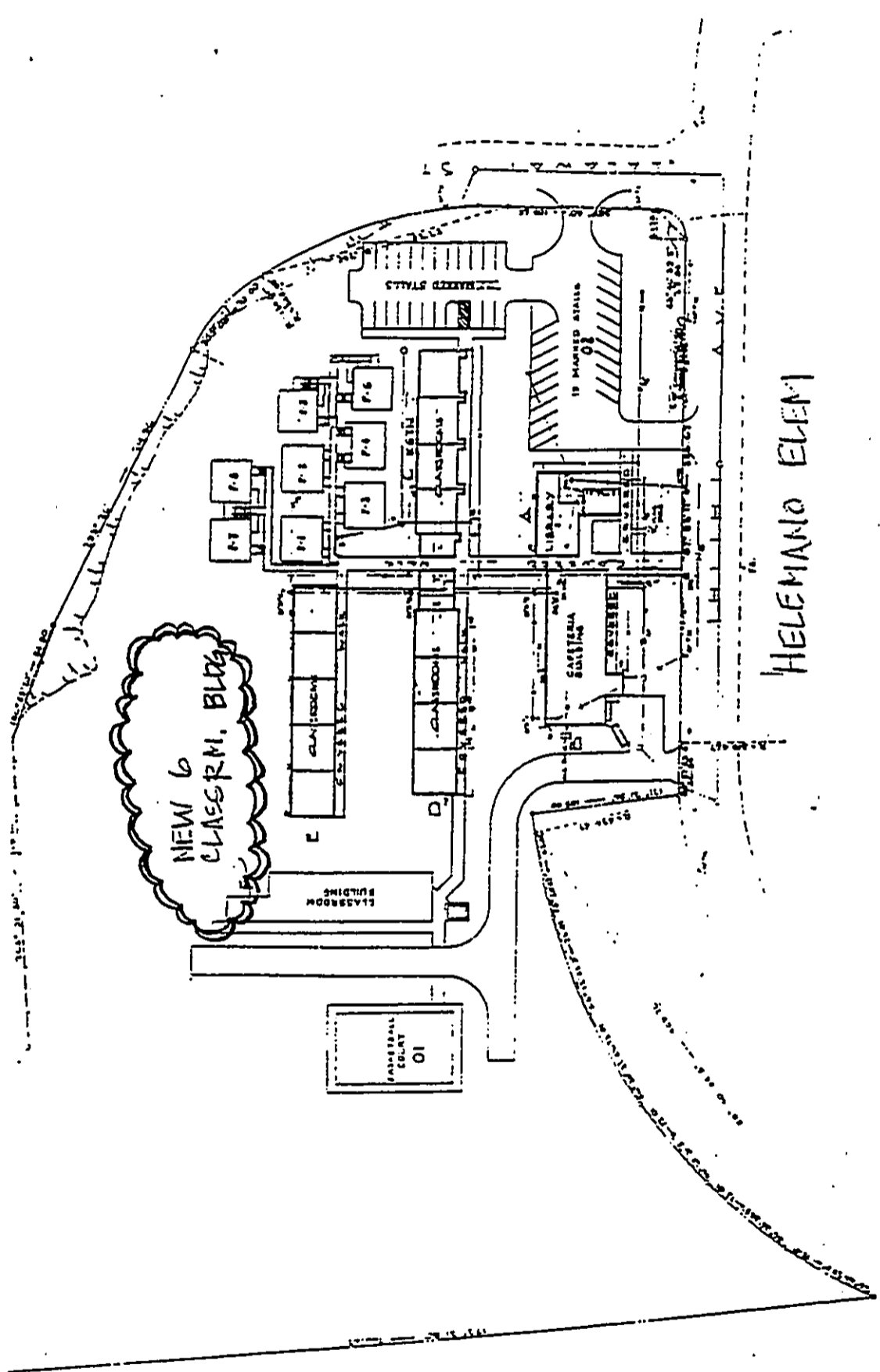

HELEMANO ELEM.

0 10 20 30 40
SCALE IN FEET

FIGURE 2