

BENJAMIN J. CAYETANO
GOVERNOR



SAM CALLEJO
COMPTROLLER

RECEIVED MARY PATRICIA WATERHOUSE
DEPUTY COMPTROLLER

STATE OF HAWAII
DEPARTMENT OF ACCOUNTING AND GENERAL SERVICES
P. O. BOX 119, HONOLULU, HAWAII 96810

96 JUL 25 10:37 (P) 1446.6

OFFICE OF ENVIRONMENTAL
QUALITY CONTROL

JUL 23 1996

Mr. Gary Gill
Director
Office of Environmental
Quality Control
Central Pacific Plaza
220 South King Street, 4th Floor
Honolulu, Hawaii 96813

Dear Mr. Gill:

Subject: Final EA for Keonepoko Elementary School
(Finding of No Significant Impact)
New Cafetorium
TMK 3rd Division 1-5-09:por. 9

The Department of Accounting and General Services has reviewed the comments received during the 30-day public comment period which began on January 23, 1995. The agency has determined that this project will not have significant environmental effect and has issued a Finding of No Significant Impact (FONSI). Please publish this notice in the August 8, 1996 OEQC bulletin.

We have enclosed a completed OEQC Bulletin Publication Form and four copies of the Final EA/FONSI. If there are any questions, please have your staff contact Mr. Brian Isa of the Planning Branch at 586-0484.

Very truly yours,

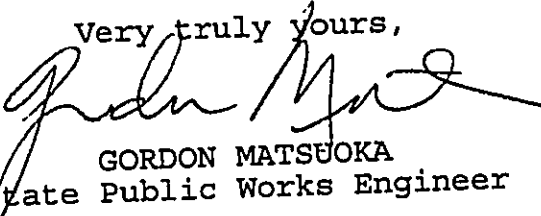
GORDON MATSUOKA
State Public Works Engineer

BI:jk
Attachments

90

1996-08-08-HI-FEA-Keonepoko Elementary School New Cafetorium AUG - 8 1996
FILE COPY

FINAL ENVIRONMENTAL ASSESSMENT
(FINDING OF NO SIGNIFICANT IMPACT)
KEONEPOKO ELEMENTARY SCHOOL
NEW CAFETORIUM
JULY 17, 1996

- A. PROPOSING AGENCY: Department of Accounting and General Services for the Department of Education (DOE).
- B. APPROVING AGENCY: Not applicable.
- C. AGENCY CONSULTED: DOE.
- D. GENERAL DESCRIPTION OF THE TECHNICAL, SOCIO-ECONOMIC AND ENVIRONMENTAL CHARACTERISTICS:
1. Technical: This project is to construct a cafetorium (dining room and kitchen) building of approximately 7,426 square feet on the Keonepoko Elementary School campus. This project also includes the renovation of the temporary dining room into classrooms, related site improvements (such as covered walkways, landscaping, additional parking and connections to public utilities) and easements that may be required as a result of this project.
 2. Socio-Economic:
 - a. The proposed project will not create sufficient work to substantially impact the island economy. The project would provide work for the local contractors and would create some beneficial impact to the welfare of the general community.
 - b. The estimated construction cost of the project is \$2,395,000. The completion of this project is dependent on the receipt of construction funding from the State Legislature.
 - c. Since the project will be constructed within the existing school campus, no land will be removed from the tax base.
 - d. The project will provide the school with a much-needed kitchen and dining facility to implement its program in accordance with the Educational Specifications. Currently, the school is using classrooms for a temporary dining space that does not meet the DOE's Educational Specifications and the school is experiencing a need for additional classrooms to meet the growth in student enrollment. The completion of the project would

provide a new kitchen and dining facility and much needed additional classroom space.

3. Environmental:

- a. The project will not create any major long-term environmental impacts. Upon completion, the surrounding construction area will be either grassed or paved.
- b. During construction, there will be a slight increase in on-site traffic that shall be mitigated by strategic placement of temporary fencing and construction entrance/exit area.
- c. During construction, the air quality may be affected by dust and exhaust emissions and it is anticipated there will be a temporary increase in noise levels. These impacts are expected to be minimal since State and Federal regulations need to be met.
- d. Water runoff from the construction area will meet the requirements of the Department of Health.

E. SUMMARY DESCRIPTION OF THE AFFECTED ENVIRONMENT, INCLUDING SITE MAPS:

1. The site of the proposed project is located on the school campus (TMK 1-5-09:por. 9). The school has been in existence since 1991. The school site is bounded by family housing, an agricultural park and Kahakai Boulevard.
2. The project will be located on the existing school campus and the campus is not known as a habitat for endangered species or endangered flora or fauna.
3. The project will be located on the school campus and there is no historical, archaeological or cultural sites known to exist at the site. If historical and/or archaeological sites are discovered during construction, they will be reported to the Department of Land and Natural Resources, State Historic Preservation Division for guidance.

4. The site is not in a Special Management Area.
5. The location of the school site and the proposed project are as shown in Figures 1 and 2, respectively.

F. IDENTIFICATION AND SUMMARY OF MAJOR IMPACTS AND ALTERNATIVES CONSIDERED:

1. Major Impacts: The proposed project will not:
 - a. Involve an irrevocable commitment to loss or destruction of any natural or cultural resources.
 - b. Curtail the range of beneficial uses of the environment.
 - c. Conflict with the State's long-term environmental policies.
 - d. Substantially affect (positively or negatively) the economic or social welfare of the community or State.
 - e. Involve substantial secondary impacts, such as population changes or effects on public facilities.
 - f. Impact the public right-of-way (public access or right-of-way) due to the construction of this project.
 - g. Involve a substantial degradation of environmental quality.
 - h. Detrimentally affect air or water quality or ambient noise levels.
 - i. Be located in any environmentally sensitive area, such as a flood plain, tsunami zone, erosion-prone area, geologically hazardous land, estuary, fresh water, or coastal waters.
2. Alternatives to the Proposed Project:
 - a. Continue using the temporary dining facility. This alternative would not help solve the rising

student enrollment problem and the DOE's Educational Specifications will not be met. Therefore, this alternative was not considered further.

- b. Renovate existing classroom space into a dining and kitchen facility. The DOE's Educational Specifications will be met and this alternative would create a much worse student overcrowding problem. Therefore, this alternative was not considered further.

G. PROPOSED MITIGATION MEASURES:

1. Short-term impacts on air and noise quality and drainage during construction will be controlled by the application of appropriate pollution and noise control measures.
2. Short-term impact on dust nuisances during construction will be controlled by the application of water spray, limiting earth movement during high wind days or some other appropriate measure.

H. DETERMINATION: On the basis of the above assessment, it is concluded that the proposed project will not have a significant adverse impact on the environment.

I. The concern of impact on the environmental, social, cultural, historical and archaeological characteristics from this project brought up by the University of Hawaii, Environmental Center is commendable. However, based on our findings, it has been concluded that this project will not have significant permanent adverse impact on the environment (the project is located on a developed school site currently used for educational purposes), social or economic welfare of the community or State (the project will create some additional construction jobs), public facilities (the existing dining facility will continue to be used during the construction and would be used by the public during normal school hours), and public right-of-way (public access or right-of-way due to the construction of this project). During construction, historical and/or archaeological sites discovered will be reported to the Department of Land and Natural Resources, State Historic Preservation Division for guidance. It is also noted that background information for the Geographic Information

Final Environmental Assessment
(Finding of No Significant Impact)
Keonepoko Elementary School
New Cafetorium

Page 5

System database (mainly from the City and County of Honolulu) is not currently available for this submittal but will be incorporated on other submittals to OEQC when the information is readily available to DAGS.

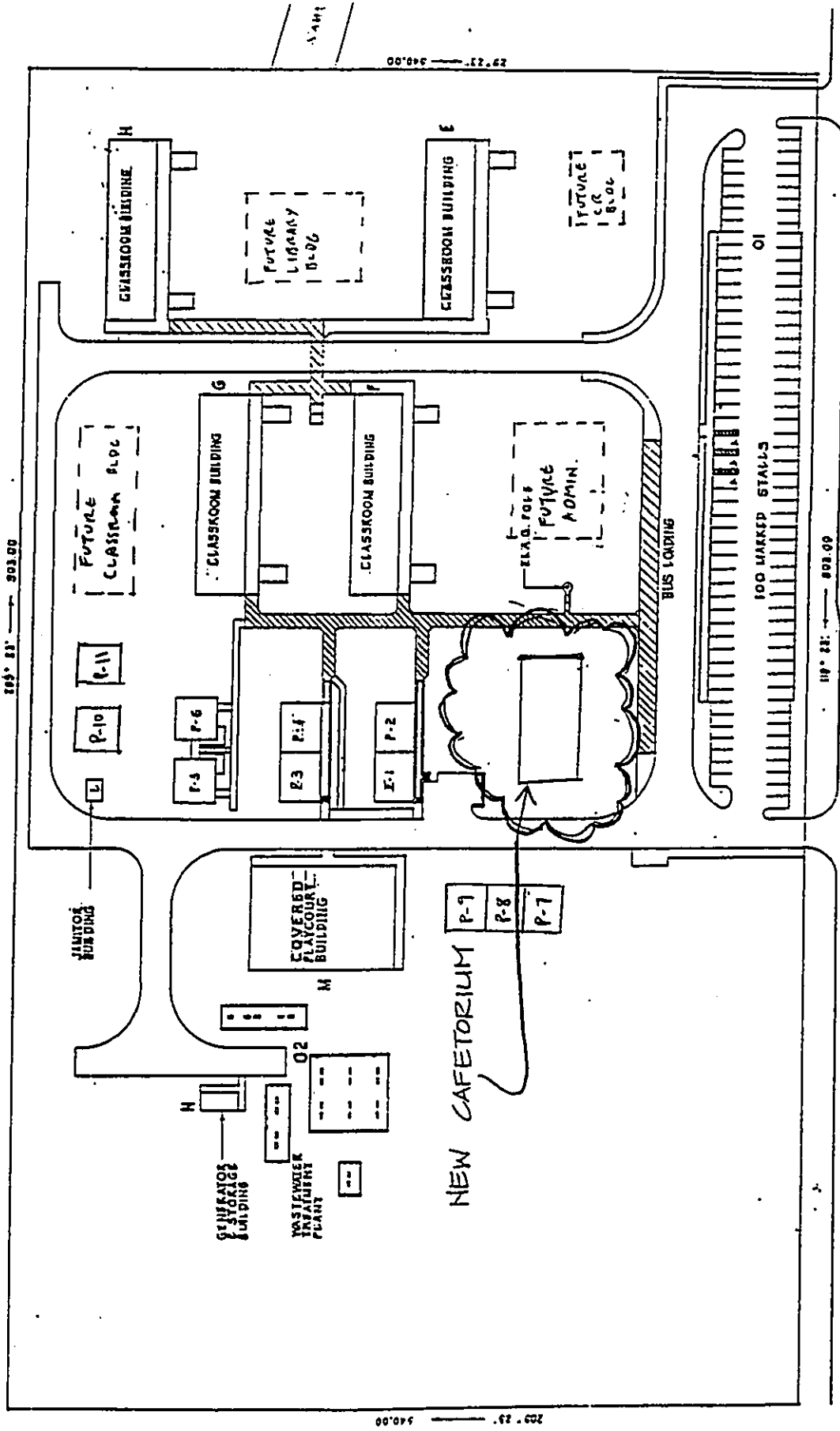

K A H A K A I B O U L E V A R D .

KEONEPOKO ELEMENTARY SCHOOL
FIGURE 2

AREA OF SCHOOL 11151 AC