

BENJAMIN J. CAYETANO
GOVERNOR



STATE OF HAWAII
DEPARTMENT OF DEFENSE
OFFICE OF THE ADJUTANT GENERAL
3849 DIAMOND HEAD ROAD, HONOLULU, HAWAII 96816-4495

Recd 4/28/97

EDWARD V. RICHARDSON
MAJOR GENERAL
ADJUTANT GENERAL

MICHAEL E. RAWLINS
COLONEL
DEPUTY ADJUTANT GENERAL

April 25, 1997

Mr. Gary Gill, Director
Office of Environmental Quality Control
220 South King Street
Honolulu, HI 96813

Dear Mr. Gill:

Re: Notice of Determination: Negative Declaration
Kauai Veterans Cemetery, Phase II, Hanapepe, Hawaii
TMK: 1-8-08: por 20

The State Department of Defense (DOD) is the proposing and accepting agency for the above referenced project. The DOD reviewed and responded to comments related to the expansion of the Kauai Veterans Cemetery. The 30-day review period began October 8, 1996 and ended November 7, 1996. The Department determined that the implementation of this project will not have any significant environmental effects as defined by HAR 11-200-12. Therefore, the agency is issuing a negative declaration. Please publish this notice in the May 8, 1997 Environmental Notice. We have enclosed a completed OEQC Bulletin Publication Form and four copies of the final EA.

Identification of the Proposing Agency
The Hawaii State Department of Defense

Identification of the Accepting Agency
The Hawaii State Department of Defense

Brief Description of Proposed Action

There is insufficient burial acreage available on the island of Kauai to meet projected needs. The DOD wishes to acquire property to expand the burial capacity of their existing Kauai Veterans Cemetery. This property totals 6.0 acres and is adjacent to that cemetery. The project consists of land acquisition of the adjacent properties and facilities improvement on the existing property. These improvements include: construction of an 800 square foot maintenance storage building; perimeter fencing; roadways and a parking lot; and addition to the committal chapel to provide supporting facilities. Committal chapel modification adds a robing room, general storage and a housekeeping closet. Upon completion of the proposed development, the expanded cemetery will provide approximately 8,000 total grave sites.

 **NATIONAL GUARD**

Americans At Their Best.

56

Mr. Gary Gill
Page 2

**Determination
Negative Declaration**

Reasons Supporting Determination

This determination is based on the significance criteria listed in HAR 11-200-12 of the Environmental Impact Statement Rules. Specifically, these significance criteria are addressed in Section 10.0 DETERMINATION of the EA.

Contact Persons for Further Information

Proposing Agency: Mr. Joseph A. Ah New, Jr.
State of Hawaii
Department of Defense
Office of the Adjutant General
3949 Diamond Head Road
Honolulu, Hawaii 96816-4495
(808) 733-4250

Consultant: Mr. Bruce D. Wade
M&E Pacific, Inc.
1001 Bishop Street
Suite 500, Pauahi Tower
Honolulu, HI 96813
(808) 521-3051

Sincerely,

Joseph A. Ah New, Jr.
Contracting and Engineering Officer

Enc. (2)

1997-05-08-KA-FFA-Kauai Veterans
Cemetery Phase II

**FINAL
FILE COPY**

MAY 8 1997

**FINAL
ENVIRONMENTAL ASSESSMENT**

**Kauai Veterans Cemetery
Phase II
TMK: 1-8-08: por. 20**

Prepared for

**State of Hawaii
Department of Defense
Office of Veterans Services**

May 1997

Prepared by

**M&E Pacific, Inc.
1001 Bishop Street, Suite 500
Pauahi Tower
Honolulu, Hawaii**

TABLE OF CONTENTS

1.0 APPLICANT	1
2.0 APPROVING AGENCY	1
3.0 CONSULTATION LIST	1
4.0 PROJECT OBJECTIVE AND NEED	2
5.0 PROJECT DESCRIPTION	3
6.0 SUMMARY OF AFFECTED ENVIRONMENT.....	5
6.1 LOCATION AND ACCESS	5
6.2 LAND USE.....	5
6.3 TOPOGRAPHY AND CLIMATE.....	5
6.4 GEOLOGY AND SOILS.....	6
6.5 ARCHAEOLOGICAL RESOURCES	6
6.6 BIOLOGICAL RESOURCES.....	6
6.7 INFRASTRUCTURE.....	7
7.0 PROBABLE IMPACTS AND MITIGATION MEASURES	8
7.1 ZONING AND LAND USE	8
7.2 GRADING AND DRAINAGE	8
7.3 NOISE AND TRAFFIC IMPACTS.....	9
7.4 WATER RESOURCES	9
8.0 ALTERNATIVES TO THE PROPOSED ACTION.....	10
8.1 NO PROJECT.....	10
8.1 ALTERNATE SITE	10
9.0 LIST OF PERMITS	11
10.0 DETERMINATION	12
11.0 REFERENCES.....	14

APPENDICES

- Appendix A: Archaeological Resources
- Appendix B: Biological Resources
- Appendix C: Draft EA Public Comments and Responses

LIST OF FIGURES

- Figure 1: Regional Location Map
- Figure 2: Tax Map Key Location Map
- Figure 3: Site Plan
- Figure 4: Flood Insurance Rate Map
- Figure 5: Grading and Drainage

1.0 APPLICANT

The applicant for the proposed Kauai Veterans Cemetery -- Phase II project is the State of Hawaii Department of Defense. This Environmental Assessment (EA) was prepared in accordance with Section 343, Hawaii Revised Statutes (HRS) and Chapter 200 of Title 11, Hawaii Administrative Rules (HAR). This Environmental Assessment is required due to the use of State land and funds.

2.0 APPROVING AGENCY

The approving agency for a determination of significance for this Environmental Assessment is the State of Hawaii Department of Defense.

3.0 CONSULTATION LIST

United States Government:

- Veterans Administration, Department of Veterans Affairs

State of Hawaii:

- Department of Business, Economic Development and Tourism:
Land Use Commission
- Department of Defense, Office of Veterans Services
- Department of Health, Clean Water Branch
- Department of Land and Natural Resources:
Office of Conservation and Environmental Affairs
Historic Preservation Division
Forestry and Wildlife Division
- Office of Environmental Quality Control
- Office of Hawaiian Affairs

County of Kauai:

- Department of Public Works
- Planning Department

4.0 PROJECT OBJECTIVE AND NEED

The Kauai Veterans Cemetery project results from the master plan developed by the State Department of Defense, Office of Veterans Services to establish, expand, and improve veteran cemeteries throughout the State.

The Kauai Veterans Cemetery was built in 1950 and provides interment services to veterans and family members on the island of Kauai. The census of 1990 indicated that 119,256 veterans live in Hawaii with approximately 4,906 on Kauai. The cemetery needs additional burial acreage to meet future requirements. The existing facilities require upgrades to meet the Department of Veterans Affairs (VA), Occupational Health and Safety Administration (OSHA), and Americans with Disabilities Act (ADA) standards.

5.0 PROJECT DESCRIPTION

The project consists of the development of land to include burial sites, support facilities, ceremonial/memorial facilities, access road and parking lot. Upon completion of the proposed development, the expanded cemetery will provide approximately 8,000 total grave sites and should provide sufficient interment capacity for at least 20 years. Construction of all facilities shall be to current Veterans Affairs, Occupational Safety and Health Administration, and accessibility requirements.

Due to the shortage of available funds, the proposed upgrades were planned for implementation in two phases. Phase I included upgrade of existing facilities and site development within the existing boundaries. Construction of Phase I was completed in 1995. Phase II of the project involves acquisition and development of land; construction of an 800 square foot maintenance storage building, perimeter fencing, roadways and parking lot; and a 210 square feet expansion of the existing committal service chapel to provide supporting facilities. Committal chapel modification adds a robing room, general storage and a housekeeping closet. Infrastructure improvements are discussed in Section 6.7. This Environmental Assessment addresses the impacts of Phase II.

Although Hawaii statutes prohibit segmentation of project disclosures, an EA was not prepared for Phase I upgrades. Phase I project scope involved only maintenance of existing facilities, minor alterations in the condition of the land and construction of minor structures accessory to the existing facilities. Facility maintenance encompassed toilet facility renovation, electrical service and telephone distribution system renovation and painting of the existing structures. Land alteration involved grading on the existing property to provide additional burial space, construction of a new parking lot with provisions for handicapped parking and extension of the irrigation system. An accessory columbarium wall was constructed as an accessory building to the existing facility. Therefore Phase I improvements to the cemetery are exempt classes of action not requiring the preparation of an environmental assessment under Hawaii's Department of Health EIS Rules §11-200-8 (1) maintenance of existing structures, §11-200-8 (4) minor alteration of land and §11-200-8 (6) construction of minor structures. No future phases are planned for this project.

Publishing the draft EA is the sole attempt to solicit public input for this project. The proposed project is located in an industrial area where the major landowner is the State of Hawaii. The site abuts a sugar cane field and the nearest residences are over one-quarter mile away.

New burial acreage will cover approximately 68% of the acreage to be acquired. The additional burial acreage will add 5581 plots to the existing inventory of approximately 2500 plots. Burial density in the subject parcel will be 1360 plots per acre utilizing 4 feet by 8 feet plots. The V.A. standard is 600 grave sites per acre based on a 5 feet by 10 feet

grave. A verbal concurrence from the V.A. has been given as a waiver of the standard. For each grave plot, double interment is possible.

The project is covered by the Veterans Housing Benefits Act of 1978, Public Law 95-476, State Cemetery Program. The Department of Veterans Affairs will provide matching funds to the State for implementation of this project. A February 1994 report, issued by the State Department of Defense, estimated acquisition and development costs for Phase II to be \$626,567. This amount included design, construction management services, construction and a 5% contingency. The figure did not include permit fees, utility connection charges, cost of water development (if required by the Department of Water Supply) or cost growth due to inflation.

6.0 SUMMARY OF AFFECTED ENVIRONMENT

6.1 Location and Access

Figures 1 and 2 show the location of the existing Veterans Cemetery site. *Figure 3* shows the site plan of the expanded facility. The site is identified as a 5.45 acre portion of Tax Map Key (TMK) 1-8-08:38. Expansion of the cemetery involves acquisition of a six-acre portion of TMK 1-8-08:20 located west of and adjacent to the facility.

The Kauai Veterans Cemetery is located in the Hanapepe sub-area of the Waimea District. The site is accessible from Lele Road (see *Figure 3*). The 20 feet wide main entrance road is used for funeral processions entering the existing cemetery site. A 24 feet wide entrance from Lele Road provides access to the parking area. Proposed modifications include extending a road (Road "A" on *Figure 3*) from the back of the parking lot into the new property to provide access to additional cemetery burial areas. A cul-de-sac at the end of Road "A" will serve as a turnaround to exit the cemetery from the new burial areas. Road "B" will branch off of Road "A" so that no burial plot in the new acreage will be further than 275 feet from the road per V.A. criteria. Eight additional parking stalls will be provided for the new cemetery burial areas at the end of Road "B".

6.2 Land Use

The project site is classified as an Agricultural District by the State Land Use Commission and the County of Kauai Planning Department. This parcel is owned by the State of Hawaii and is currently leased to Gay and Robinson, Inc.

General land use in the vicinity includes residential (R), agricultural (A), and limited industrial (IL) activities. Facilities neighboring the project site include the Port Allen Airfield, the County's solid waste transfer station and base yard, public and private cemeteries, the Hanapepe Stadium, the old AMFAC warehouse, and the Air National Guard Armory.

6.3 Topography and Climate

The project site may be characterized as moderate to flat terrain with slopes ranging between 1 and 10 percent. The prevailing trade winds from the northeast and easterly directions ensure moderate temperatures all year. Annual soil temperature varies between 73 and 75 degrees Fahrenheit. The average annual rainfall recorded in the vicinity is approximately 22.2 inches. The Flood Insurance Rate Map (FIRM) flood plain hazard maps designated the site as zone X, and the area is determined to be outside the 500-year flood plain (see *Figure 4*).

6.4 Geology and Soils

The soil survey conducted by the U.S. Soil Conservation Service (USDA, 1972) has classified the soils on the project site as Jaucas loamy fine sand (JfB), Makaweli silty clay loam (MgB), and Nonopahu clay (NnC). Jaucas soils occur on narrow strips of coastal plains. The soil developed in wind-deposited sand from coral and seashells. This soil is neutral to moderately alkaline through from the surface to the subsoil. It is an excessively-drained soil with rapid permeability and very slow runoff. While the threat of water erosion is slight, wind erosion is possible if the vegetative cover is removed. Makaweli silty clay loam is characterized as slightly acidic in surface layer, gradually becoming neutral in the subsoil. These soils are developed from material weathered from basic igneous rock. Permeability is moderate, runoff is slow, and the erosion hazard is slight. Nonopahu clays are developed from material weathered from basic igneous rock also. They are underlain by soft weathered rock and are mildly alkaline throughout. Permeability is moderately slow, runoff is medium and the erosion hazard is moderate.

6.5 Archaeological Resources

The site has been under extensive agricultural use for several decades. In light of the past and present use of the subject property for sugar cane cultivation, the State Historic Preservation Division feels that it is very unlikely that any significant historic sites remain in the parcel. A copy of their report is found in Appendix A.

Should the contractor uncover any subsurface cultural remains such as artifacts, burials, deposits of shells or charcoal during excavation work, he is required to stop work in the area and contact the State's Historic Preservation Division immediately.

6.6 Biological Resources

The Department of Land and Natural Resources' Division of Forestry and Wildlife was consulted for information on threatened or endangered species that inhabit the project site. A review of the Hawaii Heritage Program maps prepared by the Nature Conservancy of Hawaii in May 1994 found no listed endangered plants. The Division noted that endangered koloa (ducks) and gallinules frequent the Salt Pond area and adjacent canefield irrigation ditches to the west of the desired parcel. It is their determination that the proposed action will not affect either species. Their correspondence is found in Appendix B.

6.7 Infrastructure

The cemetery site is provided with potable water by the Department of Water Supply, County of Kauai. Modifications to the existing system include installation of a 2-inch lateral that taps into the existing 2-inch water line. A new irrigation system will provide irrigation only along the perimeter of the existing cemetery burial areas for landscaping. No permanent irrigation system will be provided at the proposed adjacent cemetery site. A new water line will provide hose bibb service for the newly developed portion of the cemetery at intervals of approximately 100 feet.

The existing sewer lines are connected to a cesspool. No modifications are proposed to the existing system.

The facility is provided with electrical and telephone system. A new electrical system will tie into the existing electrical system and provide service for the new maintenance facility.

A new concrete sidewalk will connect the parking lot and the existing committal chapel. There will be ready access to the sidewalk as there will be no roadside curbs. Sidewalk grade will be flat to minimal.

7.0 PROBABLE IMPACTS AND MITIGATION MEASURES

7.1 Zoning and Land Use

The project site is within the State Agricultural Land Use District and is zoned Open District by the County of Kauai. Construction of a cemetery in State Agricultural District requires a Special Permit that is reviewed under the jurisdiction the County of Kauai Planning Commission. The site is currently under lease to the Olokele Sugar Company, Ltd. Acquisition of the agricultural land shall be coordinated with the Lessee.

Removing a six acre portion of parcel 20 and consolidating that portion with parcel 38 constitutes a subdivision of parcel 20. This creates implications for the remaining acreage in parcel 20. The County of Kauai zoning ordinances limit any resubdivision of an agricultural parcel if the land has been subdivided after September 1, 1972. To resubdivide a parcel that has been subdivided since 1972, the parcel must be transferred to Urban or Rural Districts under the provision of the State Land Use Law and is transferred to a use district other than Agriculture or Open. However, exceptions to this ordinance include: subdivisions requested by any governmental agency, subdivisions resulting from the construction of public improvements by governmental action, subdivisions requested for public utility purposes or consolidation and resubdivision of properties where no additional lots or parcels are created provided that the resulting properties would not permit greater density. As the subdivision is requested by a state agency, the proposed action is an exception to the ordinance and the resubdivision restriction does not apply.

The subject property is located on ceded land. The State of Hawaii Department of Land and Natural Resources (DLNR) will closely work with the Office of Hawaiian Affairs (OHA) directives to secure rights to the property.

Once the land acquisition is complete, the Department of Defense will proceed with the construction of cemetery modifications. The site will be transferred to the county of Kauai for operation and maintenance.

No visual impacts are expected from this project. Expanding the cemetery will preserve green space for land that is presently in agricultural service.

7.2 Grading and Drainage

The terrain at the project site is relatively flat, with an average slope of less than 5 percent. In accordance with Veterans Administration Cemetery Program Guide requirements, all on-site roadways will have a grade less than 10 percent, and all grave sites will be located on land with a grade less than or equal to 5 percent. The acquisition parcel will be graded entirely. Connection of the parking area road with the new access Road "A" will require

some excavation and grading on the existing property. Excavated material will be recycled and utilized as fill for roadway construction. Imported fill will be used as required in the construction of the roadways. Suitable topsoil will be imported for the new grave site area. Plans and specifications will incorporate indigenous land plant species whenever and wherever feasible as required by state law.

The existing cemetery does not have a piped drainage system, and the proposed modifications do not include installation of a drainage system. The final grade of the cemetery will mimic the natural contours of the project area wherever possible. *Figure 5* details the final grading plan. Runoff from the burial area will be conveyed in accordance with the existing drainage flow pattern through sheet flow and swales. The proposed development will not significantly increase run off.

The contractor is required to submit a plan for best management practices to be implemented during the construction phase of the project. These include: sediment traps or ponds to prevent sediment laden runoff from the construction site, gravel construction entrances at each ingress and egress, silt fences around any drain and perimeter runoff control. The contractor will be directed to keep the project area and surrounding area free from dust nuisance. Graded earth will be sodded and stabilized as soon as final grades are established. Planting will not be delayed until all grading is completed. If grading work is delayed or interrupted, the area will be planted. An NPDES storm water construction permit will be required for the facility as the disturbed area is greater than 5 acres.

7.3 Noise and Traffic Impacts

Noise and traffic are expected to be construction impacts of the project. However, construction nuisances are temporary and abatement measures will be undertaken during the construction period. Construction activity will be limited to regular work hours and will limit noise impacts to these times. Grading will only be permitted between the hours of 6 A.M. and 6 P.M. on Monday through Friday excepting holidays. All internal combustion engine powered equipment will have mufflers to minimize noise. Blasting or the use of explosives will be prohibited unless prior approval has been received from the Contracting Officer. The successful bidding contractor will be required to submit a traffic plan as part of his bid.

7.4 Water Resources

The proposed cemetery site is located below the Underground Injection Control (UIC) line. There are no drinking water resources located hydrologically downgradient from this site. As the site is located at an elevation of approximately 25 feet mean sea level, there is a large unsaturated filter zone to protect nearby water resources (groundwater, Hanapepe Bay) from contamination. Therefore no contamination of these waters are expected.

8.0 ALTERNATIVES TO THE PROPOSED ACTION

8.1 No Project

Construction of the Kauai Veterans Cemetery will benefit veterans and their families by providing interment services for the next 20 years. The existing cemetery does not meet the state or federal requirements and insufficient burial acreage remains to accommodate eligible veterans and their families. Eventually this cemetery will reach burial capacity. If no action is taken, when the existing cemetery reaches full capacity, eligible veterans must be interred at a private cemetery or at remotely located veterans cemeteries. Interment at private or remotely located cemeteries results in additional time, expense and inconvenience for Kauai veterans and their families. Failure to upgrade will deny veterans and their families use of a facility of comparable quality and stature as found at other veterans facilities nationwide.

8.1 Alternate Site

The project site was selected as part of the Veterans Cemeteries Master Planning by the state Department of Defense. One project goal included expansion and incorporation of adjacent land into the existing cemetery. The desired parcel is ideal because it is already owned by the State of Hawaii and is located adjacent to the existing veterans cemetery.

Selection of an alternative site will have negative economic consequences. There are no funds budgeted for land purchases. Selection of another site involves a land swap with or donation from a private landowner. In addition, the receipt of federal funds for this project requires that cemetery expansion be contiguous. Rejection of the proposed site, in favor of another remotely located site will lead to the loss of federal funds. Consequently, any upgrades planned for facilities on the existing property as part of Phase II, (e.g., construction of a new maintenance shed or addition of a robing room to the existing committal chapel), would be eliminated.

9.0 LIST OF PERMITS

The following permits and clearances will be required as part of this project:

State of Hawaii:

- NPDES Storm Water Construction Permit (DOH Clean Water Branch)

County of Kauai:

- Grading Permit (Department of Public Works)
- Building Permit (Building Department)
- Use Permit (Planning Department)
- Class IV Zoning Permit
- Approval (County Council)

10.0 DETERMINATION

In accordance with Chapter 343, Hawaii Revised Statutes, this Environmental Assessment has characterized the technical and environmental issues of the Phase II -- Kauai Veterans Cemetery project, identified potential impacts and their significance. It is anticipated that the proposed project will not significantly impact the environment. Therefore, a Negative Declaration is anticipated, and an Environmental Impact Statement is not required for this project. This determination is based on the significance criteria listed in § 11-200-12 of the Environmental Impact Statement Rules. Specifically, these significance criteria are addressed below:

1. The proposed project will not result in an adverse commitment, loss, or destruction of any natural or cultural resources. A six-acre portion of agricultural land will be used to provide interment services for the next 20 years.
2. The range of beneficial uses of the environment will not be curtailed.
3. The project will not conflict with the state's long-term environmental policies or goals and guidelines as expressed in chapter 344, HRS, and any revisions thereof and amendments thereto, court orders or executive orders.
4. The proposed project will not adversely affect the economic or social welfare of the community or state. The project will improve the social welfare of the community by providing improved interment services for the veterans and their families on the island of Kauai.
5. The project will not adversely affect public health.
6. The project will not involve substantial adverse secondary impacts, such as population changes or effects on public facilities. The proposed project responds to current population trends.
7. The project will not involve any substantial degradation of environmental quality.
8. The project will not include cumulative considerable effect upon the environment nor involves a commitment for larger actions. The proposed actions are complete and will require no further action.
9. The project will not substantially affect a rare, threatened or endangered species, or its habitat.
10. The project will not detrimentally affect air or water quality or ambient noise levels. Short-term impacts will occur during the construction phase.

11. The project will not affect an environmentally sensitive area such as a flood plain, tsunami zone, erosion-prone area, geologically hazardous land, estuary, fresh water, or coastal waters.
12. The project will not affect scenic vistas and view planes.
13. The project will not require substantial energy consumption.

11.0 REFERENCES

Documents reviewed during preparation of this Environmental Assessment:

- Applied Planning Services, 1995, *Environmental Assessment for Hanapepe Self-Help Project*. Prepared for the Self-Help Housing Corporation of Hawaii, Honolulu, HI.
- Armstrong, R.W., editor, 1983, *Atlas of Hawaii*, second edition. Department of Geography, University of Hawaii. University of Hawaii Press, Honolulu.
- Federal Emergency Management Agency, 1987, *Flood Insurance Rate Map*, Kauai County, Hawaii, community panel number 150002 0190C.
- Foote, D.E., Hill, E.L., Nakamura, S., Stephens, F., 1972, *Soil Survey of islands of Kauai, Oahu, Maui, Molokai, and Lanai, State of Hawaii*: U.S. Dept. of Agriculture, Soil Conservation Service.
- Hawaii Department of Taxation, *Tax Map* for fourth division, zone 1, section 8, plat 08, Scale 1:36,000.
- M&E Pacific, Inc., 1994, *Neighbor Islands Veterans Cemetery -- Master Plan Report*. Prepared for the State Department of Defense Office of Veterans Services.
- U.S. Geological Survey, 1983, *Topographic Map of Kauai -- Hanapepe Quadrangle*, Hawaii, Scale 1:24,000.

Appendix A: Archaeological Resources

DOCUMENT CAPTURED AS RECEIVED

ENJAMIN J. CAYTANO
GOVERNOR OF HAWAII



STATE OF HAWAII
DEPARTMENT OF LAND AND NATURAL RESOURCES
STATE HISTORIC PRESERVATION DIVISION
33 SOUTH KING STREET, 6TH FLOOR
HONOLULU, HAWAII 96813

MICHAEL D. WILSON, CHAIRPERSON
BOARD OF LAND AND NATURAL RESOURCES

DEPUTY
GUEST COLOMA-AGARAN

AQUACULTURE DEVELOPMENT
PROGRAM

AQUATIC RESOURCES
CONSERVATION AND

ENVIRONMENTAL AFFAIRS
CONSERVATION AND

RESOURCES ENFORCEMENT
CONVEYANCES

FORESTRY AND WILDLIFE
HISTORIC PRESERVATION

DIVISION

LAND MANAGEMENT

STATE PARKS

WATER AND LAND DEVELOPMENT

August 14, 1996

Ms. Jian Cai
M&E Pacific, Inc.
Suite 500, Pauhi Tower
1001 Bishop Street
Honolulu, Hawai'i 96813

LOG NO: 17817 ✓
DOC NO: 9608NM03

Dear Ms. Cai:

**SUBJECT: Historic Preservation Information on Historic Sites for the
EA for Kauai Veterans Cemetery
TMK: 1-8-8: 38
Hanapepe, Waimea, Kaua'i**

Thank you for your fax, dated August 2, 1996, concerning information on historic sites in the project area in preparation for your EA. The project area indicated on your map accompanying your letter was formerly under sugar cane cultivation so it is unlikely that significant historic sites are still present.

Should you have any questions, please call Nancy McMahon at 742-7033.

Aloha,

DON HIBBARD, Administrator
State Historic Preservation Division

NM:amk

Appendix B: Biological Resources

Department of Land and Natural Resources
Division of Forestry and Wildlife
Kauai District
3060 Eiwa St., Room 306
Lihue, HI 96766-1875
(808) 241-3433/(808) 241-3605 (Fax)

August 22, 1996

MEMORANDUM

TO: JIAN CAI
FROM: ED PETTEYS, District Manager *EDP*
SUBJECT: EA for Veterans Cemetery, Hanapepe, Kauai.

There are no listed endangered plants according Hawaii Heritage Program maps dated 5/3/94 as prepared by the Nature Conservancy of Hawaii.

There are endangered ducks(koloa) and gallinules that frequent the Salt Pond area and adjacent canefield irrigation ditches to the west of the project site. The proposed action should not affect the species mentioned above.

Should you have any questions, please contact Galen Kawakami at (808) 274-3433.
Thank you.

Appendix C: Draft EA Public Comments and Responses

BENJAMIN J. CAYETANO
GOVERNOR



STATE OF HAWAII
DEPARTMENT OF DEFENSE
OFFICE OF THE ADJUTANT GENERAL
3949 DIAMOND HEAD ROAD, HONOLULU, HAWAII 96816-4495

EDWARD V. RICHARDSON
MAJOR GENERAL
ADJUTANT GENERAL

MICHAEL E. RAWLINS
COLONEL
DEPUTY ADJUTANT GENERAL

April 25, 1997

Mr. Gary Gill, Director
Office of Environmental Quality Control
220 South King Street
Honolulu, HI 96813

Dear Mr. Gill:

Re: Response to OEQC Comments regarding Draft Environmental Assessment (EA) for
Kauai Veterans Cemetery, Phase II, Hanapepe, Hawaii

This is in response to your letter dated October 3, 1996 to Lieutenant Colonel Richard Young of the State Department of Defense. Per your review of the draft EA you raised concerns regarding the following six items: 1) segmentation of projects is not permitted and whether there are any future phases, 2) notify neighbors and document contacts, 3) construction activity noise and traffic impacts, 4) what measures will be taken to prevent ground and water contamination from embalming fluids 5) impact on nearby water resources and 6) visual impacts.

Our responses are:

- 1) No future phases are planned for this project. This project was segmented into two phases due to budgeting. Phase 1 involved maintenance and minor repairs to existing structures and did not require any assessment. Phase 2 involves the acquisition of additional land and thus requires an EA. This will be stated in the final EA.
- 2) As the proposed project is a) located in an industrial area where the major landowner is the State of Hawaii, b) abuts a sugar cane field and c) the nearest neighbors are more than one-quarter mile away, no attempt was made to solicit public input other than publishing the draft EA. This will be stated in the final EA.
- 3) Short term construction related impacts will be added to the final EA.
- 4) The proposed cemetery site is located below the Underground Injection Control (UIC) line. There are no drinking water sources downgradient from this site. As the site elevation is at an elevation of approximately 25 feet MSL, there is a large unsaturated filter zone to protect nearby water resources (Hanapepe Bay) from contamination. Therefore, no contamination of this water is expected. This will be stated in the final EA.



Mr. Gary Gill
Page 2

- 5) The impacts, if any, to nearby water resources will be discussed in the final EA.
- 6) The visual impact of the project on nearby neighbors will be discussed in the final EA.

Sincerely,

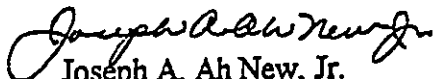
Joseph A. Ah New, Jr.
Contracting and Engineering Officer

c: Bruce D. Wade - M&E Pacific

BENJAMIN J. CAYETANO
GOVERNOR



GARY GILL
DIRECTOR

STATE OF HAWAII
OFFICE OF ENVIRONMENTAL QUALITY CONTROL

220 SOUTH KING STREET
FOURTH FLOOR
HONOLULU, HAWAII 96813
TELEPHONE (808) 598-4188
FACSIMILE (808) 598-4188

October 3, 1996

Lt. Col. Richard Young
State Department of Defense
3949 Diamond Head Road
Honolulu, Hawaii 96816

Dear Lt. Col. Young:

Subject: Draft Environmental Assessment (EA) for Kauai Veterans Cemetery,
Phase II, Hanapepe

Please include the following in the final EA.

1. For project disclosures under HRS 343 *segmentation* of is not permitted. Projects must be described in their entirety. This EA describes Phase II and Phase I is mentioned in the document. Are any future phases planned for this project? If so a single disclosure document for all phases must be submitted.
2. Please notify the nearest neighbors and any interested community groups and document your *contacts*.
3. Discuss *noise and traffic impacts* of construction activities and any mitigation measures planned.
4. Formalin, used to preserve bodies, has the potential to contaminate surrounding soils. What measures will be taken to prevent *ground and water contamination* by formalin?
5. What are the impacts to nearby *water resources* and what mitigation measures are planned to lessen or eliminate these impacts?

Lt. Col. Richard Young
October 3, 1996
Page 2

6. Discuss *visual impacts* of the project on the nearest neighbors and if any mitigation measures are planned.

If you have any questions, call Nancy Heinrich at 586-4185.

Sincerely,



GARY GILL
Director

c: ✓ Bruce Wade, M&E Pacific

BENJAMIN J. CAYETANO
GOVERNOR



STATE OF HAWAII
DEPARTMENT OF DEFENSE
OFFICE OF THE ADJUTANT GENERAL
3949 DIAMOND HEAD ROAD, HONOLULU, HAWAII 96816-4495

EDWARD V. RICHARDSON
MAJOR GENERAL
ADJUTANT GENERAL

MICHAEL E. RAWLINS
COLONEL
DEPUTY ADJUTANT GENERAL

April 25, 1997

Mr. Dee Crowell, Planning Director
County of Kauai
Planning Department
4444 Rice Street, Suite 473
Lihue, Hawaii 96766

Dear Mr. Crowell:

Re: Response to Planning Department Comments for Draft Environmental Assessment (EA)
Kauai Veterans Cemetery, Phase II, Hanapepe

This is in response to your letter dated November 6, 1996 to Lieutenant Colonel Richard Young of the State Department of Defense. Per your review of the draft EA you raised concerns regarding the following seven items: 1) indicate Tax Map Key as 1-8-08: por. 20; 2) zoning designations; 3) special permit requirement; 4) subdivision and consolidation of the parcel; 5) Council review and approval; 6) consultation with County Attorney regarding ownership transfer of ceded lands; and 7) Planning Department permit requirements regarding improvements to TMK: 1-8-08: 38.

Our responses are:

- 1) The TMK Location Map (Figure 2 of the EA) will be changed to indicate 1-8-08: por 20.
- 2) Zoning designation in Section 7.1 - Zoning and Land Use of the EA will be changed to reflect that the proposed site is within the State Agricultural Land Use District and the County of Kauai Open District.
- 3) The requirement for a Special Permit approved by the County of Kauai Planning Commission will be added to the EA.
- 4) The implications of subdivision will be more fully explained in the EA.
- 5) The requirement for approval of cemetery expansion by the Kauai County Council will be added to the EA.
- 6) The State Department of Defense will consult with the County Attorney regarding the transfer of ownership of ceded lands from the State to the County.



Mr. Dee Crowell
Page 2

- 6) The State Department of Defense will consult with the County Attorney regarding the transfer of ownership of ceded lands from the State to the County.
- 7) The State Department of Defense will consult with the Planning Department regarding any permits required for additional improvements to be made on TMK: 1-8-08: 38.

Thank you for your comments on this draft EA.

Sincerely,

Joseph A. Ah New, Jr.
Contracting and Engineering Officer

c: Mr. Bruce D. Wade - M&E Pacific, Inc.

MARYANNE W. KUSAKA
MAYOR



COUNTY OF KAUAI
PLANNING DEPARTMENT
4444 RICE STREET, SUITE 473
LIHUE, KAUAI, HAWAII 96766

DEE M. CROWELL
PLANNING DIRECTOR
IAN K. COSTA
DEPUTY PLANNING DIRECTOR
TELEPHONE (808) 241-6677
FAX (808) 241-6699

November 6, 1996

Lt. Col. Richard Young
Department of Defense
3949 Diamond Head Road
Honolulu, HI 96816

COPY

SUBJECT: Draft Environmental Assessment (EA)
Kauai Veterans Cemetery Phase II
TMK 1-8-08: por. 20

Thank you for the opportunity to review the Draft Environmental Assessment for the subject project. We have the following comments:

- (1) The Tax Map Key should be indicated as 1-8-08: por. 20.
- (2) The proposed site is within the State Agricultural Land Use District and is zoned Open District (O) by the County of Kaua'i (see attached map).
- (3) A Special Permit would be required to establish a cemetery use in the State Agricultural Land Use District. Such permit would be reviewed under the jurisdiction of the County of Kaua'i Planning Commission.
- (4) Subdivision of the subject parcel from the larger parcel (379.06 acres) would be required and consolidation with the existing cemetery may be recommended or required.
- (5) Review and approval by the Kaua'i County Council would be required for the expansion of a cemetery, pursuant to Hawai'i revised Statutes Section 441-4, prior to granting of any permits for such use by the Planning Commission.
- (6) The applicant should consult with the County Attorney's office regarding any transfer of ownership of ceded lands from the State to the County for the Veterans Cemetery.

AN EQUAL OPPORTUNITY EMPLOYER

Lt. Col. Richard Young
Page 2
November 6, 1996

- (6) The applicant should consult with the Planning Department regarding permits required for any additional improvements to be made on TMK 1-8-08: 38.

Thank you again for the opportunity to comment on this Draft Environmental Assessment.



DEE M. CROWELL
Planning Director

cc: Mr. Bruce Wade, M & E Pacific, Inc.
OEQC



STATE OF HAWAII
OFFICE OF HAWAIIAN AFFAIRS
711 KAPI'OLANI BOULEVARD, SUITE 500
HONOLULU, HAWAII 96813-5248
PHONE (808) 594-1888
FAX (808) 594-1865

October 08, 1996

Mr. Bruce D. Wade
Project Engineer
M&E Pacific, Inc.
1001 Bishop Street, Suite 500
Honolulu, HI 96813

Dear Mr. Wade:

Thank you for the opportunity to review the Draft Environmental Assessment (DEA) for Kauai Veterans Cemetery, Phase II, Island of Kauai. The Kauai Veterans Cemetery project results from the master plan developed by the State Department of Defense to establish, expand, and improve veteran cemeteries throughout the State. Phase II consists of the development of the land to include burial sites, support facilities, access roads, and parking facilities.

After a review of the DEA, the Office of Hawaiian Affairs has no objections at this time to the proposed project. Based on the information contained in the DEA, developments in Phase II apparently bear no significant long-term adverse impacts on adjacent urban areas nor upon existing flora or fauna habitats. Furthermore, no known archaeological remains exist in the cemetery and the proposed developments will not significantly impact scenic resources. Please contact me, or Linda K. Delaney, the Land and Natural Resources Division Officer (594-1938), or Luis A. Manrique (594-1755), should you have any questions on this matter.

Sincerely yours,
Martha Ross

Martha Ross
Deputy Administrator

LM:lm

FIGURES

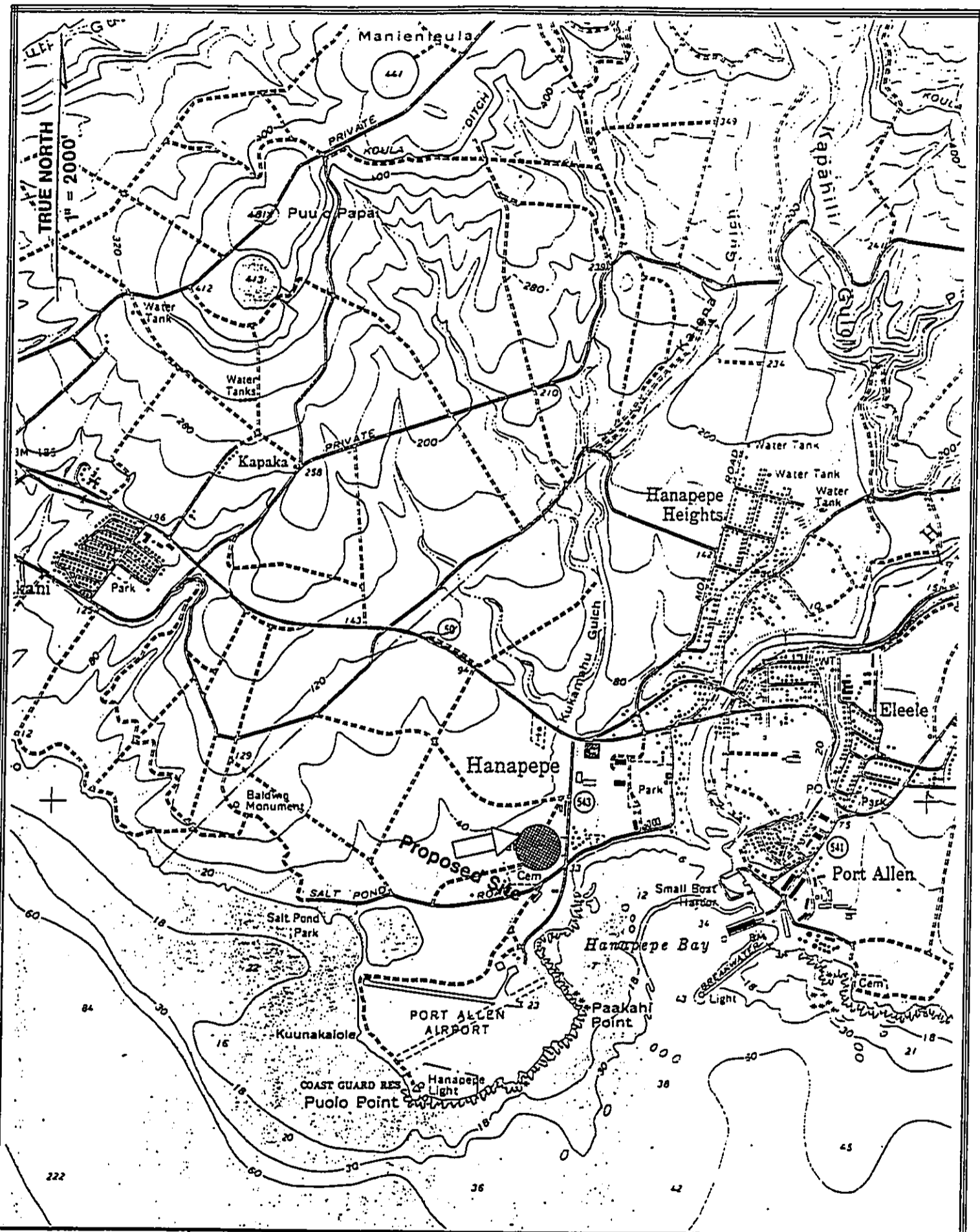

M&E
Pacific, Inc.

KAUAI VETERANS CEMETERY
Environmental Assessment
T.M.K.: 1-8-8:por 20

FIGURE 1
REGIONAL LOCATION MAP

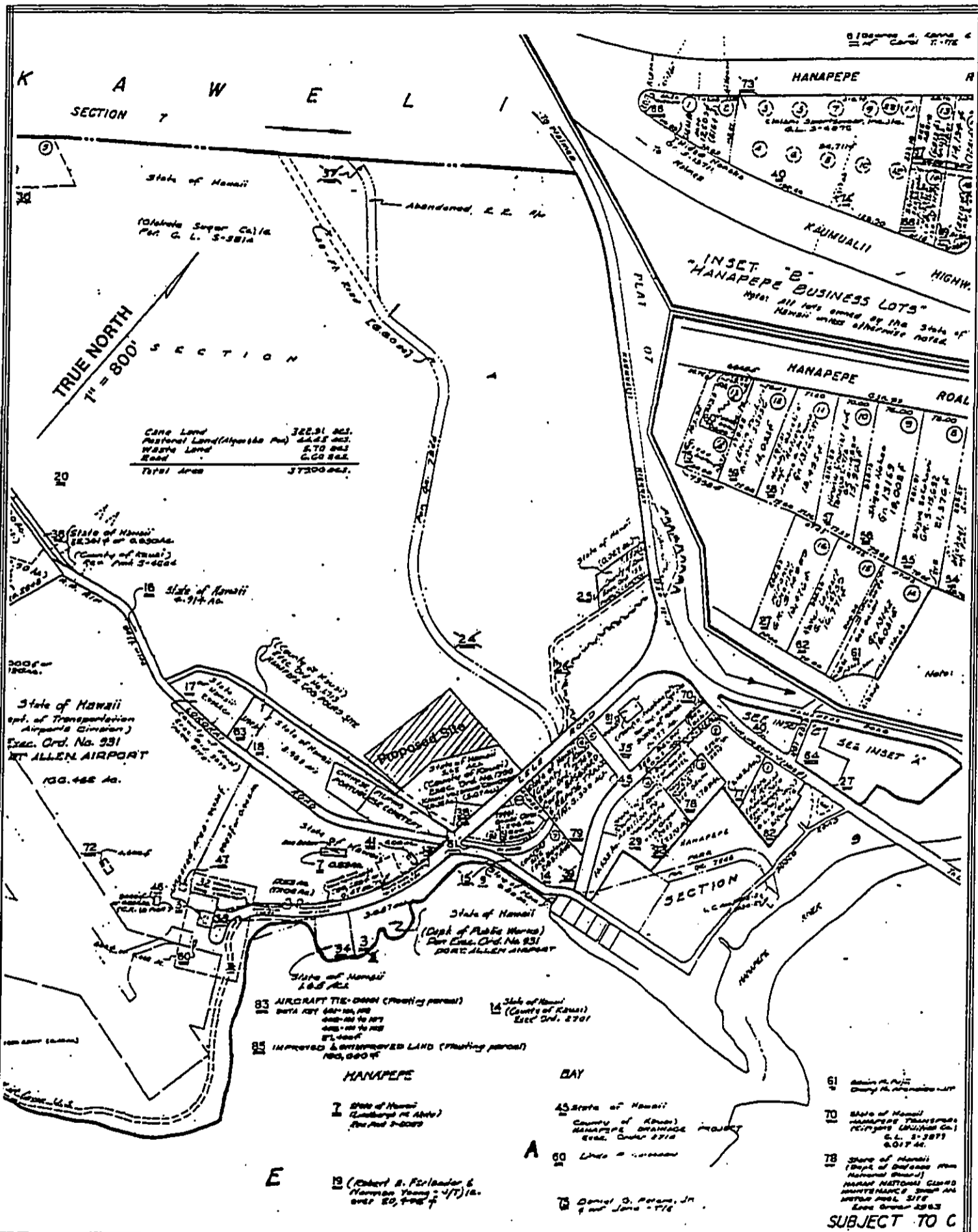

M&E
Pacific, Inc.

KAUAI VETERANS CEMETERY
Environmental Assessment
T.M.K.: 1-8-8:por 20

FIGURE 2
T.M.K. LOCATION MAP

TRUE NORTH
1" = 100'

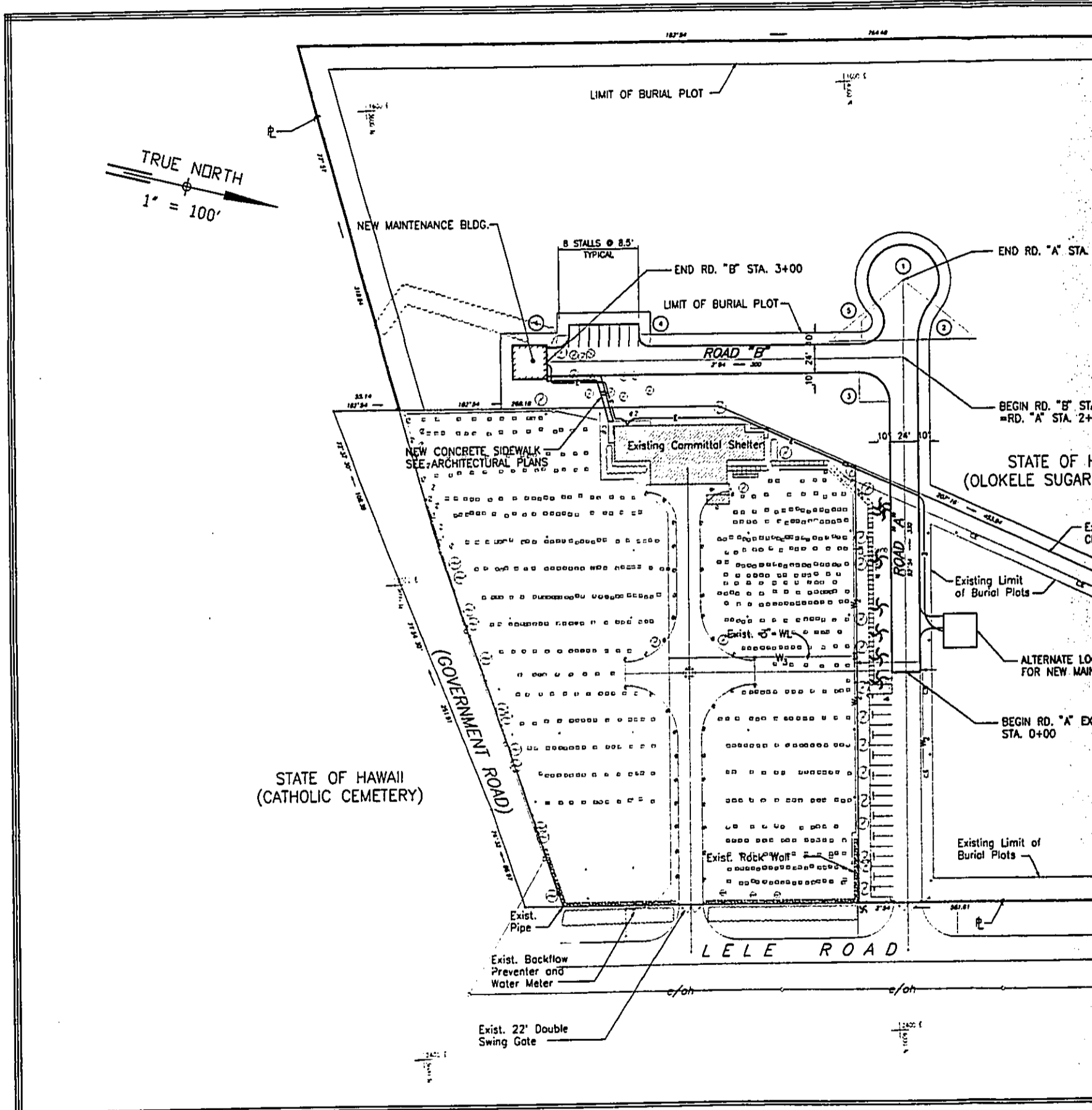

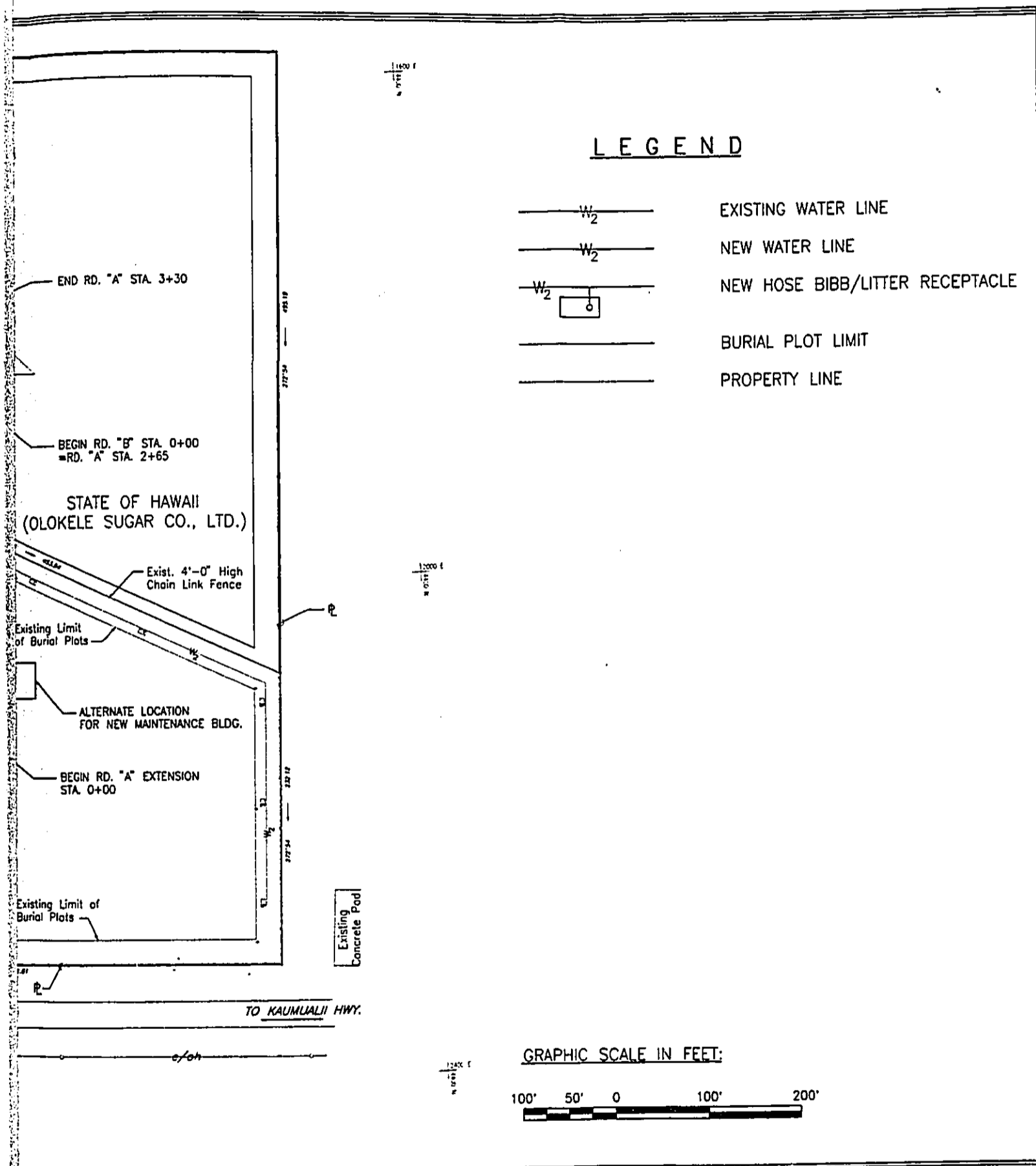

M&E
Pacific, Inc.

KAUAI VETERANS CE
Environmental Assess
T.M.K.: 1-8-8:por

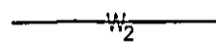
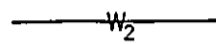
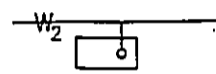
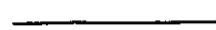

LEGEND

-  EXISTING WATER LINE
-  NEW WATER LINE
-  NEW HOSE BIBB/LITTER RECEPTACLE
-  BURIAL PLOT LIMIT
-  PROPERTY LINE

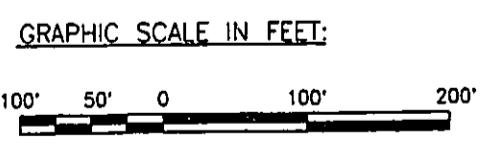

ANS CEMETERY
al Assessment
-8-8:por 20

FIGURE 3
SITE PLAN

DATE: 11/14/88

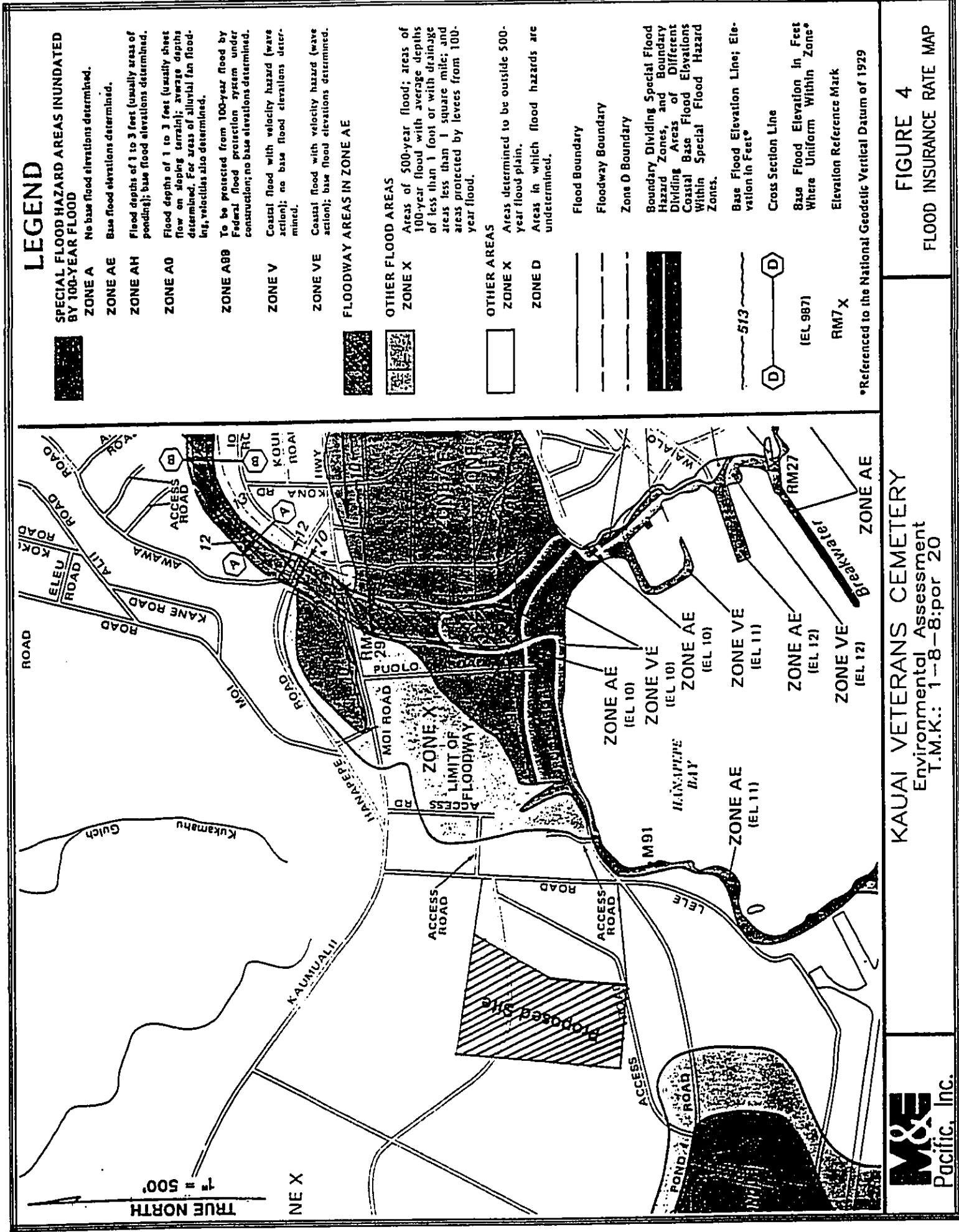
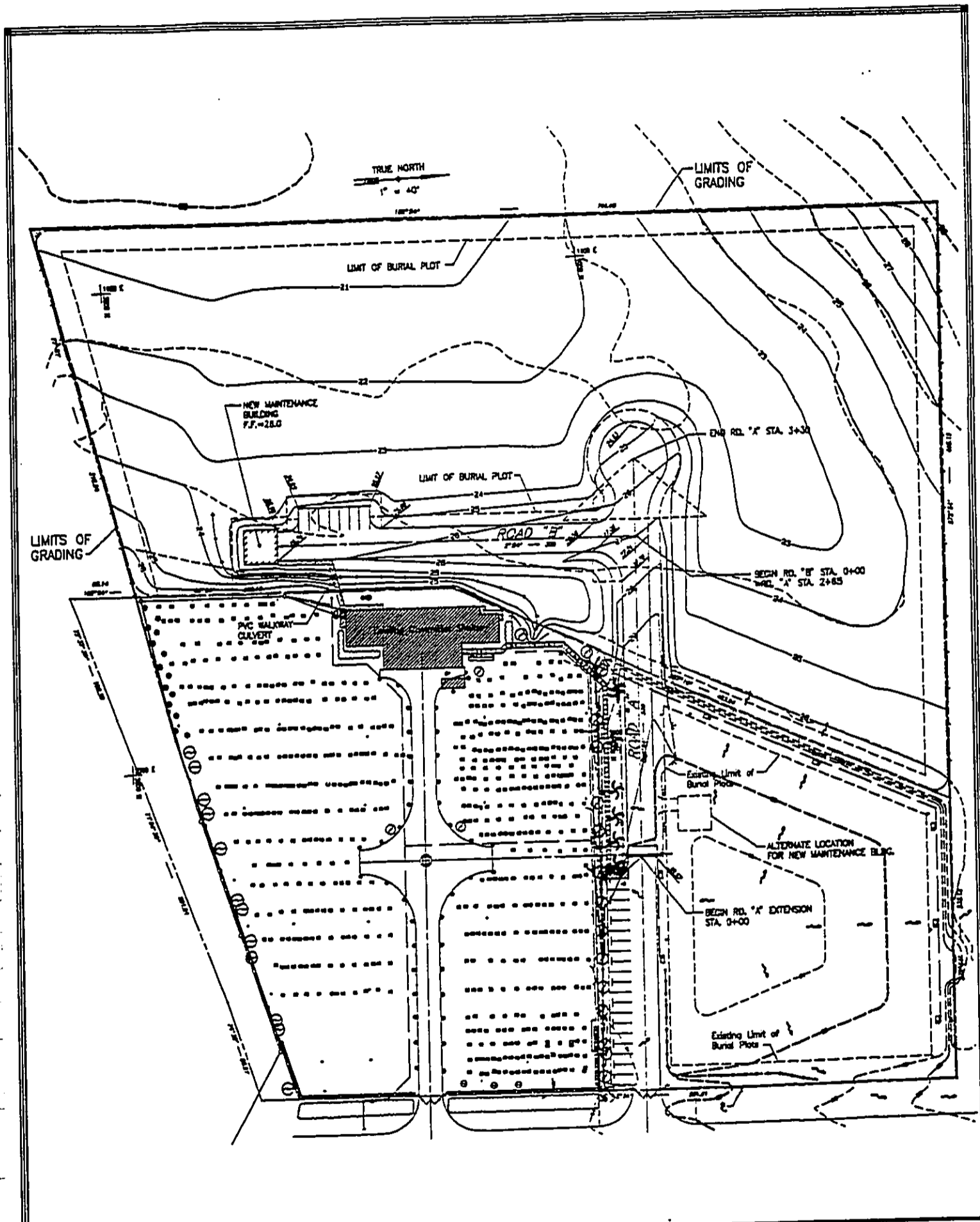

FIGURE 4
FLOOD INSURANCE RATE MAP



M&E
Pacific, Inc.

KAUAI VETERANS CEMETERY
Environmental Assessment
T.M.K.: 1-8-8:por 20

FIGURE 5
GRADING & DRAINAGE