

DEPARTMENT OF DESIGN AND CONSTRUCTION
CITY AND COUNTY OF HONOLULU

650 SOUTH KING STREET, 11TH FLOOR
HONOLULU, HAWAII 96813
PHONE: (808) 523-4564 FAX: (808) 523-4567
WEB SITE ADDRESS: www.co.honolulu.hi.us

JEREMY HARRIS
MAYOR



July 1, 2002

RECEIVED

'02 JUL 10 P 4:02

OFFICE OF ENVIRONMENTAL
QUALITY CONTROL

RAE M. LOUI, P.E.
DIRECTOR
ERIC G. CRISPIN, AIA
DEPUTY DIRECTOR
GEORGE T. TAMASHIRO, P.E.
ASSISTANT DIRECTOR

CDEP 02-0187

Ms. Genevieve Salmonson, Director
Office of Environmental Quality Control
State of Hawaii
235 South Beretania Street, Suite 702
Honolulu, Hawaii 96813

Dear Ms. Salmonson:

Subject: Finding of No Significant Impact (FONSI) for
Pooleka Street Drainage Improvements
TMK: 3-4-03: 10, 22, 24, 25, 32, 33, 36 and 37
Palolo, Honolulu, Oahu, Hawaii

The Department of Design and Construction (DDC) is the proposing agency and accepting authority for the above project. DDC has reviewed and responded to comments received during the 30-day public comment period and the Draft Environmental Assessment (DEA) of the project which began on May 8, 2002.

DDC has determined that this project will not have significant environmental effects and is issuing a notice of determination of a FONSI. Please publish this notice in the July 23, 2002, OEQC *Environmental Notice*. We have enclosed a completed OEQC Publication Form and four copies of the Final Environmental Assessment (FEA).

Identification of Proposing Agency and Accepting Authority

Department of Design and Construction
City and County of Honolulu

Brief Description of Proposed Action

The City and County of Honolulu proposes to construct an underground drainage system to alleviate flooding that occurs in private residential areas at the end of Pooleka Street.

60

Ms. Genevieve Salmonson
Page 2
July 1, 2002

Stormwater from Pooleka Street currently concentrates at the southwest corner at the end of the road. This runoff and additional stormwater contributed by adjacent properties discharges by way of surface sheet flow through a 10-foot wide easement, terminating at the end of the easement into a residential property.

The proposed system will satisfy current City and County storm drainage standards (2000) and will include approximately 460 lineal feet of 18-inch diameter reinforced concrete pipe, 3 drainage inlets, 3 manholes, and an outlet structure on the bank of Waiomao Stream. The system will accommodate 11.2 cubic feet per second (CFS) of stormwater from a drainage area of 1.83 acres.

Construction will take approximately 4 months. Residents may expect temporary inconvenience from equipment noise, dust and possibly some interference with vehicular and pedestrian traffic. However, the contractor will be required to provide adequate grading, stockpiling and erosion control measures as required by Chapter 23 of the Revised Ordinances of Honolulu, and to comply with requirements of Title 11, Chapter 60.1 of the Hawaii Administrative Rules (HAR), Air Pollution Control.

Determination and Reasons Supporting the Determination

After completing an assessment of the potential environmental effects of the proposed project, reviewing comments from the public, governmental agencies and interested parties, and evaluating the Significance Criteria, Section 12 of Hawaii Administrative Rules Title 11, Chapter 300, Environmental Impact Statement Rules, the proposing agency does not anticipate any significant impacts on the environment. A **Finding of No Significant Impact (FONSI)** has been determined for the project with the reasons supporting this determination discussed below.

1. *The project will not involve an irrevocable commitment to loss or destruction of any natural or cultural resources.*

The proposed project site is located in a residential area, and hence urbanization has already altered the land. No significant natural or cultural resources are expected to be encountered since the project scope calls for modification of existing man-made infrastructure with no disturbance of lands which were previously undisturbed.

2. *The project will not curtail the range of beneficial uses of the environment.*

The proposed project is solely intended to enhance the existing beneficial uses of the urban center.

Ms. Genevieve Salmonson
Page 3
July 1, 2002

3. *The project will not conflict with the State's long-term environmental policies or goals and guidelines as expressed in Chapter 344, Hawaii Revised Statutes, and any revisions thereof and amendments thereto, court decisions or executive orders.*

The project will not conflict with the environmental policies as set forth in the State Plan and Chapter 344, Hawaii Revised Statutes (HRS) in that the project will not damage sensitive natural resources nor emit contaminants.

4. *The project will not substantially affect the economic or social welfare of the community or State.*

There may be some negative short-term economic and social impacts as related to construction (traffic congestion, blockage of street frontage and noise, etc.). However, the long-term benefits are related to the safety and protection of property and residents along Pooleka Street, the existing drainage easement, and TMK: 3-4-03: 10.

5. *The project will not substantially affect public health.*

No impact on public health is anticipated. Increased safety is considered positive.

6. *The project will not involve substantial secondary impacts, such as population change or effects on public facilities.*

The project will not influence population change nor impact on existing infrastructure.

7. *The project will not involve a substantial degradation of environmental quality.*

Environmental quality will be essentially the same as that which exists prior to project implementation. The project consists of underground improvements within a road and existing right-of-way. Discharge of storm runoff will be into Waiomao Stream which will have no significant long-term impacts to aquatic resources.

8. *The project is individually limited and will not cumulatively have a considerable effect upon the environment nor involves a commitment for larger actions.*

The proposed drainage system is limited to Pooleka Street (City and County of Honolulu), and existing drainage easement and a residential lot that is being

leased by the State of Hawaii. Subsequent actions will require the creation of a perpetual, non-exclusive easement for drainage purposes in favor of the City and County of Honolulu on the lot that is being leased.

9. *The project will not substantially affect a rare, threatened or endangered species, or its habitat.*

The project area is limited to an existing road and right-of-way which are not known to sustain any habitats of threatened or endangered species.

10. *The project will not detrimentally affect air quality, water quality or ambient noise levels.*

Short-term impacts may occur during the construction of the project. However, the contractor must comply with current Department of Health regulations and must adhere to and provide Best Management Practices (BMP) practices.

11. *The project will not affect an environmentally sensitive area such as a flood plain, tsunami zone, erosion-prone area, geologically hazardous land, estuary, fresh water, or coastal waters.*

The project site is not located in any sensitive area.

12. *The project will not substantially affect scenic vistas or view lanes as identified in County or State plans or studies.*

The proposed drainage improvements will be constructed underground within an existing road and right-of-way and will not have any affect on scenic vistas or view planes.

13. *The proposed project will not require substantial energy consumption.*

The only energy consumption involved with this project is that related to construction activities. After construction completion, energy consumption will essentially return to that which existed prior to construction.

Supplementary Information

The FEA for the proposed project and the results of the coordination and consultation undertaken with affected governmental agencies and interested parties are attached to support the notice of

Ms. Genevieve Salmonson
Page 5
July 1, 2002

determination of a FONSI. The FEA is part of the environmental review process to meet the requirements of Chapter 343, HRS.

Name, Address and Phone Number of Contact Person for Further Information

Mr. Gregory Sue
Department of Design and Construction
City and County of Honolulu
650 South King Street, 11th Floor
Honolulu, Hawaii 96813
Phone: 527-6304

Very truly yours,



RAE M. LOUI, P.E.
Director

GS:dk
Enclosures

cc: Gray, Hong, Bills, Nojima & Associates, Inc.

64

JUL 23 2002

FILE COPY

2002-07-23-0A-~~FEA~~-

FINAL ENVIRONMENTAL ASSESSMENT

FOR

(POOLEKA STREET DRAINAGE IMPROVEMENTS)
WAIOMAO, PALOLO, HONOLULU, OAHU, HAWAII
TMK: 3-4-03: 10, 22, 24, 25, 32, 33, 36, 37



Gray • Hong • Bills • Nojima & Associates, Inc.
CONSULTING ENGINEERS

FINAL ENVIRONMENTAL ASSESSMENT

FOR

**(~~POOLEKA STREET DRAINAGE IMPROVEMENTS~~
~~WAIOMAO, PALOLO, HONOLULU, OAHU, HAWAII~~
TMK: 3-4-03: 10, 22, 24, 25, 32, 33, 36, 37)**

PREPARED

FOR

**DEPARTMENT OF DESIGN AND CONSTRUCTION
CITY AND COUNTY OF HONOLULU**

PREPARED

BY

**GRAY, HONG, BILLS, NOJIMA & ASSOCIATES, INC.
841 BISHOP STREET, SUITE 1100
HONOLULU, HAWAII 96813**

JULY 2002

TABLE OF CONTENTS

	Page
I. AGENCY PROPOSING THE ACTION	1
II. APPROVING AGENCY	1
III. AGENCIES, ORGANIZATIONS, AND INDIVIDUALS CONSULTED	1
IV. GENERAL DESCRIPTION OF THE PROPOSED ACTION	2
A. NEED FOR THE PROJECT	2
B. TECHNICAL CHARACTERISTICS	2
C. ECONOMIC	3
D. SOCIAL	3
E. ENVIRONMENTAL CHARACTERISTICS	3
V. SUMMARY DESCRIPTION OF THE AFFECTED ENVIRONMENT	4
A. FLORA AND FAUNA	4
B. SURFACE WATER QUALITY	4
C. TRAFFIC	5
D. AIR QUALITY	5
E. NOISE	5
F. WATER SYSTEMS	5
G. SEWER SYSTEMS	6
H. DRAINAGE SYSTEMS	6
I. ELECTRIC/CABLE UTILITIES	6
J. GAS MAINS	6
VI. SUMMARY OF MAJOR IMPACTS	6
A. SHORT-TERM	6
B. LONG-TERM	7
VII. ALTERNATIVES CONSIDERED	7
VIII. MITIGATION MEASURES	7
A. CONSTRUCTION ACTIVITIES	7
B. LONG-TERM	9
IX. PERMITS REQUIRED FOR PROJECT	9
A. U.S. GOVERNMENT	9
B. STATE OF HAWAII	9
C. CITY AND COUNTY OF HONOLULU	9
X. FINDINGS AND REASONS TO SUPPORT THE DETERMINATION	10
XI. SUMMARY OF UNRESOLVED ISSUES	12

XII. LIST OF AGENCIES, ORGANIZATIONS OR PRIVATE INDIVIDUALS THAT WERE NOTIFIED DURING THE PUBLIC COMMENT PERIOD 12

XIII. LIST OF PERSONS, FIRMS OR AGENCIES THAT PREPARED THIS ASSESSMENT 13

REFERENCES 14

LIST OF FIGURES

- FIGURE 1 - VICINITY MAP
- FIGURE 2 - LOCATION MAP
- FIGURE 3 - PROJECT SITE PLAN
- FIGURE 4 - HYDROLOGIC MAP
- FIGURE 5 - PRELIMINARY PLAN AND PROFILE
- FIGURE 6 - OUTLET STRUCTURE
- FIGURE 7 - PHOTOS OF PARCEL 10 (TMK: 3-4-03:10)
- FIGURE 8 - FLOOD HAZARD MAP
- FIGURE 9 - SILT CURTAIN DETAIL

LIST OF APPENDICES

- APPENDIX A - COMMENTS AND RESPONSES ON DRAFT ENVIRONMENTAL ASSESSMENT
- APPENDIX B - PRELIMINARY COST ESTIMATE

**FINAL ENVIRONMENTAL ASSESSMENT
FOR
POOLEKA STREET DRAINAGE IMPROVEMENTS
WAIOMAO, PALOLO, HONOLULU, OAHU, HAWAII**

I. AGENCY PROPOSING THE ACTION

City and County of Honolulu
Department of Design and Construction
650 South King Street
Honolulu, Hawaii 96813

II. APPROVING AGENCY

City and County of Honolulu
Department of Design and Construction
650 South King Street
Honolulu, Hawaii 96813

III. AGENCIES, ORGANIZATIONS, AND INDIVIDUALS CONSULTED

The following agencies, organizations, and individuals were consulted prior to or during the preparation of the Draft Environmental Assessment (DEA):

Department of Land and Natural Resources
Commission on Water Resource Management
Department of the Army, Corps of Engineers, Pacific Ocean Division
The Gas Company
Hawaiian Electric Company
Office of Environmental Quality Control
Residents/Property Owners of TMK: 3-4-03: 10 and 36

Subsequently, the DEA was circulated to various parties during the public review period (refer to Section XII for listing of parties). Appendix A contains letters received during the DEA 30-day review period and copies of responses to the comments.

IV. GENERAL DESCRIPTION OF THE PROPOSED ACTION

A. NEED FOR THE PROJECT

Pooleka Street is a city-owned right-of-way located in Palolo Valley (refer to Figures 1 and 2). Stormwater presently concentrates at the southwest corner of Pooleka Street and discharges by way of surface flow through a 10-foot wide easement (in favor of the City and County of Honolulu), terminating at the end of the easement into a residential property, TMK: 3-4-03: 10. Additional surface runoff is contributed by adjacent properties (TMK: 3-4-03: 13, 15, 17, 29, 31-36 and 45).

The Pooleka Street Drainage Improvement Project is being proposed as a result of drainage complaints by residents of Parcel 10, TMK: 3-4-03 (hereafter referred to as Parcel 10). Surface runoff from the City and County drainage easement terminating at their property sheet flows across their lot and under a post and pier house foundation. In addition to the general nuisance of localized flooding, the surface flow has disqualified any termite treatment warranty on their property. Termite damage has also resulted because of the dampness caused by the runoff.

Records indicate the installation of a drainline to handle runoff from Pooleka Street and designation of the 10-foot wide easement were conditions of subdivision approval stipulated by the City and County of Honolulu Department of Planning in 1969. However, the subdivider, the State of Hawaii, lacked funds for construction of drainage improvements. As a result, final subdivision approval was granted in 1970, creating the easement without installation of the drainline. Parcel 10 is presently owned by the State of Hawaii, under the Department of Land and Natural Resources, and is being leased to the resident homeowner.

B. TECHNICAL CHARACTERISTICS

The City and County of Honolulu proposes to construct an underground drainage system off Pooleka Street to alleviate sheet flow occurring in Parcel 10 (refer to Figure 3). This alternative was developed following field investigations and interviews with affected property owners and nearby residents. As shown in Figure 4, the system will be designed for a drainage area of 1.83 acres and 50-year storm flow of 11.2 cubic feet per second (CFS), which will satisfy current City and County Storm Drainage Standards (January, 2000).

The proposed improvements will be designed in accordance with City standards and specifications. The system will include drain inlets at the end of Pooleka Street which will collect runoff from Pooleka Street (refer to Figure 5). The inlets will be connected by 18-inch diameter reinforced concrete pipe running through the existing easement and into a third inlet structure. This structure will collect

surface runoff from the lots adjoining the easement. Flow from the structure will then be piped through another 18-inch line to an outlet headwall at the edge of Parcel 10 above the Waiomao Stream bank (refer to Figures 6 and 7). The stream's top of bank in this region is approximately 5 feet below the proposed discharge point. The proposed drainage system will include the following:

- 460 linear feet (LF) of 18-inch diameter reinforced concrete pipe (RCP)
- Three (3) grated inlets
- Three (3) manholes
- Headwall outlet structure above the bank of Waiomao Stream

The project is likely to require relocation of a utility pole and two water laterals at the end of Pooleka Street (refer to Figure 5). In addition, the last 10 LF of the existing water main serving Pooleka Street will be cut and plugged.

Zoning of the proposed project site is Residential (R-5) based on the City and County of Honolulu Land Use Ordinance. The State Land Use Map classifies the project site as Urban. The proposed drainage alignment discussed above does not enter Shoreline Setback or Special Management Areas. However, the project will require approval of an easement for drainage purposes in favor of the City and County of Honolulu through Parcel 10 from the Board of Land and Natural Resources.

C. ECONOMIC

The construction cost for the drainage improvements is estimated at \$190,000 (refer to Appendix for Preliminary Cost Estimate). This will be funded by the City and County of Honolulu; however, appropriation of City funds for construction is still pending.

D. SOCIAL

The primary focus of the proposed project is to direct surface runoff through a definitive underground system so as to alleviate and prevent flooding in the vicinity of Pooleka Street and Parcel 10 (TMK: 3-4-03: 10). The proposed underground drainage system will convey runoff to nearby Waiomao Stream, generally following the natural drainage pattern.

E. ENVIRONMENTAL CHARACTERISTICS

1. Flood, Erosion, and Geological Characteristics

The project site is located in an area designated as Zone X on the Flood Insurance Rate Map (Map No. 15003C0370 E, effective November 20, 2000), which is outside the 500-year flood plain (refer to Figure 8).

The Soil Survey of the Islands of Kauai, Oahu, Maui, Molokai, and Lanai, State of Hawaii (U.S. Department of Agriculture Soil Conservation Service, 1972) identified the soils in the project site as Lualualei clay (LuA), consisting of a very sticky and plastic, dark grayish-brown clay. Permeability and runoff are slow. The erosion hazard is slight.

2. Archaeological and Historical Characteristics

There is reason to believe that there are no historic sites present at the proposed project site because residential development/urbanization has altered the land. Thus, no historic sites should be affected by the proposed action. However, if significant sites, including human burials, are uncovered during construction, the contractor will be required to stop work and contact the State Historic Preservation Division (SHPD) of the Department of Land and Natural Resources at 692-8015.

3. Cultural Characteristics

Two long-time residents discussed their knowledge of cultural/historical practices which may have occurred in the area. Both were aware of active farming in the valley and could recall the use of an 'auwai' system that had been used to enhance taro cultivation. However, there is no active or remnant evidence of the auwai system or its use today.

V. SUMMARY DESCRIPTION OF THE AFFECTED ENVIRONMENT

A. FLORA AND FAUNA

The proposed project site is located in a residential area that has been fully developed. Therefore, there are no anticipated impacts to endangered or rare species. The Department of Land and Natural Resources, Division of Aquatic Resources has also confirmed that while some temporary disturbance to the environment may occur during construction, no significant long-term impact to aquatic resources is expected (May 2002).

B. SURFACE WATER QUALITY

Because the City will not be altering the topography and size of the drainage basin, the proposed project will not result in an increase or decrease of storm run-off into Waiomao Stream. Waiomao Stream is designated by the U.S. Geological Survey as a perennial stream. The State Department of Health's Water Quality Standards (Chapter 54 of Title 11, Hawaii Administrative Rules) classifies streams as inland water areas. Storm runoff itself will not contain any hazardous pollutants.

It is recognized that during construction surface water runoff has the potential to convey more sediment, but the contractor will be required to comply with project-specific Best Management Practices (BMPs).

C. TRAFFIC

Traffic along the short Pooleka Street will be of temporary inconvenience to motorists and pedestrians due to construction-related activities. Traffic control plans will be developed by a qualified civil engineer and submitted to the City and County of Honolulu Department of Planning and Permitting's Traffic Review Branch for review and approval.

D. AIR QUALITY

Air quality can be impacted by traffic volumes and temporary construction-related impacts. Since traffic volumes will remain essentially identical to current levels, no significant effects are anticipated.

With respect to construction-related impacts, licensed contractors are required to maintain construction equipment in proper working order to ensure no violations and are subject to enforcement actions if found in non-compliance. In addition, construction activities will satisfy requirement of Chapter 11-60.1, "Air Pollution Control," and Section 11-60.1-33, Fugitive Dust.

E. NOISE

Noise levels in this developed residential area are anticipated to be identical prior to and after project implementation. Noise related to construction activities are primarily controlled by hours of operation. All construction will be limited to daytime hours. Activities associated with the construction phase of the project will comply with the Chapter 46 of Title 11, Hawaii Administrative Rules, Community Noise Control.

F. WATER SYSTEMS

The public water service in the area is provided by the Board of Water Supply. No additional services will be required specifically for the proposed project; however, Part IV of the Palolo Water System Improvements involving Pooleka Street is scheduled by the Honolulu Board of Water Supply for 2008.

The last 10 feet of the existing 8-inch waterline serving Pooleka Street will be cut and capped. In addition, two existing water laterals at the end of Pooleka Street will be relocated or replaced. Construction plans will be routed to the Board of

Water Supply for review and approval during the design phase. In addition, construction activities will be scheduled so as to minimize or prevent disruption to existing water service.

G. SEWER SYSTEMS

The project will not require additional sewer service. Wastewater facilities (including manholes, sewers, etc.) will not be disturbed.

H. DRAINAGE SYSTEMS

The proposed underground drainage system will provide adequate hydraulic capacity which will significantly reduce sheet flow along the existing easement and in Parcel 10.

I. ELECTRIC/CABLE UTILITIES

The project area is currently served by the Hawaiian Electric Company's (HECO) overhead electrical lines. Additional electrical or cable service will not be required for this project.

There is the possibility that an overhead utility pole may need to be relocated to accommodate the new drainline. Any work requiring temporary or permanent relocation will be coordinated among the City, its consultant and the utilities involved.

J. GAS MAINS

The Gas Company maintains underground gas mains in the project vicinity, which serve residential and commercial customers in the area and is interconnected with the utility network in Palolo. Additional gas service will not be required for this project.

VI. SUMMARY OF MAJOR IMPACTS

A. SHORT-TERM

The actual construction phase of the project will cause disruption of every day routine activities in the area. This could affect access to properties, increase traffic congestion and construction-related nuisances including increased sediment runoff during storm runoff events and increased noise levels. In addition, the visual appearance of construction barriers and scarred pavement including metal plates is aesthetically unappealing. However, these impacts by definition are short-term.

B. LONG-TERM

The only identifiable long-term impact is considered to be related to the benefits of the project which will permanently reduce sheet flow in the existing easement and Parcel 10.

VII. ALTERNATIVES CONSIDERED

In addition to the proposed action described above, the No Action (forego construction of the drainage improvements) alternative was considered. Under the No Action alternative, runoff would continue to sheet flow from the low end of Pooleka Street through the existing drainage easement and into Parcel 10 (TMK: 3-4-03: 10). This would continue to inconvenience the property owners of Parcel 10 and further deteriorate their house structure. In addition, the property owners adjacent to the easement (TMK: 3-4-03: 22, 24, 25, 32, 33, 36 and 37) would continue to be exposed to surface runoff because the easement was not designed to handle such conditions. *This alternative is not an acceptable course of action because it exposes the public to unacceptable risk every time it rains.*

VIII. MITIGATION MEASURES

A. CONSTRUCTION ACTIVITIES

During construction, normal requirements for mitigation of construction impacts will be utilized. These requirements include traffic control, compliance with BMP requirements, compliance with hours prescribed for construction to minimize noise impacts, and compliance with businesses and their normal hours of operation through direct contact. Proposed BMPs are as follows:

1. All loose material and small tools and equipment will be removed from the construction site after each work day is completed.
2. City-approved area(s) away from the stream bed to store or stockpile construction-related materials and equipment will be designated prior to the start of construction.
3. Removed vegetation, debris and unsuitable excavated materials will be properly disposed at a site approved by the City.
4. All hazardous or toxic waste will be disposed of in the manner specified by federal, state or local regulations or the manufacturer.

5. All sanitary waste from portables will be collected and disposed of properly.
6. All solid waste from the site will be stored in a securely lidded dumpster within or adjacent to the project site. The dumpster will be emptied as needed, at least on a daily basis, and the trash will be hauled to a City-approved site.
7. Any debris and other deleterious material will be contained and prevented from entering State waters.
8. Materials to be placed in State waters will be free of waste metal products, organic materials, petroleum products, objectionable debris and any other pollutants at concentrations toxic or potentially hazardous to aquatic life.
9. Silt curtains will be installed downstream of the working area should there be any flow in Waiomao Stream (refer to Figure 9).
10. Visual monitoring will be performed by the contractor on a daily basis or following any storm event. The contractor will inspect all control measures including silt curtains to ensure that they are maintained in good working condition. Necessary repairs will be initiated by the contractor within 24 hours of notification or observation.
11. Rocks, soil or debris will not be allowed to fall, slide or flow onto adjoining properties.
12. Exposed surfaces will be kept well watered whenever feasible. At the end of each work day, the project site will be sufficiently damp so as to remain moist overnight.
13. Areas denuded of vegetation will be appropriately stabilized to reduce susceptibility to erosion by water or wind.
14. Construction will be done during dry weather so that there is low or no flows in Waiomao Stream. The contractor will be required to temporarily suspend work during periods of heavy rain. All erosion control measures will be inspected following any storm event.
15. Equipment shall be inspected daily to ensure that oil leaks do not occur. Equipment shall be stored away from the ditch or stream bed. Fueling and lubricating of equipment and motor vehicles will be conducted away from the ditch and in a manner to protect against spills and evaporation. Lubricants and excess oils will be disposed of in accordance with applicable federal, state and local regulations.

In addition, utility services should not be disrupted during construction activities. The contractor will be required to verify utility locations, protect utilities during construction and ensure no interruption of services of all utilities in the vicinity of the project site during construction. Access to fire apparatus will be maintained throughout the construction site and any interruption to the existing fire hydrant system during construction will be reported to the Fire Department at 523-4411 by the contractor.

B. LONG-TERM OPERATION

Currently there are no mitigation plans, since it is believed the total project benefits are in concert with the community's vision and the City's policy of properly disposing of runoff generated on its streets.

IX. PERMITS REQUIRED FOR PROJECT

A. U.S. GOVERNMENT

Department of the Army (DA) Permit*	USACE
-------------------------------------	-------

B. STATE OF HAWAII

Community Noise Control Permit	DOH
Stream Channel Alteration Permit	DLNR
Water Quality Certification*	DOH

C. CITY AND COUNTY OF HONOLULU

Building Permit	DPP
Grading Permit	DPP
Trenching Permit	DPP
Street Usage Permit	DTS

* The U.S. Army Corps of Engineers Regulatory Branch responded after the Draft Environmental Assessment 30-day public review period. They were unable to determine whether a DA permit would be necessary pending a field investigation. If a DA Permit is required, an application will be filed by the City and County of Honolulu for the proposed project. The DA Permit would also necessitate a Section 401 Water Quality Certification (WQC) from the Department of Health. A WQC application would also be filed by the City.

X. FINDINGS AND REASONS TO SUPPORT THE DETERMINATION

It is anticipated that the proposed project will not significantly impact the environment, and therefore a Finding of No Significant Impact (FONSI) is anticipated. It is not anticipated that the preparation and processing of an Environmental Impact Statement will be required for this project. This statement of findings is based on an evaluation of the significance criteria listed in HAR, Chapter 11-200-12b, as described below:

- a. ***The project will not involve an irrevocable commitment to loss or destruction of any natural or cultural resources.***

The site is already fully developed and no significant natural or cultural resources are expected to be encountered since the project scope calls for modification of existing man-made infrastructure with no disturbance of lands which were previously undisturbed.

- b. ***The project will not curtail the range of beneficial uses of the environment.***

The proposed project is solely intended to enhance the existing beneficial uses of the urban center.

- c. ***The project will not conflict with the State's long-term environmental policies or goals and guidelines as expressed in Chapter 344, Hawaii Revised Statutes, and any revisions thereof and amendments thereto, court decisions or executive orders.***

The project will not conflict with the environmental policies as set forth in the State Plan and Chapter 344, Hawaii Revised Statutes (HRS) in that the project will not damage sensitive natural resources nor emit contaminants.

- d. ***The project will not substantially affect the economic or social welfare of the community or State.***

There may be some negative short-term economic and social impacts as related to construction (traffic congestion, blockage of street frontage and noise, etc.). However, the long-term benefit related to public safety of property owners adjacent to the existing drainage easement off Pooleka Street is considered positive.

- e. ***The project will not substantially affect public health.***

No impact on Public Health is anticipated. Increased safety is considered positive.

- f. ***The project will not involve substantial secondary impacts, such as population change or effects on public facilities.***

The project will not influence population change nor impact on existing infrastructure.

- g. ***The project will not involve a substantial degradation of environmental quality.***

Environmental quality will be essentially the same as that which exists prior to project implementation. The project consists of underground improvements within an existing developed residential area with discharge of storm runoff into a perennial stream.

- h. ***The project is individually limited and will not cumulatively have a considerable effect upon the environment nor involves a commitment for larger actions.***

The proposed drainage system is limited to Pooleka Street and will not result in the requirement of other actions.

- i. ***The project will not substantially affect a rare, threatened or endangered species, or its habitat.***

The project area is limited to an existing developed residential area which is not known to sustain any habitats of threatened or endangered species.

- j. ***The project will not detrimentally affect air quality, water quality or ambient noise levels.***

Short-term impacts may occur during the construction of the project. However, the contractor must comply with current Department of Health regulations and must adhere to and provide Best Management Practices (BMP) practices.

- k. ***The project will not affect an environmentally sensitive area such as a flood plain, tsunami zone, erosion-prone area, geologically hazardous land, estuary, fresh water, or coastal waters.***

The project site is not located in any sensitive area.

- l. ***The project will not substantially affect scenic vistas or view lanes as identified in County or State plans or studies.***

The proposed drainage improvements will be constructed on or under the ground and will not have any effect on scenic vistas or view planes.

m. *The proposed project will not require substantial energy consumption.*

The only energy consumption involved with this project is that related to construction activities. After construction completion, energy consumption will essentially return to that which existed prior to construction.

XI. SUMMARY OF UNRESOLVED ISSUES

There is one unresolved issue that was raised subsequent to the DEA 30-day public review period comment. This issue involves the uncertainty surrounding the need for a Department of the Army (DA) Permit for the proposed action. If the U.S. Corps of Engineers determines that the proposed system will require a DA Permit, one will be obtained prior to the start of construction. In addition, the DA Permit would necessitate the need for a Section 401 Water Quality Certification from the Department of Health.

XII. LIST OF AGENCIES, ORGANIZATIONS OR PRIVATE INDIVIDUALS THAT WERE NOTIFIED DURING THE PUBLIC COMMENT PERIOD

The following is a list of government agencies, organizations or individuals that were notified regarding the 30-day public comment period for the Draft EA. Comments were not received from all agencies, organizations and individuals. Copies of substantive comments and responses are provided in Appendix A.

City and County of Honolulu

Board of Water Supply
Department of Environmental Services
Facilities Maintenance Department
Fire Department
Department of Parks and Recreation Services
Department of Planning and Permitting
Police Department
Department of Transportation Services

State of Hawaii

Department of Business, Economic Development and Tourism
Department of Land and Natural Resources (DLNR)
DLNR Commission on Water Resource Management
DLNR Historic Preservation Division
DLNR Land Division
Department of Health
Office of Hawaiian Affairs

Federal Government

U.S. Army Corps of Engineers, Honolulu Engineer District

Utilities

The Gas Company
Hawaiian Electric Company
Oceanic Cable
Verizon Hawaii

Community Groups/Business/Others

Palolo Neighborhood Board Neighborhood Board No. 6
Kaimuki Public Library
Council Member Duke Bainum
Residents of Pooleka Street

XIII. LIST OF PERSONS, FIRMS OR AGENCIES THAT PREPARED THIS ASSESSMENT

The following list identifies the persons, firms, and government agency involved with the preparation of the environmental assessment for the proposed action.

- | | |
|--|---------------------|
| 1. David B. Bills, Senior Vice President
Gray, Hong, Bills, Nojima & Associates, Inc. | EA Project Manager |
| 2. Gregory Sue, Civil Engineer
Department of Design and Construction
City and County of Honolulu | Project Coordinator |

REFERENCES

City and County of Honolulu, Department of Planning and Permitting, January 2000, Rules Relating to Storm Drainage Standards.

U.S. Department of Agriculture Soil Conservation Service, 1972, Soil Survey of Islands of Kauai, Oahu, Maui, Molokai, and Lanai, State of Hawaii.

FIGURES

FIGURE 1 - VICINITY MAP

FIGURE 2 - LOCATION MAP

FIGURE 3 - PROJECT SITE PLAN

FIGURE 4 - HYDROLOGIC MAP

FIGURE 5 - PRELIMINARY PLAN AND PROFILE

FIGURE 6 - OUTLET STRUCTURE

FIGURE 7 - PHOTOS AT PARCEL 10 (TMK: 3-4-01:10)

FIGURE 8 - FLOOD HAZARD MAP

FIGURE 9 - SILT CURTAIN DETAIL

TRUE NORTH

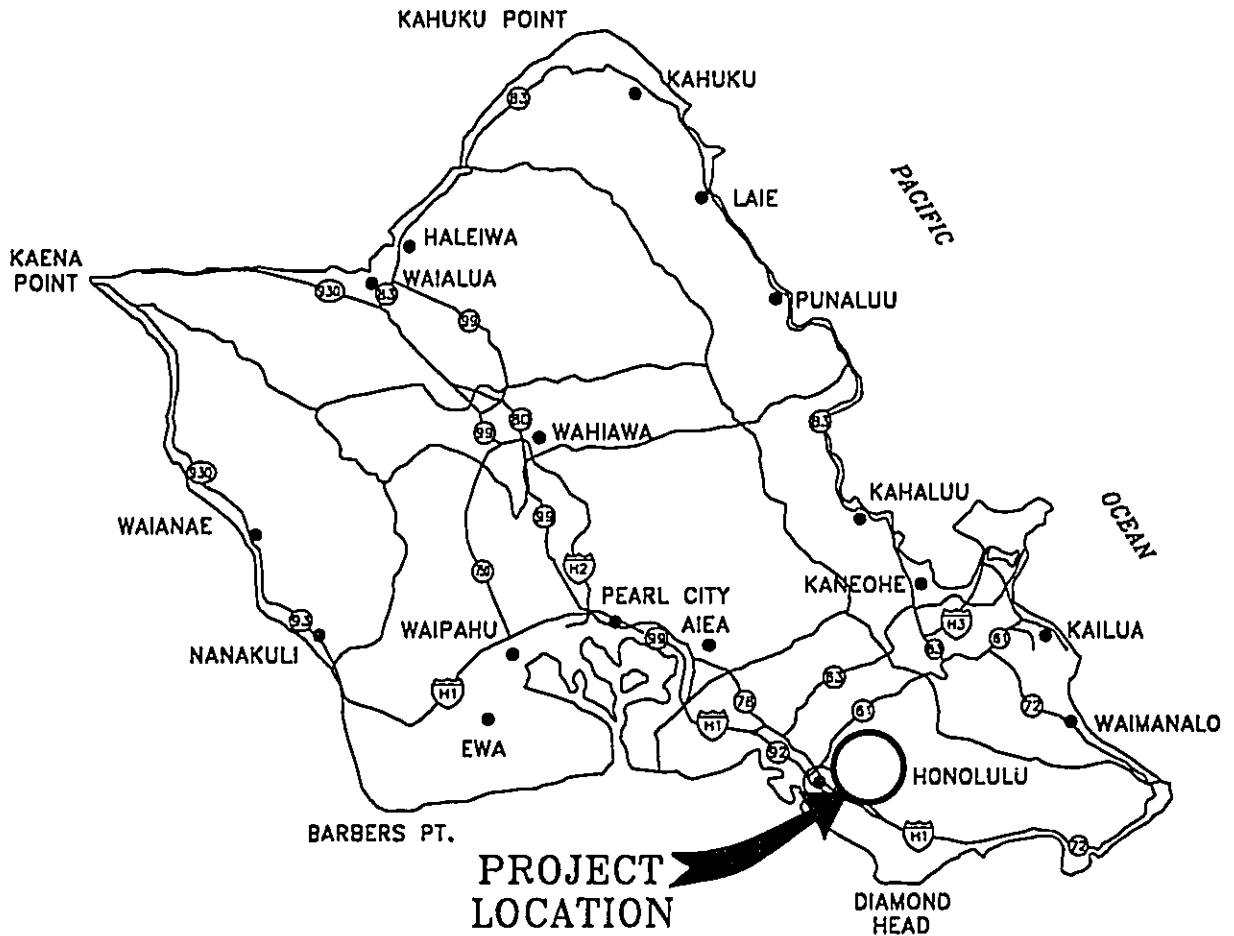

PREPARED FOR:
 City and County of Honolulu
 Pooleka Street Drainage Improvements
 Palolo, Honolulu, Oahu, Hawaii

VICINITY
 MAP



Gray-Hong-Bills-Nojima & Associates, Inc
 CONSULTING ENGINEERS
 841 Bishop Street Suite 1100

FIGURE
 1

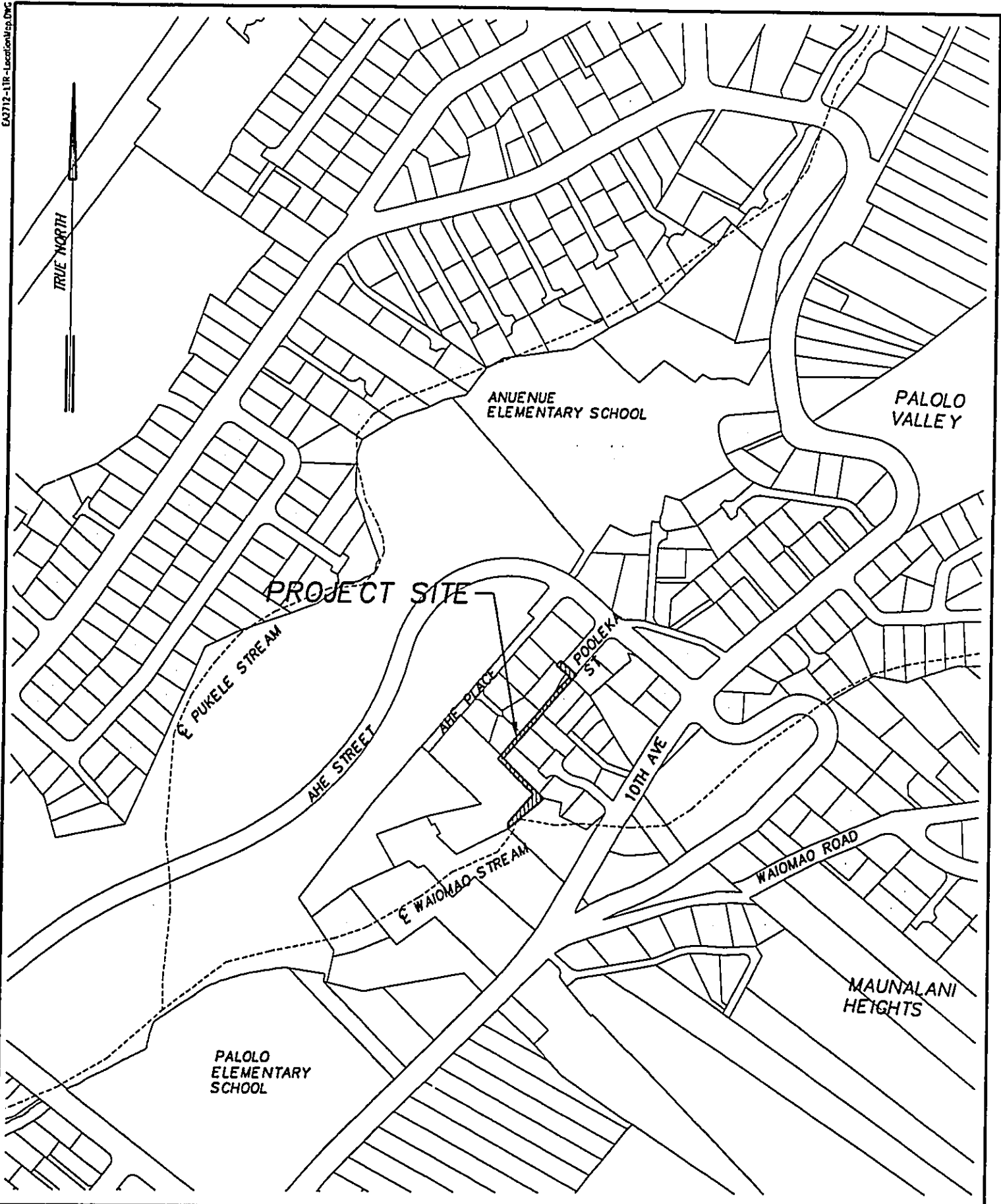

PREPARED FOR:
 City and County of Honolulu
 Pooleka Street Drainage Improvements
 Palolo, Honolulu, Oahu, Hawaii

LOCATION
 MAP





 Gray-Hong-Bills-Nojima & Associates, Inc
 CONSULTING ENGINEERS
 841 Bishop Street Suite 1100

FIGURE
 2

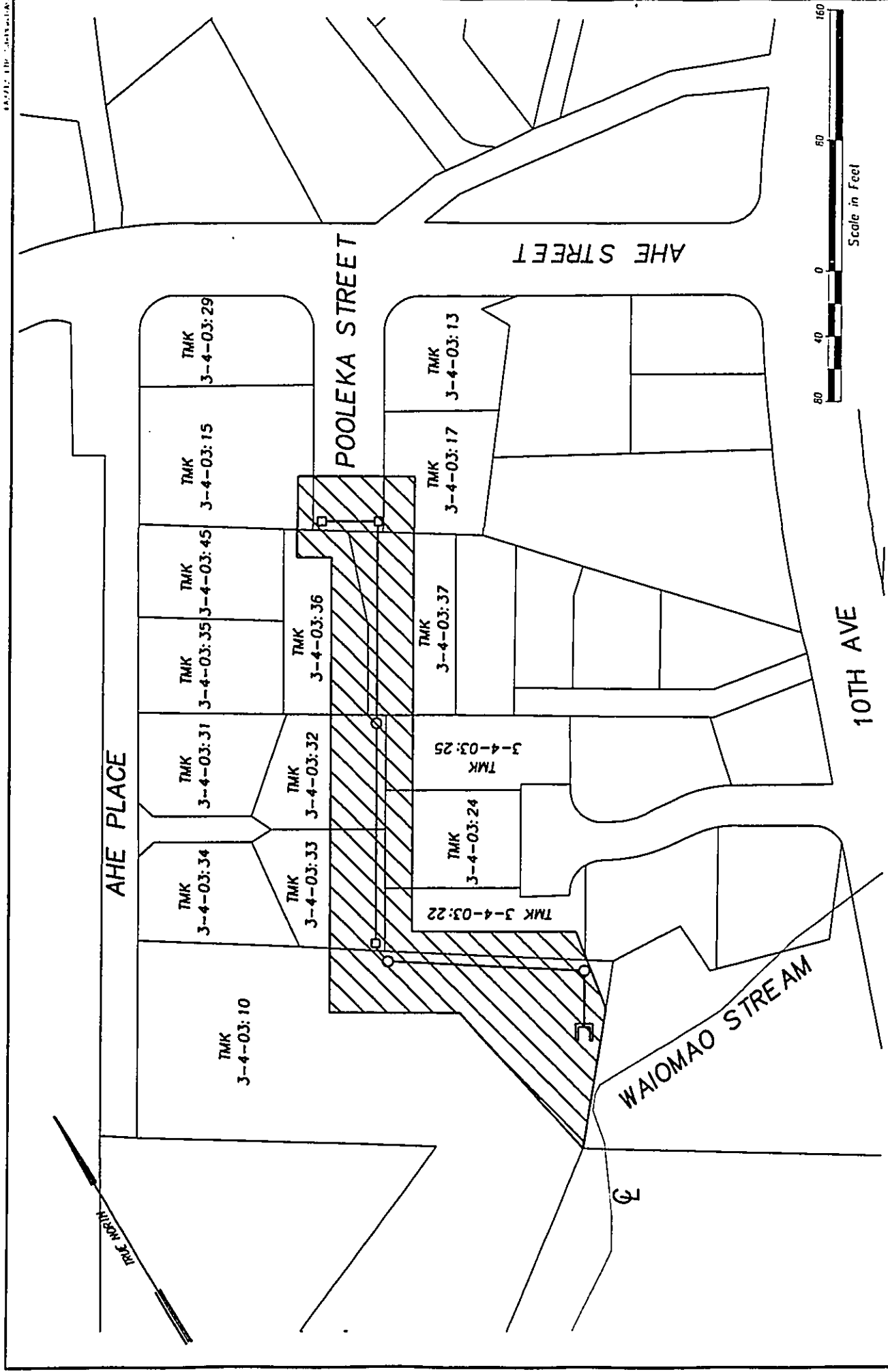

<p>FIGURE 3</p>	<p>PREPARED FOR: City and County of Honolulu Pooleka Street Drainage Improvements Pololo, Honolulu, Oahu, Hawaii</p>	<p>PROJECT SITE PLAN</p>	 <p>Gray-Hong-Bills-Nojima & Associates, Inc CONSULTING ENGINEERS 841 Bishop Street Suite 1100</p>
----------------------------	--	--------------------------	---

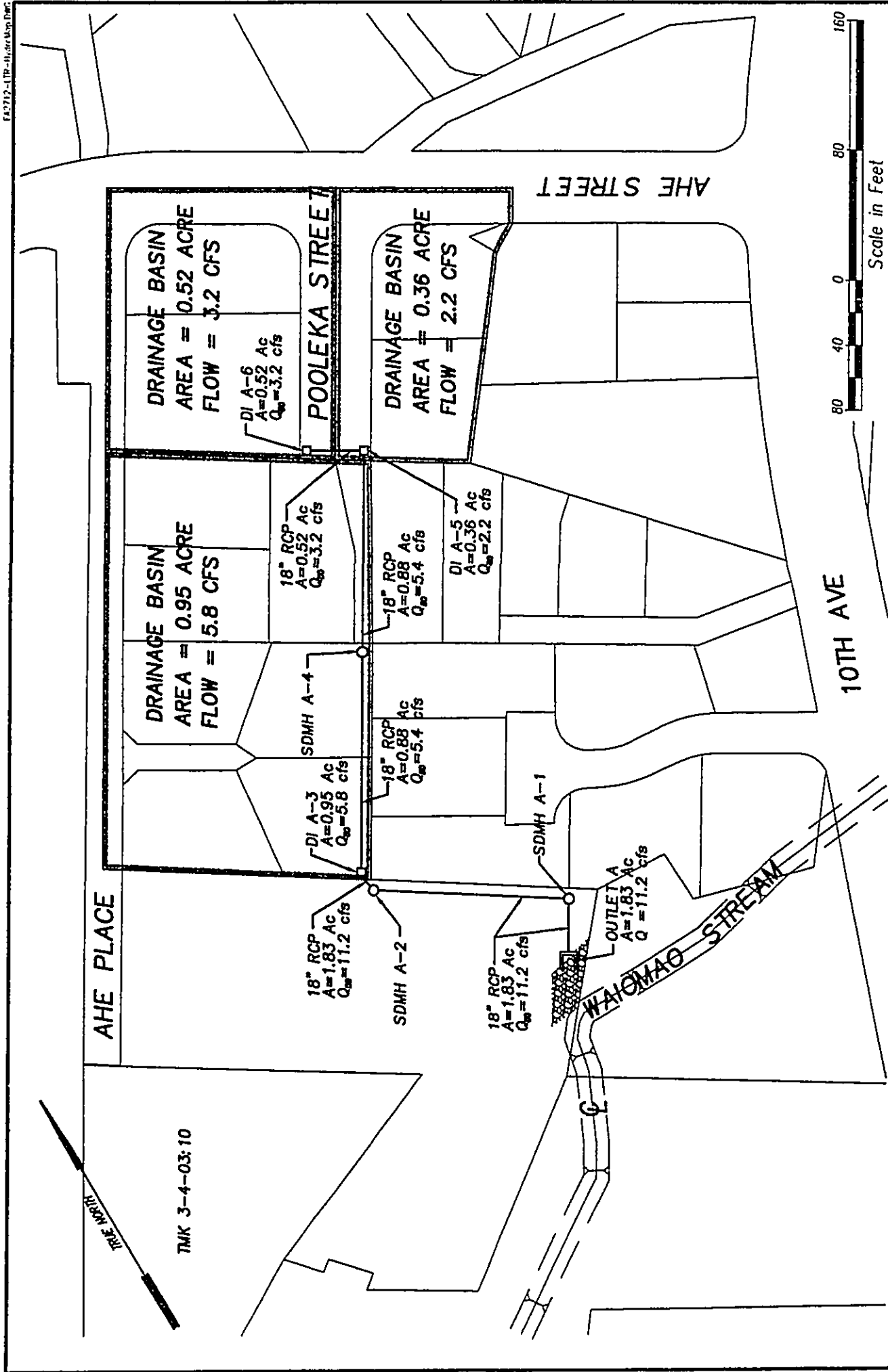

<p>FIGURE 4</p>	<p>PREPARED FOR: City and County of Honolulu Poolaka Street Drainage Improvements Pololo, Honolulu, Oahu, Hawaii</p>	<p>HYDROLOGIC MAP</p>	 <p>Gray-Hong-Bills-Nojima & Associates, Inc CONSULTING ENGINEERS 841 Bishop Street Suite 1100</p>
-----------------------------------	---	---	---

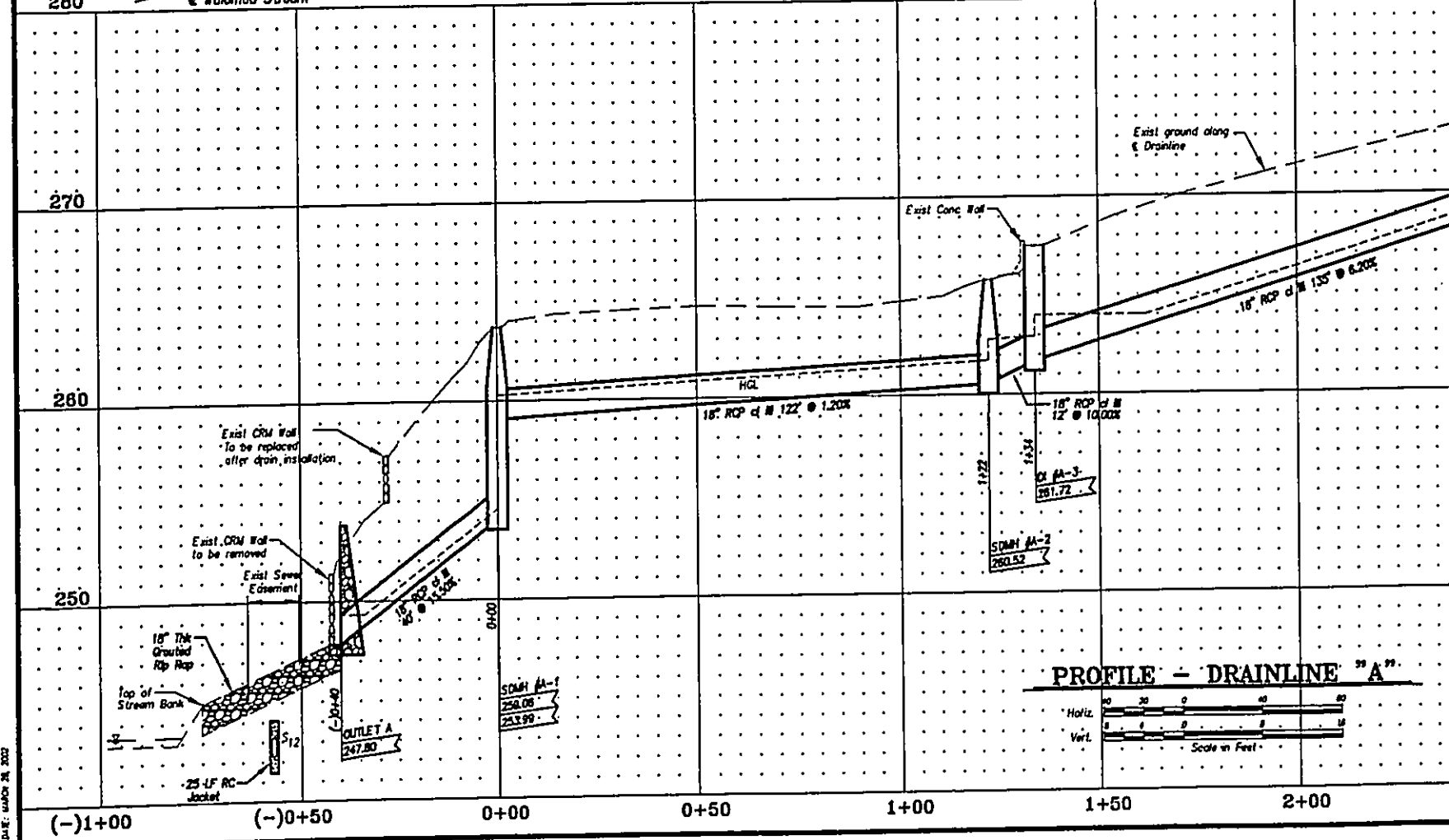
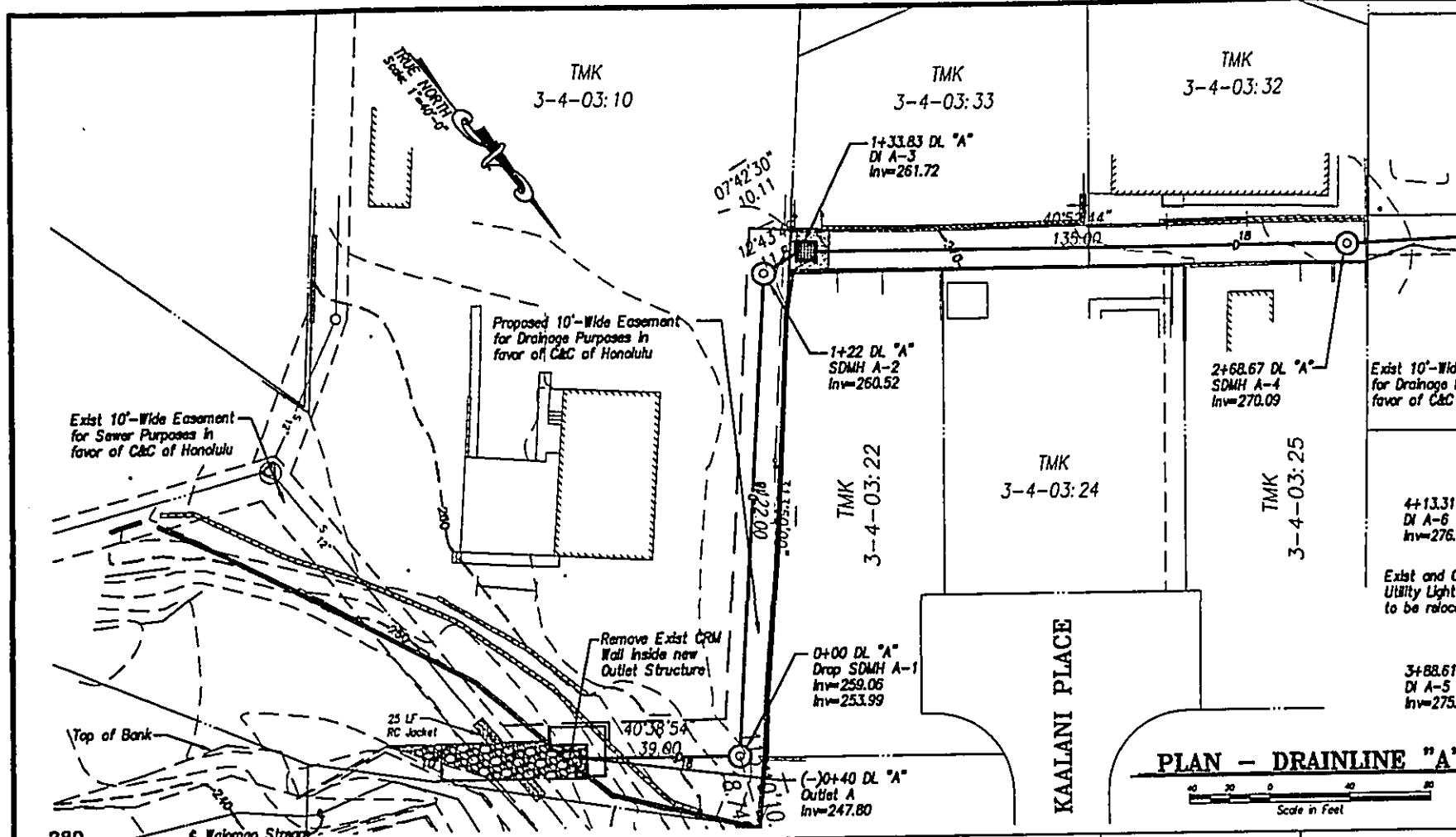

DATE: MARCH 24, 2003

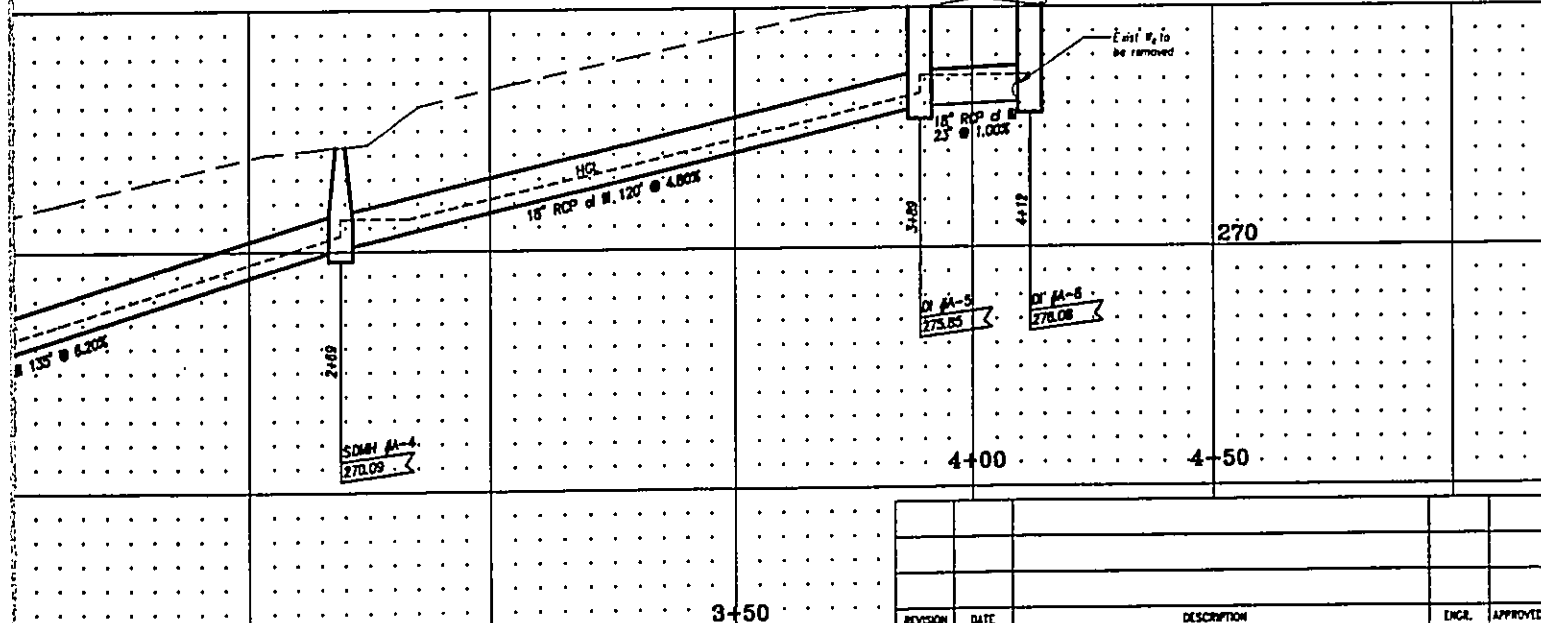
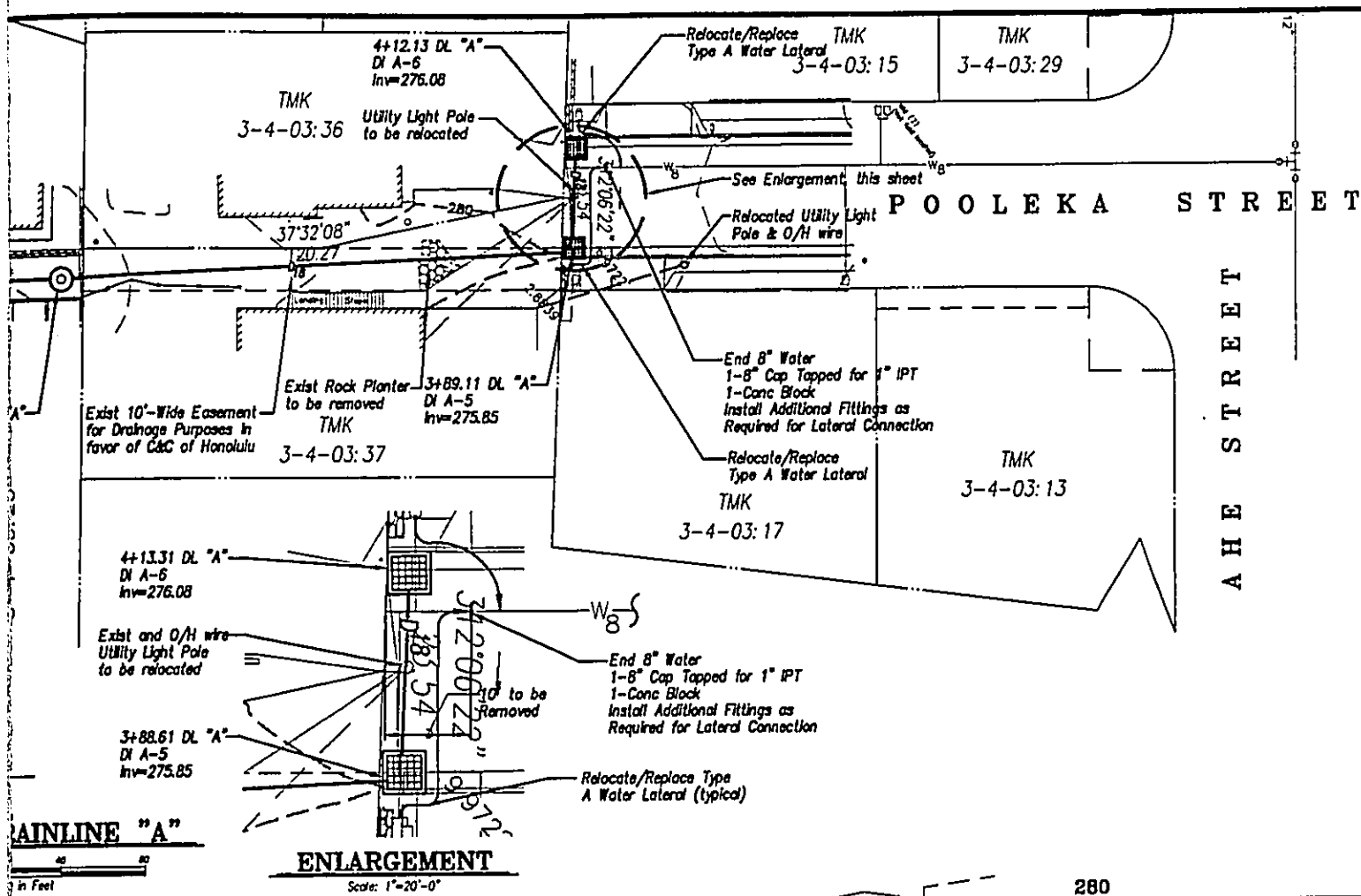

REVISION	DATE	DESCRIPTION	ENGR.	APPROVE

DAVID B. BILLS
LICENSED PROFESSIONAL ENGINEER
No. 4810-C
HAWAII, U.S.A.

DEPARTMENT OF DESIGN AND CONSTRUCTION
CITY AND COUNTY OF HONOLULU
CIVIL DESIGN AND ENGINEERING DIVISION

POOLEKA STREET DRAINAGE IMPROVEMENTS

WAIKMAO, PALOLO VALLEY, HONOLULU, OAHU, HAWAII

PRELIMINARY PLAN AND PROFILE - DRAINLINE 'A'
STA. (-)0+40 TO STA. 4+23

DESIGN: BN
DRAWN: LB
CHECKED: -
DATE: 8-28-02

APPROVED: _____
CHIEF, CIVIL DESIGN & ENGINEERING DIV., CDC

FILE _____ DRAW _____ FOLDER _____ NUMBER _____

5
SHEET -
OF - SHEETS

GRAY, HONG, BILLS, HOJIMA & ASSOCIATES, INC.
CONSULTING ENGINEERS
841 BISHOP STREET SUITE 1100

E2712-LTR-04/14.DWG

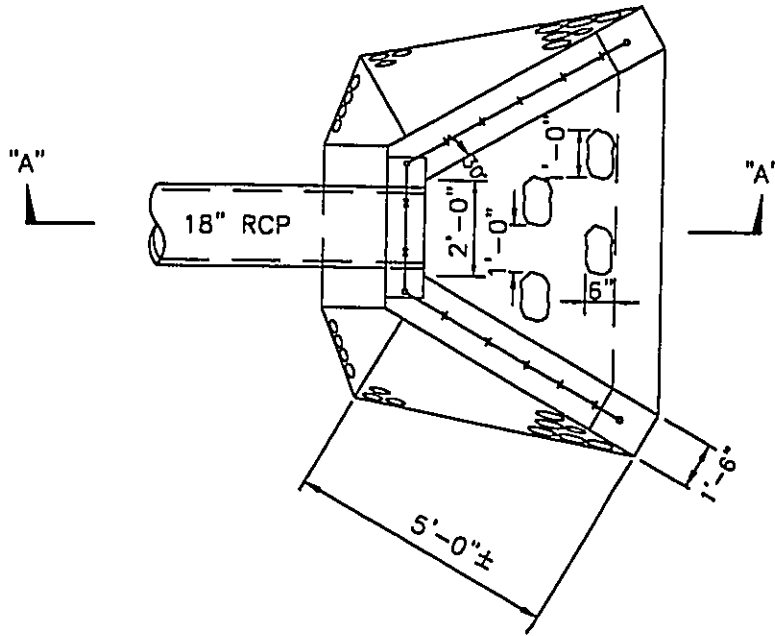

PLAN

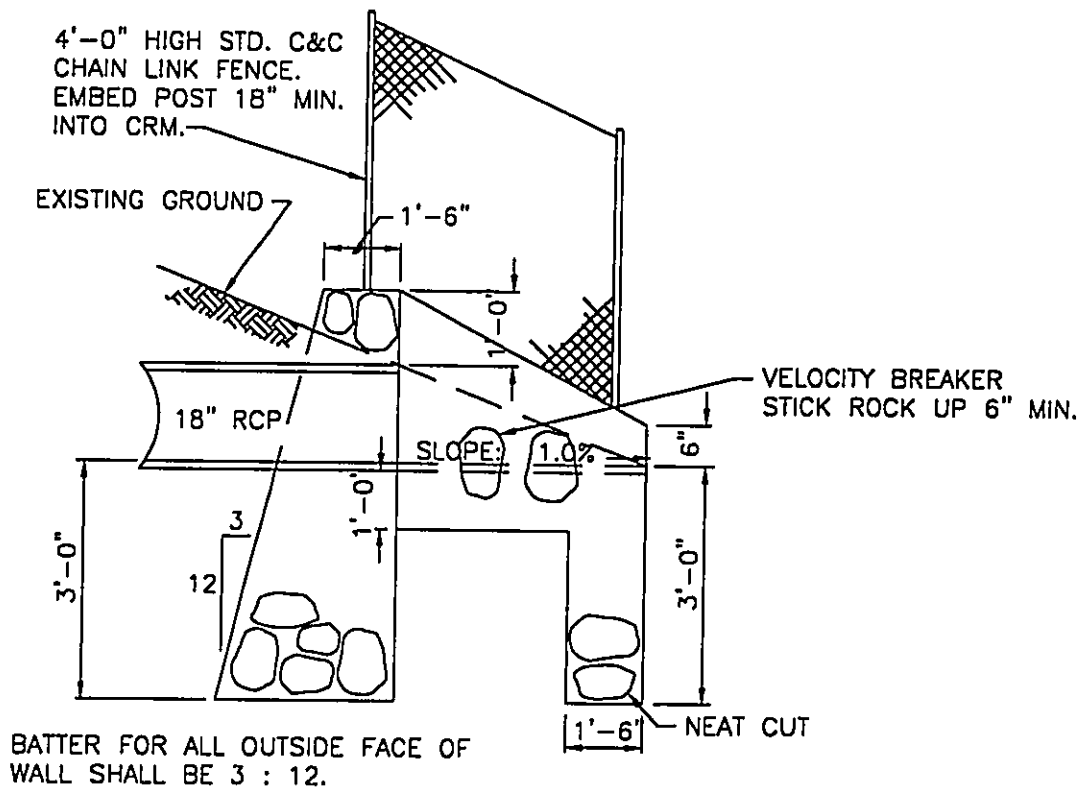

SECTION "A" - "A"

OUTLET STRUCTURE

NOT TO SCALE

<p>PREPARED FOR: City and County of Honolulu Pooleka Street Drainage Improvements Palolo, Honolulu, Oahu, Hawaii</p>	<p>OUTLET STRUCTURE</p>	 <p>Gray-Hong-Bills-Nojima & Associates, Inc CONSULTING ENGINEERS 841 Bishop Street Suite 1100</p>	<p>FIGURE 6</p>
---	--------------------------------------	---	------------------------------

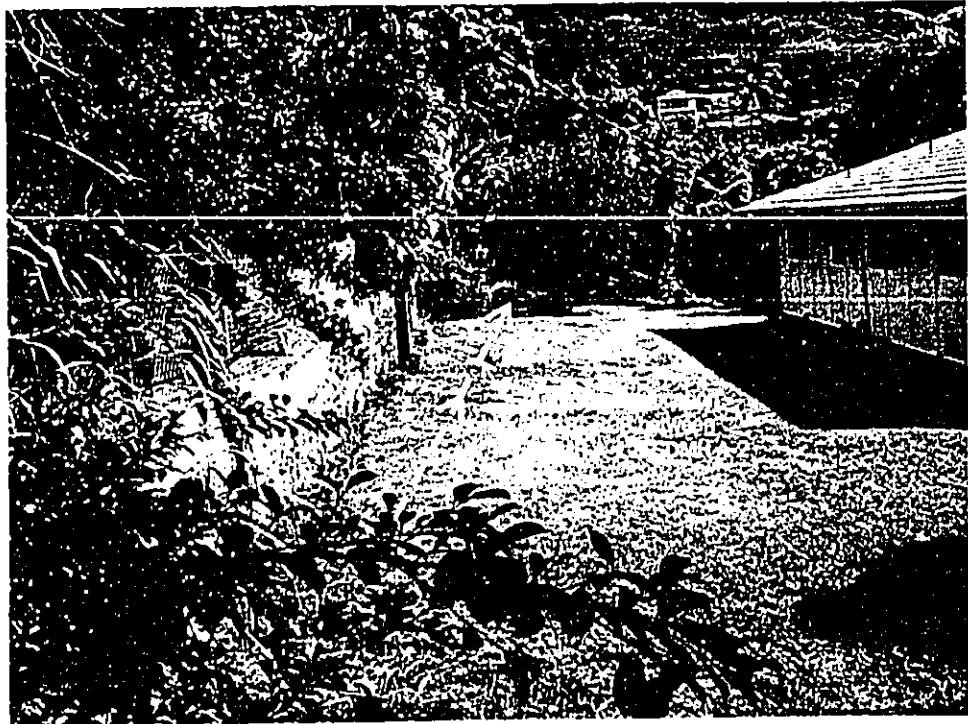



Photo Date: 11-12-2001



Photo Date: 1-31-2002

PREPARED FOR:
 City and County of Honolulu
 Pooleka Street Drainage Improvements
 Paialo, Honolulu, Oahu, Hawaii

PHOTOS AT PARCEL 10
 (TMK: 3-4-03:10)



Gray • Hong • Bills • Nojima & Associates, Inc
 CONSULTING ENGINEERS
 841 Bishop Street Suite 1100

FIGURE

7

LEGEND

SPECIAL FLOOD HAZARD AREAS INUNDATED BY 100-YEAR FLOOD

- ZONE A** no base flood elevations determined
- ZONE AE** Base flood elevations determined
- ZONE AH** Flood depths of 1 to 3 feet (usual area of parking); base flood elevation determined
- ZONE AD** Flood depths of 1 to 3 feet (usual area on highway, terraces, average depths determined); areas of about 100,000 sq. ft. vehicles also determined
- ZONE AV9** To be protected from 100-year flood by Federal Flood Protection system under construction; no base flood elevation determined
- ZONE V** Coastal flood with velocity hazard wave attack; no base flood elevation determined
- ZONE VE** Coastal flood with velocity hazard wave attack; base flood elevation determined

FLOODWAY AREAS IN ZONE AE

OTHER FLOOD AREAS

ZONE X Area of 500-year flood, area is 100-year flood with average depth of less than 1 foot or with drainage area less than 1 square mile; and area protected by levees from 100-year flood

OTHER AREAS

ZONE X Area determined to be suitable for development

ZONE D Area in which flood hazard is unmitigated

UNDEVELOPED COASTAL BARRIERS



Mitigated (RM)
 Coastal barrier areas are normally located within or adjacent to Special Flood Hazard Areas

FLUORPLAN BOUNDARY

FOOTWAY BOUNDARY

ZONE D BOUNDARY

Boundary Distinguishes 100 Year Flood Zones and Hazardous Coastal Areas from Other Coastal Areas
 Boundary Distinguishes Special Flood Hazard Zones

Base Flood Elevation Line
 Elevation in Feet See Map Index for Elevation Datum

Cross Section Line

Base Flood Elevation in Feet Where Uniform Within Zone See Map Index for Elevation Datum
 Elevation Reference Mark

IEL 9871

RM7 X

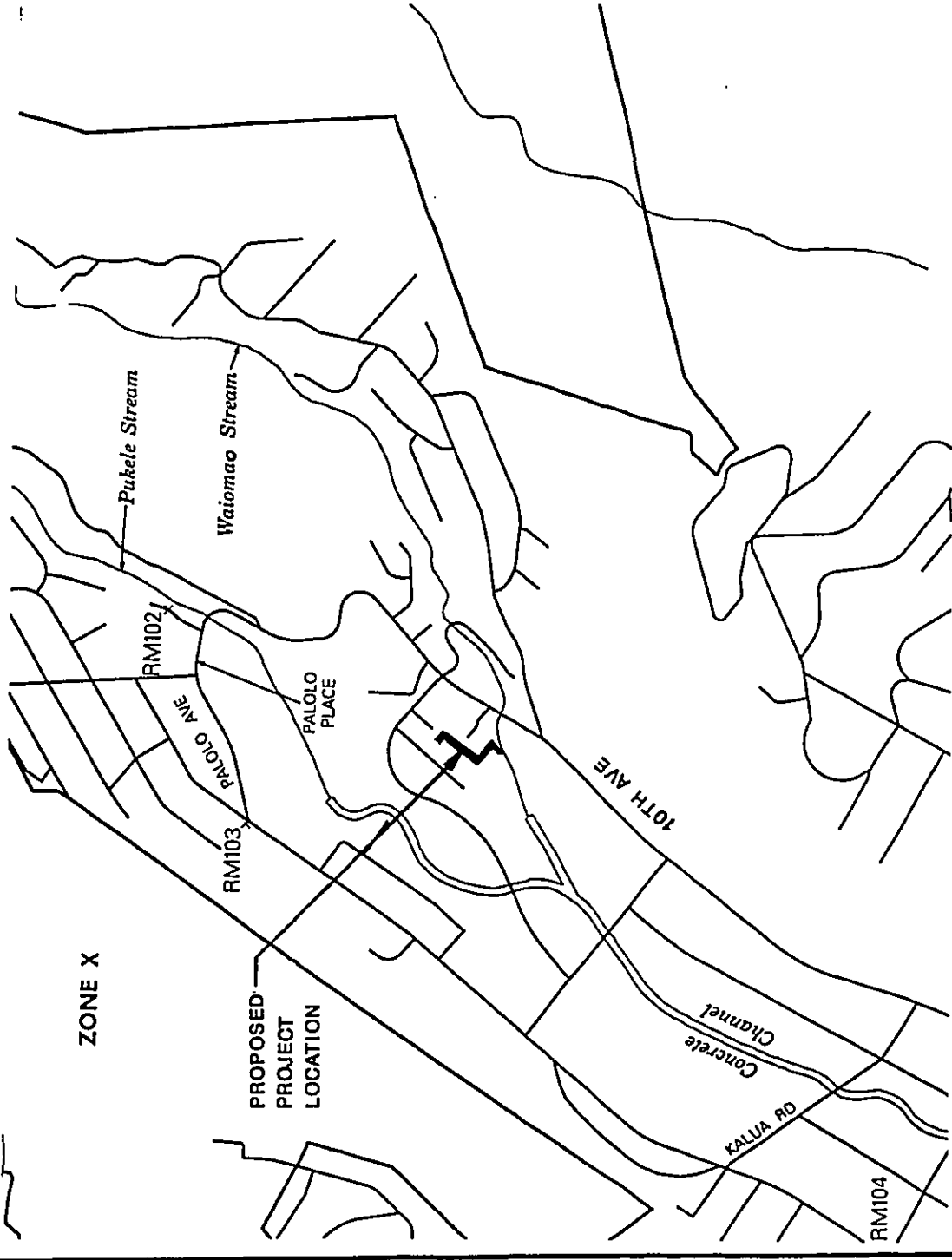

REFERENCE:
 FEDERAL EMERGENCY MGMT. AGENCY
 FLOOD INSURANCE RATE MAP
 PANEL NUMBER 15003C0370E, NOV. 20, 2000



Gray-Hong-Bills-Notjima & Associates, Inc
 CONSULTING ENGINEERS
 841 Bishop Street Suite 1100

FLOOD HAZARD MAP

PREPARED FOR:
 City and County of Honolulu
 Pooleka Street Drainage Improvements
 Palolo, Honolulu, Oahu, Hawaii

FIGURE
 8

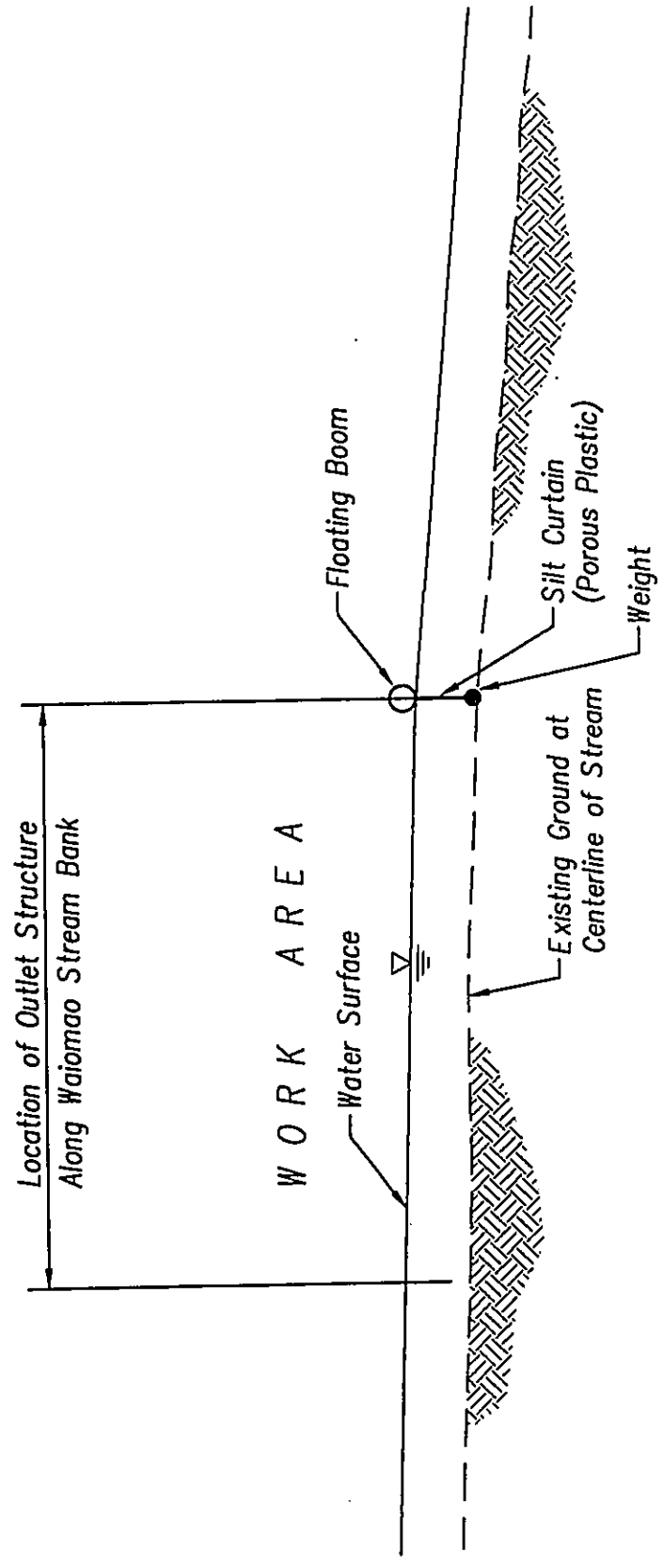

NOTE:
Silt Curtain Shall Extend From Edge to Edge of Stream.

SILT CURTAIN DETAIL
Not to Scale

<p>FIGURE 9</p>	<p>PREPARED FOR: City and County of Honolulu Pooleka Street Drainage Improvements Palolo, Honolulu, Oahu, Hawaii</p>	<p>SILT CURTAIN DETAIL</p>	 <p>Gray-Hong-Bills-Nojima & Associates, Inc CONSULTING ENGINEERS 841 Bishop Street Suite 1100</p>
----------------------------	--	----------------------------	---

APPENDIX A

**COMMENTS AND RESPONSES ON
DRAFT ENVIRONMENTAL ASSESSMENT**

BENJAMIN J. CATTEAO
GOVERNOR OF HAWAII



STATE OF HAWAII
DEPARTMENT OF HEALTH
P.O. BOX 3378
HONOLULU, HAWAII 96801

BRUCE E. ANDERSON, M.D., M.P.H.
DIRECTOR OF HEALTH

Priority phone calls to
Fax
02-1077epo

May 29, 2002

Mr. David B. Bills
Gray, Hong, Bills, Nojima & Associates, Inc.
841 Bishop Street, Suite 1100
Honolulu, Hawaii 96813

Dear Mr. Bills:

Subject: Draft Environmental Assessment (DEA)
Pooleka Street Drainage Improvements
Tax Map Key: 3-4-003: 10, 22, 24, 25, 33, 36 & 37.

Thank you for the opportunity to review and comment on the subject proposal. The DEA was routed to the various branches of the Environmental Health Administration. We have the following comments.

Clean Water Branch (CWB)

1. The applicant should contact the Army Corps of Engineers to identify whether a federal permit (including a Department of Army permit) is required for this project. A Section 401 Water Quality Certification is required for "Any applicant for Federal license or permit to conduct any activity including, but not limited to, the construction or operation of facilities, which may result in any discharge into the navigable waters..." pursuant to Section 401(a)(1) of the Federal Water Pollution Act (commonly known as the "Clean Water Act");

2. A National Pollutant Discharge Elimination System (NPDES) general permit coverage is required for the following discharges to waters of the State:

- a. Discharge of storm water runoff associated with industrial activities, as defined in Title 40, Code of Federal Regulations, Sections 122.26(b)(14)(i) through 122.26(b)(14)(ix) and 122.26(b)(14)(xi);
- b. Discharge of storm water runoff associated with construction activities that involve the disturbance of five (5) acres or greater, including clearing, grading, and excavation;

Mr. David B. Bills
May 29, 2002
Page 2

- c. Discharge of treated effluent from leaking underground storage tank remedial activities;
- d. Discharge of once through cooling water less than one million gallons per day;
- e. Discharge of hydro-testing water;
- f. Discharge of construction dewatering effluent;
- g. Discharge of treated effluent from petroleum bulk stations and terminals; and;
- h. Discharge of treated effluent from well drilling activities.

Any person requesting to be covered by a NPDES general permit for any of the above activities should file a Notice of Intent with the Department of Health, Clean Water Branch (CWB) at least thirty (30) days prior to commencement of any discharges to State waters;

- 3. If construction activities involve the disturbance of one acre or greater, including clearing, grading, and excavation, and will take place or extend after March 10, 2003, an NPDES general permit coverage is required for discharges of storm water runoff into State waters; and
- 4. The applicant may be required to apply for an individual NPDES permit if there is any type of activity in which wastewater is discharged from the project into State waters.

If you have any questions, please contact the Clean Water Branch at (808) 586-4309.

Wastewater Branch (WVWB)

All wastewater plans must conform to applicable provisions of the Department of Health's Administrative Rules, Chapter 11-62, "Wastewater Systems". We reserve the right to review the detailed wastewater plans for conformance to applicable rules.

If you have any questions, please contact the Wastewater Branch at (808) 586-4294.

Clean Air Branch

Control of Fugitive Dust

There is a significant potential for fugitive dust emissions during the construction activities. Implementation of adequate dust control measures during all phases of development and construction activities is warranted.

Mr. David B. Bills
May 29, 2002
Page 3

Construction activities must comply with provisions of Hawaii Administrative Rules, Chapter 11-60.1, "Air Pollution Control," Section 11-60.1-33, Fugitive Dust.

The contractor should provide adequate measures to control dust from the road areas and during the various phases of construction. These measures include, but are not limited to:

- a. Planning the different phases of construction, focusing on minimizing the amount of dust generating materials and activities, centralizing on-site vehicular traffic routes, and locating potentially dusty equipment in areas of the least impact;
- b. Providing an adequate water source at the site prior to start up of construction activities;
- c. Landscaping and rapid covering of bare areas, including slopes, starting from the initial grading phase;
- d. Controlling of dust from shoulders and access roads;
- e. Providing adequate dust control measures during weekends, after hours, and prior to daily start-up of construction activities; and
- f. Controlling of dust from debris being hauled away from project site.

If you have any questions regarding these issues on fugitive dust, please contact the Clean Air Branch at (808) 586-4200.

Sincerely,



GARY GILL
Deputy Director
Environmental Health Administration

c: CWB
WVB
CAB

DEPARTMENT OF DESIGN AND CONSTRUCTION
CITY AND COUNTY OF HONOLULU

436 SOUTH KING STREET, 11TH FLOOR
HONOLULU, HAWAII 96813
PHONE: (808) 521-3446 FAX: (808) 521-0447
WEB SITE ADDRESS: www.cdc.hawaii.gov



HELENY HARRIS
DIRECTOR

RAE M. LOEB, P.E.
DIRECTOR
ERIC G. CRISTINA, LIA
INFRASTRUCTURE
GEORGET. TAMASUBIRO, P.E.
ASSISTANT DIRECTOR
CDEP 02-0166

June 20, 2002

Mr. Gary Gill, Deputy Director
Environmental Health Administration
Department of Health
State of Hawaii
P. O. Box 3378
Honolulu, Hawaii 96801

Dear Mr. Gill:

Subject: Draft Environmental Assessment (DEA)
Poolaka Street Drainage Improvements
TMK: 3-4-03: 10, 22, 24, 25, 20, 32, 33, 36 and 37
Palolo, Honolulu, Oahu, Hawaii

Thank you for your correspondence of May 29, 2002, regarding the subject project. The following are responses to your comments:

1. A Department of the Army Permit is not necessary for the proposed project; thus, it is our understanding that a Section 401 Water Quality Certification will not be required.
2. The construction site (area to be disturbed) is less than 1 acre; therefore, it is our understanding that a National Pollutant Discharge Elimination System (NPDES) general permit will not be required for storm water discharges relating to construction activities of the proposed project.
3. After construction, the proposed drainage system will not involve any wastewater discharge into State waters.
4. The FEA will indicate that construction activities will comply with Chapter 11-60.1 "Air Pollution Control," Section 11-60.1-33, Fugitive Dust.

Mr. Gary Gill
Page 2
June 20, 2002

Should there be any questions, please contact Gregory Sue at 527-6304. Again, thank you for your participation in the environmental review process.

Very truly yours,

RAE M. LOUI, P.E.
Director

GS:dk

cc: Gray, Hong, Bills, Nojima & Associates, Inc.

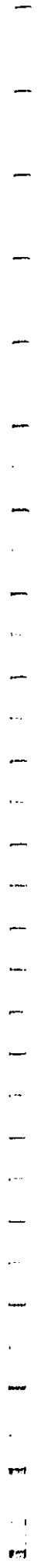

BENJAMIN J. CAYetano
Mayor



STATE OF HAWAII
OFFICE OF ENVIRONMENTAL QUALITY CONTROL
275 SOUTH KING STREET
SUITE 102
HONOLULU, HAWAII 96813
PHONE: (808) 586-1111 FAX: (808) 586-1112
WWW.HAWAII.GOV/DEQ

GENEVIEVE SALMONSON
DIRECTOR

JEREMY HARMS
MAYOR

DEPARTMENT OF DESIGN AND CONSTRUCTION
CITY AND COUNTY OF HONOLULU

650 SOUTH KING STREET, 11TH FLOOR
HONOLULU, HAWAII 96813
PHONE: (808) 521-1144 FAX: (808) 521-4347
WEB SITE ADDRESS: www.dca.honolulu.gov



RAE M. LOUI, P.E.
DIRECTOR
EMIG C. CRISPIN, AIA
DEPUTY DIRECTOR
GEORGE T. TAMASHIRO, P.E.
ASSISTANT DIRECTOR
CDEP 02-0167

June 20, 2002

Rae Loui, Director
Department of Design & Construction
650 South King Street
Honolulu, Hawaii 96813

Attention: Gregory Sue

Dear Ms. Loui:

Subject: Draft Environmental Assessment (EA) for Pooleka St. Drainage Improvements

We have the following comments to offer:

Two-sided pages: In order to reduce bulk and save on paper, please print on both sides of the pages in the final document.

Contacts: In the final EA list state agencies, county agencies, other organizations and individuals receiving a copy of the draft EA. If you received any correspondence from contacts made during the pre-consultation phase, be sure to also include this.

Runoff: Water has and will continue to sheetflow across residential lots. With the new drainage system, what measures will be taken to prevent hazardous materials, such as herbicides applied to lawns, from entering Waioamao Stream?

Figures: In the final EA enclose a topographical map of this area, a FIRM map, and a photo of the portion of Waioamao Stream where the outlet structure will be located.

If you have any questions, call Nancy Heinrich at 586-4185.

Sincerely,

Genevieve Salmonson
GENEVIEVE SALMONSON
Director

c: David Bills

Ms. Genevieve Salmonson, Director
Office of Environmental Quality Control
Suite of Hawaii
235 South Beretania Street, Suite 702
Honolulu, Hawaii 96813

Attention: Ms. Nancy Heinrich

Dear Ms. Salmonson:

Subject: Draft Environmental Assessment (DEA)
Pooleka Street Drainage Improvements
TRM: 2-4-03: 10, 22, 24, 25, 20, 32, 33, 36 and 37
Palolo, Honolulu, Oahu, Hawaii

Thank you for your correspondence of May 13, 2002, regarding the subject project. The following are responses to your comments:

1. We will make every effort to use double-sided printing of the Final EA (FEA).
2. The FEA will include an updated list of contacts made during the DEA process.
3. In order to prevent hazardous materials from entering Waioamao Stream, area property owners and residents may be supplied with literature explaining types of hazardous materials, such as herbicides, that could potentially end up in the runoff and the potential environmental consequences.
4. The FEA will include the FIRM and topographical maps, as well as a photo at the proposed outlet location in Parcel 10.

Should there be any questions, please contact Gregory Sue at 527-6304. Again, thank you for your participation in the environmental review process.

Very truly yours,
Genevieve Salmonson
RAE M. LOUI, P.E.
Director

GS:dk
cc: Gray, Hong, Bills, Nojima & Associates, Inc.



RECEIVED
LAND DIVISION

MAY 17 A 9 08

STATE OF HAWAII
DEPARTMENT OF LAND AND NATURAL RESOURCES

LAND DIVISION
P.O. BOX 571
HONOLULU, HAWAII 96809

April 29, 2002

AGRICULTURE
BOATING AND OCEAN RECREATION
CONSERVATION AND
RECREATION DEVELOPMENT
FORESTRY AND WILDLIFE
HISTORIC PRESERVATION
LAND DIVISION
PLANNING AND TECHNICAL SERVICES
WATER RESOURCE MANAGEMENT

LD-NAV

Ref.: POOLEKS-STREETDRAINAGE.COM

Suspense Date: 5/23/02

MEMORANDUM:

- TO: XXX Division of Aquatic Resources
- XXX Division of Forestry & Wildlife
- XXX Division of State Parks
- Division of Boating and Ocean Recreation
- XXX Historic Preservation Division
- XXX Commission on Water Resource Management
- Land Division Branches of:
 - XXX Planning and Technical Services
 - XXX Engineering Branch
 - XXX Oahu District Land Office

FROM: Dierdre S. Mamiya, Administrator
Land Division *Dierdre*

SUBJECT: Draft Environmental Assessment (DEA) covering the City and County of Honolulu Department of Design and Construction Pooleka Street Drainage Improvements at Waiomao, Palolo, Honolulu, Oahu, Hawaii TMK: (1) 3-4-03: 010, 022, 024, 025, 032, 033, 036 & 037

Please review the document covering the subject matter and submit your written comments and recommendations (if any) on Division letterhead signed and dated on or before the suspense date. Should you need more time to review the subject matter, please contact Nicholas A. Vaccaro at ext.: 7-0438.

If this office does not receive your comments by the suspense date, we will assume there are no comments.

() We have no comments. (X) Comments attached.

Signed:

Date:

DEPARTMENT OF LAND AND NATURAL RESOURCES
Land Division
Engineering Branch

COMMENTS

We confirm that the project site is located in Zone X. This is an area determined to be outside of the 500-year floodplain.

Reference to the Flood Insurance Rate Map (FIRM) panel 0360E (September 20, 2000) on page 3, Item E, Section 1, Flood, Erosion, and Geological Characteristics, paragraph one is incorrect. Please revise document to reference FIRM panel 0370E (September 20, 2000)

Signed: *Andrew M. Mondien*
ANDREW M. MONDIEN, CHIEF ENGINEER

Date: 5/16/02

DEPARTMENT OF DESIGN AND CONSTRUCTION
CITY AND COUNTY OF HONOLULU

449 SOUTH KING STREET, 11TH FLOOR
HONOLULU, HAWAII 96813
PHONE: (808) 531-4141 FAX: (808) 531-4147
WEB SITE ADDRESS: www.cc.honolulu.hi.us



JELENY HARRIS
MAYOR

RAE M. LOUI, P.E.
DIRECTOR
ERIC O. CRISPER, AIA
DEPUTY DIRECTOR
GEORGE T. TAMASSIRO, P.E.
ASSISTANT DIRECTOR
CDEP 02-0168

June 20, 2002

Ms. Dierdre S. Mamiya, Administrator
Land Division
Department of Land and Natural Resources
State of Hawaii
P. O. Box 621
Honolulu, Hawaii 96809

Attention: Mr. Andrew Monden
Chief Engineer, Engineering Branch

Dear Ms. Mamiya:

Subject: Draft Environmental Assessment (DEA)
Poolaka Street Drainage Improvements
TMK: 3-4-03: 10, 22, 24, 25, 20, 32, 33, 36 and 37
Palolo, Honolulu, Oahu, Hawaii

Thank you for your correspondence of May 16, 2002, regarding the subject project. We acknowledge that you have confirmed the project site location in Zone X of Flood Insurance Rate Map 15003C0370 E.

Should there be any questions, please contact Gregory Sue at 527-6304. Again, thank you for your participation in the environmental review process.

Very truly yours,

RAE M. LOUI, P.E.
Director

GS:dk
cc: Gray, Hong, Bills, Nojima & Associates, Inc.

DEPARTMENT OF DESIGN AND CONSTRUCTION



GILBERT S. COLQUHOUN
DIRECTOR
BRUCE S. ANDERSON
SEVENTH FLOOR
CLAYTON W. DELOUZE
DEPARTMENT OF DESIGN AND CONSTRUCTION
HONOLULU, HAWAII, P.O. BOX 21088
KOA, HONOLULU, HAWAII 96821-0108
TEL: 521-2000 FAX: 521-2001

DEPARTMENT OF DESIGN AND CONSTRUCTION
CITY AND COUNTY OF HONOLULU

630 SOUTH KING STREET, 11TH FLOOR
HONOLULU, HAWAII 96813
PHONE (808) 521-2000 FAX (808) 521-2001
WEB SITE ADDRESS: www.cc.hawaii.gov



JERRY HARRIS
MAYOR

RAEM LOUI, P.E.
DIRECTOR
ERIC G. CHRISTY, AIA
DEPUTY DIRECTOR
GEORGE T. TAMASIRO, P.E.
ASSISTANT DIRECTOR
CDEP 02-0164

June 20, 2002

TO: Ms. Dierdre S. Mamiya, Administrator
Land Division

FROM: Linnel T. Nishioka, Deputy Director
Commission on Water Resource Management (CWRM)

SUBJECT: Draft Environmental Assessment, City and County of Honolulu, Department of Design & Construction, Pooleka Street Drainage Improvements at Waiohio Stream, Palolo, Oahu
TMK (1) 3-4-03: 10, 22, 24-25, 32-33, 36 & 37

FILE NO.: L-2475

Thank you for the opportunity to review the subject document. Our comments related to water resources are marked below.

In general, the CWRM strongly promotes the efficient use of our water resources through conservation measures and use of alternative non-potable water resources whenever available, feasible, and there are no harmful effects to the ecosystem. Also, the CWRM encourages the protection of water recharge areas, which are important for the maintenance of streams and the replenishment of aquifers.

- We recommend coordination with the county government to incorporate this project into the county's Water Use and Development Plan.
- We recommend coordination with the Land Division of the State Department of Land and Natural Resources to incorporate this project into the State Water Projects Plan.
- We are concerned about the potential for ground or surface water degradation/contamination and recommend that approvals for this project be conditioned upon a review by the State Department of Health and the developer's acceptance of any resulting requirements related to water quality.
- A Well Construction Permit and/or a Pump Installation Permit from the Commission would be required before ground water is developed as a source of supply for the project.
- The proposed water supply source for the project is located in a designated water management area, and a Water Use Permit from the Commission would be required prior to use of this source.
- Groundwater withdrawals from this project may affect streamflow, which may require an instream flow standard amendment.
- We are concerned about the potential for degradation of instream uses from development on highly erodible slopes adjacent to streams within or near the project. We recommend that approvals for this project be conditioned upon a review by the corresponding county's Building Department and the developer's acceptance of any resulting requirements related to erosion control.
- If the proposed project includes construction of a stream diversion, the project may require a stream diversion works permit and amend the instream flow standard for the affected stream(s).
- If the proposed project alters the bed and banks of a stream channel, the project may require a stream channel alteration permit.

[X] OTHER: The Draft Environmental Assessment acknowledges the need for a Stream Channel Alteration Permit. If there are any questions, please contact David Higa at 587-0249.

cc: City and County of Honolulu, Department of Design and Construction, Attention: Gregory Sue
Office of Environmental Quality Control
Gray, Hong, Bills, Nijima & Associates, Attention: David Bills

c:\projects\water\2475\pooleka drain imp.dg.doc

Ms. Dierdre S. Mamiya, Administrator
Land Division
State of Hawaii
P. O. Box 621
Honolulu, Hawaii 96809

Attention: Mr. David Higa
Commission on Water Resource Management

Dear Ms. Mamiya:

Subject: Draft Environmental Assessment (DEA)
Pooleka Street Drainage Improvements
TMK: 3-4-03: 10, 22, 24, 25, 20, 32, 33, 36 and 37
Palolo, Honolulu, Oahu, Hawaii

Thank you for your correspondence of May 10, 2002, regarding the subject project. We acknowledge that a stream channel alteration permit will be required for the project, which has been indicated in the DEA.

Should there be any questions, please contact Gregory Sue at 527-6304. Again, thank you for your participation in the environmental review process.

Very truly yours,

RAEM M. LOUI, P.E.
Director

GS:dk
cc: Gray, Hong, Bills, Nijima & Associates, Inc.

RECEIVED
LAND DIVISION



STATE OF HAWAII
DEPARTMENT OF LAND AND NATURAL RESOURCES

LAND DIVISION
PO BOX 621
HONOLULU, HAWAII 96809

April 29, 2002

AQUATIC RESOURCES
BOATING AND DECOR REGULATION
CONSERVATION AND
RESOURCES ENFORCEMENT
FORESTRY AND WILDLIFE
HISTORIC PRESERVATION
LAND DIVISION
WATER RESOURCE MANAGEMENT



STATE OF HAWAII
DEPARTMENT OF LAND AND NATURAL RESOURCES

LAND DIVISION
PO BOX 621
HONOLULU, HAWAII 96809

AQUACULTURE DEVELOPMENT
PROGRAM
BOATING AND DECOR REGULATION
CONSERVATION AND
RESOURCES ENFORCEMENT
FORESTRY AND WILDLIFE
HISTORIC PRESERVATION
LAND DIVISION
WATER RESOURCE MANAGEMENT

LD-NAV

Ref.: POOLEKASTREETDRAINAGE.COM

Suspense Date: 5/23/02

L-2475

MEMORANDUM:

- XXX Division of Aquatic Resources
- XXX Division of Forestry & Wildlife
- XXX Division of State Parks
- XXX Division of Boating and Ocean Recreation
- XXX Historic Preservation Division
- XXX Commission on Water Resource Management
- Land Division Branches of:
 - XXX Planning and Technical Services
 - XXX Engineering Branch
 - XXX Oahu District Land Office

TO: Dierdre S. Mamiya, Administrator
Land Division

Shalene

SUBJECT: Draft Environmental Assessment (DEA) covering the City and County of Honolulu Department of Design and Construction Pooleka Street Drainage Improvements at Waiomao, Palolo, Honolulu, Oahu, Hawaii TMK: (1) 3-4-03: 010, 022, 024, 025, 032, 033, 036 & 037

Please review the document covering the subject matter and submit your written comments and recommendations (if any) on Division letterhead signed and dated on or before the suspense date. Should you need more time to review the subject matter, please contact Nicholas A. Vaccaro at ext.: 7-0438.

If this office does not receive your comments by the suspense date, we will assume there are no comments.

() We have no comments.

() Comments attached.

Signed: *Shalene*

Date: 5/17/02

Shalene

MEMORANDUM

To: Dierdre Mamiya
Land Administrator

Attn: Nick Vaccaro

From: Steve Lau
Land Agent

Subject: Draft Environmental Assessment (DREA) covering the City and County of Honolulu, Dept. of Design and Construction Pooleka Street Drainage Improvements at Waiomao, Palolo, Honolulu, Oahu, TMK: 3-4-03:10, 022, 24, 25, 32, 33, 36 & 37.

Tax Map Key: 3-4-03:10 is encumbered under HL 17 to Irma H. Keliipuleole and William Iao.

Pending City and County obtaining concurrence from Lessees, we would request Board's approval for a perpetual, non-exclusive easement to the City and County of Honolulu, Dept. of Design and Construction for drainage purposes.

DEPARTMENT OF DESIGN AND CONSTRUCTION
CITY AND COUNTY OF HONOLULU

628 SOUTH KING STREET, 11TH FLOOR
 HONOLULU, HAWAII 96813
 PHONE: (808) 522-4144 FAX: (808) 522-4147
 WEB SITE ADDRESS: www.cc.honolulu.hi.us



JEREMY HARRIS
 MAYOR

RAE M. LOUI, P.E.
 DIRECTOR
 ERIC G. CLESTER, AIA
 DEPUTY DIRECTOR
 GEORGE T. YAMASHIRO, P.E.
 ASSISTANT DIRECTOR
 CDEP 02-0162

June 20, 2002

Ms. Dierdre S. Mamiya, Administrator
 Land Division
 Department of Land and Natural Resources
 State of Hawaii
 P. O. Box 621
 Honolulu, Hawaii 96809

Attention: Mr. Steve Lau, Land Agent

Dear Ms. Mamiya:

Subject: Draft Environmental Assessment (DEA)
 Pooleka Street Drainage Improvements
 TMK: 3-4-03: 10, 22, 24, 25, 20, 32, 33, 36 and 37
 Palolo, Honolulu, Oahu, Hawaii

Thank you for your correspondence of May 7, 2002, regarding the subject project. We acknowledge that TMK: 3-4-03: 10 was encumbered under HL 17 to Irma H. Keliipuleole and William Iao. The current lessees, Mr. and Mrs. Irwin Keliipuleole, have concurred in writing with the proposed improvements and easement designation. As recommended, the Final EA will state that the City and County of Honolulu will request approval of the Board of Land and Natural Resources for a perpetual, non-exclusive easement for drainage purposes.

Should there be any questions, please contact Gregory Sue at 527-6304. Again, thank you for your participation in the environmental review process.

Very truly yours,

RAE M. LOUI, P.E.
 Director

GS:dk

cc: Gray, Hong, Bills, Nojima & Associates, Inc.

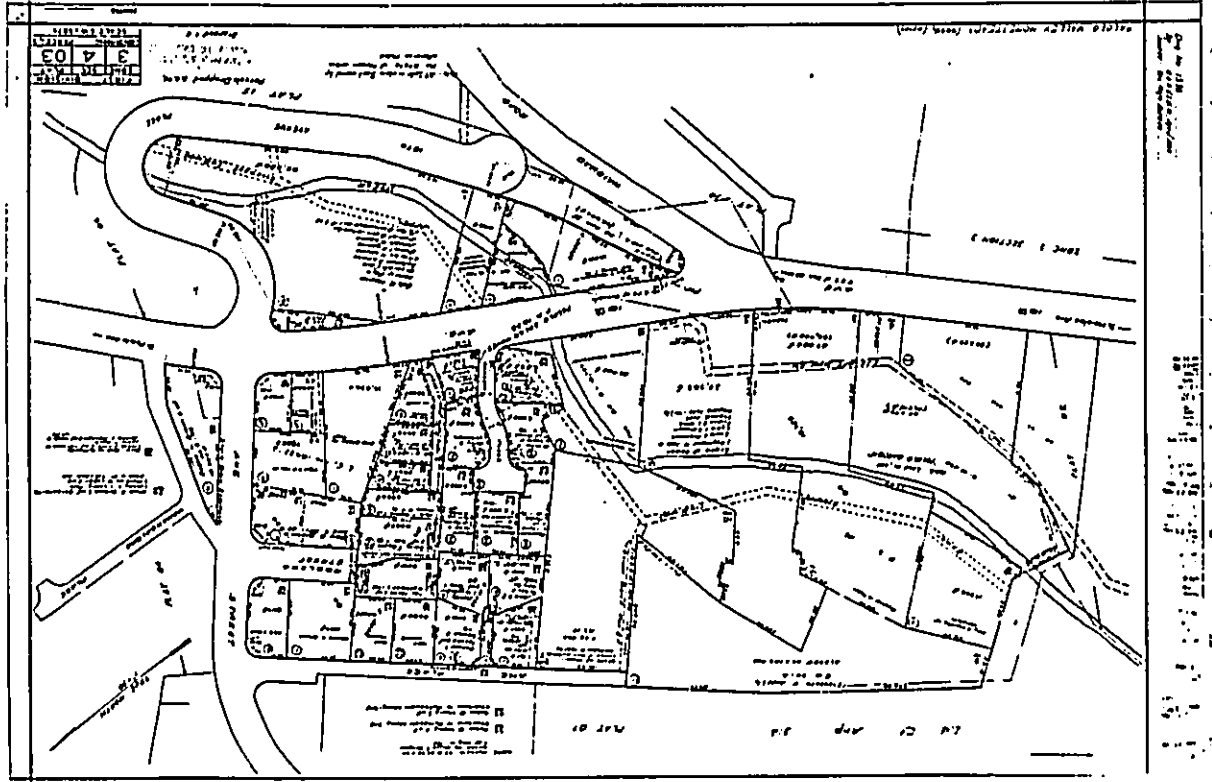

SUSPENSE DATE: May 23, 2002

STATE OF HAWAII
Department of Land and Natural Resources
Division of Aquatic Resources

MEMORANDUM

To: William Devick, Administrator
From: Richard Sixberry, Aquatic Biologist
Subject: Comments on Draft Environmental Assessment

Comments Requested By: Dede Mamiya - Land Division

Date of Request: 4/29/02 Date Received: 5/1/02

Summary of Project

Title: Pooleka Street Drainage Improvements
Proj. By: C&C
Location: Palolo, Oahu

Brief Description:

The applicant plans to improve the drainage system at Pooleka Street by installing new drain inlets, manholes and a headwall outlet structure to alleviate flooding in this area of Palolo Valley.

Comments:

No significant long-term impact to aquatic resources is expected, although some temporary disturbance to the environment may occur during construction. The applicant should provide adequate measures, such as Best Management Practices, to mitigate potential impacts adverse to the aquatic environment.

We suggest that construction activities be restricted to periods of minimal rainfall and areas denuded of vegetation which could be susceptible to wind or water erosion are appropriately stabilized. Also, precautionary measures should include preventing construction materials, petroleum products, debris and especially eroded soil from entering Waiomao Stream.

Richard Sixberry
Aquatic Biologist

DEPARTMENT OF DESIGN AND CONSTRUCTION
CITY AND COUNTY OF HONOLULU

650 SOUTH KING STREET, 15TH FLOOR
HONOLULU, HAWAII 96813
PHONE: (808) 523-4344 FAX: (808) 523-4499
WEB SITE ADDRESS: www.cc.honolulu.hi.us



JEREMY HARRIS
MAYOR

RAEM LOUI, P.E.
DIRECTOR
ERIC G. CRISTINA, AIA
DEPUTY DIRECTOR
GEORGET. TAMASHIRO, P.E.
ASSISTANT DIRECTOR
CDEP 02-0163

June 20, 2002

Ms. Dierdre S. Mamiya, Administrator
Land Division
Department of Land and Natural Resources
State of Hawaii
P. O. Box 621
Honolulu, Hawaii 96809

Attention: Mr. Richard Sixberry
Division of Aquatic Resources

Dear Ms. Mamiya:

Subject: Draft Environmental Assessment (DEA)
Pooleka Street Drainage Improvements
TMK: 3-4-03: 10, 22, 24, 25, 20, 32, 33, 36 and 37
Palolo, Honolulu, Oahu, Hawaii

Thank you for your correspondence of May 14, 2002, regarding the subject project. We acknowledge that the proposed project is not expected to have any significant long-term impacts to aquatic resources in the area; however, Best Management Practices will be implemented to mitigate potential temporary disturbances that may occur during construction. In addition, as requested, every attempt will be made to restrict construction activities to dry periods and to areas denuded of vegetation so as to minimize erosion.

Should there be any questions, please contact Gregory Sue at 527-6304. Again, thank you for your participation in the environmental review process.

Very truly yours,

RAEM M. LOUI, P.E.
Director

GS:dk

cc: Gray, Hong, Bills, Nojima & Associates, Inc.

BENJAMIN J. CAYTELANO
GOVERNOR OF HAWAII



STATE OF HAWAII

DEPARTMENT OF LAND AND NATURAL RESOURCES

HISTORIC PRESERVATION DIVISION
LAWRENCE S. BULLOCK BUILDING, ROOM 508
1550 SOUTH KING STREET, HONOLULU, HAWAII 96813
PHONE: (808) 531-1544 FAX: (808) 531-1417
WWW.DLR.HAWAII.GOV

DAVID B. COVARRUBIAS CHAIRPERSON
BOARD OF LAND AND NATURAL RESOURCES
COMMISSION ON WATER RESOURCES MANAGEMENT

DEPT. OF LAND AND NATURAL RESOURCES
1550 SOUTH KING STREET, HONOLULU, HAWAII 96813
PHONE: (808) 531-1544 FAX: (808) 531-1417
WWW.DLR.HAWAII.GOV

ADJUTANT GENERAL
BOARD OF LAND AND NATURAL RESOURCES
COMMISSION ON WATER RESOURCES MANAGEMENT
DEPARTMENT OF LAND AND NATURAL RESOURCES
1550 SOUTH KING STREET, HONOLULU, HAWAII 96813
PHONE: (808) 531-1544 FAX: (808) 531-1417
WWW.DLR.HAWAII.GOV

HAWAII HISTORIC PRESERVATION
DIVISION REVIEW

Log #: 29780
Doc #: 0204EJ24

Applicant/Agency:

Gregory Sue
Department of Design and Construction
City & County of Honolulu
650 S. King Street, 11th Floor
Honolulu, Hawaii 96813

Address:

SUBJECT:

Chapter 6E-8 Historic Preservation Review Draft Environmental
Assessment Pooleka Street Drainage Improvements

Abupua'a: Palolo

District, Island: Kona, O'ahu

TMK: (1) 3-4-003:010, 022, 024, 025, 032, 033, 036, 037

1. We believe there are no historic properties present, because:

- a) intensive cultivation has altered the land
- b) residential development/urbanization has altered the land
- c) previous grubbing/grading has altered the land
- d) an acceptable archaeological assessment or inventory survey found no historic properties
- e) other

2. This project has already gone through the historic preservation review process, and mitigation has been completed.

Thus, we believe that "no historic properties will be affected" by this undertaking

Staff: Silvia Sciville Date: April 30, 2002
Title: Elaine Jourdane, Assistant Archaeologist O'ahu Phone (808) 692-8027

Cc: OEQC
David Bills, Gray, Hong, Bills Nojima & Associates, Inc. 841 Bishop Street, Suite 1100,
Honolulu, HI 96813

DEPARTMENT OF DESIGN AND CONSTRUCTION
CITY AND COUNTY OF HONOLULU

150 SOUTH KING STREET, 11TH FLOOR
HONOLULU, HAWAII 96813
PHONE: (808) 531-1544 FAX: (808) 531-1417
WEB SITE ADDRESS: www.cc.honolulu.hi.us



JEREMY HARRIS
MAYOR

RAE M. LOUI, P.E.
DIRECTOR
ERIC C. CHOPIN, AIA,
DEPUTY DIRECTOR
GEORGE F. TAMASHIRO, P.E.
ASSISTANT DIRECTOR
CDEP 02-0165

June 20, 2002

Mr. Don Hibbard, Administrator
State Historic Preservation Division
Department of Land and Natural Resources
State of Hawaii
601 Kamokila Boulevard, Room 555
Kapolei, Hawaii 96707

Dear Mr. Hibbard:

Subject: Draft Environmental Assessment (DEA)
Pooleka Street Drainage Improvements
TMK: 3-4-03: 10, 22, 24, 25, 20, 32, 33, 36 and 37
Palolo, Honolulu, Oahu, Hawaii

Thank you for your correspondence of April 30, 2002 (LOG NO. 29780/DOC NO. 0204EJ24) regarding the subject project. We acknowledge that no significant historic sites will be affected by the proposed action.

Should there be any questions, please contact Gregory Sue at 527-6304. Again, thank you for your participation in the environmental review process.

Very truly yours,

RAE M. LOUI, P.E.
Director

GS:dk
cc: Gray, Hong, Bills, Nojima & Associates, Inc.

POLICE DEPARTMENT
CITY AND COUNTY OF HONOLULU
201 SOUTH BERETANIA STREET
HONOLULU, HAWAII 96813 - AREA CODE (808) 529-3111
<http://www.honolulu.gov>
www.co.honolulu.hi.us



JEREMY HARRIS
MAYOR

OUR REFERENCE CS-KP

June 3, 2002

LEE D. DONOHUE
CHIEF
ROBERT AU
OLEN KAJIYAMA
DEPUTY CHIEFS

JEREMY HARRIS
MAYOR

DEPARTMENT OF DESIGN AND CONSTRUCTION
CITY AND COUNTY OF HONOLULU
610 SOUTH KING STREET, 11TH FLOOR
HONOLULU, HAWAII 96813
PHONE: (808) 522-4544 FAX: (808) 522-4167
WEB SITE ADDRESS: www.cd.honolulu.hi.us



June 20, 2002

RAE M. LOUI, P.E.
DIRECTOR
ERIC G. CHRISTOPHER, AIA
DEPUTY DIRECTOR
GEORGE T. TAMASIERO, P.E.
ASSISTANT DIRECTOR
CDEP 02-0177

TO: RAE M. LOUI, P.E., DIRECTOR
DEPARTMENT OF DESIGN AND CONSTRUCTION

ATTENTION: GREGORY SUE

FROM: LEE D. DONOHUE, CHIEF OF POLICE
HONOLULU POLICE DEPARTMENT

SUBJECT: DRAFT ENVIRONMENTAL ASSESSMENT
POOLEKA STREET DRAINAGE IMPROVEMENTS
TMK 3-4-03: 10, 22, 24, 25, 32, 33, 36, AND 37
WAIONAHO, PALOLO, HONOLULU, OAHU, HAWAII

Thank you for the opportunity to review and comment on the subject project.
This project should have minimal impact on the services and facilities of the Honolulu Police Department.

If there are any questions, please call Ms. Carol Sodetani of the Support Services Bureau at 529-3658.

LEE D. DONOHUE
Chief of Police

By 
KARL GODSEY
Assistant Chief of Police
Support Services Bureau

MEMORANDUM

TO: LEE D. DONOHUE, CHIEF OF POLICE
HONOLULU POLICE DEPARTMENT

ATTN: CAROL SODETANI
SUPPORT SERVICES BUREAU

FROM: RAE M. LOUI, P.E., DIRECTOR 
DEPARTMENT OF DESIGN AND CONSTRUCTION

SUBJECT: DRAFT ENVIRONMENTAL ASSESSMENT (DEA)
POOLEKA STREET DRAINAGE IMPROVEMENTS
TMK: 3-4-03: 10, 22, 24, 25, 20, 32, 33, 36 AND 37
PALOLO, HONOLULU, OAHU, HAWAII

Thank you for your correspondence of June 3, 2002, regarding the subject project. We acknowledge that the proposed project should have negligible impact on the facilities and services of the Police Department.

Should there be any questions, please contact Gregory Sue at extension 6304. Again, thank you for your participation in the environmental review process.

GS:dk

cc: Gray, Hong Bills, Nojima & Associates, Inc.

DEPARTMENT OF PARKS AND RECREATION
CITY AND COUNTY OF HONOLULU

1000 ULUKOUA STREET, SUITE 300 • PALOHELE, HAWAII 968707
PHONE: (808) 692-5581 • FAX: (808) 692-5131 • INTERNET: www.co.honolulu.hi.us



JEREMY HARRIS
MAYOR

WILLIAM D. BALFOUR, JR.
DIRECTOR

EDWARD T. "SHUPPA" DAIZ
DEPUTY DIRECTOR

May 17, 2002

TO: RAE M. LOUI, P.E., DIRECTOR
DEPARTMENT OF DESIGN AND CONSTRUCTION

ATTENTION: GREGORY SUE

FROM: WILLIAM D. BALFOUR, JR., DIRECTOR

SUBJECT: DRAFT ENVIRONMENTAL ASSESSMENT
POOLEKA STREET DRAINAGE IMPROVEMENTS
TMK 3-4-03: 10, 22, 24, 25, 32, 33, 36&37
WAIOMAO, PALOLO, HONOLULU, OAHU, HAWAII

Thank you for the opportunity to review and comment on the Draft Environmental Assessment relating to the Pooleka Street drainage improvements.

The Department of Parks and Recreation has no comment on the proposed project.

Should you have any questions, please contact Mr. John Reid, Planner, at 692-5454

W.D. Balfour, Jr.

WILLIAM D. BALFOUR, JR.
Director

WDB:cu (11005)

cc: Office of Environmental Quality Control
✓ Gray, Hong, Bills, Nojima & Associates, Inc.
Mr. Don Griffin, Department of Design and Construction

DEPARTMENT OF DESIGN AND CONSTRUCTION
CITY AND COUNTY OF HONOLULU

400 SOUTH KING STREET, 11TH FLOOR
HONOLULU, HAWAII 96813
PHONE: (808) 531-4144 • FAX: (808) 531-4147
WEB SITE ADDRESS: www.ddc.honolulu.gov



JEREMY HARRIS
MAYOR

RAE M. LOUI, P.E.
DIRECTOR
ERIC G. CRISPEN, AIA
DEPUTY DIRECTOR
GEORGET TAMASIBIRO, P.E.
ASSISTANT DIRECTOR
BY REPLY REFER TO
CDEP 02-0173

June 20, 2002

MEMORANDUM

TO: WILLIAM D. BALFOUR, JR., DIRECTOR
DEPARTMENT OF PARKS AND RECREATION

ATTN: JOHN REID

FROM: RAE M. LOUI, P.E., DIRECTOR
DEPARTMENT OF DESIGN AND CONSTRUCTION

SUBJECT: DRAFT ENVIRONMENTAL ASSESSMENT (DEA)
POOLEKA STREET DRAINAGE IMPROVEMENTS
TMK: 3-4-03: 10, 22, 24, 25, 32, 33, 36 AND 37
PALOLO, HONOLULU, OAHU, HAWAII

Thank you for your correspondence of May 17, 2002, regarding the subject project. We acknowledge that your department has no comments at this time.

Should there be any questions, please contact Gregory Sue at extension 6304. Again, thank you for your participation in the environmental review process.

GS:dk

cc: Gray, Hong Bills, Nojima & Associates, Inc.

FIRE DEPARTMENT
CITY AND COUNTY OF HONOLULU

3375 KOAHALA STREET, SUITE 1425 • HONOLULU, HAWAII 96819-1888
TELEPHONE: (808) 931-7781 • FAX: (808) 931-7780 • INTERNET: www.honolulu.gov



JEREMY HARRIS
MAYOR

ATTILIO K. LEONARDI
FIRE CHIEF
JOHN CLARK
DEPUTY FIRE CHIEF

May 13, 2002

TO: RAE M. LOUI, P.E., DIRECTOR
DEPARTMENT OF DESIGN AND CONSTRUCTION

ATTN: GREGORY SUE

FROM: ATTILIO K. LEONARDI, FIRE CHIEF

SUBJECT: DRAFT ENVIRONMENTAL ASSESSMENT
POOLEKA STREET DRAINAGE IMPROVEMENTS
TAX MAP KEY: 3-4-003: 010, 022, 024, 025, 032, 036, & 037

We received a letter from Mr. David B. Bills of Gray, Hong, Bills, Nojima & Associates, Inc., dated April 24, 2002, requesting our review and comments for the above-mentioned project.

The Honolulu Fire Department requests that the following be complied with:

1. Maintain fire apparatus access throughout the construction site for the duration of the project.
2. Notify the Fire Communication Center at 523-4411 regarding any interruption in the existing fire hydrant system during the project.

Should you have any questions, please call Battalion Chief Kenneth Silva of our Fire Prevention Bureau at 831-7778.

ATTILIO K. LEONARDI
Fire Chief

AK/LDL:bh

cc: Office of Environmental Quality Control
Gray, Hong, Bills, Nojima & Associates, Inc.

DEPARTMENT OF DESIGN AND CONSTRUCTION
CITY AND COUNTY OF HONOLULU

650 SOUTH KING STREET, 11TH FLOOR
HONOLULU, HAWAII 96813
PHONE: (808) 931-4141 • FAX: (808) 931-4147
WEB SITE ADDRESS: www.cc.honolulu.gov



JEREMY HARRIS
MAYOR

RAEM LOULI, P.E.
DIRECTOR
ERIC G. CRISPIN, AIA
DEPUTY DIRECTOR
GEORGE J. MASUDA, P.E.
ASSISTANT DIRECTOR
CDEF 02-0172

June 20, 2002

MEMORANDUM

TO: ATTILIO K. LEONARDI, FIRE CHIEF
HONOLULU FIRE DEPARTMENT

ATTN: KENNETH SILVA

FROM: RAE M. LOUI, P.E., DIRECTOR 
DEPARTMENT OF DESIGN AND CONSTRUCTION

SUBJECT: DRAFT ENVIRONMENTAL ASSESSMENT (DEA)
POOLEKA STREET DRAINAGE IMPROVEMENTS
TMK: 3-4-03: 10, 22, 24, 25, 20, 32, 33, 36 AND 37
PALOLO, HONOLULU, OAHU, HAWAII

Thank you for your correspondence of May 13, 2002, regarding the subject project. The Final EA will address your concerns.

1. The contractor will be required to maintain fire apparatus access throughout the construction period.
2. The Fire Communication Center at 523-4411 will be notified in the event of any interruption in the existing fire hydrant system.

Should there be any questions, please contact Gregory Sue at extension 6304. Again, thank you for your participation in the environmental review process.

GS:dk

cc: Gray, Hong Bills, Nojima & Associates, Inc.

BOARD OF WATER SUPPLY
CITY AND COUNTY OF HONOLULU
630 SOUTH BERETANIA STREET
HONOLULU, HI 96843



May 24, 2002

JEREMY HARRIS, Mayor
EDDIE FLORES, JR., Chairman
CHARLES A. STEG, Vice-Chairman
JAN LILLY ALUM
ROBERT S.K. KAOPULA, SR.

BRYAN K. MONAGHAN, Esq., Clerk
ROSS E. SASAKAWA, Esq., Clerk
CLIFFORD S. JAMILE
Manager and Chief Engineer

TO: MR. GREGORY SUE
DEPARTMENT OF DESIGN AND CONSTRUCTION

FROM: *CSJ* CLIFFORD S. JAMILE, MANAGER AND CHIEF ENGINEER

SUBJECT: THE LETTER OF APRIL 24, 2002 ON THE DRAFT ENVIRONMENTAL ASSESSMENT FOR THE POOLEKA STREET DRAINAGE IMPROVEMENTS, TMK: ~~3-4-3-10, 22, 24, 25, 32, 33, 36 AND 37~~

Thank you for the opportunity to review the subject document for the proposed drainage improvements.

The construction schedule should be coordinated to minimize impacts to the community and our water system. In conjunction with the project scheduling, the construction plans should be submitted for our review.

We have tentatively scheduled the Palolo Water System Improvements, Part IV for construction in fiscal year 2008. This project calls for Water System Improvements along Pooleka Street.

If you have any questions, please contact Joseph Kaakua at 527-6123.

cc: Office of Environmental Quality Control
JK Gray, Hong, Bills, Nojima & Associates

DEPARTMENT OF DESIGN AND CONSTRUCTION
CITY AND COUNTY OF HONOLULU

400 SOUTH KING STREET, 11TH FLOOR
HONOLULU, HAWAII 96813
PHONE: (808) 532-4564 FAX: (808) 531-4147
WEB SITE ADDRESS: www.cc.honolulu.gov



JEREMY HARRIS
MAYOR

RAE M. LOUI, P.E.
DIRECTOR
ERIC G. CRISPIN, AIA
DEPUTY DIRECTOR
GEORGE TAMASHIRO, P.E.
ASSISTANT DIRECTOR
CDEP 02-0161

June 20, 2002

MEMORANDUM

TO: CLIFFORD S. JAMILE, MANAGER AND CHIEF ENGINEER
BOARD OF WATER SUPPLY

ATTN: MR. JOSEPH KAAKUA

FROM: RAE M. LOUI, P.E., DIRECTOR *RML*
DEPARTMENT OF DESIGN AND CONSTRUCTION

SUBJECT: DRAFT ENVIRONMENTAL ASSESSMENT (DEA)
POOLEKA STREET DRAINAGE IMPROVEMENTS
TMK: 3-4-03: 10, 22, 24, 25, 20, 32, 33, 36 AND 37
PALOLO, HONOLULU, OAHU, HAWAII

Thank you for your correspondence of May 24, 2002, regarding the subject project. We will incorporate your comments into the Final Environmental Assessment as follows:

1. The contractor will be required to coordinate to minimize impacts to the community. During construction, normal requirements for mitigation of construction impacts will be utilized. These requirements include traffic control, compliance with BMP requirements, and compliance with hours prescribed for construction to minimize noise impacts.
2. All construction activities will be scheduled such so as to minimize or prevent disruption to ongoing utility services.
3. Construction plans will be submitted to the Board of Water Supply for review during the design phase.
4. Construction scheduled for FY 2009 of the Palolo Water System Improvements, Part IV will be referenced.

Should there be any questions, please contact Gregory Sue at extension 6304. Again, thank you for your participation in the environmental review process.

GS:dk
cc: *JK* Gray, Hong Bills, Nojima & Associates, Inc.

DEPARTMENT OF FACILITY MAINTENANCE
CITY AND COUNTY OF HONOLULU
DIVISION OF ROAD MAINTENANCE
650 SOUTH KING STREET, HONOLULU, HAWAII 96813
TELEPHONE: (808) 311-4471 FAX: (808) 337-4097



JEREMY HARRIS
MAYOR

ROSS S. SASAMURA
DIRECTOR AND CHIEF ENGINEER
LARRY J. LEOPARDI
CHIEF

BY REFRY REFER TO:
DIRM02-478

10 16 AM '02

May 16, 2002

MEMORANDUM

TO: MARVIN M.W. CHAR, CHIEF
CIVIL DESIGN AND ENGINEERING DIVISION
DEPARTMENT OF DESIGN AND CONSTRUCTION

FROM: *Larry Leopardi*
LARRY LEOPARDI, CHIEF
DIVISION OF ROAD MAINTENANCE

SUBJECT: DRAFT ENVIRONMENTAL ASSESSMENT
POOLEKA STREET DRAINAGE IMPROVEMENTS
TMK: 3-4-03:10, 22, 24, 25, 32, 33, 36 & 37

We have reviewed the subject draft environmental assessment and provide the following comment:
Please refer to Page 3 and Figure 5, a 15-foot wide easement is recommended from Station -0+40 to Station 0+00, for our maintenance trucks to turn around.

Should you have any questions, please contact Hugh Liu at 5337.

DEPARTMENT OF DESIGN AND CONSTRUCTION
CITY AND COUNTY OF HONOLULU
610 SOUTH KING STREET, 11TH FLOOR
HONOLULU, HAWAII 96813
PHONE: (808) 331-2144 FAX: (808) 331-4487
WEB SITE ADDRESS: www.hawaii.gov/dep



JEREMY HARRIS
MAYOR

RAE M. LOUI, P.E.
DIRECTOR
ERIC G. CRISTINA, AIA
DEPUTY DIRECTOR
GEORGE TAKASIERO, P.E.
ASSISTANT DIRECTOR
MARLENE BERRY, TO
CODEP 02-0174

June 20, 2002

MEMORANDUM

TO: ROSS S. SASAMURA, DIRECTOR
DEPARTMENT OF FACILITY MAINTENANCE

ATTN: LARRY LEOPARDI, CHIEF
DIVISION OF ROAD MAINTENANCE

FROM: RAE M. LOUI, P.E., DIRECTOR
DEPARTMENT OF DESIGN AND CONSTRUCTION

SUBJECT: DRAFT ENVIRONMENTAL ASSESSMENT (DEA)
POOLEKA STREET DRAINAGE IMPROVEMENTS
TMK: 3-4-03: 10, 22, 24, 25, 20, 32, 33, 36 AND 37
PALOLO, HONOLULU, OAHU, HAWAII

Thank you for your correspondence of May 16, 2002, regarding the subject project. We acknowledge your request for 15-foot wide easements between Station -0+40 (outlet structure) to Station 0+00 (SDMH A-1). Every effort will be made to acquire such easements during the design phase of the project.

Should there be any questions, please contact Gregory Sue at extension 6304. Again, thank you for your participation in the environmental review process.

GS:dk

cc: Gray, Hong Bills, Nojima & Associates, Inc.

RECEIVED

PHONE (808) 534-1344
FAX (808) 534-1345
JUN 10 11 30 AM '02



STATE OF HAWAII
OFFICE OF HAWAIIAN AFFAIRS
711 KAUICUARI BOULEVARD, SUITE 830
HONOLULU, HAWAII 96813

PHONE (808) 534-1344

HRD02-586

June 3, 2002

Gregory Sue
Department of Design and Construction
650 South King Street, 11th Floor
Honolulu, HI 96813

Subject: Draft Environmental Assessment
Pooleka Street Drainage Improvements

Dear Mr. Sue:

Thank you for the opportunity to comment on the above-referenced project.

OHA asks that the draft EA be amended to include a more detailed assessment of the impact on Waiomao stream and the extent to which this stream hosts traditional and customary Hawaiian practices. This assessment should identify aquatic resources (e.g. biota) in the stream, with a particular focus on native fauna and related Hawaiian gathering and subsistence practices. Such native fauna may be present in Waiomao stream as the Board of Water Supply leaves enough water flowing in the stream to allow native o'opu to survive in this area. Further, Waiomao stream has historically supported taro cultivation as Native Planters describes terraces all along the stream. The assessment should determine whether the storm runoff directed to Waiomao stream will impede cultural resources and practices and propose appropriate remedies.

If you have any questions, please contact Sharda Manley, Policy Analyst at 594-1944, or email her at shardam@oha.org.

Sincerely,

Kalina S. Keala
Acting Director, Hawaiian Rights Division

cc: OHA Board of Trustees
Clyde W. Namu'o, Administrator

DEPARTMENT OF DESIGN AND CONSTRUCTION
CITY AND COUNTY OF HONOLULU

450 SOUTH KING STREET, 11TH FLOOR
HONOLULU, HAWAII 96813
PHONE: (808) 524-4564 FAX: (808) 522-4457
WEB SITE ADDRESS: www.cc.honolulu.hi.us

HELENY HARRIS
MAYOR



RAE M. LOUI, P.E.
DIRECTOR
ERIC G. CRISPIN, L.A.
DEPUTY DIRECTOR
GEORGE T. TAMASHIRO, P.E.
ASSISTANT DIRECTOR
CDEP 02-0171

June 24, 2002

Ms. Jalna S. Keala, Acting Director
Hawaiian Rights Division
Office of Hawaiian Affairs
711 Kapiolani Boulevard, Suite 500
Honolulu, Hawaii 96813

Attention: Ms. Sharla Manley

Dear Ms. Keala:

Subject: Draft Environmental Assessment (DEA)
Pooleka Street Drainage Improvements
TMK: 3-4-03: 10, 22, 24, 25, 20, 32, 33, 36 and 37
Palolo, Honolulu, Oahu, Hawaii

Thank you for your correspondence of June 3, 2002, regarding the subject project. We acknowledge and appreciate the comments you have provided with respect to the project's impact on cultural practices with respect to Waiomao Stream. The following are our responses to the issues you have identified:

1. Impact of Storm Runoff

Because the City will not be altering the topography and size of the drainage basin, there will be no change in the quantity of storm runoff resulting from the proposed drainage system. The runoff generated in the existing drainage basin is being presently discharged into the stream as it runs through Parcel 10 (TMK: 3-4-03: 10). The new drainage outlet will actually serve to improve conditions for the terraced landscape along the Waiomao Stream bank at the rear of Parcel 10, by directing the flow to enter the stream on one side of the property. As such, there will be no detrimental impacts resulting from the proposed action, since the same amount of runoff will be entering the stream.

Ms. Jalna S. Keala
Page 2
June 24, 2002

2. Impact on Aquatic Resources

As part of the DEA review process, the Department of Land and Natural Resources Division of Aquatic Resources responded that the proposed project is not expected to have any significant long-term impacts to aquatic resources in the area (refer to enclosed letter dated May 14, 2002). Potential temporary disturbances however, will be mitigated by stringent Best Management Practices which will be implemented throughout the construction period.

3. Taro Cultivation Practices Along Waiomao Stream

As indicated by long-time area residents interviewed during the DEA preparation process, the aawai system was used to enhance taro cultivation in Palolo Valley. However, there is no known active or remnant evidence of the system or its use today. Moreover, there is no ongoing practice in the vicinity of the proposed discharge outlet.

In summary, the proposed drainage system will not increase or otherwise impact stream flow or aquatic resources. Thus, the proposed project is not anticipated to significantly affect cultural resources and traditional gathering practices. Please be assured that the information provided above will be disclosed in the Final Environmental Assessment.

Should there be any questions, please contact Gregory Sue at 527-6304. Again, thank you for your participation in the environmental review process.

Very truly yours,

RAE M. LOUI, P.E.
Director

GS:dk
Enclosure

cc: Gray, Hong, Bills, Nojima & Associates, Inc.

DEPARTMENT OF TRANSPORTATION SERVICES
CITY AND COUNTY OF HONOLULU
650 SOUTH KING STREET 3RD FLOOR - HONOLULU HAWAII 96813
TELEPHONE: (808) 522-4529 • FAX: (808) 522-4720 • INTERNET: www.honolulu.gov



JEREMY HARRIS
MAYOR

CHERYL D. SOON
DIRECTOR
GEORGE W. LONG HALLMOTO
STAFF DIRECTOR

May 29, 2002

TPD402-01637R

Mr. David B. Bills
Gray, Hong, Bills, Nojima & Associates, Inc.
841 Bishop Street, Suite 1100
Honolulu, Hawaii 96813

Dear Mr. Bills:

Subject: Draft Environmental Assessment - Pooleka Street Drainage

This responds to your April 24, 2002 letter and the Draft Environmental Assessment (DEA Revised April 2002).

Except to note the project is expected to improve surface driving conditions at Pooleka Street during rainy periods, we have no comments on the DEA.

Regarding traffic controls for the relatively short duration while under construction, the Department of Transportation Services requests submittal of the project traffic control plans for our review/approval at the earliest opportunity.

Should you have any questions, please contact Bruce Nagao of the Transportation Planning Division at 527-6899.

Sincerely,

CHERYL D. SOON
Director

cc: Office of Environmental Quality Control

Gregory Sue
Department of Design and Construction

DEPARTMENT OF DESIGN AND CONSTRUCTION
CITY AND COUNTY OF HONOLULU
650 SOUTH KING STREET, 11TH FLOOR
HONOLULU, HAWAII 96813
PHONE: (808) 522-4444 • FAX: (808) 522-4447
WEB SITE ADDRESS: www.honolulu.gov



JEREMY HARRIS
MAYOR

RAE M. LOUI, P.E.
DIRECTOR
ERIC G. GIBSON, AIA
DEPUTY DIRECTOR
GEORGE T. TAMASUJIMA, P.E.
ASSISTANT DIRECTOR

June 21, 2002

IN REPLY REFER TO
CDEP-02-0176

MEMORANDUM

TO: CHERYL D. SOON, DIRECTOR
DEPARTMENT OF TRANSPORTATION SERVICES

ATTN: BRUCE NAGAO

FROM: RAE M. LOUI, P. E., DIRECTOR
DEPARTMENT OF DESIGN AND CONSTRUCTION

SUBJECT: DRAFT ENVIRONMENTAL ASSESSMENT (DEA)
POOLEKA STREET DRAINAGE IMPROVEMENTS
TMK: 3-4-03: 10, 22, 24, 25, 20, 32, 33, 36 AND 37
PALOLO, HONOLULU, OAHU, HAWAII

Thank you for your correspondence of May 29, 2002, regarding the subject project. The traffic control plans will be prepared with the development of the construction plans and will be submitted to your department for your review and approval.

Should there be any questions, please contact Gregory Sue at extension 6304. Again, thank you for your participation in the environmental review process.

GS:dk

cc: Gray, Hong Bills, Nojima & Associates, Inc.

DEPARTMENT OF PLANNING AND PERMITTING
CITY AND COUNTY OF HONOLULU

450 SOUTH KING STREET - HONOLULU, HAWAII 96813
TELEPHONE (808) 522-4114 • FAX (808) 527-4173 • INTERNET: www.ci.honolulu.hi.us



RANDALL K. FUJIKI, AIA
DIRECTOR
LORETTA R. C. CHIEE
DEPUTY DIRECTOR

May 16, 2002

2002/ACT-05-165 (d)

Ms. Rae Loui
Page 2

If there are any questions, please have your staff contact Mr. Don Fujii of the Civil Engineering Branch at 547-7320.

RKF:ky

cc: Gray, Hong, Bills, Nojima and Associates, Inc.
OEQC

Doc No. 153265 rev 1

MEMORANDUM

TO: RAE LOUI, P.E., DIRECTOR
DEPARTMENT OF DESIGN AND CONSTRUCTION

FROM: *Rae Loui*
RANDALL K. FUJIKI, AIA, DIRECTOR
DEPARTMENT OF PLANNING AND PERMITTING

SUBJECT: DRAFT ENVIRONMENTAL ASSESSMENT POOKELA STREET DRAINAGE IMPROVEMENTS, TMK: 3-4-03-010, 022, 024, 02032, 033, 036 & 037

This is in response to Gray, Hong, Bills, Nojima and Associates, Inc.'s April 24, 2002 letter requesting comments to the Draft EIS for the subject project. Our comments are as follows:

1. Page 1: Add the Department of Planning and Permitting to the list of agencies, organizations and individuals being consulted.
2. Page 2, Section IV(B) (Technical Characteristics): State if the improvements will be designed in accordance with City standards and specifications.
3. Grate inlets should be used if and only if there are no other viable alternatives. Furthermore, the inlets shall be designed as to allow only authorized personnel to access them (i.e., grates shall be bolted down).
4. Page 13: Delete "and Regulations" from your first reference.
5. Preliminary Plan and Profile - Drainline "A", STA3+89.11: A portion of Drainline "A" appears to lie outside of the existing easement.

DEPARTMENT OF DESIGN AND CONSTRUCTION
CITY AND COUNTY OF HONOLULU
450 SOUTH KING STREET, 13TH FLOOR
HONOLULU, HAWAII 96813
PHONE: (808) 531-4544 FAX: (808) 531-4549
WEB SITE ADDRESS: www.cc.honolulu.gov



JEREMY HARRIS
MAYOR

RAE M. LOUI, P. E.
DIRECTOR
ERIC G. CRISPIN, AIA
DEPUTY DIRECTOR
GEORGE T. YAMASAKI, P. E.
ASSISTANT DIRECTOR
IN REPLY REFER TO
CDEP 02-0173

June 20, 2002

MEMORANDUM

TO: RANDALL K. FUJIKI, AIA, DIRECTOR
DEPARTMENT OF PLANNING AND PERMITTING

ATTN: DON FUJII

FROM: RAE M. LOUI, P. E., DIRECTOR *Rae M. Loui*
DEPARTMENT OF DESIGN AND CONSTRUCTION

SUBJECT: DRAFT ENVIRONMENTAL ASSESSMENT (DEA)
POOLEKA STREET DRAINAGE IMPROVEMENTS
TMK: 3-4-03: 10, 22, 24, 25, 20, 32, 33, 36 AND 37
PALOLO, HONOLULU, OAHU, HAWAII

Thank you for your correspondence of May 16, 2002, regarding the subject project. The following are responses to your comments:

1. The Final Environmental Assessment (FEA) will list the Department of Planning and Permitting as one of the agencies contacted in the DEA review process.
2. Section IV.B. will indicate that improvements will be designed in accordance with City standards and specifications.
3. Grate inlets will be used only because the existing road slope and configuration of sidewalks and utility boxes do not allow for standard catch basins. As requested, the grates will be bolted so as to restrict access to authorized personnel.
4. "and Regulations" will be deleted from the reference on page 13.
5. In the final design, all drainlines will be located within the existing easements.

Should there be any questions, please contact Gregory Sue at extension 6304. Again, thank you for your participation in the environmental review process.

GS:dk
cc: Gray, Hong Bills, Nojima & Associates, Inc.

515 Kamae Street Honolulu, Hawaii 96814
P.O. Box 3000 Honolulu, Hawaii 96802-3000
Telephone 808.535.5900 Facsimile 808.594.5830 Sales



June 5, 2002

Department of Design and Construction
City and County of Honolulu
650 South King Street, 11th Floor
Honolulu, Hawaii 96813

Attention: Mr. Gregory Sue

Gentlemen:

Subject: Draft Environmental Assessment for
Pooleka Street Drainage Improvements

Please be advised that The Gas Company maintains underground utility gas mains in the project vicinity, which serves commercial and residential customers in the area and is interconnected with the utility network in Palolo. We would appreciate your consideration during the project planning and design process to minimize any potential conflicts with the existing gas facilities in the project area.

Thank you for the opportunity to comment on the Draft Environmental Assessment. Should there be any questions, or if additional information is desired, please call Chris Anderson at 594-5564.

Sincerely,

Charles E. Calvet, P.E.
Manager, Engineering

CECLN
02-111

cc: Office of Environmental Quality Control
Mr. David B. Bills, Gray, Hong, Bills, Nojima & Associates, Inc.

DEPARTMENT OF DESIGN AND CONSTRUCTION
CITY AND COUNTY OF HONOLULU

650 SOUTH KING STREET, 11TH FLOOR
HONOLULU, HAWAII 96813
PHONE: (808) 535-4544 FAX: (808) 533-4343
WEB SITE ADDRESS: www.cc.honolulu.gov



FREDERICK HARRIS
MAYOR

June 20, 2002

RAE M. LOUI, P.E.
DIRECTOR
EMILY G. CRISPIN, AIA
DEPUTY DIRECTOR
GEORGE T. TANASIBIRO, P.E.
ASSISTANT DIRECTOR
CDEP 02-0170

Mr. Charles E. Calvet
Manager, Engineering
The Gas Company
515 Kamae Street
Honolulu, Hawaii 96814

Attention: Chris Anderson

Dear Mr. Calvet:

Subject: Draft Environmental Assessment (DEA)
Pooleka Street Drainage Improvements
TMK: 3-4-03: 10, 22, 24, 25, 20, 32, 33, 36 and 37
Palolo, Honolulu, Oahu, Hawaii

Thank you for your correspondence of June 5, 2002, regarding the subject project. We acknowledge that The Gas Company maintains underground gas mains in the project vicinity. The Final EA will indicate that the contractor will be required to verify utility locations prior to the start of construction and ensure that there is minimal interruption of utility services during construction.

Should there be any questions, please contact Gregory Sue at 527-6304. Again, thank you for your participation in the environmental review process.

Very truly yours,

RAE M. LOUI, P.E.
Director

GS:dk

cc: Gray, Hong, Bills, Nojima & Associates, Inc.

Hawaiian Electric Company, Inc. • PO Box 2750 • Honolulu, HI 96840-0001

GEN-6 (EIS)



June 7, 2002

Attention: Mr. Gregory Sue
Department of Design and Construction
City and County of Honolulu
650 South King Street, 11th Floor
Honolulu, Hawaii 96813

Dear Mr. Sue:

Re: Pooleka Street Drainage Improvements

Thank you for the opportunity to comment on the April 2002 Draft EA for the Pooleka Street Drainage Improvements in Palolo. We have reviewed the subject document and have the following comments:

1. Please note that HECO facilities are located within the vicinity of the proposed drainage improvement area.
2. We would appreciate the opportunity to review the pre-final construction plans to determine whether the project will impact our facilities, and any work requiring their temporary or permanent relocation should be coordinated among the City, its consultant and HECO.

Our point of contact for this project, and the originator of these comments, is Michael Ho (543-7785) lead engineer. I suggest your staff and consultant deal directly with Michael to coordinate HECO's continuing input in this project.

Sincerely,

Kirk Tomita
Senior Environmental Scientist

cc: OEQC
David Bills (Gray, Hong, et al.)

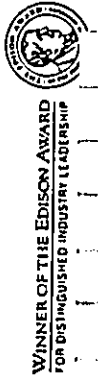

DEPARTMENT OF DESIGN AND CONSTRUCTION
CITY AND COUNTY OF HONOLULU

430 SOUTH KING STREET, 11TH FLOOR
HONOLULU, HAWAII 96813
PHONE: (808) 531-4544 FAX: (808) 531-4347
WEB SITE ADDRESS: www.cc.honolulu.hi.us



JEREMY HARRIS
MAYOR

RAEM LOUI, P.E.
DIRECTOR
ERIC G. CRISTEN, AIA
DEPUTY DIRECTOR
GEORGET T. TAMASIRO, P.E.
ASSISTANT DIRECTOR
CDEP 02-0169

June 20, 2002

Mr. Kirk Tomita
Senior Environmental Scientist
Hawaiian Electric Company
P. O. Box 2750
Honolulu, Hawaii 96840-0001

Attention: Mr. Michael Ho

Dear Mr. Tomita:

Subject: Draft Environmental Assessment (DEA)
Pooleka Street Drainage Improvements
TMK: 3-4-03: 10, 22, 24, 25, 20, 32, 33, 36 and 37
Palolo, Honolulu, Oahu, Hawaii

Thank you for your correspondence of June 7, 2002, regarding the subject project. We acknowledge that the proposed project area is served by HECO facilities. The DEA will also indicate the following:

1. Construction plans will be submitted for review by HECO.
2. Any work requiring temporary or permanent relocation will be coordinated among the City, its consultant and HECO.

Should there be any questions, please contact Gregory Sue at 527-6304. Again, thank you for your participation in the environmental review process.

Very truly yours,

RAEM M. LOUI, P.E.
Director

GS:dk

cc: Gray, Hong, Bills, Nojima & Associates, Inc.

APPENDIX B

PRELIMINARY COST ESTIMATE

PRELIMINARY COST ESTIMATE

ITEM	QUANTITY	UNIT PRICE	COST
18" Reinforced Concrete Pipe	460 LF	\$150/LF	\$ 69,000
Drain Inlet	3	\$8,500	24,000
Storm Drain Manhole	3	\$6,000	18,000
Outlet Structure	1	\$25,000	25,000
Relocation of Existing Utilities (utility pole and water laterals)	L.S.		10,000
Site Preparation, BMP, Erosion/Dust Control, etc.	L.S.		15,000
Restoration of Existing Improvements (Walls, driveways, pavement, etc.)	L.S.		12,000
Contingency	10%		17,000
TOTAL			\$190,000