

2003-09-08-0A-FEA

SEP 8 2003

FILE COPY

**Final
Environmental Assessment**

Roosevelt High School
Building A, Auditorium Renovation



STATE OF HAWAII
Department of Accounting and General Services
Public Works Division

August 2003

Final
Environmental Assessment

Roosevelt High School
Building A, Auditorium Renovation



prepared for
STATE OF HAWAII
Department of Accounting and General Services
Public Works Division

prepared by



KIMURA INTERNATIONAL

August 2003

Table of Contents

<u>Section</u>	<u>Page</u>
1 INTRODUCTION	1-1
1.1 Proposing Agency and Action	1-1
1.2 Purpose of the Environmental Assessment	1-1
1.3 Permits Required or Potentially Required	1-2
2 PROPOSED ACTION	2-1
2.1 Project Location and Description	2-1
2.1.1 Location	2-1
2.1.2 Background	2-1
2.1.3 Project Description	2-4
2.2 Project Purpose and Need	2-4
2.3 Project Schedule and Cost	2-8
2.4 Project Summary	2-9
3 AFFECTED ENVIRONMENT	3-1
3.1 Physical Environment	3-1
3.1.1 Geology and Topography	3-1
3.1.2 Soils	3-1
3.1.3 Climate and Air Quality	3-3
3.1.4 Natural Hazards	3-4
3.1.5 Hydrology	3-4
3.1.6 Noise	3-4
3.1.7 Hazardous Materials	3-6
3.2 Biological Environment	3-6
3.2.1 Flora	3-6
3.2.2 Terrestrial Fauna	3-7
3.3 Socio-Economic Environment	3-8
3.3.1 Population Characteristics	3-8
3.3.2 Scenic and Visual Resources	3-11
3.3.3 Archaeological, Historic, and Cultural Resources	3-12
3.4 Traffic and Circulation	3-13
3.4.1 Existing Conditions	3-13
3.4.2 Potential Impacts and Mitigation	3-15

<u>Section</u>	<u>Page</u>
3.5 Public Utilities	3-18
3.5.1 Drainage System	3-18
3.5.2 Water System	3-18
3.5.3 Wastewater System	3-19
3.5.4 Electrical and Telecommunications System	3-19
3.6 Public Health and Safety	3-20
3.6.1 Police Services	3-20
3.6.2 Fire and Emergency Medical Services	3-20
4 LAND USE PLANS, POLICIES, AND CONTROLS	4-1
4.1 Hawaii State Plan	4-1
4.2 State Land Use Classification	4-1
4.3 City and County of Honolulu Land Use Regulations	4-2
4.3.1 General Plan	4-2
4.3.2 Primary Urban Center Development Plan	4-3
4.3.3 Zoning	4-4
4.3.4 Special Management Area	4-4
4.3.5 Punchbowl Special District	4-5
5 POSSIBLE ALTERNATIVES	5-1
5.1 No Action	5-1
5.2 Delayed Action	5-1
5.3 Alternative Designs	5-1
5.4 Evaluation of Alternatives	5-2
6 DETERMINATION	6-1
7 FINDINGS AND REASONS SUPPORTING THE DETERMINATION	7-1
8 BIBLIOGRAPHY	8-1
9 ORGANIZATIONS AND AGENCIES CONSULTED IN THE PREPARATION OF THE DRAFT AND FINAL ENVIRONMENTAL ASSESSMENTS	9-1
9.1 Organizations Consulted During Preparation of the Draft EA	9-1
9.2 Review of the Draft EA	9-2

List of Figures

1	Location Map	2-2
2	TMK Map	2-3
3	Preliminary Site Plan	2-5
4	Elevations--Auditorium Addition	2-6
5	Elevations--Public Restroom	2-7
6	Soils Map	3-2
7	Preliminary Landscape Plan	3-7
8	Census Tracts	3-12
9	State Land Use	4-2
10	Primary Urban Center DP Land Use Map	4-4
11	Zoning	4-5
12	Punchbowl Special District.....	4-6

List of Tables

1	Potential Government Permits and Approvals	1-2
2	Project Summary	2-9
3	Demographic Characteristics of Census Tract 33 and Surrounding Areas.....	3-11
4	Existing Traffic Volumes.....	3-16

1 INTRODUCTION

1.1 PROPOSING AGENCY AND ACTION

The State of Hawaii Department of Accounting and General Services (DAGS) proposes to renovate and expand the Roosevelt High School Auditorium, Honolulu, Hawaii. The project is being implemented on behalf of the State of Hawaii Department of Education.

1.2 PURPOSE OF THE ENVIRONMENTAL ASSESSMENT

Under Chapter 343, Hawaii Revised Statutes (HRS), Act 241, Session Laws of Hawaii (SLH) 1992, and Chapter 200 of Title 11, Department of Health (DOH) Administrative rules, "Environmental Impact Statement Rules," the proposed project involves the use of public funds and is therefore subject to the environmental review process.

Draft and Final Environmental Assessments were prepared to address potential impacts that may occur during construction and/or operation of the renovated auditorium. It was determined that the project will have no significant impact, and an Environmental Impact Statement will not be required.

This Final Environmental Assessment and Finding of No Significant Impact (FONSI) are being filed with the State Office of Environmental Quality Control (OEQC) in accordance with Chapter 343, HRS. The accepting agency for the Final Environmental Assessment is the State of Hawaii Department of Accounting and General Services.

1.3 PERMITS REQUIRED OR POTENTIALLY REQUIRED

Governmental permits needed to implement the proposed action are listed in Table 1.

Table 1: Potential Government Permits and Approvals

Type	Agency
HRS Chapter 6E Historic Preservation Review	Department of Land and Natural Resources, State Historic Preservation Division
Waiver from Punchbowl Special District height limit (<i>25-ft maximum height</i>)	City and County of Honolulu, Department of Planning and Permitting
Construction and grading permits	City and County of Honolulu, Department of Planning and Permitting, Civil Engineering Branch
Minor Special District Permit for removal of trees (<i>for removal of any tree six inches of greater in diameter within the Special District</i>)	City and County of Honolulu, Department of Planning and Permitting
Noise permit	State Department of Health, Noise, Radiation, and Indoor Air Quality Branch

2. PROPOSED ACTION

2.1 PROJECT LOCATION AND DESCRIPTION AND LOCATION

2.1.1 Location

The proposed project involves the renovation and expansion of an existing auditorium located in Building A at Roosevelt High School, Honolulu, Hawaii. Roosevelt High School is located on the southeastern slope of Punchbowl Crater, in central Honolulu. The school's 19.951-acre campus fronts Nehoa Street, bordered by Mott-Smith Drive and Auwaiolimu Street (Figure 1). As shown in the figure, Abraham Lincoln Elementary School and Robert Louis Stevenson Middle School are also located in close proximity to Roosevelt High School, and are part of the State Department of Education's "Roosevelt High School Complex."

The project is located in TMK 2-4-32:001. The parcel boundary is shown in Figure 2.

2.1.2 Background

President Theodore Roosevelt High School was established in 1930 as the only public, English-standard secondary school in the (then) Territory of Hawaii. The English-standard system was established in an effort to facilitate the Americanization process of the Territory's schoolchildren. It offered an educational system patterned after the American standard school system. Admission to English-standard schools required students to pass an oral English entrance exam.

The school was constructed on a piece of government-owned land referred to at the time as the Marine hospital site. Between 1883 and 1927, the site was occupied by the Lunalilo Home, an institution for aged and infirm Hawaiians. Its creation was willed by the estate of William Charles Lunalilo, Hawaii's sixth king.

Building A was the first building at the new high school to be constructed in 1932. The H-shaped building was designed in the Spanish Revival style of architecture, and is currently listed on the State Register of Historic Places. Building A is two and three stories high, about 50-feet in height, with red tile roofing shingles. Its east wing includes the school's distinctive domed tower. The square-shaped tower is approximately 75 feet in height and its dome is painted red and gold, the school's colors. During World War II, the tower was utilized by U.S. Army sentries, as a post to search for enemy bombers. Today, the tower is the school's architectural signature and a neighborhood landmark.

DOCUMENT CAPTURED AS RECEIVED

Roosevelt High School Auditorium Renovation
Final Environmental Assessment

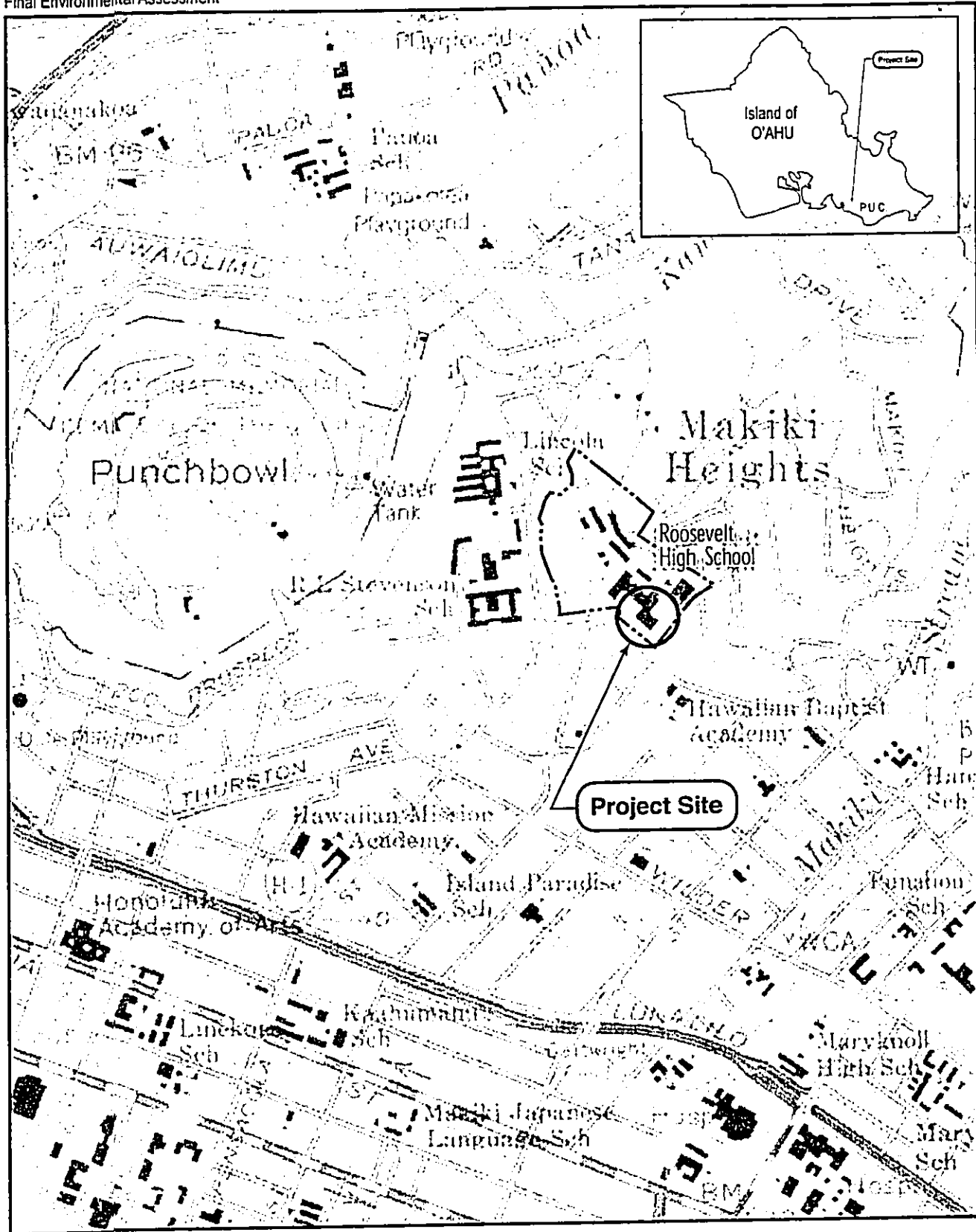

Source: USGS 1982, Visicom 1999

May 2003

0 SCALE IN FEET 1000



Figure 1
Location

Roosevelt High School Auditorium Renovation
Final Environmental Assessment

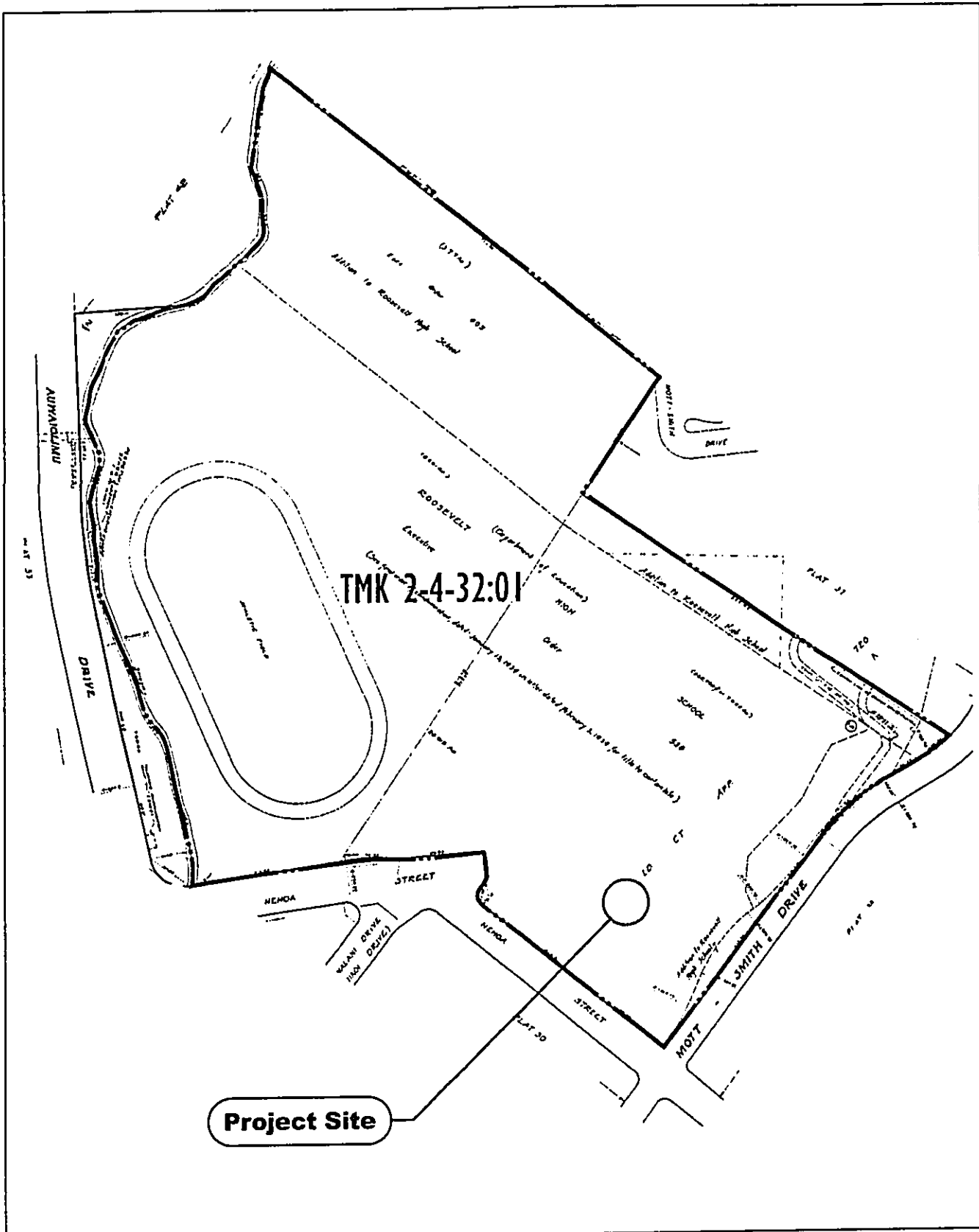

Source: C&C of Honolulu GIS, 2002

May 2003

0 SCALE IN FEET 200



Figure 2
Tax Map

The George Robert Carter Auditorium was added to Building A in 1936, abutting the front of the tower, and located parallel to Nehoa Street. The auditorium was named after the former Governor of the Territory of Hawaii from 1903 to 1907. Other uses in Building A include administrative offices, library, cafeteria/dining areas, and classrooms.

2.1.3 Project Description

The proposed project involves a renovation and expansion of the existing 983-seat Carter Auditorium to create a modern, performing arts facility/auditorium. The renovated facility will support general school activities (assemblies, etc.), band and theatre performances, and certain classes. The auditorium may be made available for general community use on a selective basis as determined by the school.

Figure 3 illustrates the preliminary project site plan. The existing auditorium, approximately 11,400 square feet in size, will be enlarged by some 11,000 square feet to develop a fully functioning theatre facility. Proposed work includes extending and enlarging the stage, construction of a new lobby at the front of the auditorium, addition of a scene shop/costume shop/dressing rooms at the back of the auditorium, and addition of a side stage area, restrooms and mechanical space on the north side. A net decrease of 233 seats is proposed, and the new auditorium will seat 750 persons. New restroom facilities are proposed in the existing courtyard area. Figures 4 and 5 show elevations of the building additions at the back of the auditorium and the in the entry courtyard.

The auditorium is currently used for assemblies such as graduation and school spirit activities. The wrestling team uses the stage for team practice by placing tumbling mats down. Drama and other classes still utilize the stage, and the basement is used for Polynesian/music classes and rehearsals. These uses will be relocated during construction, possibly into existing facilities or in temporary portable classrooms.

In order to meet federal Americans with Disabilities Act (ADA) requirements, the project will construct ramps and wheelchair locations within the auditorium. Two ADA parking stalls will be located at the north side of the auditorium, near the existing parking area. An accessible path will run along the side of the auditorium. A wheelchair lift will provide access down a stairway that leads to a pair of side entry doors.

Previously, handicapped access was proposed via a new driveway, vehicle turnaround and parking area off Nehoa Street. However, this proposal was revised due to traffic safety concerns associated with a new driveway on Nehoa Street, as well as potential impacts to the large *Ficus benjamina* tree in front of the school.

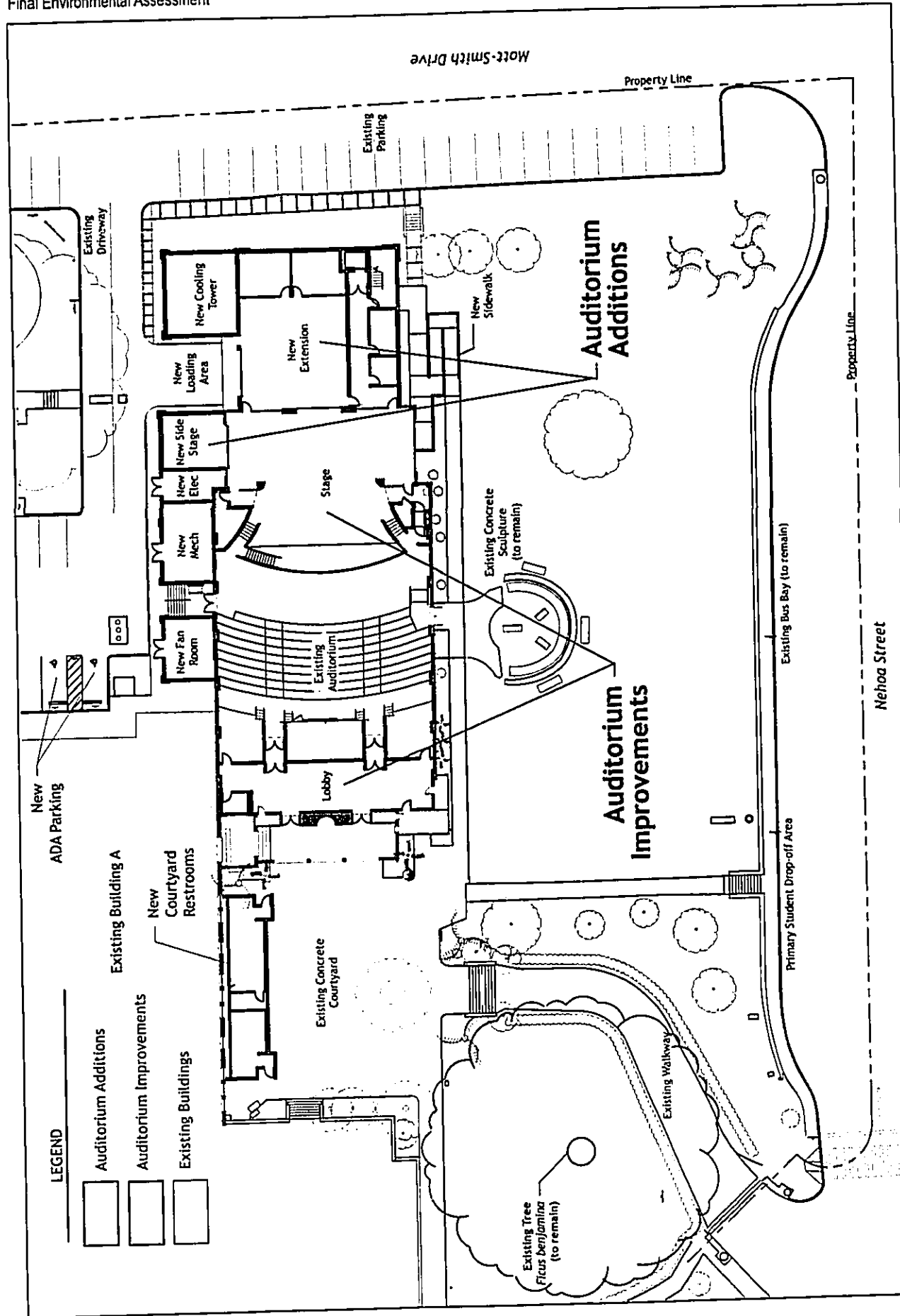

LEGEND

- Auditorium Additions
- Auditorium Improvements
- Existing Buildings

Figure 3
Preliminary Site Plan

Source: CDS International

August 2003

0 SCALE IN FEET 50



Roosevelt High School Auditorium Renovation
 Final Environmental Assessment

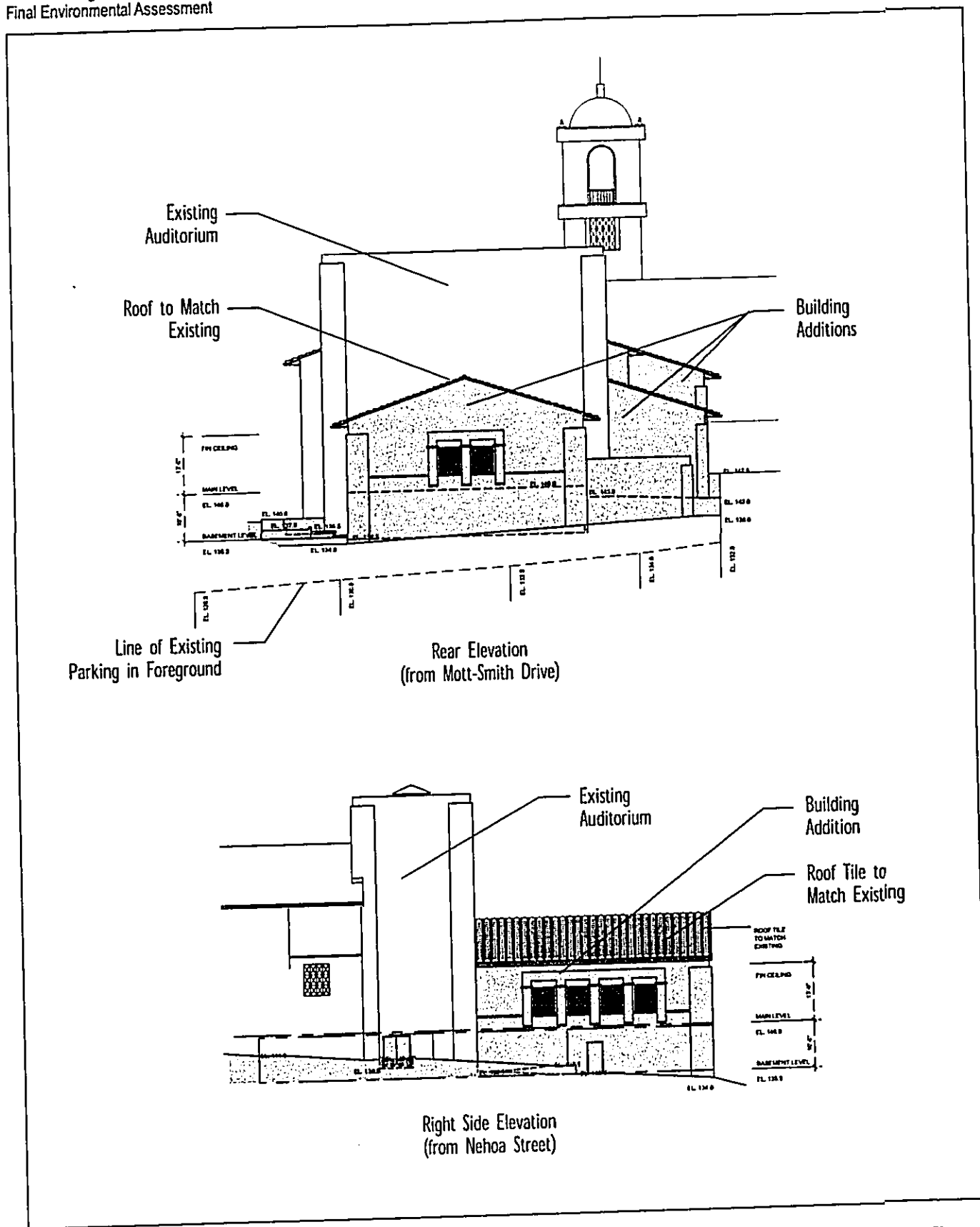

Source: CDS International

May 2003

0 SCALE IN FEET 30

Figure 4

Elevations - Auditorium Addition

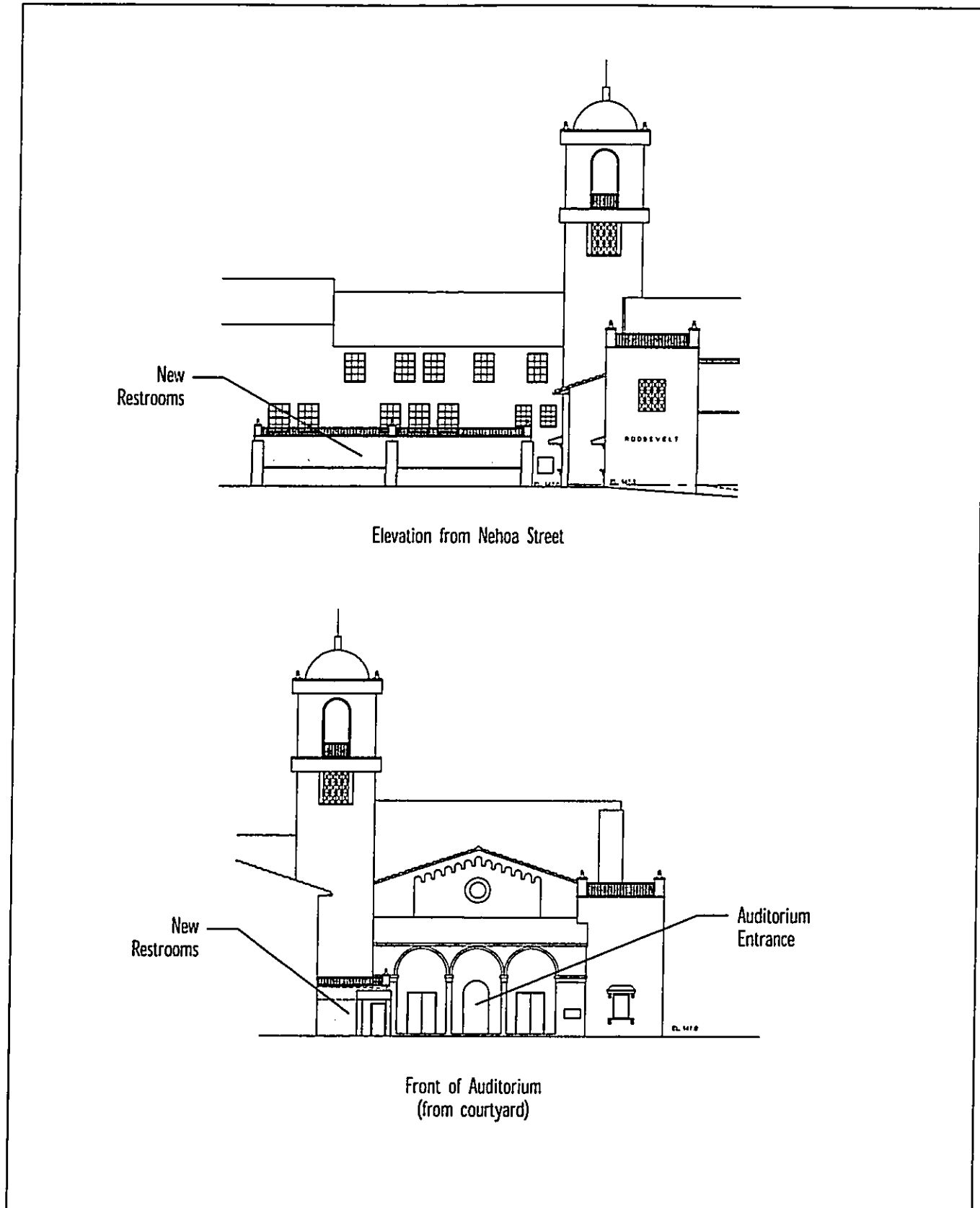

Source: CDS International

May 2003

0 SCALE IN FEET 30

Figure 5

Elevations - New Restrooms

2.2 PROJECT PURPOSE AND NEED

The project is needed to provide an updated and more efficiently designed facility to accommodate school events as well as serve the larger community. The existing auditorium, while large, is 70 years old and does not meet current design standards for performing arts or auditoriums. The stage configuration, poor acoustics and lighting, and outdated utility systems severely limit its use. For example, the school band has not performed in the existing auditorium for over 10 years, in part because the stage is structurally inadequate to support the band and all its equipment. There are small dressing rooms, no restroom facilities, and storage space is limited. The auditorium is not air conditioned, making it difficult to use for large performances, events or meetings. In addition, existing facilities do not meet federal ADA accessibility requirements.

Despite its physical limitations, the present seating capacity of the auditorium is the largest of any public or private school auditorium in the state. This gives the facility very high potential for future multi-purpose use, including use by the larger community.

The renovation of the Carter Auditorium is part of an overall master plan developed by the school and larger community. Participants in the planning effort included Roosevelt High School faculty, students, and alumni, community members, representatives from the State Department of Education, and elected officials.

Over the course of several months, participants came up with a list of desired improvements to the physical campus as well as to the school's curriculum. One of the highest priority items was physical improvement of Carter Auditorium. The master plan specified a complete renovation of the auditorium, installation of air conditioning, more storage, upgraded seating, a new stage, and new lighting and sound systems.

The master plan envisioned a multi-purpose, performing arts center to support the band program, theatre and performing arts, school assemblies and special events.

2.3 PROJECT SCHEDULE AND COST

Conceptual plans have been developed, and the project design phase has begun. The design phase is expected to extend through the first quarter of 2004. However, the design will be generally as described in this Final Environmental Assessment and Finding of No Significant Impact (FONSI). Total construction costs are estimated at \$7,322,000, and the project is proposed for construction in three phases. Currently, \$4,383,000 has been approved for Phase I, which includes work on the existing auditorium interior and mechanical/electrical equipment. Construction is expected to begin in mid-2004, and last approximately 13 months, with completion in 2005. Phase II consists of further work on the existing auditorium and the courtyard restroom. Phase III consists of the building extension. The project is funded by the State of Hawaii Department of Education, with the Department of Accounting and General Services the designated expending agency.

2.4 PROJECT SUMMARY

Table 2 contains a description of the project and applicable land-use designations.

Table 2: Project Summary

Item	Description
Project Name	Roosevelt High School Building A, Auditorium Renovation
Applicant	State of Hawaii Department of Accounting and General Services, on behalf of State of Hawaii Department of Education
Address	1120 Nehoa Street, Honolulu, Hawaii
Tax Map Keys	2-4-032:001
Existing Uses	Auditorium (983 seats). <i>(Other uses in Building A include administrative offices, library, cafeteria/dining areas, and classrooms. These will not be impacted by the project.)</i>
Proposed Project	Enlarge existing auditorium by some 11,000 SF to develop a fully functioning theatre facility. Extend and enlarge the stage, construct new lobby. Net decrease of 233 seats, new auditorium will seat 750 persons. Addition at back of auditorium to include scene shop/costume shop/dressing rooms. Addition at north side to include side stage area, mechanical space and cooling tower. New public restrooms to be added in existing courtyard near front of auditorium.
State Land Use	Urban
Primary Urban Center Development Plan Land Use	Institutional
Special District	Punchbowl Special District
Zoning	R-5 Residential (allows school use subject to site plan review)
Flood Insurance Rate Map	Zone X (outside of 500-year flood plain)

3 AFFECTED ENVIRONMENT, IMPACTS AND MITIGATION

3.1 PHYSICAL ENVIRONMENT

3.1.1 Geology and Topography

Roosevelt High School is constructed on a sloping site that ranges in elevation from 100 to 200 feet mean sea level (MSL). The school buildings are constructed on three graded and terraced levels to accommodate the hilly topography. When the campus was initially planned, portions of the hillside at the back of the school were cut away to create room for future expansion. The auditorium, located on a knoll fronting Nehoa Street, ranges in elevation from 147 ft elevation at the front of the auditorium (west/Ewa side) to an elevation of 136 ft MSL at the back of the building (east/Diamond Head side).

3.1.2 Soils

The soils around Roosevelt High School are designated as mixed Fill Land (FL) by the U.S. Department of Agriculture Soil Conservation Service. Surrounding areas include soils from the Tantalus series, Tantalus silty clay loam (TCC and TCE). Figure 6 shows the locations of various soils in the project area.

Fill Land, mixed (FL)

This soil type occurs mostly near Pearl Harbor and in Honolulu, adjacent to the ocean. It consists of areas filled with material dredged from the ocean or hauled from nearby areas, garbage, and general material from other sources. This land type is used for urban development.

Tantalus silty clay loam, 8 to 15 percent slopes (TCC)

The Tantalus series consists of well-drained soils on uplands on Oahu. These soils developed in volcanic ash and material weathered from cinders. They are moderately sloping to very steep. Tantalus silty clay loam, 8 to 15 percent slopes (TCC) has slow runoff and slight erosion hazard.

Tantalus silty clay loam, 15 to 40 percent slopes (TCE)

Tantalus silty clay loam, 15 to 40 percent slopes (TCE) has medium runoff and moderate erosion hazard.

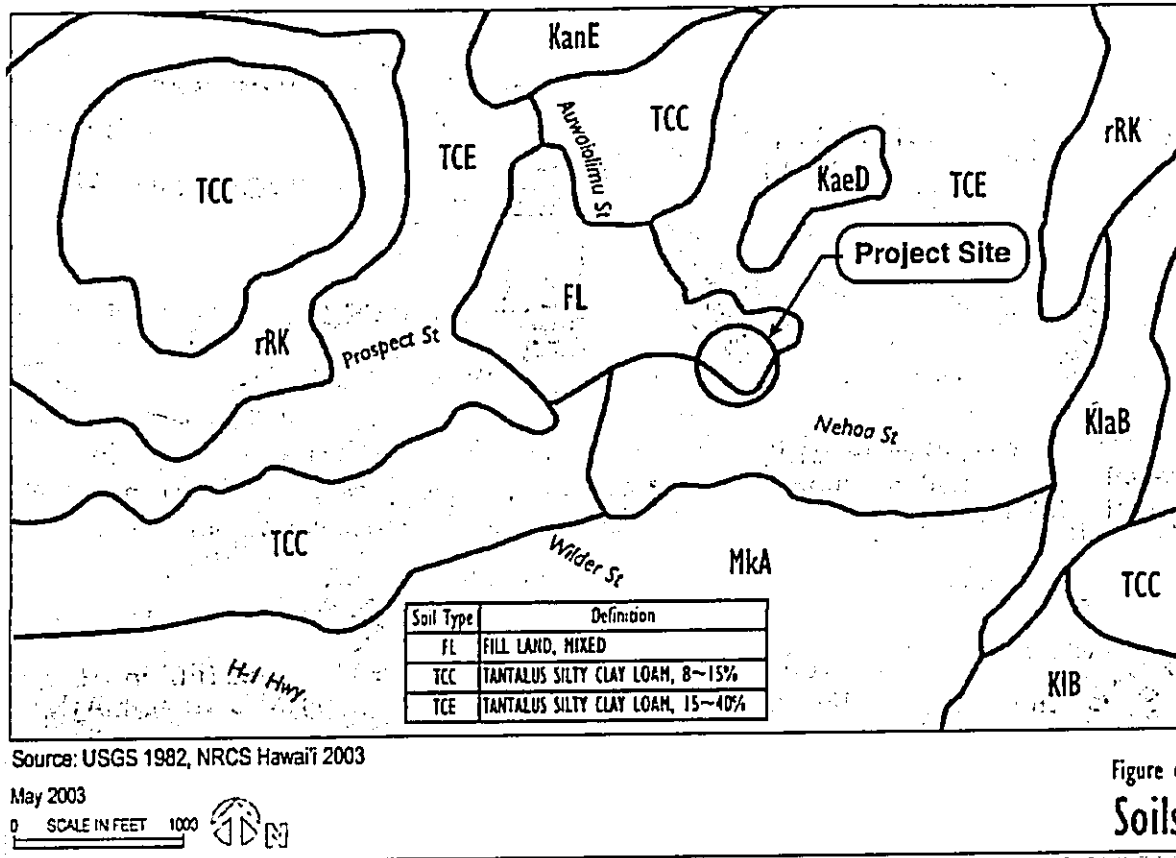

Figure 6:
Soils

Potential Impacts and Mitigation Measures

The proposed renovation and construction will not adversely impact soils in the project area. All construction will occur in existing structures or in paved or grassed areas; therefore soil exposure will be limited.

Any impact of construction activities on soils will be mitigated by several measures, as outlined in the following regulations:

- City and County of Honolulu’s Grading, Grubbing and Stockpiling Ordinance No. 3968, (1972);
- Department of Planning and Permitting, Rules relating to Soil Erosion Standards and Guidelines, (1999);
- USDA Soil Conservation Services Erosion and Sediment Control Guide for Hawaii, (1968).

Best construction management practices restrict stockpiling of construction material and call for proper disposal of construction debris. Regular watering is recommended as a means of reducing the amount of fugitive dust in the air.

3.1.3 Climate and Air Quality

For most of Hawaii, there are only two seasons: "summer," between May and October, and "winter," between October and April. Most of the rain falls in winter storms from November through January while summer months are dry. The climate in the project area is typical for Honolulu as a whole. During the winter, normal average rainfall in Honolulu ranges from three to four inches per month. During the drier summer months, rainfall averages one to two inches per month. During the summer, temperatures in Honolulu typically range from a high of 88.7 degrees Fahrenheit to a low of 74.2 degrees Fahrenheit. In January, temperatures range from a high of 80.1 to a low of 65.6 degrees Fahrenheit. (National Weather Service).

The State Department of Health operates a network of air quality monitoring stations located at various locations on Oahu. Air quality on Oahu is generally good, meeting all national ambient air quality standards. Vehicular traffic is the major source of air pollutants. However, the vehicular traffic levels near the project area are not high enough to significantly degrade air quality. Prevailing northeast trade winds also help to keep pollution levels low.

Potential Impacts and Mitigation Measures

Climatic conditions are not expected to have a significant affect on the project. Temporary and localized negative impacts on air quality will occur in areas adjacent to the construction site. Equipment used during the construction phase will emit exhaust and airborne particulates, and construction work will produce dust. Due to the close proximity of school classroom and administrative facilities, appropriate mitigation measures will be employed to reduce the potential for fugitive dust during construction activities. These mitigation measures include the following:

- Dust screen barrier will be erected during construction of the expanded building area.
- Stockpiles will be covered with appropriate materials. Construction debris will be disposed of at permitted facilities.
- The contractor will sprinkle water, as necessary, to control dust.
- The contractor will use vehicles that are properly maintained.

Construction activities will employ fugitive dust emission control measures in compliance with provisions of the State DOH Rules and Regulations (Chapter 43, Section 10), and Hawaii Administrative Rules (HAR), Chapter 11-60.1, "Air Pollution Control," Section 11-60.1-33 on Fugitive Dust.

3.1.4 Natural Hazards

Flood Zone

The State of Hawaii Civil Defense Tsunami Evacuation Zone Map and the Federal Emergency Management Agency (FEMA) Flood Insurance Rate Map (FIRM) indicate that the project site is not vulnerable to tsunami or flood inundation.

According to the Federal Emergency Management Agency (FEMA)–Flood Insurance Rate Map (FIRM), Roosevelt High School and surrounding areas are located in Zone X, areas determined to be outside the 500-year flood plain.

Seismic Activity

The Uniform Building Code (UBC) provides minimum design criteria to address potential for damages due to seismic disturbances. The UBC scale is rated from Seismic Zone 1 through Zone 4, with 1 the lowest level for potential seismic induced ground movement. Oahu has a Seismic Zone 1 designation. In the interest of public health and safety, DAGS has adopted UBC Seismic Zone 3 standards for all its structures and projects, including this project.

Potential Impacts and Mitigation Measures

Flooding is not anticipated to affect the proposed project. During construction, the potential for impacts due to storm runoff will be addressed by use of erosion control measures in accordance with City and County of Honolulu, Rules relating to Soil Erosion Standards and Guidelines, 1999, and Erosion and Sediment Control Guide for Hawaii, Soil conservation Service, 1968.

3.1.5 Hydrology

Kanaha Stream runs adjacent to the western boundary of Roosevelt High School near Auwaiolimu Street. The stream meets Kanealole Stream and joins Makiki Stream near the intersection of Wilder Avenue and Makiki Street. Kanaha Stream and Kanealole Stream are tributaries to Makiki Stream, which eventually joins the Ala Wai Stream before emptying into the ocean. The Hawaii Stream Assessment (Commission on Water Resource Management, 1990) identifies the Ala Wai Stream system (Code 3-3-07s) as a “small stream,” defined as streams with median flows less than or equal to 10 cubic feet per second (cfs) or average flows less than or equal to 20 cfs. These streams are located within the larger Ala Wai Watershed, the area that drains into the Ala Wai Canal and nearshore waters of Waikiki. The Ala Wai Watershed is comprised of seven sub-watersheds. Kanaha Stream is within the “Makiki, Punchbowl, Tantalus & Papakolea” sub-watershed.

In recent years, a non-profit community group called the Ala Wai Watershed Association has organized watershed clean up and restoration activities, including Kanaha Stream restoration. Students from Roosevelt High School have participated in the Kanaha Stream restoration, which has included stream clean-up and revegetation with native plants.

Potential Impacts and Mitigation Measures

The proposed auditorium renovation will not permanently alter the land surface or increase the amount of impervious surfaces. Therefore, it is not expected to increase the amount of surface runoff. The project will not impact Kanaha Stream or the Ala Wai watershed.

There are no potable groundwater sources in the vicinity of the project site. Groundwater contamination will not be a problem.

3.1.6 Noise

Existing noise levels in the project area are consistent with similar urban environments. Traffic along Nehoa Avenue is the primary noise generator, particularly during the morning and afternoon school rush hours.

The surrounding neighborhood is primarily residential in character. The Department of Health's (DOH) maximum permissible noise levels for construction equipment during nighttime hours in residential areas is 45 dBA and 55 dBA during daytime hours or the ambient noise level—whichever is higher.

Potential Impacts and Mitigation Measures

Construction activities will generate noise that may have a short-term impact on some school activities and adjacent land uses. Typical ranges of construction equipment noise vary between 70 and 95 dBA. Because much of the renovation will take place inside the auditorium, noise impacts to adjacent classrooms or residences should not be significant. Construction of the building additions, new driveway and parking area will generate noise, but these areas are not immediately adjacent to classrooms or offices. Construction noise could also impact some homes across Mott-Smith Drive. The closest existing residences are located about 80 feet from the back of the auditorium where a building addition will be constructed. These noise impacts are unavoidable, but will be temporary.

All construction activities will comply with the DOH Administrative Rules Chapter 11-46 on Community Noise Control. In cases where construction noise exceeds, or is expected to exceed the DOH's "maximum permissible noise levels at the school property line, a permit will be obtained from the DOH to operate vehicles, construction equipment, power tools, etc. that emit noise levels in excess of "maximum permissible" levels. To reduce the noise impact of construction activities, exterior work will be conducted during the daytime hours. The contractor may be permitted to work within the auditorium interior at night.

Construction equipment and on-site vehicles that exhaust gas or air must be equipped with mufflers. Construction vehicles using roadways are also required to satisfy the DOH's vehicular noise requirements.

The project includes exterior mechanical equipment such as a new cooling tower that will generate noise. The design team will work with an acoustical consultant during the design phase to develop appropriate mitigation for operational noise generated by mechanical equipment. Potential mitigation measures for mechanical equipment noise include equipment inlet and outlet silencers, acoustical louvers, sound-rated wall constructions, sound-rated doors, acoustical absorption on mechanical room walls, and spring or neoprene isolators.

During the design phase, presentation(s) to the Makiki/Punchbowl/Tantalus Neighborhood Board will be made to inform the community about the specific mechanical equipment proposed, its location, anticipated noise levels, and proposed mitigation measures. Noise levels from exterior mechanical equipment will meet State noise regulations.

3.1.7 Hazardous Materials

A State-funded asbestos removal and repairs project for portions of the auditorium was recently completed. That project removed and replaced the existing asbestos acoustical sprayed ceiling (which also was painted with lead paint) and walls and replaced them with new acoustical spray. The projector room areas, which had vinyl composition tiles with asbestos, were also replaced with new vinyl composition tiles. Asbestos-containing flooring was removed and replaced with new tile flooring. Existing lead paint was painted over within the auditorium space.

Potential Impacts and Mitigation Measures

The recently completed project tested for lead and asbestos only in the auditorium and projection room areas. The basement level was never tested. As part of the proposed auditorium renovation, basement areas will need to be tested to determine areas that may require further hazardous materials removal.

During project renovation, all hazardous materials will be removed and disposed of in accordance with State of Hawaii standards.

3.2 BIOLOGICAL ENVIRONMENT

3.2.1 Flora

Existing vegetation in the areas proposed for expansion of the auditorium is primarily introduced trees, shrubs and grass. There are no rare, endangered, or threatened species of plants in the project area or on the school campus.

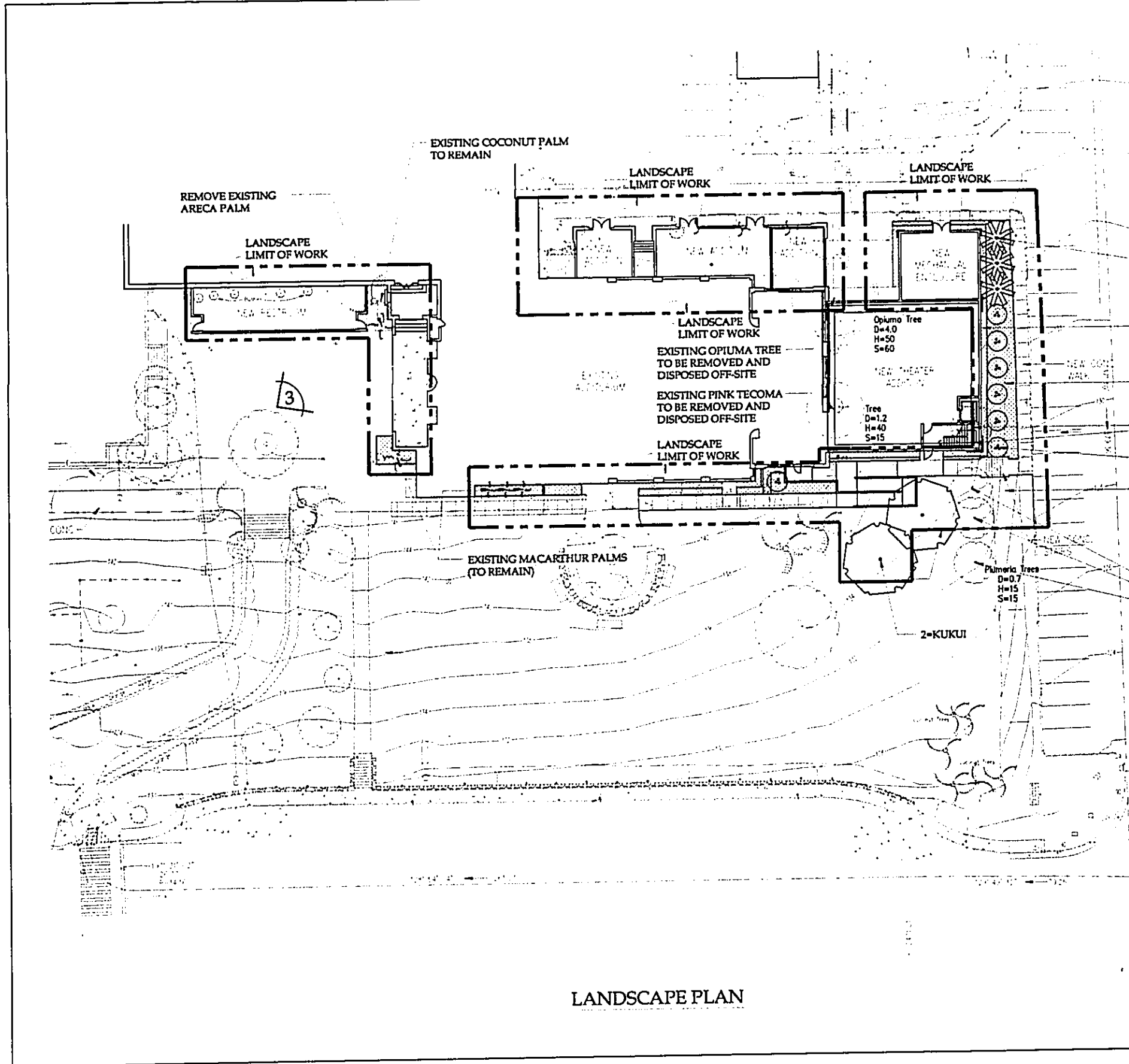

LANDSCAPE PLAN

Source: CDS International, 8/21/2003

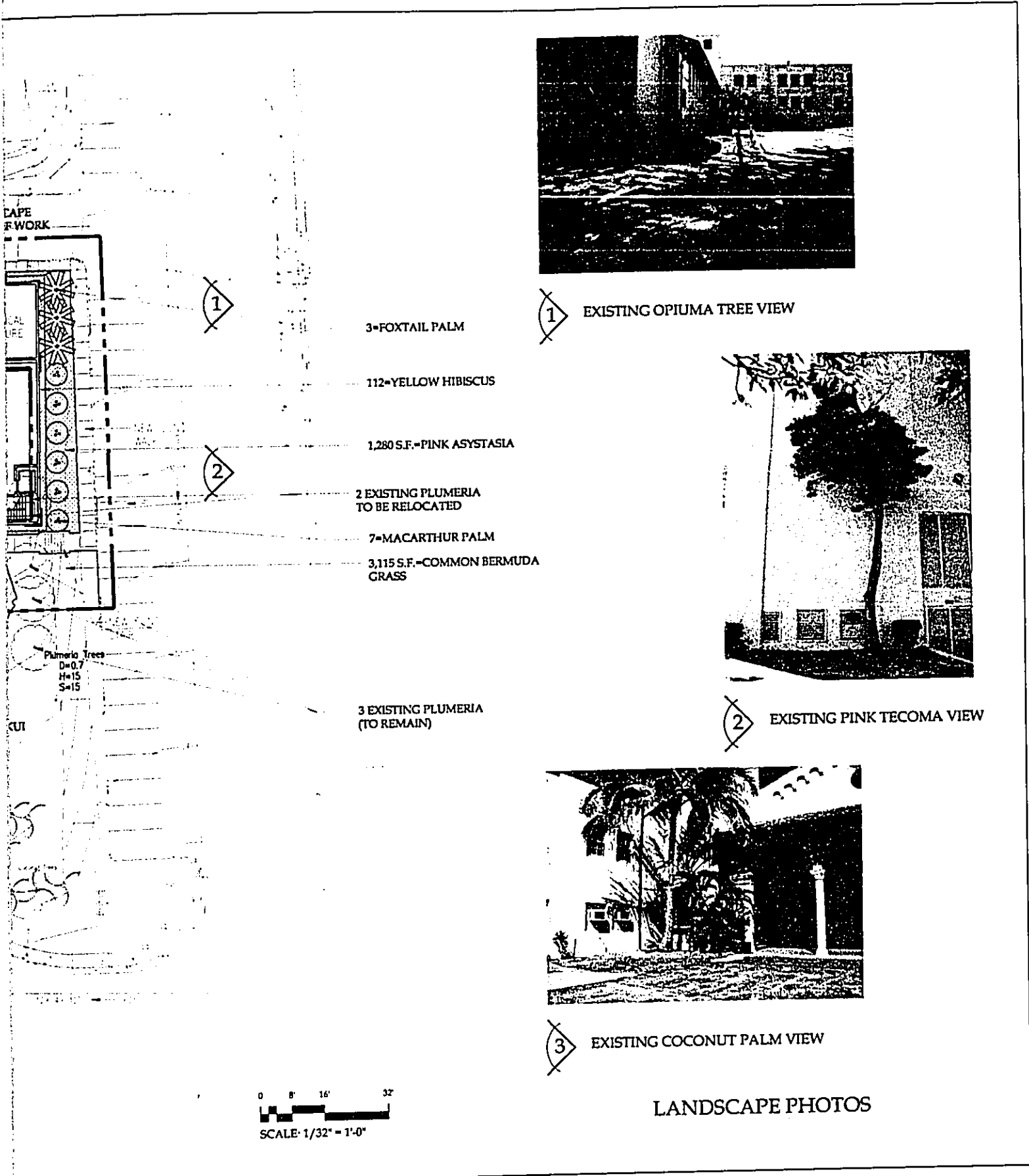

Figure 7
Preliminary Landscape Plan

The large, *Ficus benjamina* tree near the front courtyard on Nehoa Street has been nominated and approved as an "exceptional tree" by the City and County of Honolulu Mayor's Arborist Advisory Committee. Exceptional trees are trees that are recognized for their historic and cultural value due to their age, rarity, location, size, aesthetic quality and endemic status. They are protected by Hawaii State law (HRS Chapter 58) and by City and County of Honolulu ordinance.

The tree at the Roosevelt High School campus was nominated due to its age (over 75 years old), location, size and aesthetic quality. Its huge canopy shades and beautifies the entry to the historic campus. In addition, its location in the Punchbowl Special District contributes to its "exceptional" status.

Potential Impacts and Mitigation Measures

A preliminary landscape plan is shown in Figure 7. The figure shows existing vegetation in the project area, what vegetation will be impacted by the project, and the proposed landscaping around the new building addition. The project will not have an impact on rare, threatened or endangered plants. The project will not impact the exceptional *Ficus benjamina* tree near the front of the school.

Several mature trees will need to be removed as part of the project construction, including two plumeria trees, an opiuma (*Pithecellobium dulce*) and a pink tecoma (*Tabebuia sp.*). The plumeria trees will be relocated to an area south of three remaining plumeria trees, near Mott Smith Drive. The opiuma and pink tecoma trees, located near the back of the existing auditorium, cannot be relocated. Due to their proximity to the existing building, half of their root balls would need to be cut.

Due to the project's location within the Punchbowl Special District, removal of trees six inches or greater in trunk diameter will require a Minor Special District Permit from the Department of Planning and Permitting. Where possible, trees proposed for removal must be relocated to another area of the project site.

The project designers have been coordinating with The Outdoor Circle (see correspondence in Chapter 9). As requested by The Outdoor Circle, a certified arborist will conduct an assessment of affected trees within the project boundaries, and will prepare a tree protection plan. These documents will be submitted to The Outdoor Circle, as well as the City and County of Honolulu.

3.2.2 Terrestrial Fauna

Fauna in the project area would most likely include naturalized introduced species that have adapted readily to the human environment. Among the species commonly found in residential areas are rats (*Rattus sp.*), house mouse (*Mus musculus*), domesticated cats (*Felis catus*) and domesticated dogs (*Canis familiaris familiaris*). Avian species should include common Mynas (*Acridotheres tristis*), Spotted dove (*Streptopelia chinensis*) and

Zebra dove (*Geopelia striata*), House finch (*Carpodacus mexicanus*), English sparrow (*Passer domesticus*), Java sparrows (*Padda oryzivora*), and pigeons (*Columba livia*).

Potential Impacts and Mitigation Measures

The developed project area does not support native wildlife or threatened or endangered species or their habitats. The project will not have any adverse impact on wildlife resources in the area.

3.3 SOCIO-ECONOMIC ENVIRONMENT

3.3.1 Population Characteristics

Roosevelt High School is surrounded by residential neighborhoods with greatly varying socio-economic characteristics. Just over its western boundary is Papakolea Hawaiian Homestead, comprised of lower to lower-middle income native Hawaiian and part-Hawaiian families. The residential area across Nehoa Street is a middle income neighborhood, and further *makai* is an area zoned for high-rise apartments and condominiums. To the east and rear of the campus are middle to upper-middle income residential areas.

The school is located in Census Tract (CT) 33 (Makiki Heights). As shown in Figure 8, surrounding census tracts also include CT 44 (Pauoa), CT 43 (Puowaina), CT 34.03 (Thurston Street), 34.04 (Wilder-Lewalani), 34.05 (Punahou-Keeaumoku), CT 30 (Manoa), and CT 32 (Round Top-Tantalus)¹. The school's student population draws from these, as well as other census tracts.

According to data from the 2000 U.S. Census, CT 33 had a total population of 832 persons. Of this number, approximately 20.7% were white, 60.5% Asian, 3.1% Native Hawaiian/Pacific Islander alone, and 15.1% were or two or more races. Median household income in this census tract was \$79,563 in 1999, compared to the Honolulu County-wide median of \$51,914.

Table 3 presents a demographic profile of CT 33, its surrounding census tracts and the County as a whole. Compared to the County as a whole, CT 33 has a higher percentage of individuals identifying themselves as Asian (alone) (60.5% vs. 46.0%) and a lower percentage of Hawaiian/Pacific Islanders (3.1% vs. 8.9%).

¹ Data from the U.S. Census Bureau website at www.census.gov.

Table 3: Demographic Characteristics of Census Tract 33 & Surrounding Areas

	CT 33, Makiki Heights	CT 44, Pauoa	CT 43, Puowaina	CT 34.03, Thurston Street	CT 34.04, Wilder- Lewalani	CT 34.05, Punahou Keeau- moku	CT 30, Manoa	CT 32, Roundtop -Tantalus	Honolulu County
Total Population	832	5,173	5,473	5,195	4,623	3,066	4,140	885	876,156
Race (% of CT total population)									
--White (alone)	20.7%	7.6%	16.6%	25.2%	19.8%	27.3%	29.5%	43.2%	21.3%
--Black (alone)	0.0%	0.4%	0.8%	1.0%	1.3%	1.6%	0.2%	0.3%	0.3%
--Native American (alone)	0.1%	0.1%	0.2%	0.2%	0.3%	0.2%	0.1%	0.0%	0.2%
--Asian (alone)	60.5%	46.9%	49.7%	53.6%	58.2%	47.5%	54.3%	28.1%	46.0%
--Hawaiian/ Pacific Islander (alone)	3.1%	22.4%	9.6%	4.9%	5.3%	5.9%	2.4%	8.7%	8.9%
--Other race (alone)	0.4%	0.4%	1.6%	0.5%	1.0%	1.6%	0.6%	1.2%	1.3%
--Two or more races	15.1%	22.2%	21.4%	4.6%	14.2%	15.9%	12.8%	18.4%	19.9%
Average Household Size	2.67	3.19	2.39	1.96	1.95	1.78	2.65	2.73	2.95
1999 Median Household Income	\$79,563	\$57,426	\$35,924	\$41,753	\$40,220	\$31,686	\$77,299	\$101,167	\$51,914

As shown in the table, the racial make up of the surrounding census tracts varies significantly. For example, CT 32 (Roundtop-Tantalus) has a relatively high percentage of individuals identifying themselves as white only (43.2%), compared to only 7.6% in CT 44 (Pauoa) and 21.3% County-wide. CT 44 (Pauoa) has a relatively high percentage of Hawaiian/Pacific Islanders (22.4%) compared to the County (8.9%).

Median household income also varies significantly for the surrounding census tracts, ranging from \$31,686 in CT 34.05 (Punahou-Keeaumoku) to over \$100,000 in CT 32 (Roundtop-Tantalus). The latter is nearly twice the County-wide median income.

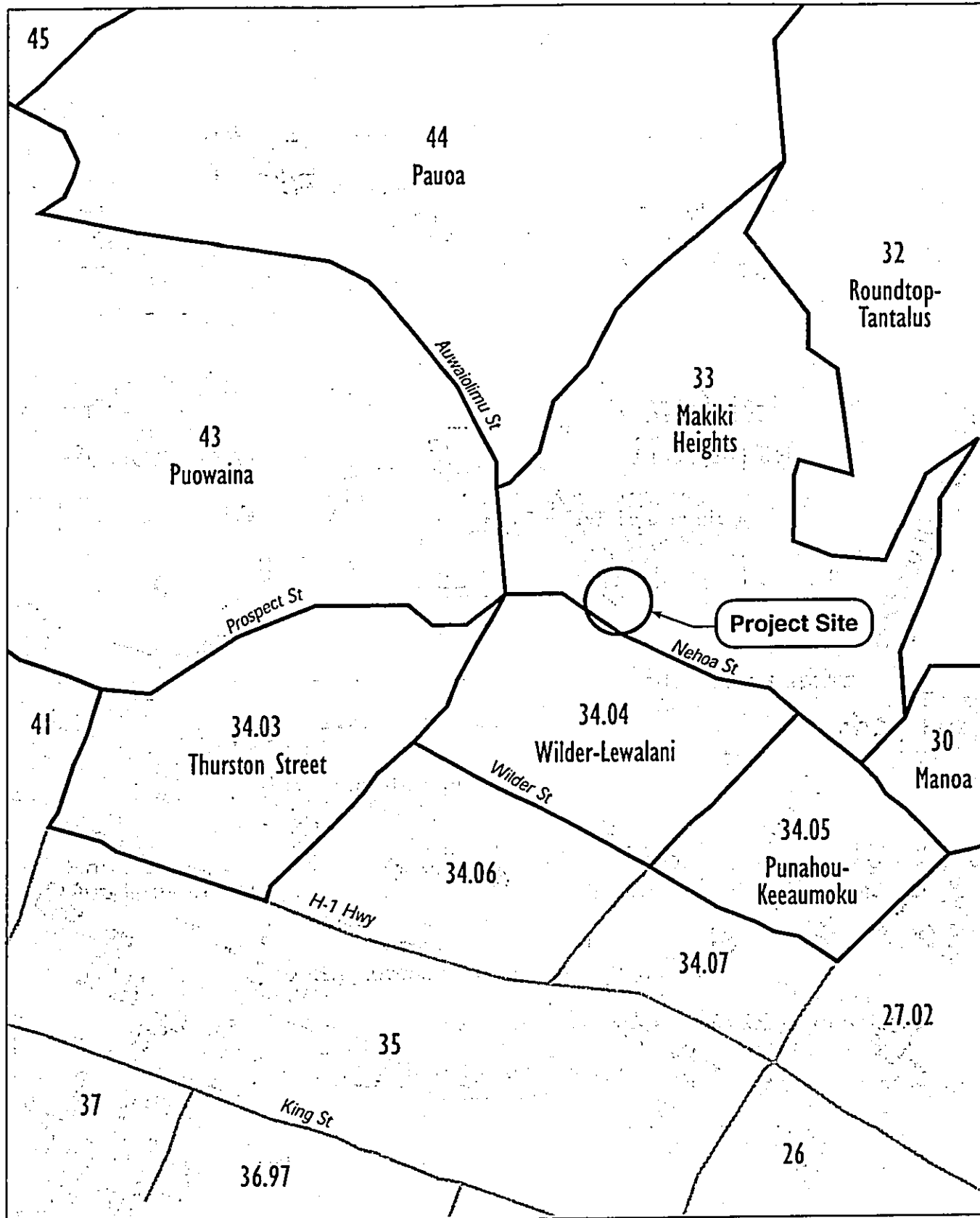

Source: USGS 1982, C&C of Honolulu 2002

May 2003

0 SCALE IN FEET 1000



Figure 8

Census Tracts

Potential Impacts and Mitigation Measures

The proposed project will not affect population levels, income or household characteristics. The proposed auditorium improvements and expansion will improve existing facilities used primarily by Roosevelt High School students and faculty. Furthermore, the improved auditorium will also provide a cultural asset that may be available for use by the surrounding community.

There will be short-term, construction noise and dust that will impact the school and some surrounding residences, particularly on Mott-Smith Drive. Construction-related dust will be minimized and noise levels will meet the Department of Health community noise standards at the property line. However, some temporary construction noise and dust is unavoidable. There will be no long-term adverse impact on the school or surrounding residences.

The \$7 million construction project will also provide positive economic benefits in terms of construction jobs, construction spending, and multiplier effects on the local economy. In the long-term, the new facility will have a positive economic effect on the school and community due to its capacity to host large, performing arts events.

3.3.2 Scenic and Visual Resources

The most significant visual resource in the vicinity of Roosevelt High School is Punchbowl Crater, which houses the National Memorial Cemetery of the Pacific. The campus is located within the City's designated Punchbowl Special District. The objectives of the Punchbowl Special District are to:

- Preserve and enhance Punchbowl's form and character as a significant landmark
- Preserve and enhance the park-like character of the immediate slopes of Punchbowl and its major streets
- Preserve and enhance significant public views to and from Punchbowl, especially those from the Punchbowl lookouts and long-range views of Punchbowl, by modifying construction projects that would diminish those views
- Provide landscaping and open space which will enhance views and the general character of the Punchbowl area
- Preserve, enhance and restore, to the extent possible, the serene and scenic qualities within the national cemetery.

Although Roosevelt High School is located outside the Punchbowl Special District "core area," the City has identified the campus as a "viewing site." Building heights within the Special District are limited to 25 feet.

Important visual resources on campus include Building A itself, a historic structure listed on the State Register of Historic Places. In particular, the school's signature domed tower, attached to Building A, is also a distinctive area landmark as well as an historic structure.

Potential Impacts and Mitigation Measures

The proposed two-story building addition, which includes dressing rooms, offices, and a scene shop, will exceed the 25-foot height limit within the Punchbowl Special District. The proposed height of the addition will be 30 feet, at the ridge of the sloped roof. This building height is necessary because the scene shop needs a minimum ceiling height of 13 feet. A flat roof could have kept the building height below 25 feet, but the sloped roof was determined to be more in keeping with the architectural character of the historic auditorium. The building addition will still be below the height of the existing auditorium, the majority of Building A (about 50 feet in height) and the domed tower (about 70 feet in height).

The two-story building addition will be noticeable from the residences located across Mott-Smith Drive, but will not obstruct views, as it is still lower than the height of the existing auditorium. The addition will not impact public views of Punchbowl or obstruct views from Punchbowl. The sloped roof design, in fact, would be more visually compatible and more in keeping with the historic character of Building A.

Approval from the City Department of Planning and Permitting is needed to exceed the 25-foot height limit, but overall, there will be no adverse visual impact to historic structures in the area, or to the Punchbowl landmark.

3.3.3 Archaeological, Historic, and Cultural Resources

Although the entire Roosevelt High School Campus is listed on the State Register of Historic Places, Building A, in which the existing auditorium is located, is considered to be the only "contributing" building. The 10 remaining buildings on campus were constructed after 1932, are of contemporary design, and are considered "non-contributing" to the historic status.

Building A was designed by Guy Rothwell and Marcus Lester, and constructed in 1932 in the Spanish Revival architectural style. The three-storied building, square, domed tower and auditorium are characterized by plain, cream-colored stucco walls, asymmetrically placed windows, decorative arches and a red tile roof. This style of architecture dominated the major public buildings of Hawaii in the 1920's to early 1930's. Today, few buildings of this style remain in Hawaii. Other buildings in Honolulu in the Spanish Revival style include McKinley High School, Honolulu Hale, the Merchant Street Police Station, and the Oahu Railway and Land Company Building. Architectural historians consider these buildings the last tangible evidence of one of Hawaii's most active periods of public architecture. For this reason, Building A is considered of historical value.

The auditorium portion of the building was built in 1936. Because it is a listed historic structure, modifications to Building A must follow the Secretary of the Interior's standards regarding additions to historic buildings. The proposed design must be reviewed and approved by the Department of Land and Natural Resources State Historic Preservation Division (DLNR-SHPD).

Potential Impacts and Mitigation Measures

In preliminary discussions with the DLNR-SHPD, project designers were instructed that the Nehoa Street and Courtyard exterior building facades should not be modified, and that work on the building exterior should be compatible with and compliment the existing building. At that time, SHPD indicated that areas of potential concern include the Nehoa Street handicapped accessible walkways, the addition on the Mott-Smith Drive side, and the new restrooms. They requested review of plans as they become available.

Project designers are continuing to work with the SHPD to ensure that exterior and interior features are compatible with, and do not detract from the historic character of the building. Modifications to the design have been made to address SHPD concerns. For example, the slope of the ramp fronting the auditorium's Nehoa Street façade was changed from a 1:12 slope to a 1:20 slope. This change will eliminate the need for handrails in front of the historic façade. The SHPD's written concurrence will be obtained prior to construction.

Act 50, Session Laws of Hawaii, 2000 requires that a proposed action's impact(s) on the cultural practices of a community be disclosed in the environmental review process. In this case, the project is limited to renovation of an existing facility. The project will improve the auditorium, but will not alter its current use. The project includes access improvements to meet federal Americans with Disabilities Act requirements. Therefore, the proposed action will improve public access and use of the auditorium.

3.4 TRAFFIC AND CIRCULATION

3.4.1 Existing Conditions

A traffic impact assessment was completed by Julian Ng, Inc. (May 2003). Roosevelt High School is located *mauka* of Nehoa Street, which runs east to west starting at Punahou Street, then joining Prospect Street west of Auwaiolimu Street. The school is located between the intersections of Nehoa and Mott-Smith Drive and Nehoa and Pensacola/Auwaiolimu Street. Lewalani Drive also intersects Nehoa Street at an unsignalized "T" intersection approximately halfway between the two signalized intersections.

All of the streets in the area provide one lane of traffic in each direction. Separate turn lanes are provided at some intersections, and the prohibition of curbside parking provides adequate width for two lanes of traffic on parts of Nehoa Street during peak periods.

Existing traffic volumes in the area have not changed significantly in recent years. Data from traffic counts taken at several locations near the project site are shown in Table 4.

Existing student and faculty parking areas are accessed off Mott-Smith Drive. An inventory of parking stalls notes 81 parking stalls at the school, though parking for up to 117 vehicles may actually be available on campus.

Table 4: Existing Traffic Volumes

	Traffic volumes	
	eastbound or southbound	westbound or northbound
Nehoa Street at Pensacola Street (Auwaiolimu Street)		
24-hour total (May 1993)	3,495	7,647
AM Peak Hour	377	1,091
PM Peak Hour	417	775
Auwaiolimu Street (Pensacola Street) at Nehoa Street		
24-hour total (May 1993)	6,980	2,208
AM Peak Hour	1,165	252
PM Peak Hour	624	239
Nehoa Street at Lewalani Drive		
24-hour total (August 1999)	5,598	6,087
AM Peak Hour	402	581
PM Peak Hour	636	589
Lewalani Drive Makai of Nehoa Street		
24-hour total (August 1999)	177	402
AM Peak Hour	14	33
PM Peak Hour	16	39
Nehoa Street at Mott-Smith Drive		
24-hour total (October 1993)	7,196	7,755
AM Peak Hour	863	1,039
PM Peak Hour	770	774
Mott-Smith Drive at Nehoa Street		
24-hour total (October 1993)	1,753	1,374
AM Peak Hour	180	230
PM Peak Hour	146	104

Source: City and County of Honolulu, Department of Transportation Services

The existing 983-seat auditorium is estimated to generate up to 500 vehicle trips in each direction (arriving in the area and departing the area) during an event that fills the facility. This additional traffic would be in addition to other traffic in the area, but is not expected to occur when traffic volumes in the area are at peak levels (between 6:30 AM and 8:00 AM on weekday mornings and between 3:30 PM and 6:00 PM on weekday afternoons). Traffic volumes on Nehoa Street, for example, are about 200 vehicles per hour between 7:00 PM and 10:00 PM.

The existing 983-seat auditorium is estimated to generate up to 500 vehicle trips in each direction (arriving in the area and departing the area) per event. The greatest impact of traffic generated by the existing auditorium occurs when an event is held in the facility, typically in the evening after the PM Peak Hour.

City bus service ("TheBus") is provided on Nehoa Street, with two routes passing the site; a bus stop is located in a long turnout along the site frontage. TheBus Route #15 provides service between Makiki and Pacific Heights, with two buses per hour during weekdays and one bus per hour during evenings and on weekends. TheBus Route #17 provides two buses per hour between Makiki and Ala Moana Center. Other bus routes are accessed via transfers or on Wilder Avenue (two blocks away).

3.4.2 Potential Impacts and Mitigation

The proposed auditorium renovation will have minimal impact on traffic conditions near the site. The project will result in the continued use of an existing facility. Any traffic impact would be a result of increased use of the auditorium, which could generate additional traffic in the area more often. However, because the seating capacity will be reduced by approximately 20%, peak hourly traffic volumes due to full use of the auditorium will be proportionately less, or up to 400 vehicle trips in each direction. Full use, however, is not expected to occur more than ten times per year. Events during school hours will not generate any significant increases in traffic. Events during non-school hours would generally not fill the auditorium and would generate less traffic than estimated for full use. Even with full use, the project traffic would be added to non-peak volumes and would be less than for an event that fills the existing auditorium.

Parking for special events will also be available at Stevenson Middle School and Lincoln Elementary School to reduce parking impact on surrounding residential streets. The impact of the project will be a lessening of the peak traffic conditions due to use of the auditorium. The roadway system in the area will continue to be adequate.

Previously, the project included construction of a new driveway, vehicle turnaround and handicapped parking area off Nehoa Street. This proposal was described in the Draft Environmental Assessment. The driveway was proposed at the front of the school, near the existing road "stub out" used as a loading area. It was offset about 60 feet east of the Lewalani Drive intersection.

Due to traffic safety concerns and potential conflicts with traffic on Nehoa Street and Lewalani Drive, the project was revised to eliminate the new driveway, turnaround and parking. Handicapped parking will now be available near the existing parking area on the north side of the auditorium. This design change will reduce traffic on Nehoa Street and eliminate safety concerns associated with turning movements in and out of a new driveway. However, moving the handicapped parking and access to the north side of the auditorium will increase traffic near the Mott Smith Drive entrance to the campus.

3.5 PUBLIC UTILITIES

3.5.1 Drainage System

The project site is located within the Ala Wai Watershed, and the surrounding areas have underground storm drain lines, which eventually empty into the Ala Wai Canal. The Ala Wai Canal empties into a major concrete-lined channel that flows into the ocean at the near shore off Kuhio Beach. The existing concrete drainage channels are owned and maintained by the City and County of Honolulu.

Potential Impacts and Mitigation Measures

The auditorium renovation and construction of handicapped accessible parking area will not impact on or off-site drainage conditions. No additional drainage improvements are planned. The contractor will employ erosion control measures during construction, and permanent runoff can be directed to grassed surfaces. No significant off-site runoff is anticipated.

3.5.2 Water System

The project area is served by the Board of Water Supply reservoir in the Municipal 405 system. The number refers to a common spillway elevation.

The water pressure at the school is 112 pounds per square inch (psi). A new pressure-reducing valve should be provided to limit the maximum pressure to 80 psi.

Future water system improvements are planned at Roosevelt High School, including a proposed 4-inch waterline in the stadium area.

Potential Impacts and Mitigation Measures

A new water line will be provided to service the new restroom facility. The waterline will be connected to the school's existing water system at the 4-inch compound meter near the athletic field. The new mechanical room and chiller room at the rear of the auditorium will require a separate water connection. If needed, a new fire line to serve building sprinklers with a detector check meter will be provided.

The project will not significantly impact the existing water system, as it will not increase student population or result in an increase in water demand. Use of the auditorium by the public will occur in the evenings or on weekends, when the school is closed. The Board of Water Supply has indicated that the existing water system is presently adequate to accommodate the proposed auditorium renovation.

3.5.3 Wastewater System

Roosevelt High School ties into the existing City sewer lines along Nehoa Street. As with the water system, existing sewer service to the school is old and undersized.

Potential Impacts and Mitigation Measures

A new sewer line will be provided to serve the new restroom facility. A new 6-inch pipe will connect to the municipal system along Nehoa Street.

The project will not increase demand on existing wastewater facilities, as it will not increase the student population. Use of the facilities by the public will occur in the evenings or on weekends, when the school is closed.

All wastewater plans will conform to applicable provisions of the State Department of Health's Administrative Rules, Chapter 11-62, "Wastewater Systems."

3.5.4 Electrical and Telecommunications Systems

The electric and telecommunications service to Building A extends from an existing joint utility pole located on Nehoa Avenue, through the courtyard fronting the auditorium to the building service entrance. The Hawaiian Electric Company (HECo) service to Building A is fed from an existing 750 kVA transformer, which in turn is fed by HECo.'s Piikoi Street Substation.

The Verizon Hawaii telephone service to this area originates at their Alakea (downtown) central office. The Oceanic Cable service originates at the system head end located in Mililani Tech Park.

Potential Impacts and Mitigation Measures

The project includes the addition of an air conditioning system to the auditorium as well as upgraded lighting and telecommunications systems. Exterior lighting is being provided for the front entry and courtyard areas, walkways, and the handicapped parking area.

Roosevelt High School was designed in the 1930's and the existing electrical power is reaching capacity. Based on preliminary discussions with HECo, the existing peak demand load on the existing 750 kVA transformer is 644 kVA. Therefore, additional electrical service is required to accommodate the new air conditioning equipment and

upgraded performing arts requirements. This second electric service will be adequate to serve the renovated auditorium. Removing the auditorium load from the existing transformer has the added benefit of increasing the spare capacity for future improvements to Building A. The new transformer will be about 8' x 9' in size. The conceptual design has sited the transformer pad inside the proposed cooling tower.

Construction of the new driveway turn-around and handicapped parking area below the existing courtyard will impact existing utility lines in the area. A portion of the existing electric and telecommunications duct lines in that area will need to be reconstructed at a lower depth.

The auditorium's upgraded electrical and telecommunications systems will be connected to the school campus main distribution frame. The building fire alarm system will be connected to the existing campus fire alarm control panel located in Building A. Currently, the State Department of Accounting and General Services has an ongoing project to upgrade portions of the existing fire alarm system. The auditorium fire alarm system will be coordinated with these upgrades.

The project design will be consistent with the engineering requirements specified by Hawaiian Electric Co., Verizon Hawaii and other utility companies.

3.6 PUBLIC HEALTH AND SAFETY

3.6.1 Police Services

Roosevelt High School is located in the Honolulu Police Department's District 1, which covers the area from Pacific Heights to Punahou Street. Police officers serving the area operate out of the departmental headquarters on Beretania Street. The Police Department has indicated that the project should have a negligible impact on police services to the area.

3.6.2 Fire and Emergency Medical Services

The Honolulu Fire Department consists of five battalions with Battalion 1 servicing the central Honolulu District. The Makiki Fire Station (Station 3) is located just over a quarter mile south (*makai*) of the school, at the intersection of Wilder Avenue and Piikoi Street.

Five firefighters are on duty per shift, a captain, an engineer and three firefighters. The station has one engine, but also receives support from other nearby stations. For example, in the event of a confirmed fire alarm at the school, three engines and two ladders would be dispatched immediately. The fire station also responds to emergency 911 medical service calls, in conjunction with the City's EMS units.

4 LAND USE PLANS, POLICIES, AND CONTROLS

4.1 HAWAII STATE PLAN

The Hawaii State Plan, Chapter 226, HRS, serves as a written guide for the future long-range development of the State by identifying goals, objectives, policies, and priorities and by providing a basis for determining priorities and allocating limited resources, such as public funds, services, manpower, land, energy, water, and other resources. Relevant State Plan goals, objectives, policies and priority guidelines are noted below.

The proposed project would be in conformance with State Plan objectives and policies for socio-cultural advancement—education,

“(b) To achieve the educational objective, it shall be the policy of this State to: (1) Support educational programs and activities that enhance personal development, physical fitness, recreation, and cultural pursuits of all groups... (2) Ensure the provision of adequate and accessible educational services and facilities that are designed to meet individual and community needs...” (Section 226-21, HRS).

The project also conforms to Section 226-23, objectives and policies for socio-cultural advancement—leisure,

“(a) Planning for the State’s socio-cultural advancement with regard to leisure shall be directed towards the achievement of the objective of the adequate provision of resources to accommodate diverse cultural, artistic, and recreational needs for present and future generations...”

“(b) To achieve the leisure objective, it shall be the policy of this State to: (1) Foster and preserve Hawaii’s multi-cultural heritage through supportive cultural, artistic, recreational, and humanities-oriented programs and activities... (2) Provide a wide range of activities and facilities to fulfill the cultural, artistic, and recreational needs of all diverse and special groups effectively and efficiently...”

4.2 STATE LAND USE CLASSIFICATION

The State Land Use Commission, pursuant to Chapter 205 and 205A, HRS and Chapter 15-15, Hawaii Administrative Rules, is empowered to classify all lands in the State into one of four land use districts: urban, rural, agricultural and conservation. The entire alignment falls within the “Urban” classification. Activities or uses that fall within the Urban classification are regulated by the City (see Figure 9).

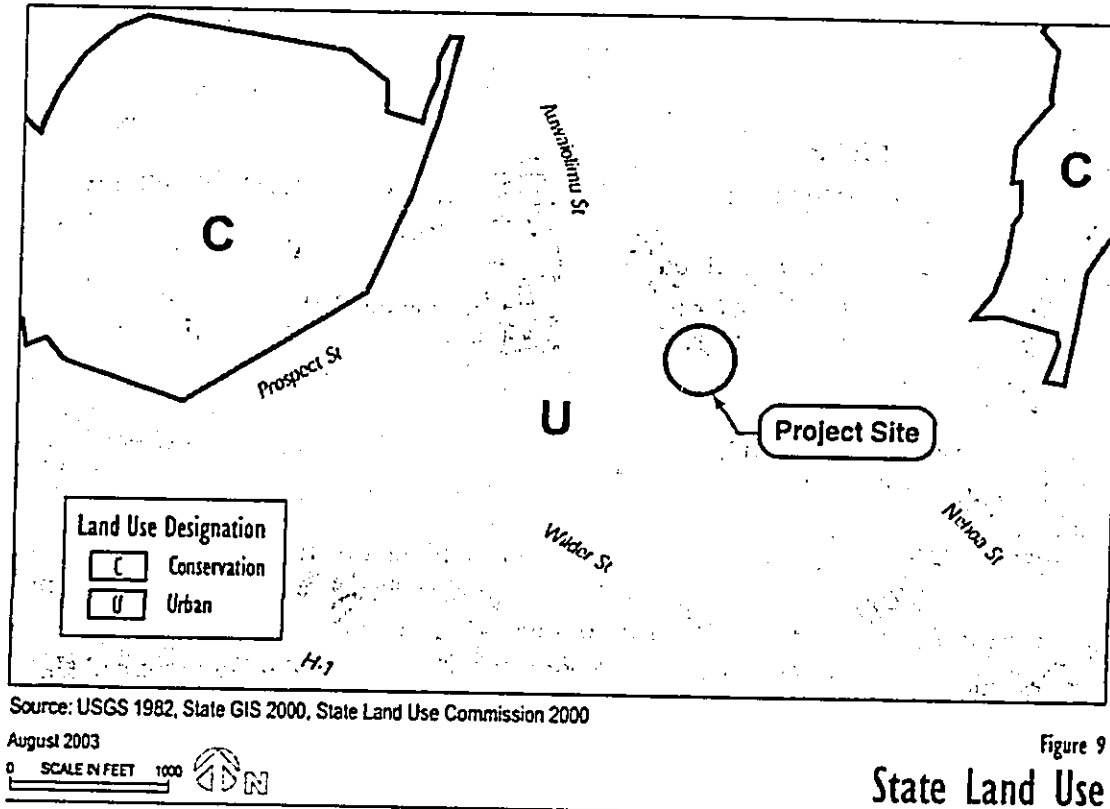

4.3 CITY AND COUNTY OF HONOLULU LAND USE REGULATIONS

4.3.1 General Plan

The General Plan for the City and County of Honolulu (1992) is a comprehensive statement of long-term objectives and policies for Oahu over a 20 year period. The General Plan addresses eleven areas of concern, including population; economic activity; the natural environment; housing; transportation and utilities; energy; physical development and urban design; public safety; health and education; culture and recreation; and government operations and fiscal management.

The proposed project is consistent with the following policies and guidelines of the 1992 General Plan Objectives and Policies, Chapter IX, Health and Education.

Objective B: To provide a wide range of educational opportunities for the people of Oahu.

Policy 3: Encourage the after-hours use of school buildings, grounds and facilities.

Policy 4: Encourage the construction of school facilities that are designed for flexibility and high levels of use.

The proposed project is consistent with the following policies and guidelines of the General Plan Objectives and Policies, Chapter X, Culture and Recreation.

Objective C: To foster the visual and performing arts.

Policy 1: Encourage and support programs and activities for the visual and performing arts.

Policy 2: Encourage creative expression and access to the arts by all segments of the population.

Objective D: To provide a wide range of recreational facilities and services that are readily available to all residents of Oahu.

Policy 11: Encourage the after-hours, weekend and summertime use of public schools facilities for recreation.

4.3.2 Primary Urban Center Development Plan

Development Plans, a mandate of the City Charter, have been adopted by ordinance for eight geographic regions of the island since 1985. Development Plans provide general guidelines and policies for development by identifying permissible land uses on the Development Plan Land Use Map, and various public facilities and improvements on the Development Plan Public Facilities Map.

The proposed project falls within the Primary Urban Center planning area. According to the Primary Urban Center Development Plan (DP) Land Use Map for PUC-Central, the Roosevelt High School is designated for Institutional use. Surrounding areas are designated for (lower density and higher density) residential uses (City and County of Honolulu, 2002) (see Figure 10).

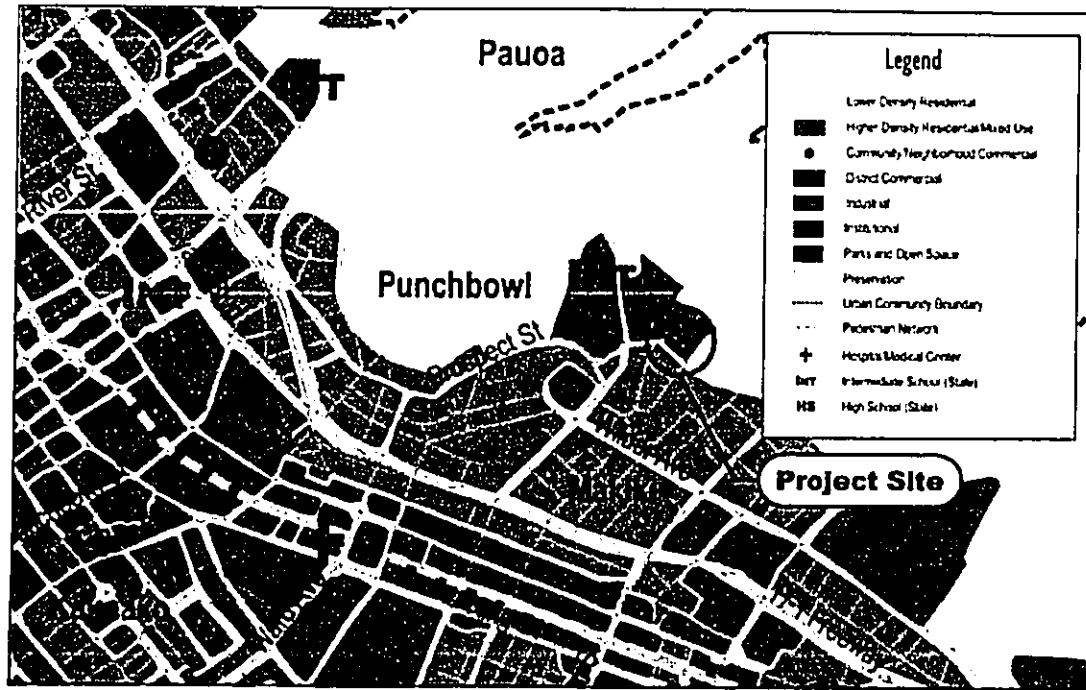

Source: C&C of Honolulu DP, 2002

August 2003

0 SCALE IN FEET 2000



Figure 10

Primary Urban Center - Land Use Map

4.3.3 Zoning

Roosevelt High School is located in the R-5 Residential zoning district, which requires a minimum lot size of 5,000 square feet. The intent of the (R-7.5, R-5 and R-3.5) residential districts is to provide areas for urban residential development. Schools are a permitted use within the R-5 zoning district (see Figure 11).

4.3.4 Special Management Area

The proposed action lies well outside the boundaries of the Special Management Area (SMA), as the school is approximately 1.5 miles from the coastline. A Special Management Area use permit is not required.

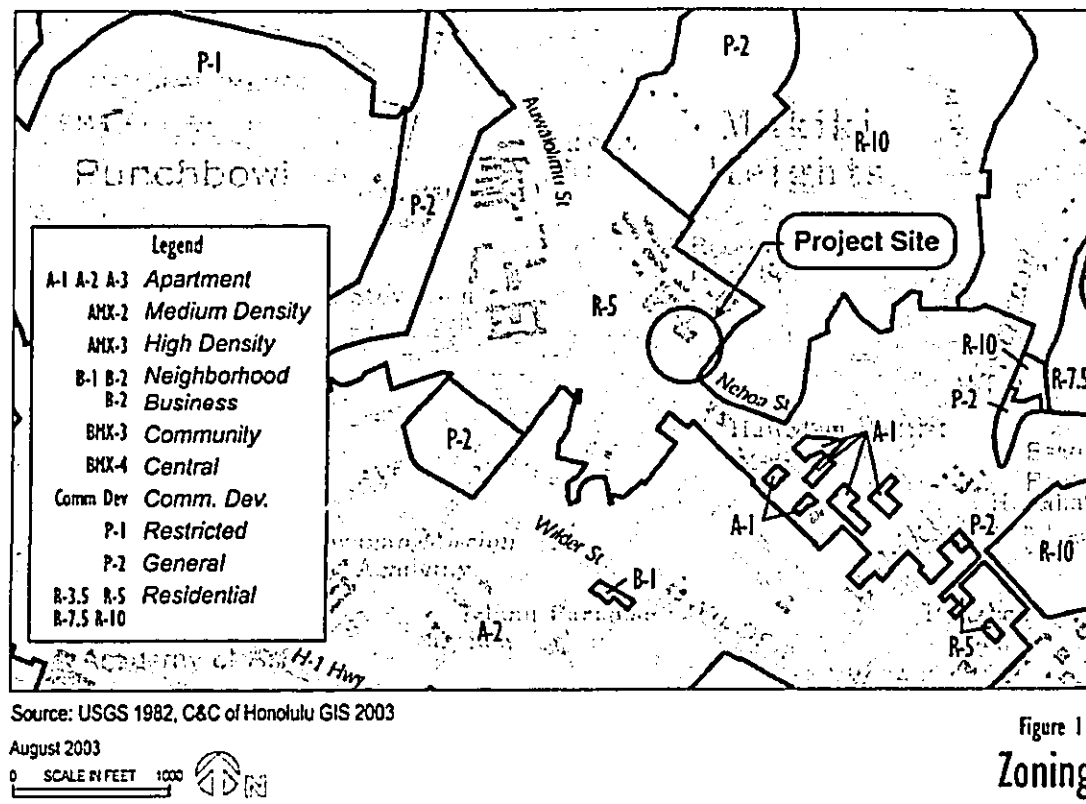

4.3.5 Punchbowl Special District

As shown in Figure 12, Roosevelt High School is located within the boundaries of the Punchbowl Special District, although the school is outside the Special District “core area.” According to the City’s Land Use Ordinance Section 21-9.50, the significance of the National Memorial Cemetery of the Pacific as a national monument and as one of Hawaii’s important landmarks has long been recognized. However, over the years, land development and land use changes have threatened views of Punchbowl’s slopes and diminished the serenity and natural appearance of its environs. The purpose of the Special District is to preserve and protect the public views of Punchbowl, and the appearance of its slopes and surrounding areas.

Within the project district, maximum building height is 25 feet (Land Use Ordinance Exhibit 21-9.6: Punchbowl Special District - Height Precincts). Other design requirements in the special district include encouragement of articulated facades to break up building mass, the use non-reflective and subdued materials, finishes and colors, and mandatory replacement of trees that are removed from any street, park or other public viewing area.

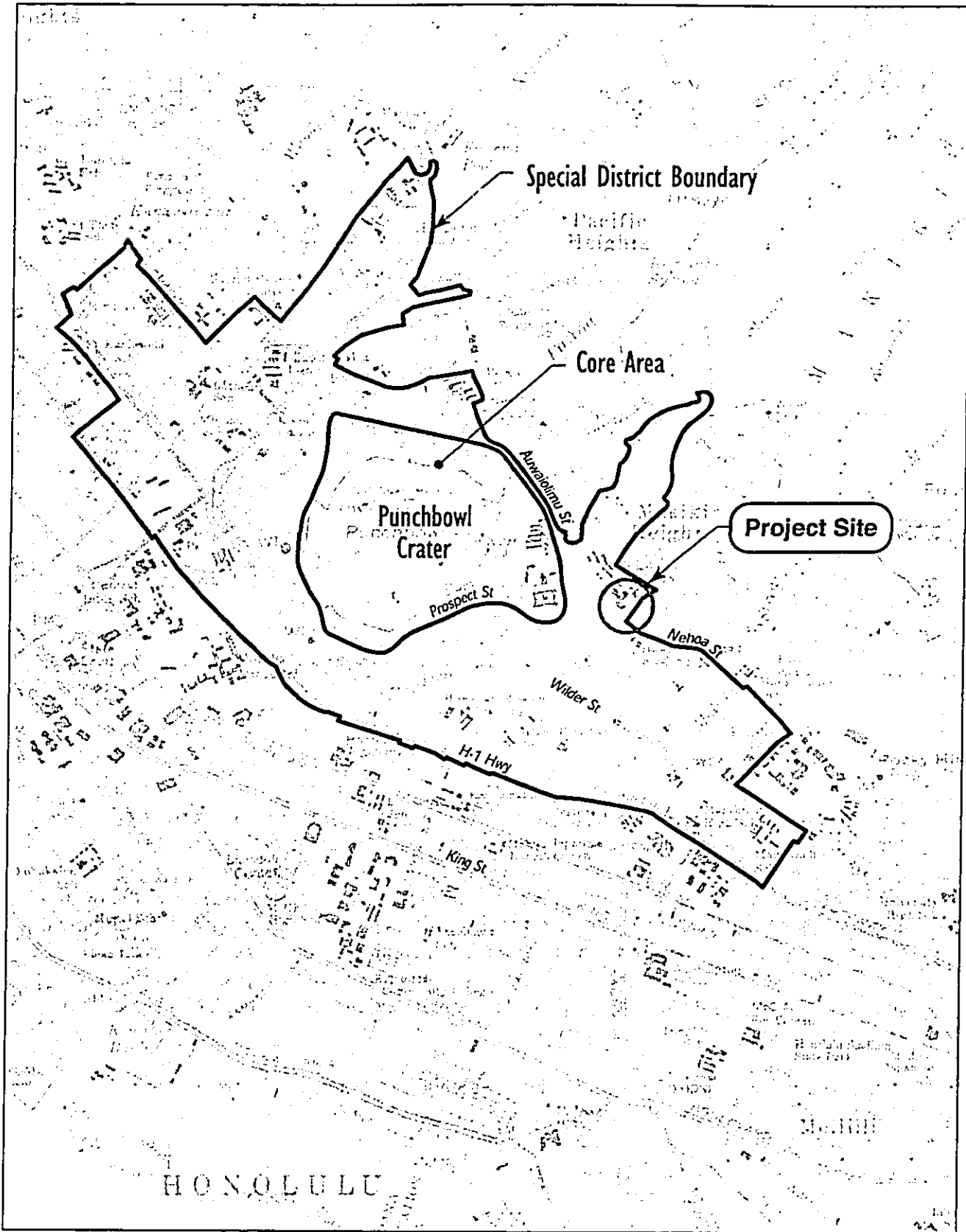

Source: USGS 1982, C & C of H, Land Use Ordinance 1999

May 2003

0 SCALE IN FEET 2000



Figure 12

Punchbowl Special District

The building height of the proposed two-story addition will exceed the maximum 25-foot height. This addition includes the scene shop, dressing rooms, and offices, and will be 30 feet at the ridge of the sloped roof. This building height is necessary because the scene shop needs a minimum ceiling height of 13 feet. A flat roof could have kept the building height below the height limit, however the designers felt that a sloped roof was more in character with the existing auditorium.

According to the Land Use Ordinance, exemptions from the 25-foot maximum building height are allowed at the discretion of the Director of Planning and Permitting provided they do not obstruct any significant views and are consistent with the intent and objectives of the Punchbowl special district. A waiver from the 25-foot building height standard will be obtained during the project design phase.

5 POSSIBLE ALTERNATIVES

5.1 NO ACTION

The "no action" alternative assumes the status quo, i.e., no renovation or improvements to existing facilities. Under this alternative, the existing, substandard auditorium would remain and continue to be underutilized. The auditorium, while large, has an obsolete layout and design, poor acoustics and lighting, outdated utility systems, and it is not air conditioned. There are no restrooms in the auditorium and the facilities do not meet ADA parking or accessibility requirements. Roosevelt High School students would not have adequate facilities to support their band and performing arts activities. The school and larger community would be denied the benefit of a high quality facility for school and public events.

5.2 DELAYED ACTION

To delay the project will mean continued reliance on the existing facilities until the action is initiated. Delaying the project would not significantly alter the environmental consequences of the project. The existing facilities are 70 years old, outdated and in poor physical condition. In addition, delaying the proposed renovation would only increase overall project costs because of inflation and changes in economic and labor supply conditions.

5.3 ALTERNATIVE DESIGNS

A Functional Analysis Concept Design (FACD) process was held in May and June 2002 to explore planning and design alternatives for the project. Seven alternative design schemes were developed and discussed with participants, who included representatives from Roosevelt High School, the community and the State of Hawaii Department of Accounting and General Services and the Department of Education.

The alternative designs were identified as Schemes A through G, with several alternatives being variations of a similar concept. They are described in detail in the Pre-Final Master Plan Report (CDS International, June 2002). Features that varied among the alternatives included the style of seating, (i.e., stadium seating, mezzanine seating), the total number of seats, size and height of the entry lobby, the presence or absence of a mezzanine level, restroom location, the inclusion/exclusion of back-of-house functions (i.e., scene shop, offices), modification/relocation of the proscenium, and the size and width of the stage. Each alternative had distinct design and functional advantages and disadvantages. Important considerations in selecting an alternative were the auditorium's ultimate seating capacity (750 seats minimum was desired by Roosevelt High School), flexibility in use, space requirements for band performances, optimizing use of the structure and cost of improvements. Another concern was whether improvements would be allowed by the State Historic Preservation Division. In particular, it was not known to what extent modification to the historic structure's exterior and to the proscenium would be allowed.

5.4 EVALUATION OF ALTERNATIVES

A conceptual design, illustrated in Figure 3 in Chapter 2, evolved through the FACD process and the refinement of the alternative schemes. Although still subject to change, the proposed alternative balances and optimizes the required functions and design requirements. For this reason, it was selected as the preferred conceptual design alternative.

6 DETERMINATION

Based on the information described in this document, the proposed project is not expected to result in significant social, economic, cultural, or environmental impacts. Consequently, the State of Hawaii Department of Accounting and General Services, on behalf of the Department of Education, has determined that the project will have no significant impact, pursuant to the provisions of Subchapter 6 of Chapter 200, Title 11, Hawaii Administrative Rules of the Department of Health.

7 FINDINGS AND REASONS SUPPORTING THE DETERMINATION

This Environmental Assessment, prepared in accordance with Chapter 343, HRS, as amended, has found that the potential for impacts associated with the proposed action will not be significant. Potential environmental impacts will be temporary and are not expected to adversely impact the long-term environmental quality of the area.

The potential effects of the proposed project were evaluated based on the significance criteria in Section 11-200-12 (Hawaii Administrative Rules, revised in 1996). The following is a summary of potential effects of the action.

SIGNIFICANCE CRITERIA

1. Irrevocable commitment to loss or destruction of natural or cultural resources.

The proposed project will not adversely impact natural or cultural resources. The project will modify an existing structure and improvements are within a developed area of the school campus. Building A, which includes Carter Auditorium, is a historic structure on the State Register of Historic Places. The renovation will be consistent and compatible with the historic character of the building, and will not have an adverse impact on this cultural resource.

2. Curtailment of the range of beneficial uses of the environment.

The project will modify, but not alter an existing use within the Roosevelt High School campus. The project will not curtail the range of beneficial uses of the environment.

3. Conflicts with the State's long-term environmental policies or goals and guidelines as expressed in Chapter 344, HRS, and any revisions thereof and amendments thereto, court decisions, or executive orders.

The proposed project is consistent with the environmental policies, goals, and guidelines defined in Chapter 344, HRS. Specifically, the project is consistent with guideline (9)(A) Education and culture, in §344-4, Guidelines. That specific guideline is to "Foster culture and the arts and promote their linkage to the enhancement of the environment."

4. Substantially affects the economic or social welfare of the community or state.

The project will upgrade an old, substandard and utilized auditorium facility and provide handicapped access, in accordance with federal requirements. In this regard, it will have a positive impact on the economic and social welfare of the community. Short-term negative

impacts are associated with traffic disruptions and construction noise and dust to the school and surrounding residents. These impacts will be temporary.

5. Substantially affects public health.

The proposed project will be completed in accordance with Federal, State and City and County of Honolulu rules and regulations governing public safety and health. Primary public health concerns involve construction-period air quality, noise, and traffic. The contractor will be obligated to meet the environmental standards and procedures of various governmental agencies in the course of obtaining necessary permits. Traffic impacts will not be significant, as public events at the facility will be intermittent and held during evenings and on weekends, when school is not in session. Overall, potential public health impacts will be minimized or brought to negligible levels by the mitigation measures described in this document.

6. Involves substantial secondary impacts, such as population changes or effects on public facilities.

The proposed project will not result in secondary impacts such as population changes or effects on public facilities. The project will improve, but not change the primary use of an existing school auditorium.

7. Involves substantial degradation of environmental quality.

The project will take place within the boundaries of an existing school campus. All project activities will occur in existing structures or in currently developed areas. Construction-related noise, dust and traffic impacts will be temporary. There will be no degradation of environmental quality. Upon completion of the project, the environmental quality of the area will return to pre-construction condition.

8. Is individually limited but cumulatively has considerable effect on the environment, or involves a commitment for large actions.

The proposed project is part of the Roosevelt High School master plan. Other components of the master plan will be planned and funded separately by the State Department of Education. This project does not involve a commitment for larger actions. It will not have an impact on local, regional, and island-wide land use and/or population.

9. Substantially affects a rare, threatened, or endangered species, or its habitat.

The project area is a long established urban community with no rare, threatened, or endangered species.

10. Detrimentially affects air or water quality or ambient noise levels.

There will be short-term impacts on the air quality and noise levels inside of and adjacent to the construction area. Mitigation measures will be implemented to minimize construction-related impacts. There will be no long-term impacts to air or water quality or ambient noise levels.

11. Affect or is likely to suffer damage by being located in an environmentally sensitive area, such as a flood plain, tsunami zone, beach, erosion-prone area, geologically hazardous land, estuary, freshwater, or coastal waters.

The project area is not at high risk for tsunami inundation or flooding, and is away from the Special Management Area and coastal resources. The project will not impact Kanaha Stream, which is located near Roosevelt High School, nor the Ala Wai watershed area. The project will not affect sensitive environmental resources.

12. Substantially affects scenic vistas and view planes identified in county or state plans or studies

The project will not affect scenic vistas and view planes identified in public planning documents or studies. The school is located within the City's Punchbowl Special District, which was established to preserve and protect the public views of Punchbowl Crater, and the appearance of its slopes and surrounding areas. Within this area, maximum building height is 25 feet. The height of the proposed two-story addition will be 30 feet, exceeding this maximum height. The new addition will not obstruct any significant views of Punchbowl Crater, and will be lower than the roof of the existing auditorium and remainder of Building A. The sloped roof, as designed, will be more visually compatible with the existing historic structure and with the objectives of the special district than a lower, flat roof. An exemption from the 25-foot maximum building height will be requested from the Director of Planning and Permitting.

13. Requires substantial energy consumption.

Installation of the new air conditioning system and upgraded electrical system will increase electrical demand of the auditorium. However, energy consumption will not be substantial and will be typical for a project of this type. The building is being designed to be properly insulated and to meet current energy codes.

CONCLUSION

The analysis contained in this Environmental Assessment has determined that the project will not have significant adverse impacts. The State of Hawaii Department of Accounting and General Services, on behalf of the Department of Education, will file a Finding of No Significant Impact (FONSI) with the State Office of Environmental Quality Control. Anticipated impacts will be temporary and will not adversely affect environmental quality in the area.

8 BIBLIOGRAPHY

City and County of Honolulu, Department of General Planning. *General Plan: Objectives and Policies*. 1992.

City and County of Honolulu, Department of Planning and Permitting. *Primary Urban Center Development Plan*. May 2002.

City and County of Honolulu Geographic Information System (on line).
<http://gis.hicentral.com>

CDS International. *Roosevelt High School Building A. Auditorium Renovation, Phase I, Master Plan Report (Pre-Final)*. June 2002.

State of Hawaii, Commission on Water Resource Management. *Hawaii Stream Assessment, A Preliminary Appraisal of Hawaii's Stream Resources*. December 1990.

Ng, Julian, Inc. *Preliminary Traffic Impact Assessment*. May 2003.

United States Department of Agriculture, Soil Conservation Service, In Cooperation with the University of Hawaii Agriculture Experiment Station. *Soil Survey of Kauai, Oahu, Maui, Molokai and Lanai, State of Hawaii*. August 1972.

U.S. Census Bureau (on-line). <http://factfinder.census.gov>

U.S. Department of the Interior, National Park Service, National Register of Historic Places, Registration Form (description of President Theodore Roosevelt High School, Honolulu, Hawaii).

9 ORGANIZATIONS AND AGENCIES CONSULTED IN PREPARATION OF THE DRAFT AND FINAL ENVIRONMENTAL ASSESSMENTS

9.1 Organizations Consulted During Preparation of the Draft EA

The following agencies and organizations were sent a pre-consultation letter on April 17, 2003, requesting comments prior to completion of the Draft Environmental Assessment. Comments were requested by May 6, 2003.

A total of 17 comment letters were received during the pre-consultation period, and are reproduced in this chapter. These comments were incorporated into the Draft Environmental Assessment.

Federal

U.S. Army Engineer District
U.S. Environmental Protection Agency

State

Department of Accounting and General Services
Department of Business, Economic Development & Tourism, Office of Planning
Department of Education
 Honolulu District Office
 Facilities and Support Services Branch
 Roosevelt High School
 Stevenson Middle School
 Lincoln Elementary School
Department of Hawaiian Home Lands
Department of Land and Natural Resources
 • Land Division
 • State Historic Preservation Division
Department of Health
 • Environmental Management Division
 • Office of Environmental Quality Control
Department of Human Services
Department of Transportation, Statewide Transportation Planning Office
Office of Hawaiian Affairs

City and County of Honolulu

Board of Water Supply
Department of Design and Construction
Fire Department
Department of Planning & Permitting
Department of Parks and Recreation
Department of Transportation Services
Police Department
Department of Environmental Services
Department of Facility Maintenance

Utilities

Hawaiian Electric Company
Verizon Hawaii

Other Community Organizations

Hawaii Opera Theatre
Makiki/Punchbowl/Tantalus Neighborhood Board

Elected Officials

Senator Carol Fukunaga, State Senate District 11
Representative Brian Schatz, State House District 25
City Councilman Rod Tam, City Council District 6

9.2 Review of the Draft EA

The Draft EA was filed with the Office of Environmental Quality Control, and its notice of availability published in the June 8, 2003 edition of The Environmental Notice. The Draft EA was sent to the agencies and organizations listed below, as well as the Hawaii State Library. The 30-day review period ended on July 8, 2003. However, at the request of area legislators, comments were accepted for another two weeks, until July 22, 2003. Notice of the extended public review period was published in the July 8 edition of OEQC's Environmental Notice.

On July 9, 2003, a community briefing on the project was held at the Roosevelt High School Library. The meeting was sponsored by State Senators Carol Fukunaga, Suzanne Chun Oakland, and Brian Taniguchi; and Representatives Sylvia Luke, Brian Schatz, and Kirk Caldwell. The purpose of the meeting was to provide information on the project as well as to solicit community comments and concerns. This meeting was attended by over 50 community members, in addition to State legislators, DOE and DAGS representatives, and project consultants. Some of the issues raised at the meeting included potential noise

and lighting impacts on nearby residents, the need for overflow parking during evening events, community use of the auditorium, and overall management of the facility.

During the Draft EA comment period, 20 letters were received from 18 agencies and organizations. Copies of follow-up correspondence between the project architect and the State Historic Preservation Division, and the project architect and The Outdoor Circle is included. During the Draft EA comment period, six area legislators sent a letter (dated June 16, 2003) requesting an extension of the 30-day Draft EA comment period, and announcing the July 9 community meeting. A copy of that letter is included.

Agencies that sent comment letters during the Draft EA comment period are noted with an asterisk (*) below. The letters, as well as the response letters are included at the end of this chapter.

Federal

*U.S. Army Engineer District

State

Department of Business, Economic Development & Tourism, Office of Planning

Department of Education

Honolulu District Office

* Facilities and Support Services Branch

Roosevelt High School

Stevenson Middle School

Lincoln Elementary School

*Department of Hawaiian Home Lands

Department of Land and Natural Resources

Land Division

* State Historic Preservation Division

Department of Health

* Environmental Management Division

* Wastewater Division

* Office of Environmental Quality Control

*Department of Human Services

Department of Transportation, Statewide Transportation Planning Office

Office of Hawaiian Affairs

City and County of Honolulu

*Board of Water Supply

Department of Budget & Fiscal Services

*Department of Design and Construction

*Fire Department

Department of Planning & Permitting
*Department of Parks and Recreation
Department of Transportation Services
*Police Department
Department of Environmental Services
*Department of Facility Maintenance

Utilities

*Hawaiian Electric Company
*Verizon Hawaii

Other Community Organizations

Hawaii Opera Theatre
*Makiki/Punchbowl/Tantalus Neighborhood Board
Mayor's Arborist Advisory Committee
*The Outdoor Circle

Elected Officials

*Senator Carol Fukunaga, State Senate District 11
*Representative Brian Schatz, State House District 25
City Councilman Rod Tam, City Council District 6

Comments Received During DEIS Pre-Consultation Period

LENDING
STATE OF HAWAII

APR 23 2003

DEPARTMENT OF HAWAIIAN HOMELANDS

PO BOX 178
HONOLULU, HAWAII 96814

MICHAEL KANE
CHAIRMAN
HAWAIIAN HOMES COMMISSION
150 KAPIOLANI BOULEVARD
HONOLULU, HAWAII 96814

LENDING
STATE OF HAWAII

APR 30 2003

DEPARTMENT OF EDUCATION

PO BOX 2360
HONOLULU, HAWAII 96804

OFFICE OF ADMINISTRATIVE SERVICES

April 22, 2003

April 8, 2003

Kimura International, Inc.
1600 Kapiolani Boulevard
Suite 1610
Honolulu, Hawaii 96814

Mr. Glenn T. Kimura, President
Kimura International, Inc.
1600 Kapiolani Boulevard, Suite 1610
Honolulu, Hawaii 96814

Dear Mr. Kimura:

Subject: Roosevelt High School Auditorium Renovation
Honolulu, Hawaii

Dear Mr. Kimura:

Subject: Roosevelt High School Auditorium Renovation

Thank you for the opportunity to review the subject assessment report and offer preliminary comments. The Department of Hawaiian Home Lands has no comments to offer at this time.

The Department of Education has no comment at this time on the plans for renovating the auditorium at Roosevelt High School. We look forward to reviewing the Draft Environmental Assessment.

If you have any questions, please call me at 586-3801 or call our Planning Office at 586-3836.

Thank you for this early opportunity to review the renovation plans. Should you have any questions, please call Ms. Heidi Mecker of our branch at 733-4862.

Aloha and mahalo,

Sincerely yours,

Micah A. Kane
Micah A. Kane, Chairman
Hawaiian Homes Commission

Raynor M. Minami
Raynor M. Minami, Director
Facilities and Support Services Branch
RMM:mp

cc: Rae M. Loui, OAS

AN AFFIRMATIVE ACTION AND EQUAL OPPORTUNITY EMPLOYER

LEGAL COUNSEL
OFFICE OF THE ATTORNEY GENERAL



STATE OF HAWAII
DEPARTMENT OF LAND AND NATURAL RESOURCES
AND DIVISION

POST OFFICE BOX 621
HONOULULU, HAWAII 96809

May 20, 2003

OA-2003-007.RCH
LD-NAV

Kimura International, Inc.
Glenn T. Kimura, President
1600 Kapiolani Blvd, Suite 1610
Honolulu, Hawaii 96814

Dear Mr. Kimura:

SUBJECT: Pre-Consultation for Preparation of a Draft Environmental Assessment for Roosevelt High School Auditorium Renovation Honolulu, Oahu, Hawaii - THK: 1st/ 2-4-32: 01)

Thank you for the opportunity to review and comment on the Roosevelt High School Auditorium Renovation project.

The Department of Land and Natural Resources' Land Division Oahu District Land Office has no comment to offer on the subject matter.

If you have any questions, please feel free to contact Nicholas A. Vaccaro of the Land Division Support Services Branch at 808-587-0438.

Very truly yours,

DIERDRE S. MAHIYA
Administrator

C: ODLO

REGISTRATION
DIVISION
LAND AND NATURAL RESOURCES
COMMISSION ON RESOURCE MANAGEMENT
DEPARTMENT OF LAND AND NATURAL RESOURCES
STATE OF HAWAII
HONOLULU, HAWAII 96814

STATE OF HAWAII
DEPARTMENT OF LAND AND NATURAL RESOURCES
AND DIVISION
POST OFFICE BOX 621
HONOULULU, HAWAII 96809

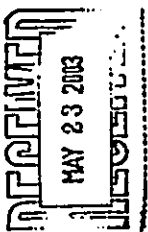

April 24, 2003

Mr. Glenn T. Kimura
President
Kimura International
1600 Kapiolani Blvd, Ste 1610
Honolulu, HI 96814

Dear Mr. Kimura:

SUBJECT: Comments to the Roosevelt High School Auditorium Renovation Pre-Consultation for Environmental Assessment

Our comments should be printed as follows:

"Project activities shall comply with the Administrative Rules of the Department of Health:

- Chapter 11-39 Air Conditioning and Ventilating.
- Chapter 11-46 Community Noise Control.
- Chapter 11-501 Asbestos Requirements.
- Chapter 11-502 Asbestos-Containing Materials in Schools.
- Chapter 11-503 Fees for Asbestos Removal and Certification
- Chapter 11-504 Asbestos Abatement Certification Program

Should there be any questions, please contact me at 586-4701.

Sincerely,

Russell S. Takata
Program Manager
Noise, Radiation & IAQ Branch

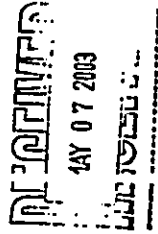

STATE OF HAWAII
DEPARTMENT OF HEALTH
P.O. BOX 3319
HONOLULU, HAWAII 96813-0319

LEGAL COUNSEL
OFFICE OF THE ATTORNEY GENERAL



OFFICE OF THE ATTORNEY GENERAL
STATE OF HAWAII

LEGAL COUNSEL
OFFICE OF THE ATTORNEY GENERAL

LINDA LINDALE
DIRECTOR OF HEALTH



STATE OF HAWAII
DEPARTMENT OF HEALTH
P.O. BOX 3378
HONOLULU, HAWAII 96801

APR 20 2003

LINDA LINDALE
DIRECTOR OF HEALTH

RECEIVED
MAY 16 2003

LINDA LINDALE
DIRECTOR OF HEALTH

STATE OF HAWAII
OFFICE OF ENVIRONMENTAL QUALITY CONTROL
MAY 16 2003

GENEVIEVE SALMONSON
DIRECTOR

RECEIVED
MAY 16 2003

Mr. Glenn T. Kimura, President
Kimura International Inc.
1600 Kapiolani Blvd. Suite 1610
Honolulu, Hawaii 96814

Dear Mr. Kimura:

Subject: Roosevelt High School Auditorium Renovation
Early Consultation
1120 Nehoa Street, Honolulu, Hawaii 96814
TMK: (1)2 - 04 - 032: 001

Reference is made to your letter of April 16, 2003 to Dr. Fukino regarding the subject matter. Your letter has been forwarded to our office for a direct reply. We have reviewed the subject document which proposes renovation and expansion of the existing 983-seat auditorium to create a modern, performing arts facility/auditorium. The existing auditorium, approximately 11,400 square feet in size, will be enlarged by some 11,000 square feet.

We have no objections to the proposed renovations and expansion of the auditorium as the school is connected to the City sewer system.

All wastewater plans must conform to applicable provisions of the Department of Health's Administrative Rules, Chapter 11-62, "Wastewater Systems." We do reserve the right to review the detailed wastewater plans for conformance to applicable rules. Should you have any questions, please contact the Planning & Design Section of the Wastewater Branch at 586-4294.

Sincerely,

Harold K. Yee
HAROLD K. YEE, P.E.
Chief, Wastewater Branch

May 5, 2003

Mr. Glenn Kimura
Kimura International
1600 Kapiolani Blvd., Suite 1610
Honolulu, HI 96814

Subject: Roosevelt High School Auditorium Renovation
Pre-assessment Consultation Honolulu, Hawaii

Dear Mr. Kimura,

We have reviewed the information provided for the Roosevelt High School Auditorium renovation. We have the following suggestions:

1. Address the impacts to traffic and noise in the neighborhood
2. Contact the neighbors within a 500 yards radius

We have no other comment to offer at this time, but will reserve further comments when the documents are submitted.

Should you have any questions, please feel free to call our office at 586-4185.

Sincerely,

Genevieve Salmonson
Genevieve Salmonson
Director

14 May 2003

MEMORANDUM

To: Roosevelt High School Auditorium File
From: Leslie Iurasaki
Kimura International
Re: OEQC Comment Letter, Follow-up phone con

Talked to Genevieve Salmonson, OEQC Director, regarding OEQC's pre-assessment consultation letter. In a May 5, 2003 letter, Ms. Salmonson suggested that we "Contact the neighbors within a 500 yard radius."

According to Ms. Salmonson, she intended to specify a 500-foot (not 500 yard) radius. She was primarily concerned about noise impacts on surrounding residential areas. I asked her if a presentation to the area Neighborhood Board would suffice instead of contacting individual households in a 500-foot radius, and she agreed.

I will add a statement to the EA discussion on Noise (Chapter 3) that presentation to the Makiki/Punchbowl/Tantalus Neighborhood Board will be made during the project design phase.

The Neighborhood Board will also receive a copy of the Draft EA for review and comment.

LINDA LINGLE
GOVERNOR



STATE OF HAWAII
DEPARTMENT OF HUMAN SERVICES
P.O. Box 339
Honolulu, Hawaii 96809-0339

May 6, 2003

Mr. Glenn T. Kimura, President
Kimura International, Inc.
1600 Kapiolani Blvd., Suite 1610
Honolulu, Hawaii 96814

Dear Mr. Kimura:

Re: Roosevelt High School Auditorium Renovation
Honolulu, Hawaii
Early Consultation

This is in response to your letter of April 16, 2003, requesting the Department to comment on the Roosevelt High School Auditorium Renovation. We have no preliminary comments on the renovation as we are responsible for the licensing of child care programs on Department of Education (DOE) sites only when DOE contracts the use of their facilities for child care programs.

In reviewing your project description, you report that the "facility will support general school activities (assemblies, etc.), band and theatre performances, sports practices and certain classes." According to your reported activities for use of the facility, the activities do not fall under the purview of the Child Care Law, Hawaii Revised Statutes §346-151 to §346-166.

Should you have any questions regarding the Child Care Law, please contact Elaine Rabacal, Supervisor, at the Child Care Connection Hawaii Unit I of the Benefit, Employment & Support Services Division at 587-5271.

Sincerely,

Lillian B. Koller, Esq.
Director

AN EQUAL OPPORTUNITY AGENCY

LILLIAN B. KOLLER, ESQ.
DIRECTOR
HENRI DUVA
DEPUTY DIRECTOR

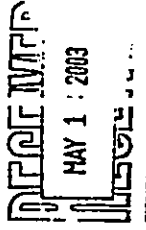

LINDA LINGG
GOVERNOR



STATE OF HAWAII
DEPARTMENT OF TRANSPORTATION
869 PUNCHBOWL STREET
HONOLULU, HAWAII 96813-5097

MAY 22 2003

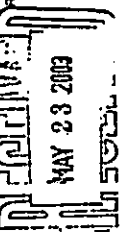

JEREMY HARAGA
DIRECTOR

Acting Deputy Director
GENERAL COUNSEL

REPLY REFER TO

HVY-PS
2.0389

Mr. Glenn T. Kimura
Kimura International, Inc.
1600 Kapiolani Boulevard, Suite 1610
Honolulu, Hawaii 96814

Dear Mr. Kimura:

Subject: Early Consultation, Roosevelt High School Auditorium Renovation

Thank you for requesting our review and comments on the proposed renovation.

The proposed renovation will not impact our State highway facilities.

If you have any questions, please contact Ronald F. Tsuzuki, Head Planning Engineer, Highways Division, at 587-1830. Please reference file review number 03-098 in all contacts and correspondence regarding these comments.

Very truly yours,

GLENN M. YASUI
Administrator
Highways Division

BOARD OF WATER SUPPLY

STATE OF HAWAII
83 SOUTH BERETANIA STREET
HONOLULU, HI 96843



MAY 28, 2003

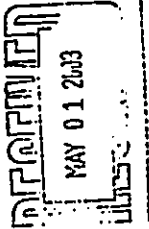

Mr. Glenn T. Kimura, President
1600 Kapiolani Boulevard, Suite 1610
Honolulu, Hawaii 96814

Dear Mr. Kimura:

Subject: Your Letter of April 16, 2003 on the Environmental Assessment for the Roosevelt High School Auditorium Renovation. TMK: 2-4-32-1

Thank you for the opportunity to comment on the subject document.

The existing water system is presently adequate to accommodate the proposed auditorium renovation.

The availability of water will be confirmed when the building permit is approved. When water is made available, the applicant will be required to pay our Water System Facilities Charges for resource development, transmission and daily storage.

The proposed project is subject to Board of Water Supply Cross-Connection Control and Backflow Prevention requirements prior to the issuance of the Building Permit Applications.

If you have any questions, please contact Joseph Kaakua at 748-5442.

Very truly yours,

CLIFFORD S. JAMILE
Manager and Chief Engineer

JEREMY 903, Mayor
EDDIE FLORES, Jr., Chairman
CHARLES STEED, Vice-Chairman
JAMILL Y. MA
HERBERT K. KAOPUA, SR.
DAROLYN LEONG

RODNEY K. HARAGA, Esq., Director
LARRY J. L. CHAN, Esq., Director
CLIFFORD S. JAMILE
Manager and Chief Engineer
DOMINICA K. KUROSAKI
Deputy Manager and Chief Engineer

**FIRE DEPARTMENT
CITY AND COUNTY OF HONOLULU**
3375 KONA STREET, HONOLULU, HAWAII 96819
TELEPHONE: (808) 931-7777 • FAX: (808) 931-7770 • INTERNET: www.honolulu.gov

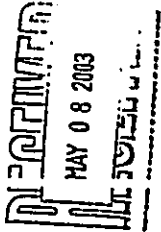

JEREMY HARRIS
MAYOR

ATTILIO K. LEONARDI
FIRE CHIEF

May 6, 2003

Mr. Glenn T. Kimura, President
Kimura International, Inc.
1660 Kapiolani Boulevard, Suite 1610
Honolulu, Hawaii 96814

Dear Mr. Kimura:

Subject: Roosevelt High School Auditorium Renovation
Honolulu, Hawaii
Early Consultation

We received your letter dated April 16, 2003, requesting our comments regarding the above-mentioned project. The Honolulu Fire Department has no objections to the project.

Should you have any questions, please call Battalion Chief Lloyd Rogers of our Fire Prevention Bureau at 831-7778.

Sincerely,

Attilio K. Leonard
ATTILIO K. LEONARDI
Fire Chief

AKL/SK:hh

**DEPARTMENT OF PLANNING AND PERMITTING
CITY AND COUNTY OF HONOLULU**
450 SOUTH KING STREET, HONOLULU, HAWAII 96813
TELEPHONE: (808) 523-4414 • FAX: (808) 527-7132 • INTERNET: www.honolulu.gov



MAY 02 2003

ERIC G. CRISPIN, AIA
DIRECTOR

1 WARDEN STATION
PLANNING SECTION

2003/ELOG-1125

April 29, 2003

Mr. Glenn T. Kimura, President
Kimura International, Inc.
1660 Kapiolani Boulevard, Suite 1610
Honolulu, Hawaii 96814

Dear Mr. Kimura:

Roosevelt High School Auditorium Renovation
Early Consultation

We have reviewed your pre-assessment consultation for Roosevelt High School Auditorium Renovation Draft EA dated April 16, 2003, and have no comments to offer at this time.

Should you have any questions, please contact Kathy Sokugawa of my staff at 523-4039.

Sincerely yours,

Eric G. Crispin
ERIC G. CRISPIN, AIA
Director of Planning & Permitting

EGC:js

P:\function\ea-eis\2003\RooseveltAuditorium

DEPARTMENT OF PARKS AND RECREATION
CITY AND COUNTY OF HONOLULU
1000 ULUOAHUA ST. 4TH FLOOR - HAWAII, HAWAII 96813
TELEPHONE: (808) 492-3561 FAX: (808) 522-5131 • INTERNET: www.parksandrec.hawaii.gov



May 1, 2003

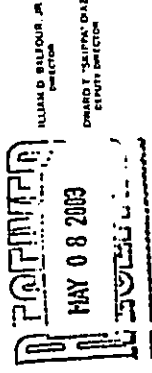

J. Remy Harris
Mayor

FOR REFERENCE CS-DK

POLICE DEPARTMENT
CITY AND COUNTY OF HONOLULU
801 SOUTH BERETANIA STREET
HONOLULU, HAWAII 96813 - AREA CODE (808) 29-3111
http://www.honolulu.gov
www.ccp.honolulu.hawaii.gov



April 23, 2003

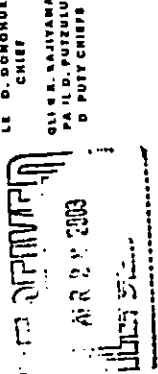

LEE D. DONOHUE
Chief
OLIVER K. SAITAMA
PAUL D. YUZZULU
D. POTT CHIEFS

Mr. Glenn T. Kimura, President
Kimura International
1600 Kapiolani Blvd., Suite 1610
Honolulu, Hawaii 96814

Dear Mr. Kimura:

Subject: Roosevelt High School Auditorium Renovation
Environmental Assessment/Early Consultation

Thank you for the opportunity to review and comment on the proposed renovation to the Roosevelt High School Auditorium.

When evaluated by the Oahu Civil Defense Agency for use as an emergency shelter, the Auditorium did not qualify because of the six tightly screened openings in the rear wall, sixteen open, fixed wooden louvers and six sets of double doors that did not have full sets of panic hardware and bracing.

The Department of Parks and Recreation recommends that renovations to the auditorium include modifications to these items that will qualify the auditorium as a public shelter during times of emergency. Having a new building capable of sheltering over 750 people will significantly complement the public shelters servicing the surrounding community.

Should you have any questions, please contact Mr. John Reid, Planner, at 692-5454.

Sincerely,

William D. Balfour, Jr.
WILLIAM D. BALFOUR, JR.,
Director

WDB:mk (J. Reid, ESO)
(2/1995)

cc: Mr. Don Griffin, Department of Design and Construction
Mr. Peter Hirai, Oahu Civil Defense Agency

Mr. Glenn T. Kimura, President
Kimura International, Inc.
1600 Kapiolani Boulevard, Suite 1610
Honolulu, Hawaii 96814

Dear Mr. Kimura:

Thank you for the opportunity to comment on the Early Consultation for the Roosevelt High School Auditorium Renovation project.

Roosevelt High School is in District 1 (Honolulu). It covers the area between Pacific Heights and Punahou Street and operates from the main police headquarters at 801 South Beretania Street.

Based on the project description that was provided, the proposed renovation should have negligible impact on police services to the area.

If there are any questions, please call Major Michael Tucker of District 1 at 529-3386 or Ms. Carol Sodekani of the Support Services Bureau at 529-3658.

LEE D. DONOHUE
Chief of Police

By *Karl Godsey*
KARL GODSEY
Assistant Chief of Police
Support Services Bureau

Printing and Postmarking with Aloha

DEPARTMENT OF FACILITY MAINTENANCE
CITY AND COUNTY OF HONOLULU
1000 ALUAKA STREET - SUITE 215 - HAWAII, HAWAII 96813
Phone: (808) 525-5554 - Fax: (808) 592-5857



JEREMY HARRIS
MAYOR

RECEIVED
MAY 12 2003
LARRY J. LEOPARDI
DIRECTOR AND CHIEF ENGINEER

A UNIKO AN
DE JTI DIRECTOR
INI NI A NY REFER TO.

PRO 03-028

April 22, 2003

Mr. Glenn T. Kimura, President
Kimura International, Inc.
1600 Kapiolani Boulevard, Suite 1610
Honolulu, Hawaii 96814

Dear Mr. Kimura:

Subject: EARLY CONSULTATION
ROOSEVELT HIGH SCHOOL AUDITORIUM RENOVATION

The Department of Facility Maintenance does not have any comments at this time.

Very truly yours,

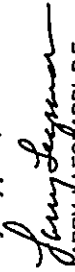
LARRY LEOPARDI, P.E.
DIRECTOR AND CHIEF ENGINEER

GEN-6 EIS(EA)

RECEIVED
MAY 26 2003
HAWAII

May 16, 2003



Mr. Glenn T. Kimura
Kimura International, Inc.
1600 Kapiolani Boulevard - Suite 1610
Honolulu, HI 96814

Dear Mr. Kimura:

Re: Roosevelt High School Auditorium Renovation
Honolulu, Oahu

Thank you for the opportunity for early comment on the subject project, as proposed by the Department of Account & General Services, State of Hawaii. We have reviewed the information provided and have no comments at this time.

HECO reserves the opportunity to further comment on the protection of existing powerlines and electric power facilities that may be affected by the project until construction plans are finalized. Again, thank you for the opportunity to comment on this draft EA.

Sincerely,



Kirk S. Tomita
Senior Environmental Scientist

cc: Ms. Genevieve Salmonson (OEQC)

LJL:lh

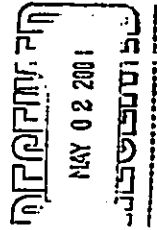

WINNER OF THE EDISON AWARD
FOR DISTINGUISHED INDUSTRY LEADERSHIP



Verizon Hawaii, Inc.
P.O. Box 2200
Honolulu, HI 9 841



The Senate
State of Hawaii

STATE CAPITOL
HOPU LULU, HAWAII 96813
May 6, 2003

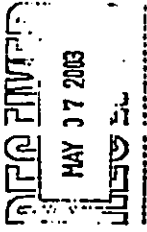

April 30, 2003

Mr. Glenn Kimura
KIMURA INTERNATIONAL, INC.
1600 Kapiolani Boulevard, Suite 1610
Honolulu, Hawaii 96814

Subject: ROOSEVELT HIGH SCHOOL AUDITORIUM RENOVATION
HONOLULU, HAWAII
EARLY CONSULTATION

Dear Mr. Kimura:

Thank you for providing Verizon Hawaii Incorporated, the opportunity to comment on the Draft Environmental Assessment for the State of Hawaii Department of Accounting and General Services (DAGS) for the renovation of the Roosevelt High School Auditorium Honolulu, Hawaii.

We have no comments or changes to the Draft EA at this time.

If there are any questions, please call Glenn Morita at 840-5809.

Sincerely Yours,

Lynette Yoshida
Section Manager -
Network Engineering & Planning

c: File (1025 ALAK)
G. Morita

Mr. Glenn T. Kimura, President
Kimura International, Inc.
1600 Kapiolani Boulevard, Suite 1610
Honolulu, Hawaii 96814

Subject: Roosevelt High School Auditorium Renovation, Honolulu, Hawaii

This is in reference to your request for input prior to completing a Draft Environmental Assessment (EA) for the State of Hawaii Department of Accounting and General Services (DAGS) for the renovation of the Roosevelt High School Auditorium, Honolulu, Hawaii.

The Legislature has appropriated CIP funds for Roosevelt High School Auditorium renovations in 2000, 2001-2002 and 2003. I would appreciate your reviewing the following concerns in the Draft EA:

1. There is a pedestrian safety problem at the intersection of Nehoa Street and Lewalani Drive, fronting Roosevelt High School. Several accidents and near accidents have occurred during the past 24 months. My office has requested that DTS and DOE consider:
 - (a) removing the crosswalk at that intersection because cars driving mauka on Nehoa Street often do not see pedestrians until they reach the Lewalani corner;
 - (b) relocating the bus stop to the Nehoa/Moiti-Smith corner to reduce the hazardous traffic conditions at Nehoa/Lewalani Drive. The City's Department of Transportation Services has asked DOE safety engineers to review the request and come back with their recommendations.

2. In light of the traffic hazards involving Nehoa Street/Lewalani Drive, I would appreciate your disabled access planning/design to address the additional hazards posed by vehicular access in/around the Nehoa Street entrance to Roosevelt Campus.

Should you have any questions, please call Judy Gold of my staff at 586-6890. Thank you for your assistance in this matter.

Sincerely,

Senator Carol Fukuyaga
District 11 (Makiki/Tantalus-Ala Moana)

cc: Mr. Dennis Hokama
Mr. Willard Gouveia

Comments Received During DEIS Review Period



DEPARTMENT OF THE ARMY
U.S. ARMY ENGINEER DISTRICT, HONOLULU
FORT SHAFTER, HAWAII 96858-5440

REPLY TO
ATTENTION: CPO4046CT

June 25, 2003

Civil Works Technical Branch

Ms. Leslie Kurisaki
Kimura International
1600 Kapiolani Boulevard, Suite 1610
Honolulu, Hawaii 96814

Dear Ms. Kurisaki:

Thank you for the opportunity to review and comment on the Draft Environmental Assessment (DEA) for the Roosevelt High School Renovation, Honolulu, Oahu (TMK 2-4-32: 1). The following comments are provided in accordance with Corps of Engineers authorities to provide flood hazard information and to issue Department of the Army (DA) permits.

- a. Based on the information provided, a DA permit will not be required for the project.
 - b. The flood hazard information provided on page 3-4 of the DEA is correct.
- Should you require additional information, please contact Ms. Jessie Dobinchick of my staff at (808) 438-8876.

Sincerely,

James Pennaz
James Pennaz, P.E.
Chief, Civil Works
Technical Branch



July 30, 2003

Mr. James Pennaz, P.E.
Chief, Civil Works Technical Branch
Department of the Army
U.S. Army Engineer District, Honolulu
Fort Shafter, Hawaii 96858-5440

Dear Mr. Pennaz:

**Subject: Roosevelt High School Building A, Auditorium Renovation
Draft Environmental Assessment
Your Letter dated June 25, 2003**

Thank you for your review of the Roosevelt High School Building A, Auditorium Renovation Draft EA. We have received a copy of your letter dated June 25, 2003, and note that a DA permit is not required.

If you have questions or other comments, please contact me or Mr. Dail Rhee, Public Works Division, State of Hawaii Department of Accounting and General Services at 586-0467.

Sincerely,

KIMURA INTERNATIONAL, Inc.

Glenn T. Kimura

Glenn T. Kimura
President

Cc: Gabe Won, CDS International
Dail Rhee, DAGS

1600 Kapiolani Blvd., Suite 1610
Honolulu, Hawaii 96814
Tel: (808) 944-8848 • Fax: (808) 944-8999



STATE OF HAWAII
DEPARTMENT OF EDUCATION
P.O. BOX 2360
HONOLULU, HAWAII 96804

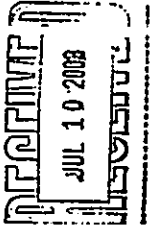

OFFICE OF BUSINESS SERVICES

July 3, 2003

MEMO TO: Mr. Gregory Tanaka
Project Management Branch
Public Works Division, DAGS
Raynor M. Minami
F R O M: Raynor M. Minami, Director
Facilities and Support Services Branch
SUBJECT: Draft Environmental Assessment (DEA)
Roosevelt High School - Auditorium Renovation
Honolulu, Hawaii TMK: 2-4-32:001

The Department of Education has reviewed the DEA for the renovation of the auditorium at Roosevelt High School. We have no comment concerning the proposed project.

Thank you for the opportunity to review the plans.

Should you have any questions, please call Ms. Heidi Meeker of our branch at 733-4862.

RMM:HM:hy

cc: Rae M. Louj, OBS
Genevieve Salmonson, OEQC
Leslie Kurisaki, Kimura International, Inc.

AN AFFIRMATIVE ACTION AND EQUAL OPPORTUNITY EMPLOYER



July 25, 2003

Mr. Raynor M. Minami, Director
Facilities and Support Services Branch
State of Hawaii
Department of Education
P.O. Box 2360
Honolulu, Hawaii 96804

Dear Mr. Minami:

Subject: Roosevelt High School Building A, Auditorium Renovation
Draft Environmental Assessment
Your Letter to DAGS dated July 3, 2003

Thank you for your review of the Roosevelt High School Building A, Auditorium Renovation Draft EA. We have received a copy of your memo to DAGS dated July 3, 2003 and note that you have no comments.

If you have questions or comments, please contact me or Mr. Dail Rhee, Public Works Division, State of Hawaii Department of Accounting and General Services at 586-0467.

Sincerely,

KIMURA INTERNATIONAL, Inc.

Glenn T. Kimura
President

Cc: Gabe Won, CDS International
Dail Rhee, DAGS

1600 Kapiolani Blvd., Suite 1610
Honolulu, Hawaii 96814
Tel (808) 941-8818 • Fax (808) 941-8999

LEON I. LEONG
GOVERNOR
STATE OF HAWAII



JUN 18 2003

UPPER ALI'OLE
MAIL ROOM
STATE OF HAWAII
DEPARTMENT OF PUBLIC WORKS
DIVISION OF PUBLIC WORKS
P.O. BOX 1879
HONOLULU, HAWAII 96805

STATE OF HAWAII
DEPARTMENT OF HAWAIIAN HOMELANDS
P.O. BOX 1879
HO OLI'OLE, HAWAII 96805

June 16, 2003

To: Gregory Tanaka, Project Manager
Department of Accounting and General Services
Division of Public Works, Project Management Branch

From: *Michael A. Kane*
Michael A. Kane, Chairman
Hawaiian Homes Commission

Subject: Roosevelt High School Auditorium Renovation, Honolulu,
Oahu

Thank you for the opportunity to comment on the draft environmental assessment report for the Roosevelt High School Auditorium Renovation project. The Department of Hawaiian Home Lands has no comments to offer.

If you have any questions, please call me at 586-3801 or call our Planning Office at 586-3836.

c: OEQC
Kimura International, Inc.

July 25, 2003

Mr. Micah A. Kane, Chairman
Hawaiian Homes Commission
State of Hawaii
Department of Hawaiian Home Lands
P.O. Box 1879
Honolulu, Hawaii 96805

Dear Mr. Kane:

Subject: Roosevelt High School Building A, Auditorium Renovation
Draft Environmental Assessment
Your Memo to DAGS dated June 16, 2003

Thank you for your review of the Roosevelt High School Building A, Auditorium Renovation Draft EA. We have received a copy of your memo to DAGS dated June 16, 2003, and note that you have no comment.

If you have questions or other comments, please contact me or Mr. Dail Rhee, Public Works Division, State of Hawaii Department of Accounting and General Services at 586-0467.

Sincerely,

KIMURA INTERNATIONAL, Inc.

Glenn T. Kimura

Glenn T. Kimura
President

Cc: Gabe Won, CDS International
Dail Rhee, DAGS

1600 Kapehau Blvd., Suite 1610
Honolulu, Hawaii 96814
Tel: (808) 944-0818 • Fax: (808) 941-8999



July 29, 2003

Ms. Holly P. A. McEldowney, Acting Administrator
State of Hawaii
Department of Land and Natural Resources
State Historic Preservation Division
Kakuhiihewa Building, Room 555
601 Kamokila Blvd.
Kapolei, Hawaii 96707

Dear Ms. McEldowney:

Subject: Roosevelt High School Building A, Auditorium Renovation
Draft Environmental Assessment
Your Letter to DAGS dated June 23, 2003
(LOG NO: 2003.0906, DOC NO: 0306st12, Architecture)

Thank you for your review of the Roosevelt High School Building A, Auditorium Renovation Draft EA. We have received a copy of your EA comment letter to DAGS dated June 23, 2003 and have the following comments:

Architectural Concerns

Your letter states that SHPD believes "the addition of handrails for the new accessible ramps along Nehoa Street will create an obscuring element of the historic building and the determination for the project is 'historic properties adversely affected.'"

In a follow up phone conversation between Susan Tasaki of your staff and Gabe Won, CDS International, it was agreed that the slope of the ramp fronting the Auditorium would be modified so that handrails would not be required in front of the historic façade. Other design modifications agreed to include lowering an existing exit from the basement on the Nehoa Street façade, and removal of the existing Auditorium ceiling. These items were summarized in your subsequent June 26, 2003 letter to Gabe Won (LOG NO: 2003.1002, DOC NO: 0306st17, Architecture). That letter also requested photographic documentation of the existing Auditorium's interior and stage and the existing courtyard, in accordance with Historic American Buildings Survey (HABS) standards.

Archaeological Concerns

We acknowledge your finding that the project will have "no effect" on archaeological sites.

If you have questions or comments, please contact me or Mr. Dail Rhee, Public Works Division, State of Hawaii Department of Accounting and General Services at 586-0467.

Sincerely,

KIMURA INTERNATIONAL, Inc.

Glenn T. Kimura
President

Cc: Gabe Won, CDS International
Dail Rhee, DAGS



CDS INTERNATIONAL, L.L.C.
 Architects • Planners • Interior Design • Graphic Design

Memo

To: CDS International

Date: 19 Jun 2003

Project Number: 02-00

Project Name: Roost /elt HS Auditorium Renovation (DACS Job No. 12-16-4018)

Subject

Per phone conversation with Susan Tasaki of DLNR State Historic Preservation Division, the following items were discussed.

- Susan stated that a 1:20 ramp could be used in order not to have railings that would comply with the Carol Ogata fax dated June 25, 2003. She later clarified that no railings could be introduced on the existing Auditorium Nehoa Street facade, however the New Extension facade could have ramps with railings. Gabriel stated that the elevation drawings are essentially the same elevations that were shown to Don Hibbard and Carol Ogata.
- CDS is proposing removing the existing seating area ceiling. The existing Auditorium ceiling shape and finish are not conducive acoustically to the band performances or plays. The flat shaped ceiling does not reflect sound effectively and the acoustical spray finish absorbs sound. This result is an Auditorium where sound can't be heard at the rear of the existing Auditorium. With the Renovations, the New Clouds would redirect sound effectively and be conducive to musical and vocal performances. Supports for the New Clouds, Lights, Stage Lighting, and Air-Conditioning would generate numerous holes through the existing ceiling, which would be hidden by the New Clouds. In addition, our Structural Engineer's preliminary indications show that the existing roof trusses will not be able to support both the existing ceiling and New Clouds. Gabriel will send Susan interior photos of the existing ceiling for reference.
- CDS is proposing on lowering the existing exit from the existing Basement on the Nehoa Street facade. The door location will remain the same, but be lowered about 3 feet. The existing exit does not meet existing building codes and could not be utilized by the Renovation. Gabriel will send Susan a photo of the existing condition, where the stage floor reduces the interior height of the exit door.

Gabriel K.K. Won
 Gabriel K.K. Won, RA
 Project Manager

Note: We assure that the above-mentioned items are stated correctly and that any further work or discrepancy will be based on these statements, unless we are notified to the contrary within 7 days of the above date, in writing, by one of the above-mentioned parties.

1001 Bishop Street • Pahuhi Tower Suite 400 • Honolulu, HI, USA 96813-3499
 Tel: (808) 524-4200 • FAX: (808) 521-3766 • e-mail: mail@cdsintl.com

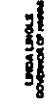

DEPARTMENT OF LAND AND NATURAL RESOURCES
 HISTORIC PRESERVATION DIVISION
 KAUAIHANA HALL BUILDING, ROOM 1555
 601 K. MOKUA BOULEVARD
 HONOLULU, HAWAII 96817



STATE OF HAWAII
 BOARD OF LAND AND NATURAL RESOURCES
 COMMISSIONER OF LAND AND NATURAL RESOURCES
 DEPARTMENT OF LAND AND NATURAL RESOURCES
 601 K. MOKUA BOULEVARD
 HONOLULU, HAWAII 96817

June 26, 2003

Gabriel K.K. Won, RA
 CDS International
 1001 Bishop Street, Pahuhi Tower, Suite 400
 Honolulu, Hawaii 96813-3499

LOG NO: 2003.1002
 DOC NO: 0306st27
 Architecture

Dear Mr. Won:

**SUBJECT: Chapter 6E (HRS) Review
 Exterior Ramps, Auditorium Ceiling, Fire Exit Door
 Roosevelt High School - Building A, Auditorium Renovation, Phase I
 Honolulu, Oahu, Hawaii
 IMK: (1) 2-4-032:002**

Thank you for the memo dated June 19, 2003, regarding a telephone conversation with SHPD staff, Susan Tasaki. As discussed the proposed changes to the project as earlier submitted are: (1) use of a 1:20-sloped ramp instead of a 1:12-sloped ramp fronting the existing Auditorium's Nehoa Street facade, thereby not requiring handrails in front of the historic facade only; (2) lowering of an existing exit from the existing Basement on the Nehoa Street facade about 3 feet to meet building code requirements; (the existing stage floor reduces the interior height of the exit door).

Also discussed is the proposed removal of the existing Auditorium ceiling, the shape and finish of which are not conducive acoustically for performances or plays and the surface of which will receive resultant numerous holes for support systems. The Structural Engineer has advised that the existing roof trusses will not be able to support both the existing ceiling as well as proposed modifications.

We request photographs (35 mm black and white) of the existing Auditorium's interior and stage, and of the existing courtyard. Thank you for the opportunity to comment. Should you have any questions regarding architecture please contact Susan Tasaki at 682-8032.

Aloha,
P. Holly McEldowney
 P. Holly McEldowney, Acting Administrator
 State Historic Preservation Division

ST:jrk



STATE OF HAWAII
DEPARTMENT OF HEALTH
P.O. BOX 3378
HONOLULU, HAWAII 96801-3378

RECEIVED
JUL 23 2003
HAWAII

ANTHONY L. FRUNDO, M.D.
DIRECTOR OF HEALTH

DATE RECEIVED
DATE TIME

07062PKP.03

July 22, 2003

The Honorable Russ K. Saito
Comptroller
Department of Accounting and General Services
P.O. Box 119
Honolulu, Hawaii 96810-0119

Attention: Mr. Gregory Tanaka
Project Management Branch
Division of Public Works

Dear Mr. Saito:

Subject: Draft Environmental Assessment
Roosevelt High School, Building A, Auditorium Renovation

The Department of Health, Clean Water Branch (CWB) has reviewed the subject document and offers the following comments:

1. The Army Corps of Engineers should be contacted at (808) 438-9258 to identify whether a Federal license or permit (including a Department of Army permit) is required for this project. Pursuant to Section 401(a)(1) of the Federal Water Pollution Act (commonly known as the "Clean Water Act"), a Section 401 Water Quality Certification is required for "[a]ny applicant for Federal license or permit to conduct any activity including, but not limited to, the construction or operation of facilities, which may result in any discharge into the navigable waters...."
2. A National Pollutant Discharge Elimination System (NPDES) general permit coverage is required for the following activities:
 - a. Storm water associated with industrial activities, as defined in Title 40, Code of Federal Regulations, Sections 122.26(b)(14)(i) through 122.26(b)(14)(ix) and 122.26(b)(14)(xi).
 - b. Construction activities, including clearing, grading, and excavation, that result in the disturbance of equal to or greater than one (1) acre of total land area. The total land area includes a contiguous area where multiple separate and distinct construction

The Honorable Russ K. Saito
July 22, 2003
Page 2

activities may be taking place at different times on different schedules under a larger common plan of development or sale. An NPDES permit is required before the commencement of the construction activities.

- c. Discharge of treated effluent from leaking underground storage tank remedial activities.
- d. Discharge of once through cooling water less than one (1) million gallons per day;
- e. Discharge of hydrotesting water.
- f. Discharge of construction dewatering effluent.
- g. Discharge of treated effluent from petroleum bulk stations and terminals.
- h. Discharge of treated effluent from well drilling activities.
- i. Discharges of treated effluent from recycled water distribution systems.
- j. Discharges of storm water from a small municipal separate storm sewer system.
- k. Discharge of circulation water from decorative ponds or tanks.

The CWB requires that a Notice of Intent (NOI) to be covered by a NPDES general permit for any of the above activities be submitted at least 30 days before the commencement of the respective activities. The NOI forms may be picked up at our office or downloaded from our website at <http://www.state.hi.us/doh/cwb/forms/egm1-index.html>.

3. The applicant may be required to apply for an individual NPDES permit if there is any type of activity in which wastewater is discharged from the project into State waters and/or coverage of the discharge(s) under the NPDES general permit(s) is not permissible (i.e. discharges into Class 1 or Class AA waters). An application for the NPDES permit is to be submitted at least 180 days before the commencement of the respective activities. The NPDES application forms may also be picked up at our office or downloaded from our website at <http://www.state.hi.us/doh/cwb/forms/indiv-index.html>.

4. Hawaii Administrative Rules, Section 11-55-38, also requires the owner to either submit a copy of the new NOI or NPDES permit application to the State Department of Land and Natural Resources, State Historic Preservation Division (SHPD) or demonstrate to the satisfaction of the DOH that the project, activity, or site covered by the NOI or application

has been or is being reviewed by SHI D. Please submit a copy of the request for review by SHPD or SHI D's determination letter for the project.

If you have any questions, please contact me at CWB at 586-4309.

Sincerely Yours,

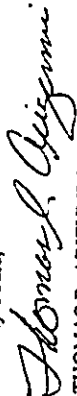
THOMAS R. ARIZUMI, P.E., CHIEF
Environmental Management Division

K.P:cu

c: Director, Office of Environmental Quality Control
Leslie Kurisaki, Kimura International, Inc.



July 28, 2003

Mr. Thomas F. Arizumi, P.E., Chief
Environmental Management Division
State of Hawaii
Department of Health
P.O. Box 3378
Honolulu, Hawaii 96801-3378

Dear Mr. Arizumi:

Subject: Roosevelt High School Building A, Auditorium Renovation
Draft Environmental Assessment
Your Letter to DAGS dated July 22, 2003

Thank you for your review of the Roosevelt High School Building A, Auditorium Renovation Draft EA. We have received a copy of your letter to DAGS dated July 22, 2003 and have the following responses to your comments:

1. In a June 25, 2003 letter providing comments on the Draft EA, the Army Corps of Engineers noted that a DA permit will not be required for the project.
2. We do not anticipate the need for a National Pollutant Discharge Elimination System (NPDES) general permit, as project activities will not generate discharge other than storm water. In addition, the project size is approximately 0.5 acres, below the NPDES one-acre threshold.
3. We do not anticipate the need for an individual NPDES permit, as no wastewater will be discharged from the project into State waters or into Class 1 or Class AA waters.
4. Should NPDES permit(s) be required, a copy of the NOI or NPDES permit application will be submitted to the DLNR State Historic Preservation Division, as required. A copy of the request for review or the SHPD determination letter will be sent to your office.

Mr. Thomas Ahiz mi
July 28, 2003
Page 2

If you have questions or other comments, please contact me or Mr. Dail Rhee, Public Works Division, State of Hawaii Department of Accounting and General Services at 508-0467.

Sincerely,

KIMURA INTERNATIONAL, Inc.



Glenn T. Kimura
President

Cc: Gabe Won, CDS International
Dail Rhee, DAGS

LEOLA LIMOLE
DIRECTOR OF HEALTH



STATE OF HAWAII
DEPARTMENT OF HEALTH
P.O. BOX 3378
HONOLULU, HAWAII 96814

RECEIVED
AUG 11 2003
STATE OF HAWAII

OTOMELI, JAMES M.A.
DIRECTOR OF HEALTH

In reply, please refer to
EUC/198
01 113 001-104
PS 010072

August 4, 2003

Mr. Glenn T. Kimura
Kimura International
1600 Kapiolani Blvd., Suite 1610
Honolulu, Hawaii 96814

Dear Mr. Kimura:

Subject: Draft Environmental Assessment
Roosevelt High School - Building A, Auditorium Renovation
Honolulu, Oahu
TMK: (1) 2-4-032: 001 19.951 acre campus

We have reviewed the subject document which requests comments to the proposed renovation and expansion of an existing auditorium located in Building A at Roosevelt High School, Honolulu, Hawaii.

As wastewater generated on the property will be treated and disposed of via the City's sewer system, we have no objections to the proposed project.

All wastewater plans must conform to applicable provisions of the Department of Health's Administrative Rules, Chapter 11-62, "Wastewater Systems." We do reserve the right to review the detailed wastewater plans for conformance to applicable rules. Should you have any questions, please contact the Planning & Design Section of the Wastewater Branch at 586-4294.

Sincerely,



HAROLD K. YEE, P.E., CHIEF
Wastewater Branch

LNK:erm

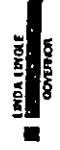

CEC JEWEL SALMONSON
DIRECTOR

STATE OF HAWAII
OFFICE OF ENVIRONMENTAL QUALITY CONTROL
2301 SOUTH BETHLEHEM STREET
HONOLULU, HAWAII 96813
TEL: (808) 586-5100
FAX: (808) 586-5100

RECEIVED
JUL 11 2003
STATE OF HAWAII

August 12, 2003

Mr. Harold K. Yee, P.E., Chief
Wastewater Branch
State of Hawaii
Department of Health
P.O. Box 3378
Honolulu, Hawaii 96801-3378

Dear Mr. Yee:

**Subject: Roosevelt High School Building A, Auditorium Renovation
Draft Environmental Assessment
Your Letter dated August 4, 2003**

Thank you for your review of the Roosevelt High School Building A, Auditorium Renovation Draft EA. We have received a copy of your letter dated August 4, 2003 and note that you have no objections to the proposed project.

If you have questions or comments, please contact me or Mr. Dail Rhee, Public Works Division, State of Hawaii Department of Accounting and General Services at 586-0467.

Sincerely,

KIMURA INTERNATIONAL, Inc.

Glenn T. Kimura
President

Cc: Gabe Won, CDS International
Dail Rhee, DAGS

1600 Kaysland Blvd., Suite 1610
Honolulu, Hawaii 96814
Tel (808) 941-8548 • Fax (808) 941-8999

July 8, 2003

Mr. Russ K. Saito, Comptroller
Department of Accounting and General Services
P.O. Box 119
Honolulu, Hawaii 96810

Dear Mr. Saito:

Subject: Draft EA for the Roosevelt High School Building A, Auditorium Renovation

Thank you for the opportunity to review the subject document. We have the following comments.

1. Please consider applying sustainable building techniques as presented in the "Guidelines for Sustainable Building Design in Hawaii," which is available at OEQC's website
2. This project should comply with sections 103D-107 and 408 of Hawaii Revised Statutes concerning the use of indigenous plants and recycled glass.
3. Please include any correspondence with the Outdoor Circle in the environmental assessment.

Should you have any questions, please call Jeyan Thirugnanam at 586-4185.

Sincerely,

Gedicvieve Salmonson
Director

c: Kimura International.

LOCAL GOVERNMENT



LILLIAN B. KOLLER, ESQ.
DIRECTOR
HENRY XUYA
DEPUTY DIRECTOR

STATE OF HAWAII
DEPARTMENT OF HUMAN SERVICES
P. O. Box 339
Honolulu, Hawaii 96809-0339

RECEIVED
JUN 17 2003
HONOLULU

June 26, 2003

Mr. Gregory Tanaka
Department of Accounting and General Services
Division of Public Works/Project Management Branch
P. O. Box 119
Honolulu, Hawaii 96810-0119

Dear Mr. Tanaka:

Thank you for the opportunity to comment on your Draft Environmental Assessment (DEA) relating to the Roosevelt High School, Building A, Auditorium Renovation.

We have reviewed your document and have no objections to the proposed renovations to the auditorium. As we are responsible for the licensing of child care programs on Department of Education (DOE) sites only when DOE contracts the use of their facilities for child care programs, this particular project would have no impact on our licensing requirements at this time.

Should you have any questions, please feel free to contact Elaine Rabacai, Supervisor, at the Child Care Connection Hawaii Unit I of the Benefit, Employment and Support Services Division at 587-5271.

Sincerely,

Lillian B. Koller, Esq.
Director

cc: Office of Environmental Quality Control
Kimura International, Inc.

AN EQUAL OPPORTUNITY AGENCY



July 29, 2003

Ms. Genevieve Salmonson, Director
State of Hawaii
Office of Environmental Quality Control
235 S. Beretania St., Suite 702
Honolulu, Hawaii 96813

Dear Ms. Salmonson:

Subject: Roosevelt High School Building A, Auditorium Renovation
Draft Environmental Assessment
Your Letter to DAGS dated July 8, 2003

Thank you for your review of the Roosevelt High School Building A, Auditorium Renovation Draft EA. We have received a copy of your letter to DAGS dated July 8, 2003, and have the following responses to your comments:

1. Sustainable building techniques will be incorporated in the design as deemed appropriate for the project.
2. The project will comply with sections 103D-407 and 408 of Hawaii Revised Statutes concerning the use of indigenous plants and recycled glass.
3. Correspondence with the Outdoor Circle will be included in the Final EA.

If you have questions or other comments, please contact me or Mr. Dail Rhee, Public Works Division, State of Hawaii Department of Accounting and General Services at 586-0467.

Sincerely,

KIMURA INTERNATIONAL, Inc.

Glenn T. Kimura
President

Cc: Gabe Won, CDS International
Dail Rhee, DAGS

1600 Kapiolani Blvd., Suite 1610
Honolulu, Hawaii 96814
Tel (808) 944-8818 • Fax (808) 944-8999



July 25, 2003

Ms. Lillian B. Koller, Esq.
Director
State of Hawaii
Department of Human Services
P.O. Box 339
Honolulu, Hawaii 96809-0339

Dear Ms. Koller:

**Subject: Roosevelt High School Building A, Auditorium Renovation
Draft Environmental Assessment
Your Letter to DAGS dated June 26, 2003**

Thank you for your review of the Roosevelt High School Building A, Auditorium Renovation Draft EA. We have received a copy of your letter to DAGS dated June 26, 2003 and note that your department has no objections to the project.

If you have questions or other comments, please contact me or Mr. Dail Rhee, Public Works Division, State of Hawaii Department of Accounting and General Services at 586-0467.

Sincerely,

KIMURA INTERNATIONAL, Inc.

Glenn T. Kimura
President

Cc: Gabe Won, CDS International
Dail Rhee, DAGS

1600 Kapealani Blvd., Suite 1610
Honolulu, Hawaii 96814
Tel (808) 944-8618 • Fax (808) 944-8999



July 30, 2003

Mr. Clifford S. Jamile
Manager and Chief Engineer
Board of Water Supply
City and County of Honolulu
630 South Beretania Street
Honolulu, Hawaii 96843

Dear Mr. Jamile:

**Subject: Roosevelt High School Building A, Auditorium Renovation
Draft Environmental Assessment
Your Letter dated June 27, 2003**

Thank you for your review of the Roosevelt High School Building A, Auditorium Renovation Draft EA. We have received your letter dated June 27, 2003 stating that the existing water system is adequate to accommodate the proposed project.

We also note that the availability of water will be confirmed when the building permit is approved and that a Water System Facilities Charges will be imposed for resource development, transmission and daily storage. We also acknowledge that the project is subject to BWS Cross-Connection Control and Backflow Prevention requirements prior to the issuance of the building permit application.

If you have questions or other comments, please contact me or Mr. Dail Rhee, Public Works Division, State of Hawaii Department of Accounting and General Services at 586-0467.

Sincerely,

KIMURA INTERNATIONAL, Inc.

Glenn T. Kimura
President

Cc: Gabe Won, CDS International
Dail Rhee, DAGS

1600 Kapealani Blvd., Suite 1610
Honolulu, Hawaii 96814
Tel (808) 944-8618 • Fax (808) 944-8999

BOARD OF WATER SUPPLY
CITY AND COUNTY OF HONOLULU
525 SOUTH BERTANHA STREET
HONOLULU, HI 96843



June 27, 2003

JEFFREY H. MOSE, Mayor
EDDIE FULFORD, ESQ., Chairman
CHARLES STED, Vice-Chairman
JAN MULLY, AM
HERBERT K. KAGURUA, SA
DAROLYN LINDO
ROSEMARY HANAGA, ESQ., Mayor
LARRY L. OPAROA, ESQ., Mayor
CLIFFORD S. JAMILE
Manager and Chief Engineer
DONALD P. K. KYOSAKI
Deputy Manager and Chief Engineer

Mr. Gregory Tanaka
Division of Public Works
Department of Accounting and General Services
State of Hawaii
Project Management Branch
P. O. Box 119
Honolulu, Hawaii 96810-0119

Dear Mr. Tanaka:
Subject: Draft Environmental Assessment for Roosevelt High School,
Building A, Auditorium Renovation. TMK: 2-4-32-1

Thank you for the opportunity to comment on the subject document.
The existing water system is presently adequate to accommodate the proposed auditorium renovation.
The availability of water will be confirmed when the building permit is approved. When water is made available, the applicant will be required to pay our Water System Facilities Charges for resource development, transmission and daily storage.
The proposed project is subject to Board of Water Supply Cross-Connection Control and Backflow Prevention requirements prior to the issuance of the Building Permit Application.

If you have any questions, please contact Joseph Kaakua at 748-5440.

Very truly yours,

K. S. Jamile
CLIFFORD S. JAMILE
Manager and Chief Engineer

cc: Office of Environmental Quality Control
Leslie Kurisaki, Kimura International, Inc.

DEPARTMENT OF DESIGN AND CONSTRUCTION
CITY AND COUNTY OF HONOLULU
650 SOUTH KING STREET, 11TH FLOOR
HONOLULU, HAWAII 96813
Phone: (808) 521-4344 • Fax: (808) 527-4577
Web: WWW.DCA.HONOLULU.HI



July 10, 2003

Mr. Gregory Tanaka
Project Management Branch
Division of Public Works
Department of Accounting and General Services
State of Hawaii
P. O. Box 119
Honolulu, Hawaii 96810-0119

Dear Mr. Tanaka:
Subject: Draft Environmental Assessment (DEA) for Roosevelt High School,
Building A, Auditorium Renovation

This is in response to your letter of June 5, 2003 regarding the subject project.
The Department of Design and Construction has no comments to offer, and we thank you for the opportunity to review the project.

Please call Mr. Gary Doi at 527-6699 if there are any questions.

Very truly yours,

Timothy E. Steinberger
for TIMOTHY E. STEINBERGER, P.E.
Director

TES:ci
cc: Genevieve Salomonson, Director, OEQC
Leslie Kurisaki, Kimura International, Inc.

JUL 11 2003

TIMOTHY E. STEINBERGER, P.E.
DIRECTOR



July 30, 2003

Mr. Timothy I. Steinberger, P.E.
Department of Design and Construction
City and County of Honolulu
650 S. King St., 11th Floor
Honolulu, Hawaii 96813

Dear Mr. Steinberger:

**Subject: Roosevelt High School Building A, Auditorium Renovation
Draft Environmental Assessment
Your Letter to DAGS dated July 10, 2003**

Thank you for your review of the Roosevelt High School Building A, Auditorium Renovation Draft EA. We have received a copy of your letter to DAGS dated July 10, 2003, and note that you have no comments.

If you have questions or comments, please contact me or Mr. Dail Rhee, Public Works Division, State of Hawaii Department of Accounting and General Services at 586-0467.

Sincerely,

KIMURA INTERNATIONAL, Inc.

Glenn T. Kimura
President

Cc: Gabe Won, CDS International
Dail Rhee, DAGS

1600 Kapiolani Blvd., Suite 1610
Honolulu, Hawaii 96816
Tel (808) 944-8818 • Fax (808) 941-8799

CITY AND COUNTY OF HONOLULU
FIRE DEPARTMENT
3375 KANANUA STREET, JITE #425 - HONOLULU, HAWAII 96819
TELEPHONE: (808) 831-7781 • FAX: (808) 831-7250 • INTERNET: www.honolulu.gov

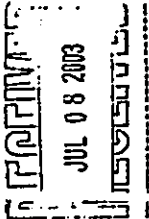

July 2, 2003

Mr. Gregory Tanaka, Project Coordinator
Project Management Branch
Division of Public Works
State of Hawaii
Department of Accounting and General Services
P.O. Box 119
Honolulu, Hawaii 96810-0119

Dear Mr. Tanaka:

**Subject: Draft Environmental Assessment
Project: Roosevelt High School, Building A, Auditorium Renovation
Location: Oahu, Honolulu District
Tax Map Key: 2-4-032: 001**

We received a letter dated June 5, 2003, from Glenn T. Kimura of Kimura International Inc., requesting our review and comments on the above-mentioned project.

The proposed project will not adversely impact the services provided by the Honolulu Fire Department.

Should you have any questions, please call Battalion Chief Lloyd Rogers of our Fire Prevention Bureau at 831-7778.

Sincerely,

JOHN CLARK
Acting Fire Chief

JC/SD:hh

cc: Office of Environmental Quality Control
Leslie Kurisaki, Kimura International, Inc.



July 30, 2003

Acting Chief John Clark
Fire Department
City and County of Honolulu
3375 Koapaka Street, Suite H425
Honolulu, Hawaii 96819-1869

Dear Chief Clark:

**Subject: Roosevelt High School Building A, Auditorium Renovation
Draft Environmental Assessment
Your Letter to DAGS dated July 2, 2003**

Thank you for your review of the Roosevelt High School Building A, Auditorium Renovation Draft EA. We have received a copy of your letter to DAGS dated July 2, 2003. We note your comment that the proposed project will not adversely impact the services provided by the Honolulu Fire Department.

If you have questions or further comments, please contact me or Mr. Dail Rhee, Public Works Division, State of Hawaii Department of Accounting and General Services at 586-0467.

Sincerely,

KIMURA INTERNATIONAL, Inc.

Glenn T. Kimura
President

Cc: Gabe Won, CDS International
Dail Rhee, DAGS

1600 Kapiolani Blvd., Suite 1610
Honolulu, Hawaii 96814
Tel (808) 941-8818 • Fax (808) 941-8999

DEPARTMENT OF PARKS AND RECREATION
CITY AND COUNTY OF HONOLULU
450 SOUTH KING STREET, 7TH FLOOR • HONOLULU, HAWAII 96813
TELEPHONE: (808) 523-4182 • FAX: (808) 527-5725 • INTERNET: www.honolulu.gov



JERRY HARRIS
DIRECTOR

WILLIAM D. BALFOUR, JR.
DIRECTOR
WILLIAM D. BALFOUR, JR.
DEPUTY DIRECTOR

June 16, 2003

Mr. Gregory Tanaka
State of Hawaii Department of Accounting
and General Services
Division of Public Works
Project Management Branch
P.O. Box 119
Honolulu, Hawaii 96810-0119

Dear Mr. Tanaka:

**Subject: Draft Environmental Assessment
Roosevelt High School Auditorium Renovation**

Thank you for the opportunity to review and comment on the Draft Environmental Assessment relating to the Auditorium Renovation at Roosevelt High School.

The Department of Parks and Recreation has no comment on the Draft Environmental Assessment.

We continue to encourage you to include our previous recommendations regarding modifications to the auditorium that will qualify it as a public shelter in case of emergency.

Should you have any questions, please contact Mr. John Reid Planner, at 692-5454.

Sincerely,

WILLIAM D. BALFOUR, JR.
Director

WDB:mk (J. Reid)
(2/19)

cc: Office of Environmental Quality Control
✓ Mr. Leslie Kurisake, Kimura International, Inc.



POLICE DEPARTMENT
CITY AND COUNTY OF HONOLULU
 801 SO 4TH BERTANIA STREET
 HONOLULU, HAWAII 96813 - AREA CODE (808) 428-3111
 http://www.honolulu.gov
 www.kco.honolulu.hi.us



LEE D. DONOHUE
 CHIEF
 OLIVER K. KAJIYAMA
 P. ULU. PUTZLU
 DEPUTY CHIEFS

TERESA HARRIS
 MAYOR

July 30, 2003

Mr. William D. Balfour, Jr.
 Director
 Department of Parks and Recreation
 City and County of Honolulu
 650 South King Street, 10th Floor
 Honolulu, Hawaii 96813

Dear Mr. Balfour:

**Subject: Roosevelt High School Building A, Auditorium Renovation
 Draft Environmental Assessment
 Your Letter to DAGS dated June 16, 2003**

Thank you for your review of the Roosevelt High School Building A, Auditorium Renovation Draft EA. We have received a copy of your letter to DAGS dated June 16, 2003 and note that you have no comment.

The original structure was not designed to withstand the major storm/wind loads, and therefore the building cannot be designated as an Emergency Shelter. Additional building modifications to qualify it as a public shelter are limited at this time, due to budgetary constraints.

If you have questions or other comments, please contact me or Mr. Dail Rhee, Public Works Division, State of Hawaii Department of Accounting and General Services at 586-0467.

Sincerely,

KIMURA INTERNATIONAL, Inc.

Glen T. Kimura
 Glen T. Kimura
 President

Cc: Gabe Won, CDS International
 Dail Rhee, DAGS

1600 Kapiolani Blvd., Suite 1610
 Honolulu, Hawaii 96814
 Tel (808) 944-8518 • Fax (808) 941-8999

CUR REFERENCE CS-KP

June 26, 2003

Mr. Gregory Tanaka
 Project Management Branch
 Division of Public Works
 Department of Accounting and General Services
 P.O. Box 119
 Honolulu, Hawaii 96810-0119

Dear Mr. Tanaka:

Thank you for the opportunity to review and comment on the Draft Environmental Assessment for the Roosevelt High School, Building A, Auditorium Renovation.

We have no further comment to offer at this time. If there are any questions, please call Major Michael Tucker of District 1 at 529-3386 or Ms. Carol Sodelani of the Support Services Bureau at 529-3658.

Sincerely,

LEE D. DONOHUE
 Chief of Police

By *Karl Godsey*
 KARL GODSEY
 Assistant Chief of Police
 Support Services Bureau

cc: OEQC

✓ Ms. Leslie Kurisaki
 Kimura International, Inc.

Setting and Printing with Aloha



July 29, 2003

Chief Lee Donohue
Police Department
City and County of Honolulu
801 South Bercliana Street
Honolulu, Hawaii 96813

Dear Chief Donohue:

**Subject: Roosevelt High School Building A, Auditorium Renovation
Draft Environmental Assessment
Your Letter to DAGS dated June 26, 2003**

Thank you for your review of the Roosevelt High School Building A, Auditorium Renovation Draft EA. We have received a copy of your letter to DAGS dated June 26, 2003 and note that you have no comments at this time.

If you have questions or comments, please contact me or Mr. Dail Rhee, Public Works Division, State of Hawaii Department of Accounting and General Services at 586-0467.

Sincerely,

KIMURA INTERNATIONAL, Inc.

Glenn T. Kimura
President

Cc: Gabe Won, CDS International
Dail Rhee, DAGS

1600 Kapolei Blvd., Suite 1610
Honolulu, Hawaii 96814
Tel (808) 944-8888 • Fax (808) 941-8999

DEPARTMENT OF FACILITY MAINTENANCE
CITY AND COUNTY OF HONOLULU
1000 ULUKOHA STREET, SUITE 215, KAPOLEI, HAWAII 96707
TELEPHONE: (808) 942-5054 FAX: (808) 942-3437



June 13, 2003

Mr. Glenn T. Kimura
Kimura International, Inc.
1600 Kapolei Boulevard, Suite 1610
Honolulu, Hawaii 96814

Dear Mr. Kimura:

**Subject: Draft Environmental Assessment
Roosevelt High School, Building A, Auditorium Renovation**

Thank you for the opportunity to review the Draft Environmental Assessment. The Department of Facility Maintenance does not have any comments.

Should you have any questions, please contact me at 523-4472.

Sincerely,

LARRY J. LEOPARDI, P. E.
Director and Chief Engineer

cc: OEQC

RECEIVED
JUL 17 2003
FACILITY MAINTENANCE

LARRY J. LEOPARDI, P.E.
DIRECTOR AND CHIEF ENGINEER
AL. ENR. C. 010
ENR. 11 DIRECTOR
NAME IN REFER TO:
DRM#03 - 451

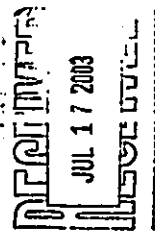

July 15, 2003



Ms. Leslie Kurisaki
Kimura International, Inc.
1600 Kapiolani Blvd. - Ste. 1610
Honolulu, HI 96814

Dear Ms. Kurisaki:

Re: Roosevelt High School
Building A, Auditorium Renovation
TMK: 2-4-32:001
Oahu, Hawaii

Thank you for the opportunity to comment on the May 2003 draft EA of the subject project, as proposed by the Public Works Division, Department of Accounting & General Services, State of Hawaii. We have reviewed the document and have no comments at this time.

We would appreciate the opportunity to review the preliminary construction plans, as they become available, to determine whether the project will impact our facilities; and any work requiring the temporary or permanent relocation of HECO powerlines and/or facilities should be coordinated among the State, its consultant and HECO.

Sincerely,

Kirk S. Tomita
Senior Environmental Scientist

cc: Ms. Genevieve Salmonson (OEQC)



WINNER OF THE EDISON AWARD
FOR DISTINGUISHED INDUSTRIAL LEADERSHIP



July 30, 2003

Mr. Larry J. Leopardi, P.E.
Director and Chief Engineer
Department of Facility Maintenance
City and County of Honolulu
1000 Uluohia Street, Suite 215
Kapolei, Hawaii 96707

Dear Mr. Leopardi:

Subject: Roosevelt High School Building A, Auditorium Renovation
Draft Environmental Assessment
Your Letter dated June 13, 2003

Thank you for your review of the Roosevelt High School Building A, Auditorium Renovation Draft EA. We have received a copy of your letter dated June 13, 2003 and note that you have no comments.

If you have questions or other comments, please contact me or Mr. Dail Rhee, Public Works Division, State of Hawaii Department of Accounting and General Services at 586-0467.

Sincerely,

KIMURA INTERNATIONAL, Inc.

Glenn T. Kimura
President

Cc: Gabe Won, CDS International
Dail Rhee, DAGS

1600 Kapiolani Blvd., Suite 1610
Honolulu, Hawaii 96814
Tel (808) 941-8610 • Fax (808) 941-8999



KIMURA INTERNATIONAL

July 30, 2003

Mr. Kirk S. Tomita
Senior Environmental Scientist
Hawaiian Electric Company, Inc.
P.O. Box 2750
Honolulu, Hawaii 96840-0001

Dear Mr. Tomita:

**Subject: Roosevelt High School Building A, Auditorium Renovation
Draft Environmental Assessment
Your Letter dated July 15, 2003**

Thank you for your review of the Roosevelt High School Building A, Auditorium Renovation Draft EA. We have received your letter dated July 15, 2003 and note that you have no comments at this time.

As requested, you will be given the opportunity to review preliminary construction plans as they become available.

If you have questions or other comments, please contact me or Mr. Dail Rhee, Public Works Division, State of Hawaii Department of Accounting and General Services at 586-0467.

Sincerely,

KIMURA INTERNATIONAL, Inc.

Glenn T. Kimura
President

Cc: Gabe Won, CDS International
Dail Rhee, DAGS

1600 Kapiolani Blvd., Suite 1610
Honolulu, Hawaii 96814
Tel (808) 944-5818 • Fax (808) 941-8999

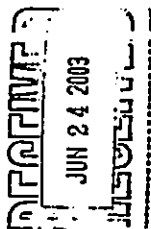

June 20, 2003

Mr. Glenn Kimura
KIMURA INTERNATIONAL, INC.
1600 Kapiolani Boulevard, Suite 1610
Honolulu, Hawaii 96814

**Subject: ROOSEVELT HIGH SCHOOL, BUILDING A, AUDITORIUM RENOVATION
DRAFT ENVIRONMENTAL ASSESSMENT**

Dear Mr. Kimura:

Thank you for providing Verizon Hawaii Incorporated, the opportunity to comment on the Draft Environmental Assessment for the State of Hawaii Department of Accounting and General Services (DAGS) for the renovation of the Roosevelt High School Auditorium Honolulu, Hawaii.

There will be a cost associated with the relocation of telephone facilities that enter the school grounds. The determination of cost would be dependent on type and amount of work required.

If there are any questions, please call Glenn Morita at 840-5809.

Sincerely Yours,

Lynette Yoshida
Section Manager -
Network Engineering & Planning

c: File (1025 ALAK)
G. Morita



Verizon Hawaii Inc.
P.O. Box 2200
Honolulu, HI 9 341



KIMURA INTERNATIONAL



MAK KIMURA LOWER PUNCHBOULDER NEIGHBORHOOD BOARD NO. 0
1600 KAPAHULU BLVD., SUITE 1610 HONOLULU, HAWAII 96814
PHONE: (808) 941-8841 FAX: (808) 941-8999

July 7, 2003

State of Hawaii
Department of Accounting and General Services
Division of Public Works
Project Management Branch
P.O. Box 119
Honolulu, HI 96810-0119

Attention: Gregory Tanaka

Dear Sir:

Subject: Draft Environmental Assessment (DEA) for Roosevelt High School, Building A, Auditorium Renovation

The Board strongly supports the auditorium renovation and other improvements to Roosevelt High School Building A as proposed in this Draft Environmental Assessment (DEA).

We are concerned about the noise effect on the students learning environment in Building A during the construction period. The DEA had no mitigating measures for this effect except that the distance of the classrooms from the construction would provide protection from the noise. We will pursue this matter and any other community concerns at the Roosevelt Principal and consultants presentations to our Board as outlined in the second paragraph on page 3-6 of the DEA during the construction design phase.

Thank you for the opportunity to comment on this DEA.

Sincerely,

John Steelquist
John Steelquist
Chair

cc: Director, Office of Environmental Quality Control
Leslie Kurisaki, Kimura International, Inc.



Oahu's Neighborhood Board System - Established 1973

July 28, 2003

Ms. Lynette Yoshida
Section Manager
Network Engineering and Planning
Verizon Hawaii Inc.
P.O. Box 2200
Honolulu, Hawaii 96841

Dear Ms. Yoshida:

Subject: Roosevelt High School Building A, Auditorium Renovation
Draft Environmental Assessment
Your Letter dated June 20, 2003

Thank you for your review of the Roosevelt High School Building A, Auditorium Renovation Draft EA. We have received your letter dated June 20, 2003. We acknowledge your comment that the cost associated with the relocation of telephone facilities will depend on the type and amount of work required.

If you have questions or other comments, please contact me or Mr. Dail Rhee, Public Works Division, State of Hawaii Department of Accounting and General Services at 586-0467.

Sincerely,

KIMURA INTERNATIONAL, Inc.

Glenn T. Kimura
Glenn T. Kimura
President

Cc: Gabe Won, CDS International
Dail Rhee, DAGS

1600 Kapahulu Blvd., Suite 1610
Honolulu, Hawaii 96814
Tel: (808) 941-8841 • Fax: (808) 941-8999

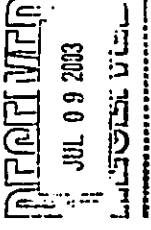



KIMURA INTERNATIONAL

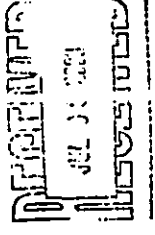

THE O JDDOOR CIRCLE
1314 South King A, Suite 306 • Honolulu, HI 96814
Phone: 808-93-0300 Fax: 808-593-0521

July 30, 2003

Mr. John Steelquist
Chair
Makiki/Lower Punchbowl/Tantalus Neighborhood Board No. 10
c/o Neighborhood Commission
530 S. King Street, Rm. 400
Honolulu, Hawaii 96813

Dear Mr. Steelquist:

Subject: Roosevelt High School Building A, Auditorium Renovation
Draft Environmental Assessment
Your Letter to DAGS dated July 7, 2003

Thank you for your review of the Roosevelt High School Building A, Auditorium Renovation Draft EA. We have received a copy of your letter to DAGS dated July 7, 2003.

As mentioned in your letter, the potential effect of construction period noise on student learning environment will be discussed at future Neighborhood Board presentations during the design phase.

If you have questions or comments, please contact me or Mr. Dail Rhee, Public Works Division, State of Hawaii Department of Accounting and General Services at 586-0467.

Sincerely,

KIMURA INTERNATIONAL, Inc.

Glenn T. Kimura
President

Cc: Gabe Won, CDS International
Dail Rhee, DAGS

1600 Kapiolani Blvd., Suite 1610
Honolulu, Hawaii 96814
Tel (808) 944-8548 • Fax (808) 941-8999

Ju y 7, 2003

Established 1912
A Non-profit Organization

BI ARCHIES

O HUU

Kaunaloa

Laai-Kaiaha

North Shore

Waialae-Kahala

HI WAI'I

Hilo

Kaunaloa

Kona

Waikoloa Village

Waimea

K UAI

LAU KAIHA

G. ROSEN CIRCLE

Laai-Kaiaha

M. Gregory Tanaka
Department of Accounting and General Services
Division of Public Works
Project Management Branch
P.O. Box 119
Honolulu, HI 96810-0119

RE: Draft Environmental Assessment
Roosevelt High School Building A, Auditorium Renovation

Dear Mr. Tanaka:

On behalf of The Outdoor Circle I would like to thank you for allowing us to comment on the above referenced Draft Environmental Assessment (DEA). My comments and questions are listed below:

- > We are pleased that the document notes there is an Exceptional Ficus benjamina Tree located within the project site. However, we are disappointed that the DEA mentions only the guidelines for mitigation required by the Mayor's Arborist Advisory Committee and no more. The Outdoor Circle believes that every conceivable measure be taken to protect this tree during construction. The DEA should contain stronger language on mitigation measures for both this Exceptional Tree and all of the other trees in the project area. There are several landscape architects and/or qualified arborist who can provide this information.
- > Additionally, before making an assessment of the impact to the trees (and the environment), construction details for building the access road and parking facility must be provided. Construction activity can easily damage tree roots, leading to the tree's eventual decline and then death. The DEA must show mitigation to minimize this impact. Further information on items such as grading, the depth of excavation, location of power lines and street lights all must be addressed.
- > In addition to the palm (what kind of palm is it?) mentioned in the DEA, please provide a plan which shows the other mature trees that will be removed as part of the project construction. Once again, it is not possible to assess project impacts without all of the information being provided. We would suggest an assessment of all of the existing trees in the project area be completed by a qualified certified arborist.

Mr. Gregory Tanaka
July 7, 2003
Page 2

- > Provide landscaping details that show the project after completion. There is concern that all of the funding will be spent on the renovation and none will be left for landscaping.
- > The DEA says The Outdoor Circle will be consulted as to how to deal with the existing trees in the project area. So far, no one has contacted us nor we were given an opportunity to comment in the pre-consultation phase. It is in the best interest of DAGS, DOE, and the contractor to be proactive and consult with The Outdoor Circle early in the process.
- > Has the project schedule slipped? According to the document, project design is scheduled to begin mid-2003. That would be now. Please update the time table in the document.
- > Because plans require exceeding the height limit in the Special Design District, the DEA should contain more documentation on the effects of a 30-foot high roof on the view plane. Please provide computer simulations that accurately reflect this condition. Without the simulations, it is impossible to judge the impacts when viewing Punchbowl from the public viewing areas. These simulations will either prove or disprove your statement that, "...overall, there will be no adverse visual impact to historic structures in the area, or to the Punchbowl landmark. (pg. 3-12)
- > Has Historic Hawai'i Foundation, the leading organization in the State that deals with historic preservation, been included in the discussion of the Auditorium's renovation compatibility with the historic character of the building? This public interest group should have been consulted in the pre-consultation stage and their input would be quite useful in preserving the historic integrity of the auditorium.

Thank you for the opportunity to comment. We look forward to hearing your reply.

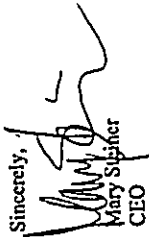
Sincerely,

Mary Steiner
CEO

CC: Director, Office of Environmental Quality Control
Ms. Leslie Kurisaki, Kimura International, Inc.



July 30, 2003

Ms. Mary Steiner
CEO
The Outdoor Circle
1314 South King Street, Suite 306
Honolulu, Hawaii 96814

Dear Ms. Steiner:

**Subject: Roosevelt High School Building A, Auditorium Renovation
Draft Environmental Assessment
Your Letter to DAGS dated July 7, 2003**

Thank you for your review of the Roosevelt High School Building A, Auditorium Renovation Draft EA. We have received a copy of your letter to DAGS dated July 7, 2003.

As an update, the project designers have modified the project to provide Americans With Disabilities Act (ADA) access and parking at the rear of Building A, rather than by constructing an access driveway and parking near the *Ficus benjamina* tree. This change will eliminate the potential for adverse impact to this exceptional tree.

We offer the following responses to your comments:

1. As stated above, the design has been modified and the access driveway and handicapped parking fronting Nehoa Street will not be required.
2. Comment no longer applicable.
3. The project design team includes a landscape consultant. Information on what mature trees will be removed as part of construction will be provided to your office for review and comment later in the design process.
4. Landscaping details showing the project after completion will be provided to your office for review and comment.
5. Representatives from the project designers, CDS International, will be contacting your office to discuss how to deal with the existing trees in the project area.
6. Project schedule will be updated in Final EA.

1600 Kapulehaili Blvd., Suite 1610
Honolulu, Hawaii 96814
Tel: (808) 944-8343 • Fax: (808) 941-8999



THE OUTDOOR CIRCLE

1314 South King : Suite 206 • Honolulu, HI 96814
Phone: 808-73-0300 Fax: 808-593-0523

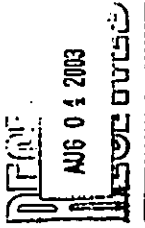

AUG 04 2003

7. As shown in Figure 4 (Elevatic is-Auditorium Addition) in the Draft EA, the 3'-foot high addition at the back of the auditorium will actually be lower in height than the existing auditorium structure. As such, it will not obstruct the existing view plane in the area. In addition, the building addition will incorporate the same exterior finishes (e.g., clay tile roofs, plaster finish for walls, copper louvers) as the auditorium, in order to be visually compatible with the historic structure.
8. Although the Historic Hawaii Foundation has not been involved in discussing the auditorium renovation, the Department of Land and Natural Resources State Historic Preservation Division has been very involved in the design process since June 2002. SHPD staff participated in a site visit and design charrette. In May 2003, SHPD staff reviewed and commented on schematic drawings. Their comments have been incorporated in the current design.

If you have questions or other comments, please contact me or Mr. Dail Rhee, Public Works Division, State of Hawaii Department of Accounting and General Services at 586-0467.

Sincerely,

KIMURA INTERNATIONAL, Inc.

Glenn T. Kimura
President

Cc: Gabe Wom, CDS International
Dail Rhee, DAGS

August 1, 2003

M. Gregory Tanaka
Department of Accounting and General Services
Division of Public Works
Project Management Branch
P.O. Box 119
Honolulu, HI 96810-0119

RE: Draft Environmental Assessment Roosevelt High School Building
Kimura International Response Dated July 30, 2003

Dear Mr. Tanaka:

We are pleased that the design for the above referenced project has been modified to provide ADA access and parking at the rear of Building A rather than by constructing an access driveway and parking lot near the Ficus benjamina tree. Thank you for revisiting that concern.

However, there are issues in Kimura International's response which were not addressed to our satisfaction. They remain:

- > The Environmental Assessment refers to a palm and other trees which will have to be removed. The Outdoor Circle asked for a plan showing which trees would be eliminated. Kimura's response does not address this. We need to know the number of trees planned for removal prior to assessing the project's impacts.
- > In addition, we suggested an assessment of all of the existing trees in the project area be completed by a qualified certified arborist. The response we received does not address this. It is important that DAGS be as proactive as possible in protecting the important trees on Roosevelt High School's campus. Waiting until the design team contacts us will be too late.
- > Kimura's response does not speak to the need to have a qualified certified arborist as part of the project team. Typically, landscape consultants are not certified arborists and come to a project with a different perspective. We would like the response to focus on having an arborist as a member of the team.

Established 1912
A. non-profit Organization

BRANCHES

HI: HIU

Kaunaloa

Lehi-Kaunaloa

North Shore

Waialeale-Kaunaloa

HI: WAI

Hilo

Kaunaloa

Waialeale Village

Waimea

K: JAI

MI: UI

G: ODEEN CIRCLE

Lehi-Kaunaloa

Mr. Gregory Tanaka
August 1, 2003
Page 2

Finally, the FEA should be revised to indicate, as stated in our July 7, 2003 letter, that The Outdoor Circle has not been consulted as of yet as to how to deal with the existing trees in the area. This was not addressed in the Kimura letter.

Thank you for your time. We look forward to hearing from you again.

Sincerely,

Mary Steiner
CEO

cc: Genevieve Salmonson, Director, OEQC
Leslie Kurisaki, Kimura International, Inc.



THE OUTDOOR CIRCLE

1314 South King St., Suite 306 - Honolulu, HI 96814
Phone: 808-531-0300 Fax: 808-531-0325

Established 1912
Non-profit Organization

1 MARCHES
1 'ARU

Kawika
Kauai
North Shore
North Kona

AWAII

Hilo
Kona
Kauai
Waialeale Village
Waimea

AUAU

MAUI

ARDEN CIRCLE

Lan Kaha

August 8, 2003

Mr. Gabriel K.K. Won
CDS International
Paunahi Tower, Ste. 400
1001 Bishop Street
Honolulu, HI 96813

Dear Mr. Won:

Thank you so much for delivering to me a full-size landscape plan with photos for the Roosevelt High School Auditorium Renovation. I found working from the PDF file hard to manage and the plan made it much easier for me.

Upon review of the landscape plan I have the following comments and questions:

- > What does it mean on the plan when it says, "Existing plumerias to be removed and disposed off site?" Does this mean the plumerias, opiuma tree and pink tecoma will be destroyed or relocated? If they are to be relocated where will they go? Roosevelt's campus is quite large--why can't homes be found for these trees on the school grounds? If these trees are going to be relocated, a qualified arborist should assess them to determine if they will survive the relocation.
- > If the new landscaping is being phased in as financing allows, will the removals be done in the same way? In other words, will the plumerias being removed on the phase three plan be done when phase three construction is undertaken or at the beginning of phase one? We urge phase two and three removals occur when construction on those phases begins.
- > The plan shows how close the trees to remain are to the construction. Once again, I reiterate the need for a tree protection plan to be included in the Final Environmental Assessment.

Mr. Gabriel K.K. Won
August 8, 2003
Page 2

I look forward to receiving a response to my letter dated August 1, 2003 as well as to these comments. If you have any questions, please do not hesitate to contact me.

Sincerely,

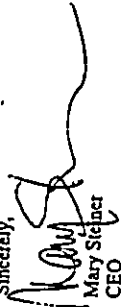

Mary Steiner
CEO

cc: Mr. Gregory Tanaka
Genevive Salmonson, Director, OEQC
Leslie Kurisaki, Kimura International, Inc.



August 20, 2003

Ms. Mary Steiner
CEO
The Outdoor Circle
1314 South King Street, Suite 306
Honolulu, Hawaii 96814

Dear Ms. Steiner:

**Subject: Roosevelt High School Building A, Auditorium Renovation
Draft Environmental Assessment
Your Letter to DAGS dated August 1, 2003
Your Letter to CDS International dated August 8, 2003**

This is in response to your follow-up letter to DAGS dated August 1, 2003, and your letter to CDS International dated August 8, 2003, providing comments on the landscape plan.

August 1, 2003 Letter

Your August 1 letter requested a plan showing which trees would be eliminated by the project. You were subsequently contacted by Mr. Gabe Won of CDS International, who provided you with a Landscape Plan on August 7, 2003. The plan identified the specific trees and vegetation that would be removed. They include an areca palm near the courtyard, and two plumeria, an opiuma and a pink tecoma tree at the back of the auditorium. Photographs of these trees were also provided.

As suggested, we are in the process of retaining an arborist of this project, who will conduct an assessment of the affected trees within the project boundaries.

August 8, 2003 Letter

Your August 8 letter included questions and comments to the landscape plan provided to you on August 7. We offer the following responses to your questions:

- The two plumeria trees will be relocated south of the three remaining plumeria trees. The project landscape architect does not plan to relocate the opiuma and pink tecoma trees. Due to their proximity to the auditorium building, half of the tree's root balls would have to be cut in order to move them. An arborist will confirm these recommendations.

1600 Kapiolani Blvd., Suite 1610
Honolulu, Hawaii 96814
Tel: (808) 944-8848 • Fax: (808) 941-8999

- The removal of the subject trees will be scheduled prior to the start of work in Phase II.
- An arborist will be providing a tree protection plan. Due to time constraints, a copy of the arborist's assessment (including a tree protection plan) will be forwarded to you when completed.

We thank you for your keen interest in the trees in the project area, and trust that our responses to your requests have shown good faith, and our ongoing commitment to working with your organization.

If you have questions or other comments, please contact me or Mr. Dail Rhee, Public Works Division, State of Hawaii Department of Accounting and General Services at 586-0467.

Sincerely,

KIMURA INTERNATIONAL, Inc.

Glenn T. Kimura
President

Cc: Gabe Won, CDS International
Dail Rhee, DAGS



HAWAII STATE LEGISLATURE
STATE CAPITOL
HONOLULU, HAWAII 96813
June 16, 2003

PROFIT
JUN 21 2003
LOVE

Mr. Glenn T. Kimura, President
Kimura International, Inc.
1600 Kapiolani Boulevard, Suite 1610
Honolulu, Hawaii 96813

Dear Mr. Kimura:

SUBJECT: Roosevelt High School Auditorium Renovation Environmental Assessment

We are writing to request your consideration in extending the deadline to submit comments to the Draft Environmental Assessment, beyond July 8, 2003 by 10 days and accepting public input through July 22, 2003.

On Wednesday, July 9, 2003, we are scheduling a community briefing on the proposed Roosevelt High School's Auditorium renovation and expansion project to provide interested residents, businesses and other community leaders with an opportunity to learn more about the plans. We would like to submit comments and concerns raised at this community briefing.

Thank you for your favorable consideration on this matter.

Sincerely,

Sen. Suzanne Chun
District 13 (Aiea/Nuuanu Liliha)

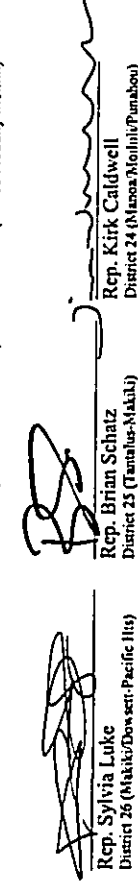
Sen. Brian Taniguchi
District 10 (Maunaloa-McCuilly-Moiliili)

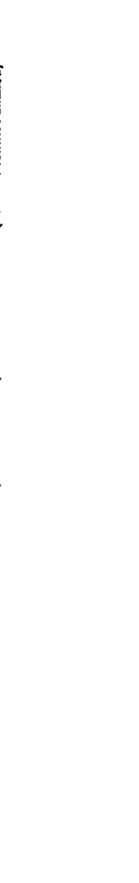
Rep. Kirk Caldwell
District 24 (Maunaloa/Moiliili/Punahoa)

Rep. Brian Schatz
District 25 (Tantalus-Makiki)

Rep. Sylvia Luke
District 26 (Makiki/Downtown-Pacific Hts)

Sen. Carol Fukunaga
District 11 (Makiki/Punahoa/Aiea-Noana)

Rep. Brian Schatz
District 25 (Tantalus-Makiki)



June 23, 2003

Senator Carol Fukunaga
Chair, Senate Economic Development Committee
Hawaii State Legislature
Room 216, State Capitol
Honolulu, Hawaii 96813

Dear Senator Fukunaga:

**Subject: Roosevelt High School Auditorium Renovation Environmental Assessment
Your Letter dated June 16, 2003**

Thank you for your letter requesting an extension of the comment deadline for the Roosevelt High School Auditorium Renovation Draft Environmental Assessment (DEA). As requested, the Department of Accounting and General Services, project proponent, has agreed to accept DEA review comments until July 22, 2003.

A notice will also be published in the July 8, 2003 edition of OEQC's The Environmental Notice, stating that comments will be accepted through July 22.

Thank you for your interest in this project.

Sincerely,

KIMURA INTERNATIONAL, Inc.

Glenn T. Kimura
President

cc: Gregory Tanaka, DAGS
Gabriel Won, CDS International

1600 Kapiolani Blvd., Suite 1610
Honolulu, Hawaii 96814
Tel (808) 944-8868 • Fax (808) 941-8999



June 23, 2003

Senator Suzanne Chun Oakland
District 13
Hawaii State Legislature
Room 226, State Capitol
Honolulu, Hawaii 96813

Dear Senator Chun Oakland:

**Subject: Roosevelt High School Auditorium Renovation Environmental Assessment
Your Letter dated June 16, 2003**

Thank you for your letter requesting an extension of the comment deadline for the Roosevelt High School Auditorium Renovation Draft Environmental Assessment (DEA). As requested, the Department of Accounting and General Services, project proponent, has agreed to accept DEA review comments until July 22, 2003.

A notice will also be published in the July 8, 2003 edition of OEQC's The Environmental Notice, stating that comments will be accepted through July 22.

Thank you for your interest in this project.

Sincerely,

KIMURA INTERNATIONAL, Inc.

Glenn T. Kimura
President

cc: Gregory Tanaka, DAGS
Gabriel Won, CDS International

1600 Kapiolani Blvd., Suite 1610
Honolulu, Hawaii 96814
Tel (808) 944-8868 • Fax (808) 941-8999

Post-it® Fax Note	7671	Date	6/23/03
To	Carol Tanaka, DAGS	From	L. Kurisaki
Company	ABC	Phone	586-0950
Fax	521-8766	Fax	941-8999



June 23, 2003

Senator Brian Taniguchi
District 10
Hawaii State Legislature
Room 210, State Capitol
Honolulu, Hawaii 96813

Dear Senator Taniguchi:

Subject: Roosevelt High School Auditorium Renovation Environmental Assessment
Your Letter dated June 16, 2003

Thank you for your letter requesting an extension of the comment deadline for the Roosevelt High School Auditorium Renovation Draft Environmental Assessment (DEA). As requested, the Department of Accounting and General Services, project proponent, has agreed to accept DEA review comments until July 22, 2003.

A notice will also be published in the July 8, 2003 edition of OEQC's The Environmental Notice, stating that comments will be accepted through July 22.

Thank you for your interest in this project.

Sincerely,

KIMURA INTERNATIONAL, Inc.

Glenn T. Kimura
President

cc: Gregory Tanaka, DAGS
Gabriel Won, CDS International

1600 Kapolei Blvd., Suite 1610
Honolulu, Hawaii 96814
Tel: (808) 941-8608 • Fax: (808) 941-8999



June 23, 2003

Representative Sylvia Luke
District 26
Hawaii State Legislature
Room 422, State Capitol
Honolulu, Hawaii 96813

Dear Representative Luke:

Subject: Roosevelt High School Auditorium Renovation Environmental Assessment
Your Letter dated June 16, 2003

Thank you for your letter requesting an extension of the comment deadline for the Roosevelt High School Auditorium Renovation Draft Environmental Assessment (DEA). As requested, the Department of Accounting and General Services, project proponent, has agreed to accept DEA review comments until July 22, 2003.

A notice will also be published in the July 8, 2003 edition of OEQC's The Environmental Notice, stating that comments will be accepted through July 22.

Thank you for your interest in this project.

Sincerely,

KIMURA INTERNATIONAL, Inc.

Glenn T. Kimura
President

cc: Gregory Tanaka, DAGS
Gabriel Won, CDS International

1600 Kapolei Blvd., Suite 1610
Honolulu, Hawaii 96814
Tel: (808) 941-8608 • Fax: (808) 941-8999



June 23, 2003

Representative Brian Schatz
District 25
Room 425, State Capitol
Honolulu, Hawaii 96813
Dear Representative Schatz:

Subject: Roosevelt High School Auditorium Renovation Environmental Assessment
Your Letter dated June 16, 2003

Thank you for your letter requesting an extension of the comment deadline for the Roosevelt High School Auditorium Renovation Draft Environmental Assessment (DEA). As requested, the Department of Accounting and General Services, project proponent, has agreed to accept DEA review comments until July 22, 2003.

A notice will also be published in the July 8, 2003 edition of OEQC's The Environmental Notice, stating that comments will be accepted through July 22.

Thank you for your interest in this project.

Sincerely,

KIMURA INTERNATIONAL, Inc.

Glenn T. Kimura
President

cc: Gregory Tanaka, DAGS
Gabriel Won, CDS International

1600 Kapiolani Blvd., Suite 1610
Honolulu, Hawaii 96814
Tel (808) 944-8849 • Fax (808) 941-8799



June 23, 2003

Representative Kirk Caldwell
District 24
Hawaii State Legislature
Room 406, State Capitol
Honolulu, Hawaii 96813

Dear Representative Caldwell:

Subject: Roosevelt High School Auditorium Renovation Environmental Assessment
Your Letter dated June 16, 2003

Thank you for your letter requesting an extension of the comment deadline for the Roosevelt High School Auditorium Renovation Draft Environmental Assessment (DEA). As requested, the Department of Accounting and General Services, project proponent, has agreed to accept DEA review comments until July 22, 2003.

A notice will also be published in the July 8, 2003 edition of OEQC's The Environmental Notice, stating that comments will be accepted through July 22.

Thank you for your interest in this project.

Sincerely,

KIMURA INTERNATIONAL, Inc.

Glenn T. Kimura
President

cc: Gregory Tanaka, DAGS
Gabriel Won, CDS International

1600 Kapiolani Blvd., Suite 1610
Honolulu, Hawaii 96814
Tel (808) 944-8849 • Fax (808) 941-8799