

**NON-EA OR EIS
PUBLICATION FORM
OFFICE OF ENVIRONMENTAL QUALITY CONTROL**

Project Name: 'Īao Surface Water Treatment Plant Upgrades

Applicable Law: 36 CFR Part 800 Section 106 of the National Historic Preservation Act of 1966, as amended (Section 106).

Type of Document: Section 106 Consultation

Island: Maui

District: Wailuku

TMK: (2) 3-5-001:121, (2) 3-5-001:091 Por., (2) 3-5-001:100 Por., (2) 3-5-001:111 Por.,
(2) 3-5-001:112 Por.

Permits Required: N/A

Applicant or Proposing Agency:

State of Hawai'i, Department of Health, Environmental Management Division, Safe Drinking Water Branch

Uluakupu Building 4, 2385 Waimano Home Road, Suite 110, Pearl City, HI 96782-1400

Contact Ms. Joan Corrigan (808) 586-4258

Approving Agency or Accepting Authority:

State of Hawai'i, Department of Health, Environmental Management Division, Safe Drinking Water Branch

Uluakupu Building 4, 2385 Waimano Home Road, Suite 110, Pearl City, HI 96782-1400

Contact Ms. Joan Corrigan (808) 586-4258

Consultant: N/A

Status: Comments due no later than July 9, 2018 to:

State of Hawai'i, Department of Health

Environmental Management Division

Safe Drinking Water Branch

Uluakupu Building 4, 2385 Waimano Home Road, Suite 110

Pearl City, HI 96782-1400

ATTN: Ms. Joan Corrigan

Project Summary: (Provide proposed action and purpose/need in less than 200 words. Please keep the summary brief and on this one page):

The Department of Health (DOH) will be initiating Section 106 of the NHPA consultation with the State Historic Preservation Division (SHPD) in accordance with 36 CFR Part 800. In 2015, the U.S. Environmental Protection Agency (EPA) designated the DOH to act on EPA's behalf, pursuant to 36 CFR §800.2 (c) (4), when initiating Section 106 of the NHPA process for projects funded under the Hawai'i Drinking Water State Revolving Fund (DWSRF).

The DOH is providing funding under the DWSRF to the County of Maui, Department of Water Supply for 'Īao Surface Water Treatment Plant (WTP) Upgrades. The proposed project will utilize federal funding and is considered an undertaking, as defined by Section 106 of the NHPA, 54 U.S.C. §306101 et seq., and 36 CFR Part 800. The project proposes to construct a new WTP in an adjacent parcel to the existing WTP and 3.0 MG tank. The existing WTP was meant to be temporary, so a new, permanent WTP is necessary. The WTP will treat up to 1.7 MGD of treated water which will be withdrawn from the 'Īao-Waikapu Ditch. Any comments for the project will be included as part of the NHPA Section 106 consultation with SHPD.

Copyright © 2010 qPublic.net

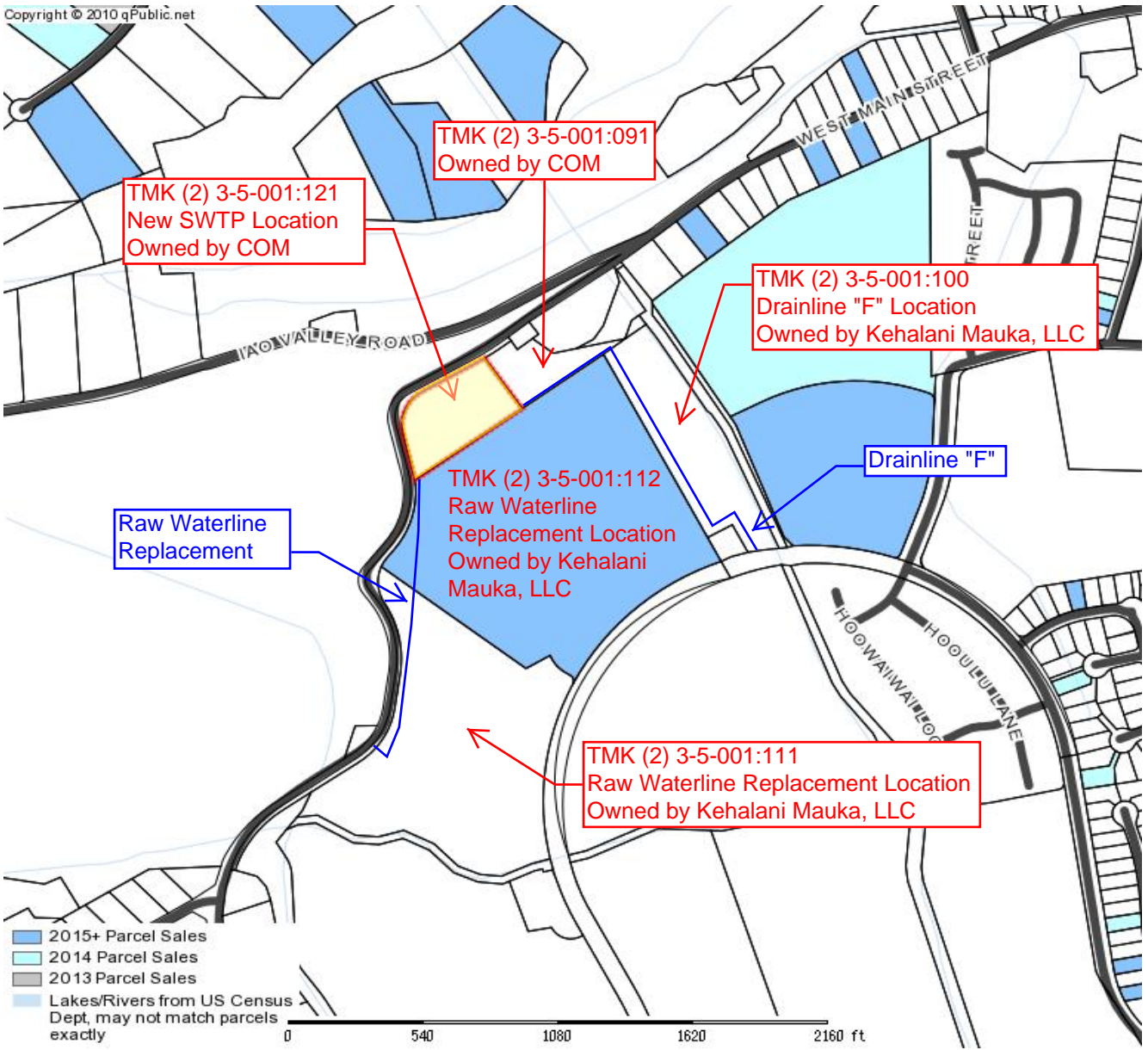

Maui County Assessor

Parcel: 350011210000 Acres: 2.54

**FIGURE 1
PROJECT AREA MAP**

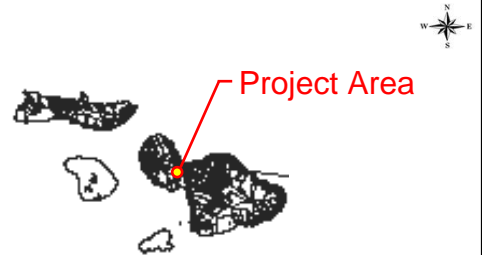

The Maui County Assessor's Office makes every effort to produce the most accurate information possible. No warranties, expressed or implied, are provided for the data herein, its use or interpretation. The assessment information is from the last certified taxroll. All data is subject to change before the next certified taxroll. PLEASE NOTE THAT THE PROPERTY APPRAISER MAPS ARE FOR ASSESSMENT PURPOSES ONLY NEITHER MAUI COUNTY NOR ITS EMPLOYEES ASSUME RESPONSIBILITY FOR ERRORS OR OMISSIONS ---THIS IS NOT A SURVEY---

Date printed: 02/12/18 : 13:26:56

DAVID Y. IGE
GOVERNOR OF HAWAII

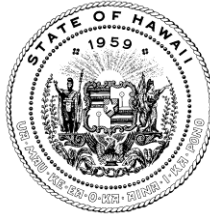

SUZANNE D. CASE
CHAIRPERSON
BOARD OF LAND AND NATURAL RESOURCES
COMMISSION ON WATER RESOURCE MANAGEMENT

KEKOA KALUHIWA
FIRST DEPUTY

W. ROY HARDY
ACTING DEPUTY DIRECTOR - WATER

AQUATIC RESOURCES
BOATING AND OCEAN RECREATION
BUREAU OF CONVEYANCES
COMMISSION ON WATER RESOURCE MANAGEMENT
CONSERVATION AND COASTAL LANDS
CONSERVATION AND RESOURCES ENFORCEMENT
ENGINEERING
FORESTRY AND WILDLIFE
HISTORIC PRESERVATION
KAHOOLAWE ISLAND RESERVE COMMISSION
LAND
STATE PARKS

STATE OF HAWAII
DEPARTMENT OF LAND AND NATURAL RESOURCES

STATE HISTORIC PRESERVATION DIVISION
KAKUHIHEWA BUILDING
601 KAMOKILA BLVD, STE 555
KAPOLEI, HAWAII 96707

August 10, 2015

David Taylor, P.E., Director
Department of Water Supply
County of Maui
200 South High Street, 5th Floor
Wailuku Hawaii 96793

LOG NO: 2015.02706
DOC NO: 1508JP03
Archaeology

Aloha Mr. Taylor,

**SUBJECT: Chapter 6E-8 Historic Preservation Review – Maui County
Final Archaeological Assessment Survey for the ‘Īao Water Treatment Facility
Wailuku Ahupua‘a, Wailuku District, Island of Maui
TMK (2) 3-5-001:067 por. and 3-5-001:091: por.**

Thank you for the opportunity to review the draft and final submittals both titled *An Archaeological Assessment on a 2.5 Acre Parcel for the Iao Water Treatment Facility Project in Iao, Wailuku Ahupua‘a, Wailuku District Island of Maui, Hawaii [TMK: (2) 3-05-001:067]* by Perzinski and Dega (July and August 2015). We received the revised draft report submittal on July 14, 2015 and the revised final on August 10, 2015. The revised reports address the requested revisions recommended by our division for the draft document (*Log 2013.6035, Doc 1506JP01*).

The subject archaeological assessment survey was conducted at the request of Munekiyo Hiraga. The project area consists of approximately 2.5 acres, located along Alu Road, adjacent to the existing 3.0 MG water tank. Archaeological field procedures consisted of a 100% surface pedestrian survey conducted on August 30, 2013. Upon request, Historic Preservation (HP) staff archaeologist Jenny Pickett and Scientific Consultant Services archaeologist Ian Bassford conducted a site inspection on Monday July 6, 2015 in order to consult and evaluate the necessity for subsurface testing. It was agreed upon that **subsurface testing is not necessary**. The requested revisions have been included in the subject submittals and we concur that no further archaeological work is necessary.

Pursuant to Hawai‘i Administrative Rule §13-276-5, the archaeological assessment survey report is accepted. We accept the Final copy for our Maui Library. However, **for the final** Kapolei submittal, we request that you edit the TMK number to comply with the HP standard format. Please send one hardcopy of the corrected final document, clearly marked **FINAL**, along with a copy of this review letter and a text-searchable PDF version on CD to the Kapolei SHPD office, attention SHPD Library. Please contact Jenny Pickett at (808) 243-5169 or Jenny.L.Pickett@hawaii.gov if you have any questions or concerns about this letter.

Mahalo,

Morgan E. Davis
Lead Archaeologist, Maui Section

cc: County of Maui DSA (Cathy.Hasfurther@co.maui.hi.us); County Planning (planning@mauicounty.gov); Annalise Kehler, (annalise.kehrer@mauicounty.gov); Mike Dega (mike@scshawaii.com); Tessa Munekiyo Ng (tessa@munekiyohiraga.com); and Charlene Shibuya (charlene@munekiyohiraga.com)