

NEIL ABERCROMBIE
GOVERNOR



STATE OF HAWAII
DEPARTMENT OF TRANSPORTATION
869 PUNCHBOWL STREET
HONOLULU, HAWAII 96813-5097

GLENN M. OKIMOTO
DIRECTOR

Deputy Directors
JADE T. BUTAY
FORD N. FUCHIGAMI
RANDY GRUNE
JADINE URASAKI

IN REPLY REFER TO:

Board of Land and
Natural Resources
State of Hawaii
Honolulu, Hawaii

AMENDMENT TO PRIOR BOARD ACTION OF FEBRUARY 8, 2013,
ITEM M-3, ISSUANCE OF A DIRECT LEASE TO K.W. AUTO BODY, LLC
2885 UALENA STREET, HONOLULU INTERNATIONAL AIRPORT
TO DELETE THE SPECIFIC TERMINATION DATE AND
TO REVISE THE PROPERTY DESCRIPTION
TMK: (1) 1-1-04:06

OAHU

On February 8, 2013, under agenda Item M-3, and pursuant to Section 261-7 and 171-59, Hawaii Revised Statutes, relating to Disposition by Negotiation, the Land Board authorized the Department of Transportation (DOT) to issue a lease to K.W. Auto Body, LLC, for the operation and maintenance of an auto body repair and painting business located at Ualena Street, Honolulu International Airport on the Island of Oahu.

The DOT requests certain changes to the end date of the lease to K.W. Auto Body, LLC previously approved by the Land Board. The changes are listed below:

ORIGINAL:

TERM OF LEASE:

Approximately five (5) years, commencing on the date of lease execution and ending on December 31, 2017.

AS AMENDED:

TERM OF LEASE:

The lease will be for five (5) years commencing upon execution of the lease document.

ITEM M-5

ORIGINAL:

AREA:

EXHIBIT A:

Area/Space No. 005-123, consisting of approximately 22,079 square feet.

AS AMENDED:

AREA:

EXHIBIT A:

Area/Space No. 005-123, consisting of approximately 7,089 square feet;
Building/Space No. 142-101, consisting of approximately 1,227 square feet;
Building/Space No. 142-102, consisting of approximately 9,178 square feet; and
Building/Space No. 143-101, consisting of approximately 4,586 square feet.

REMARKS:

All other terms of the lease will remain unchanged.

RECOMMENDATION:

That the Board amends its prior action of February 8, 2013, under agenda Item M-3, by approving the change in the term of the lease, as herein outlined, which are by reference incorporated herein and subject to such other terms and conditions as may be prescribed by the Director of Transportation to best serve the interests of the State.

Respectfully submitted,



GLENN M. OKIMOTO, Ph.D.
Director of Transportation

APPROVED FOR SUBMITTAL:

WILLIAM J. AILA, JR.
Chairperson and Member

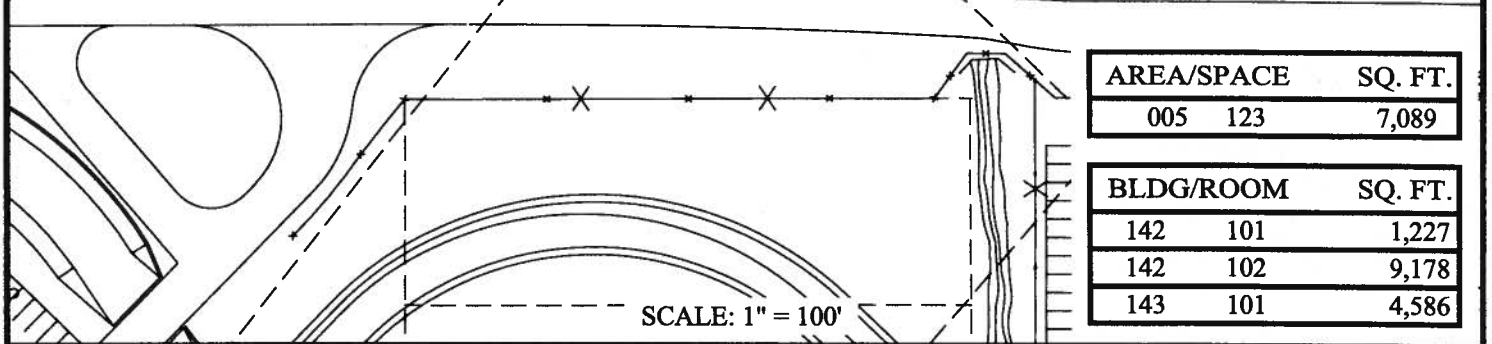
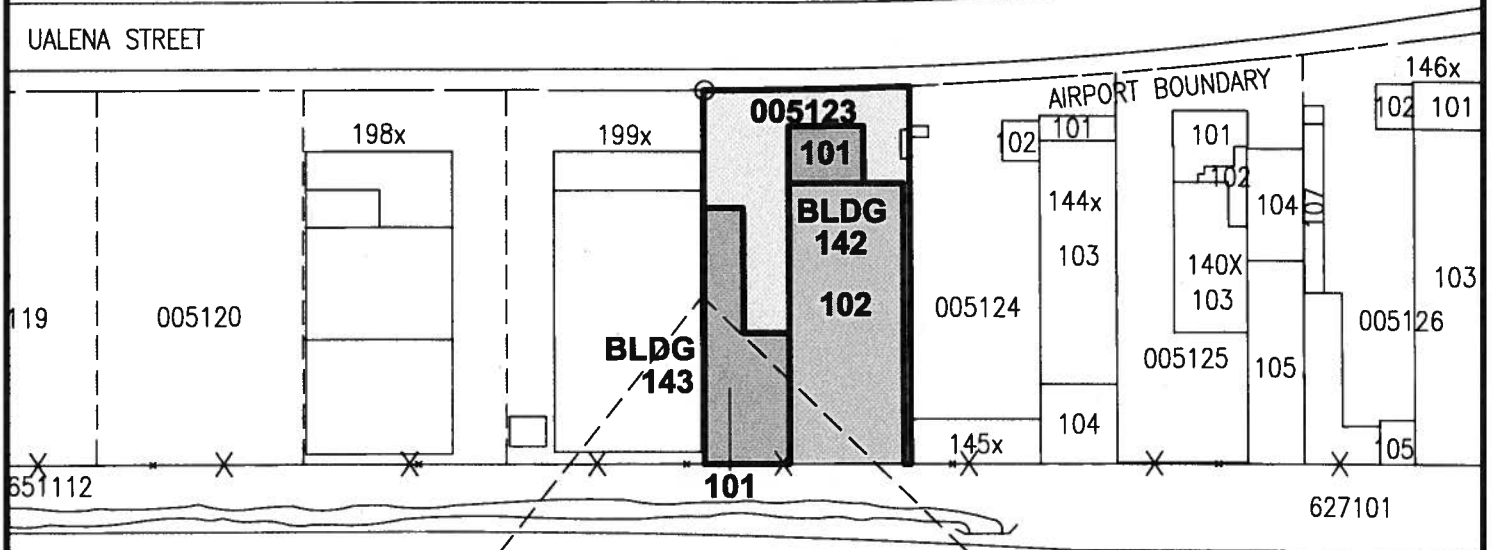
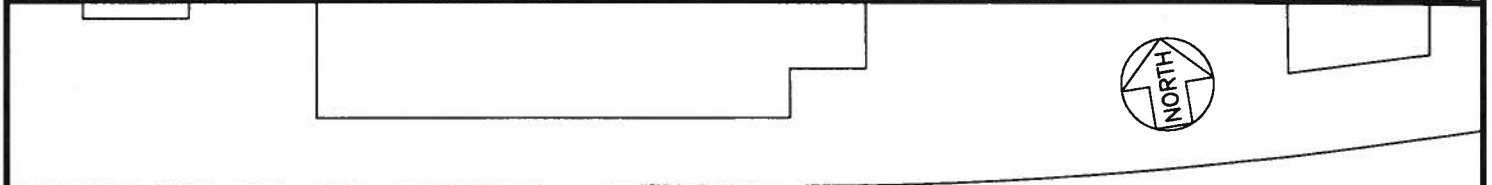
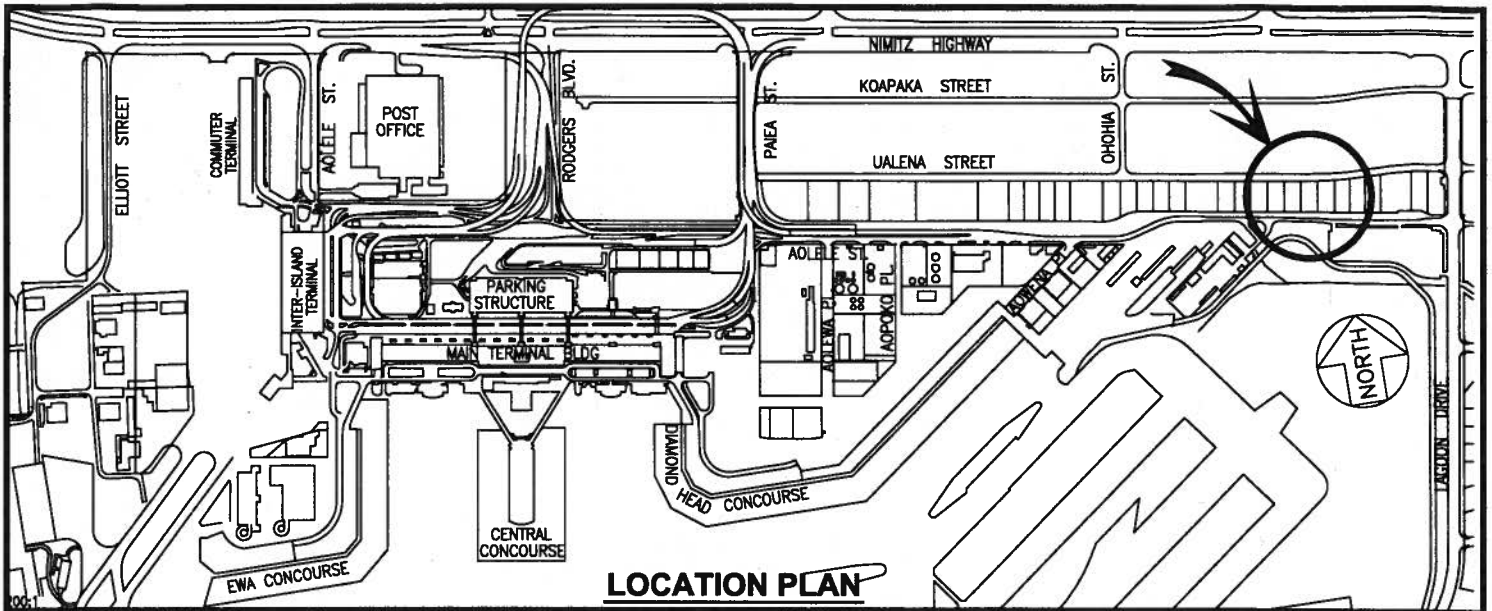

AREA/SPACE	SQ. FT.
005 123	7,089

BLDG/ROOM	SQ. FT.
142 101	1,227
142 102	9,178
143 101	4,586

SCALE: 1" = 100'

DATE : DECEMBER 2012

EXHIBIT: **A**



K.W. AUTOBODY, LLC

2885 UALENA STREET

005123
142101,02
143101
PLAT 16

HONOLULU INTERNATIONAL AIRPORT

N:\AIRPORTS\HNL_HONOLULU\CAD\FM\UALENA\HNL_005123-03.DWG