

NEIL ABERCROMBIE
GOVERNOR



STATE OF HAWAII
DEPARTMENT OF TRANSPORTATION
869 PUNCHBOWL STREET
HONOLULU, HAWAII 96813-5097

GLENN M. OKIMOTO
DIRECTOR

Deputy Directors
JADE T. BUTAY
FORD N. FUCHIGAMI
RANDY GRUNE
JADINE URASAKI

IN REPLY REFER TO:

Board of Land and Natural Resources
State of Hawaii
Honolulu, Hawaii

OAHU

**ISSUANCE OF RIGHT-OF-ENTRY PERMIT TO ALOHA PETROLEUM, LTD. ON
LAND SITUATED AT, HILO HARBOR, WAIAKEA, SOUTH HILO, ISLAND OF
HAWAII, TAX MAP KEY NO. (3) 2-1-09:PORTIONS OF 07 & 62**

APPLICANT:

Aloha Petroleum, Ltd., whose mailing address is 1132 Bishop Street, Suite 1700,
Honolulu, Hawaii 96813

LEGAL REFERENCE:

Section 171-11, Hawaii Revised Statutes, as amended.

LOCATION:

Portion of Hilo Harbor, Waiakea, South Hilo, Island of Hawaii identified by Tax Map
Key No. (3) 2-1-09:Portions of 07 & 62, as shown on the attached map labeled Exhibit
"A".

AREA:

3200 square feet, more or less.

ZONING:

State Land Use District: Urban
County of Hilo Industrial

LAND STATUS:

Subsection 5(A) lands of the Hawaii Admission Act, non-ceded.

CURRENT USE STATUS:

Encumbered by Governor's Executive Order No. 3962 to Department of Transportation, Harbors Division, for Commercial Maritime, Marine and Associated Purposes.

Encumbered by Revocable Permit No. H-98-2063 to Equilon Enterprises, LLC to monitor ground water conditions beneath adjacent bulk fuel distribution terminal.

CHARACTER OF USE:

Staging and Operation of Equipment and Material Related to the Construction of Improvements to the Aloha Petroleum, Ltd's Fuel Farm Facility.

TERM OF RIGHT-OF-ENTRY:

Three months, option to extend up to March 31, 2014.

CONSIDERATION:

Gratis.

REMARKS:

Applicant operates a petroleum fuel farm facility at 661 Kalaniana'ole Avenue, Hilo, HI 96720, adjacent to the Hilo Harbor. As part of their construction project the Applicant plans on renovating their existing perimeter wall by increasing its height. Access to Harbors' property is being requested during the project to stage and operate equipment and to move material on and off the Applicant's property. The Applicant will be required to work with the Harbors' Hawaii District staff and Young Brothers to prevent any disruption to harbors operations.

RECOMMENDATION:

That the Board authorizes the issuance of a Right-of-Entry permit to Aloha Petroleum, Inc. covering the subject area under the terms and conditions cited above, which are by this reference incorporated herein and further subject to the following:

1. The standard terms and conditions of the most current right-of-entry permit form, as may be amended from time to time.
2. Review and approval by the Department of the Attorney General.

3. Such other terms and conditions as may be prescribed by the Director of Transportation that best serve the interest of the State.

Respectfully submitted,

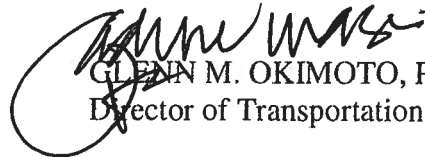
GLENN M. OKIMOTO, Ph.D.
Director of Transportation

Attachment

APPROVED FOR SUBMITTAL:

WILLIAM J. AILA, JR.
Chairperson and Member
Board of Land and Natural Resources

Hilo Harbor

8' high fence

Crane locations

Proposed ROE Area

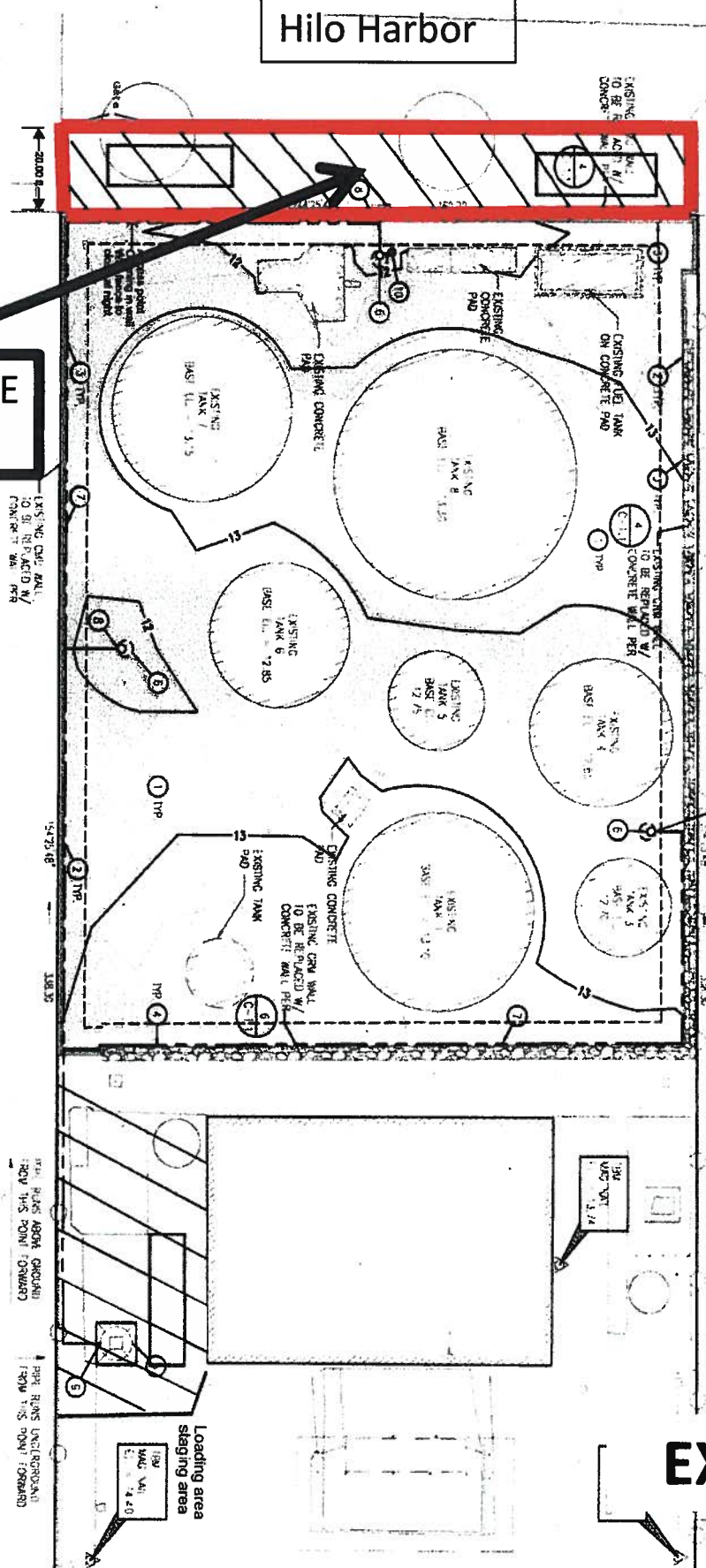
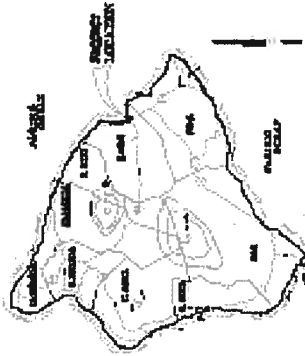

EXHIBIT A

SITE IMPROVEMENT PLANS

FOR:
ALOHA PETROLEUM WEST FUEL FARM
 WAIAKEA, SOUTH HILO, HAWAII, HAWAII
 TMK: (3) 2-1-007:002

HAWAII ISLAND MAP



VICINITY MAP

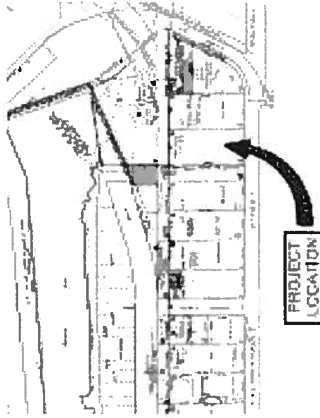

DRAWING INDEX

DRAWING NO.	DESCRIPTION
T-1.0	TITLE SHEET
D-1.0	NOTES
D-1.1	STRUCTURAL
D-2.0	SITE PLAN
D-3.0	GRADING PLAN

PROJECT TEAM

CONSULTANT FIRM:
 ALOHA PETROLEUM LTD.
 5125 BISHOP STREET SUITE 1703
 HONOLULU, HAWAII 96813
 PH: 1808 5220900
 ENGINEERING COORDINATOR:

APPROVALS

DATE: _____
 COUNTY: _____
 COUNTY ENGINEER:
 COUNTY OF HAWAII
 COUNTY ENGINEER

PLOT PLAN
 SCALE: 1"=12'

Green 'Alina

1111 1/2 St. #100
 Honolulu, HI 96813
 (808) 535-1111



STATE OF HAWAII
 DEPARTMENT OF LAND AND NATURAL RESOURCES
 ENGINEERING DIVISION

ALOHA PETROLEUM WEST FUEL FARM
 1122 Bishop Street Suite 1703
 Honolulu, Hawaii 96813
 (808) 522-0900

DATE: _____
 SCALE: _____
 DRAWING NO. _____

NO.	REVISION

Title Sheet

PROJECT NO. 11
 DRAWN BY: _____
 CHECKED BY: _____
 DATE: _____

DRAWING NO.
T-1.0