



STATE OF HAWAII
DEPARTMENT OF TRANSPORTATION
869 PUNCHBOWL STREET
HONOLULU, HAWAII 96813-5097

GLENN M. OKIMOTO
DIRECTOR

Deputy Directors
FORD N. FUCHIGAMI
RANDY GRUNE
AUDREY HIDANO
JADINE URASAKI

IN REPLY REFER TO:

Board of Land and
Natural Resources
State of Hawaii
Honolulu, Hawaii

AMENDMENT NO. 3 TO CONCESSION AGREEMENT NO. DOT-A-11-0006
RESTAURANT AND LOUNCE CONCESSION, ADDITIONAL SPACE
HOST INTERNATIONAL, INC.
LIHUE AIRPORT
TAX MAP KEY: (4) 3-5-01: 8 (PORTION)

LIHUE

PURPOSE:

To amend the existing Concession Agreement at Lihue Airport to allow for additional floor space to facilitate the food and beverage operations. Under Article III. (Premises) of the Lease, the specific area assigned or provided for the concession activity may be changed at the discretion of the Director of Transportation.

LEGAL REFERENCE:

Chapter 102, Hawaii Revised Statutes, as amended.

APPLICANT:

HOST INTERNATIONAL, INC., whose business address is 6905 Rockledge Drive,
Bethesda, Maryland 20817.

LOCATION AND TAX MAP KEY:

Lihue Airport, Tax Map Key: (4) 3-5-01: 8 (Portion)

ZONING:

State Land Use District:	Urban
County of Kauai:	Airport

LAND TITLE STATUS:

Section 5(a) lands of the Hawaii Admissions Act: Non-Ceded
DHHL 30% entitlement lands pursuant to the Hawaii State Constitution: No

LEASE COMMENCEMENT DATE:

October 1, 2011 through September 30, 2021.

ADDITIONAL PREMISES:

Building 306, Space No.219D, containing an area of approximately 606 square feet as shown on the attached Exhibit H, dated February 2014.

CONCESSION FEE:

No additional square footage floor rent will be charged. All gross receipts generated from the additional space will be included with the gross receipts of the concession. The concession pays the greater of minimum annual guaranteed fee or a percentage fee of gross receipts as provided in Article VI. (Concession Fee).

IMPROVEMENTS:

Applicant at its own cost and expense shall be responsible for any renovation, upgrade, remodeling, and improvement to the additional space.

CHAPTER 343, HRS - ENVIRONMENTAL ASSESSMENT:

Pursuant to Section 11-200-8 (a), Environmental Impact Statement Rules of the Department of Health, State of Hawaii, this disposition is exempt from requirements regarding preparation of an environmental assessment, negative declaration, or environmental impact statement as required by Chapter 343, Hawaii Revised Statutes, as amended, relating to Environmental Impact Statements because the proposed action falls within Exemption Class #3, Comprehensive Exemption List for the State of Hawaii, Department of Transportation Amended November 15, 2000, as approved by the Environmental Quality Council. Exemption Class #3 covers the construction and location of single, new, small facilities or structures and the alteration and modification of same and installation of new, small equipment and facilities and the alteration and modification of same including, but not limited to: (d) Water, sewage, electrical, gas, telephone and other essential public utility services extensions to serve such structures or facilities and (e) Accessory or appurtenant structures.

REMARKS:

The Department of Transportation and Host International, Inc. entered into that certain Concession Agreement (DOT-A-11-0006), effective October 1, 2011, for the Restaurant and Lounge Concession at the Lihue Airport. The additional space will allow Host International, Inc. to better serve the traveling public.

RECOMMENDATION:

The Board authorize the Department of Transportation to: (1) amend Article III. (Premises) of the subject Agreement as herein outlined, which are by reference incorporated herein; 2) such other terms and conditions as may be prescribed by the Director of Transportation to best serve the interests of the State; and 3) review and approval by the Department of the Attorney General.

Respectfully submitted



GLENN M. OKIMOTO, Ph. D.
Director of Transportation

APPROVED FOR SUBMITTAL:



WILLIAM J. AILA, JR.
Chairperson and Member

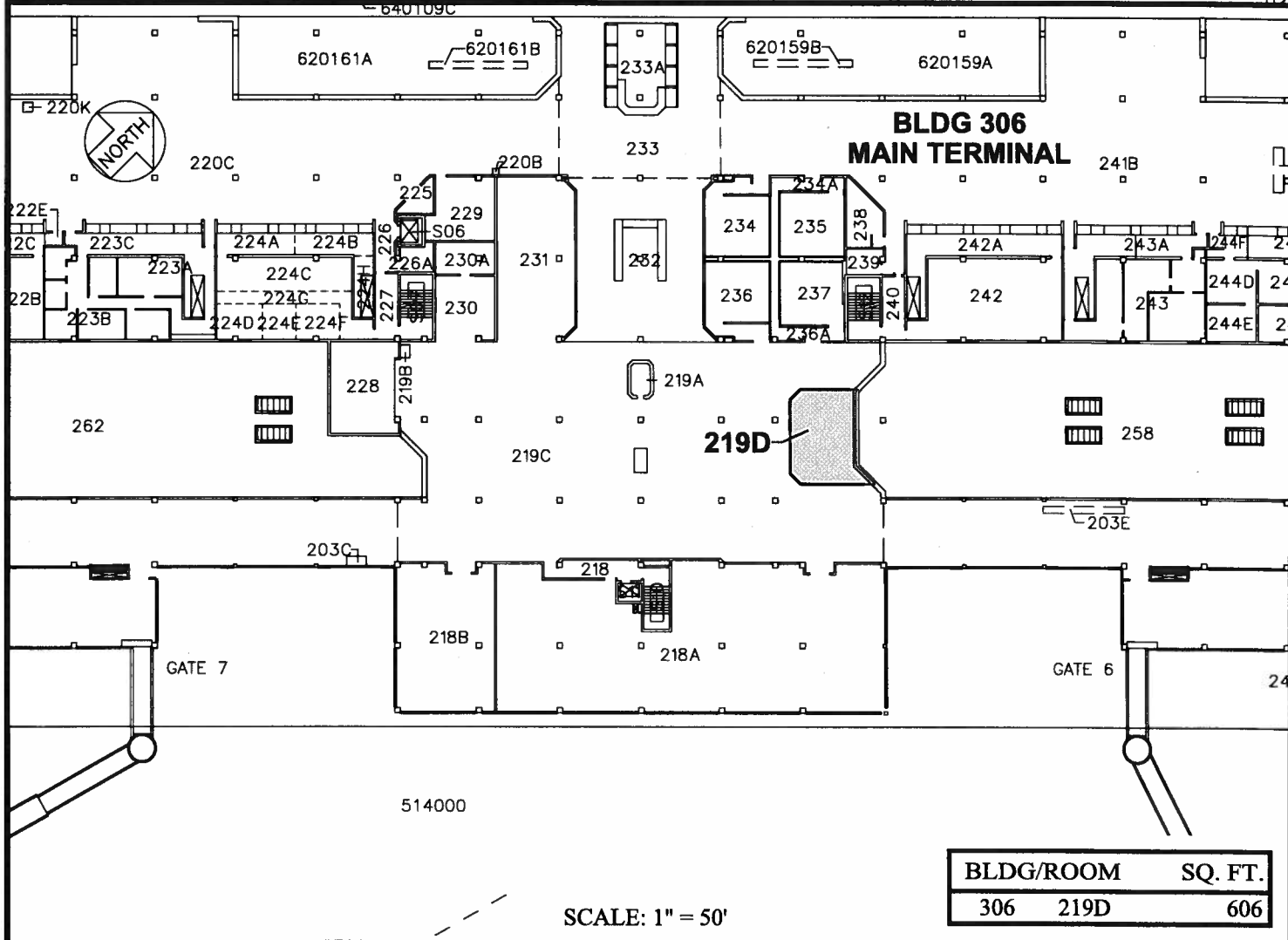
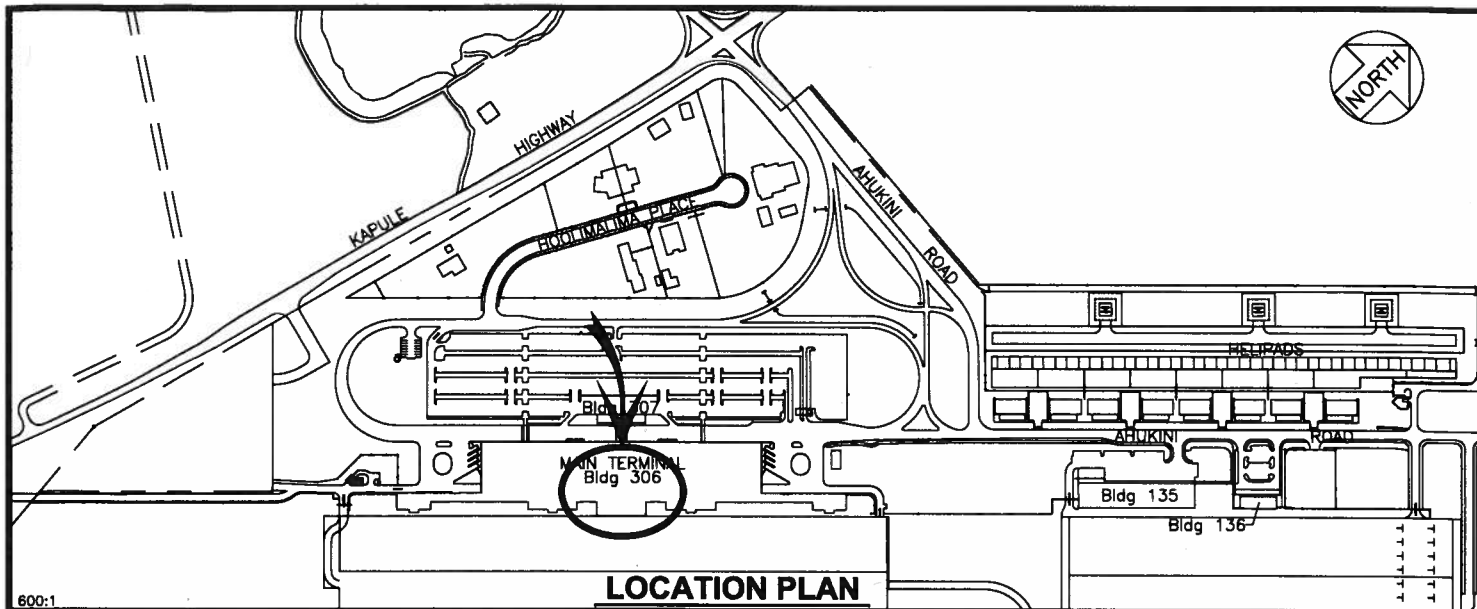

Amendment No. 3 to State Lease No. DOTA-11-0006

DATE : FEBRUARY 2014

EXHIBIT: **H**



Airports Division

HOST INTERNATIONAL, INC.

**BUILDING 306
MAIN TERMINAL
TERMINAL LEVEL**

306219D

PLATS C2, 45

LIHUE AIRPORT