

NEIL ABERCROMBIE
GOVERNOR



STATE OF HAWAII
DEPARTMENT OF TRANSPORTATION
869 PUNCHBOWL STREET
HONOLULU, HAWAII 96813-5097

GLENN M. OKIMOTO
DIRECTOR

Deputy Directors
FORD N. FUCHIGAMI
RANDY GRUNE
AUDREY HIDANO
JADINE URASAKI

IN REPLY REFER TO:

Board of Land and
Natural Resources
State of Hawaii
Honolulu, Hawaii

ISSUANCE OF A REVOCABLE PERMIT
US GENERAL SERVICES ADMINISTRATION FOR
TRANSPORTATION SECURITY ADMINISTRATION
MOLOKAI AIRPORT
TAX MAP KEY: (2) 5-2-04: PORTION OF 8

MOLOKAI

LEGAL REFERENCE:

Subsection 171-11 and 171-55, Hawaii Revised Statutes

APPLICANT:

U.S. General Services Administration for Transportation Security Administration (GSA),
whose business address is PBS San Diego Service Center (9PDE), 401 West A Street,
Suite 2075, Sand Diego, California, 92101

LOCATION AND TAX MAP KEY:

Portion of Molokai Airport, Hoolehua, Island of Molokai, identified by
Tax Map Key: 2nd Division, 5-2-04: Portion of 8

AREA:

Building/Room No. 301-143, containing an area of approximately 269 square feet
as shown and delineated on the attached map labeled Exhibit "A"

ZONING:

State Land Use: Agricultural
County: Interim Zoning Provisions of the Maui County Zoning Code

ITEM M-19

BLNR- ISSUANCE OF A REVOCABLE PERMIT
U.S. GENRAL SERVICES ADMINISTRATION FOR
TRANSPORTATION SECURITY ADMINISTRATION
Page 2

LAND TITLE STATUS:

Section 5(b), Hawaii Admissions Act - Ceded
DHHL, 30% entitlement lands Yes _____ No X

CURRENT USE STATUS:

Airport purposes

CHARACTER OF USE:

Occupancy for office space

COMMENCEMENT DATE:

Upon complete execution of the revocable permit

MONTHLY RENTAL:

\$511.10

SECURITY DEPOSIT:

\$0.00

HOLDOVER TENANCY:

\$0.00

DCCA VERIFICATION:

| | | |
|---|--------------|----------|
| Place of business registration confirmed: | YES <u>X</u> | NO _____ |
| Registered business name confirmed: | YES <u>X</u> | NO _____ |
| Good standing confirmed: | YES <u>X</u> | NO _____ |

CHAPTER 343, HRS - ENVIRONMENTAL ASSESSMENT:

Pursuant to Section 11-200-8(a), Environmental Impact Statement Rules of the Department of Health, State of Hawaii, this disposition is exempt from requirements regarding preparation of an environmental assessment, negative declaration, or

BLNR- ISSUANCE OF A REVOCABLE PERMIT
U.S. GENRAL SERVICES ADMINISTRATION FOR
TRANSPORTATION SECURITY ADMINISTRATION

Page 3

environmental impact statement as required by Chapter 343, Hawaii Revised Statutes, as amended, relating to Environmental Impact Statements, because the proposed action falls within Exemption Class #1, Comprehensive Exemption List for the State of Hawaii, Department of Transportation, dated November 15, 2000, as approved by the Environmental Quality Council. Exemption Class #1 covers operations, repairs, or maintenance of existing structures, facilities, equipment, or topographical features involving negligible or no expansion or change of use beyond that previously existing

REMARKS:

The DOT has no objections to GSA's request and therefore, in accordance with Sections 171-11 and 171-55, HRS, relating to Public Purposes and Permits respectively, the DOT proposes to issue a month-to-month revocable permit to GSA, Building/Room No. 301-143 for office use at MKK

RECOMMENDATION:

That the Board authorizes the Department of Transportation to issue a revocable permit to GSA, subject to: (1) terms and conditions herein outlined, which are by reference incorporated herein; (2) such other terms and conditions as may be prescribed by the Director of Transportation to best serve the interests of the State.

Respectfully submitted,



GLENN M. OKIMOTO, Ph.D.
Director of Transportation

APPROVED FOR SUBMITTAL:



WILLIAM J. AILA, JR.
Chairperson and Member

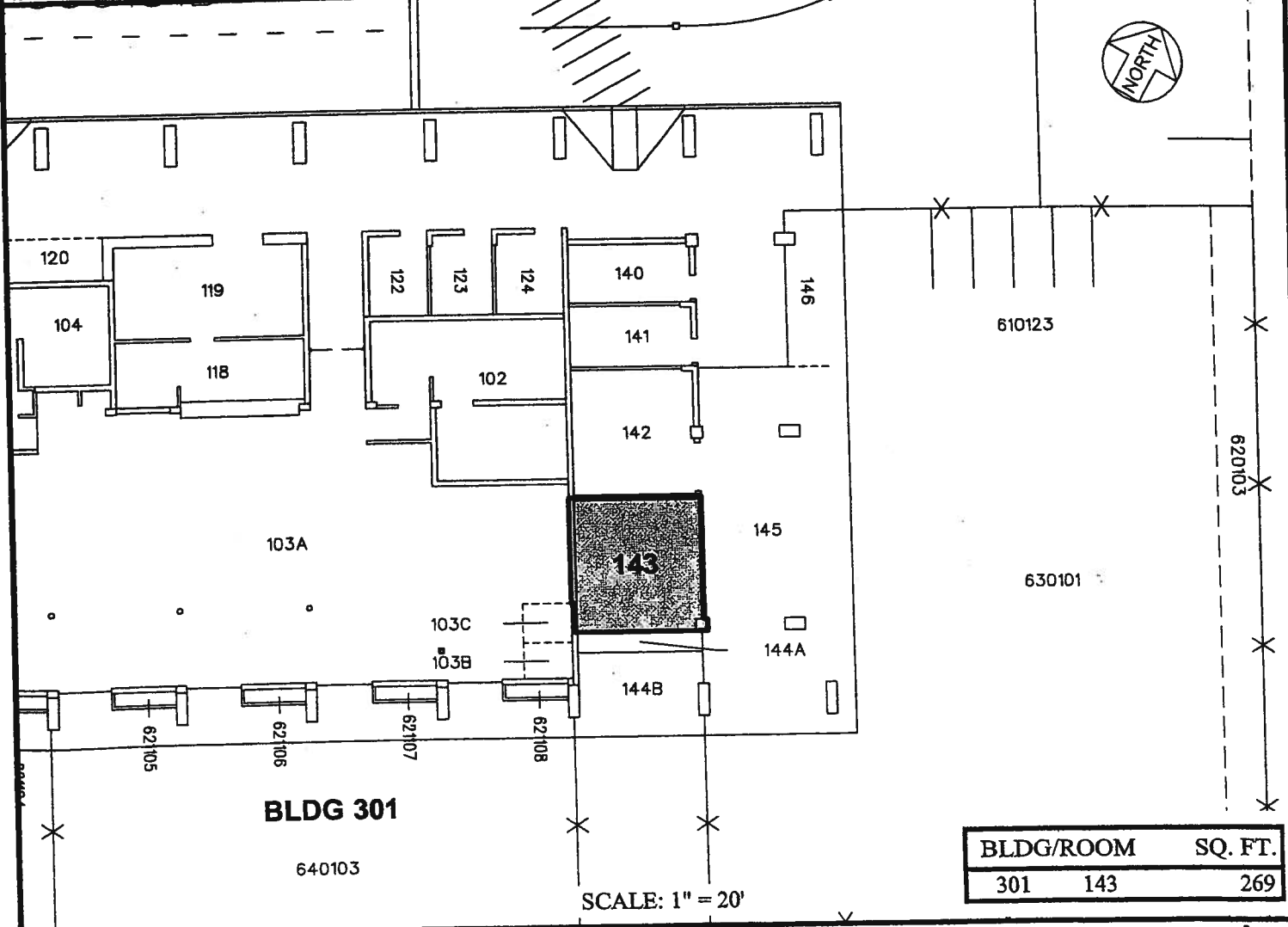
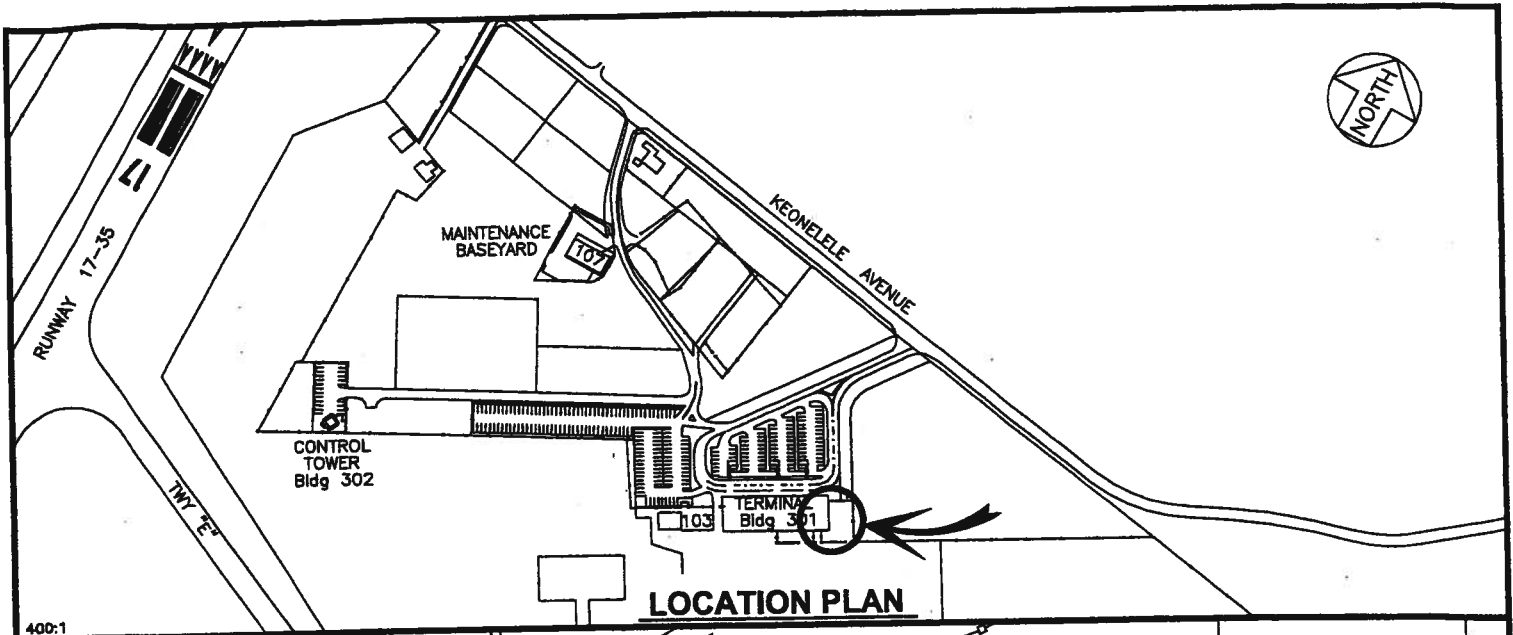

| BLDG/ROOM | SQ. FT. |
|-----------|---------|
| 301 143 | 269 |

DATE : SEPTEMBER 2013 EXHIBIT: **A**



U S GENERAL SERVICES
ADMINISTRATION FOR
TRANSPORTATION SECURITY
ADMINISTRATION

BUILDING 301
TERMINAL BUILDING
GROUND LEVEL

301143
PLAT A1

MOLOKAI AIRPORT

N:\AIRPORTS\MKK_Molokai\CAD\PM\mkk_301143-01.dwg