

NEIL ABERCROMBIE
GOVERNOR



STATE OF HAWAII
DEPARTMENT OF TRANSPORTATION
869 PUNCHBOWL STREET
HONOLULU, HAWAII 96813-5097

GLENN M. OKIMOTO
DIRECTOR

Deputy Directors
FORD N. FUCHIGAMI
RANDY GRUNE
AUDREY HIDANO
JADINE URASAKI

IN REPLY REFER TO:

Board of Land and
Natural Resources
State of Hawaii
Honolulu, Hawaii

ISSUANCE OF A REVOCABLE PERMIT
ISLAND HELICOPTERS KAUAI, INC.
LIHUE AIRPORT
TMK: (4) 3-5-01: PORTION OF 8

KAUAI

LEGAL REFERENCE:

Subsection 171-11 & 171-55, Hawaii Revised Statutes (HRS)

APPLICANT:

ISLAND HELICOPTERS KAUAI, INC. (IHK), a Hawaii corporation, authorized to do business in the State of Hawaii.

LOCATION AND TAX MAP KEY:

Portion of Lihue Airport, Lihue, Island of Kauai,
identified by Tax Map Key: 4th Division, 3-5-01: Portion of 8

AREA:

Area/Space No. 011-101A, containing a land area of approximately 12,200 square feet of improved, paved land and Area/Space Nos. 011-101B, -101C, -101D and -101E, containing a total land area of approximately 19,677 square feet of improved, unpaved lands, as shown and delineated on the attached Exhibit A.

ZONING:

State Land Use District: Urban
County of Kauai: Industrial (IG-STP)

ITEM M-8

LAND TITLE STATUS:

Section 5(a), Hawaii Admissions Act: Non-ceded
DHHL, 30% entitlement lands Yes____ No X

CURRENT USE STATUS:

Airport purposes

CHARACTER OF USE:

Commercial helicopter tours and operations

COMMENCEMENT DATE:

Upon complete execution of the revocable permit

MONTHLY RENTAL:

\$5,269.55

SECURITY DEPOSIT:

\$15,808.65

HOLDOVER TENANCY:

\$175.65

DCCA VERIFICATION:

Place of business registration confirmed:	YES <u>X</u>	NO _____
Registered business name confirmed:	YES <u>X</u>	NO _____
Good standing confirmed:	YES <u>X</u>	NO _____

CHAPTER 343, HRS – ENVIRONMENTAL ASSESSMENT:

The subject land areas are covered by the Environmental Assessment for Lihue Airport Ahukini Road Realignment and General Aviation Subdivision dated March 6, 1997. This Environmental Assessment evaluated the environmental effects of the recommended Airport Plan to realign Ahukini Road and the development of a General Aviation Subdivision. The assessment was prepared by the State of Hawaii, Department of Transportation, Airports Division.

REMARKS:

The Department of Transportation (DOT) has no objections to IHK's request and therefore, in accordance with Sections 171-11 and 171-55, HRS, relating to Public Purposes and Permits, respectively and therefore, the DOT proposes to issue a month-to-month revocable permit to IHK, Area/Space Nos. 011-101A, -101B, -101C, -101D, and -101E for commercial helicopter tours and operations at Lihue Airport.

RECOMMENDATION:

That the Board authorize the DOT to issue a month-to-month revocable permit to IHK, subject to: (1) terms and conditions herein outlined, which are by reference incorporated herein; and (2) such additional terms and conditions as may be prescribed by the Director of Transportation to best serve the interests of the State.

Respectfully submitted,



GLENN M. OKIMOTO, Ph.D.
Director of Transportation

APPROVED FOR SUBMITTAL:

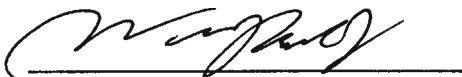

WILLIAM J. AILA, Jr.
Chairperson and Member

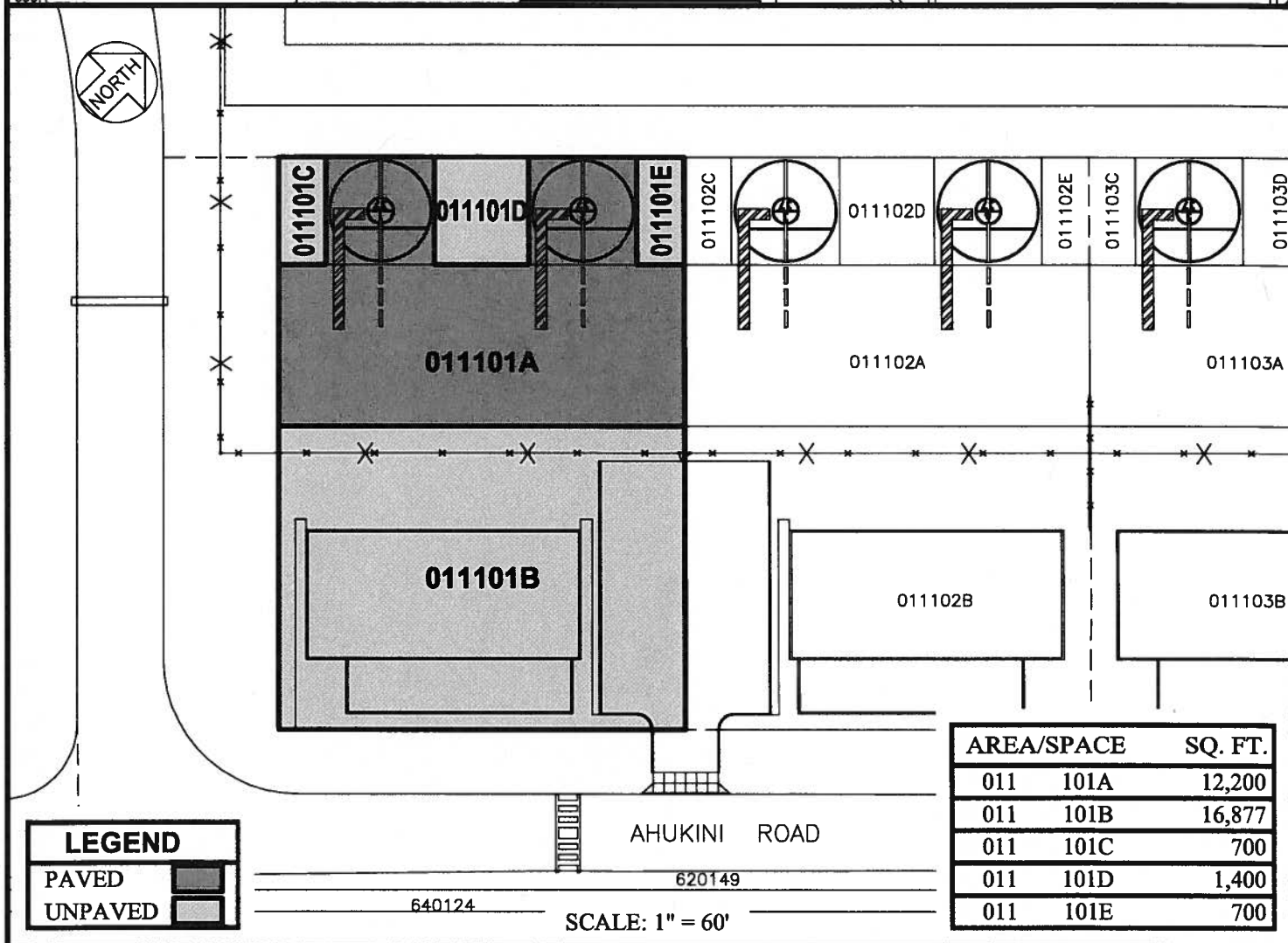
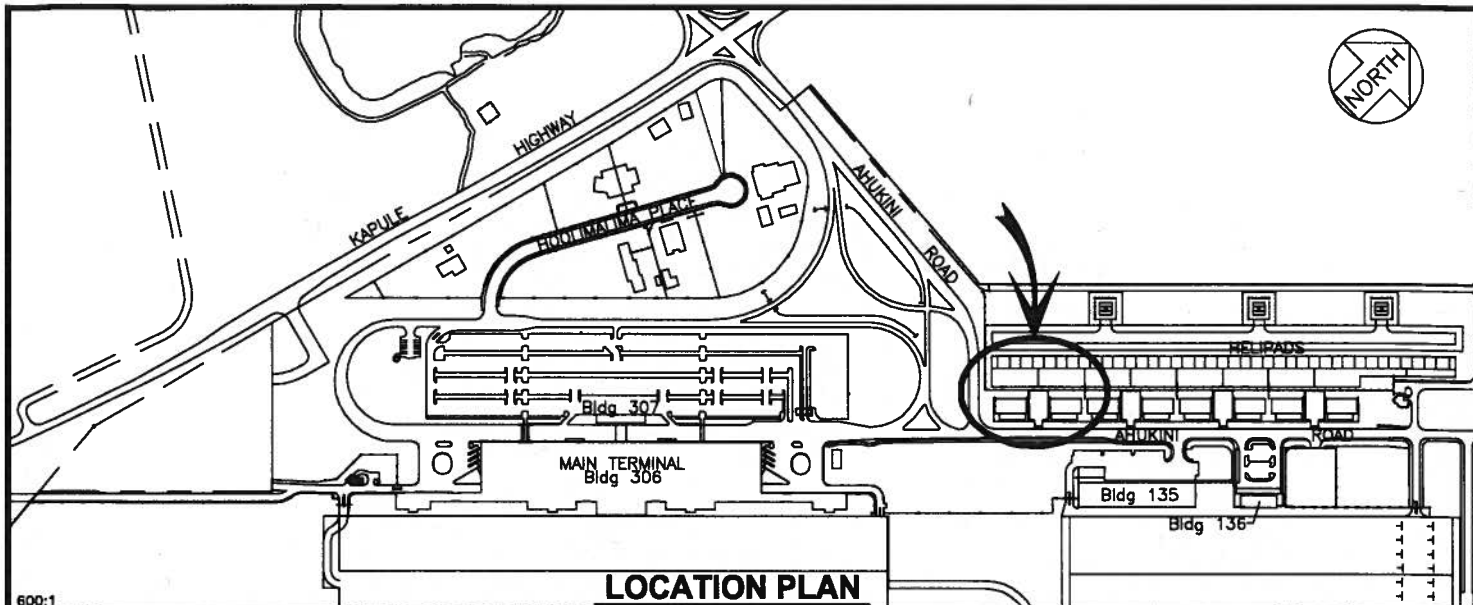

RP-8109

DATE : SEPTEMBER 2013

EXHIBIT: **A**



Airports Division

ISLAND HELICOPTERS
KAUAI, INC.

HELIPORT
LOTS
GROUND LEVEL

011101A-E

PLATS A1, D1, 35

LIHUE AIRPORT