

NEIL ABERCROMBIE
GOVERNOR



STATE OF HAWAII
DEPARTMENT OF TRANSPORTATION
869 PUNCHBOWL STREET
HONOLULU, HAWAII 96813-5097

GLENN M. OKIMOTO
DIRECTOR

Deputy Directors
FORD N. FUCHIGAMI
RANDY GRUNE
AUDREY HIDANO
JADINE URASAKI

IN REPLY REFER TO:

Board of Land and
Natural Resources
State of Hawaii
Honolulu, Hawaii

ISSUANCE OF A REVOCABLE PERMIT
MICHAEL SINGER
HILO INTERNATIONAL AIRPORT
TAX MAP KEY: (3) 2-1-12: PORTION OF 09

HAWAII

REQUEST:

Issuance of a Revocable Permit to Michael Singer at Hilo International Airport (ITO).

LEGAL REFERENCE:

Subsection 171-11 and 171-55, Hawaii Revised Statutes

APPLICANT:

Michael Singer, whose business address is P.O. Box 1719, Keaau, Hawaii 96749-1716

AREA:

Building/Room No. 402-101, containing an area of approximately 176 square feet
as shown on the attached map labeled Exhibit "A"

LOCATION AND TAX MAP KEY:

Portion of Hilo International Airport, Hilo, Island of Hawaii, identified by
Tax Map Key: 3rd division, 2-1-12: Portion of 09

ZONING:

State Land Use District:
County of Hawaii:

Urban
Industrial (ML-20)

ITEM M-7

BLNR – ISSUANCE OF A REVOCABLE PERMIT
MICHAEL SINGER
Page 2

LAND TITLE STATUS:

Section 5(a) lands (“ceded” lands) of the Hawaii Admission Act
DHHL 30% entitlement lands pursuant to the Hawaii State Constitution: YES NO

CURRENT USE STATUS:

Airport and aeronautical purposes

CHARACTER OF USE:

Office space

COMMENCEMENT DATE:

Upon complete execution of the revocable permit

MONTHLY RENTAL:

\$119.64

SECURITY DEPOSIT:

\$358.92

HOLDOVER TENANCY:

\$3.99

DCCA VERIFICATION:

Place of business registration confirmed:	YES <u>n/a</u>	NO <u>n/a</u>
Registered business name confirmed:	YES <u>n/a</u>	NO <u>n/a</u>
Good standing confirmed:	YES <u>n/a</u>	NO <u>n/a</u>

CHAPTER 343, HRS - ENVIRONMENTAL ASSESSMENT:

Pursuant to Section 11-200-8(a), Environmental Impact Statement Rules of the Department of Health, State of Hawaii, this disposition is exempt from requirements regarding preparation of an environmental assessment, negative declaration, or environmental impact statement as required by Chapter 343, Hawaii Revised Statutes, as amended, relating to Environmental Impact Statements, because the proposed action falls within Exemption Class #1, Comprehensive Exemption List for the State of Hawaii, Department of Transportation, dated November 15, 2000, as approved by the

BLNR – ISSUANCE OF A REVOCABLE PERMIT

MICHAEL SINGER

Page 3

Environmental Quality Council. Exemption Class #1 covers operations, repairs, or maintenance of existing structures, facilities, equipment, or topographical features involving negligible or no expansion or change of use beyond that previously existing.

REMARKS:

The DOT has no objections to the issuance of a revocable permit to Michael Singer, in accordance with Section 171-11 and 171-55, HRS, relating to Public Purposes and Permits, respectively and therefore, the DOT proposes to issue a month-to-month revocable permit to Michael Singer, Bldg/Room No. 402-101, for its office space at ITO.

RECOMMENDATION:

That the Board authorize the Department of Transportation to issue a month-to-month revocable permit to Michael Singer, subject to: (1) terms and conditions herein outlined, which are by reference incorporated herein; and (2) such additional terms and conditions as may be prescribed by the Director of Transportation to best serve the interests of the State.

Respectfully submitted,

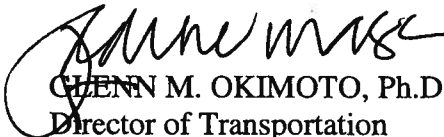
GLENN M. OKIMOTO, Ph.D.
Director of Transportation

APPROVED FOR SUBMITTAL:

WILLIAM J. AILA, JR.
Chairperson and Member

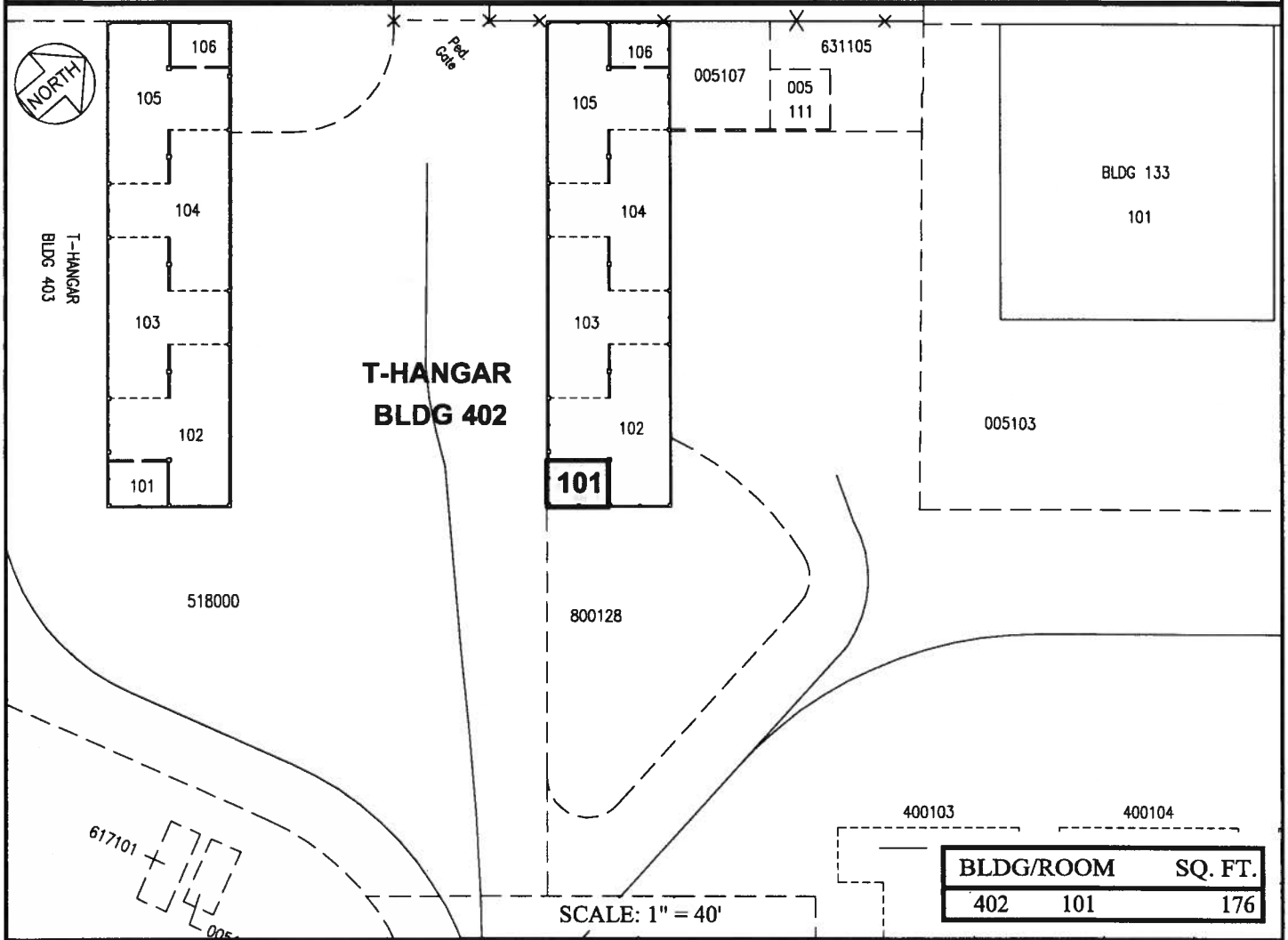
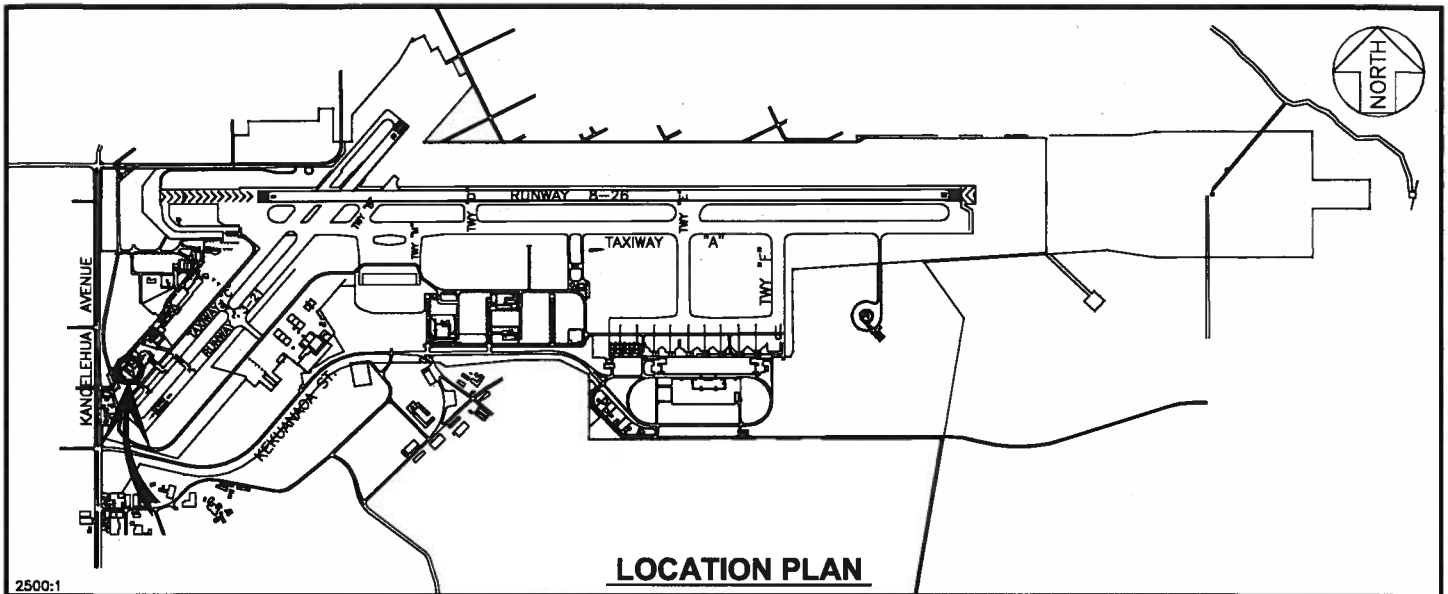

DEPARTMENT OF TRANSPORTATION Airports Division	DATE :	EXHIBIT: A
	MICHAEL SINGER	BUILDING 402 T-HANGARS GROUND LEVEL
		402101 PLATS B1,40

HILO INTERNATIONAL AIRPORT

N:\AIRPORTS\TO_Hilo\CAD\PM\to_402101-01.dwg