

NEIL ABERCROMBIE  
GOVERNOR



STATE OF HAWAII  
DEPARTMENT OF TRANSPORTATION  
869 PUNCHBOWL STREET  
HONOLULU, HAWAII 96813-5097

GLENN M. OKIMOTO  
DIRECTOR

Deputy Directors  
FORD N. FUCHIGAMI  
RANDY GRUNE  
AUDREY HIDANO  
JADINE URASAKI  
IN REPLY REFER TO:

Board of Land and  
Natural Resources  
State of Hawaii  
Honolulu, Hawaii

ISSUANCE OF A REVOCABLE PERMIT  
MOKULELE FLIGHT SERVICE, INC.  
KAPALUA AIRPORT  
TAX MAP KEY: (2) 4-3-01: PORTION OF 68

MAUI

LEGAL REFERENCE:

Sections 171-11 and 171-55, Hawaii Revised Statutes

APPLICANT:

Mokulele Flight Service, Inc. (MFS), whose business address is 73-350 U'u Street  
Kailua-Kona, Hawaii 96740

LOCATION AND TAX MAP KEY:

Portion of Kapalua Airport (JHM), Kapalua, Island of Maui, identified by Tax Map Key:  
2nd Division, 4-3-01: Portion of 68

AREAS:

Building/Space No. 300-106A, containing an area of approximately 47 square feet;  
Building/Space No. 300-107B, containing an area of approximately 178 square feet, all  
shown on the attached Exhibit "A".

ZONING:

State Land Use District: Urban  
County of Maui: Airport

LAND TITLE STATUS:

Section 5(a) lands of the Hawaii Admission Act: Non-Ceded  
DHHL 30% entitlement lands pursuant to Hawaii Admission Act YES\_\_\_ NO X

**ITEM M-4**

CURRENT USE STATUS:

Airport and aeronautical purposes

CHARACTER OF USE:

Ticket counters and office space

COMMENCEMENT DATE:

Upon complete execution of the revocable permit

MONTHLY RENTAL:

\$391.50

SECURITY DEPOSIT:

\$1,174.50

HOLDOVER TENANCY:

\$13.05

DCCA VERIFICATION:

Place of business registration confirmed:	YES <u>X</u>	NO _____
Registered business name confirmed:	YES <u>X</u>	NO _____
Good standing confirmed:	YES <u>X</u>	NO _____

CHAPTER 343, HRS - ENVIRONMENTAL ASSESSMENT:

Pursuant to Section 11-200-8(a), Environmental Impact Statement Rules of the Department of Health, State of Hawaii, this disposition is exempt from requirements regarding preparation of an environmental assessment, negative declaration, or environmental impact statement as required by Chapter 343, Hawaii Revised Statutes, as amended, relating to Environmental Impact Statements, because the proposed action falls within Exemption Class #1, Comprehensive Exemption List for the State of Hawaii, Department of Transportation, dated November 15, 2000, as approved by the Environmental Quality Council. Exemption Class #1 covers operations, repairs, or maintenance of existing structures, facilities, equipment, or topographical features involving negligible or no expansion or change of use beyond that previously existing.

BLNR – ISSUANCE OF A REVOCABLE PERMIT  
MOKULELE FLIGHT SERVICE, INC.

Page 3

REMARKS:

The Department of Transportation (DOT) has no objections to MFS's request and therefore, in accordance with Sections 171-11 and 171-55, HRS, relating to Public Purposes and Permits, respectively and therefore, the DOT proposes to issue a month-to-month revocable permit to MFS, Bldg/Space Nos. 300-106A and 300-107B for its ticket counters and office space at JHM.

RECOMMENDATION:

That the Board authorize the Department of Transportation to issue a month-to-month revocable permit to MFS, subject to: (1) terms and conditions herein outlined, which are by reference incorporated herein; and (2) such additional terms and conditions as may be prescribed by the Director of Transportation to best serve the interests of the State.

Respectfully submitted,

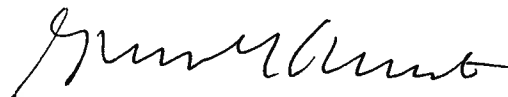

GLENN M. OKIMOTO, Ph.D.  
Director of Transportation

APPROVED FOR SUBMITTAL:



WILLIAM J. AILA, JR.  
Chairperson and Member

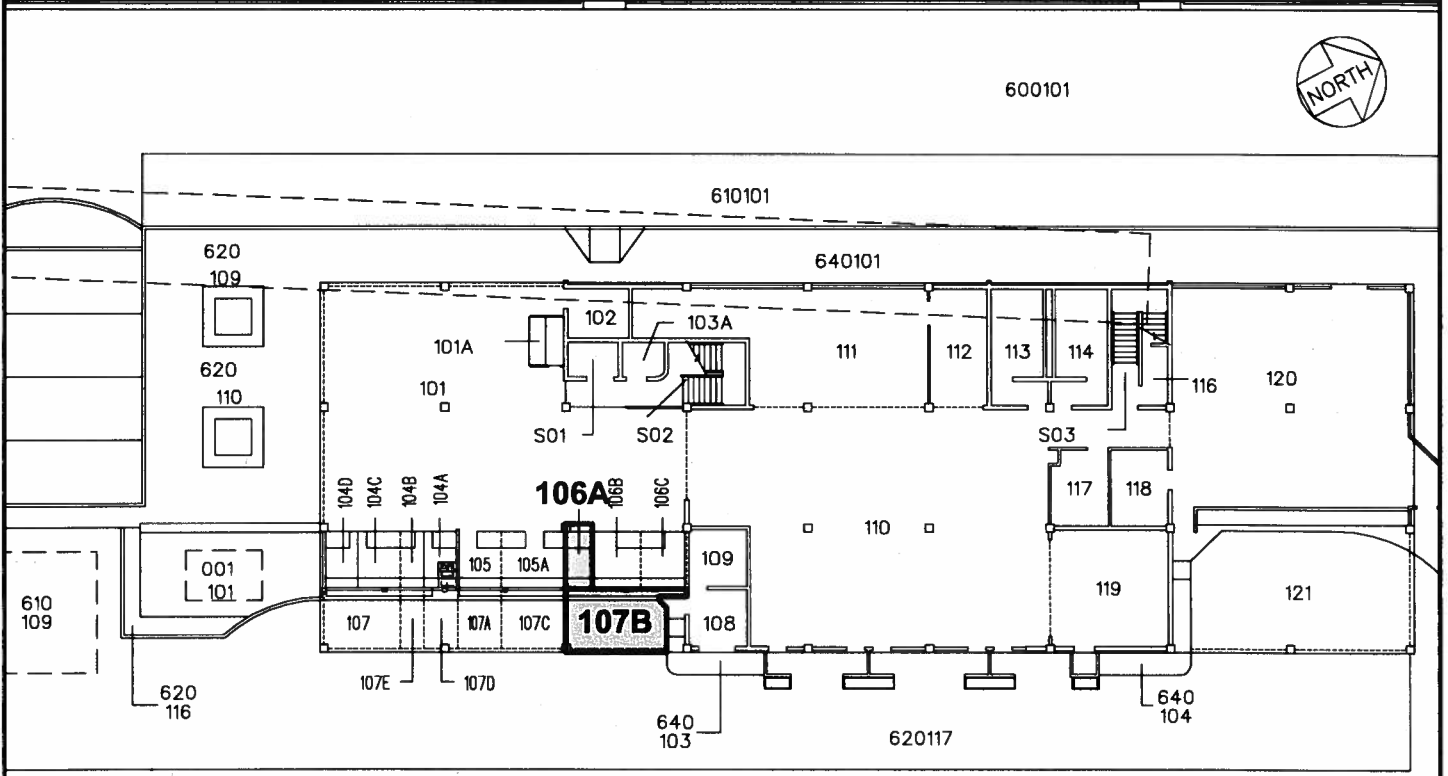
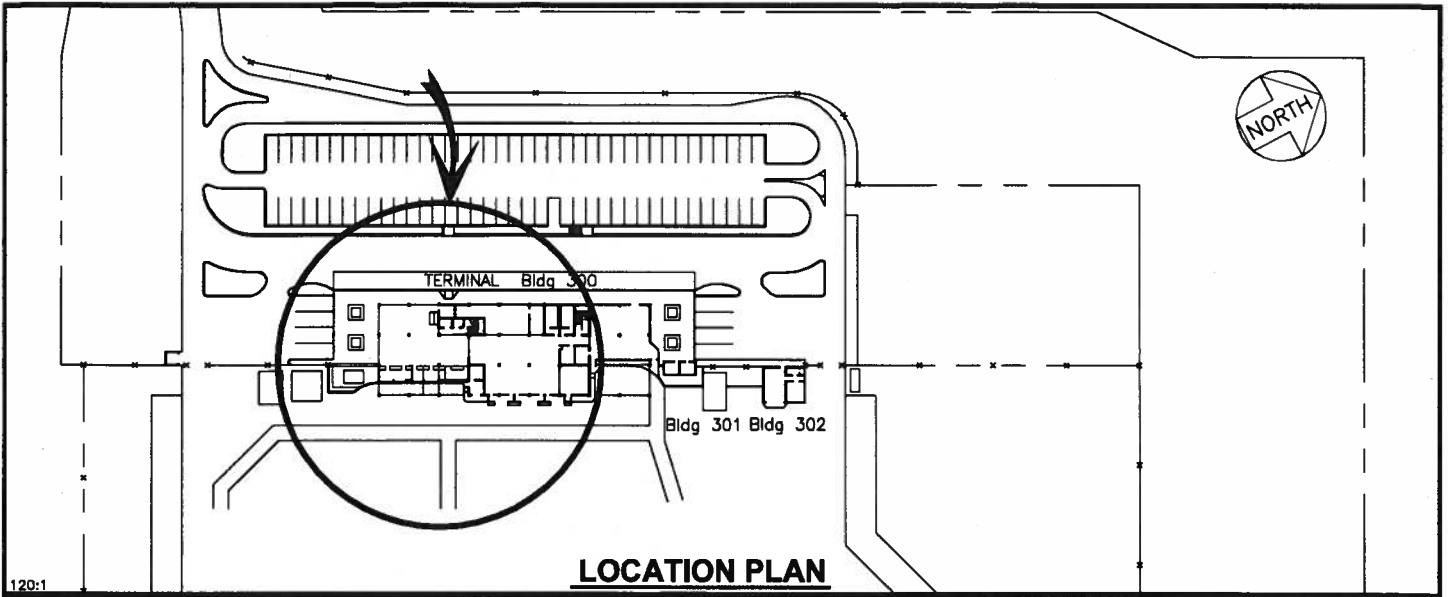

**TERMINAL BLDG 300**

502101

BLDG/ROOM	SQ. FT.
300 106A	47
300 107B	178

SCALE: 1" = 30'

DATE : MARCH 2014

EXHIBIT: **A**



**MOKULELE FLIGHT SERVICES, INC.**

**BUILDING 300  
TERMINAL BLDG  
GROUND LEVEL**

**300106A  
300107B  
PLATS A1, 42**

N:\AIRPORTS\JHM\_Kapalua\CAD\FM\jhm\_300106A-01.dwg