



STATE OF HAWAII
DEPARTMENT OF TRANSPORTATION
869 PUNCHBOWL STREET
HONOLULU, HAWAII 96813-5097

GLENN M. OKIMOTO
DIRECTOR

Deputy Directors
FORD N. FUCHIGAMI
RANDY GRUNE
AUDREY HIDANO
JADINE URASAKI

IN REPLY REFER TO:

Board of Land and
Natural Resources
State of Hawaii
Honolulu, Hawaii

ISSUANCE OF A REVOCABLE PERMIT FOR
PASSENGER CHECK-IN COUNTER, STORAGE AND
EQUIPMENT STORAGE AREA FOR AIRLINE OPERATIONS PURPOSES
MOKULELE FLIGHT SERVICE, INC.
KALAELOA AIRPORT, ISLAND OF OAHU, STATE OF HAWAII
TAX MAP KEY: (1) 9-1-13: PORTION OF 32

OAHU

LEGAL REFERENCE:

Section 171-55, Hawaii Revised Statutes

APPLICANT:

Mokulele Flight Service, Inc. doing business as Mokulele Airlines, a domestic profit corporation registered to do business in the State of Hawaii, whose mailing address is 73-350 U`u Street, Kailua-Kona, Hawaii 96740.

LOCATION:

Portion of Kalaeloa Airport, Kapolei, Island of Oahu, State of Hawaii, identified by Tax Map Key: 1st Division, 9-1-13: Portion of 32

AREA:

Building/Space No.104-128, containing an area of approximately 103 square feet;
Space No. 104-129, containing an area of approximately 21 square feet; and
Space No. 001-123, containing an area of approximately 400 square feet,
as shown and delineated on the attached map labeled Exhibit A.

ZONING:

State Land Use District: Urban
City and County of Honolulu: P-2 (To be rezoned in the future)

LAND TITLE STATUS:

Non-ceded land acquired from the U.S. Government by the State of Hawaii after Statehood
DHHL 30% entitlement lands pursuant to the Hawaii State Constitution: YES NO

CURRENT USE STATUS:

Land presently encumbered by Governor's Executive Order No. 3861, setting aside
Kalaeloa Airport under the control and management of the Department of Transportation,
Airports Division, State of Hawaii for Airport Purposes.

CHARACTER OF USE:

Mokulele will occupy a portion of Building 104 for passenger check-in counter and storage,
and land area, Space No. 001-123 for equipment storage for airline operations.

REVOCABLE PERMIT COMMENCEMENT DATE:

To be determined by the Director of Transportation at a later date.

MONTHLY RENTAL:

\$216.54

SECURITY DEPOSIT:

\$649.62

HOLDOVER TENANCY:

\$7.22

CHAPTER 343, HRS - ENVIRONMENTAL ASSESSMENT:

Pursuant to Section 11-200-8(a), Environmental Impact Statement Rules of the
Department of Health, State of Hawaii, this disposition is exempt from requirements
regarding preparation of an environmental assessment, negative declaration, or
environmental impact statement as required by Chapter 343, Hawaii Revised Statutes, as
amended, relating to Environmental Impact Statements, because the proposed action falls
within Exemption Class #1, Comprehensive Exemption List for the State of Hawaii
Department of Transportation, dated November 14, 1990 and as amended, November 15,
2000, as approved by the Environmental Quality Council. Exemption Class #1 covers
operations, repairs, or maintenance of existing structures, facilities, equipment, or

topographical features involving negligible or no expansion or change of use beyond that previously existing.

DCCA VERIFICATION:

Place of business registration confirmed:	YES <u>X</u>	NO _____
Registered business name confirmed:	YES <u>X</u>	NO _____
Good standing confirmed:	YES <u>X</u>	NO _____

REMARKS:

In accordance with Section 171-55, HRS, relating to Permits, the Department of Transportation proposes to issue a month-to-month revocable permit to Mokulele Flight Service, Inc., to occupy a portion of Building 104 to use as passenger check-in counter and storage, and a portion of land, Space No. 001-123 to be used for equipment storage in support of passenger airline operation at Kalaeloa Airport.

RECOMMENDATION:

That the Board authorize the Department of Transportation to issue a month-to-month revocable permit to Mokulele Flight Service, Inc. subject to: (1) terms and conditions herein outlined, which are by reference incorporated herein; (2) such other terms and conditions as may be prescribed by the Director of Transportation to best serve the interests of the State; and (3) review and approval by the Department of the Attorney General.

Respectfully submitted,

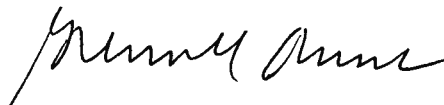

GLENN M. OKIMOTO, Ph.D.
Director of Transportation

APPROVED FOR SUBMITTAL:



WILLIAM J. AILA, JR.
Chairperson and Member

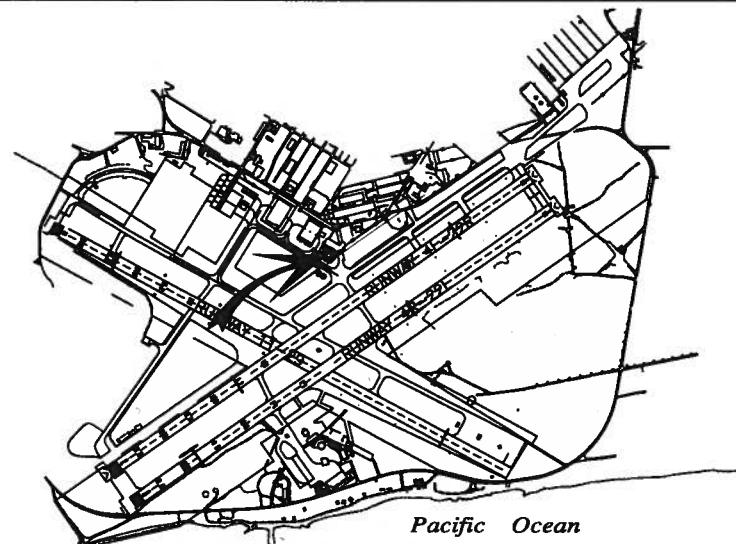

LOCATION PLAN

3000:1

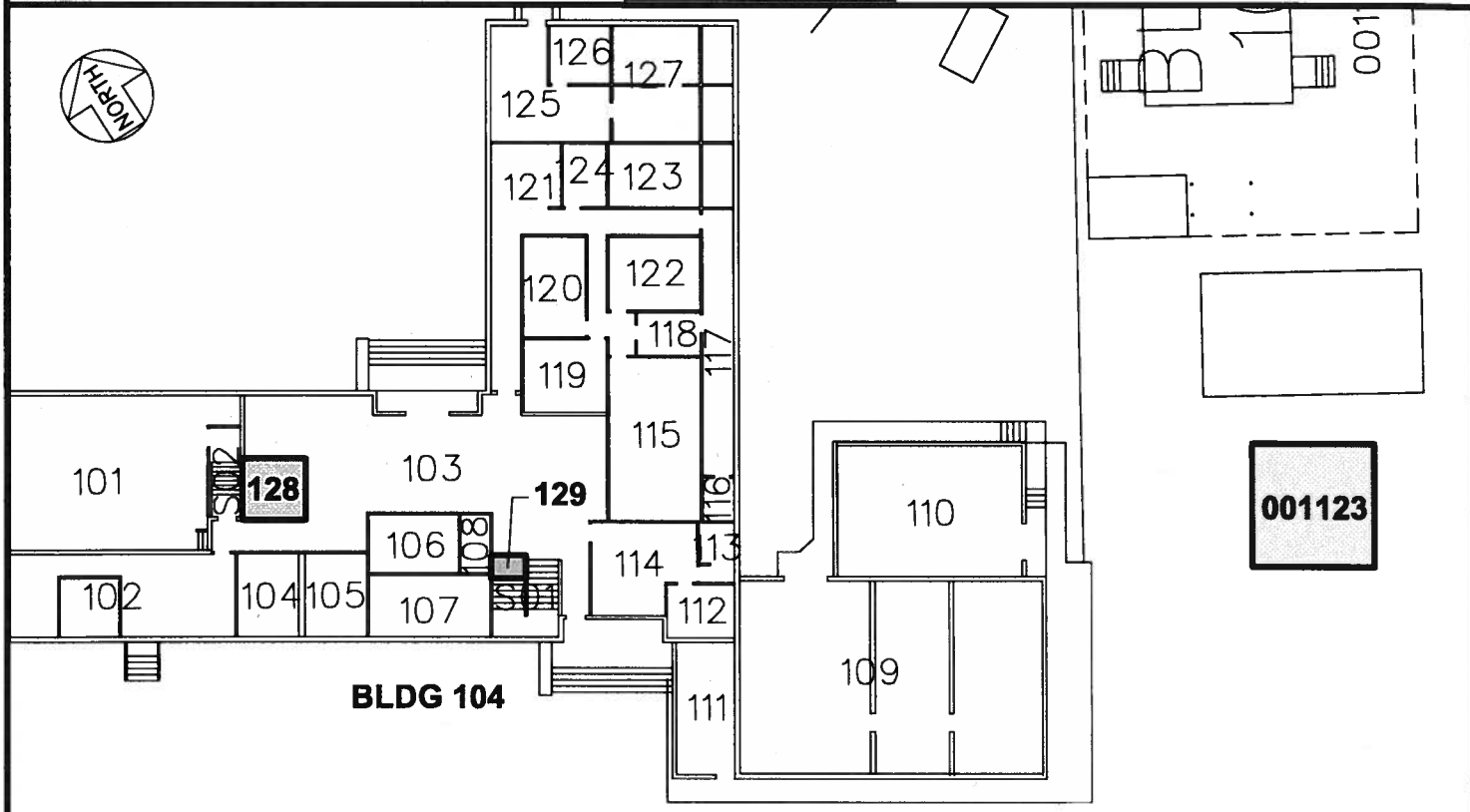

AREA/SPACE	SQ. FT.
001 123	400

BLDG/ROOM	SQ. FT.
104 128	103
104 129	21

SCALE: 1" = 30'

DATE : APRIL 2014

EXHIBIT: **A**



MOKULELE FLIGHT SERVICES, INC.

**BUILDING 104
OPERATIONS BUILDING
GROUND LEVEL**

**001123
104128
104129**

KALAELOA AIRPORT

N:\AIRPORTS\JRF_Kalaeloa\CAD\FM\jrf_104128_01.dwg