

STATE OF HAWAII
DEPARTMENT OF LAND AND NATURAL RESOURCES
Land Division
Honolulu, Hawaii 96813

August 8, 2014

Board of Land and Natural Resources
State of Hawaii
Honolulu, Hawaii

PSF No. 14OD-131

Oahu

Issuance of a Right-of-Entry Permit to Waikiki Roughwater Swim Committee, Inc.
for a Swim Race Event to be held on September 1, 2014, at Waikiki, Honolulu,
Oahu, Tax Map Key: (1) 2-3-37:por. 21

APPLICANT:

Waikiki Roughwater Swim Committee, Inc.

LEGAL REFERENCE:

Sections 171-55, Hawaii Revised Statutes, as amended.

LOCATION:

Portion of Government lands of Waikiki, Honolulu, Oahu, identified as Tax Map Key:
(1) 2-3-037: portion of 021, as shown on the attached Exhibit 1.

AREA

1,700 square feet, more or less

ZONING:

State Land Use District: Conservation/Urban
City and County of Honolulu LUO: Public Precinct

TRUST LAND STATUS:

Section 5(a) lands of the Hawaii Admission Act
DHHL 30% entitlement lands pursuant to the Hawaii State Constitution: No

CURRENT USE STATUS:

Requested area is unencumbered

CHARACTER OF USE:

Swim Race Event

TERM:

From 5:30 a.m. to 12:30 p.m. on September 1, 2014

RENTAL:

\$170.00 (A one-time payment based on 10¢ per square feet per day.)

COLLATERAL SECURITY DEPOSIT:

None

CHAPTER 343 - ENVIRONMENTAL ASSESSMENT:

In accordance with Hawaii Administrative Rule Section 11-200-8(a)(1) and (4) and the Exemption List for the Department of Land and Natural Resources approved by the Environmental Council and dated December 4, 1991, the subject request is exempt from the preparation of an environmental assessment pursuant to Exemption Class No. 1, that states "Operations, repairs or maintenance of existing structures, facilities, equipment, or topographical features, involving negligible or no expansion or change of use beyond that previously existing" and Class No. 4, that states "Minor alteration in the conditions of land, water, or vegetation.", as explained in Exhibit 2.

DCCA VERIFICATION:

Place of business registration confirmed:	YES <u>x</u>	NO <u> </u>
Registered business name confirmed:	YES <u>x</u>	NO <u> </u>
Applicant in good standing confirmed:	YES <u>x</u>	NO <u> </u>

REMARKS:

The Waikiki Roughwater Swim Committee, Inc. (WRSC) requests permission to use selected areas of the Duke Kahanamoku Beach for the finish of their 45th Annual Waikiki Roughwater Swim race event. The event is scheduled for Monday, September 1, 2014. Equipment will be set-up on the permitted beach areas starting from 5:30 a.m. and torn-down by 12:30 p.m. Included within Exhibit 3, is a map furnished by the applicant depicting the selected beach areas requested for use relating to the subject event. A roped finish-line area of the Duke Kahanamoku Beach fronting the Hilton Hawaiian Village Hotel will consist of 1,100 square feet, with timing equipment and an announcer's table present. WRSC requests the use of 200 square feet of beach area situated adjacent to the finish line for the setting up of two tents, serving medical doctor and first aid purposes. An additional 200 square feet of tent and table area is requested for: "Clothes Pick-up". Lastly, the applicant also requests the use of 200 square feet of beach area for the placement of a tent with tables for T-shirt distribution purposes. The right-of-entry permit request includes the use of 1,700 total

square feet of beach area.

The applicant has not had a lease, permit, easement or other disposition of State lands terminated within the past five years due to non-compliance with such terms and conditions.

There were no requests routed to government and/or community agencies for comments since there are currently no outstanding issues associated with this request.

Staff has no objections to the subject request.

Staff now brings the subject request to the Board for its approval.

RECOMMENDATION: That the Board

1. Declare that, after considering the potential effects of the proposed disposition as provided by Chapter 343, HRS, and Chapter 11-200, HAR, this project will probably have minimal or no significant effect on the environment and is therefore exempt from the preparation of an environmental assessment.
2. Authorize the issuance of a right-of-entry permit to Waikiki Roughwater Swim Committee, Inc. for the purpose of covering the subject area for the swim race event under the terms and conditions cited above, which are by this reference incorporated herein and further subject to the following:
 - a. The standard terms and conditions of the most current right-of-entry form, as may be amended from time to time; and
 - b. Such other terms and conditions as may be prescribed by the Chairperson to best serve the interests of the State.

Respectfully Submitted,



Timmy Chee
Land Agent

APPROVED FOR SUBMITTAL:



William J. Aila Jr., Chairperson

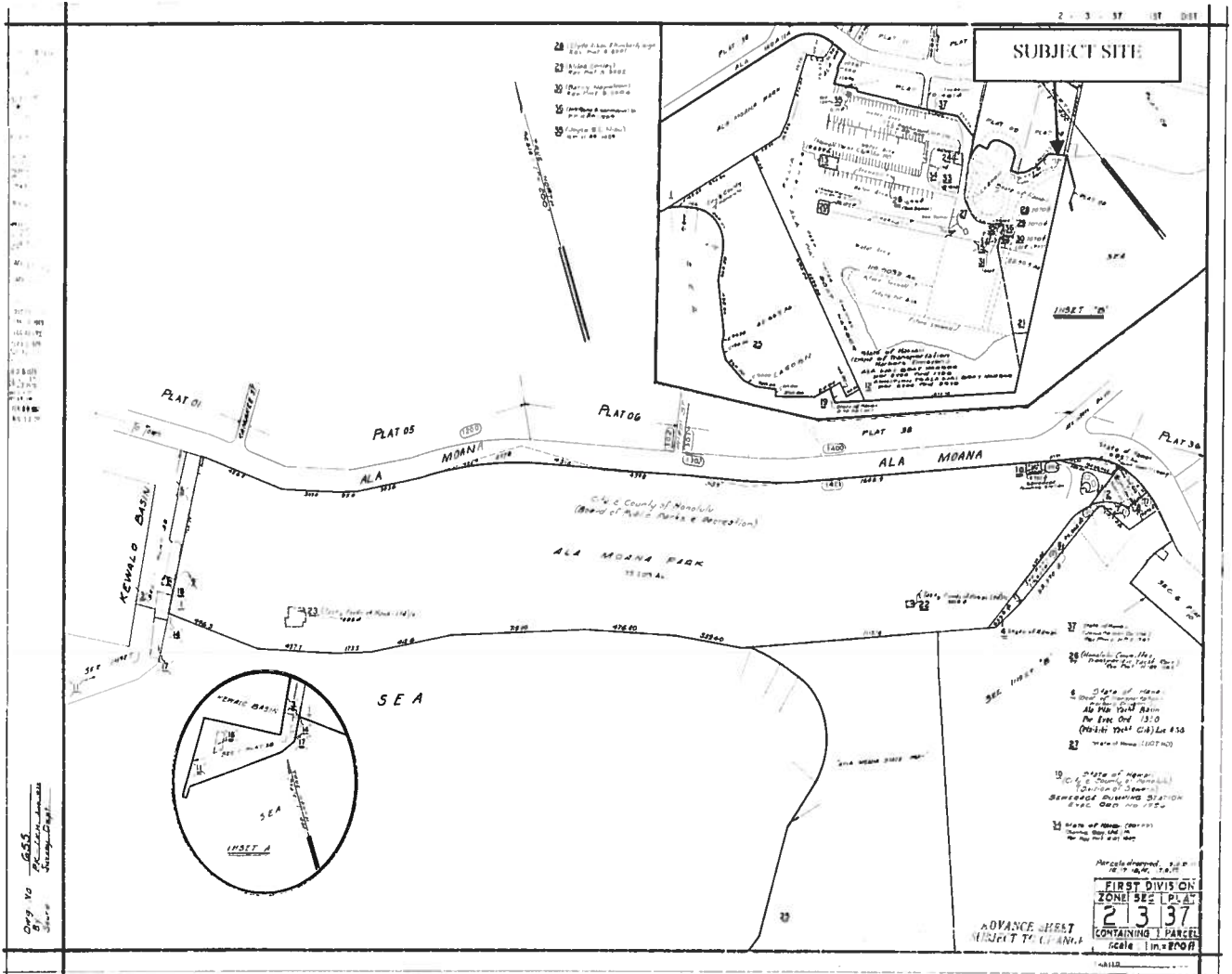

EXHIBIT 1

EXEMPTION NOTIFICATION

regarding the preparation of an environmental assessment pursuant to Chapter 343, HRS and Chapter 11-200, HAR

Project Title: Issuance of Right-of-Entry Permit for the Waikiki Roughwater Swim Committee, Inc

Project / Reference No.: PSF 14OD-131

Project Location: Waikiki, Honolulu, Oahu, Tax Map Key: (1) 2-3-037: portions of: 021.

Project Description: Swim Race Event

Chap. 343 Trigger(s): Use of State Land

Exemption Class No.: In accordance with Hawaii Administrative Rule Section 11-200-8(a)(1) and (4) and the Exemption List for the Department of Land and Natural Resources approved by the Environmental Council and dated December 4, 1991, the subject request is exempt from the preparation of an environmental assessment pursuant to Exemption Class No. 1, that states "Operations, repairs or maintenance of existing structures, facilities, equipment, or topographical features, involving negligible or no expansion or change of use beyond that previously existing" and Class No. 4, that states "Minor alteration in the conditions of land, water, or vegetation."

This Board has permitted similar events in the past. The proposed activity is of a similar type and scope of beach activities that periodically occurred and continues to occur on this and other beach areas across the State. Such activities have resulted in no known significant impacts, whether immediate or cumulative, to the natural, environmental and/or cultural resources in the area. As such staff believes that the proposed event would involve negligible or no expansion or change in use beyond that previously existing.

Consulted Parties Not Applicable

Recommendation: It is recommended that the Land Board find this project to have minimal or no significant effect on the environment and is presumed to be exempt from the preparation of an environmental assessment.

William J. Aila Jr., Chairperson

Date

Waikiki Rough Water Swim

Finish Line/Beach set-up

Hilton Hawaiian Village

Pa oa Lane

Sunday & Monday
10/20 Tent
4 tables/8 chairs

Hale Koa



Stage

Sidewalk

Beach Usage

2 = 10 x 20 tents

2 = 10x10 tents

Finish Line area = 1100 sq ft

Total Usage = 1700 sq ft

All remaining beach area is completely open to the public

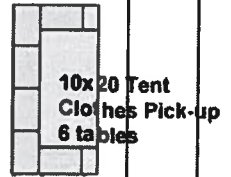
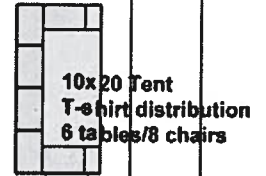
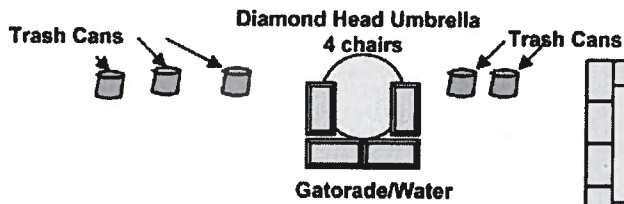

Sidewalk

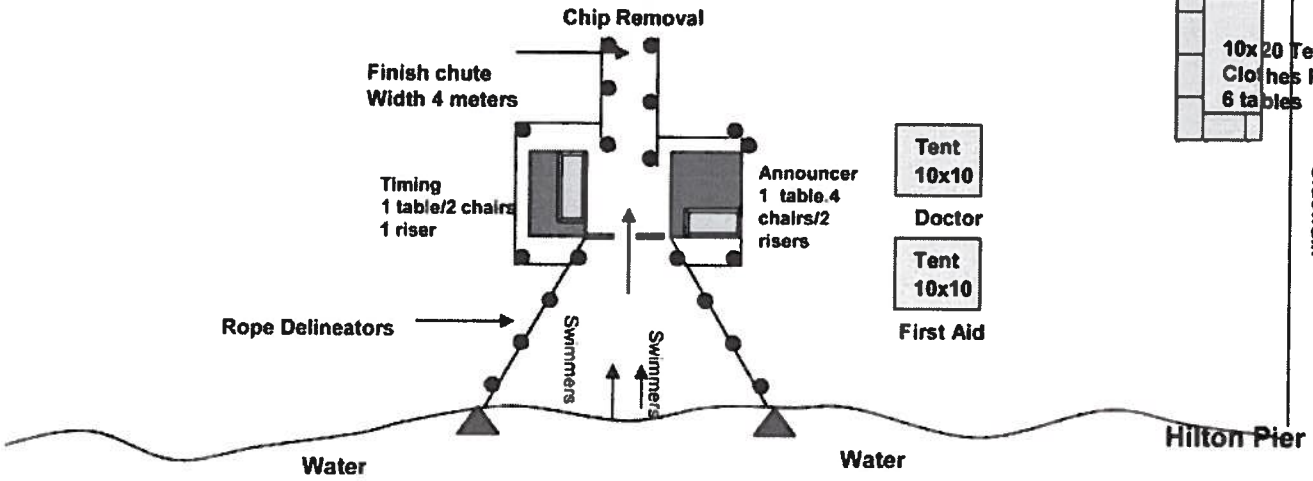

EXHIBIT 3