



STATE OF HAWAII  
DEPARTMENT OF TRANSPORTATION  
869 PUNCHBOWL STREET  
HONOLULU, HAWAII 96813-5097

IN REPLY REFER TO:

Board of Land and  
Natural Resources  
State of Hawaii  
Honolulu, Hawaii

ISSUANCE OF A REVOCABLE PERMIT FOR LAND  
FOR STORAGE OF AN OFFICE TRAILER  
HAWAII PACIFIC AVIATION, INC., SPACE NO. 006-107  
KONA INTERNATIONAL AIRPORT AT KEAHOLE  
TAX MAP KEY: (3) 7-3-43: PORTION OF 40

HAWAII

REQUEST:

Issuance of a Revocable Permit to Hawaii Pacific Aviation, Inc. at Kona International  
Airport at Keahole

LEGAL REFERENCE:

Sections 171-11 and 171-55, Hawaii Revised Statutes

APPLICANT:

Hawaii Pacific Aviation, Inc. (HPA), whose address is 73-310 U'u Street, Kailua-Kona,  
Hawaii 96740

AREA:

Area/Space No. 006-107, containing an area of approximately 8,500 square feet of  
improved/unpaved land, as shown on the attached map labeled Exhibit "A"

LOCATION AND TAX MAP KEY:

Portion of Kona International Airport at Keahole (KOA), Kailua-Kona, Island of Hawaii,  
identified by Tax Map Key: (3) 7-3-43: Portion of 40

ZONING:

State Land Use District:  
County of Hawaii:

Urban & Conservation  
Industrial (MG-1a) and Open

BLNR – ISSUANCE OF A REVOCABLE PERMIT  
FOR LAND FOR STORAGE OF AN OFFICE TRAILER (SPACE NO. 006-107)  
HAWAII PACIFIC AVIATION INC.

Page 2

LAND TITLE STATUS:

Section 5(a) lands of the Hawaii Admission Act - Ceded  
DHHL 30% entitlement lands pursuant to Hawaii Admission Act: YES    NO X

CURRENT USE STATUS:

Airport and aeronautical purposes

CHARACTER OF USE:

Land for the storage of an office trailer

COMMENCEMENT DATE:

Upon complete execution of the revocable permit

MONTHLY RENTAL:

\$842.92

SECURITY DEPOSIT:

\$2,528.76

HOLDOVER TENANCY:

\$28.10

DCCA VERIFICATION:

Place of business registration confirmed:	YES <u>X</u>	NO <u>  </u>
Registered business name confirmed:	YES <u>X</u>	NO <u>  </u>
Good standing confirmed:	YES <u>X</u>	NO <u>  </u>

CHAPTER 343, HRS - ENVIRONMENTAL ASSESSMENT:

This project will have no significant impact as stated in the Final Environmental Assessment/Finding of No Significant Impact for the Airfield, Terminal and Facility Improvements for KOA as prepared for the State of Hawaii, Department of Transportation, Airports Division by Wilson Okamoto Corporation, Engineers and Planners under WOC Job No. 8027-01 for State Project No. AH2011-05.

BLNR – ISSUANCE OF A REVOCABLE PERMIT  
FOR LAND FOR STORAGE OF AN OFFICE TRAILER (SPACE NO. 006-107)  
HAWAII PACIFIC AVIATION INC.

Page 3

REMARKS:

The DOT has no objections to HPA’s request and therefore, in accordance with Sections 171-11 and 171-55, HRS, relating to Public Purposes and Permits, respectively, and therefore, the DOT proposes to issue a month-to-month revocable permit to HPA, Area/Space No. 006-107, for land used for the storage of an office trailer at KOA.

RECOMMENDATION:

That the Board authorize the Department of Transportation to issue a month-to-month revocable permit to HPA, subject to: (1) terms and conditions herein outlined, which are by reference incorporated herein; and (2) such additional terms and conditions as may be prescribed by the Director of Transportation to best serve the interests of the State.

Respectfully submitted,



FORD N. FUCHIGAMI  
Interim Director of Transportation

APPROVED FOR SUBMITTAL:



WILLIAM J. AILA, JR.  
Chairperson and Member

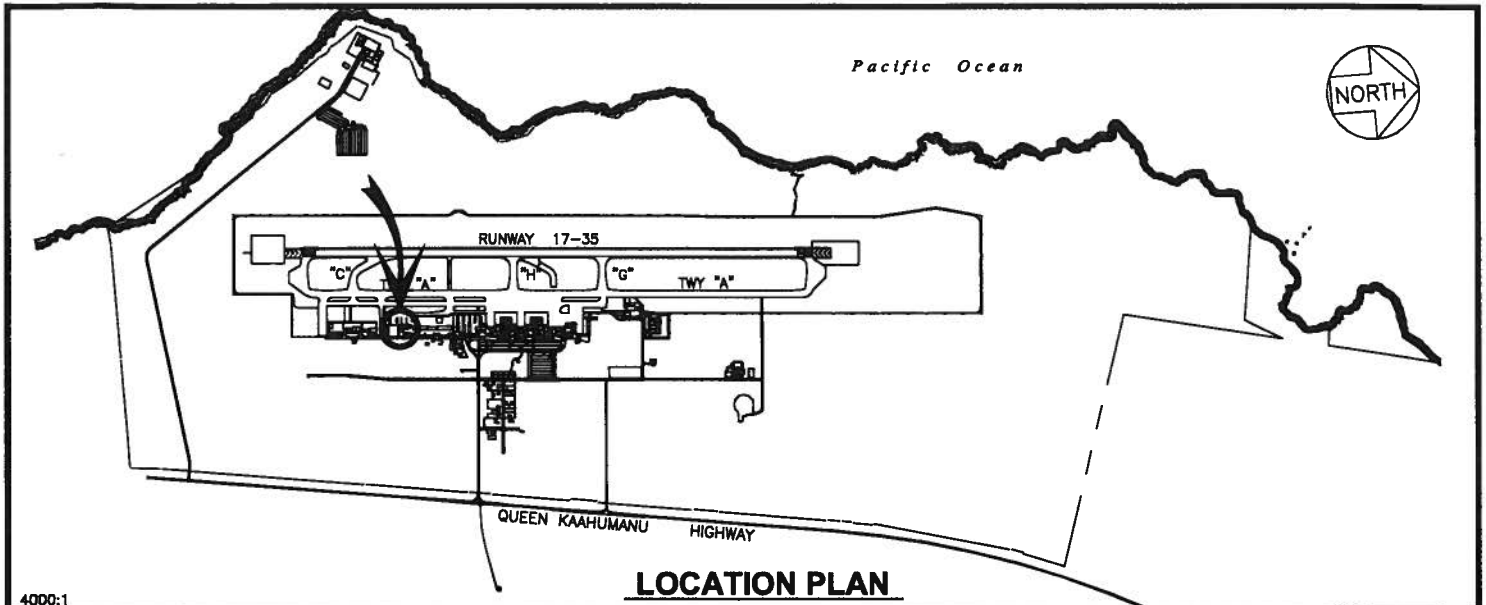

4000:1

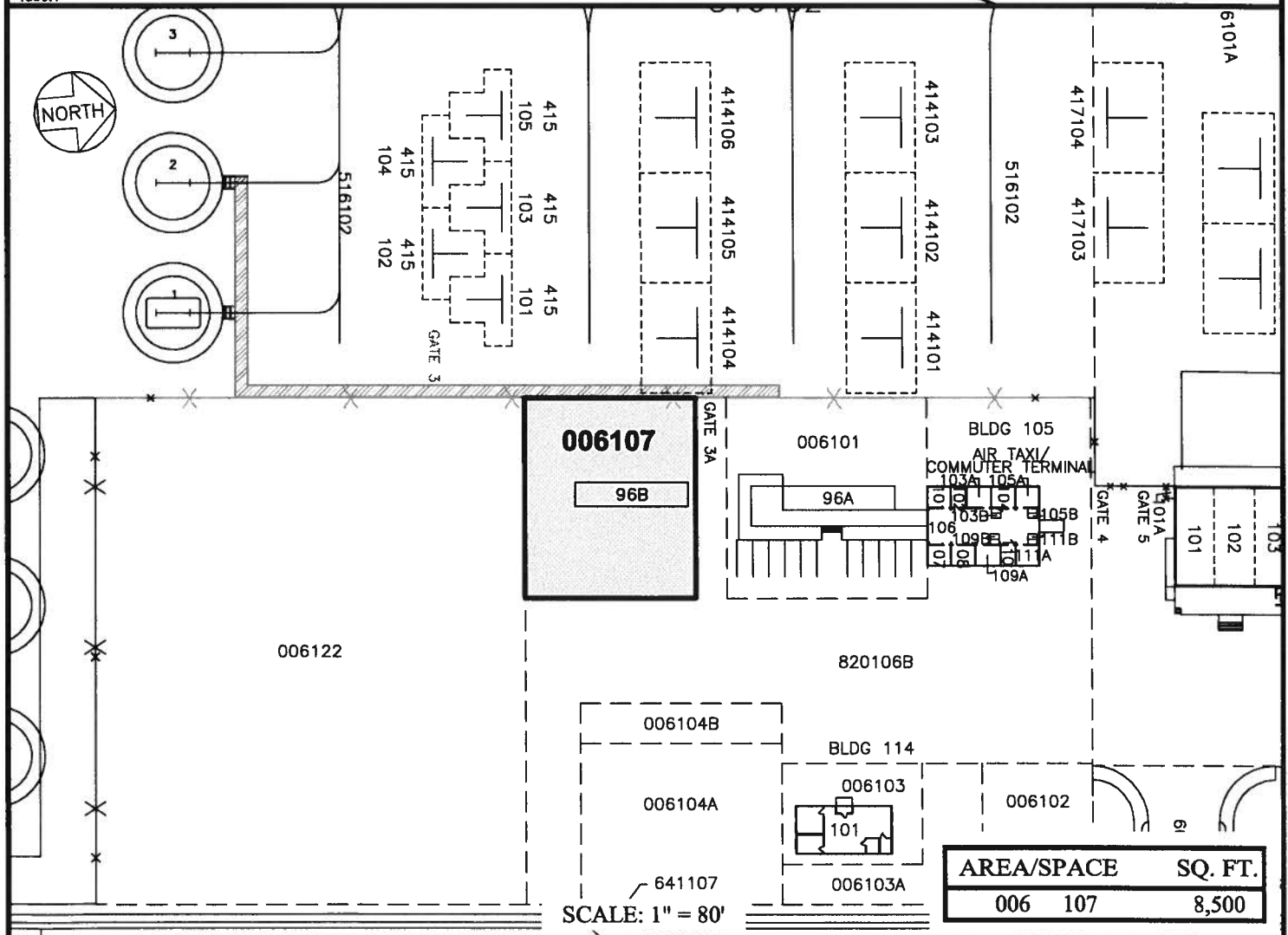

RP-8230

DATE : AUGUST 2014

EXHIBIT: A



Airports Division

HAWAII PACIFIC AVIATION INC.

LOT

006107  
PLATS B1, 39

**KONA INTERNATIONAL AIRPORT AT KEAHOLE**