

NEIL ABERCROMBIE
GOVERNOR



STATE OF HAWAII
DEPARTMENT OF TRANSPORTATION
869 PUNCHBOWL STREET
HONOLULU, HAWAII 96813-5097

FORD N. FUCHIGAMI
INTERIM DIRECTOR

Deputy Directors
RANDY GRUNE
AUDREY HIDANO
ROSS M. HIGASHI
JADINE URASAKI

IN REPLY REFER TO:

Board of Land and
Natural Resources
State of Hawaii
Honolulu, Hawaii

ISSUANCE OF A REVOCABLE PERMIT FOR THREE PODIUM SPACES
ALASKA AIRLINES, INC., LIHUE AIRPORT
TAX MAP KEY: (4) 3-5-01: PORTION OF 8

KAUAI

APPLICANT:

Alaska Airlines, Inc. (AAD), whose business address is P.O. Box 68900, Seattle,
Washington 98168-0900

LEGAL REFERENCE:

Subsection 171-11 & 171-55, Hawaii Revised Statutes

LOCATION AND TAX MAP KEY:

Portion of Lihue Airport (LIH), Lihue, Island of Kauai, identified by
Tax Map Key: 4th Division, 3-5-01: Portion of 8

AREA:

Building/Room Nos. 306-201B, -201C, and -217C, containing an area of approximately
12, 9, & 12 square feet, respectively, as shown and delineated on the attached maps
labeled Exhibits "A" and "B"

ZONING:

State Land Use: Urban
County: Industrial (IG-STP)

LAND TITLE STATUS:

Section 5(a), Hawaii Admissions Act: Non-ceded
DHHL, 30% entitlement lands Yes _____ No X

ITEM M-15

**BLNR – ISSUANCE OF A REVOCABLE PERMIT FOR THREE PODIUM SPACES
ALASKA AIRLINES, INC.**

Page 2

CURRENT USE STATUS:

Airport purposes

CHARACTER OF USE:

Three podium spaces located in holdrooms of Main Terminal

COMMENCEMENT DATE:

Upon complete execution of the revocable permit

MONTHLY RENTAL:

\$146.43

SECURITY DEPOSIT:

\$439.28

HOLDOVER TENANCY:

\$4.88

CHAPTER 343, HRS – ENVIRONMENTAL ASSESSMENT:

Pursuant to Section 11-200-8(a), Environmental Impact Statement Rules of the Department of Health, State of Hawaii, this disposition is exempt from requirements regarding preparation of an environmental assessment, negative declaration, or environmental impact statement as required by Chapter 343, Hawaii Revised Statutes, as amended, relating to Environmental Impact Statements, because the proposed action falls within Exemption Class #1, Comprehensive Exemption List for the State of Hawaii, Department of Transportation, dated November 15, 2000, as approved by the Environmental Quality Council. Exemption Class #1 covers operations, repairs, or maintenance of existing structures, facilities, equipment, or topographical features involving negligible or no expansion or change of use beyond that previously existing.

DCCA VERIFICATION:

Place of business registration confirmed:	YES <u>X</u>	NO _____
Registered business name confirmed:	YES <u>X</u>	NO _____
Good standing confirmed:	YES <u>X</u>	NO _____

BLNR – ISSUANCE OF A REVOCABLE PERMIT FOR THREE PODIUM SPACES
ALASKA AIRLINES, INC.

Page 3

REMARKS:

The Department of Transportation (DOT) has no objections to AAI's request and therefore, in accordance with Sections 171-11 and 171-55, HRS, relating to Public Purposes and Permits, respectively, and therefore, the DOT proposes to issue a month-to-month revocable permit to AAI, Bldg/Room Nos. 306-201B, -201C and -217C for three podium spaces at LIH.

RECOMMENDATION:

That the Board authorize the DOT to issue a month-to-month revocable permit to AAI, subject to: (1) terms and conditions herein outlined, which are by reference incorporated herein; and (2) such additional terms and conditions as may be prescribed by the Director of Transportation to best serve the interests of the State.

Respectfully submitted,



FORD N. FUCHIGAMI
Interim Director of Transportation

APPROVED FOR SUBMITTAL:

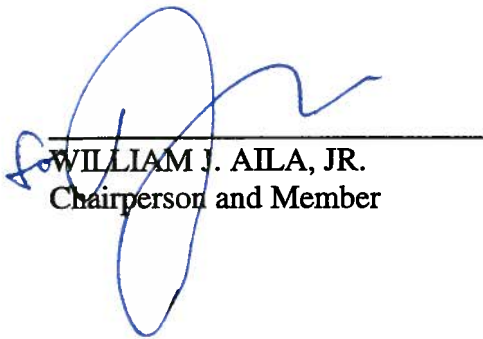

WILLIAM J. AILA, JR.
Chairperson and Member

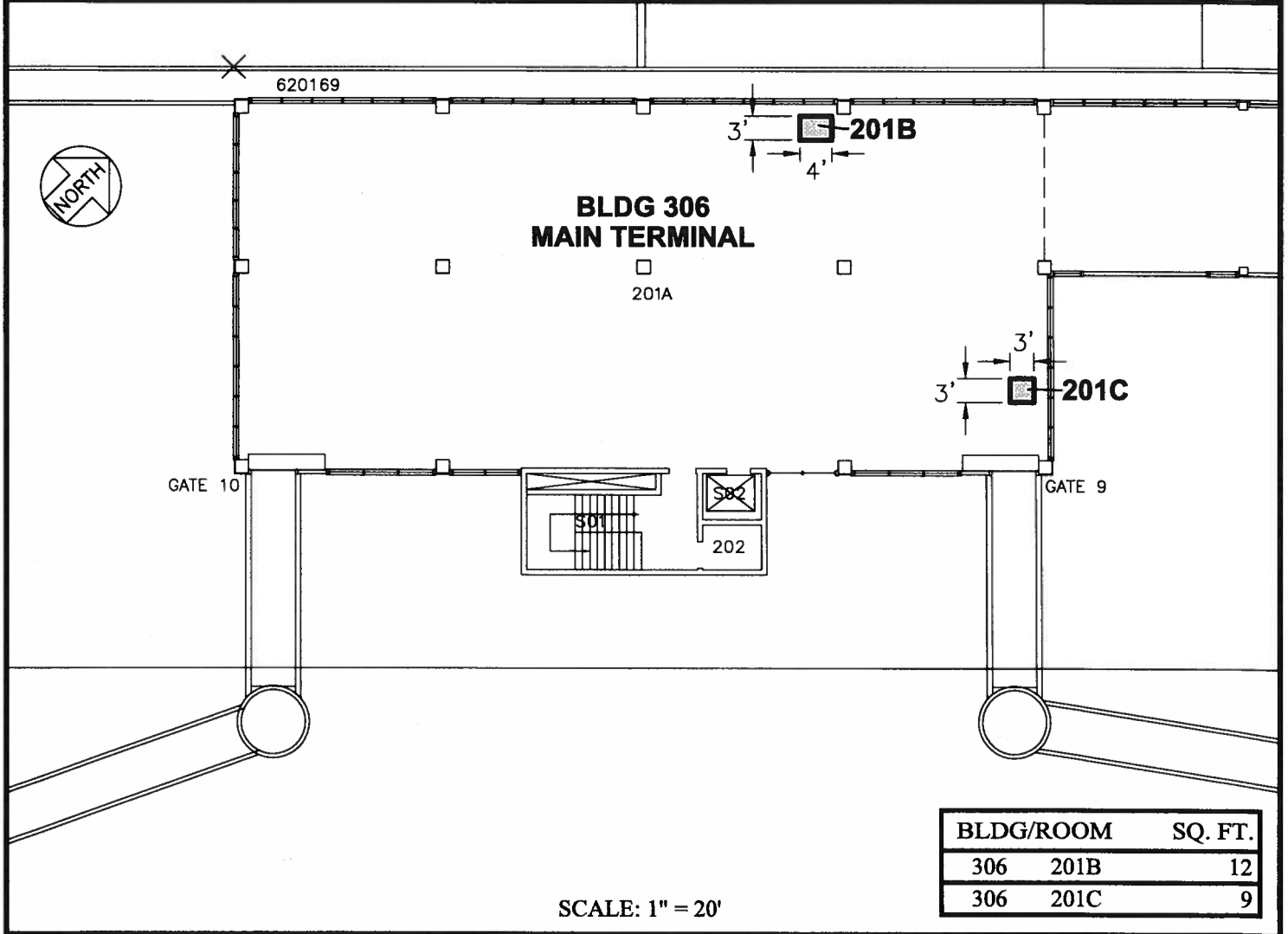
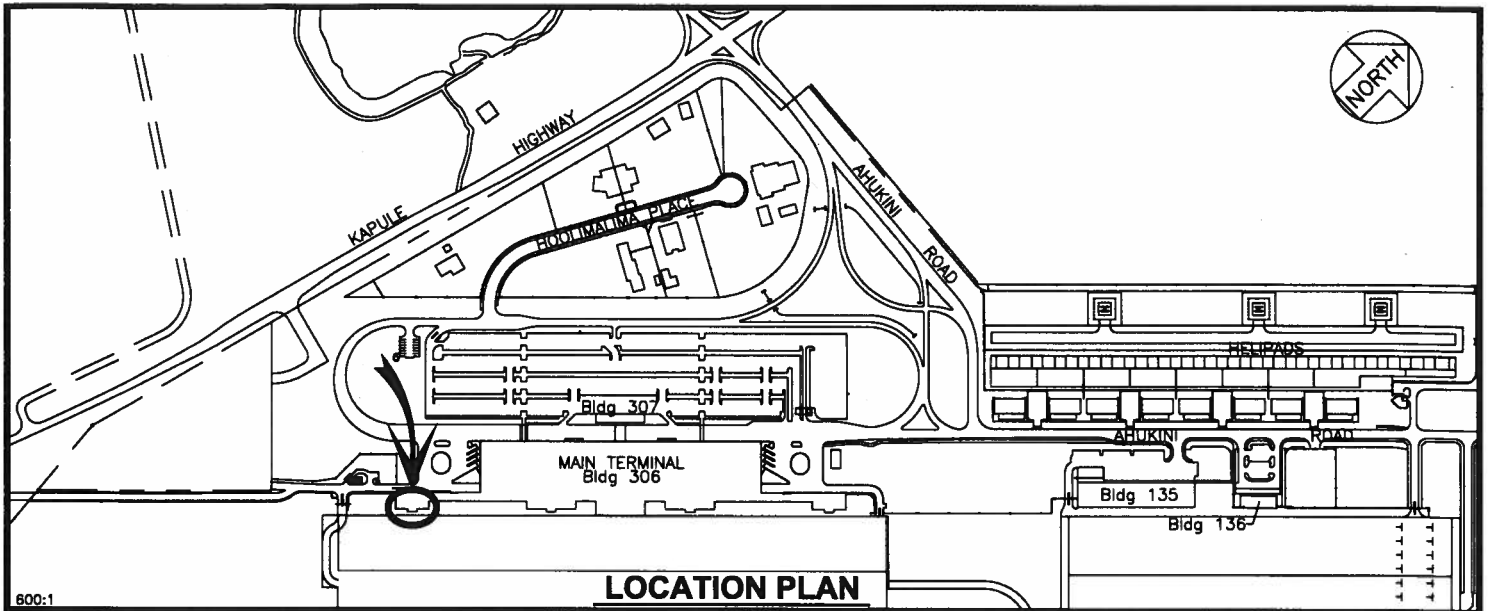

RP-8220

DATE : AUGUST 2014

EXHIBIT: **A**



Airports Division

ALASKA AIRLINES, INC.

BUILDING 306
MAIN TERMINAL
TERMINAL LEVEL

306201B
306201C

PLATS C2, 44

LIHUE AIRPORT

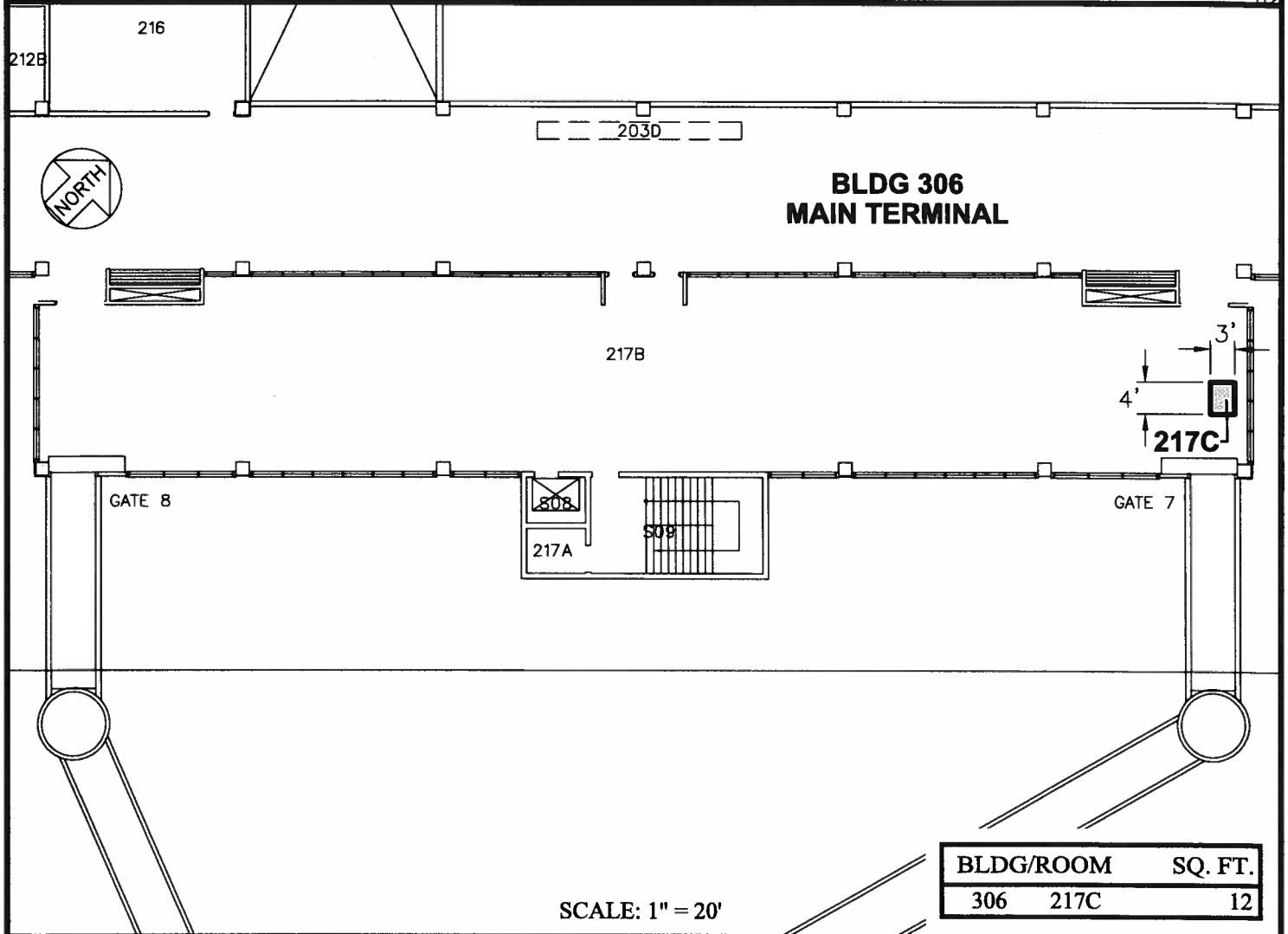
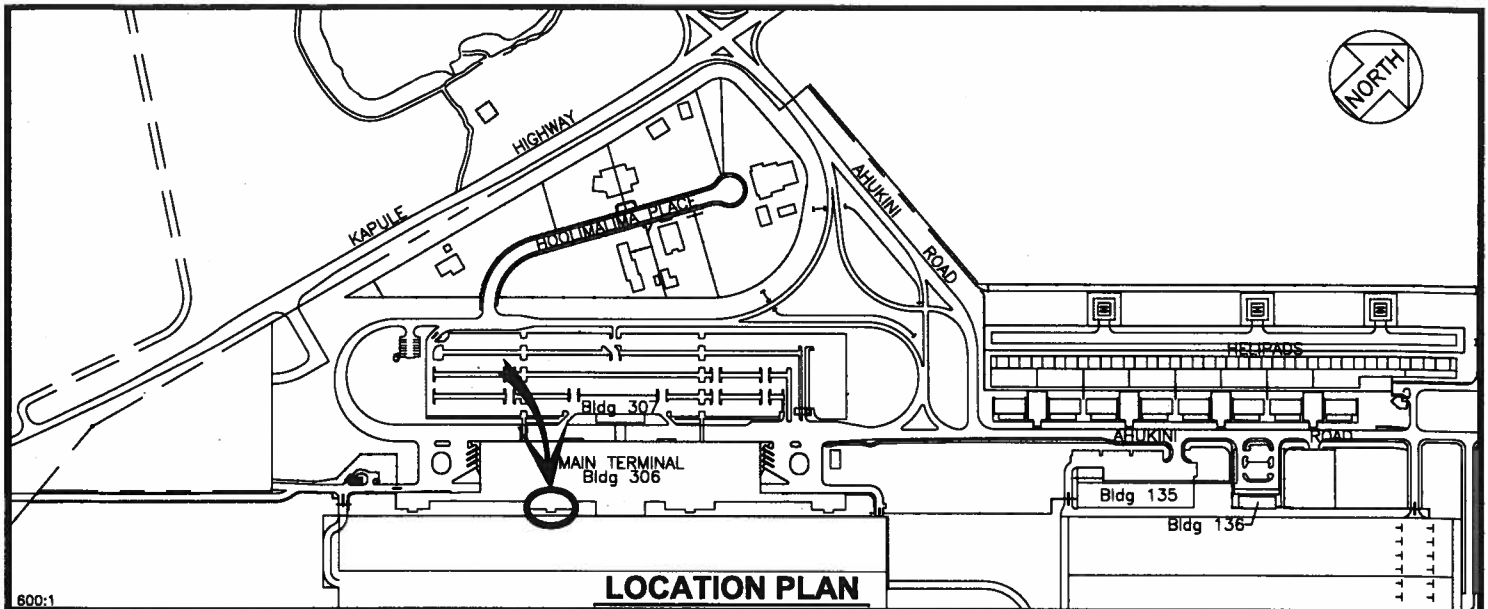

SCALE: 1" = 20'

BLDG/ROOM	SQ. FT.
306 217C	12

RP-8220

DATE : AUGUST 2014

EXHIBIT: **B**



Airports Division

ALASKA AIRLINES, INC.

BUILDING 306
MAIN TERMINAL
TERMINAL LEVEL

306217C

PLATS C2, 45

LIHUE AIRPORT