

NEIL ABERCROMBIE  
GOVERNOR



STATE OF HAWAII  
DEPARTMENT OF TRANSPORTATION  
869 PUNCHBOWL STREET  
HONOLULU, HAWAII 96813-5097

FORD N. FUCHIGAMI  
INTERIM DIRECTOR

Deputy Directors  
RANDY GRUNE  
AUDREY HIDANO  
ROSS M. HIGASHI  
JADINE URASAKI

IN REPLY REFER TO:

Board of Land and  
Natural Resources  
State of Hawaii  
Honolulu, Hawaii

ISSUANCE OF A REVOCABLE PERMIT FOR THE INSTALLATION  
AND MAINTENANCE OF RADIO EQUIPMENT TO SUPPORT THE  
OPERATION OF THE USFAA AIR TRAFFIC CONTROL TOWER  
EXELIS, INC.  
HILO INTERNATIONAL AIRPORT  
TAX MAP KEY: (3) 2-1-12: PORTION OF 90

HAWAII

REQUEST:

Issuance of a Revocable Permit to Exelis, Inc. at Hilo International Airport (ITO) to install and maintain radio equipment to support the operation of the USFAA Air Traffic Control Tower

LEGAL REFERENCE:

Subsection 171-11 and 171-55, Hawaii Revised Statutes

APPLICANT:

Exelis, Inc. (Exelis) whose business address is 12930 Worldgate Drive, Herndon, Virginia, 20170

AREA:

Bldg/Room Nos. 302-112 and 302 -113, containing an area of approximately 27 and 80 square feet, respectively, as shown on the attached map labeled Exhibit "A"

LOCATION AND TAX MAP KEY:

Portion of Hilo International Airport, Hilo, Island of Hawaii, identified by Tax Map Key: 3<sup>rd</sup> division, 2-1-12: Portion of 90

**ITEM M-9**

BLNR – ISSUANCE OF A REVOCABLE PERMIT  
EXELIS, INC.  
Page 2

ZONING:

State Land Use District: Urban  
County of Hawaii: Industrial (ML-20)

LAND TITLE STATUS:

Section 5(a) lands (“ceded” lands) of the Hawaii Admission Act  
DHHL 30% entitlement lands pursuant to the Hawaii State Constitution: YES \_\_ NO X

CURRENT USE STATUS:

Airport and aeronautical purposes

CHARACTER OF USE:

Land areas for the installation and maintenance of radio equipment

COMMENCEMENT DATE:

Upon complete execution of the revocable permit

MONTHLY RENTAL:

\$25.00

SECURITY DEPOSIT:

\$75.00

HOLDOVER TENANCY:

\$0.83

DCCA VERIFICATION:

Place of business registration confirmed:	YES <u>X</u>	NO ___
Registered business name confirmed:	YES <u>X</u>	NO ___
Good standing confirmed:	YES <u>X</u>	NO ___

CHAPTER 343, HRS - ENVIRONMENTAL ASSESSMENT:

Pursuant to Section 11-200-8(a), Environmental Impact Statement Rules of the Department of Health, State of Hawaii, this disposition is exempt from requirements regarding preparation of an environmental assessment, negative declaration, or environmental impact statement as required by Chapter 343, Hawaii Revised Statutes, as amended, relating to Environmental Impact Statements, because the proposed action falls within Exemption Class #1, Comprehensive Exemption List for the State of Hawaii, Department of Transportation, dated November 15, 2000, as approved by the Environmental Quality Council. Exemption Class #1 covers operations, repairs, or maintenance of existing structures, facilities, equipment, or topographical features involving negligible or no expansion or change of use beyond that previously existing.

REMARKS:

The DOT has no objections to the issuance of a revocable permit to Exelis in accordance with Section 171-11 and 171-55, HRS, relating to Public Purposes and Permits, respectively and therefore, the DOT proposes to issue a month-to-month revocable permit to Exelis, Bldg/Room Nos. 302-112 and 302-113, for its use of land areas to install and maintain radio equipment.

RECOMMENDATION:

That the Board authorize the Department of Transportation to issue a month-to-month revocable permit to GFI, subject to: (1) terms and conditions herein outlined, which are by reference incorporated herein; and (2) such additional terms and conditions as may be prescribed by the Director of Transportation to best serve the interests of the State.

Respectfully submitted,

  
FORD N. FUCHIGAMI  
Interim Director of Transportation

APPROVED FOR SUBMITTAL:

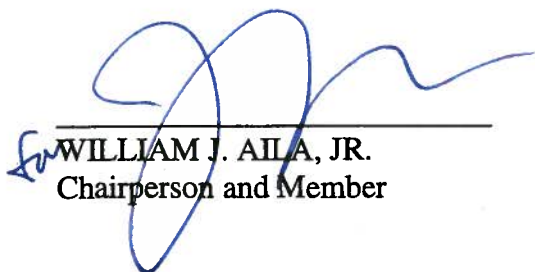
  
WILLIAM J. AILA, JR.  
Chairperson and Member

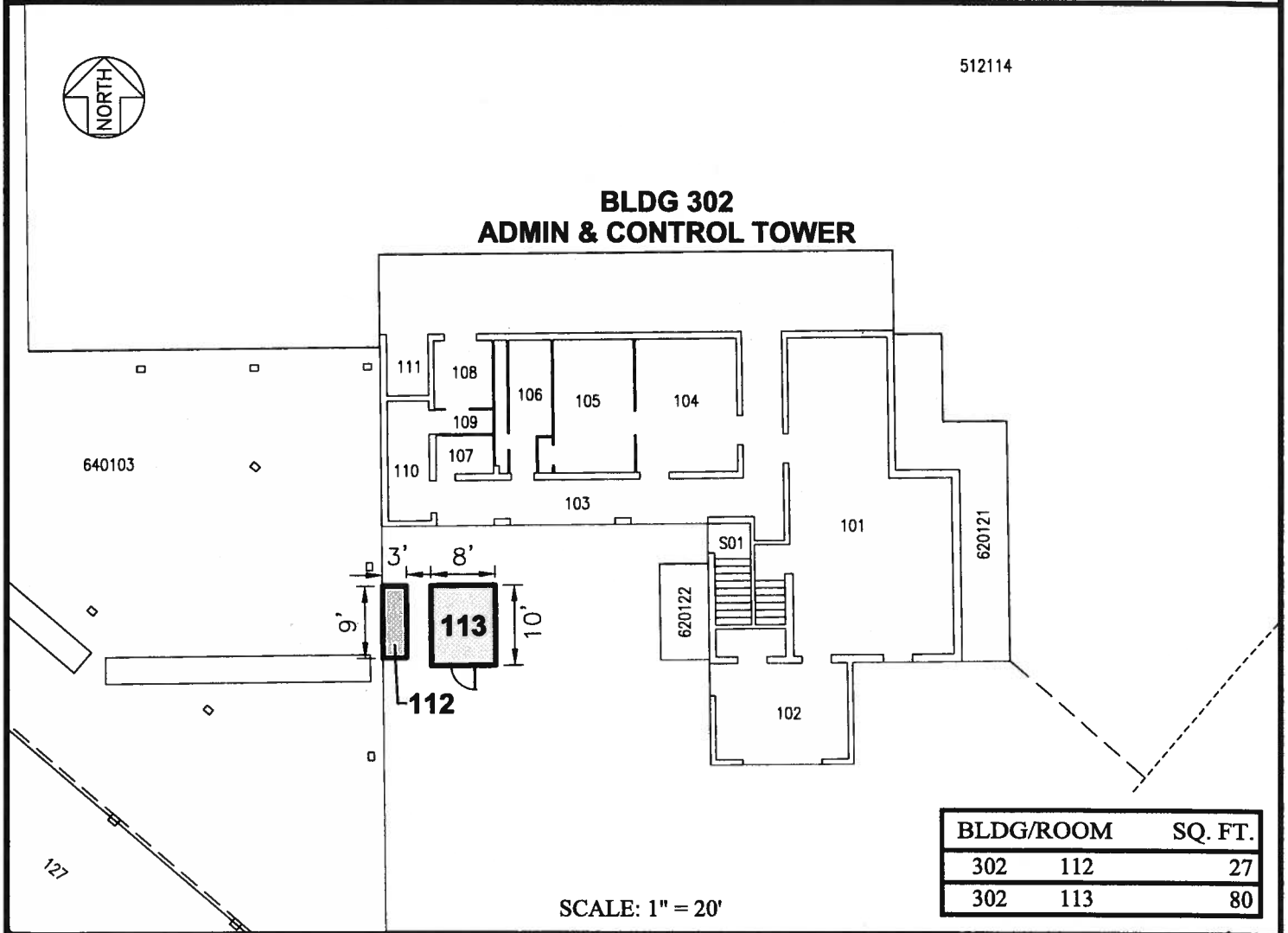
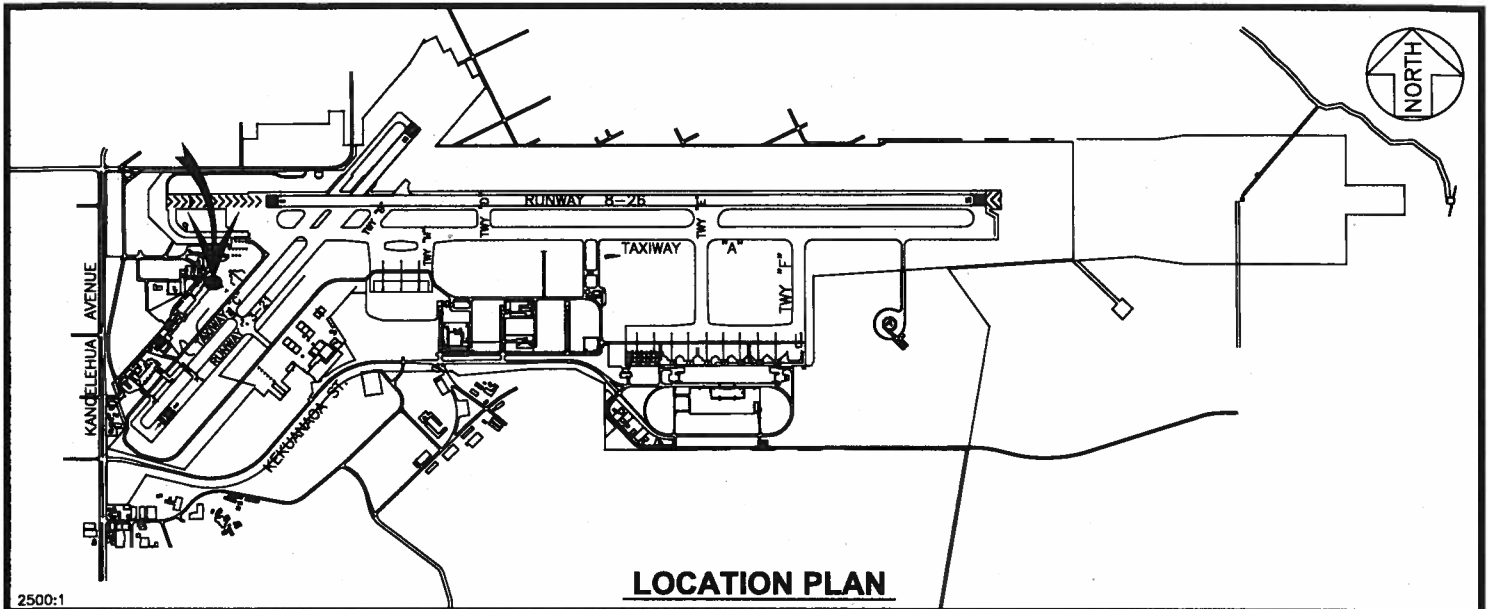

RP-8229

DATE : AUGUST 2014

EXHIBIT: **A**



Airports Division

EXELIS INC.

**BUILDING 302  
ADMIN & CONTROL TOWER  
GROUND LEVEL**

302112  
302113

PLATS A1, 30

**HILO INTERNATIONAL AIRPORT**