



**STATE OF HAWAII  
DEPARTMENT OF TRANSPORTATION  
869 PUNCHBOWL STREET  
HONOLULU, HAWAII 96813-5097**

IN REPLY REFER TO:

Board of Land and  
Natural Resources  
State of Hawaii  
Honolulu, Hawaii

**ISSUANCE OF A REVOCABLE PERMIT FOR A LEI STAND TO  
LANA HAASENRITTER DBA AH LAN'S LEI STAND  
HILO INTERNATIONAL AIRPORT  
TAX MAP KEY: (3) 2-1-12: PORTION OF 9**

**HAWAII**

**PURPOSE:**

Issuance of a revocable permit to Lana Haasenritter dba Ah Lan's Lei Stand at Hilo International Airport.

**LEGAL REFERENCE:**

Chapters 102, Hawaii Revised Statutes, as amended.

**APPLICANT:**

Lana Haasenritter dba Ah Lan's Lei Stand whose postal address is 263 Lama Street, Hilo, Hawaii 96720.

**LOCATION AND TAX MAP KEY:**

Hilo International Airport, Island of Hawaii  
Tax Map Key: (3) 2-1-12: Portion of 9

**PREMISES:**

Space No. 307-127, containing an area of approximately 200 square feet, as shown on the attached Exhibit A dated November 2014.

**ZONING:**

State Land Use District:	Urban
County of Hawaii:	Airport

LAND TITLE STATUS:

Section 5(b) Hawaii Admissions Act: Ceded  
DHHL 30% entitlement lands: No

CURRENT USE STATUS:

Lei and flower stand

CHARACTER OF USE:

Lei and flower stand

COMMENCEMENT DATE:

Upon complete execution of the revocable permit

MONTHLY RENTAL:

The greater of \$30.00 minimum monthly or five (5) percent up to \$1,000.00 or ten (10) percent over \$1,000.00 of the monthly gross receipts

SECURITY DEPOSIT:

\$ 90.00

IMPROVEMENTS:

Lana Haasenritter dba Ah Lan’s Lei Stand will maintain and cover all costs of improvements to the above premises.

DCCA VERIFICATION:

Place of business registration confirmed:	YES	<u>X</u>	NO	<u>      </u>
Registered business name confirmed:	YES	<u>X</u>	NO	<u>      </u>
Good standing confirmed:	YES	<u>X</u>	NO	<u>      </u>

CHAPTER 343, HRS - ENVIRONMENTAL ASSESSMENT:

Pursuant to Section 11-200-8(a), Hawaii Administrative Rules, this disposition is exempt from requirements regarding preparation of an environmental assessment, negative declaration, or environmental impact statement as required by Chapter 343, Hawaii Revised Statutes, as amended, relating to Environmental Impact Statements because the proposed action falls within Exemption Class #1, Comprehensive Exemption List for the

BLNR – Issuance of Revocable Permit for a Lei Stand  
Lana Haasenritter dba Ah Lan’s Lei Stand  
Page 3

State of Hawaii, Department of Transportation, amended November 15, 2000, as approved by the Environmental Quality Council (Docket 92-EX-01). Exemption Class #1 covers operations, repairs, or maintenance of existing structures, facilities, equipment, or topographical features involving negligible or no expansion or change of use beyond that previously existing.

**REMARKS:**

In accordance with Sections 102-2 (Contracts for concession; bid required, exception) and 171-55 (Permits), the Department of Transportation (DOT) proposes to issue month-to-month revocable permit to Lana Haasenritter dba Ah Lan’s Lei Stand for its lei stand operation at Hilo International Airport.

**RECOMMENDATION:**

The Board authorize: 1) the Department of Transportation to issue new month to month revocable permit for the aforementioned premises, which exhibit is by reference incorporated herein; and 2) such other terms and conditions as may be prescribed by the Director of Transportation to best serve the interests of the State.

Respectfully submitted,



FORD N. FUCHIGAMI  
Interim Director of Transportation

APPROVED FOR SUBMITTAL:



---

WILLIAM J. AILA, JR.  
Chairperson and Member

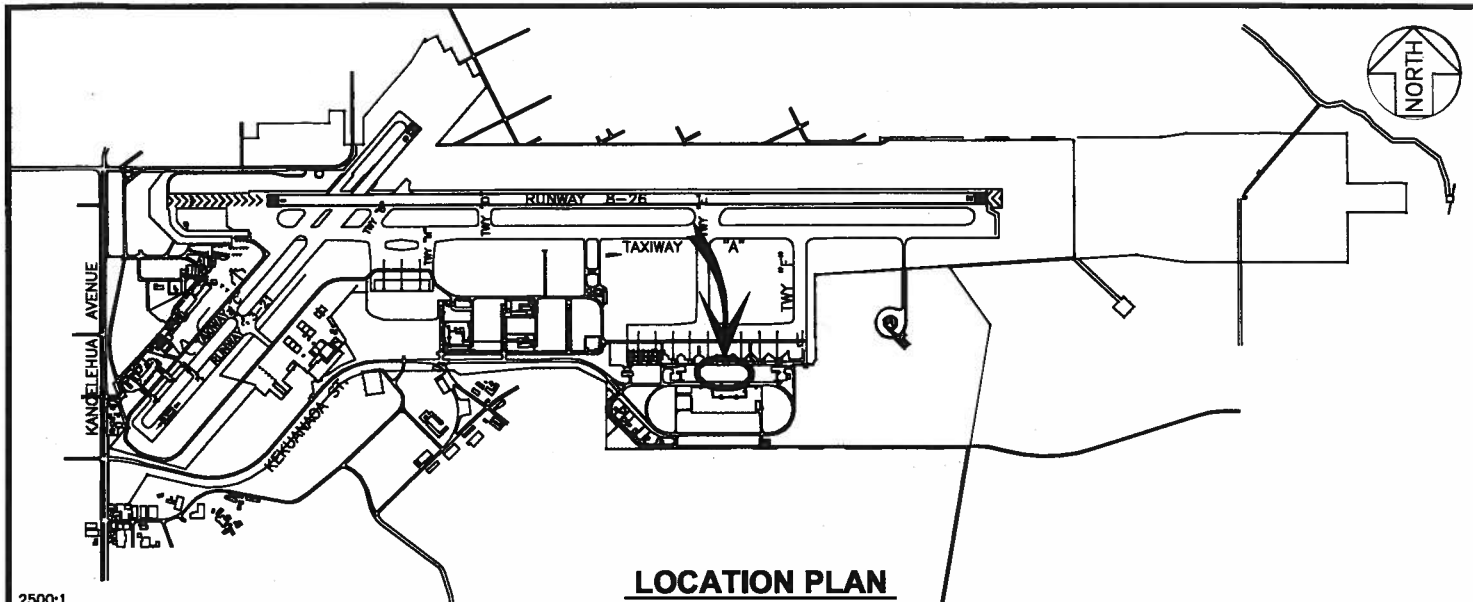

**DEPARTURE TERMINAL  
BLDG 307**

145A

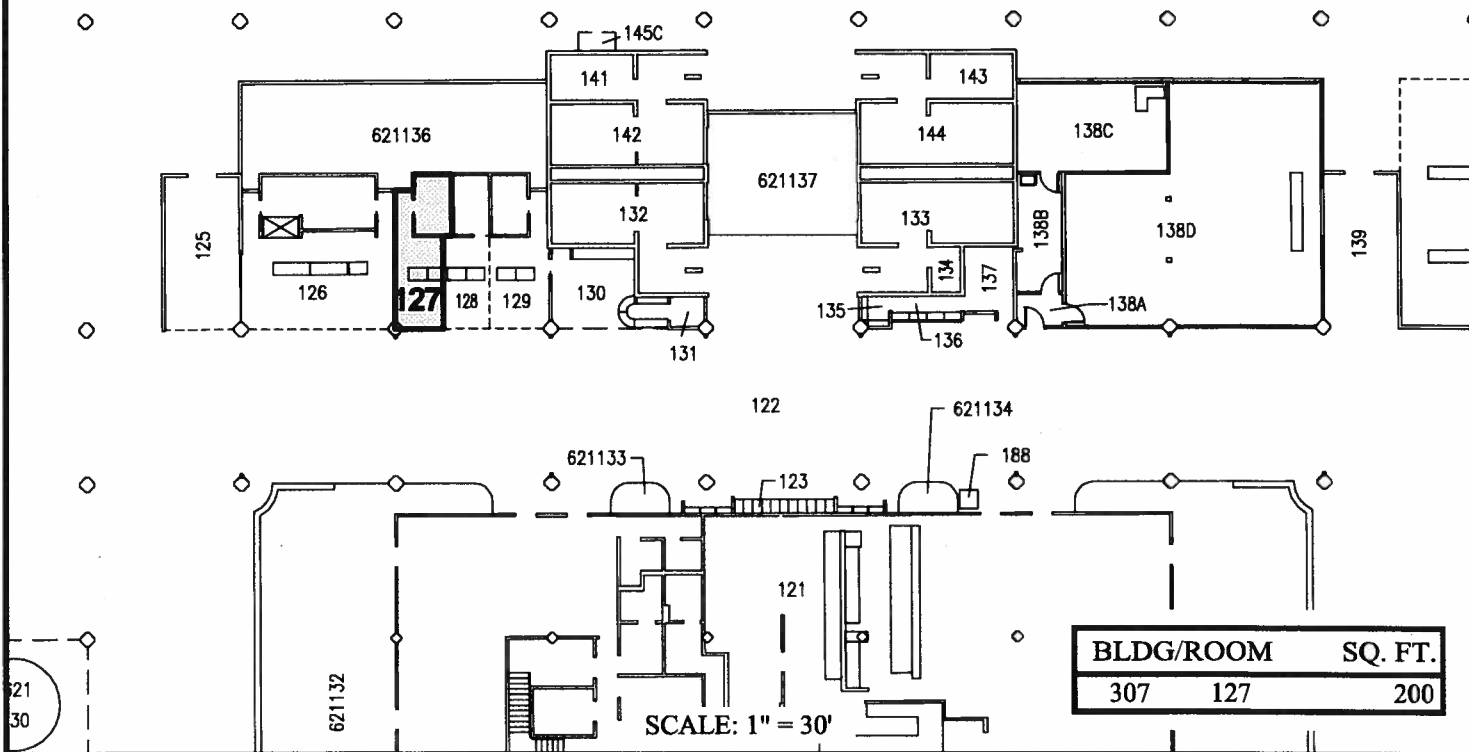

RP-8253

DATE : NOVEMBER 2014

EXHIBIT: **A**



**HAASENRITTER, LANA**

**BUILDING 307  
DEPARTURE TERMINAL  
GROUND LEVEL**

**307127  
PLATS C1, 42**