

DAVID Y. IGE
GOVERNOR



FORD N. FUCHIGAMI
DIRECTOR

Deputy Directors
JADE T. BUTAY
ROSS M. HIGASHI
EDWIN H. SNIFFEN

STATE OF HAWAII
DEPARTMENT OF TRANSPORTATION
869 PUNCHBOWL STREET
HONOLULU, HAWAII 96813-5097

IN REPLY REFER TO:

Board of Land and
Natural Resources
State of Hawaii
Honolulu, Hawaii

ISSUANCE OF A REVOCABLE PERMIT
FOR MATERIAL STORAGE AND STOCKPILING
HAWAIIAN DREDGING CONSTRUCTION COMPANY, INC.
EWA INTERISLAND MAINTENANCE AREA
HONOLULU INTERNATIONAL AIRPORT
TAX MAP KEY: (1) 1-1-003: 001 (PORTION)

OAHU

LEGAL REFERENCE:

Section 171-55, Hawaii Revised Statutes

APPLICANT:

Hawaiian Dredging Construction Company, Inc. (HDC), whose business address is
P.O. Box 4088, Honolulu, Hawaii 96812-4088.

LOCATION:

Ewa Interisland Maintenance Area, Ground Level, Space Nos. 004-153, 004-154 and
004-155 at Honolulu International Airport, Tax Map Key: 1st Division, 1-1-003: 001
(Portion)

AREA:

Space No. 004-153, containing an area of approximately 57,400 square feet,
Space No. 004-154, containing an area of approximately 5,640 square feet, and
Space No. 004-155, containing an area of approximately 40,000 square feet, as shown
and delineated on the attached map labeled Exhibit "A".

ITEM M-1

ZONING:

State Land Use District: Urban
City and County of Honolulu LUO: Industrial (I-2)

LAND TITLE STATUS:

Non-ceded.
DHHL 30% entitlement lands pursuant to Hawaii Admission Act YES ___ NO X

CURRENT USE STATUS:

Land presently encumbered by Governor’s Executive Order No. 3529, setting aside a portion of Honolulu International Airport under the control and management of the Department of Transportation, Airports Division, State of Hawaii, for Airport Purposes.

CHARACTER OF USE:

HDC will use the space for a construction field office, at no charge, as specifically stated in State Project No. AO1121-24, HNL NDWP Widen Taxiways G & L, Phase I, at Honolulu International Airport.

COMMENCEMENT DATE:

To be determined by the Director of Transportation at a later date.

MONTHLY RENTAL:

Not applicable (NA)

SECURITY DEPOSIT:

NA

HOLDOVER TENANCY:

NA

DCCA VERIFICATION:

Place of business registration confirmed: YES X NO ___
Registered business name confirmed: YES X NO ___
Good standing confirmed: YES X NO ___

CHAPTER 343, HRS - ENVIRONMENTAL ASSESSMENT:

Pursuant to Section 11-200-8(a), Environmental Impact Statement Rules of the Department of Health, State of Hawaii, this disposition is exempt from requirements regarding preparation of an environmental assessment, negative declaration, or environmental impact statement as required by Chapter 343, Hawaii Revised Statutes, as amended, relating to Environmental Impact Statements, because the proposed action falls within Exemption Class #1, Comprehensive Exemption List for the State of Hawaii, Department of Transportation, dated November 15, 2000, as approved by the Environmental Quality Council. Exemption Class #1 covers operations, repairs, or maintenance of existing structures, facilities, equipment, or topographical features involving negligible or no expansion or change of use beyond that previously existing.

REMARKS:

As stated within State Project No. AO1121-24, HNL NDWP Widen Taxilanes G & L, Phase I, at Honolulu International Airport, Item 1.04 Provisions for Field Office/Storage Space: “Pending the availability of space on airport property, the State will issue a permit to the Contractor for the use of the space, at no charge, to be used specifically for a field office and/or storage of materials and equipment...”

RECOMMENDATION:

That the Board authorize the Department of Transportation to issue a month-to-month revocable permit to Hawaiian Dredging Construction Company, Inc., subject to: (1) terms and conditions herein outlined, which are by reference incorporated herein; and (2) such additional terms and conditions as may be prescribed by the Director of Transportation to best serve the interests of the State.

Respectfully submitted,

FORD N. FUCHIGAMI
Director of Transportation

APPROVED FOR SUBMITTAL:

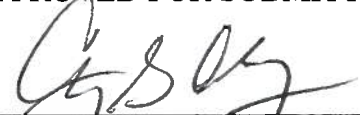
CARTY S. CHANG
Acting Chairperson and Member

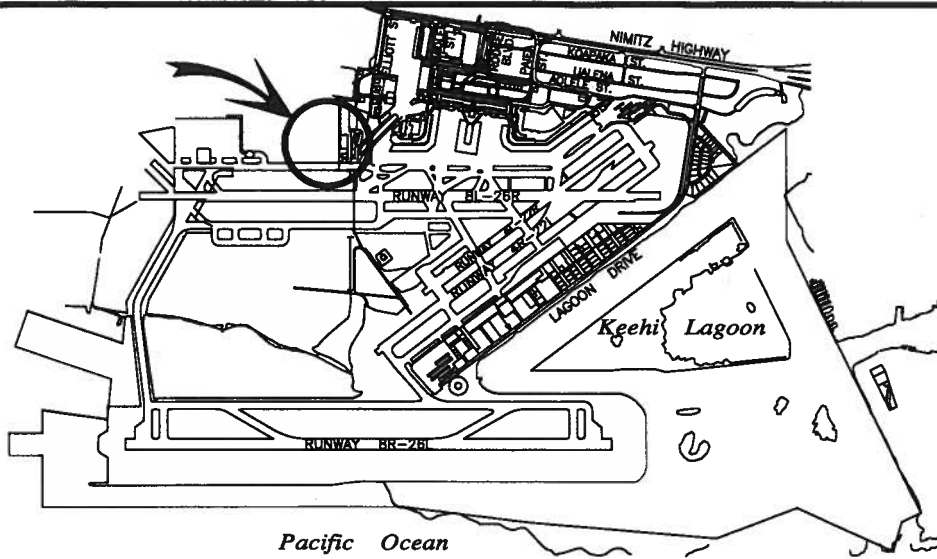

LOCATION PLAN

5000:1

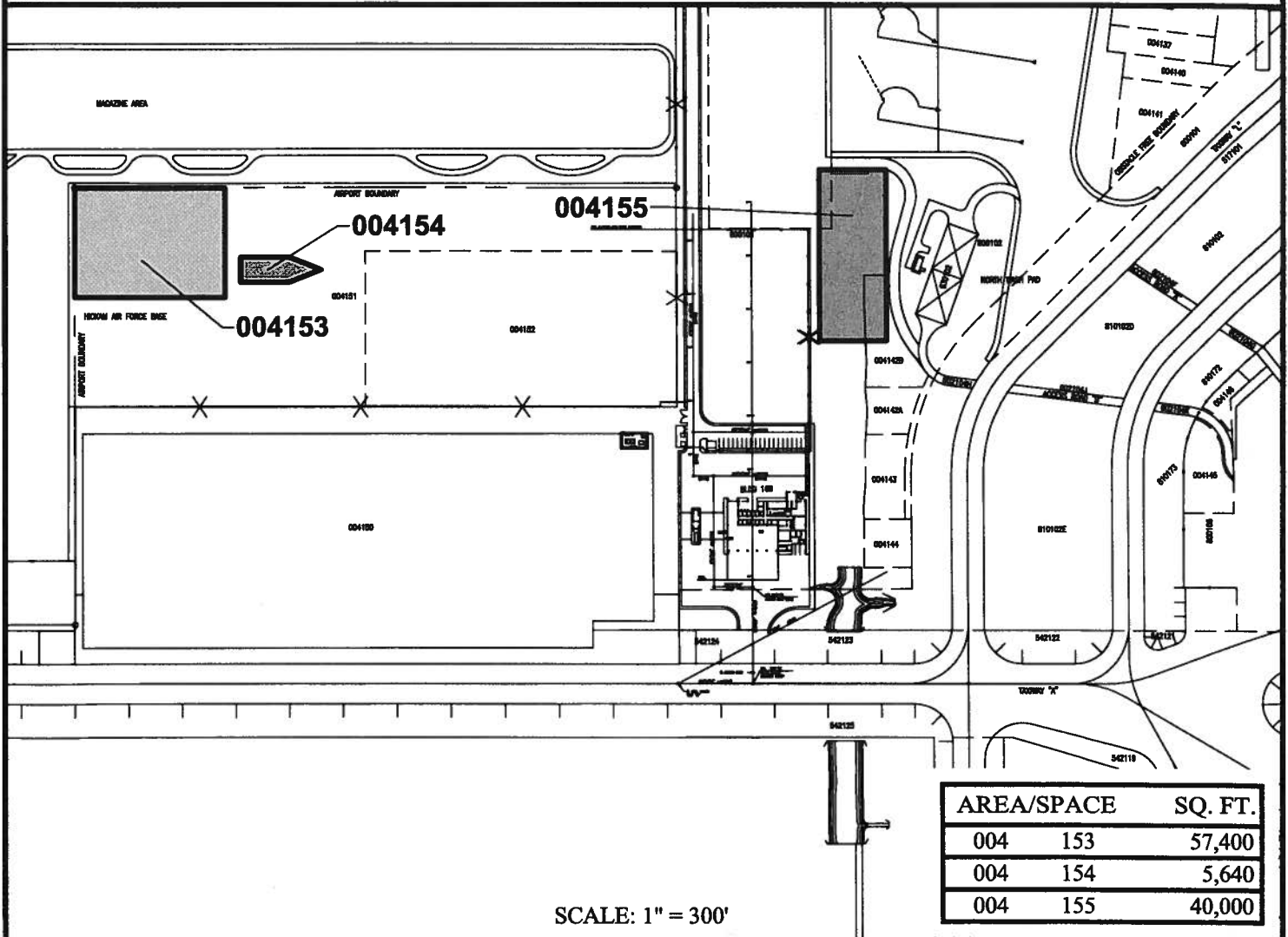

AREA/SPACE	SQ. FT.
004 153	57,400
004 154	5,640
004 155	40,000

SCALE: 1" = 300'

RP-8271

DATE : JANUARY 2015

EXHIBIT: **A**



Airports Division

HAWAIIAN DREDGING
 CONSTRUCTION
 COMPANY, INC.

INTER-ISLAND
 MAINTENANCE AREA

004153
 004154
 004155
 PLAT 24

HONOLULU INTERNATIONAL AIRPORT