

DAVID Y. IGE
GOVERNOR



STATE OF HAWAII
DEPARTMENT OF TRANSPORTATION
869 PUNCHBOWL STREET
HONOLULU, HAWAII 96813-5097

FORD N. FUCHIGAMI
DIRECTOR

Deputy Directors
JADE T. BUTAY
EDWIN H. SNIFFEN
ROSS M. HIGASHI

IN REPLY REFER TO:

Board of Land and
Natural Resources
State of Hawaii
Honolulu, Hawaii

ISSUANCE OF A REVOCABLE PERMIT FOR OFFICE SPACE
HAWAIIAN AIRLINES INC.
MOLOKAI AIRPORT
TAX MAP KEY: (2) 5-2-04: PORTION OF 8

MOLOKAI

LEGAL REFERENCE:

Subsection 171-11 and 171-55, Hawaii Revised Statutes

APPLICANT:

Hawaiian Airlines Inc. (HAL) whose business address is P.O. Box 30008,
Honolulu, Hawaii 96819

LOCATION AND TAX MAP KEY:

Portion of Molokai Airport (MKK), Hoolehua, Island of Molokai, identified by
Tax Map Key: 2nd Division, 5-2-04: Portion of 8

AREA:

Building/Room No. 301-116, containing an area of approximately 142 square feet
shown and delineated on the attached map labeled Exhibit "A"

ZONING:

State Land Use: Agricultural
County: Interim Zoning Provisions of the Maui County Zoning Code

LAND TITLE STATUS:

Section 5(b), Hawaii Admissions Act - Ceded
DHHL, 30% entitlement lands Yes No

ITEM M-10

CURRENT USE STATUS:

Airport purposes

CHARACTER OF USE:

Office space

COMMENCEMENT DATE:

Upon complete execution of the revocable permit

MONTHLY RENTAL:

\$247.08

SECURITY DEPOSIT:

\$741.24

HOLDOVER TENANCY:

\$8.24

DCCA VERIFICATION:

Place of business registration confirmed:	YES <input checked="" type="checkbox"/>	NO <input type="checkbox"/>
Registered business name confirmed:	YES <input checked="" type="checkbox"/>	NO <input type="checkbox"/>
Good standing confirmed:	YES <input checked="" type="checkbox"/>	NO <input type="checkbox"/>

CHAPTER 343, HRS - ENVIRONMENTAL ASSESSMENT:

Pursuant to Section 11-200-8(a), Environmental Impact Statement Rules of the Department of Health, State of Hawaii, this disposition is exempt from requirements regarding preparation of an environmental assessment, negative declaration, or environmental impact statement as required by Chapter 343, Hawaii Revised Statutes, as amended, relating to Environmental Impact Statements, because the proposed action falls within Exemption Class #1, Comprehensive Exemption List for the State of Hawaii, Department of Transportation, dated November 15, 2000, as approved by the Environmental Quality Council. Exemption Class #1 covers operations, repairs, or maintenance of existing structures, facilities, equipment, or topographical features involving negligible or no expansion or change of use beyond that previously existing.

BLNR- ISSUANCE OF A REVOCABLE PERMIT FOR OFFICE SPACE
HAWAIIAN AIRLINES INC.
Page 3

REMARKS:

The DOT has no objections to HAL's request and therefore, in accordance with Sections 171-11 and 171-55, HRS, relating to Public Purposes and Permits respectively, the DOT proposes to issue a month-to-month revocable permit to HAL, Building/Room No. 301-116 for office space at MKK

RECOMMENDATION:

That the Board authorizes the Department of Transportation to issue a revocable permit to HAL, subject to: (1) terms and conditions herein outlined, which are by reference incorporated herein; (2) such other terms and conditions as may be prescribed by the Director of Transportation to best serve the interests of the State

Respectfully submitted,

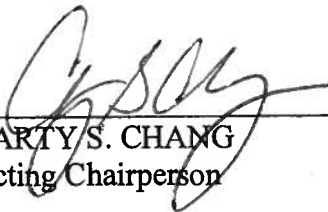

FORD N. FUCHIGAMI
Director of Transportation

APPROVED FOR SUBMITTAL:

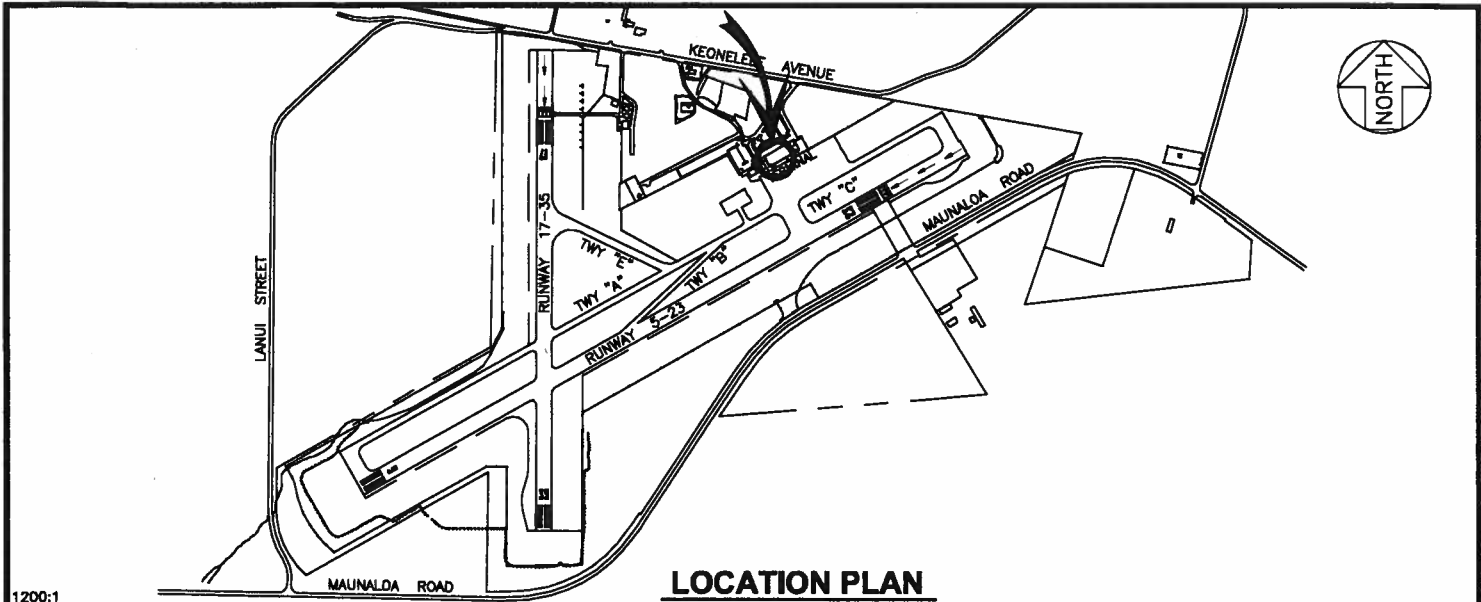
CARTY S. CHANG
Acting Chairperson

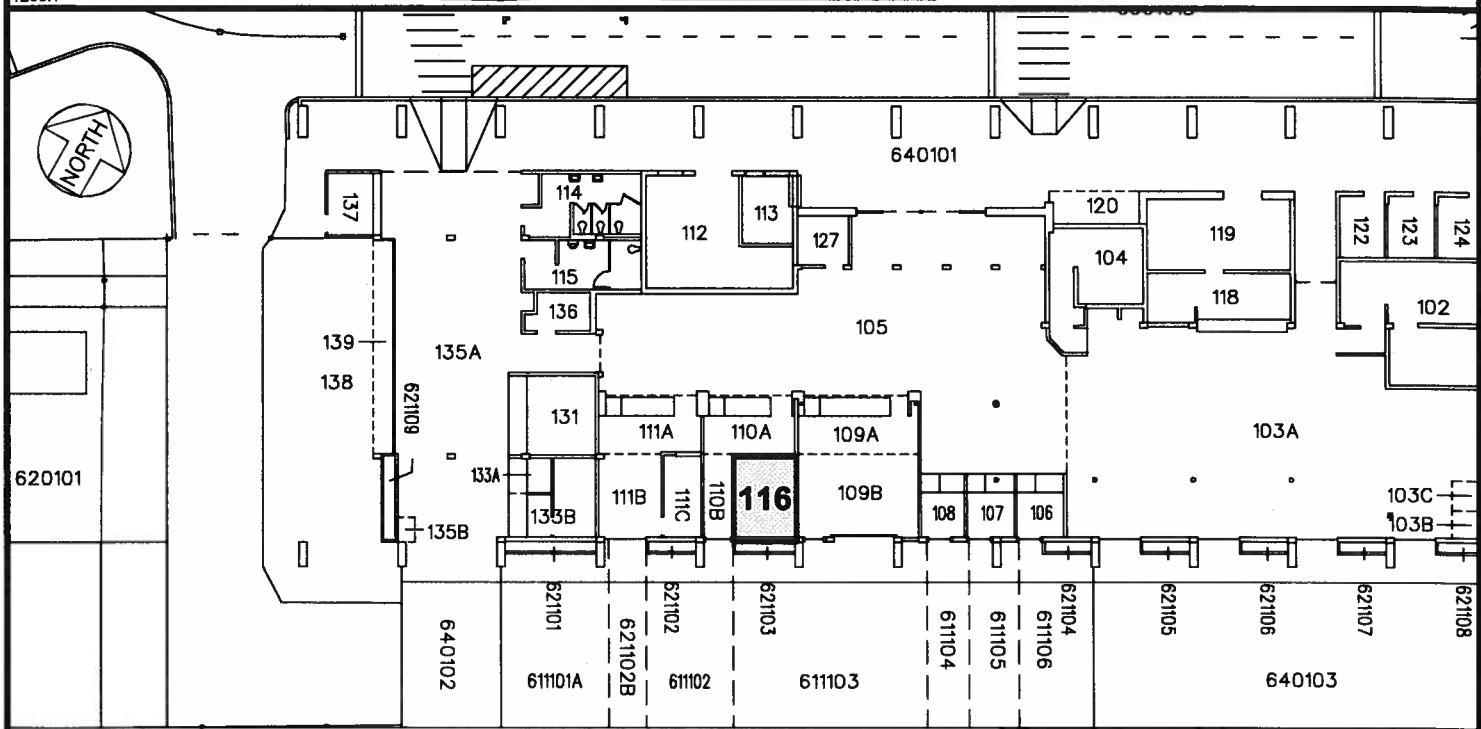

1200:1



SCALE: 1" = 30'

BLDG/ROOM	SQ. FT.
301 116	142

RP-8269

DATE : JANUARY 2015

EXHIBIT: **A**



**HAWAIIAN AIRLINES INC.-
SWFC-POST**

**BUILDING 301
TERMINAL BLDG
GROUND LEVEL**

**301116
PLATS A1, 33**

MOLOKAI AIRPORT

N:\AIRPORTS\MKK_Molokai\CAD\PM\mkk_301116-02.dwg