

DAVID Y. IGE  
GOVERNOR



STATE OF HAWAII  
DEPARTMENT OF TRANSPORTATION  
869 PUNCHBOWL STREET  
HONOLULU, HAWAII 96813-5097

FORD N. FUCHIGAMI  
DIRECTOR

Deputy Directors  
JADE T. BUTAY  
ROSS M. HIGASHI  
EDWIN H. SNIFFEN

IN REPLY REFER TO:

Board of Land and  
Natural Resources  
State of Hawaii  
Honolulu, Hawaii

ISSUANCE OF A REVOCABLE PERMIT FOR PARKING  
HAWAII WILDERNESS ADVENTURES, LLC  
HILO INTERNATIONAL AIRPORT  
TAX MAP KEY: (3) 2-1-12: PORTION OF 90

HAWAII

REQUEST:

Issuance of a Revocable Permit for Parking (parking permit) to Hawaii Wilderness Adventures, LLC at Hilo International Airport (ITO).

LEGAL REFERENCE:

Subsection 171-11 and 171-55, Hawaii Revised Statutes

APPLICANT:

Hawaii Wilderness Adventures, LLC (HWA), whose business address is P.O. Box 5595, Hilo, Hawaii 96720

AREA:

Area/Space No. 413-105, containing an area of approximately 990 square feet as shown on the attached map labeled Exhibit "A"

LOCATION AND TAX MAP KEY:

Portion of Hilo International Airport, Hilo, Island of Hawaii, identified by Tax Map Key: 3<sup>rd</sup> Division, 2-1-12: Portion of 90

ZONING:

State Land Use District:  
County of Hawaii:

Urban  
Industrial (ML-20)

**ITEM M-14**

BLNR – ISSUANCE OF A REVOCABLE PERMIT FOR PARKING  
HAWAII WILDERNESS ADVENTURES, LLC  
Page 2

LAND TITLE STATUS:

Section 5(a) lands (“ceded” lands) of the Hawaii Admission Act  
DHHL 30% entitlement lands pursuant to Hawaii Admission Act YES\_\_\_ NO X

CURRENT USE STATUS:

Airport and aeronautical purposes

CHARACTER OF USE:

Aircraft Tie-Down

COMMENCEMENT DATE:

Upon complete execution of the parking permit

MONTHLY RENTAL:

\$96.00

SECURITY DEPOSIT:

Three times the monthly rental in effect

DCCA VERIFICATION:

Place of business registration confirmed:	YES <u>n/a</u>	NO <u>n/a</u>
Registered business name confirmed:	YES <u>n/a</u>	NO <u>n/a</u>
Good standing confirmed:	YES <u>n/a</u>	NO <u>n/a</u>

CHAPTER 343, HRS - ENVIRONMENTAL ASSESSMENT:

Pursuant to Section 11-200-8(a), Environmental Impact Statement Rules of the Department of Health, State of Hawaii, this disposition is exempt from requirements regarding preparation of an environmental assessment, negative declaration, or environmental impact statement as required by Chapter 343, Hawaii Revised Statutes, as amended, relating to Environmental Impact Statements, because the proposed action falls within Exemption Class #1, Comprehensive Exemption List for the State of Hawaii, Department of Transportation, dated November 15, 2000, as approved by the Environmental Quality Council. Exemption Class #1 covers operations, repairs, or maintenance of existing structures, facilities, equipment, or topographical features involving negligible or no expansion or change of use beyond that previously existing.

BLNR – ISSUANCE OF A REVOCABLE PERMIT FOR PARKING  
HAWAII WILDERNESS ADVENTURES, LLC  
Page 3

REMARKS:

The Department of Transportation (DOT) has no objections to the issuance of a parking permit to HWA, in accordance with Section 171-11 and 171-55, HRS, relating to Public Purposes and Permits, respectively, and therefore, the DOT proposes to issue a month-to-month parking permit to HWA, Area/Space No. 413-105, for an aircraft tie-down at ITO.

RECOMMENDATION:

That the Board authorize the Department of Transportation to issue a month-to-month parking permit to HWA, subject to: (1) terms and conditions herein outlined, which are by reference incorporated herein; and (2) such additional terms and conditions as may be prescribed by the Director of Transportation to best serve the interests of the State.

Respectfully submitted,



FORD N. FUCHIGAMI  
Director of Transportation

APPROVED FOR SUBMITTAL:



---

CARTY S. CHANG  
Acting Chairperson

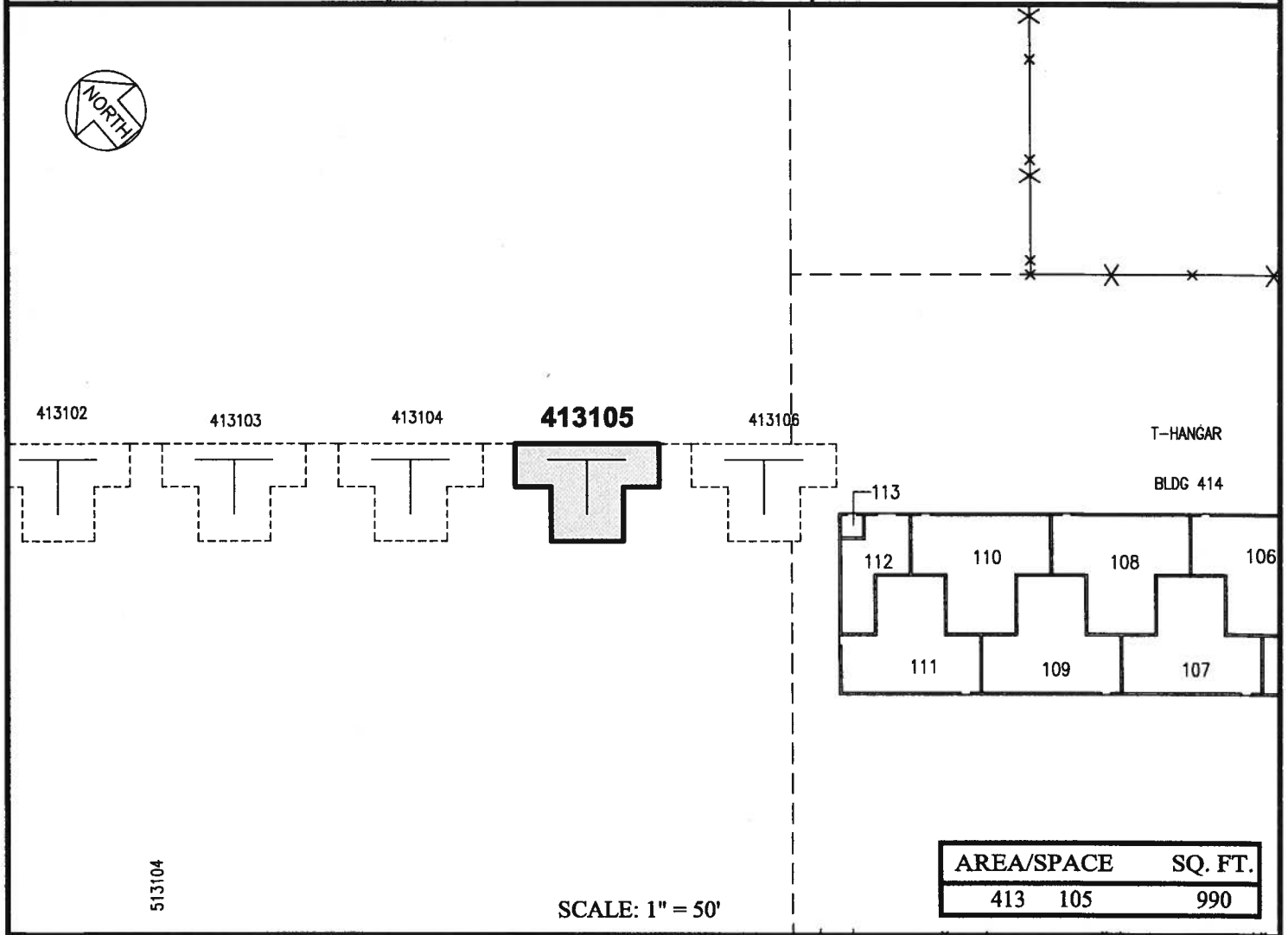
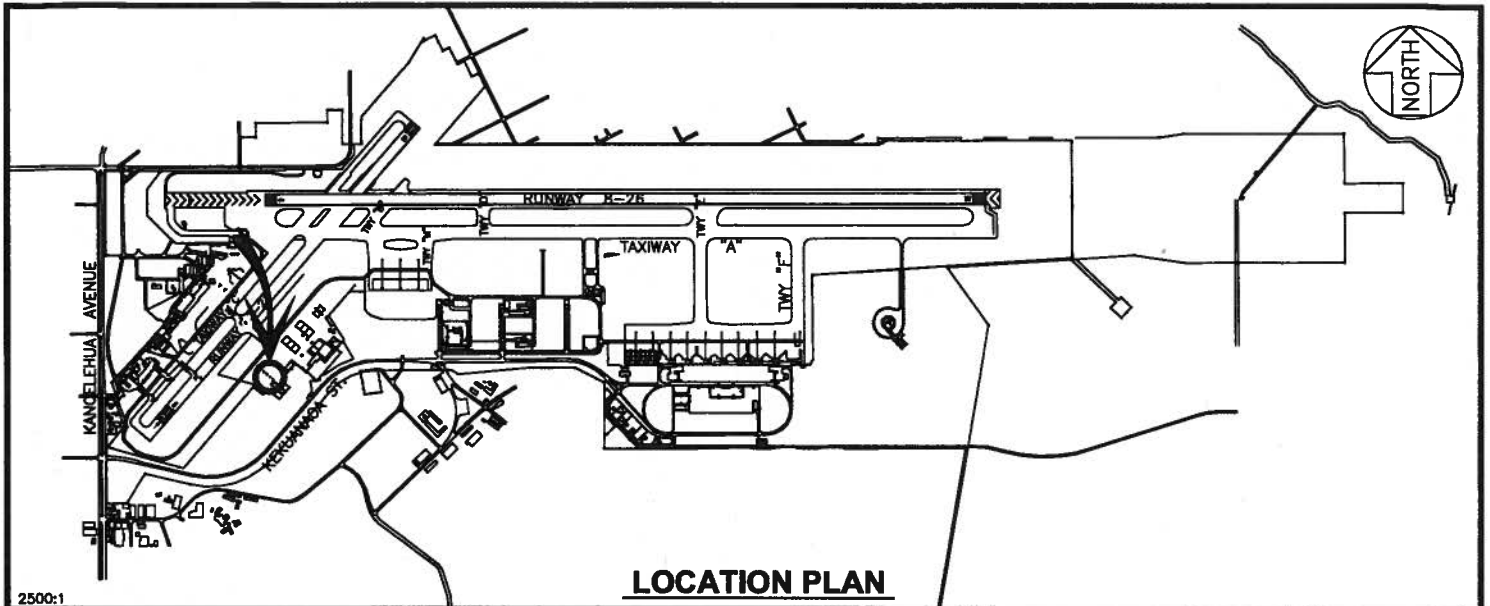

PP-14-S275

DATE : JANUARY 2015

EXHIBIT: **A**



Airports Division

HAWAII WILDERNESS  
ADVENTURES, LLC

TIE-DOWNS

413105  
PLAT 40