

DAVID Y. IGE
GOVERNOR



STATE OF HAWAII
DEPARTMENT OF TRANSPORTATION
869 PUNCHBOWL STREET
HONOLULU, HAWAII 96813-5097

FORD N. FUCHIGAMI
DIRECTOR

Deputy Directors
JADE T. BUTAY
ROSS M. HIGASHI
EDWIN H. SNIFFEN
DARRELL T. YOUNG

IN REPLY REFER TO:

Board of Land and
Natural Resources
State of Hawaii
Honolulu, Hawaii

ISSUANCE OF A REVOCABLE PERMIT FOR THE PURPOSES
OF PARTS AND EQUIPMENT STORAGE AND OFFICE SPACE
VANDERLANDE INDUSTRIES INC.
EWA CONCOURSE, HONOLULU INTERNATIONAL AIRPORT
TAX MAP KEY: 1-1-003: 001 (PORTION)

OAHU

LEGAL REFERENCE:

Section 171-55, Hawaii Revised Statutes

APPLICANT:

Vanderlande Industries Inc. (Vanderlande), whose business address is
1828 W. Oak Parkway, Marietta Georgia 30062.

LOCATION:

Building No. 368, Ewa Concourse Extension, Ground Level, Space Nos. 115A, 115B,
115C, and Building No. 360, Ewa Concourse, Ground Level, Space Nos. 188C at
Honolulu International Airport, Tax Map Key: 1st Division, 1-1-003: 001 (Portion)

AREA:

Space No. 368-115A, containing an area of approximately 2,190 square feet;
Space No. 368-115B, containing an area of approximately 783 square feet;
Space No. 368-115C, containing an area of approximately 629 square feet; and
Space No. 360-188C, containing an area of approximately 142 square feet;
as shown and delineated on the attached map labeled Exhibit "A".

ZONING:

State Land Use District: Urban
City and County of Honolulu LUO: Industrial (I-2)

ITEM M-1

BLNR – ISSUANCE OF A REVOCABLE PERMIT
VANDERLANDE INDUSTRIES INC.
Page 2

LAND TITLE STATUS:

Non-ceded - Section 5(a) lands of the Hawaii Admission Act
DHHL 30% entitlement lands pursuant to Hawaii Admission Act YES ___ NO X

CURRENT USE STATUS:

Land presently encumbered by Governor's Executive Order No. 3201, dated June 8, 1983, setting aside 3,152.177 acres designated as Honolulu International Airport under the control and management of the State of Hawaii, Department of Transportation, Airports Division (DOTA) for Airport Purposes.

CHARACTER OF USE:

Vanderlande will use the spaces as a site office and for storage of spare parts/tools for operations and maintenance of the Inline Explosive Detection System (EDS) at Honolulu International Airport

COMMENCEMENT DATE:

To be determined by the Director of Transportation at a later date.

MONTHLY RENTAL:

\$6,143.83

SECURITY DEPOSIT:

\$18,431.49

HOLDOVER TENANCY:

\$204.79

DCCA VERIFICATION:

Place of business registration confirmed:	YES <u>X</u>	NO ___
Registered business name confirmed:	YES <u>X</u>	NO ___
Good standing confirmed:	YES <u>X</u>	NO ___

CHAPTER 343, HRS - ENVIRONMENTAL ASSESSMENT:

Pursuant to Section 11-200-8(a), Environmental Impact Statement Rules of the Department of Health, State of Hawaii, this disposition is exempt from requirements regarding preparation of an environmental assessment, negative declaration, or

BLNR – ISSUANCE OF A REVOCABLE PERMIT
VANDERLANDE INDUSTRIES INC.

Page 3

environmental impact statement as required by Chapter 343, Hawaii Revised Statutes, as amended, relating to Environmental Impact Statements, because the proposed action falls within Exemption Class #1, Comprehensive Exemption List for the State of Hawaii, Department of Transportation, dated November 15, 2000, as approved by the Environmental Quality Council. Exemption Class #1 covers operations, repairs, or maintenance of existing structures, facilities, equipment, or topographical features involving negligible or no expansion or change of use beyond that previously existing.

REMARKS:

Vanderlande will be maintaining the inline EDS for baggage make-up and breakdown areas within Honolulu International Airport. Maintenance of the system will require that Vanderlande use the requested spaces for storage of parts, equipment, etc. as well as a small office for its operations.

RECOMMENDATION:

That the Board authorize the Department of Transportation to issue a month-to-month revocable permit to Vanderlande Industries Inc., subject to: (1) terms and conditions herein outlined, which are by reference incorporated herein; and (2) such additional terms and conditions as may be prescribed by the Director of Transportation to best serve the interests of the State.

Respectfully submitted,



FORD N. FUCHIGAMI
Director of Transportation

APPROVED FOR SUBMITTAL:

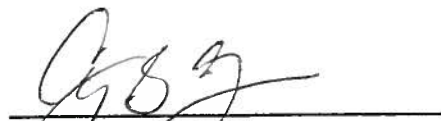

CARTY S. CHANG
Acting Chairperson

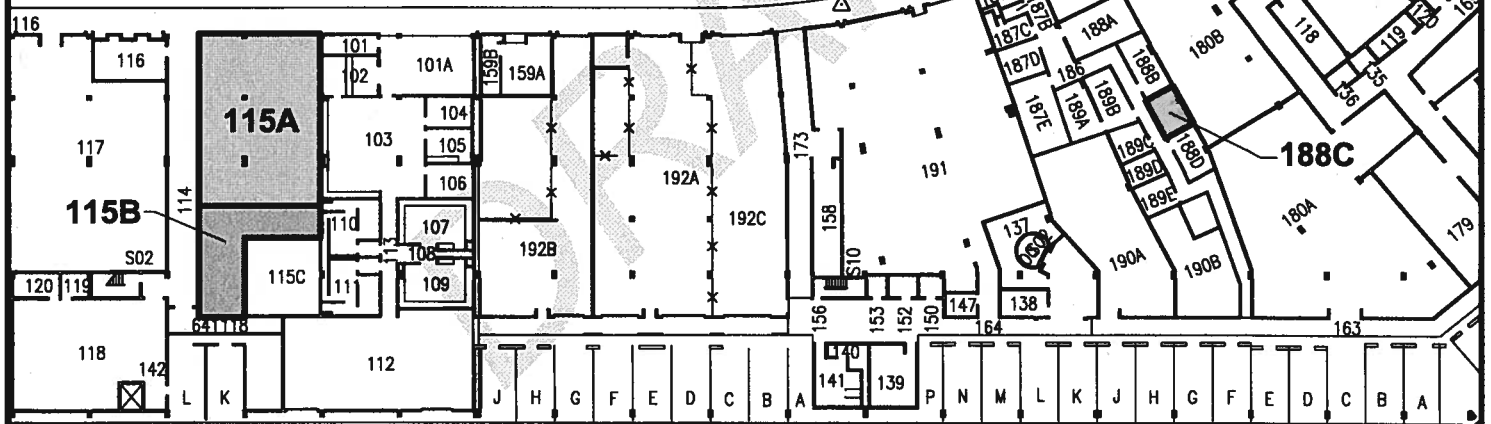
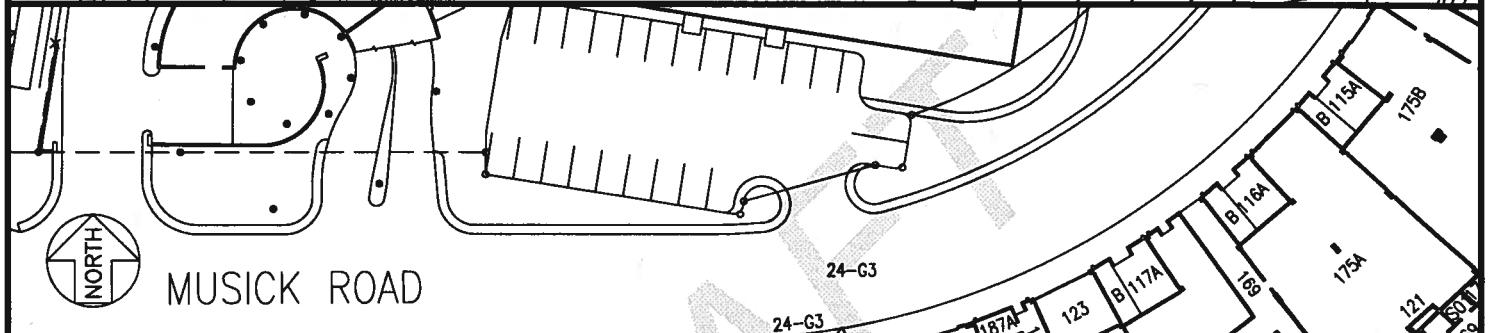
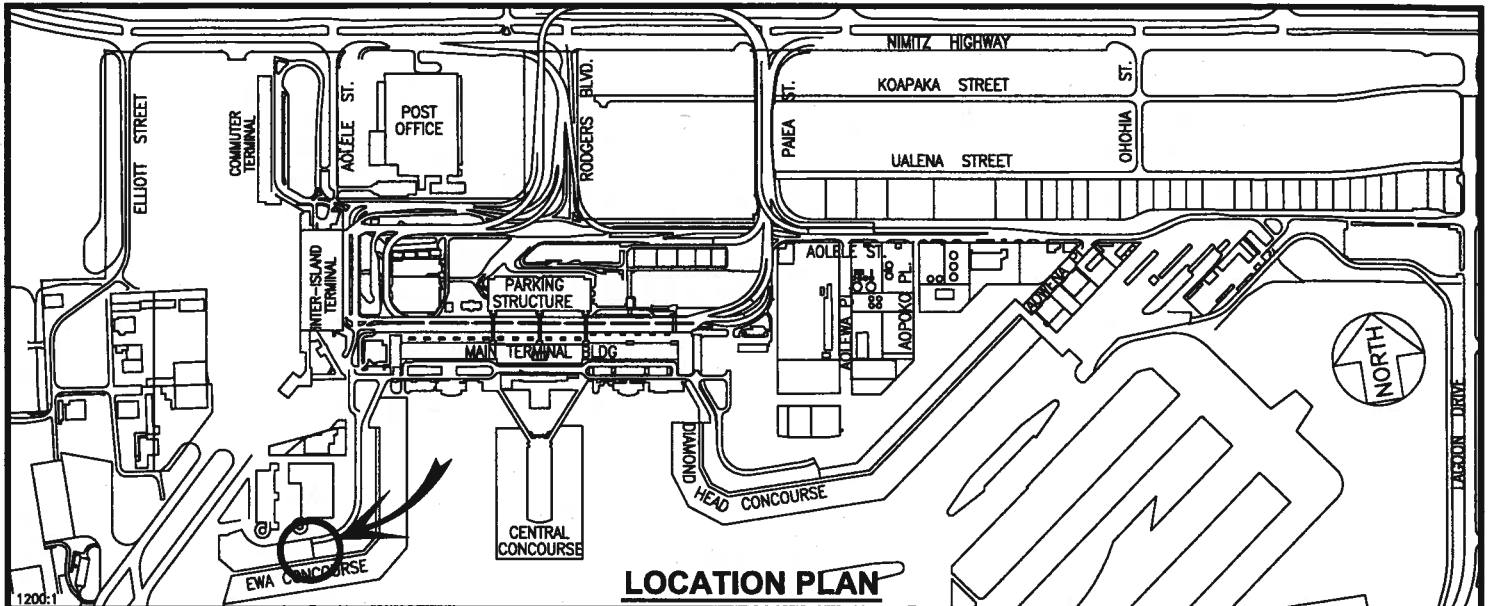

BLDG 368

BLDG 360

SCALE: 1" = 60'

AREA/SPACE	SQ. FT.
360 188C	142
368 115A	2,190
368 115B	783

RP-8282

DATE : FEBRUARY 2015

EXHIBIT: **A**



VANDERLANDE INDUSTRIES, INC.

**BUILDING 360 & 368
EWA CONCOURSE
GROUND LEVEL**

**360188C
368115A,B
PLAT F1**

N:\AIRPORTS\HNL_HONOLULU\CAD\PM_DRAFT\HNL_368115A-01_DRAFT.DWG