

DAVID Y. IGE
GOVERNOR



FORD N. FUCHIGAMI
DIRECTOR

Deputy Directors
JADE T. BUTAY
ROSS M. HIGASHI
EDWIN H. SNIFFEN
DARRELL T. YOUNG

STATE OF HAWAII
DEPARTMENT OF TRANSPORTATION
869 PUNCHBOWL STREET
HONOLULU, HAWAII 96813-5097

Board of Land and
Natural Resources
State of Hawaii
Honolulu, Hawaii

ISSUANCE OF A REVOCABLE PERMIT TO PARK A STORAGE CONTAINER
KANAE, CLARENCE K. AND CORRINE
KALAELOA AIRPORT, ISLAND OF OAHU, STATE OF HAWAII
TAX MAP KEY: (1) 9-1-13: PORTION OF 32

OAHU

LEGAL REFERENCE:

Section 171-55, Hawaii Revised Statutes

APPLICANT:

Clarence K. and Corrine Kanae, whose mailing address is 92-898 Palailai Street,
Kapolei, Hawaii 96707

LOCATION:

Portion of Kalaeloa Airport, Kapolei, Island of Oahu, State of Hawaii, identified by
Tax Map Key: 1st Division, 9-1-13: portion of 32

AREA:

Area/Space No. 800-101, containing a land area of approximately 450 square feet, as
shown and delineated on the attached map labeled Exhibit A.

ZONING:

State Land Use District: Urban
City and County of Honolulu: P-2 (To be rezoned in the future)

LAND TITLE STATUS:

Non-ceded land acquired from the U.S. Government by the State of Hawaii after Statehood
DHHL 30% entitlement lands pursuant to the Hawaii State Constitution: YES ___ NO X

ITEM M-8

BLNR-ISSUANCE OF A REVOCABLE PERMIT
KANAE, CLARENCE K. AND CORRINE
Page 2

CURRENT USE STATUS:

Land presently encumbered by Governor's Executive Order No. 3861, setting aside Kalaeloa Airport under the control and management of the Department of Transportation, Airports Division, State of Hawaii, for Airport Purposes.

CHARACTER OF USE:

The Applicant intends to park a storage container on the premises to store aircraft equipment.

COMMENCEMENT DATE:

Upon execution of the revocable permit.

MONTHLY RENTAL:

\$97.13

SECURITY DEPOSIT:

Three (3) times the monthly land rental in effect.

HOLDOVER TENANCY:

\$3.24

CHAPTER 343, HRS - ENVIRONMENTAL ASSESSMENT:

The subject land area is covered by the Final Environmental Assessment for the Kalaeloa Airfield Development Plan Improvements, State Project No. AO5011-02 dated June 2010. This Environmental Assessment was prepared by Wilson Okamoto Corp. for the State of Hawaii, Department of Transportation, Airports Division, in part to evaluate the environmental effects of the recommended Kalaeloa Airfield Master Plan to meet existing and forecast general aviation demands.

DCCA VERIFICATION:

Not Applicable

REMARKS:

In accordance with Section 171-55, HRS, relating to Permits, the Department of Transportation proposes to issue a month-to-month revocable permit to Clarence K. and Corrine Kanae, to park a storage container on the premises to store aircraft equipment at Kalaeloa Airport.

RECOMMENDATION:

That the Board authorize the Department of Transportation to issue a month-to-month revocable permit to Clarence K. and Corrine Kanae, subject to: (1) terms and conditions herein outlined, which are by reference incorporated herein; and (2) such additional terms and conditions as may be prescribed by the Director of Transportation to best serve the interest of the State.

Respectfully submitted,



FORD N. FUCHIGAMI
Director of Transportation

APPROVED FOR SUBMITTAL:

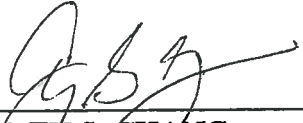

CARTY S. CHANG
Acting Chairperson

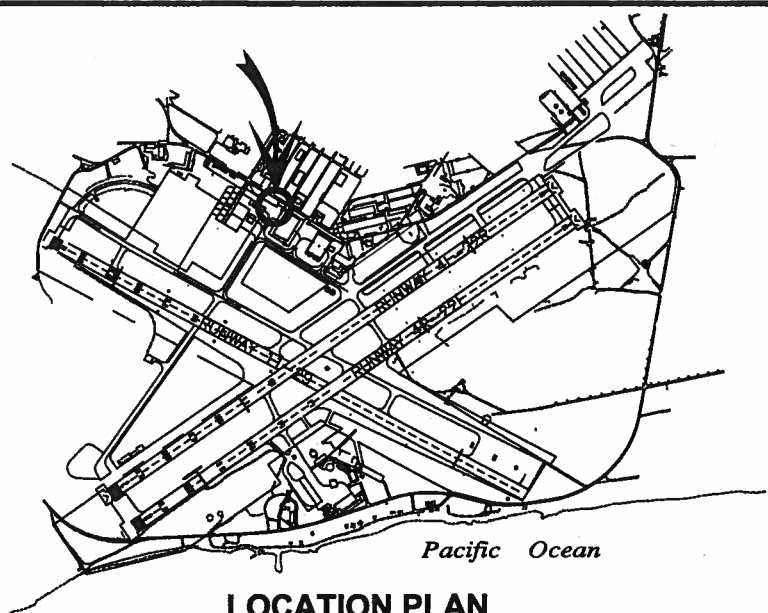

3000:1

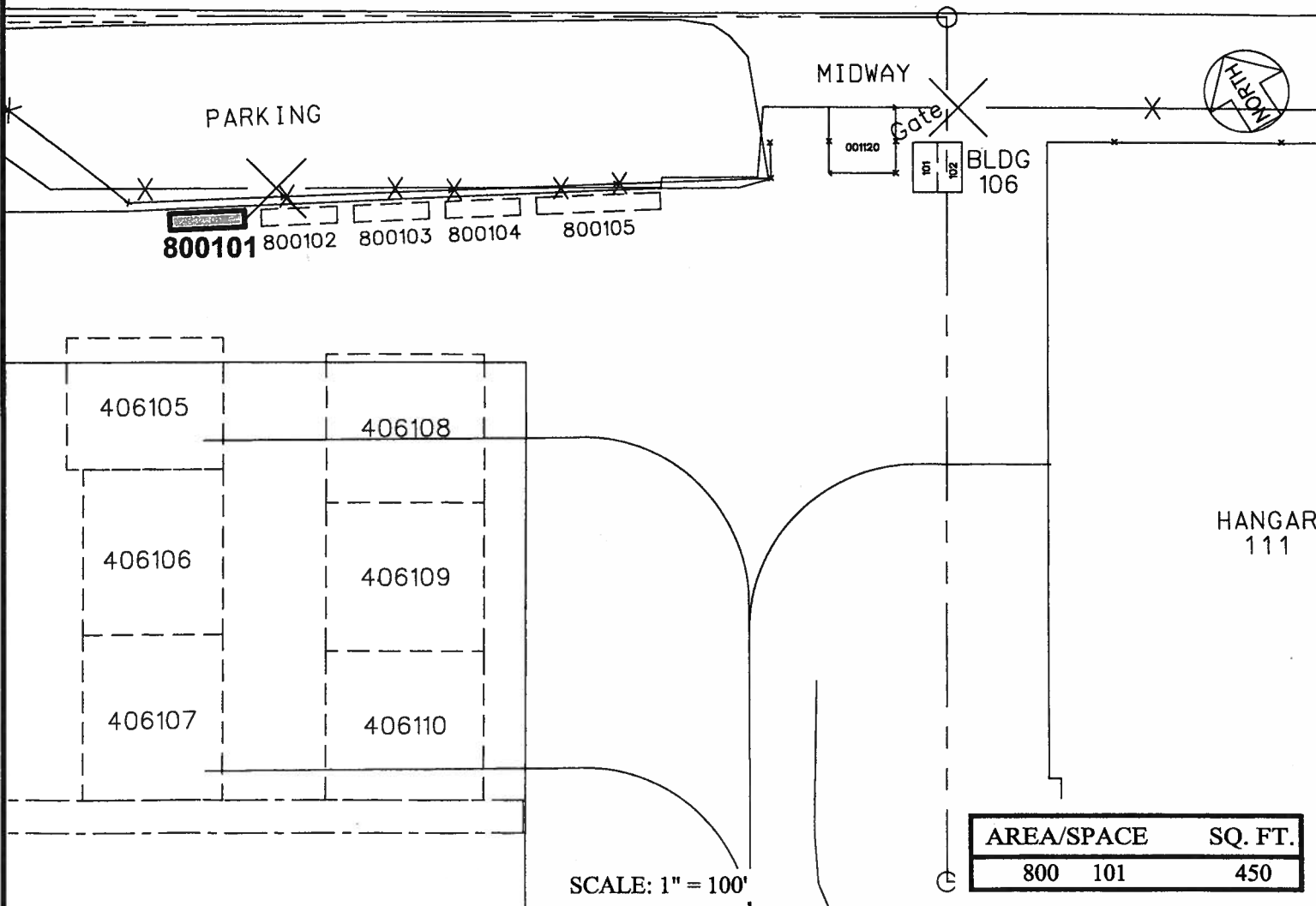

RP-8286

DATE : NOVEMBER 2014

EXHIBIT: **A**



LOT AREA

800101

800101

KALAELOA AIRPORT

N:\AIRPORTS\JRF_Kalaeloa\CAD\PM\Jrf_800101-01.dwg