

DAVID Y. IGE
GOVERNOR



STATE OF HAWAII
DEPARTMENT OF TRANSPORTATION
869 PUNCHBOWL STREET
HONOLULU, HAWAII 96813-5097

FORD. N. FUCHIGAMI
DIRECTOR

Deputy Director
JADE T. BUTAY
ROSS M. HIGASHI
EDWIN H. SNIFFIN
DARRELL T. YOUNG

IN REPLY REFER TO:

Board of Land and
Natural Resources
State of Hawaii
Honolulu, Hawaii

ISSUANCE OF A REVOCABLE PERMIT
FOR HELICOPTER STORAGE AND MAINTENANCE
CITY AND COUNTY OF HONOLULU,
HONOLULU POLICE DEPARTMENT
HONOLULU INTERNATIONAL AIRPORT
TAX MAP KEY: (1) 1-1-72: 13 (PORTION OF)

OAHU

LEGAL REFERENCE:

Section 171-55, Hawaii Revised Statutes

APPLICANT:

The City and County of Honolulu, Honolulu Police Department, whose business address is 801 South Beretania Street, Honolulu, Hawaii 96813.

LOCATION:

120 Kapalulu Place, Honolulu, Hawaii 96819, identified as Building No. 210 and Building No. 244 at the Honolulu International Airport, TMK: (1) 1-1-72: 13 (Portion of).

AREA:

Building/Room No. 210-101, containing an area of approximately 1,052 square feet;
Building/Room No. 210-104, containing an area of approximately 35 square feet;
Building/Room No. 244-101, containing an area of approximately 3,284 square feet;
Building/Room No. 244-102, containing an area of approximately 219 square feet;
Building/Room No. 244-103, containing an area of approximately 225 square feet;
Building/Room No. 244-104, containing an area of approximately 68 square feet;
Building/Room No. 244-105, containing an area of approximately 63 square feet;
Building/Room No. 244-106, containing an area of approximately 170 square feet;
Building/Room No. 244-107, containing an area of approximately 82 square feet;
Building/Room No. 244-201, containing an area of approximately 602 square feet;
Building/Room No. 244-202, containing an area of approximately 170 square feet; and
Building/Room No. 244-203, containing an area of approximately 82 square feet
as shown and delineated on the attached map labeled Exhibit "A, A-1, and A-2".

ITEM M-2

BLNR – ISSUANCE OF A REVOCABLE PERMIT
TO THE CITY AND COUNTY OF HONOLULU POLICE DEPARTMENT
Page 2

ZONING:

State Land Use District: Urban
City and County of Honolulu LUO: Industrial (I-2)

LAND TITLE STATUS:

Public Law 88-233 - lands of the Hawaii Admission Act – Ceded
DHHL 30% entitlement lands pursuant to the Hawaii State Constitution: YES__ NO X

CURRENT USE STATUS:

Land presently encumbered by Governor's Executive Order No. 3201, dated June 8, 1983, setting aside 3,152.177 acres designated as Honolulu International Airport under the control and management of the State of Hawaii, Department of Transportation, Airports Division (DOTA) for Airport Purposes.

CHARACTER OF USE:

Helicopter storage and maintenance.

COMMENCEMENT DATE:

Upon execution of the Revocable Permit.

MONTHLY RENTAL:

Nominal Rent of \$25.00 per month.

DCCA VERIFICATION:

N/A

CHAPTER 343, HRS - ENVIRONMENTAL ASSESSMENT:

Pursuant to Section 11-200-8(a), Environmental Impact Statement Rules of the Department of Health, State of Hawaii, this disposition is exempt from requirements regarding preparation of an environmental assessment, negative declaration, or environmental impact statement as required by Chapter 343, Hawaii Revised Statutes, as amended, relating to Environmental Impact Statements, because the proposed action falls within Exemption Class #1, Comprehensive Exemption List for the State of Hawaii, Department of Transportation, dated November 15, 2000, as approved by the Environmental Quality Council. Exemption Class #1 covers operations, repairs, or maintenance of existing structures, facilities, equipment, or topographical features involving negligible or no expansion or change of use beyond that previously existing.

BLNR – ISSUANCE OF A REVOCABLE PERMIT
TO THE CITY AND COUNTY OF HONOLULU POLICE DEPARTMENT
Page 3

REMARKS:

Building 210 and Building 244 were originally leased to Gilbert W. Delacruz, Trustee and Robert Y. Ota, Trustee (Trust), in which the Honolulu Police Department was a sublessee. Prior to the lease expiration of 7/31/2014, the Trust filed for Bankruptcy. All tenants occupying the building with the exception of the Honolulu Fire Department (HFD) and the Honolulu Police Department (HPD) vacated the premises. HPD was allowed to remain on premises and continue to store and maintain their City-owned helicopters that respond to cases that include tactical callouts involving active shooters, clearing the airway corridor used by Air Force One when the President of the United States arrives or departs from the Honolulu International Airport. In addition, they provided building security and maintenance for DOTA.

Pending the release of Building 210 and Building 244 from Bankruptcy protection, and in accordance with Section 171-55, HRS, relating to Permits, the DOT proposes to issue a month-to-month Revocable Permit to the City and County of Honolulu, Honolulu Police Department to: (1) store and maintain helicopters that responds to cases that include tactical callouts involving active shooters, clearing the airway corridor used by Air Force One when the President of the United States arrives or departs from the Honolulu International Airport, and (2) provide security and maintenance of the premises for DOTA, at a nominal rental of \$25.00 per month.

RECOMMENDATION:

That the Board authorize the Department of Transportation to issue a month-to-month revocable permit to the City and County of Honolulu, Honolulu Police Department subject to: (1) terms and conditions herein outlined, which are by reference incorporated herein; and (2) such additional terms and conditions as may be prescribed by the Director of Transportation to best serve the interests of the State.

Respectfully submitted,



FORD N. FUCHIGAMI
Director of Transportation

APPROVED FOR SUBMITTAL:

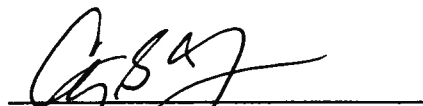

CARTY S. CHANG
Acting Chairperson

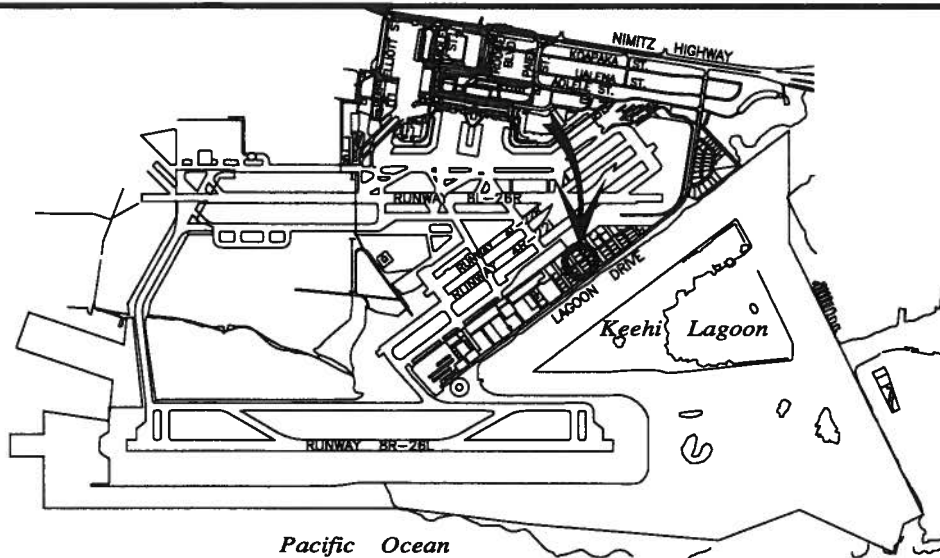

LOCATION PLAN

5000:1

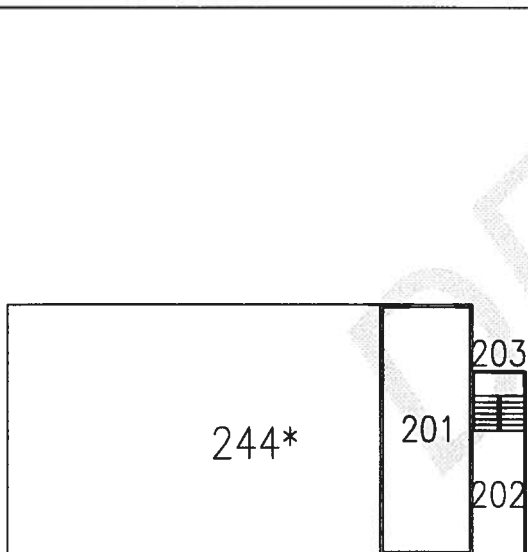

BLDG 210

202

BLDG/ROOM	SQ. FT.
210 201	1,052
210 202	35

SCALE: 1" = 30'

DATE : SEPTEMBER 2014

EXHIBIT: **A**



Airports Division

HPD

**BUILDING 210
FIXED-BASED OP FACILITY
SECOND LEVEL**

210201,
210202

PLAT 24

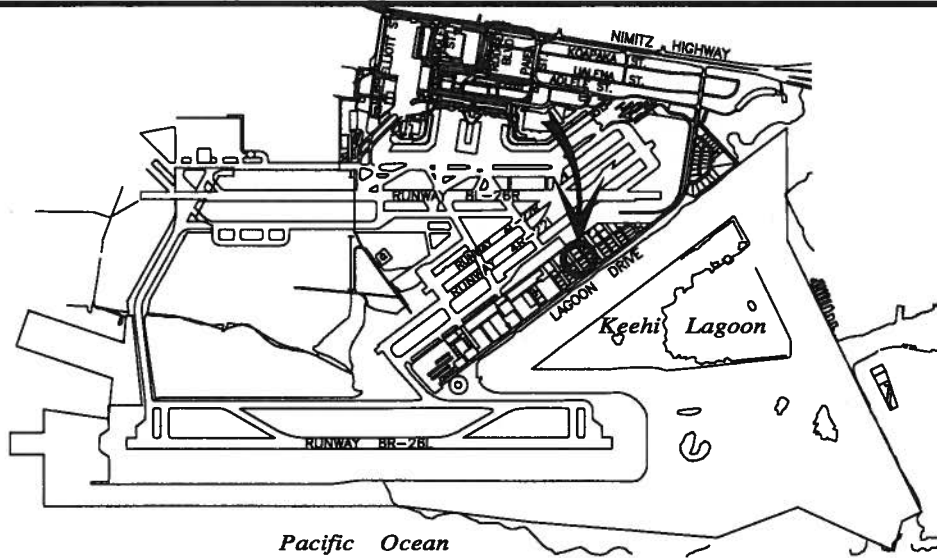

LOCATION PLAN

5000:1

210*

009110

BLDG 244

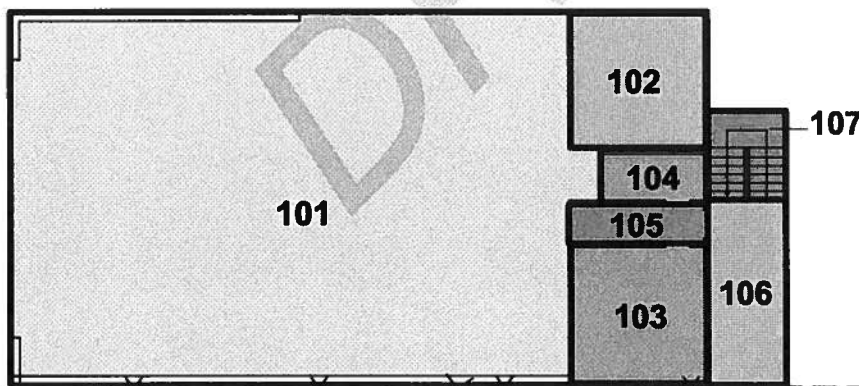

106

104

105

BLDG/ROOM	SQ. FT.
244 101	3,284
244 102	219
244 103	225
244 104	68
244 105	63
244 106	170
244 107	82

SCALE: 1" = 100

DATE : SEPTEMBER 2014

EXHIBIT: **A-1**



Airports Division

HPD

**BUILDING 244
FIXED-BASED OP FACILITY
GROUND LEVEL**

244101-
244107

PLAT 24