



STATE OF HAWAII
DEPARTMENT OF TRANSPORTATION
869 PUNCHBOWL STREET
HONOLULU, HAWAII 96813-5097

FORD N. FUCHIGAMI
DIRECTOR

Deputy Directors
JADE T. BUTAY
ROSS M. HIGASHI
EDWIN H. SNIFFIN
DARRELL T. YOUNG

IN REPLY REFER TO:

Board of Land and
Natural Resources
State of Hawaii
Honolulu, Hawaii

ISSUANCE OF A REVOCABLE PERMIT FOR AIRCRAFT PARKING
HENRY W. PELEKAI
KALAELOA AIRPORT, ISLAND OF OAHU
TAX MAP KEY: (1) 9-1-13: PORTION OF 32

OAHU

REQUEST:

Issuance of a Revocable Permit for Aircraft Parking (parking permit) to
Henry W. Pelekai, situated at Kalaeloa Airport.

LEGAL REFERENCE:

Section 171-55, Hawaii Revised Statutes

APPLICANT:

Henry W. Pelekai, whose mailing address is 89-210 Mano Avenue,
Waianae, Hawaii 96792-4031

LOCATION AND TAX MAP KEY:

A portion of Kalaeloa Airport, Kapolei, Island of Oahu, State of Hawaii, identified by
Tax Map Key: 1st Division, 9-1-13: portion of 32

AREA:

Area/Space No. 405-109, containing an area of approximately 849 square feet,
as shown and delineated on the attached map labeled Exhibit "A".

ZONING:

State Land Use District: Urban
City and County of Honolulu LUO: P-2 (To be rezoned in the future)

ITEM M-5

LAND TITLE STATUS:

Non-ceded - Section 5(a) lands of the Hawaii Admission Act
DHHL 30% entitlement lands pursuant to Hawaii Admission Act YES ___ NO X

CURRENT USE STATUS:

Land presently encumbered by Governor's Executive Order No. 3861, setting aside
Kalaeloa Airport under the control and management of the Department of Transportation,
Airports Division, State of Hawaii, for Airport Purposes.

CHARACTER OF USE:

Aircraft Tie-down

COMMENCEMENT DATE:

Upon execution

MONTHLY RENTAL:

\$24.00

SECURITY DEPOSIT:

Three (3) times the monthly rental in effect.

CHAPTER 343, HRS - ENVIRONMENTAL ASSESSMENT:

The subject land area is covered by the Final Environmental Assessment for the Kalaeloa
Airfield Development Plan Improvements, State Project No. AO5011-02 dated June 2010.
This Environmental Assessment was prepared by Wilson Okamoto Corp. for the State of
Hawaii, Department of Transportation, Airports Division, in part to evaluate the
environmental effects of the recommended Kalaeloa Airfield Master Plan to meet existing
and forecast general aviation demands.

REMARKS:

In accordance with Section 171-55, HRS, relating to Permits, the Department of
Transportation has no objections to the issuance of a month-to-month parking permit to
Henry W. Pelekai, at Kalaeloa Airport.

RECOMMENDATION:

That the Board authorize the Department of Transportation to issue a month-to-month parking permit to Henry W. Pelekai, subject to: (1) terms and conditions herein outlined, which are by reference incorporated herein; and (2) such additional terms and conditions as may be prescribed by the Director of Transportation to best serve the interests of the State.

Respectfully submitted,



FORD N. FUCHIGAMI
Director of Transportation

APPROVED FOR SUBMITTAL:



SUZANNE D. CASE
Chairperson and Member

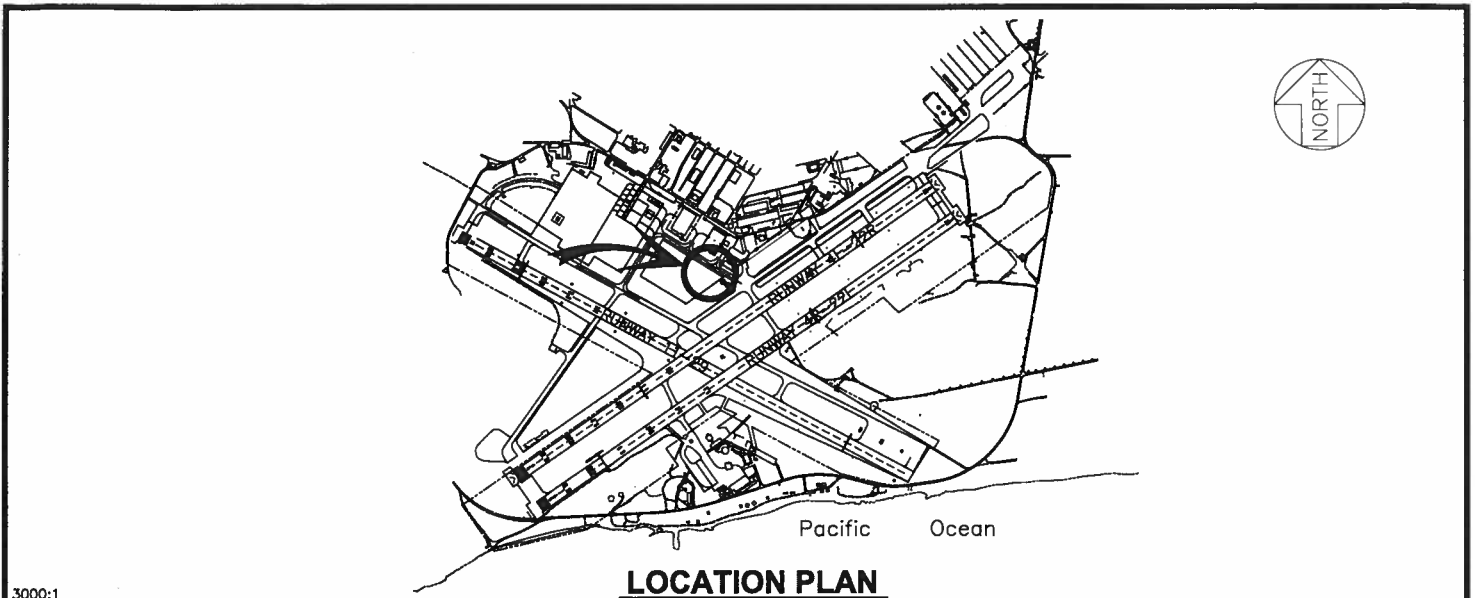

3000:1

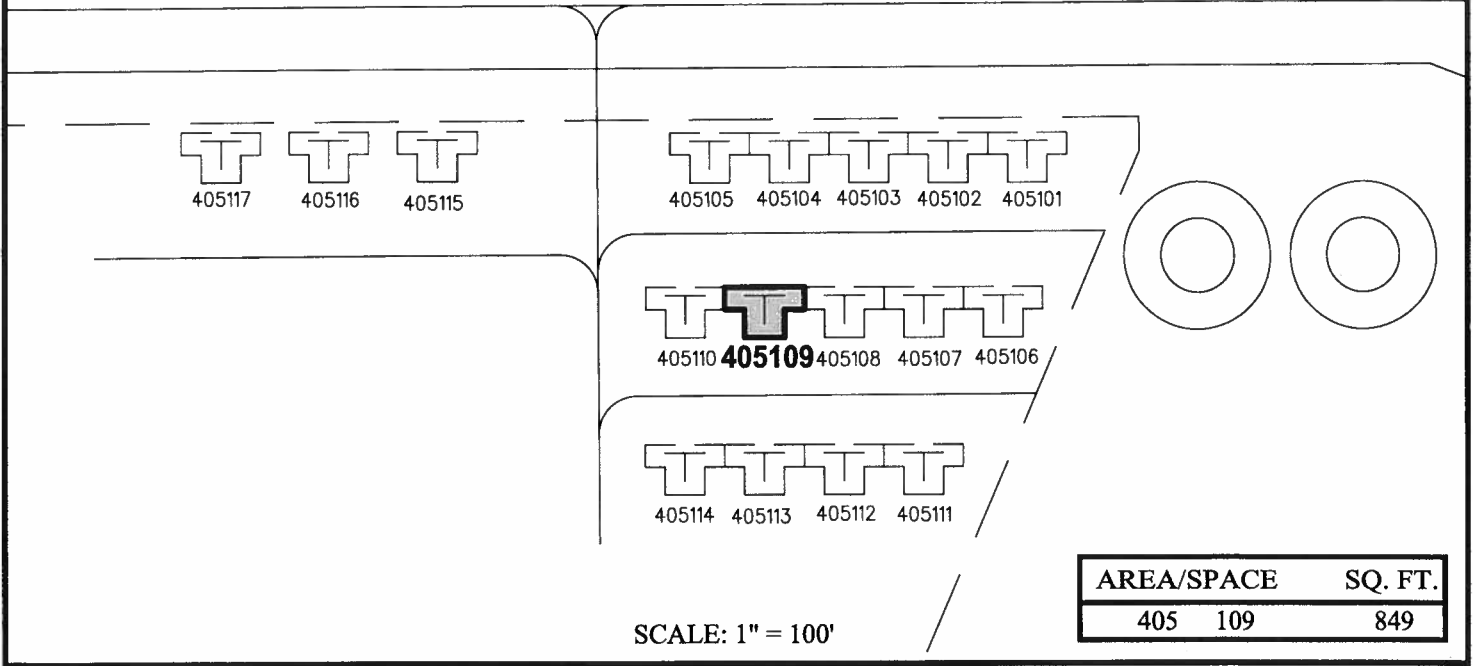
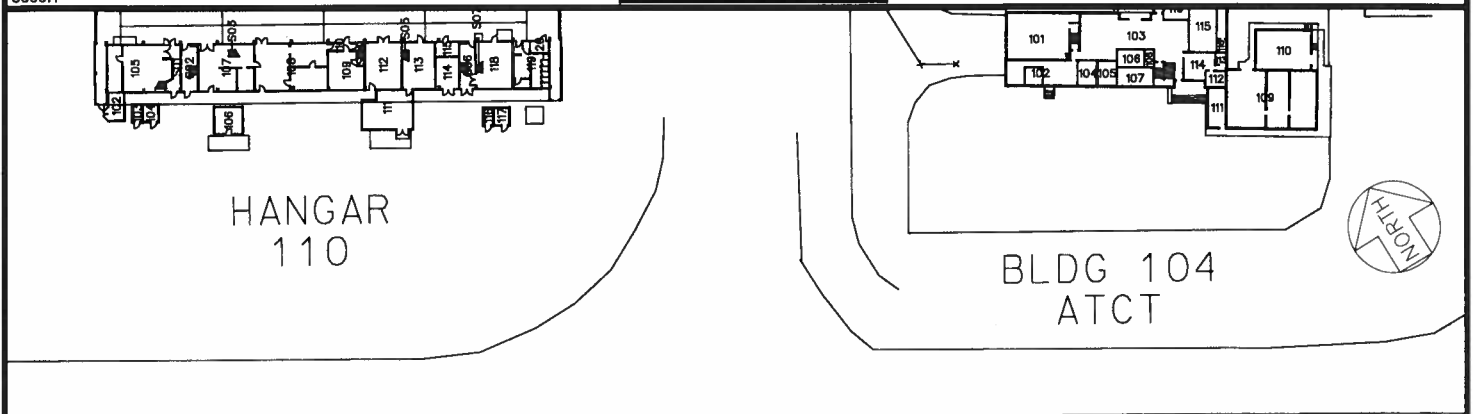

 <p>Airports Division</p>	HENRY W. PELEKAI	TIE-DOWN AREA	405109
---	------------------	---------------	--------

KALAELOA AIRPORT

N:\AIRPORTS\JRF_KALAELOA\CAD\PM\JRF_405109-01.DWG