

DAVID Y. IGE  
GOVERNOR



STATE OF HAWAII  
DEPARTMENT OF TRANSPORTATION  
869 PUNCHBOWL STREET  
HONOLULU, HAWAII 96813-5097

FORD N. FUCHIGAMI  
DIRECTOR

Deputy Directors  
JADE T. BUTAY  
ROSS M. HIGASHI  
EDWIN H. SNIFFIN  
DARRELL T. YOUNG

IN REPLY REFER TO:

Board of Land and  
Natural Resources  
State of Hawaii  
Honolulu, Hawaii

ISSUANCE OF A REVOCABLE PERMIT  
FOR THE STORAGE OF VEHICLES AND EQUIPMENT  
SOUTHERN FOODS GROUP, LLC  
DBA MEADOW GOLD DAIRIES  
KAPALAMA MILITARY RESERVATION  
HONOLULU INTERNATIONAL AIRPORT  
TAX MAP KEY: (1) 1-2-025: 108 & 109 (PORTION)

OAHU

APPLICANT:

Southern Foods Group, LLC doing business as Meadow Gold Dairies (Southern Foods),  
whose business address is P.O. Box 29603, Honolulu, Hawaii, 96820

LEGAL REFERENCE:

Section 171-55, Hawaii Revised Statutes

LOCATION:

Kapalama Military Reservation, Ground Level, Space No. 010-109A & 010-109B at  
Honolulu International Airport, Tax Map Key: 1st Division, (1) 1-2-025: 108 & 109  
(Portion)

AREA:

Space No. 010-109A, containing an area of approximately 28,992 square feet, and  
Space No. 010-109B, containing an area of approximately 33,671 square feet; as shown  
and delineated on the attached map labeled Exhibit "A".

ZONING:

State Land Use District: Urban  
City and County of Honolulu LUO: Industrial (I-2)

**ITEM M-11**

LAND TITLE STATUS:

Non-ceded - Section 5(a) lands of the Hawaii Admission Act  
DHHL 30% entitlement lands pursuant to Hawaii Admission Act    YES \_\_\_    NO X

CURRENT USE STATUS:

Land presently encumbered by Governor’s Executive Order No. 4454, dated April 30, 2014, setting aside 11.344 acres designated to be part of Honolulu International Airport under the control and management of the State of Hawaii, Department of Transportation, Airports Division for Airport Purposes.

CHARACTER OF USE:

Southern Foods will use the space to park vehicles and store equipment.

COMMENCEMENT DATE:

To be determined by the Director of Transportation at a later date.

MONTHLY RENTAL:

\$27,316.13

SECURITY DEPOSIT:

Three (3) times the monthly rental in effect.

HOLDOVER TENANCY:

\$910.54

DCCA VERIFICATION:

Place of business registration confirmed:	YES <u>X</u>	NO ___
Registered business name confirmed:	YES <u>X</u>	NO ___
Good standing confirmed:	YES <u>X</u>	NO ___

CHAPTER 343, HRS - ENVIRONMENTAL ASSESSMENT:

Pursuant to Section 11-200-8(a), Environmental Impact Statement Rules of the Department of Health, State of Hawaii, this disposition is exempt from requirements regarding preparation of an environmental assessment, negative declaration, or

BLNR – ISSUANCE OF A REVOCABLE PERMIT FOR STORAGE OF VEHICLES & EQUIPMENT  
SOUTHERN FOODS GROUP, LLC DBA MEADOW GOLD DAIRIES

Page 3

environmental impact statement as required by Chapter 343, Hawaii Revised Statutes, as amended, relating to Environmental Impact Statements, because the proposed action falls within Exemption Class #1, Comprehensive Exemption List for the State of Hawaii, Department of Transportation, dated November 15, 2000, as approved by the Environmental Quality Council.

REMARKS:

In accordance with Section 171-55 HRS, relating to Permits, the Department of Transportation proposes to issue a month-to-month revocable permit to Southern Foods to occupy a portion of the former Kapalama Military Reservation, Space Nos. 010-109A and 010-109B, to park vehicles and store equipment.

RECOMMENDATION:

That the Board authorize the Department of Transportation to issue a month-to-month revocable permit to Southern Foods, subject to: (1) terms and conditions herein outlined, which are by reference incorporated herein; and (2) such additional terms and conditions as may be prescribed by the Director of Transportation to best serve the interests of the State.

Respectfully submitted,



FORD N. FUCHIGAMI  
Director of Transportation

APPROVED FOR SUBMITTAL:



SUZANNE D. CASE  
Chairperson and Member

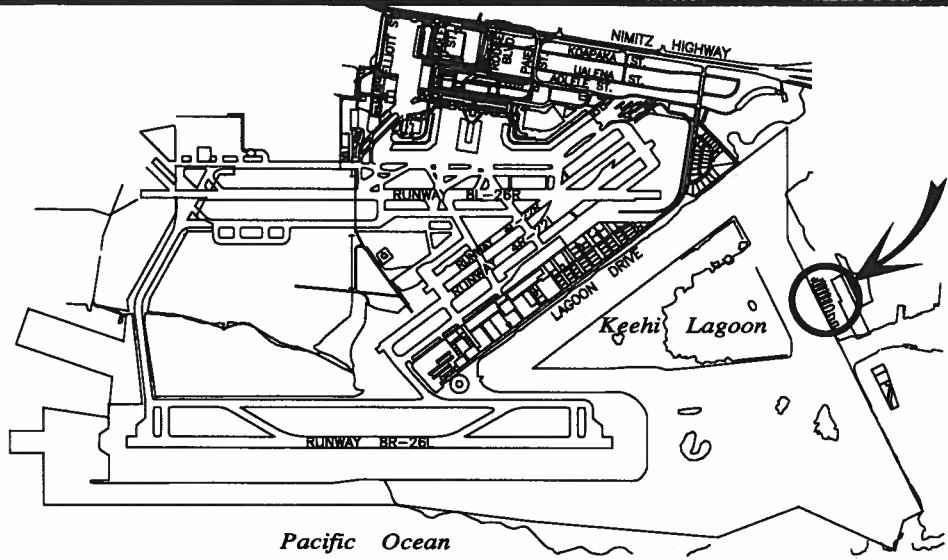

**LOCATION PLAN**

5000:1

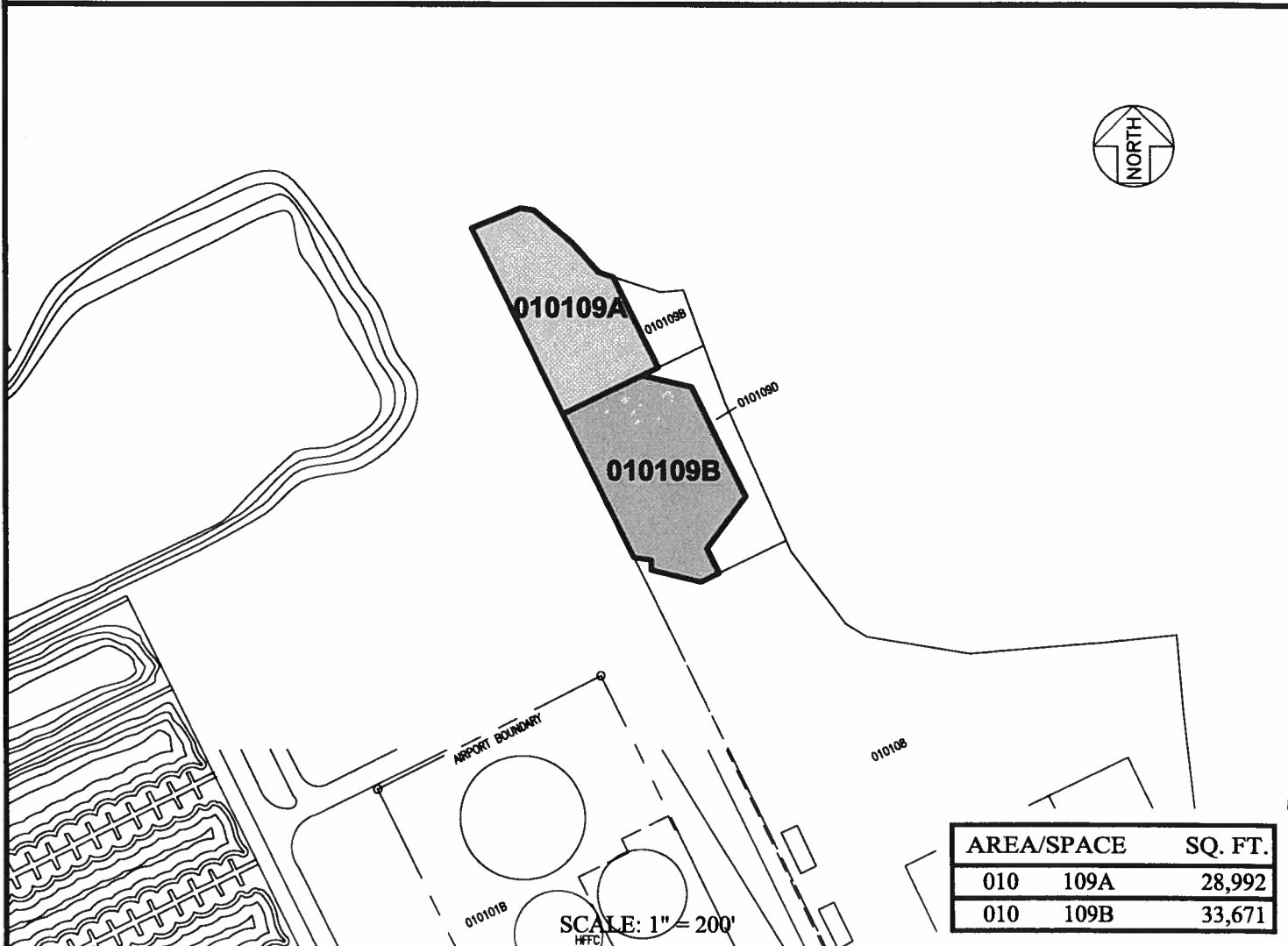

AREA/SPACE	SQ. FT.
010 109A	28,992
010 109B	33,671

SCALE: 1" = 200'

RP-8384

DATE : August 2015

EXHIBIT: **A**



**SOUTHERN FOODS GROUP, LLC**

**KAPALAMA MILITARY RESERVATION**

**010109A  
010109B**

**HONOLULU INTERNATIONAL AIRPORT**

N:\AIRPORTS\HNL\_HONOLULU\CAD\PM\HNL\_010109A\_2015-01.DWG