

DAVID Y. IGE
GOVERNOR



STATE OF HAWAII
DEPARTMENT OF TRANSPORTATION
869 PUNCHBOWL STREET
HONOLULU, HAWAII 96813-5097

FORD N. FUCHIGAMI
DIRECTOR

Deputy Directors
JADE T. BUTAY
ROSS M. HIGASHI
EDWIN H. SNIFFEN
DARRELL T. YOUNG

IN REPLY REFER TO:

Board of Land and
Natural Resources
State of Hawaii
Honolulu, Hawaii

ISSUANCE OF A REVOCABLE PERMIT FOR A T-HANGAR
CHRISTOPHER LINDEN AND MARK SWANN
HILO INTERNATIONAL AIRPORT
TAX MAP KEY: (3) 2-1-12: PORTION OF 90

HAWAII

REQUEST:

Issuance of a Revocable Permit for a T-hangar at Hilo International Airport (ITO)

LEGAL REFERENCE:

Sections 171-11 and 171-55, Hawaii Revised Statutes

APPLICANT:

Christopher Linden and Mark Swann (CLMS) whose address is 400 Hualani Street,
Hilo, Hawaii 96720

LOCATION AND TAX MAP KEY:

Portion of ITO, Hilo, Island of Hawaii, identified by
Tax Map Key: 3rd division, 2-1-12: Portion of 90

AREA:

Space No. 414-108 shown on the attached Exhibit "A"

ZONING:

State Land Use District:
County of Hawaii:

Urban
Industrial (ML-20)

ITEM M-6

BLNR – ISSUANCE OF A REVOCABLE PERMIT FOR A T-HANGAR
CHRISTOPHER LINDEN AND MARK SWANN
Page 2

LAND TITLE STATUS:

Section 5(a) lands of the Hawaii Admission Act: Ceded
DHHL 30% entitlement lands pursuant to Hawaii Admission Act YES ___ NO X

CURRENT USE STATUS:

Airport and aeronautical purposes

CHARACTER OF USE:

T-Hangar

COMMENCEMENT DATE:

Upon complete execution of the revocable permit

MONTHLY RENTAL:

\$661.44

SECURITY DEPOSIT:

\$1,984.32

HOLDOVER TENANCY:

\$22.05

DCCA VERIFICATION:

Place of business registration confirmed:	Not applicable
Registered business name confirmed:	Not applicable
Good standing confirmed:	Not applicable

REMARKS:

The issuance of revocable permits for a T-Hangar to CLMS at Hilo International Airport complies with Chapter 343, Exemption Class 1.D.10. as continuing aeronautical use, and is in accordance with Section 171-55 HRS, relating to Permits.

BLNR – ISSUANCE OF A REVOCABLE PERMIT FOR A T-HANGAR
CHRISTOPHER LINDEN AND MARK SWANN

Page 3

RECOMMENDATION:

That the Board authorize the Department of Transportation to issue a month-to-month revocable permit to CLMS, subject to: (1) terms and conditions herein outlined, which are by reference incorporated herein; and (2) such additional terms and conditions as may be prescribed by the Director of Transportation to best serve the interests of the State.

Respectfully submitted,

FORD N. FUCHIGAMI
Director of Transportation

APPROVED FOR SUBMITTAL:



SUZANNE D. CASE
Chairperson and Member

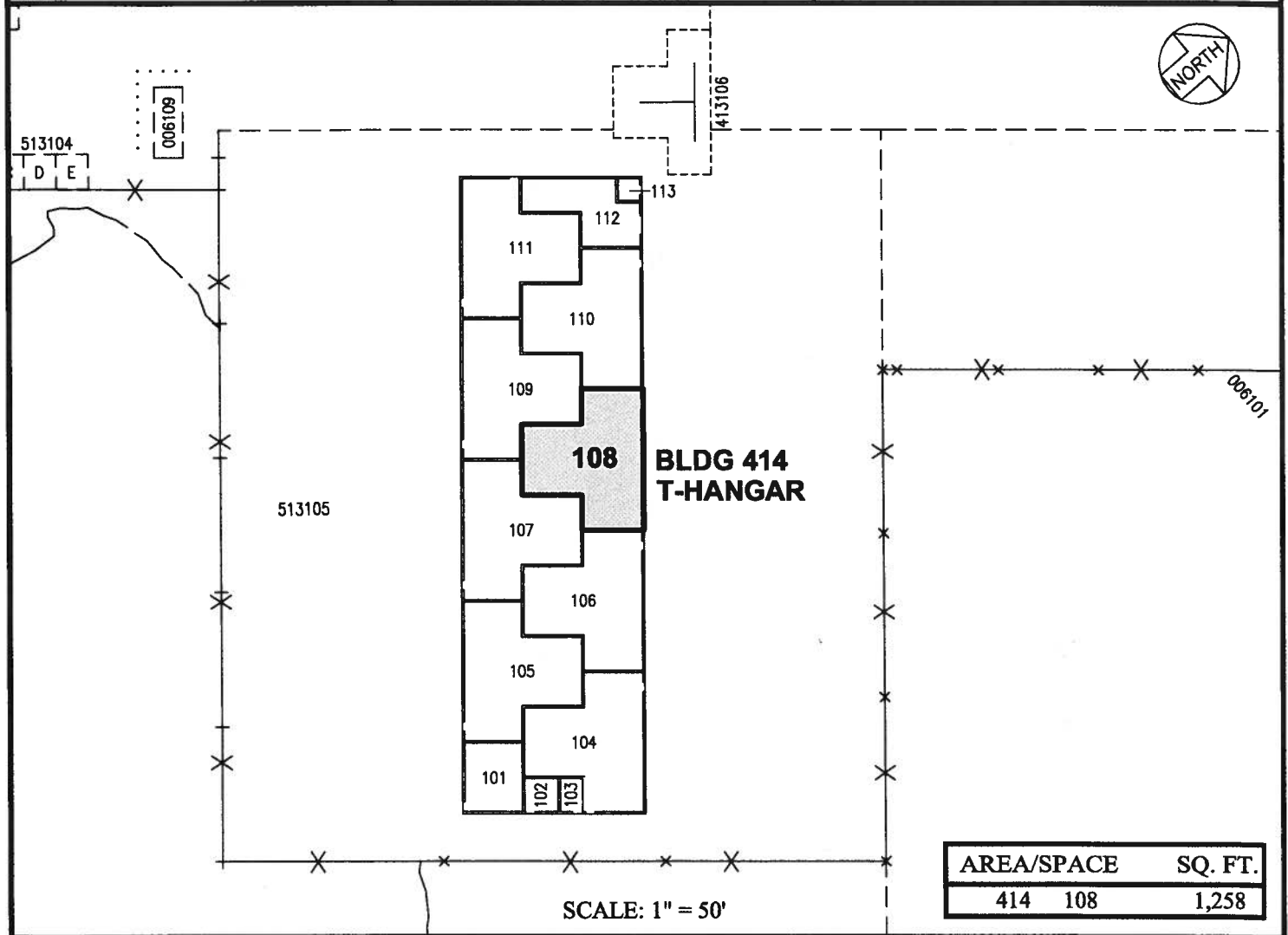
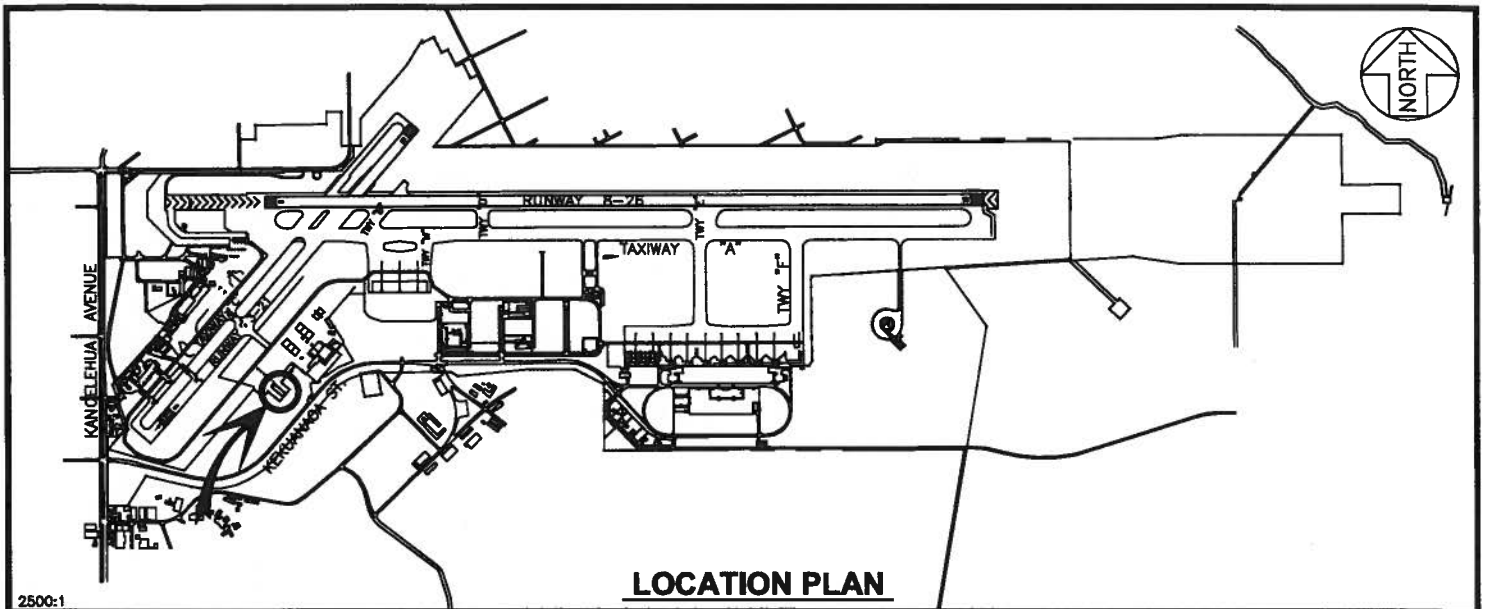

DATE : FEBRUARY 2015

EXHIBIT: **A**



Airports Division

**BUILDING 414
T-HANGAR
GROUND LEVEL**

**414108
PLAT 40**